

LISTA DE APLICACIONES - BUYERS GUIDE

78BD3272-2

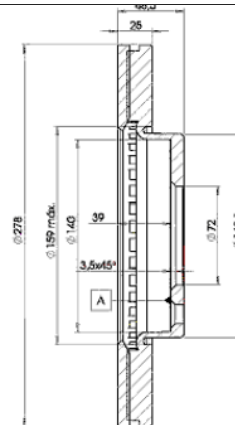

Weight: 14.324

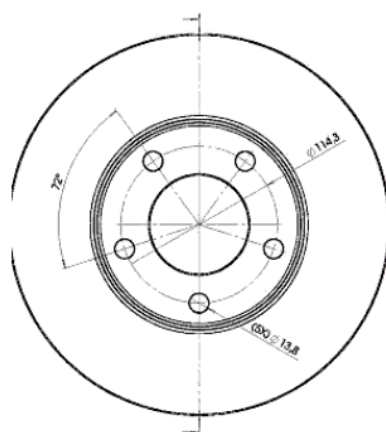

78BD3272-2

E1 90R-02C0452/0118



Ø278x25x48.8

MAKE

FIAT

IVECO

MAZDA



Trac.

CC

Kw

CV



Front / Rear

FIAT

FIORINO II (146_) 01.88-05.01

Pickup (LCVs-N1 Segment)

1.5	Gasolina	FWD	1497	52	71	05.88-11.93	■
-----	----------	-----	------	----	----	-------------	---

IVECO

DAILY III 05.99-10.09

Van (LCVs-N1 Segment)

65C15 (8140.43N)	Diesel	RWD	2798	107	146	11.01-04.06	■
------------------	--------	-----	------	-----	-----	-------------	---

MAZDA

3 II / AXELA (BL) 12.08-09.14

Hatchback (Compact car-C Segment)

1.6 MZR (BL14) (Z668)	Gasolina	FWD	1598	77	105	12.08-09.14	■
1.6 MZR (BL14) (Z682)	Gasolina	FWD	1598	77	105	12.08-09.14	■
1.6 MZR (BL14) (Z683)	Gasolina	FWD	1598	77	105	12.08-09.14	■
1.6 MZR (Z6)	Gasolina	FWD	1598	79	107	01.10-12.13	■
2.0 DISI (BLEFW) (LF-VDS)	Gasolina	FWD	1998	110	150	05.09-02.12	■
2.0 (BLFFW, BL107, BLFFP)	Gasolina	FWD	1998	113	154	09.11-10.13	■
2.0 MZR (BLEFW, BL10F) (LF5H)	Gasolina	FWD	1999	108	147	04.09-09.14	■
2.0 MZR (BLEFW, BL10F) (LF5W)	Gasolina	FWD	1999	108	147	04.09-09.14	■
2.0 MZR DISI (BLEFW) (LFZ2)	Gasolina	FWD	1999	111	151	12.08-05.13	■
2.3 MPS Turbo (BL14) (L3Y7)	Gasolina	FWD	2261	191	260	12.08-09.14	■
2.3 MPS Turbo	Gasolina	FWD	2261	196	267	06.09-	■
2.5	Gasolina	FWD	2488	125	170	01.12-12.13	■
2.0	Gasol./Etanol	FWD	1999	108	147	06.10-05.13	■
1.6 MZ-CD (BL14) (Y642)	Diesel	FWD	1560	80	109	12.08-05.13	■
1.6 MZR CD (BL14) (Y650)	Diesel	FWD	1560	85	116	09.10-05.13	■

LISTA DE APLICACIONES - BUYERS GUIDE

1.6 MZR CD (BL14) (Y655)		Diesel	FWD	1560	85	116	09.10-05.13	■
2.2 MZR CD (BL10) (R2AA)		Diesel	FWD	2184	110	150	01.09-10.13	■
2.2 MZR CD (BL10) (R2AA)		Diesel	FWD	2184	136	185	01.09-05.13	■
3 II / AXELA (BL) 12.08-					Saloon (Compact car-C Segment)			
1.6 MZR (BL12) (Z668)		Gasolina	FWD	1598	77	105	12.08-09.14	■
1.6 MZR (BL12) (Z682)		Gasolina	FWD	1598	77	105	12.08-09.14	■
1.6 MZR (BL12) (Z683)		Gasolina	FWD	1598	77	105	12.08-09.14	■
2.0 (BLFFP) (PEY2)		Gasolina	FWD	1998	113	154	09.11-09.14	■
2.0 MZR		Gasolina	FWD	1999	108	147	06.10-	■
2.0 MZR (BL12, BLEFP) (LF5H)		Gasolina	FWD	1999	110	150	03.09-09.14	■
2.0 MZR (BL12, BLEFP) (LF5W)		Gasolina	FWD	1999	110	150	03.09-09.14	■
2.0 MZR DISI (BL12) (LFZ2)		Gasolina	FWD	1999	111	151	02.09-05.13	■
2.5		Gasolina	FWD	2488	122	166	05.09-09.14	■
2.5		Gasolina	FWD	2488	125	170	01.10-	■
1.6 MZR CD (BL12) (Y642)		Diesel	FWD	1560	80	109	12.08-05.13	■
1.6 MZR CD (BL14) (Y650)		Diesel	FWD	1560	85	116	09.10-05.13	■
1.6 MZR CD (BL14) (Y655)		Diesel	FWD	1560	85	116	09.10-05.13	■
2.2 MZR CD (BL10) (R2AA)		Diesel	FWD	2184	110	150	01.09-09.14	■
2.2 MZR CD (BL10) (R2AA)		Diesel	FWD	2184	136	185	06.09-05.13	■
3 III / AXELA (BM_, BN_) 09.13-					Saloon (Compact car-C Segment)			
2.0		Gasolina	FWD	1998	116	158	01.14-05.19	■
3 / AXELA (BK) 10.03-12.09					Hatchback (Compact car-C Segment)			
1.3 (BK14) (ZJ07)		Gasolina	FWD	1349	62	84	10.03-06.09	■
1.3 (BK14) (ZJ30)		Gasolina	FWD	1349	62	84	10.03-06.09	■
1.3 (BK14) (ZJ32)		Gasolina	FWD	1349	62	84	10.03-06.09	■
1.4		Gasolina	FWD	1388	59	80	02.04-06.09	■
1.6 (BK14) (Z601)		Gasolina	FWD	1598	77	105	10.03-06.09	■
1.6 (BK14) (Z627)		Gasolina	FWD	1598	77	105	10.03-06.09	■
2.0 (BK10F, BKEP)		Gasolina	FWD	1999	104	141	10.03-06.06	■
2.3 MPS		Gasolina	FWD	2261	196	267	01.07-06.09	■
1.6 MZ-CD (Y406)		Diesel	FWD	1560	66	90	06.06-12.09	■
1.6 DI Turbo (Y601)		Diesel	FWD	1560	80	109	06.04-06.09	■
1.6 DI Turbo (Y603)		Diesel	FWD	1560	80	109	06.04-06.09	■
1.6 DI Turbo (Y605)		Diesel	FWD	1560	80	109	06.04-06.09	■
1.6 DI Turbo (Y642)		Diesel	FWD	1560	80	109	06.04-06.09	■
3 / AXELA (BK) 09.99-12.09					Saloon (Compact car-C Segment)			
1.6 (BK12) (Z601)		Gasolina	FWD	1598	77	105	02.04-06.09	■
1.6 (BK12) (Z627)		Gasolina	FWD	1598	77	105	02.04-06.09	■
2.0 (BK10F, BKEP) (LF17)		Gasolina	FWD	1999	104	141	10.03-06.06	■
1.6 DI Turbo (BK12Y) (Y601)		Diesel	FWD	1560	80	109	06.04-06.09	■
1.6 DI Turbo (BK12Y) (Y603)		Diesel	FWD	1560	80	109	06.04-06.09	■
1.6 DI Turbo (BK12Y) (Y605)		Diesel	FWD	1560	80	109	06.04-06.09	■
1.6 DI Turbo (BK12Y) (Y642)		Diesel	FWD	1560	80	109	06.04-06.09	■
5 II / PREMACY (CR) 02.05-12.10					MPV (Compact MPV-M1 Segment)			
1.8 (CR19) (L823)	Rim 15	Gasolina	FWD	1798	85	116	02.05-05.10	■
2.0 (CREW) (LFF7)	Rim 15	Gasolina	FWD	1999	107	146	02.05-05.10	■
2.3 (CR3W)		Gasolina	FWD	2261	122	166	02.05-09.08	■
2.0 CD (CR19) (RF7J)	Rim 15	Diesel	FWD	1998	81	110	02.05-05.10	■
2.0 CD (CR19) (RF7J)	Rim 15	Diesel	FWD	1998	105	143	02.05-05.10	■

LISTA DE APLICACIONES - BUYERS GUIDE

5 III / PREMACY (CW) 06.10-					MPV (Compact MPV-M1 Segment)			
2.0 (CWFFW)	Gasolina	FWD	1998	111	151	08.14-	■	
2.0 (LF-ZB)	Gasolina	FWD	1999	108	147	01.11-	■	