

LISTA DE APLICACIONES - BUYERS GUIDE

78BD3290-2



Weight: 13.864

| O.E.M. | MAKE |
|-------------|---------|
| 51712-26000 | HYUNDAI |
| 51712-3B000 | HYUNDAI |

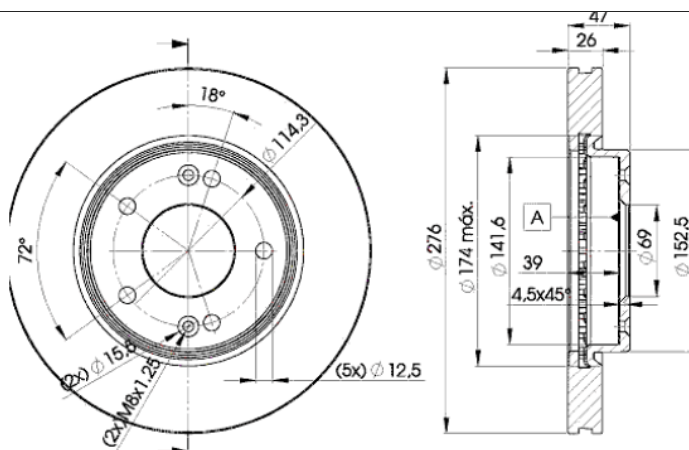

78BD3290-2

E1 90R-02C0452/0086



Ø276x26x46

MAKE
HYUNDAI



| Trac. | CC | Kw | CV | | |
|-------|----|----|----|--|--------------|
| | | | | | |
| | | | | | Front / Rear |

HYUNDAI

GALLOPER 08.91-07.98

Closed Off-Road Vehicle (Compact SUV-J Segment)

| | | | | | | | | |
|-----------------------------|--|----------|-----|------|-----|-----|-------------|---|
| 3.0 V6 (6G72) | | Gasolina | 4WD | 2972 | 104 | 141 | 08.91-07.98 | ■ |
| 2.5 TD (4D56-T) | | Diesel | 4WD | 2477 | 62 | 85 | 08.91-07.98 | ■ |
| 2.5 TD intercooler (4D56-T) | | Diesel | 4WD | 2477 | 70 | 95 | 08.91-07.98 | ■ |

HIGHWAY VAN 03.00-03.04

Box Body/MPV (LCVs-N1 Segment)

| | | | | | | | | |
|-------------------|-------------------|----------|-----|------|-----|-----|-------------|---|
| 2.0 CVVT (G4GC) | | Gasolina | FWD | 1975 | 104 | 141 | 11.03-03.04 | ■ |
| 2.0 16V (G4JP) | | Gasolina | FWD | 1997 | 100 | 136 | 03.00-03.04 | ■ |
| 2.7 V6 24V (G6BA) | vehicles with ABS | Gasolina | FWD | 2656 | 127 | 173 | 03.00-03.04 | ■ |
| 2.0 CRDi (D4EA) | | Diesel | FWD | 1991 | 83 | 113 | 03.01-03.04 | ■ |

SANTA FE (SM) 08.00-03.06

SUV Van (Executive SUV-J Segment)

| | | | | | | | | |
|----------|--------|----------|-----|------|-----|-----|-------------|---|
| 2.4 4x4 | Rim 15 | Gasolina | 4WD | 2351 | 107 | 145 | 08.00-12.05 | ■ |
| CVVT 4x4 | Rim 15 | Gasolina | 4WD | 2656 | 127 | 173 | 08.00-12.05 | ■ |
| CRDi | Rim 15 | Diesel | FWD | 1991 | 83 | 113 | 08.01-07.03 | ■ |
| CRDi 4x4 | Rim 15 | Diesel | 4WD | 1991 | 83 | 113 | 04.01-12.05 | ■ |
| CRDi 4x4 | Rim 15 | Diesel | 4WD | 1991 | 92 | 125 | 08.03-03.06 | ■ |

SANTA FE (SM) 11.00-03.06

SUV (Executive SUV-J Segment)

| | | | | | | | | |
|--------------------|--------|----------|-----|------|-----|-----|-------------|---|
| 2.0 (G4JP) | Rim 15 | Gasolina | FWD | 1997 | 99 | 135 | 08.01-03.06 | ■ |
| 2.4 16V (G4JS) | Rim 15 | Gasolina | FWD | 2351 | 100 | 136 | 02.01-03.06 | ■ |
| 2.4 16V 4x4 (G4JS) | Rim 15 | Gasolina | 4WD | 2351 | 100 | 136 | 02.01-03.06 | ■ |
| 2.4 16V (G4JS) | Rim 15 | Gasolina | FWD | 2351 | 107 | 146 | 02.01-03.06 | ■ |
| 2.4 16V 4x4 (G4JS) | Rim 15 | Gasolina | 4WD | 2351 | 107 | 146 | 02.01-03.06 | ■ |
| 2.7 V6 4x4 (G6BA) | Rim 15 | Gasolina | 4WD | 2656 | 127 | 173 | 02.01-03.06 | ■ |

LISTA DE APLICACIONES - BUYERS GUIDE

| | | | | | | | | |
|--------------------------------|--------|----------|-----|------|--|-----|-------------|---|
| 2.7 4x4 (G6BA) | | Gasolina | 4WD | 2656 | 129 | 175 | 09.02-12.04 | ■ |
| 2.7 4x4 (G6EA) | | Gasolina | 4WD | 2656 | 132 | 180 | 11.00-03.06 | ■ |
| 3.5 | | Gasolina | FWD | 3497 | 147 | 200 | 09.03-02.06 | ■ |
| 3.5 4x4 | | Gasolina | 4WD | 3497 | 147 | 200 | 09.03-02.06 | ■ |
| 2.0 CRDi (D4EA) | Rim 15 | Diesel | FWD | 1991 | 83 | 113 | 08.01-03.06 | ■ |
| 2.0 CRDi 4x4 (D4EA) | Rim 15 | Diesel | 4WD | 1991 | 83 | 113 | 04.01-03.06 | ■ |
| 2.0 CRDi 4x4 (D4EA) | | Diesel | 4WD | 1991 | 92 | 125 | 08.03-03.06 | ■ |
| 2.0 CRDi A las 4 ruedas (D4EA) | Rim 15 | Diesel | 4WD | 1991 | 107 | 145 | 11.03-02.06 | ■ |
| TRAJET (FO) 09.99-07.08 | | | | | Box Body/MPV (Large MPV-M1 Segment) | | | |
| CVVT | | Gasolina | FWD | 1975 | 103 | 140 | 01.04-07.08 | ■ |
| 2.0 | | Gasolina | FWD | 1997 | 100 | 136 | 09.99-07.08 | ■ |
| CVVT | | Gasolina | FWD | 2656 | 127 | 173 | 04.04-07.08 | ■ |
| CRDi | | Diesel | FWD | 1991 | 83 | 113 | 04.04-07.08 | ■ |
| TRAJET (FO) 01.99-07.08 | | | | | MPV (Large MPV-M1 Segment) | | | |
| 2.0 (G4GC) | | Gasolina | FWD | 1975 | 103 | 140 | 01.04-07.08 | ■ |
| 2.0 (G4GC) | | Gasolina | FWD | 1975 | 104 | 141 | 11.03-07.08 | ■ |
| 2.0 (G4JP) | | Gasolina | FWD | 1997 | 100 | 136 | 03.00-07.08 | ■ |
| 2.0 (G4CP-D) | | Gasolina | FWD | 1997 | 103 | 140 | 03.01-10.03 | ■ |
| 2.7 V6 (G6BA) | | Gasolina | FWD | 2656 | 127 | 173 | 09.00-07.08 | ■ |
| 2.7 V6 | | Gasolina | FWD | 2656 | 127 | 173 | 03.00-06.07 | ■ |
| 2.0 CRDi (D4EA) | | Diesel | FWD | 1991 | 83 | 113 | 04.01-07.08 | ■ |
| 2.0 CRDi (D4EA) | | Diesel | FWD | 1991 | 92 | 125 | 08.05-07.08 | ■ |