

LISTA DE APLICACIONES - BUYERS GUIDE

78BD3610-2



Weight: 9.430

O.E.M.	MAKE
00K68249842AB	FIAT
51767377	ALFA ROMEO
51767378	ALFA ROMEO
51963547	JEEP
51964082	FIAT
52059174	JEEP
53409036	JEEP
68249842AA	JEEP
68249842AC	JEEP
68254088AA	JEEP
68254088AB	JEEP
K68249842AA	JEEP
K68249842AB	JEEP
K68249842AC	JEEP
K68254088AA	JEEP
K68254088AB	JEEP

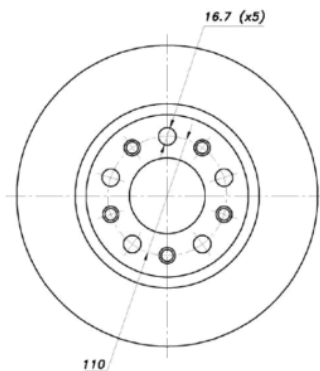
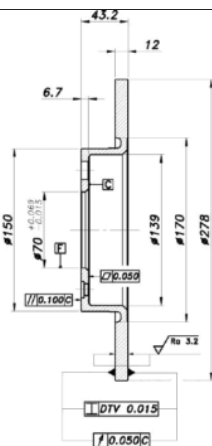

78BD3610-2



Ø278x12x43.2

MAKE
ALFA ROMEO
FIAT
JEEP
JEEP (GAC FCA)



Trac.	CC	Kw	CV
-------	----	----	----



Front / Rear

ALFA ROMEO

159 (939_) 06.05-12.12

Saloon (Compact executive car-D Segment)

1.8 Tbi (939.AXN1B) (939 B1.000)	Gasolina	FWD	1742	147	200	05.09-12.12	■
1.8 MPI (939AXL1A) (939 A4.000)	Gasolina	FWD	1796	103	140	06.05-11.11	■
1.9 JTS (939AXA1B) (939 A6.000)	Gasolina	FWD	1859	118	160	09.05-11.11	■
2.2 JTS (939AXB1B, 939AXB11) (939 A5.000)	Gasolina	FWD	2198	136	185	09.05-11.11	■
2.2 Q4 (939AXB1B, 939BxB1B) (939 A5.000)	Gasolina	4WD	2198	136	185	09.06-12.07	■
1.9 JTDM 8V (939AXE1B, 939BXE1B, 939BXH1B) (937 A7.000)	Diesel	FWD	1910	85	115	09.05-11.11	■
1.9 JTDM 8V (939AXE1B, 939BXE1B, 939BXH1B) (939 A7.000)	Diesel	FWD	1910	85	115	09.05-11.11	■
1.9 JTDM 8V (939AXE1B) (939 A1.000)	Diesel	FWD	1910	88	120	09.05-11.11	■
1.9 JTDM 16V (939AXF1B, 939AXC1B) (937 A8.000)	Diesel	FWD	1910	100	136	09.05-11.11	■
1.9 JTDM 16V (939AXF1B, 939AXC1B) (939 A8.000)	Diesel	FWD	1910	100	136	09.05-11.11	■
1.9 JTDM 16V (939AXC1B, 939AXC12) (939 A2.000)	Diesel	FWD	1910	110	150	09.05-11.11	■
2.0 JTDM (939AXR1B) (939 B4.000)	Diesel	FWD	1956	100	136	06.10-11.11	■
2.0 JTDM (939AXQ1B) (844 A2.000)	Diesel	FWD	1956	120	163	05.09-11.11	■
2.0 JTDM (939AXP1B) (939 B3.000)	Diesel	FWD	1956	125	170	05.09-11.11	■

159 Sport Wagon (939_) 06.05-12.12

Estate (Compact executive car-D Segment)

1.8 Tbi (939BXN1B) (939 B1.000)	Gasolina	FWD	1742	147	200	07.09-11.11	■
1.8 MPI (939BXL1A) (939 A4.000)	Gasolina	FWD	1796	103	140	06.05-11.11	■
1.9 JTS (939BXA1B) (939 A6.000)	Gasolina	FWD	1859	118	160	03.06-11.11	■
2.2 JTS (939BxB1B, 939BxB11) (939 A5.000)	Gasolina	FWD	2198	136	185	03.06-11.11	■
1.9 JTDM 8V (939AXH1B, 939BXH1B) (937 A7.000)	Diesel	FWD	1910	85	115	03.06-11.11	■

LISTA DE APLICACIONES - BUYERS GUIDE

1.9 JTDM 8V (939BXE1B) (939 A1.000)		Diesel	FWD	1910	88	120	03.06-11.11	■
1.9 JTDM 16V (939BXC1B) (937 A8.000)		Diesel	FWD	1910	100	136	03.06-11.11	■
1.9 JTDM 16V (939BXC1B, 939BXC12) (939 A2.000)		Diesel	FWD	1910	110	150	03.06-11.11	■
2.0 JTDM (939BXR1B) (939 B4.000)		Diesel	FWD	1956	100	136	06.10-11.11	■
2.0 JTDM (939BXQ1B) (844 A2.000)		Diesel	FWD	1956	120	163	05.09-11.11	■
2.0 JTDM (939BXP1B) (939 B3.000)		Diesel	FWD	1956	125	170	07.09-11.11	■
BRERA (939_) 01.06-05.11					Hatchback (Sports car-S Segment)			
2.2 JTS (939.DXB11) (939 A5.000)		Gasolina	FWD	2198	136	185	01.06-05.11	■
2.0 JTDM (939DXQ1B) (844 A2.000)		Diesel	FWD	1956	120	163	03.08-06.10	■
2.0 JTDM (939DXP1B) (939 B3.000)		Diesel	FWD	1956	125	170	05.09-06.10	■
GIULIETTA III (940_) 04.11-					Hatchback Van (Compact car-C Segment)			
1.4 (940FXA1A) (198 A4.000)	sports package	Gasolina	FWD	1368	88	120	04.11-02.16	■
1.4 (940FXB1A) (940 A2.000)	sports package	Gasolina	FWD	1368	125	170	04.11-12.20	■
1.8 (940FXC1A) (940 A1.000)	sports package	Gasolina	FWD	1742	173	235	04.11-02.16	■
1.6 JTDM (940FXD1A) (940 A3.000)	sports package	Diesel	FWD	1598	77	105	04.11-02.16	■
2.0 JTDM (940FXL1A) (940 A5.000)	sports package	Diesel	FWD	1956	103	140	07.13-02.16	■
2.0 JTDM (940FXQ1A) (940 B5.000)	sports package	Diesel	FWD	1956	110	150	08.13-02.16	■
2.0 JTDM (940FXE1A) (940 A4.000)	sports package	Diesel	FWD	1956	125	170	04.11-02.16	■
2.0 JTDM (940FXV11) (940 B4.000)	sports package	Diesel	FWD	1956	129	175	05.15-12.20	■
GIULIETTA III (940_) 04.10-					Hatchback (Compact car-C Segment)			
1.4 TB (940FXN1A, 940FXU1A) (940 B1.000)	sports package	Gasolina	FWD	1368	77	105	04.11-02.17	■
1.4 TB (940FXN1A, 940FXU1A) (940 B8.000)	sports package	Gasolina	FWD	1368	77	105	04.11-02.17	■
1.4 TB (940FXF1A) (940 A6.000)	sports package	Gasolina	FWD	1368	85	116	04.10-02.16	■
1.4 TB (940FXA1A, 940FXT1A) (198 A4.000)	sports package	Gasolina	FWD	1368	88	120	04.10-12.20	■
1.4 TB (940FXA1A, 940FXT1A) (940 B7.000)	sports package	Gasolina	FWD	1368	88	120	04.10-12.20	■
1.4 TB (940FXG1A) (955 A8.000)	sports package	Gasolina	FWD	1368	120	163	04.10-10.18	■
1.4 TB (940FXB1A, 940FXB11) (940 A2.000)	sports package	Gasolina	FWD	1368	125	170	04.10-10.18	■
1.8 TBi (940FXC1A) (940 A1.000)	sports package	Gasolina	FWD	1742	169	230	04.10-09.13	■
1.8 TBi (940FXC1A) (940 A1.000)	sports package	Gasolina	FWD	1742	173	235	04.10-02.16	■
1.8 TBi (940FXR11) (940 B2.000)	sports package	Gasolina	FWD	1742	177	241	09.13-10.18	■
1.8 TBi (940FXR11) (960 A1.000)	sports package	Gasolina	FWD	1742	177	241	09.13-10.18	■
1.4 BiFuel (940FXA1A, 940FXT1A) (198 A4.000)	sports package	Gasol./G as (LPG)	FWD	1368	88	120	12.11-02.17	■
1.6 JTDM (940FXD1A) (940 A3.000)	sports package	Diesel	FWD	1598	77	105	04.10-02.16	■
2.0 JTDM (940FXM1A, 940FXS1A, 940FYD1A) (940 A8.000)	sports package	Diesel	FWD	1956	100	136	04.10-02.16	■
2.0 JTDM (940FXM1A, 940FXS1A, 940FYD1A) (940 B6.000)	sports package	Diesel	FWD	1956	100	136	04.10-02.16	■
2.0 JTDM (940FXM1A, 940FXS1A, 940FYD1A) (940 C4.000)	sports package	Diesel	FWD	1956	100	136	04.10-02.16	■
2.0 JTDM (940.FXL1A) (940 A5.000)	sports package	Diesel	FWD	1956	103	140	04.10-12.20	■
2.0 JTDM (940.FXL1A) (940 C3.000)	sports package	Diesel	FWD	1956	103	140	04.10-12.20	■
2.0 JTDM (940FXQ1A, 940FYC1A) (940 B5.000)	sports package	Diesel	FWD	1956	110	150	08.13-10.18	■
2.0 JTDM (940FXQ1A, 940FYC1A) (940 C3.000)	sports package	Diesel	FWD	1956	110	150	08.13-10.18	■
2.0 JTDM (940FXH1A, 940FXH11, 940FXZ11, 940FXZ1A) (940 A7.000)	sports package	Diesel	FWD	1956	120	163	04.10-10.18	■
2.0 JTDM (940FXH1A, 940FXH11, 940FXZ11, 940FXZ1A) (940 B9.000)	sports package	Diesel	FWD	1956	120	163	04.10-10.18	■
2.0 JTDM (940FXE1A, 940FXG11) (552 83 099)	sports package	Diesel	FWD	1956	125	170	04.10-12.20	■
2.0 JTDM (940FXE1A, 940FXG11) (940 A4.000)	sports package	Diesel	FWD	1956	125	170	04.10-12.20	■

LISTA DE APLICACIONES - BUYERS GUIDE

2.0 JTDM (940FXE1A, 940FXG11) (940 B4.000)	sports package	Diesel	FWD	1956	125	170	04.10-12.20	■
2.0 JTDM (940FXV11) (940 B4.000)	sports package	Diesel	FWD	1956	129	175	11.13-10.18	■
SPIDER V (939_) 03.06-03.11					Convertible (Sports car-S Segment)			
2.2 JTS (939EXB1B, 939EXB11) (939 A5.000)		Gasolina	FWD	2198	136	185	03.06-03.11	■
2.0 JTDM (939DXQ1B) (844 A2.000)		Diesel	FWD	1956	120	163	04.09-03.11	■
2.0 JTDM (939DXP1B, 939EXP1B) (939 B3.000)		Diesel	FWD	1956	125	170	05.09-06.10	■
TONALE (965_) 03.22-					SUV (Subcompact SUV-B Segment)			
1.3 Hybrid Q4		Gasol./el éc.	4WD	1332	140	190	03.22-	■
1.3 Hybrid Q4		Gasol./el éc.	4WD	1332	206	280	03.22-	■
1.5 Mild Hybrid (46347812)		Gasol./el éc.	FWD	1469	96	131	03.22-	■
1.5 Mild Hybrid (46347696)		Gasol./el éc.	FWD	1469	118	160	03.22-	■
1.6 VGT-D		Diesel	FWD	1598	96	131	09.22-	■
FIAT								
500X (334_) 09.14-					SUV (Compact SUV-J Segment)			
1.0 (334.AXN1B) (552 82 151)		Gasolina	FWD	999	84	114	06.18-	■
1.0 (334.AXN1B) (552 82 151)		Gasolina	FWD	999	88	120	09.18-	■
1.3 (334.AXR11) (552 82 328)		Gasolina	FWD	1332	110	150	09.18-	■
1.3 (334AX) (552 82 328,EYF)		Gasolina	4WD	1332	132	179	09.18-	■
1.4 (334AXC1B) (552 63 624)		Gasolina	FWD	1368	100	136	09.14-	■
1.4 (334AXC1B, 334AXC11) (552 63 624)		Gasolina	FWD	1368	103	140	09.14-	■
1.4		Gasolina	FWD	1368	120	163	05.15-	■
1.4 4x4 (334AXF22) (552 63 623)		Gasolina	4WD	1368	120	163	02.15-09.18	■
1.4 4x4 (334AXF22) (552 63 623)		Gasolina	4WD	1368	125	170	02.15-	■
1.6 (334AXE1A) (552 63 842)		Gasolina	FWD	1598	81	110	11.14-09.20	■
2.4		Gasolina	FWD	2360	134	182	05.15-	■
2.4		Gasolina	FWD	2360	134	182	05.15-	■
2.4 4x4 (334AX) (ED6)		Gasolina	4WD	2360	135	184	05.15-	■
2.4 (334AX) (ED6)		Gasolina	FWD	2360	138	188	01.16-	■
1.4 LPG (334AXL1B) (552 77 701)		Gasol./Gas (LPG)	FWD	1368	88	120	03.17-09.18	■
1.3 D Multijet (334AXH1A) (552 66 963)		Diesel	FWD	1248	70	95	11.14-	■
1.3 D Multijet (334AXH1A) (552 83 775)		Diesel	FWD	1248	70	95	11.14-	■
1.6 D Multijet (334AXA1B, 334AXA11) (552 60 384)		Diesel	FWD	1598	84	114	09.14-	■
1.6 D Multijet (334AXA1B, 334AXA11) (552 80 444)		Diesel	FWD	1598	84	114	09.14-	■
1.6 D Multijet (334AXA1B, 334AXA11) (552 60 384)		Diesel	FWD	1598	88	120	09.14-	■
1.6 D Multijet (334AXA1B, 334AXA11) (552 80 444)		Diesel	FWD	1598	88	120	09.14-	■
1.6 D Multijet (334.AXV1B)		Diesel	FWD	1598	96	130	05.21-	■
2.0 D Multijet 4x4 (334AXB22, 334AXD2B) (552 63 087)		Diesel	4WD	1956	100	136	09.14-09.18	■
2.0 D Multijet 4x4 (334AXB22, 334AXD2B) (552 63 088)		Diesel	4WD	1956	100	136	09.14-09.18	■
2.0 D Multijet 4x4 (334AXB22, 334AXD2B) (552 83 099)		Diesel	4WD	1956	100	136	09.14-09.18	■
2.0 D Multijet 4x4 (334AXB22, 334AXD2B) (552 63 087)		Diesel	4WD	1956	103	140	09.14-09.18	■
2.0 D Multijet 4x4 (334AXB22, 334AXD2B) (552 63 088)		Diesel	4WD	1956	103	140	09.14-09.18	■
2.0 D Multijet 4x4 (334AXB22, 334AXD2B) (552 63 088)		Diesel	4WD	1956	110	150	09.18-09.20	■

LISTA DE APLICACIONES - BUYERS GUIDE

JEEP									
COMPASS II (MP, M6, MV, M7) 01.16-					SUV (Compact SUV-J Segment)				
1.3		Gasolina	FWD	1332	96	131	08.20-		■
1.3 T270		Gasolina	FWD	1332	127	173	08.20-		■
1.3 T270		Gasolina	FWD	1332	129	175	09.21-		■
1.4 Multiair (552 63 624)		Gasolina	FWD	1368	103	140	03.17-		■
1.4 Multiair (EAQ)		Gasolina	FWD	1368	103	140	03.17-		■
1.4 Multiair		Gasolina	FWD	1368	120	163	03.17-		■
1.4 MultiAir 4x4 (552 63 623)		Gasolina	4WD	1368	125	170	03.17-		■
1.4 MultiAir 4x4 (EAQ)		Gasolina	4WD	1368	125	170	03.17-		■
2.4 16V 4x4	BR3, BRF	Gasolina	4WD	2360	110	150	05.21-		■
2.4 MultiAir (ED6)		Gasolina	FWD	2360	129	175	09.17-		■
2.4 MultiAir (EDD)		Gasolina	FWD	2360	129	175	09.17-		■
2.4 MultiAir 4x4 (ED6)		Gasolina	4WD	2360	129	175	09.17-		■
2.4 MultiAir 4x4 (EDD)		Gasolina	4WD	2360	129	175	09.17-		■
2.4		Gasolina	FWD	2360	134	182	09.17-		■
2.4 4x4 (ED6)		Gasolina	4WD	2360	134	182	09.17-		■
2.4 4x4 (EDD)		Gasolina	4WD	2360	134	182	09.17-		■
1.3 T270 Turbo Flex	BR3, BRF	Gasol./Et anol	FWD	1332	136	185	06.21-		■
2.0 Flex		Gasol./Et anol	FWD	1995	122	166	01.16-04.21		■
2.0 Flex 4x4		Gasol./Et anol	4WD	1995	122	166	09.17-12.18		■
1.5 T4 Hybrid	BR3, BRF	Gasol./el éc.	FWD	1469	96	131	03.22-		■
1.6 CRD (552 60 384)		Diesel	FWD	1598	88	120	03.17-		■
1.6 CRD (EJJ)		Diesel	FWD	1598	88	120	03.17-		■
1.6 MultiJet		Diesel	FWD	1598	96	130	04.21-		■
2.0 CRD 4x4 (552 63 087)		Diesel	4WD	1956	103	140	03.17-		■
2.0 CRD 4x4 (EBS)		Diesel	4WD	1956	103	140	03.17-		■
2.0 CRD 4x4 (EBT)		Diesel	4WD	1956	103	140	03.17-		■
2.0 CRD 4x4 (552 63 088)		Diesel	4WD	1956	125	170	12.16-		■
2.0 CRD 4x4 (EBS)		Diesel	4WD	1956	125	170	12.16-		■
2.0 Multijet II		Diesel	FWD	1956	127	173	10.18-		■
2.0 Multijet II 4x4 (552 63 088)		Diesel	4WD	1956	127	173	03.17-		■
2.0 Multijet II 4x4 (EBS)		Diesel	4WD	1956	127	173	03.17-		■
2.0 Multijet II 4x4 (EBT)		Diesel	4WD	1956	127	173	03.17-		■
RENEGADE (BU, B1, BV) 07.14-					SUV (Compact SUV-J Segment)				
1.0 T-GDI		Gasolina	FWD	999	84	114	08.21-		■
1.0 T-GDI (552 82 151)		Gasolina	FWD	999	88	120	08.18-		■
1.3 T-GDi (552 82 328)		Gasolina	FWD	1332	110	150	08.18-		■
1.3 T-GDi (EYF)		Gasolina	FWD	1332	132	180	08.18-		■
1.3 T-GDi 4x4 (552 82 328)		Gasolina	4WD	1332	132	180	08.18-		■
1.3 T-GDi 4x4 (EYF)		Gasolina	4WD	1332	132	180	08.18-		■
1.4 (552 63 624)		Gasolina	FWD	1368	100	136	01.16-		■
1.4 (552 63 624)		Gasolina	FWD	1368	103	140	07.14-12.18		■
1.4 (EAM)		Gasolina	FWD	1368	103	140	07.14-12.18		■
1.4		Gasolina	FWD	1368	119	162	07.14-		■
1.4		Gasolina	FWD	1368	119	162	07.14-		■
1.4 4x4 (552 63 623)		Gasolina	4WD	1368	125	170	07.14-12.18		■
1.4 4x4 (EAM)		Gasolina	4WD	1368	125	170	07.14-12.18		■
1.6 (552 63 842)		Gasolina	FWD	1598	81	110	07.14-09.18		■

LISTA DE APLICACIONES - BUYERS GUIDE

1.6 (EJH)		Gasolina	FWD	1598	81	110	07.14-09.18	■
2.4		Gasolina	FWD	2360	129	175	09.15-	■
2.4		Gasolina	FWD	2360	129	175	09.15-	■
2.4 (500 52 375)		Gasolina	FWD	2360	132	179	09.15-	■
2.4 (ED6)		Gasolina	FWD	2360	132	179	09.15-	■
2.4 4x4 (500 52 375)		Gasolina	4WD	2360	132	179	09.15-	■
2.4 4x4 (ED6)		Gasolina	4WD	2360	132	179	09.15-	■
2.4		Gasolina	FWD	2360	137	186	07.14-	■
2.4		Gasolina	FWD	2360	137	186	07.14-	■
1.4 LPG		Gasol./Gas (LPG)	FWD	1368	88	120	01.16-	■
2.4 FLEX (ED6)		Gasol./Etanol	FWD	2360	134	182	09.14-12.18	■
2.4 Flex 4x4 (ED6)		Gasol./Etanol	4WD	2360	134	182	09.14-12.18	■
1.5 T4 Hybrid		Gasol./eléct.	FWD	1469	96	131	03.22-	■
1.6 CRD (552 60 384)		Diesel	FWD	1598	70	95	11.16-	■
1.6 CRD (EJJ)		Diesel	FWD	1598	70	95	11.16-	■
1.6 MultiJet		Diesel	FWD	1598	84	114	08.22-	■
1.6 CRD (552 63 113)		Diesel	FWD	1598	88	120	07.14-	■
1.6 CRD (552 80 444)		Diesel	FWD	1598	88	120	07.14-	■
1.6 CRD (EJK)		Diesel	FWD	1598	88	120	07.14-	■
1.6 MultiJet		Diesel	FWD	1598	96	130	02.20-	■
2.0 CRD 4x4 (552 63 087)		Diesel	4WD	1956	88	120	07.14-	■
2.0 CRD 4x4 (EBT)		Diesel	4WD	1956	88	120	07.14-	■
2.0 CRD 4x4 (552 63 087)		Diesel	4WD	1956	103	140	07.14-	■
2.0 CRD 4x4 (552 63 088)		Diesel	4WD	1956	103	140	07.14-	■
2.0 CRD 4x4 (552 83 099)		Diesel	4WD	1956	103	140	07.14-	■
2.0 CRD 4x4 (552 84 064)		Diesel	4WD	1956	103	140	07.14-	■
2.0 CRD 4x4 (EBT)		Diesel	4WD	1956	103	140	07.14-	■
2.0 CRD 4x4 (552 63 088)		Diesel	4WD	1956	125	170	07.14-	■
2.0 CRD 4x4 (552 83 099)		Diesel	4WD	1956	125	170	07.14-	■
2.0 CRD 4x4 (EBT)		Diesel	4WD	1956	125	170	07.14-	■
2.0 CRD 4x4 (552 63 088,EBT)		Diesel	4WD	1956	126	172	04.15-	■
RENEGADE VAN (BU, B1) 07.14-					SUV Van (Compact SUV-J Segment)			
1.4		Gasolina	FWD	1368	103	140	07.14-	■
1.4 4x4		Gasolina	4WD	1368	125	170	07.14-	■
1.6 E-torQ		Gasolina	FWD	1598	81	110	07.14-09.18	■
1.6 MultiJet		Diesel	FWD	1598	88	120	07.14-	■
2.0 MultiJet 4x4		Diesel	4WD	1956	103	140	07.14-	■
2.0 MultiJet 4x4		Diesel	4WD	1956	125	170	07.14-	■
JEEP (GAC FCA)								
COMPASS II (MP, M6) 06.16-					Closed Off-Road Vehicle (Compact SUV-J Segment)			
200T	BR3, BRF	Gasolina	FWD	1332	127	173	04.19-	■
220T 4x4	BR3, BRF	Gasolina	FWD	1332	127	173	04.19-	■
1.4	BR3, BRF	Gasolina	FWD	1368	121	165	12.16-	■
1.4 4x4	BR3, BRF	Gasolina	FWD	1368	121	165	11.17-	■
200TS	BR3, BRF	Gasolina	FWD	1995	109	148	04.19-	■
2.4 4x4	BR3, BRF	Gasolina	FWD	2360	129	175	06.19-	■
RENEGADE (BU) 05.16-					SUV (Compact SUV-J Segment)			
220T (463 38 779)		Gasolina	FWD	1332	127	173	09.19-	■

LISTA DE APLICACIONES - BUYERS GUIDE

220T 4x4 (463 38 779)	Gasolina	4WD	1332	127	173	09.19-
1.4 T (523A0027)	Gasolina	FWD	1368	110	150	05.16-
2.0 (M095)	Gasolina	FWD	1995	109	148	10.18-
2.0 D-VVT 4x4 (M095)	Gasolina	4WD	1995	114	155	09.16-

