

LISTA DE APLICACIONES - BUYERS GUIDE

78BD3918-2



Weight: 15.700

O.E.M.	MAKE
04683918AA	CHRYSLER
04683918AB	CHRYSLER
04683918AD	CHRYSLER
04863918AB	CHRYSLER
46833918AB	DODGE
4683918	CHRYSLER
4683918AD	CHRYSLER

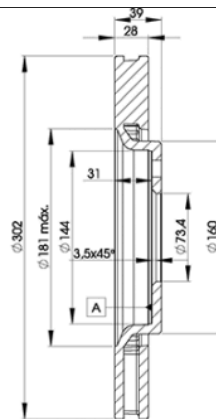
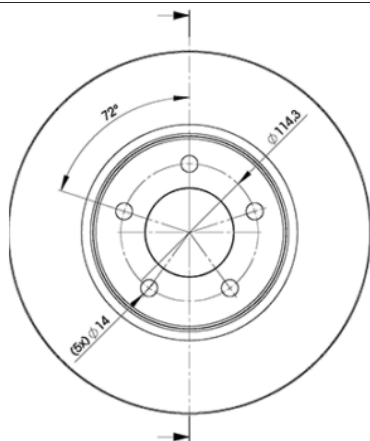

78BD3918-2

E1 90R-02C0433/0076



Ø302x28x39

MAKE
CHRYSLER
DODGE
PLYMOUTH



Trac.	CC	Kw	CV
-------	----	----	----



Front / Rear

CHRYSLER

GRAND VOYAGER III VAN (GS) 01.95-12.01						Box Body/MPV (Large MPV-M1 Segment)		
3.8		Gasolina	4WD	3778	131	178	01.99-12.99	■
RAM VAN (RG) 11.05-07.09						Box Body/MPV (LCVs-N1 Segment)		
2.5 CRD		Diesel	FWD	2499	105	143	01.06-04.08	■
2.8 CRD		Diesel	FWD	2777	110	150	11.05-07.09	■
TOWN & COUNTRY IV 10.00-08.07						MPV (Large MPV-M1 Segment)		
3.8		Gasolina	FWD	3778	160	218	10.00-09.06	■
VOYAGER III / GRAND VOYAGER III (GS_, NS_) 01.92-03.01						MPV (Large MPV-M1 Segment)		
3.3 i (R00)		Gasolina	FWD	3301	116	158	01.95-03.01	■
3.8 i AWD (L00)		Gasolina	4WD	3778	122	166	01.95-03.01	■
3.8 i AWD (EGH)		Gasolina	4WD	3778	131	178	01.95-03.01	■
VOYAGER III VAN (GS_) 01.95-12.01						Box Body/MPV ()		
3.8 AWD (GSHC52)		Gasolina	4WD	3778	131	178	10.97-03.01	■
VOYAGER IV / GRAND VOYAGER IV / TOWN & COUNTRY IV (RG, RS) 09.99-12.08						MPV (Large MPV-M1 Segment)		
2.4 (EDZ)	Rim 16	Gasolina	FWD	2429	108	147	02.00-12.08	■
2.4 (EDZ)		Gasolina	FWD	2429	111	151	04.03-12.07	■
3.3 (EGA)	Rim 16, vehicles with ABS	Gasolina	FWD	3301	128	174	02.00-12.08	■
3.3 (EGM)	Rim 16, vehicles with ABS	Gasolina	FWD	3301	128	174	02.00-12.08	■
3.3 AWD (EGA)	Rim 16, vehicles with ABS	Gasolina	4WD	3301	128	174	02.00-12.08	■
3.3 (EGM)		Gasolina	FWD	3301	131	178	10.00-09.02	■
3.3		Gasolina	FWD	3301	134	182	09.00-12.07	■
3.8 (EGH)	Rim 16, vehicles with ABS	Gasolina	FWD	3778	160	218	02.00-12.08	■

LISTA DE APLICACIONES - BUYERS GUIDE

3.8 AWD (EGH)	Rim 16, vehicles with ABS	Gasolina	4WD	3778	160	218	02.00-12.08	■
3.3 Flex-Fuel	Rim 16, vehicles with ABS	Gasol./Etanol	FWD	3301	128	174	02.00-12.08	■
2.5 CRD (EDK)	Rim 16	Diesel	FWD	2499	88	120	08.05-12.08	■
2.5 CRD (ENJ)	Rim 16	Diesel	FWD	2499	105	141	02.00-12.08	■
2.8 CRD (ENR)	Rim 16	Diesel	FWD	2777	110	150	06.04-12.08	■
VOYAGER IV VAN (S_) 09.99-12.08								Box Body/MPV ()
3.3 (SYM53, SYH53)		Gasolina	FWD	3301	128	174	10.00-06.07	■
3.8 (SYX53)		Gasolina	FWD	3778	160	218	10.00-06.07	■
3.8 AWD (SCH53)		Gasolina	4WD	3778	160	218	10.00-06.07	■
VOYAGER / GRAND VOYAGER IV (RG) 02.00-02.08								Box Body/MPV (Large MPV-M1 Segment)
2.4		Gasolina	FWD	2429	108	147	01.01-12.06	■
3.3		Gasolina	FWD	3301	128	174	02.00-08.07	■
2.5 CRD		Diesel	FWD	2499	105	143	01.01-02.08	■
DODGE								
CARAVAN III 01.95-03.01								MPV (Large MPV-M1 Segment)
3.8 i (EGH)		Gasolina	FWD	3778	122	166	01.95-03.01	■
3.8 i AWD (EGH)	01/97-, -12/00	Gasolina	4WD	3778	122	166	01.95-03.01	■
3.8 i (EGH)		Gasolina	FWD	3778	131	178	01.95-03.01	■
3.8 i AWD (EGH)		Gasolina	4WD	3778	131	178	01.95-03.01	■
CARAVAN IV (RG_) 02.00-12.07								MPV (Large MPV-M1 Segment)
2.4 (EDZ)	-11/00, vehicles with ABS	Gasolina	FWD	2429	112	152	02.00-12.07	■
3.3 (EGA)	04/01-, -09/06, vehicles with ABS	Gasolina	FWD	3301	128	174	02.00-12.07	■
3.3 AWD (EGA)	04/01-, -09/06, vehicles with ABS	Gasolina	4WD	3301	128	174	02.00-12.07	■
3.3 (EGM)		Gasolina	FWD	3301	132	179	04.01-05.07	■
3.8 AWD (EGH)	vehicles with ABS	Gasolina	4WD	3778	153	208	04.01-12.07	■
3.8 (EGH)		Gasolina	FWD	3778	154	209	04.01-05.07	■
3.8 AWD		Gasolina	4WD	3778	154	209	04.01-05.07	■
3.8 (EGH)	04/01-, -09/06, vehicles with ABS	Gasolina	FWD	3778	160	218	02.00-12.07	■
3.8 AWD (EGH)	04/01-, -09/06, vehicles with ABS	Gasolina	4WD	3778	160	218	02.00-12.07	■
PLYMOUTH								
VOYAGER III 01.95-03.01								MPV (Large MPV-M1 Segment)
3.8 i (EGH)		Gasolina	FWD	3778	122	166	01.95-03.01	■
3.8 i AWD (EGH)		Gasolina	4WD	3778	122	166	01.95-03.01	■
3.8 i (EGH)		Gasolina	FWD	3778	131	178	01.95-03.01	■
3.8 i AWD (EGH)		Gasolina	4WD	3778	131	178	01.95-03.01	■