

LISTA DE APLICACIONES - BUYERS GUIDE

78BD4022-2



Weight: 13.564

O.E.M.	MAKE
40 20 600 10R	RENAULT
40 20 641 51R	RENAULT

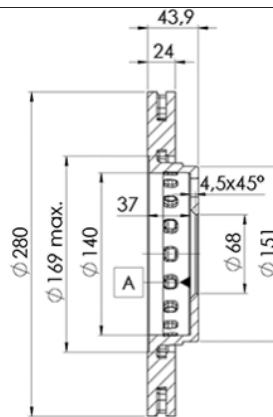
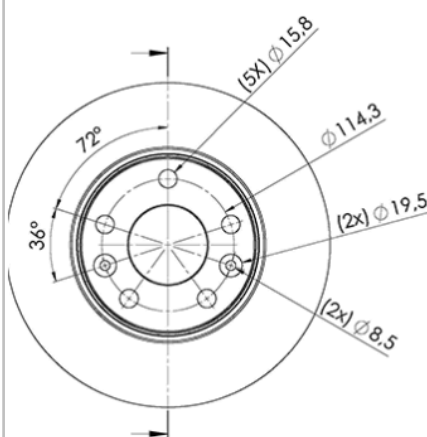

78BD4022-2



Ø280x24x43.9

MAKE
DACIA
NISSAN
RENAULT
VW



Trac.	CC	Kw	CV
-------	----	----	----



Front / Rear

DACIA

DUSTER 04.11-

SUV Van (Compact SUV-J Segment)

1.2 TCe 125 4x4 (HSAU) (H5F 404)		Gasolina	4WD	1197	92	125	10.13-	■
1.6 16V		Gasolina	FWD	1598	77	105	04.11-	■
1.6 SCe 115		Gasolina	FWD	1598	84	115	06.15-	■
1.6 SCe 115 4x4		Gasolina	4WD	1598	84	115	06.15-01.18	■
1.5 dCi (K9K 884)	vehicles with ABS	Diesel	FWD	1461	66	90	04.11-	■
1.5 dCi (K9K 892)	vehicles with ABS	Diesel	FWD	1461	66	90	04.11-	■
1.5 dCi 4x4 (K9K 884)	vehicles with ABS	Diesel	4WD	1461	66	90	04.11-	■
1.5 dCi 4x4 (K9K 892)	vehicles with ABS	Diesel	4WD	1461	66	90	04.11-	■
1.5 dCi (K9K 666)	vehicles with ABS	Diesel	FWD	1461	80	109	04.13-	■
1.5 dCi (K9K 856)	vehicles with ABS	Diesel	FWD	1461	80	109	04.13-	■
1.5 dCi 4x4 (K9K 658)	vehicles with ABS	Diesel	4WD	1461	80	109	04.13-	■
1.5 dCi 4x4 (K9K 858)	vehicles with ABS	Diesel	4WD	1461	80	109	04.13-	■

DUSTER (HS_) 04.10-

SUV (Compact SUV-J Segment)

1.2 TCe 125 (H5F 404)		Gasolina	FWD	1197	92	125	10.13-01.18	■
1.2 TCe 125 (H5F 408)		Gasolina	FWD	1197	92	125	10.13-01.18	■
1.2 TCe 125 4x4 (H5F 410)		Gasolina	4WD	1197	92	125	06.15-01.18	■
1.6 16V 4x4 (K4M 606)	vehicles with ABS	Gasolina	4WD	1598	77	105	06.10-01.18	■
1.6 SCe 115 (H4M 438)		Gasolina	FWD	1598	84	115	06.15-01.18	■
1.6 SCe 115 (H4M 738)		Gasolina	FWD	1598	84	115	06.15-01.18	■
1.6 SCe 115 4x4 (H4M 430)		Gasolina	4WD	1598	84	115	06.15-01.18	■
1.6 SCe 115 4x4 (H4M 730)		Gasolina	4WD	1598	84	115	06.15-01.18	■
1.6 SCe 115 4x4 (H4M 738)		Gasolina	4WD	1598	84	115	06.15-01.18	■

LISTA DE APLICACIONES - BUYERS GUIDE

1.6 16V LPG (K4M 616)		Gasol./Gas (LPG)	FWD	1598	77	105	04.11-01.18	■
1.6 16V LPG (K4M 642)		Gasol./Gas (LPG)	FWD	1598	77	105	04.11-01.18	■
1.6 16V Hi-Flex (K4M 696)		Gasol./Etanol	FWD	1598	77	105	08.10-01.18	■
1.6 SCe 115 LPG (H4M 740)		Gasol./Etanol	FWD	1598	84	115	06.15-01.18	■
1.5 dCi (K9K 796)		Diesel	FWD	1461	63	86	04.10-01.18	■
1.5 dCi (K9K 830)		Diesel	FWD	1461	63	86	04.10-01.18	■
1.5 dCi (HSAJ) (K9K 612)	vehicles with ABS	Diesel	FWD	1461	66	90	10.10-01.18	■
1.5 dCi (HSAJ) (K9K 884)	vehicles with ABS	Diesel	FWD	1461	66	90	10.10-01.18	■
1.5 dCi (HSAJ) (K9K 892)	vehicles with ABS	Diesel	FWD	1461	66	90	10.10-01.18	■
1.5 dCi 4x4 (K9K 884)		Diesel	4WD	1461	66	90	10.10-01.18	■
1.5 dCi 4x4 (K9K 894)		Diesel	4WD	1461	66	90	10.10-01.18	■
1.5 dCi (HSMC) (K9K 896)	vehicles with ABS	Diesel	FWD	1461	79	107	06.10-01.18	■
1.5 dCi 4x4		Diesel	4WD	1461	79	107	06.10-	■
1.5 dCi (K9K 658)	vehicles with ABS	Diesel	FWD	1461	80	109	08.13-01.18	■
1.5 dCi (K9K 666)	vehicles with ABS	Diesel	FWD	1461	80	109	08.13-01.18	■
1.5 dCi (K9K 667)	vehicles with ABS	Diesel	FWD	1461	80	109	08.13-01.18	■
1.5 dCi (K9K 856)	vehicles with ABS	Diesel	FWD	1461	80	109	08.13-01.18	■
1.5 dCi (K9K 858)	vehicles with ABS	Diesel	FWD	1461	80	109	08.13-01.18	■
1.5 dCi 4x4 (K9K 658)		Diesel	4WD	1461	80	109	08.13-01.18	■
1.5 dCi 4x4 (K9K 856)		Diesel	4WD	1461	80	109	08.13-01.18	■
1.5 dCi 4x4 (K9K 858)		Diesel	4WD	1461	80	109	08.13-01.18	■
1.5 dCi 4x4 (K9K 898)		Diesel	4WD	1461	80	109	08.13-01.18	■
1.5 dCi (K9K 658)		Diesel	FWD	1461	81	110	08.13-01.18	■
1.5 dCi (K9K 856)		Diesel	FWD	1461	81	110	08.13-01.18	■
1.5 dCi (K9K 858)		Diesel	FWD	1461	81	110	08.13-01.18	■
1.5 dCi (K9K 898)		Diesel	FWD	1461	81	110	08.13-01.18	■
1.5 dCi 4x4 (HSMC, HSMD) (K9K 856)		Diesel	4WD	1461	81	110	10.10-01.18	■
1.5 dCi 4x4 (HSMC, HSMD) (K9K 858)		Diesel	4WD	1461	81	110	10.10-01.18	■
1.5 dCi 4x4 (HSMC, HSMD) (K9K 898)		Diesel	4WD	1461	81	110	10.10-01.18	■
DUSTER II (HM_) 10.17-						SUV (Compact SUV-J Segment)		
1.0 TCe 90		Gasolina	FWD	999	67	91	05.21-	■
1.0 TCe 100 (HMMT) (H4D 450)		Gasolina	FWD	999	74	101	01.19-	■
1.0 TCe 100 (HMMT) (H4D 460)		Gasolina	FWD	999	74	101	01.19-	■
1.0 TCe 100 4x4 (HMMT) (H4D 450)		Gasolina	4WD	999	74	101	01.19-	■
1.0 TCe 100 4x4 (HMMT) (H4D 460)		Gasolina	4WD	999	74	101	01.19-	■
1.2 TCe 125 (HMMA) (H5F 408)		Gasolina	FWD	1197	92	125	10.17-	■
1.2 TCe 125 4x4 (HMMA) (H5F 410)		Gasolina	4WD	1197	92	125	10.17-	■
1.3 TCe 130 (HMMF) (H5H 470)		Gasolina	FWD	1332	96	131	01.19-	■
1.3 TCe 130 (HMMF) (H5H 480)		Gasolina	FWD	1332	96	131	01.19-	■
1.3 TCe 130 4x4 (HMMF) (H5H 470)		Gasolina	4WD	1332	96	131	01.19-	■
1.3 TCe 130 4x4 (HMMF) (H5H 480)		Gasolina	4WD	1332	96	131	01.19-	■
1.3 TCe 150 (HMM3) (H5H 470)		Gasolina	FWD	1332	110	150	01.19-	■
1.3 TCe 150 (HMM3) (H5H 480)		Gasolina	FWD	1332	110	150	01.19-	■
1.3 TCe 150 4x4 (HMM3) (H5H 470)		Gasolina	4WD	1332	110	150	01.19-	■
1.3 TCe 150 4x4 (HMM3) (H5H 480)		Gasolina	4WD	1332	110	150	01.19-	■
1.6 SCe 115 (HMM1) (H4M 738)		Gasolina	FWD	1598	84	115	10.17-	■
1.6 SCe 115 4x4 (HMM1)		Gasolina	4WD	1598	84	115	10.17-	■
1.0 TCe LPG		Gasol./Gas (LPG)	FWD	999	67	91	06.21-	■

LISTA DE APLICACIONES - BUYERS GUIDE

1.0 LPG (HMMT)		Gasol./Gas (LPG)	FWD	999	74	101	01.19-	■
1.6 SCe 115 LPG (HMM1) (H4M 740)		Gasol./Gas (LPG)	FWD	1598	80	109	10.17-	■
1.5 dCi 90 (HMAA) (K9K 656)		Diesel	FWD	1461	66	90	10.17-	■
1.5 dCi 95 (HMAF)		Diesel	FWD	1461	70	95	10.17-	■
1.5 dCi 110 (HMAB) (K9K 656)		Diesel	FWD	1461	80	109	10.17-	■
1.5 dCi 110 (HMAB) (K9K 667)		Diesel	FWD	1461	80	109	10.17-	■
1.5 dCi 110 4x4 (HMAB) (K9K 658)		Diesel	4WD	1461	80	109	10.17-	■
1.5 dCi 115 4x4		Diesel	4WD	1461	84	114	01.22-	■
1.5 dCi 115 (HMAD) (K9K 872)		Diesel	FWD	1461	85	116	10.17-	■
1.5 dCi 115 (HMAD) (K9K 874)		Diesel	FWD	1461	85	116	10.17-	■
1.5 dCi 115 4x4 (HMAD) (K9K 872)		Diesel	4WD	1461	85	116	10.17-	■
1.5 dCi 115 4x4 (HMAD) (K9K 874)		Diesel	4WD	1461	85	116	10.17-	■
NISSAN								
JUKE II (F16_) 08.19-					SUV (Mini SUV-J Segment)			
1.0		Gasolina	FWD	999	84	114	08.19-	■
DIG-T 117 (HR10DDT)		Gasolina	FWD	999	86	117	08.19-	■
TERRANO IV / PATHFINDER (D10) 08.13-					SUV (Compact SUV-J Segment)			
1.6		Gasolina	FWD	1598	75	102	03.14-	■
1.6 4x4		Gasolina	4WD	1598	75	102	03.14-	■
1.6		Gasolina	FWD	1598	84	114	12.15-	■
1.6 4x4		Gasolina	4WD	1598	84	114	12.15-	■
2.0		Gasolina	FWD	1998	98	133	03.14-	■
2.0 4x4		Gasolina	4WD	1998	98	133	03.14-	■
2.0 4x4		Gasolina	4WD	1998	105	143	12.15-	■
RENAULT								
ARKANA (LCM_, LDN_) 08.19-					SUV (Compact SUV-J Segment)			
1.3 TCe 150 (LCM3)		Gasolina	FWD	1332	110	150	08.19-	■
1.3 TCe 150 4x4 (LCM3)		Gasolina	4WD	1332	110	150	08.19-	■
1.6 (LCM1)		Gasolina	FWD	1598	84	114	08.19-	■
1.6 4x4 (LCM1)		Gasolina	4WD	1598	84	114	08.19-	■
CAPTUR II 01.20-					Hatchback (Mini SUV-J Segment)			
TCe 90 (HFM6)		Gasolina	FWD	999	67	91	09.20-	■
TCe 100 (HFMT) (H4D 450)		Gasolina	FWD	999	74	101	01.20-	■
TCe 130 (HFMF) (H5H 470)		Gasolina	FWD	1332	96	131	01.20-	■
TCe 155 (HFMN) (H5H 470)		Gasolina	FWD	1332	113	154	01.20-	■
1.0 TCe 90 ECO-G (HFM6)		Gasol./Gas (LPG)	FWD	999	67	91	01.21-	■
LPG (HFMT) (H4D 450)		Gasol./Gas (LPG)	FWD	999	74	101	01.20-	■
TCe 140 (HFN0)		Gasol./el éc.	FWD	1332	103	140	01.20-	■
TCe 160 (HFN1)		Gasol./el éc.	FWD	1332	116	158	09.20-	■
Blue dCi 95 (HFAF) (K9K 872)		Diesel	FWD	1461	70	95	01.20-	■
Blue dCi 115 (HFAD) (K9K 872)		Diesel	FWD	1461	85	116	01.20-	■
Blue dCi 115 (HFAD) (K9K 873)		Diesel	FWD	1461	85	116	01.20-	■
DUSTER (H79_U.S.A.) 09.12-					Closed Off-Road Vehicle (Compact SUV-J Segment)			
2.0	vehicles with ABS	Gasolina	FWD	1998	99	135	09.12-	■
DUSTER (HS_) 01.11-					SUV (Compact SUV-J Segment)			
1.6 16V (HSAT) (K4M 616)	vehicles with ABS	Gasolina	FWD	1598	75	102	02.12-	■

LISTA DE APLICACIONES - BUYERS GUIDE

1.6 16V 4x4 (K4M 490)		Gasolina	4WD	1598	75	102	06.11-05.15	■
1.6 16V 4x4 (K4M 606)		Gasolina	4WD	1598	75	102	06.11-05.15	■
1.6 16V 4x4 (K4M 646)		Gasolina	4WD	1598	75	102	06.11-05.15	■
1.6 16V 4x4 (K4M 690)		Gasolina	4WD	1598	75	102	06.11-05.15	■
1.6 16V	vehicles with ABS	Gasolina	FWD	1598	76	104	02.12-	■
1.6 16V (H4M 438)		Gasolina	FWD	1598	84	114	06.15-	■
1.6 16V 4x4 (H4M 430)		Gasolina	4WD	1598	84	114	06.15-	■
2.0 (F4R 403)	vehicles with ABS	Gasolina	FWD	1998	98	133	02.12-	■
2.0 (F4R 405)	vehicles with ABS	Gasolina	FWD	1998	98	133	02.12-	■
2.0 4x4 (F4R)	vehicles with ABS	Gasolina	4WD	1998	99	135	02.12-	■
2.0	vehicles with ABS	Gasolina	FWD	1998	101	137	01.11-	■
2.0 4x4 (HSAB, HSA3, HSAJ, HSMS)	vehicles with ABS	Gasolina	4WD	1998	101	137	01.11-	■
2.0	vehicles with ABS	Gasolina	FWD	1998	102	138	10.11-	■
2.0 Flex	vehicles with ABS	Gasolina	FWD	1998	104	141	01.11-	■
2.0 Hi-Flex	vehicles with ABS	Gasolina	FWD	1998	104	141	01.11-	■
2.0 (F4R 402)	vehicles with ABS	Gasolina	FWD	1998	105	142	10.11-	■
2.0 (F4R 403)	vehicles with ABS	Gasolina	FWD	1998	105	142	10.11-	■
2.0 4x4 (F4R 402)	vehicles with ABS	Gasolina	4WD	1998	105	142	10.11-	■
2.0 4x4 (F4R 403)	vehicles with ABS	Gasolina	4WD	1998	105	142	10.11-	■
2.0 Flex	vehicles with ABS	Gasolina	FWD	1998	105	142	10.11-	■
2.0 Flex	vehicles with ABS	Gasolina	FWD	1998	109	148	01.16-	■
2.0 Flex	vehicles with CBC	Gasolina	FWD	1998	109	148	01.16-	■
1.5 dCi	vehicles with ABS	Diesel	FWD	1461	63	85	02.12-	■
1.5 dCi	vehicles with ABS	Diesel	FWD	1461	66	90	06.11-	■
1.5 dCi 4x4 (K9K 884)		Diesel	4WD	1461	66	90	06.11-	■
1.5 dCi 4x4 (HSMD) (K9K 856)		Diesel	4WD	1461	80	109	09.13-01.18	■
1.5 dCi 4x4 (HSMD) (K9K 858)		Diesel	4WD	1461	80	109	09.13-01.18	■
1.5 dCi	vehicles with ABS	Diesel	RWD	1461	81	110	02.12-	■
DUSTER II (HM_) 10.17-					SUV (Compact SUV-J Segment)			
1.3 TCe 150 4x4 (HMM3, HMMC)		Gasolina	4WD	1332	110	150	11.21-	■
1.3 TCe 150		Gasolina	FWD	1332	113	154	11.21-	■
1.3 TCe		Gasolina	FWD	1332	115	156	11.21-	■
1.3 TCe 4x4		Gasolina	4WD	1332	115	156	11.21-	■
1.6 SCe 115 4x4 (HMM1)		Gasolina	4WD	1598	84	114	07.19-	■
2.0 4x4 (HMMS)		Gasolina	4WD	1998	105	143	11.21-	■
1.5 dCi 110 (HMAB) (K9K 656)		Diesel	FWD	1461	80	109	07.19-	■
1.5 dCi 110 (HMAB) (K9K 657)		Diesel	FWD	1461	80	109	07.19-	■
1.5 dCi 110 4x4 (HMAB) (K9K 658)		Diesel	4WD	1461	80	109	07.19-	■
EXPRESS 05.21-					Box Body/MPV (LCVs-N1 Segment)			
1.3 TCe 100 (F6MA)		Gasolina	FWD	1332	75	102	05.21-	■
1.6 SCe 110		Gasolina	FWD	1598	82	110	05.21-	■
1.5 Blue dCi 75 (F6AA)		Diesel	FWD	1461	55	75	05.21-	■
1.5 Blue dCi 95 (F6AB)		Diesel	FWD	1461	70	95	05.21-	■
1.5 dCi 95		Diesel	FWD	1461	70	95	05.21-	■
FLUENCE / SYMBOL (L3_) 02.10-					Saloon (Luxury car-F Segment)			
1.6 16V (K4M 838)		Gasolina	FWD	1598	78	106	02.10-	■
1.6 16V (L301, L30F, L30P, L30R) (K4M 838)		Gasolina	FWD	1598	81	110	02.10-	■
1.6 16V (L301, L30F, L30P, L30R) (K4M 839)		Gasolina	FWD	1598	81	110	02.10-	■
1.6 16V (L301, L30P, L30R) (K4M 838)		Gasolina	FWD	1598	82	111	02.10-	■
1.6 (L33T, L33J, L304, L305, L30H) (H4M 729)		Gasolina	FWD	1598	86	117	01.13-	■

LISTA DE APLICACIONES - BUYERS GUIDE

2.0 16V		Gasolina	FWD	1997	101	137	05.11-	■
2.0 16V (L30C, L30G, L30T, L30V) (M4R 714)		Gasolina	FWD	1997	103	140	02.10-	■
2.0 16V (L30C, L30G, L30T, L30V) (M4R 751)		Gasolina	FWD	1997	103	140	02.10-	■
2.0 (M4R 714)		Gasolina	FWD	1997	105	143	05.14-	■
2.0 (M4R 751)		Gasolina	FWD	1997	105	143	05.14-	■
1.6 LPG 16V (K4M 839)		Gasol./Gas (LPG)	FWD	1598	81	110	01.12-	■
1.6 Flex (L300)		Gasol./Etanol	FWD	1598	85	115	01.12-11.14	■
Z.E. (5AM 400)		Eléctrico	FWD		70	95	02.12-	■
1.5 dCi (L30A) (K9K 830)		Diesel	FWD	1461	63	86	02.10-	■
1.5 dCi (L30S) (K9K 834)		Diesel	FWD	1461	66	90	02.10-	■
1.5 dCi (K9K 826)		Diesel	FWD	1461	70	95	07.14-	■
1.5 dCi (L30B) (K9K 832)		Diesel	FWD	1461	78	106	02.10-	■
1.5 dCi (L30D, L30L, L306, L33F, L33L, L33M, L33V, L33W) (K9K 656)		Diesel	FWD	1461	81	110	02.10-	■
1.5 dCi (L30D, L30L, L306, L33F, L33L, L33M, L33V, L33W) (K9K 657)		Diesel	FWD	1461	81	110	02.10-	■
1.5 dCi (L30D, L30L, L306, L33F, L33L, L33M, L33V, L33W) (K9K 836)		Diesel	FWD	1461	81	110	02.10-	■
1.5 dCi (L30D, L30L, L306, L33F, L33L, L33M, L33V, L33W) (K9K 837)		Diesel	FWD	1461	81	110	02.10-	■
GRAND SCÉNIC III (JZ0/1_) 02.09-					MPV (Compact MPV-M1 Segment)			
1.6 16V (JZ0U) (K4M 858)		Gasolina	FWD	1598	81	109	02.09-09.16	■
1.5 dCi (JZ0A) (K9K 830)		Diesel	FWD	1461	63	86	04.09-09.16	■
KANGOO III 06.21-					Box Body/MPV (LCVs-N1 Segment)			
1.3 TCe 100 (FJMA)		Gasolina	FWD	1332	75	102	06.21-	■
1.3 TCe 130 (FJMB)		Gasolina	FWD	1332	96	131	06.21-	■
E-Tech Electric (FJJA)		Eléctrico	FWD		90	122	04.22-	■
1.5 Blue dCi 75 (FJAA)		Diesel	FWD	1461	55	75	06.21-	■
1.5 Blue dCi 95 (FJAB)		Diesel	FWD	1461	70	95	06.21-	■
1.5 Blue dCi 115 (FJAC)		Diesel	FWD	1461	85	116	06.21-	■
KANGOO III 07.21-					MPV (LCVs-N1 Segment)			
TCe 100 (KJMA)		Gasolina	FWD	1332	75	102	07.21-	■
TCe 130 (KJMB)		Gasolina	FWD	1332	96	131	07.21-	■
E-Tech Electric (KJJA)		Eléctrico	FWD		90	122	04.22-	■
Blue dCi 75 (KJAA)		Diesel	FWD	1461	55	75	07.21-	■
Blue dCi 95 (KJAB)		Diesel	FWD	1461	70	95	07.21-	■
Blue dCi 115 (KJAC)		Diesel	FWD	1461	85	116	10.21-	■
KAPTUR (H5_) 03.16-					Hatchback (Mini SUV-J Segment)			
1.3 TCe 150 (H5M3)		Gasolina	FWD	1332	110	150	10.21-	■
1.3 TCe 150 4x4 (H5M3)		Gasolina	4WD	1332	110	150	10.21-	■
2.0 4WD (F4R 410)		Gasolina	4WD	1998	105	143	03.16-	■
LAGUNA III (DT0/1) 09.08-					Coupe (Large family car-D Segment)			
1.5 dCi (K9K 846)		Diesel	FWD	1461	81	110	03.12-12.15	■
LAGUNA III (BT0/1) 10.07-					Hatchback (Large family car-D Segment)			
1.6 16V (BT04, BT0D, BT0U) (K4M 824)		Gasolina	FWD	1598	81	110	10.07-12.15	■
1.5 dCi (BT00, BT0A, BT0T, BT1J) (K9K 780)		Diesel	FWD	1461	81	110	10.07-12.15	■
1.5 dCi (BT00, BT0A, BT0T, BT1J) (K9K 782)		Diesel	FWD	1461	81	110	10.07-12.15	■
LAGUNA III Grandtour (KT0/1) 10.07-					Estate (Large family car-D Segment)			
1.6 16V (KT0D) (K4M 824)		Gasolina	FWD	1598	81	110	10.07-12.15	■
1.5 dCi (KT0A, KT0R, KT02) (K9K 780)	02/08-	Diesel	FWD	1461	81	110	10.07-12.15	■

LISTA DE APLICACIONES - BUYERS GUIDE

1.5 dCi (KT0A, KT0R, KT02) (K9K 782)	02/08-	Diesel	FWD	1461	81	110	10.07-12.15	■
1.5 dCi (KT0A, KT0R, KT02) (K9K 846)	02/08-	Diesel	FWD	1461	81	110	10.07-12.15	■
2.0 dCi (KT07, KT0J, KT14, KT1A, KT1S) (M9R 742)	01/08-	Diesel	FWD	1995	96	131	10.07-12.15	■
2.0 dCi (KT07, KT0J, KT14, KT1A, KT1S) (M9R 744)	01/08-	Diesel	FWD	1995	96	131	10.07-12.15	■
2.0 dCi (KT07, KT0J, KT14, KT1A, KT1S) (M9R 802)	01/08-	Diesel	FWD	1995	96	131	10.07-12.15	■
2.0 dCi (KT07, KT0J, KT14, KT1A, KT1S) (M9R 814)	01/08-	Diesel	FWD	1995	96	131	10.07-12.15	■
2.0 dCi (KT07, KT0J, KT14, KT1A, KT1S) (M9R 854)	01/08-	Diesel	FWD	1995	96	131	10.07-12.15	■
2.0 dCi (KT07, KT0J, KT14, KT1A, KT1S) (M9R 858)	01/08-	Diesel	FWD	1995	96	131	10.07-12.15	■
MEGANE IV 10.16-					Saloon (Compact car-C Segment)			
1.2 TCe 130 (H5F 408)		Gasolina	FWD	1197	97	130	10.16-	■
1.5 Blue dCi 95 (LVA2) (K9K 872)		Diesel	FWD	1461	70	95	02.19-	■
1.5 dCi 110		Diesel	FWD	1461	81	110	10.16-	■
1.5 Blue dCi 115 (LVA6) (K9K 872)		Diesel	FWD	1461	85	115	02.19-	■
1.5 Blue dCi 115 (LVA6) (K9K 873)		Diesel	FWD	1461	85	115	02.19-	■
MEGANE III (DZ0/1_) 11.08-					Coupe (Compact car-C Segment)			
1.2 TCe (DZ16, DZ28) (H5F 404)		Gasolina	FWD	1197	97	132	01.13-08.15	■
1.2 TCe (DZ16, DZ28) (H5F 405)		Gasolina	FWD	1197	97	132	01.13-08.15	■
1.2 TCe (DZ16, DZ28) (H5F 412)		Gasolina	FWD	1197	97	132	01.13-08.15	■
1.2 TCe (DZ2B, DZ11) (H5F 400)		Gasolina	FWD	1198	85	116	03.12-08.15	■
1.2 TCe (DZ2B, DZ11) (H5F 408)		Gasolina	FWD	1198	85	116	03.12-08.15	■
1.4 TCe (DZ0F, DZ1V) (H4J 700)		Gasolina	FWD	1397	96	131	04.09-08.15	■
1.6 16V (DZ0H) (K4M 848)	06/09-	Gasolina	FWD	1598	74	101	11.08-08.15	■
1.6 16V (DZ0U, DZ1B, DZ1H) (K4M 858)		Gasolina	FWD	1598	81	110	11.08-08.15	■
2.0 CVT (DZ0G, DZ1E) (M4R 711)		Gasolina	FWD	1997	103	140	05.09-08.15	■
1.6 16V Bifuel (DZ03, DZ1Y) (K4M 866)		Gasol./Gas (LPG)	FWD	1598	81	110	11.08-08.15	■
1.5 dCi (DZ0A) (K9K 830)		Diesel	FWD	1461	63	86	11.08-08.15	■
1.5 dCi (DZ0C, DZ1A) (K9K 834)		Diesel	FWD	1461	66	90	11.08-08.15	■
1.5 dCi (K9K 846)		Diesel	FWD	1461	70	95	07.14-08.15	■
1.5 dCi (DZ0B) (K9K 832)		Diesel	FWD	1461	78	106	02.09-08.15	■
1.5 dCi (DZ09, DZ0D, DZ1F, DZ1G, DZ14, DZ29) (K9K 636)		Diesel	FWD	1461	81	110	02.09-08.15	■
1.5 dCi (DZ09, DZ0D, DZ1F, DZ1G, DZ14, DZ29) (K9K 836)		Diesel	FWD	1461	81	110	02.09-08.15	■
1.5 dCi (DZ09, DZ0D, DZ1F, DZ1G, DZ14, DZ29) (K9K 837)		Diesel	FWD	1461	81	110	02.09-08.15	■
1.5 dCi (DZ09, DZ0D, DZ1F, DZ1G, DZ14, DZ29) (K9K 846)		Diesel	FWD	1461	81	110	02.09-08.15	■
1.6 dCi (DZ00, DZ12, DZ2A, DZ13) (R9M 402)		Diesel	FWD	1598	96	130	04.11-08.15	■
1.9 dCi (DZ0N, DZ0J, DZ1J, DZ1K) (F9Q 870)		Diesel	FWD	1870	96	131	11.08-08.15	■
1.9 dCi (DZ0N, DZ0J, DZ1J, DZ1K) (F9Q 872)		Diesel	FWD	1870	96	131	11.08-08.15	■
MEGANE III (BZ0/1_, B3_) 11.08-					Hatchback (Compact car-C Segment)			
1.2 TCe (BZ16, BZ28) (H5F 404)		Gasolina	FWD	1197	97	132	01.13-01.16	■
1.2 TCe (BZ16, BZ28) (H5F 405)		Gasolina	FWD	1197	97	132	01.13-01.16	■
1.2 TCe (BZ16, BZ28) (H5F 412)		Gasolina	FWD	1197	97	132	01.13-01.16	■
1.2 TCe (BZ2B, BZ11) (H5F 400)		Gasolina	FWD	1198	85	116	03.12-08.15	■
1.2 TCe (BZ2B, BZ11) (H5F 408)		Gasolina	FWD	1198	85	116	03.12-08.15	■
1.4 TCe (BZ0F, BZ1V) (H4J 700)		Gasolina	FWD	1397	96	131	04.09-08.15	■
1.6 16V (BZ0H) (K4M 848)		Gasolina	FWD	1598	74	101	11.08-08.15	■
1.6 16V (BZ0H, BZ1R) (K4M 848)		Gasolina	FWD	1598	78	106	01.10-08.15	■

LISTA DE APLICACIONES - BUYERS GUIDE

1.6 16V (BZ1B, BZ1H) (K4M 858)		Gasolina	FWD	1598	81	110	11.08-03.17	■
1.6 16V (K4M 858)		Gasolina	FWD	1598	82	111	11.08-01.16	■
1.6 16V (K4M 866)		Gasolina	FWD	1598	82	111	11.08-01.16	■
1.6 16V (K4M 848)		Gasolina	FWD	1598	85	116	01.13-08.15	■
1.6 16V (K4M 858)		Gasolina	FWD	1598	85	116	01.13-08.15	■
1.6 (B332) (H4M 729)		Gasolina	FWD	1598	86	117	01.14-01.16	■
2.0 CVT (BZ0G, BZ1P) (M4R 711)		Gasolina	FWD	1997	103	140	02.09-08.15	■
2.0 CVT (BZ0G, BZ1P) (M4R 713)		Gasolina	FWD	1997	103	140	02.09-08.15	■
2.0 (M4R 710)		Gasolina	FWD	1997	105	143	01.11-08.15	■
2.0 (M4R 714)		Gasolina	FWD	1997	105	143	01.11-08.15	■
1.6 16V BiFuel (BZ1U, BZ0U) (K4M 858)		Gasol./Gas (LPG)	FWD	1598	81	110	05.09-08.15	■
1.6 16V Hi-Flex (BZ03) (K4M 858)		Gasol./Etanol	FWD	1598	81	110	11.08-08.15	■
1.6 16V Hi-Flex (BZ03) (K4M 866)		Gasol./Etanol	FWD	1598	81	110	11.08-08.15	■
1.5 dCi (K9K 830)		Diesel	FWD	1461	63	86	11.08-08.15	■
1.5 dCi (BZ0C) (K9K 834)		Diesel	FWD	1461	66	90	11.08-08.15	■
1.5 dCi (BZ1G, BZ1W, BZ0R) (K9K 846)		Diesel	FWD	1461	70	95	11.13-08.15	■
1.5 dCi (K9K 832)	06/09-	Diesel	FWD	1461	78	106	02.09-01.16	■
1.5 dCi (BZ09, BZ0D, BZ1W, BZ29, BZ14) (K9K 636)		Diesel	FWD	1461	81	110	02.09-12.15	■
1.5 dCi (BZ09, BZ0D, BZ1W, BZ29, BZ14) (K9K 836)		Diesel	FWD	1461	81	110	02.09-12.15	■
1.5 dCi (BZ09, BZ0D, BZ1W, BZ29, BZ14) (K9K 837)		Diesel	FWD	1461	81	110	02.09-12.15	■
1.5 dCi (BZ09, BZ0D, BZ1W, BZ29, BZ14) (K9K 846)		Diesel	FWD	1461	81	110	02.09-12.15	■
1.6 dCi (BZ00, BZ12, BZ13) (R9M 402)		Diesel	FWD	1598	96	130	04.11-08.15	■
1.6 dCi (BZ00, BZ12, BZ13) (R9M 404)		Diesel	FWD	1598	96	130	04.11-08.15	■
1.9 dCi (BZ0N, BZ0J) (F9Q 870)		Diesel	FWD	1870	96	131	11.08-01.16	■
1.9 dCi (BZ0N, BZ0J) (F9Q 872)		Diesel	FWD	1870	96	131	11.08-01.16	■
MEGANE III (B95) 06.09-					Saloon (Compact car-C Segment)			
1.6 16V		Gasolina	FWD	1598	82	112	06.09-	■
MEGANE III Grandtour (KZ0/1) 11.08-					Estate (Compact car-C Segment)			
1.2 TCe (KZ2B, KZ11) (H5F 400)		Gasolina	FWD	1198	85	116	03.12-08.15	■
1.2 TCe (KZ2B, KZ11) (H5F 408)		Gasolina	FWD	1198	85	116	03.12-08.15	■
1.4 TCe (KZ0F, KZ1V) (H4J 700)		Gasolina	FWD	1397	96	130	05.09-08.15	■
1.6 16V (KZ0H) (K4M 848)		Gasolina	FWD	1598	74	101	05.09-08.15	■
1.6 16V (KZ0U, KZ1B, KZ1U) (K4M 858)		Gasolina	FWD	1598	81	110	05.09-08.15	■
1.6 16V (KZ0U, KZ1B, KZ1U) (K4M 866)		Gasolina	FWD	1598	81	110	05.09-08.15	■
2.0 CVT (KZ0G, KZ1P) (M4R 711)		Gasolina	FWD	1997	103	140	05.09-08.15	■
2.0 CVT (KZ0G, KZ1P) (M4R 713)		Gasolina	FWD	1997	103	140	05.09-08.15	■
1.6 BiFuel (KZ03) (K4M 866)		Gasol./Gas (LPG)	FWD	1598	81	110	11.08-08.15	■
1.5 dCi (K9K 830)		Diesel	FWD	1461	63	86	03.09-08.15	■
1.5 dCi (KZ0C, KZ1A) (K9K 834)		Diesel	FWD	1461	66	90	05.09-08.15	■
1.5 dCi (KZ1M, KZ1W, KZ0R) (K9K 832)	08/09-	Diesel	FWD	1461	78	106	02.09-08.15	■
1.5 dCi (KZ1M, KZ1W, KZ0R) (K9K 836)	08/09-	Diesel	FWD	1461	78	106	02.09-08.15	■
1.5 dCi (KZ1M, KZ1W, KZ0R) (K9K 846)	08/09-	Diesel	FWD	1461	78	106	02.09-08.15	■
1.5 dCi (KZ09, KZ0D, KZ1G, KZ29, KZ14, KZ1W, KZ10, KZ1F,...) (K9K 636)		Diesel	FWD	1461	81	110	02.09-08.15	■
1.5 dCi (KZ09, KZ0D, KZ1G, KZ29, KZ14, KZ1W, KZ10, KZ1F,...) (K9K 836)		Diesel	FWD	1461	81	110	02.09-08.15	■
1.5 dCi (KZ09, KZ0D, KZ1G, KZ29, KZ14, KZ1W, KZ10, KZ1F,...) (K9K 837)		Diesel	FWD	1461	81	110	02.09-08.15	■

LISTA DE APLICACIONES - BUYERS GUIDE

1.5 dCi (KZ09, KZ0D, KZ1G, KZ29, KZ14, KZ1W, KZ10, KZ1F,... (K9K 846)	Diesel	FWD	1461	81	110	02.09-08.15	■
1.6 dCi (KZ00, KZ12, KZ13) (R9M 402)	Diesel	FWD	1598	96	130	04.11-08.15	■
1.6 dCi (KZ00, KZ12, KZ13) (R9M 404)	Diesel	FWD	1598	96	130	04.11-08.15	■
1.6 dCi (KZ00, KZ12, KZ13) (R9M 414)	Diesel	FWD	1598	96	130	04.11-08.15	■
1.9 dCi (KZ0J, KZ0N, KZ1S) (F9Q 870)	Diesel	FWD	1870	96	131	05.09-08.15	■
1.9 dCi (KZ0J, KZ0N, KZ1S) (F9Q 872)	Diesel	FWD	1870	96	131	05.09-08.15	■
MEGANE III Hatchback Van (BZ_) 11.08-08.15				Hatchback Van (Compact car-C Segment)			
1.5 dCi (BZ0C, BZ1A) (K9K 834)	Diesel	FWD	1461	66	90	11.08-08.15	■
1.5 dCi (BZ0D, BZ1G, BZ1F, BZ1M, BZ1W, BZ0R, BZ10) (K9K 836)	Diesel	FWD	1461	81	110	02.09-08.15	■
1.5 dCi (BZ0D, BZ1G, BZ1F, BZ1M, BZ1W, BZ0R, BZ10) (K9K 846)	Diesel	FWD	1461	81	110	02.09-08.15	■
MEGANE III CC (EZ0/1_) 06.10-				Convertible (Compact car-C Segment)			
1.4 TCe (EZ0F, EZ1V) (H4J 700)	Gasolina	FWD	1397	96	131	06.10-08.15	■
1.6 16V (EZ0U, EZ1U) (K4M 858)	Gasolina	FWD	1598	81	110	06.10-08.15	■
2.0 CVT (EZ0G, EZ1E, EZ1P) (M4R 711)	Gasolina	FWD	1997	103	140	06.10-08.15	■
2.0 CVT (EZ0G, EZ1E, EZ1P) (M4R 713)	Gasolina	FWD	1997	103	140	06.10-08.15	■
1.5 dCi (EZ09, EZ1G, EZ0D, EZ14) (K9K 837)	Diesel	FWD	1461	81	110	06.10-08.15	■
1.6 dCi (EZ00) (R9M 402)	Diesel	FWD	1598	96	130	04.11-08.15	■
1.9 dCi (EZ0J, EZ1S) (F9Q 870)	Diesel	FWD	1870	96	131	06.10-08.15	■
MEGANE IV (B9A/M/N_) 11.15-				Hatchback (Compact car-C Segment)			
1.0 TCe 115 (B9MD, B9MW)	Gasolina	FWD	999	84	114	10.20-	■
1.2 TCe 100 (B9MS) (H5F 408)	Gasolina	FWD	1197	74	100	11.15-	■
1.2 TCe 130 (B9MR) (H5F 408)	Gasolina	FWD	1197	97	130	11.15-	■
1.3 TCe 100 (B9N8) (H5H 470)	Gasolina	FWD	1332	75	102	08.18-	■
1.3 TCe 115 (B9N9) (H5H 450)	Gasolina	FWD	1332	85	116	01.18-	■
1.3 TCe 115 (B9N9) (H5H 470)	Gasolina	FWD	1332	85	116	01.18-	■
1.3 TCe 140 (B9NB) (H5H 450)	Gasolina	FWD	1332	103	140	01.18-	■
1.3 TCe 140 (B9NB) (H5H 470)	Gasolina	FWD	1332	103	140	01.18-	■
1.5 Blue dCi 95 (B9A2, B9A6) (K9K 872)	Diesel	FWD	1461	70	95	08.18-	■
1.5 dCi 110 (B9A3) (K9K 646)	Diesel	FWD	1461	81	110	11.15-	■
1.5 dCi 110 (B9A3) (K9K 648)	Diesel	FWD	1461	81	110	11.15-	■
1.5 dCi 110 (B9A3) (K9K 656)	Diesel	FWD	1461	81	110	11.15-	■
1.5 dCi 110 (B9A3) (K9K 657)	Diesel	FWD	1461	81	110	11.15-	■
1.5 Blue dCi 115 (B9A6) (K9K 872)	Diesel	FWD	1461	85	116	08.18-	■
1.5 Blue dCi 115 (B9A6) (K9K 873)	Diesel	FWD	1461	85	116	08.18-	■
MEGANE IV Grandtour (K9A/M/N_) 04.16-				Estate (Compact car-C Segment)			
1.0 TCe 115 (K9MB, K9MW)	Gasolina	FWD	999	84	114	07.21-	■
1.2 TCe 100 (H5F 408)	Gasolina	FWD	1197	74	100	04.16-	■
1.2 TCe 130 (K9MR) (H5F 408)	Gasolina	FWD	1197	97	130	04.16-	■
1.3 TCe 100 (K9N8) (H5H 470)	Gasolina	FWD	1332	75	100	08.18-	■
1.3 TCe 115 (K9N9) (H5H 450)	Gasolina	FWD	1332	85	116	01.18-	■
1.3 TCe 115 (K9N9) (H5H 470)	Gasolina	FWD	1332	85	116	01.18-	■
1.3 TCe 140 (K9NB) (H5H 450)	Gasolina	FWD	1332	103	140	01.18-	■
1.3 TCe 140 (K9NB) (H5H 470)	Gasolina	FWD	1332	103	140	01.18-	■
1.6 16V (H4M 738)	Gasolina	FWD	1598	84	115	04.16-	■
1.5 dCi 90 (K9K 656)	Diesel	FWD	1461	66	90	04.16-	■
1.5 Blue dCi 95 (K9A2) (K9K 872)	Diesel	FWD	1461	70	95	08.18-	■
1.5 dCi 110 (K9K 656)	Diesel	FWD	1461	81	110	04.16-	■
1.5 dCi 110 (K9K 657)	Diesel	FWD	1461	81	110	04.16-	■

LISTA DE APLICACIONES - BUYERS GUIDE

1.5 Blue dCi 115 (K9A6) (K9K 872)	Diesel	FWD	1461	85	116	08.18-	■
1.5 Blue dCi 115 (K9A6) (K9K 873)	Diesel	FWD	1461	85	116	08.18-	■
SCÉNIC III (JZ0/1_) 12.08-				MPV (Compact MPV-M1 Segment)			
1.6 16V (JZ0U, JZ1B) (K4M 858)	Gasolina	FWD	1598	81	110	02.09-09.16	■
1.6 16V (JZ0U, JZ1B) (K4M R 858)	Gasolina	FWD	1598	81	110	02.09-09.16	■
1.6 E85 (JZ03, JZ1Y) (K4M 866)	Gasol./Etanol	FWD	1598	81	110	02.09-09.16	■
1.5 dCi (K9K 830)	Diesel	FWD	1461	63	86	04.09-09.16	■
1.5 dCi (K9K 636)	Diesel	FWD	1461	81	110	04.09-09.16	■
1.5 dCi (K9K 656)	Diesel	FWD	1461	81	110	04.09-09.16	■
1.5 dCi (K9K 657)	Diesel	FWD	1461	81	110	04.09-09.16	■
1.5 dCi (K9K 836)	Diesel	FWD	1461	81	110	04.09-09.16	■
1.5 dCi (K9K 837)	Diesel	FWD	1461	81	110	04.09-09.16	■
ZOE (BFM_) 04.19-				Hatchback Van (City car-A Segment)			
Electric (BFMC, BFMD)	Eléctrico	FWD		100	136	10.19-	■
ZOE (BFM_) 06.12-				Hatchback (City car-A Segment)			
ZOE (BFMC, BFMD) (5AQ 605)	Eléctrico	FWD		100	136	09.19-	■
VW							
JETTA V / BORA / VENTO (1K2) 09.04-12.13				Saloon (Compact car-C Segment)			
1.6 MultiFuel (CCSA)	Gasol./Etanol	FWD	1595	75	102	01.08-10.10	■