

LISTA DE APLICACIONES - BUYERS GUIDE

78BD4269-2



Weight: 12.390

O.E.M.	MAKE
4246.69	PEUGEOT
4246.B8	PEUGEOT

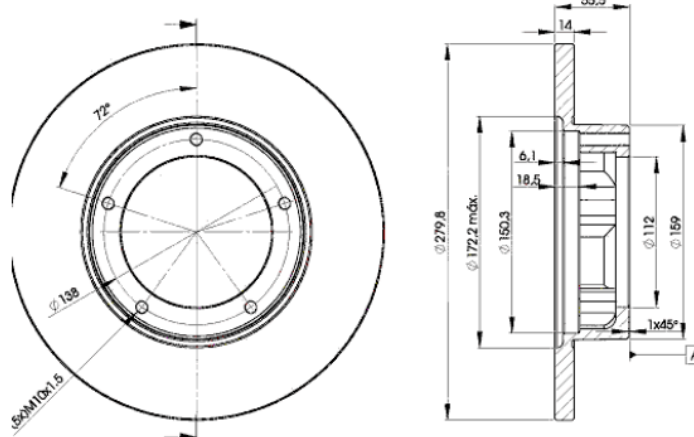

78BD4269-2

E1 90R-02C0100/0870



Ø280x14x55.5

MAKE
PEUGEOT



Trac.	CC	Kw	CV		
					Front / Rear

PEUGEOT

J7 08.68-03.80

Bus (Minibus-M2-Segment)

1.6 (XC7P)		Gasolina	FWD	1618	44	60	07.70-03.80	■
1.6 (XC5P)		Gasolina	FWD	1618	50	68	08.68-07.70	■
1.8 (XM7P)		Gasolina	FWD	1796	48	65	07.70-03.80	■
1.9 D (XDP88)		Diesel	FWD	1948	40	55	08.68-07.78	■
2.1 D (XDP90)		Diesel	FWD	2112	42	57	08.68-07.77	■
2.3 D (XD2P94)		Diesel	FWD	2304	49	67	07.77-03.80	■

J7 08.68-03.80

Platform/Chassis (LCVs-N1 Segment)

1.6 (XC7P)		Gasolina	FWD	1618	44	60	07.70-03.80	■
1.6 (XC5P)		Gasolina	FWD	1618	50	68	08.68-07.70	■
1.8 (XM7P)		Gasolina	FWD	1796	48	65	07.70-03.80	■
1.9 D (XDP88)		Diesel	FWD	1948	40	55	08.68-07.78	■
2.1 D (XDP90)		Diesel	FWD	2112	42	57	08.68-07.77	■
2.3 D (XD2P94)		Diesel	FWD	2304	49	67	07.77-03.80	■

J7 08.68-03.80

Van (LCVs-N1 Segment)

1.5 (XB5P)		Gasolina	FWD	1468	61	83	08.68-07.70	■
1.6 (XC7P)		Gasolina	FWD	1618	44	60	08.68-03.80	■
1.6 (XC5P)		Gasolina	FWD	1618	50	68	08.68-03.80	■
1.8 (XM7P)		Gasolina	FWD	1796	48	65	07.70-03.80	■
1.9 D (XDP88)		Diesel	FWD	1948	40	55	08.68-07.78	■
2.1 D (XDP90)		Diesel	FWD	2112	42	57	08.68-07.77	■
2.3 D (XD2P94)		Diesel	FWD	2304	49	67	07.77-03.80	■

LISTA DE APLICACIONES - BUYERS GUIDE

J9 03.80-06.87					Bus (Minibus-M2-Segment)			
2.0 (XN1P)		Gasolina	FWD	1971	57	78	03.80-06.87	■
2.3 D (XD2PX94)		Diesel	FWD	2304	49	67	03.80-07.82	■
2.5 D (XD3P)		Diesel	FWD	2497	53	72	08.82-06.87	■
J9 03.80-06.87					Platform/Chassis (LCVs-N1 Segment)			
2.0 (XN1P)		Gasolina	FWD	1971	57	78	03.80-06.87	■
2.3 D (XD2PX94)		Diesel	FWD	2304	49	67	03.80-07.82	■
2.5 D (XD3P)		Diesel	FWD	2497	53	72	07.82-06.87	■
J9 03.80-06.87					Van (LCVs-N1 Segment)			
1.6 (XC7P)		Gasolina	FWD	1618	44	60	03.80-06.87	■
2.0 (XN1P)		Gasolina	FWD	1971	57	78	03.80-06.87	■
2.1 D (XDPX90)		Diesel	FWD	2112	41	56	03.80-06.87	■
2.3 D (XD2PX94)		Diesel	FWD	2304	49	67	03.80-07.82	■
2.5 D (XD3P)		Diesel	FWD	2497	53	72	07.82-06.87	■