

# LISTA DE APLICACIONES - BUYERS GUIDE

## 78BD4298-2



8 424073 145857

Weight: 7.908

O.E.M.	MAKE
1690.14	CITROËN
4246.R8	PEUGEOT
4246.R9	CITROËN

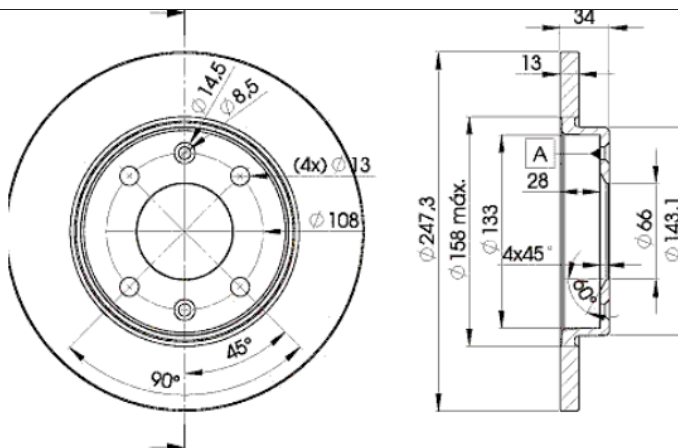

## 78BD4298-2



Ø247x13x34.2

MAKE
CITROËN
PEUGEOT



Trac.	CC	Kw	CV	
				Front / Rear

### CITROËN

#### XSARA (N0) 01.98-04.05

					Coupe (Compact car-C Segment)			
1.4 i (KFW (TU3JP))		Gasolina	FWD	1360	55	75	03.98-03.05	■
1.4 i (KFX (TU3JP))		Gasolina	FWD	1360	55	75	03.98-03.05	■

#### XSARA (N3\_) 05.98-03.05

					Hatchback Van (Compact car-C Segment)			
1.4 (KFX (TU3JP))		Gasolina	FWD	1360	55	75	05.98-10.04	■
1.5 D (VJZ (TUD5))		Diesel	FWD	1527	42	57	05.98-08.00	■

#### XSARA (N1) 04.97-12.05

					Hatchback (Compact car-C Segment)			
1.4 i (KFW (TU3JP))	-10/00, vehicles without ABS	Gasolina	FWD	1360	55	75	04.97-03.05	■
1.4 i (KFX (TU3JP))	-10/00, vehicles without ABS	Gasolina	FWD	1360	55	75	04.97-03.05	■
1.5 D (VJZ (TUD5))		Diesel	FWD	1527	42	57	04.97-09.00	■

### PEUGEOT

#### 206 04.99-03.09

					Hatchback Van (LCVs-N1 Segment)			
1.1 (HFZ (TU1JP))		Gasolina	FWD	1124	44	60	09.02-02.07	■
1.4 HDi (8HX (DV4TD))		Diesel	FWD	1398	50	68	09.01-03.09	■
1.4 HDi (8HZ (DV4TD))		Diesel	FWD	1398	50	68	09.01-03.09	■
1.9 D (WJY (DW8B))		Diesel	FWD	1868	51	69	04.99-05.07	■
1.9 D (WJZ (DW8))		Diesel	FWD	1868	51	69	04.99-05.07	■

#### 206 (2A/C) 08.98-

					Hatchback (Supermini car-B Segment)			
1.0	vehicles with ABS	Gasolina	FWD	999	45	61	09.02-02.07	■
1.0 (D4D)		Gasolina	FWD	999	52	71	06.01-12.05	■
1.1 (HFX (TU1JP))	vehicles with ABS	Gasolina	FWD	1124	40	54	08.98-07.00	■
1.1 i (HFX (TU1JP))	vehicles with ABS	Gasolina	FWD	1124	44	60	09.98-02.07	■

# LISTA DE APLICACIONES - BUYERS GUIDE

1.1 i (HFZ (TU1JP))	vehicles with ABS	Gasolina	FWD	1124	44	60	09.98-02.07	■
1.4 i (KFW (TU3A))	vehicles without ABS	Gasolina	FWD	1360	55	75	09.98-12.12	■
1.4 i (KFW (TU3JP))	vehicles without ABS	Gasolina	FWD	1360	55	75	09.98-12.12	■
1.4 i (KFX (TU3JP))	vehicles without ABS	Gasolina	FWD	1360	55	75	09.98-12.12	■
1.4 16V (KFU (ET3J4))	vehicles without ABS	Gasolina	FWD	1360	65	88	10.03-02.08	■
1.4 CNG (KFW (TU3A))		Gasol./Gas (CNG)	FWD	1360	55	75	05.06-09.07	■
1.4 Flex		Gasol./Etanol	FWD	1360	60	82	01.06-11.09	■
1.0	vehicles with ABS	Gasol./eléc.	FWD	999	48	65	09.02-02.07	■
1.4 HDi eco 70 (8HX (DV4TD))		Diesel	FWD	1398	50	68	09.01-04.09	■
1.4 HDi eco 70 (8HZ (DV4TD))		Diesel	FWD	1398	50	68	09.01-04.09	■
1.4 HDi (8HX (DV4TD))		Diesel	FWD	1398	51	69	09.02-02.07	■
<b>206 03.07-</b>					<b>Saloon (Supermini car-B Segment)</b>			
1.4 (KFV (TU3A))		Gasolina	FWD	1360	55	75	03.07-	■
1.4 (KFW (TU3JP))		Gasolina	FWD	1360	55	75	03.07-	■
1.4 HDi eco 70 (8HZ (DV4TD))		Diesel	FWD	1398	50	68	09.08-	■
<b>206 SW (2E/K) 07.02-</b>					<b>Estate (Supermini car-B Segment)</b>			
1.1 (HFX (TU1JP))	vehicles with ABS	Gasolina	FWD	1124	44	60	07.02-02.07	■
1.4 (KFV (TU3A))	vehicles with ABS	Gasolina	FWD	1360	55	75	07.02-02.07	■
1.4 (KFW (TU3JP))	vehicles with ABS	Gasolina	FWD	1360	55	75	07.02-02.07	■
1.4 16V (KFU (ET3J4))	vehicles with ABS	Gasolina	FWD	1360	65	88	10.03-	■
1.4 LPG (KFW (TU3JP))		Gasol./Gas (LPG)	FWD	1360	55	75	07.02-02.07	■
1.4 HDi (8HX (DV4TD))		Diesel	FWD	1398	50	68	07.02-02.07	■
<b>206+ (2L_, 2M_) 01.09-</b>					<b>Hatchback (Supermini car-B Segment)</b>			
1.1 (HFX (TU1A))		Gasolina	FWD	1124	44	60	01.09-06.13	■
1.4 i (KFT (TU3AE5))		Gasolina	FWD	1360	54	73	09.10-06.13	■
1.4 i (2LKFWA, 2MKFWA) (KFW (TU3A))		Gasolina	FWD	1360	55	75	01.09-08.13	■
1.1 LPG (HFX (TU1A))		Gasol./Gas (LPG)	FWD	1124	44	60	04.09-06.13	■
1.1 LPG (HFX (TU1JP))		Gasol./Gas (LPG)	FWD	1124	44	60	04.09-06.13	■
1.4 HDi eco 70 (8HR (DV4C))		Diesel	FWD	1398	50	68	01.09-06.13	■
1.4 HDi eco 70 (8HZ (DV4TD))		Diesel	FWD	1398	50	68	01.09-06.13	■
<b>306 (7D, N3, N5) 01.94-04.02</b>					<b>Convertible (Compact car-C Segment)</b>			
1.6 (NFZ (TU5JP))	05/97-, -06/00	Gasolina	FWD	1587	65	89	04.96-10.00	■