

LISTA DE APLICACIONES - BUYERS GUIDE

78BD4700-2



Weight: 8.988

O.E.M.	MAKE
4246.F0	PEUGEOT
4246.J0	CITROËN
43512-0H010	TOYOTA
43512-0H020	TOYOTA

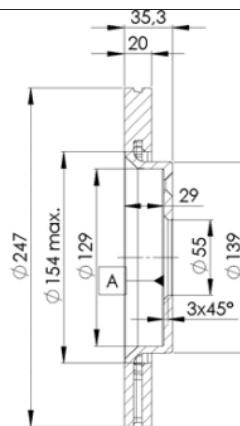
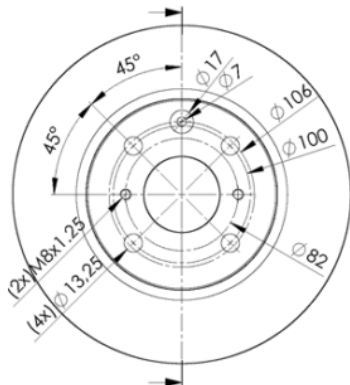

78BD4700-2



Ø247x20x35.5

MAKE
CITROËN
JAC
PEUGEOT
TOYOTA



Trac.	CC	Kw	CV
-------	----	----	----



Front / Rear

CITROËN

C1 (PM_, PN_) 06.05-09.14

Hatchback (City car-A Segment)

1.0 (CFB (1KR))		Gasolina	FWD	998	50	68	06.05-09.14	■
1.4 HDi (8HT (DV4TD))	vehicles with ABS	Diesel	FWD	1398	40	54	06.05-09.14	■

C1 II (PA_, PS_) 04.14-

Hatchback (City car-A Segment)

1.0 VTi 68 (CFB (1KR))		Gasolina	FWD	998	51	69	04.14-04.18	■
1.0 VTi 72 (CFB (1KR))		Gasolina	FWD	998	53	72	06.18-07.21	■
1.2 VTi 82 (HMT (EB2D))		Gasolina	FWD	1199	60	82	04.14-04.18	■
1.2 VTi 82 (HMZ (EB2))		Gasolina	FWD	1199	60	82	04.14-04.18	■
1.2 VTi 82 (HMZ (EB2F))		Gasolina	FWD	1199	60	82	04.14-04.18	■

JAC

iEV6E 05.17-

Hatchback ()

EV		Eléctrico	FWD		45	61	05.17-	■
EV		Eléctrico	FWD		50	68	06.18-	■
EV		Eléctrico	FWD		55	75	04.19-	■
EV		Eléctrico	FWD		60	82	05.17-	■

PEUGEOT

107 (PM_, PN_) 06.05-

Hatchback (City car-A Segment)

1.0 (CFA (384F))		Gasolina	FWD	998	50	68	06.05-05.14	■
1.0 (CFB (1KR))		Gasolina	FWD	998	50	68	06.05-05.14	■
1.4 HDi (8HT (DV4TD))	vehicles with ABS	Diesel	FWD	1398	40	54	06.05-05.14	■

108 05.14-

Hatchback (City car-A Segment)

1.0 VTi (CFB (1KR))		Gasolina	FWD	998	51	69	05.14-	■
---------------------	--	----------	-----	-----	----	----	--------	---

LISTA DE APLICACIONES - BUYERS GUIDE

1.0 VTi 72 (CFB (1KR))	Gasolina	FWD	998	53	72	05.18-	■
1.2 (HMT (EB2D))	Gasolina	FWD	1199	60	82	05.14-	■
1.2 (HMZ (EB2))	Gasolina	FWD	1199	60	82	05.14-	■
1.2 (HMZ (EB2F))	Gasolina	FWD	1199	60	82	05.14-	■
TOYOTA							
AYGO (_B1_) 07.05-05.14				Hatchback Van (City car-A Segment)			
1.0 VVTi (KGB10) (1KR-FE)	Gasolina	FWD	998	50	68	07.05-05.14	■
AYGO (_B1_) 02.05-				Hatchback (City car-A Segment)			
1.0 (KGB10_, KGB10R) (1KR-FE)	Gasolina	FWD	998	50	68	07.05-05.14	■
1.0 GPL (KGB10_) (1KR-FE)	Gasol./Gas (LPG)	FWD	998	50	68	07.05-05.14	■
1.4 D-4D (WNB10_, WNB10R) (2WZ-TV)	Diesel	FWD	1398	40	54	07.05-08.10	■
AYGO II (_B4_) 05.14-				Hatchback (City car-A Segment)			
1.0 (KGB40) (1KR-FE)	Gasolina	FWD	998	51	69	05.14-	■
1.0 VVTi (KGB40) (1KR-FE)	Gasolina	FWD	998	53	72	03.18-	■
1.2 (PAB40) (1PP)	Gasolina	FWD	1199	60	82	05.14-	■