

LISTA DE APLICACIONES - BUYERS GUIDE

78BD4844-2

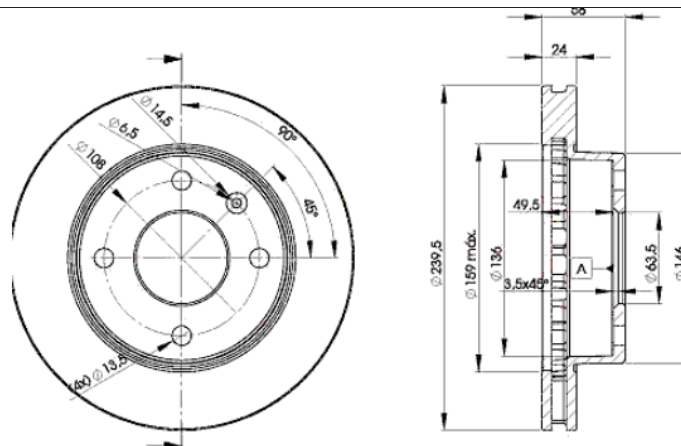

Weight: 9.512



78BD4844-2



Ø239.5x24x58

MAKE

FORD
PANTHER
TVR

O.E.M.	MAKE
1 096 104	FORD
1 595 875	FORD
1 619 053	FORD
1 619 054	FORD
1 629 482	FORD
1 644 844	FORD
1 644 845	FORD
5 022 659	FORD
5 022 660	FORD
5 022 948	FORD
5 025 573	FORD
6 077 974	FORD
6 133 549	FORD
6 133 550	FORD
6 134 507	FORD
6 155 824	FORD
6 158 202	FORD
6 158 204	FORD
6 158 210	FORD
6 158 211	FORD
87BX-1125-CA	FORD



Trac.	CC	Kw	CV
-------	----	----	----



Front / Rear

FORD

ESCORT III (ALD) 09.83-12.89

Convertible (Compact car-C Segment)

1.6 XR3	Gasolina	FWD	1555	66	90	09.83-12.85	■
1.6 (LP1)	Gasolina	FWD	1597	58	79	09.83-12.85	■
1.6 (LPA)	Gasolina	FWD	1597	58	79	09.83-12.85	■
1.6 i (LR1)	Gasolina	FWD	1597	77	105	09.83-12.85	■
1.6 i (LRA)	Gasolina	FWD	1597	77	105	09.83-12.85	■
1.6 XR3 Álcool	Etanol	FWD	1555	63	86	09.83-12.89	■

ESCORT III (GAA) 09.80-07.86

Hatchback (Compact car-C Segment)

1.6 (CHT 1600)	Gasolina	FWD	1555	48	65	05.83-07.86	■
1.6 (LP1)	Gasolina	FWD	1597	58	79	09.80-12.85	■
1.6 (LPA)	Gasolina	FWD	1597	58	79	09.80-12.85	■
1.6 i (GAA) (L4B)	Gasolina	FWD	1597	66	90	07.85-12.85	■
1.6 (LUA)	Gasolina	FWD	1597	71	97	09.80-10.82	■
1.6 XR3i (LR1)	Gasolina	FWD	1597	77	105	10.82-12.85	■
1.6 XR3i (LRA)	Gasolina	FWD	1597	77	105	10.82-12.85	■
1.6 XR3i	Gasolina	FWD	1597	81	110	09.81-02.86	■
RS 1600i (LUAE)	Gasolina	FWD	1597	85	115	05.82-12.85	■
1.6 RS Turbo (LNA)	Gasolina	FWD	1597	97	132	11.84-12.85	■

ESCORT IV (ALF) 01.86-11.92

Convertible (Compact car-C Segment)

1.4 (F6B)	Gasolina	FWD	1392	54	73	02.87-07.90	■
1.4 (F6D)	Gasolina	FWD	1392	54	73	02.87-07.90	■
1.4 (FUC)	Gasolina	FWD	1392	54	73	02.87-07.90	■
1.4 (FUA)	Gasolina	FWD	1392	55	75	01.86-07.90	■

LISTA DE APLICACIONES - BUYERS GUIDE

1.6 (LP2)		Gasolina	FWD	1597	58	79	01.86-12.87	■
1.6 (LPA)		Gasolina	FWD	1597	58	79	01.86-12.87	■
1.6 i (LJB)		Gasolina	FWD	1597	75	102	08.89-07.90	■
1.6 XR3i (LR2)		Gasolina	FWD	1597	77	105	01.86-07.90	■
1.6 XR3i (LRB)		Gasolina	FWD	1597	77	105	01.86-07.90	■
1.6 i (L4B)		Gasolina	FWD	1598	66	90	01.86-07.90	■
ESCORT IV (GAF, AWF, ABFT) 03.83-10.94					Hatchback (Compact car-C Segment)			
1.1 (GSG)		Gasolina	FWD	1117	37	50	12.85-07.90	■
1.3 (JPA)	vehicles with ABS	Gasolina	FWD	1296	51	69	11.86-07.88	■
1.3 (JBB)	vehicles with ABS	Gasolina	FWD	1297	44	60	01.86-07.90	■
1.3 (JLA)	vehicles with ABS	Gasolina	FWD	1297	44	60	01.86-07.90	■
1.3 (JLB)	vehicles with ABS	Gasolina	FWD	1297	44	60	01.86-07.90	■
1.3 (GAF) (JBA)	vehicles with ABS	Gasolina	FWD	1297	46	63	07.88-10.90	■
1.4 (FUAA)		Gasolina	FWD	1392	51	70	10.85-10.90	■
1.4 (F6B)		Gasolina	FWD	1392	54	73	01.86-07.90	■
1.4 (F6D)		Gasolina	FWD	1392	54	73	01.86-07.90	■
1.4 (FUC)		Gasolina	FWD	1392	54	73	01.86-07.90	■
1.4 (FUA)		Gasolina	FWD	1392	55	75	01.86-07.90	■
1.6		Gasolina	FWD	1555	56	77	01.90-10.94	■
1.6 (LP2)		Gasolina	FWD	1597	58	79	01.86-12.88	■
1.6 i (LJB)		Gasolina	FWD	1597	75	102	08.89-07.90	■
1.6 XR3i (LR2)		Gasolina	FWD	1597	77	105	01.86-08.89	■
1.6 XR3i (LRB)		Gasolina	FWD	1597	77	105	01.86-08.89	■
1.6 (LUG)		Gasolina	FWD	1598	65	88	04.89-07.90	■
1.6 i (L4B)		Gasolina	FWD	1598	66	90	01.86-05.90	■
1.6 Álcool		Etanol	FWD	1555	63	86	03.83-12.89	■
1.6 D (LTC)	vehicles with ABS	Diesel	FWD	1608	40	54	01.86-01.89	■
1.8 D (RTA)		Diesel	FWD	1753	44	60	01.89-07.90	■
1.8 D (RTB)		Diesel	FWD	1753	44	60	01.89-07.90	■
ESCORT IV / ESCORT '86 Express (AVF) 02.86-07.90					Estate Van (LCVs-N1 Segment)			
1.1 (GSG)		Gasolina	FWD	1117	37	50	05.86-07.90	■
1.3 (JBB)		Gasolina	FWD	1297	44	60	02.86-07.90	■
1.3 (JLA)		Gasolina	FWD	1297	44	60	02.86-07.90	■
1.3 (JLB)		Gasolina	FWD	1297	44	60	02.86-07.90	■
1.3 (JBA)		Gasolina	FWD	1297	46	63	07.88-07.90	■
1.4 i (F6B)		Gasolina	FWD	1392	54	73	02.86-07.90	■
1.4 i (F6D)		Gasolina	FWD	1392	54	73	02.86-07.90	■
1.4 i (FUC)		Gasolina	FWD	1392	54	73	02.86-07.90	■
1.6 (LUC)		Gasolina	FWD	1597	60	81	02.86-07.90	■
1.6 D (LTA)		Diesel	FWD	1608	40	54	02.86-07.90	■
ESCORT IV Turnier (AWF, AVF) 10.85-10.90					Estate (Compact car-C Segment)			
1.1 (GSG)		Gasolina	FWD	1117	37	50	10.85-09.90	■
1.3 (JPA)		Gasolina	FWD	1296	51	69	11.86-07.88	■
1.3 (JBB)		Gasolina	FWD	1297	44	60	01.86-07.90	■
1.3 (JLA)		Gasolina	FWD	1297	44	60	01.86-07.90	■
1.3 (JLB)		Gasolina	FWD	1297	44	60	01.86-07.90	■
1.4 (FUAA)		Gasolina	FWD	1392	51	70	10.85-10.90	■
1.4 (F6B)		Gasolina	FWD	1392	54	73	01.86-07.90	■
1.4 (F6D)		Gasolina	FWD	1392	54	73	01.86-07.90	■
1.4 (FUC)		Gasolina	FWD	1392	54	73	01.86-07.90	■

LISTA DE APLICACIONES - BUYERS GUIDE

1.4 (FUA)		Gasolina	FWD	1392	55	75	01.86-07.90	■
1.6 (LP2)		Gasolina	FWD	1597	58	79	01.86-07.90	■
1.6		Gasolina	FWD	1597	75	102	04.87-08.89	■
1.6		Gasolina	FWD	1597	77	105	04.87-08.89	■
1.6 i (L4B)		Gasolina	FWD	1598	66	90	01.86-07.90	■
1.6 D (LTC)		Diesel	FWD	1608	40	54	01.86-01.89	■
1.8 D (RTA)		Diesel	FWD	1753	44	60	01.89-07.90	■
1.8 D (RTB)		Diesel	FWD	1753	44	60	01.89-07.90	■
ESCORT V Turnier (ANL) 07.90-01.95					Estate (Compact car-C Segment)			
1.8 D (RTE)	-09/90	Diesel	FWD	1753	44	60	07.90-01.95	■
1.8 D (RTF)	-09/90	Diesel	FWD	1753	44	60	07.90-01.95	■
1.8 D (RTH)	-09/90	Diesel	FWD	1753	44	60	07.90-01.95	■
FIESTA II (FBD) 09.83-11.89					Hatchback (Supermini car-B Segment)			
1.6 XR2 (FBD) (LUD)		Gasolina	FWD	1597	70	95	03.84-02.89	■
1.6 XR2 (FBD) (LUB)		Gasolina	FWD	1597	71	97	04.84-02.89	■
ORION (AFD) 07.83-03.86					Saloon (Compact car-C Segment)			
1.6 (LP1)		Gasolina	FWD	1597	58	79	07.83-03.86	■
1.6 (LPA)		Gasolina	FWD	1597	58	79	07.83-03.86	■
1.6 i (LR1)		Gasolina	FWD	1597	77	105	07.83-03.86	■
1.6 i (LRA)		Gasolina	FWD	1597	77	105	07.83-03.86	■
ORION II (AFF) 12.85-07.90					Saloon (Compact car-C Segment)			
1.3 (JPA)		Gasolina	FWD	1296	51	69	11.86-07.88	■
1.3 (JBB)		Gasolina	FWD	1297	44	60	12.85-07.90	■
1.3 (JLA)		Gasolina	FWD	1297	44	60	12.85-07.90	■
1.3 (JLB)		Gasolina	FWD	1297	44	60	12.85-07.90	■
1.4 (FUAA)	vehicles with ABS	Gasolina	FWD	1392	52	72	03.86-07.90	■
1.4 (FUC)	vehicles with ABS	Gasolina	FWD	1392	54	73	01.86-07.90	■
1.4 Cat (F6B)	vehicles with ABS	Gasolina	FWD	1392	54	73	02.87-07.90	■
1.4 Cat (F6D)	vehicles with ABS	Gasolina	FWD	1392	54	73	02.87-07.90	■
1.4 (FUA)	vehicles with ABS	Gasolina	FWD	1392	55	75	12.85-07.90	■
1.6 (LUG)		Gasolina	FWD	1597	65	88	03.86-07.90	■
1.6 (LUC)		Gasolina	FWD	1597	66	90	12.85-07.90	■
1.6 i Cat (L4B)		Gasolina	FWD	1597	66	90	03.86-07.90	■
1.6 i (LJB)		Gasolina	FWD	1597	75	102	02.86-07.90	■
1.6 i (LRB)		Gasolina	FWD	1597	77	105	03.86-07.90	■
1.6 D (LTC)		Diesel	FWD	1608	40	54	12.85-01.89	■
1.8 D (RTA)		Diesel	FWD	1753	44	60	01.89-07.90	■
1.8 D (RTB)		Diesel	FWD	1753	44	60	01.89-07.90	■
P 100 04.82-09.87					Pickup (Pick-Up Truck)			
1.6 (LCR)		Gasolina	RWD	1593	54	73	04.82-09.87	■
SIERRA (GBC) 08.82-02.87					Hatchback (Large family car-D Segment)			
1.6 (LSDA)	01/87-	Gasolina	RWD	1597	51	69	10.82-02.87	■
1.6 (LSD)		Gasolina	RWD	1597	58	79	08.84-12.86	■
1.8 (REB)		Gasolina	RWD	1796	66	90	10.84-12.86	■
2.0 (NRD)		Gasolina	RWD	1993	74	100	10.85-12.86	■
2.0 (NET)		Gasolina	RWD	1993	77	105	08.82-12.86	■
2.0 i (NR2)		Gasolina	RWD	1993	85	115	03.85-12.86	■
2.0 i (NRB)		Gasolina	RWD	1993	85	115	03.85-12.86	■
2.0 (NYT)		Gasolina	RWD	1999	66	90	08.82-10.84	■

LISTA DE APLICACIONES - BUYERS GUIDE

2.3 (YYT)		Gasolina	RWD	2294	84	114	08.82-12.86	■
2.3 D (YTT)		Diesel	RWD	2304	49	67	08.82-12.86	■
SIERRA II 02.84-10.95					Hatchback (Large family car-D Segment)			
1.6 (LSF)	vehicles without ABS	Gasolina	RWD	1597	53	72	01.88-02.93	■
1.6		Gasolina	RWD	1597	55	75	01.87-02.93	■
1.6 (LSE)	vehicles without ABS	Gasolina	RWD	1597	55	75	01.87-02.93	■
1.6 i (L6B)	vehicles without ABS	Gasolina	RWD	1598	59	80	10.89-02.93	■
2.0 i (NE5)	vehicles without ABS	Gasolina	RWD	1993	74	100	01.87-02.93	■
2.0 i (NEJ)	vehicles without ABS	Gasolina	RWD	1993	74	100	01.87-02.93	■
2.0 i Cat (N4B)	vehicles without ABS	Gasolina	RWD	1993	74	100	01.87-02.93	■
2.0 (N8C)	vehicles without ABS	Gasolina	RWD	1993	77	105	01.87-02.93	■
2.0 (NES)	vehicles without ABS	Gasolina	RWD	1993	77	105	01.87-02.93	■
2.0 i (N4A)	vehicles without ABS	Gasolina	RWD	1993	85	115	01.87-02.93	■
2.0 i (N4I)	vehicles without ABS	Gasolina	RWD	1993	85	115	01.87-02.93	■
2.0 i (N8A)	vehicles without ABS	Gasolina	RWD	1998	80	109	06.89-02.93	■
2.0 i DOHC (N9E)	vehicles without ABS	Gasolina	RWD	1998	85	115	12.91-02.93	■
2.0 4x4 (N9C)	vehicles without ABS	Gasolina	4WD	1998	88	120	10.91-03.93	■
2.0 i (N9C)	vehicles without ABS	Gasolina	RWD	1998	88	120	06.89-02.93	■
2.0 i (N9B)	vehicles without ABS	Gasolina	RWD	1998	92	125	06.89-02.93	■
1.8 TD (RFA)	vehicles without ABS	Diesel	RWD	1753	55	75	08.88-02.93	■
1.8 TD (RFB)	vehicles without ABS	Diesel	RWD	1753	55	75	08.88-02.93	■
1.8 TD (RFL)	vehicles without ABS	Diesel	RWD	1753	55	75	08.88-02.93	■
2.3 D (YTR)		Diesel	RWD	2304	49	67	01.87-09.89	■
SIERRA II (GBG, GB4) 01.87-02.93					Saloon (Large family car-D Segment)			
1.6 (LSF)	vehicles without ABS	Gasolina	RWD	1597	53	72	01.88-02.93	■
1.6 (LSE)	vehicles without ABS	Gasolina	RWD	1597	55	75	01.87-02.93	■
1.6 i (L6B)	vehicles without ABS	Gasolina	RWD	1597	59	80	10.89-02.93	■
1.8 (R2C)	vehicles without ABS	Gasolina	RWD	1769	64	87	05.88-02.93	■
1.8 (R6A)	vehicles without ABS	Gasolina	RWD	1769	64	87	05.88-02.93	■
1.8 (RED)	vehicles without ABS	Gasolina	RWD	1796	59	80	10.87-09.89	■
1.8 (REF)	vehicles without ABS	Gasolina	RWD	1796	59	80	10.87-09.89	■
1.8 (R2A)	vehicles without ABS	Gasolina	RWD	1796	66	90	01.87-05.88	■
1.8 (RED)	vehicles without ABS	Gasolina	RWD	1796	66	90	01.87-05.88	■
2.0 i (NE5)	vehicles without ABS	Gasolina	RWD	1993	74	100	01.87-12.89	■
2.0 i (NEJ)	vehicles without ABS	Gasolina	RWD	1993	74	100	01.87-12.89	■
2.0 i Cat (N4B)	vehicles without ABS	Gasolina	RWD	1993	74	100	01.87-02.93	■
2.0 (N8C)	vehicles without ABS	Gasolina	RWD	1993	77	105	01.87-02.93	■
2.0 (NES)	vehicles without ABS	Gasolina	RWD	1993	77	105	01.87-02.93	■
2.0 i (N4A)	vehicles without ABS	Gasolina	RWD	1993	85	115	01.87-02.93	■
2.0 i (N4I)	vehicles without ABS	Gasolina	RWD	1993	85	115	01.87-02.93	■
2.0 (N8A)		Gasolina	RWD	1998	80	109	07.89-12.92	■
2.0 i DOHC (N9E)	vehicles without ABS	Gasolina	RWD	1998	85	115	12.91-02.93	■
2.0 4x4 (N9C)	vehicles without ABS	Gasolina	4WD	1998	88	120	01.90-02.93	■
2.0 i (N9C)	vehicles without ABS	Gasolina	RWD	1998	88	120	01.90-02.93	■
2.0 i (N9A)		Gasolina	RWD	1998	90	122	01.90-02.93	■
2.0 4x4 (N9C)	vehicles without ABS	Gasolina	4WD	1998	92	125	01.90-02.93	■
2.0 i (N9C)	vehicles without ABS	Gasolina	RWD	1998	92	125	01.90-02.93	■
1.8 TD (RFA)	vehicles without ABS	Diesel	RWD	1753	55	75	08.88-02.93	■
1.8 TD (RFB)	vehicles without ABS	Diesel	RWD	1753	55	75	08.88-02.93	■
1.8 TD (RFL)	vehicles without ABS	Diesel	RWD	1753	55	75	08.88-02.93	■

LISTA DE APLICACIONES - BUYERS GUIDE

2.3 D (YTR)		Diesel	RWD	2304	49	67	01.87-09.89	■
2.3 D (YTT)		Diesel	RWD	2304	49	67	01.87-09.89	■
SIERRA II Turnier (BNG) 01.87-02.93					Estate (Large family car-D Segment)			
1.6 (LSF)	vehicles without ABS	Gasolina	RWD	1597	53	72	01.88-02.93	■
1.6 (LSE)	vehicles without ABS	Gasolina	RWD	1597	55	75	01.87-02.93	■
1.6 i (L6B)	vehicles without ABS	Gasolina	RWD	1598	59	80	10.89-02.93	■
1.8 (R2C)	vehicles without ABS	Gasolina	RWD	1769	64	87	05.88-02.93	■
1.8 (R6A)	vehicles without ABS	Gasolina	RWD	1769	64	87	05.88-02.93	■
1.8 (RED)	vehicles without ABS	Gasolina	RWD	1796	59	80	10.87-05.88	■
1.8 (REF)	vehicles without ABS	Gasolina	RWD	1796	59	80	10.87-05.88	■
1.8 (R2A)	vehicles without ABS	Gasolina	RWD	1796	66	90	01.87-05.88	■
1.8 (RED)	vehicles without ABS	Gasolina	RWD	1796	66	90	01.87-05.88	■
2.0 i (NE5)	vehicles without ABS	Gasolina	RWD	1993	74	100	01.87-02.93	■
2.0 i (NEJ)	vehicles without ABS	Gasolina	RWD	1993	74	100	01.87-02.93	■
2.0 i Cat (N4B)	vehicles without ABS	Gasolina	RWD	1993	74	100	01.87-02.93	■
2.0 (N8C)	vehicles without ABS	Gasolina	RWD	1993	77	105	01.87-02.93	■
2.0 (NES)	vehicles without ABS	Gasolina	RWD	1993	77	105	01.87-02.93	■
2.0 i (N4A)	vehicles without ABS	Gasolina	RWD	1993	85	115	01.87-02.93	■
2.0 i (N4I)	vehicles without ABS	Gasolina	RWD	1993	85	115	01.87-02.93	■
1.9 (N8A)	vehicles without ABS	Gasolina	RWD	1998	80	108	10.88-09.91	■
2.0 i DOHC (N9E)	vehicles without ABS	Gasolina	RWD	1998	85	115	12.91-02.93	■
2.0 4x4 (N9C)	vehicles without ABS	Gasolina	4WD	1998	88	120	02.90-02.93	■
2.0 i (N9C)	vehicles without ABS	Gasolina	RWD	1998	88	120	05.89-02.93	■
2.0 4x4 (N9C)	vehicles without ABS	Gasolina	4WD	1998	92	125	05.89-02.93	■
2.0 i (N9C)	vehicles without ABS	Gasolina	RWD	1998	92	125	05.89-02.93	■
1.8 TD (RFA)	vehicles without ABS	Diesel	RWD	1753	55	75	08.88-02.93	■
1.8 TD (RFB)	vehicles without ABS	Diesel	RWD	1753	55	75	08.88-02.93	■
1.8 TD (RFL)	vehicles without ABS	Diesel	RWD	1753	55	75	08.88-02.93	■
2.3 D (YTR)		Diesel	RWD	2304	49	67	01.87-02.93	■
SIERRA Turnier (BNC) 08.82-12.86					Estate (Large family car-D Segment)			
1.6 (LCS)		Gasolina	RWD	1593	55	75	08.82-12.86	■
1.6 (LCT)		Gasolina	RWD	1593	55	75	08.82-12.86	■
1.6 (LSD)		Gasolina	RWD	1593	55	75	08.82-12.86	■
1.8 (REB)		Gasolina	RWD	1796	66	90	10.84-12.86	■
2.0 (NRD)		Gasolina	RWD	1993	74	100	10.85-12.86	■
2.0 (NET)		Gasolina	RWD	1993	77	105	08.82-12.86	■
2.0 (NR2)		Gasolina	RWD	1993	85	115	03.85-12.86	■
2.0 (NRB)		Gasolina	RWD	1993	85	115	03.85-12.86	■
2.0 (NYT)		Gasolina	RWD	1999	66	90	08.82-10.84	■
2.3 (YYT)		Gasolina	RWD	2294	84	114	08.82-12.86	■
2.3 D (YTT)		Diesel	RWD	2304	49	67	08.82-12.86	■
PANTHER								
KALLISTA 01.82-09.93					Convertible (Sports car-S Segment)			
1.6	10/87-	Gasolina	RWD	1598	71	96	01.82-12.92	■
TVR								
CHIMAERA 11.92-10.03					Convertible (Sports car-S Segment)			
3.9 (39SE)		Gasolina	RWD	3947	177	241	01.93-10.03	■