

LISTA DE APLICACIONES - BUYERS GUIDE

78BD5115-1



Weight: 6.794

O.E.M.	MAKE
05015965AA	JEEP
052005000	JEEP
052007710	JEEP
052008264	JEEP
052008440	JEEP
5015965AA	JEEP
5200500	JEEP
52007710	JEEP
52008264	JEEP
52008440	JEEP

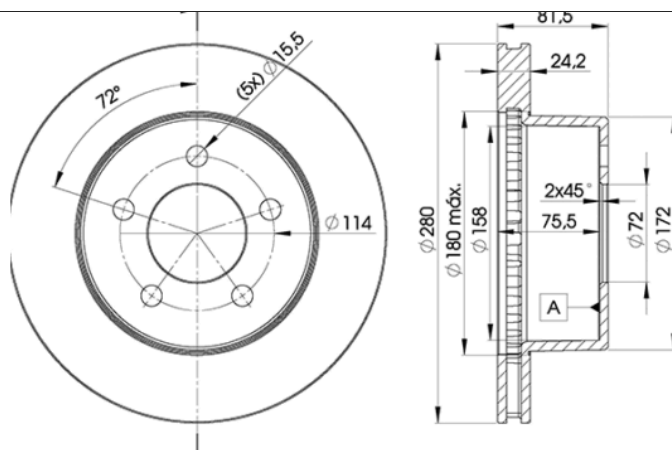

78BD5115-1

E1 90R-02C0452/0118



Ø280x24x81.5

MAKE

JEEP



Trac.	CC	Kw	CV
-------	----	----	----



Front / Rear

JEEP

CHEROKEE II / WAGONEER (XJ) 09.83-09.01

Closed Off-Road Vehicle (Compact SUV-J Segment)

2.5 4x4 (EPE)		Gasolina	4WD	2464	87	118	10.84-09.86	■
2.5 i 4x4 (EPE)	-12/98	Gasolina	4WD	2464	87	118	10.84-09.01	■
2.5 SE (EPE)	-12/98	Gasolina	RWD	2464	87	118	10.96-09.99	■
2.5 (EPE)	01/95-	Gasolina	RWD	2464	89	121	10.90-09.96	■
2.5 4x4 (EPE)		Gasolina	4WD	2464	89	121	10.90-09.96	■
2.5 (EPE)		Gasolina	RWD	2464	90	122	10.86-09.90	■
2.5 4x4 (EPE)		Gasolina	4WD	2464	90	122	10.86-09.90	■
2.5 (EPE)	-12/98	Gasolina	4WD	2469	89	121	10.95-09.01	■
2.5 i 4x4 (EPE)	01/95-, -12/98	Gasolina	4WD	2469	90	122	12.91-09.01	■
2.5 i 4x4 (HX)	01/95-, -12/98	Gasolina	4WD	2469	90	122	12.91-09.01	■
4.0 (M400L)		Gasolina	RWD	3956	131	178	10.86-09.90	■
4.0 4x4 (M400L)	01/90-	Gasolina	4WD	3956	131	178	10.86-09.90	■
4.0 i (ERH)	-12/98	Gasolina	4WD	3960	127	173	07.98-09.01	■
4.0 i (MX)		Gasolina	4WD	3960	135	184	02.99-09.01	■
4.0 i 4x4 (ERH)	-12/98	Gasolina	4WD	3964	131	178	01.95-09.01	■
4.0 i (MX)	01/95-, -12/98	Gasolina	4WD	3964	135	184	12.91-09.01	■
4.0 i (ERH)	01/95-, -12/98	Gasolina	4WD	3964	136	185	01.88-09.01	■
2.1 D 4x4 (J8S 742)	01/87-, -12/89	Diesel	4WD	2068	59	80	10.86-09.92	■
2.1 TD (J8S)		Diesel	RWD	2068	59	80	06.89-03.92	■
2.1 TD (J8S)	01/95-, -12/98	Diesel	4WD	2068	64	87	10.84-09.01	■
2.5 TDI 4x4 (ENC)	-12/98	Diesel	4WD	2498	85	116	10.96-09.01	■
2.5 TD 4x4 (ENC)	01/95-, -12/98	Diesel	4WD	2499	85	116	01.88-09.01	■

LISTA DE APLICACIONES - BUYERS GUIDE

COMANCHE (MJ) 09.85-09.96					Pickup (Pick-Up Truck)			
2.5 (EPE)		Gasolina	RWD	2464	90	122	10.86-09.90	■
2.5 4x4 (EPE)		Gasolina	4WD	2464	90	122	10.86-09.90	■
4.0		Gasolina	RWD	3964	127	173	10.90-09.96	■
4.0 (ERH)		Gasolina	RWD	3964	130	178	10.90-09.96	■
4.0 4x4 (ERH)	10/90-	Gasolina	4WD	3964	130	178	10.87-09.96	■
2.1 D (J8S-814)		Diesel	RWD	2068	63	86	10.86-09.90	■
2.1 D 4x4 (J8S-814)		Diesel	4WD	2068	63	86	01.86-09.90	■
GRAND CHEROKEE (ZJ, ZG) 09.91-04.99					Closed Off-Road Vehicle (Luxury Crossover SUV-J Segment)			
4.0 i 4x4 (Z) (S01)	-12/98	Gasolina	4WD	3960	130	177	10.95-04.99	■
4.0 Laredo (ERH)		Gasolina	RWD	3964	131	178	10.96-09.98	■
4.0 i 4x4 (ZJ) (ERH)	01/93-, -12/98	Gasolina	4WD	3964	132	180	06.92-04.99	■
4.0 i 4x4 (ZJ) (MX)	01/93-, -12/98	Gasolina	4WD	3964	135	184	09.91-04.99	■
5.2 Limited 4x4 (ELF)		Gasolina	4WD	5210	136	185	10.96-09.98	■
5.2 i 4x4 (ZJ) (ELF)	01/93-, -12/93	Gasolina	4WD	5210	155	211	01.92-04.99	■
5.2 i 4x4 (ZJ) (Y)	01/93-, -12/93	Gasolina	4WD	5210	158	215	09.92-09.98	■
5.2 (ELF)		Gasolina	RWD	5210	164	223	10.96-09.98	■
5.2 4x4 (ELF)		Gasolina	4WD	5210	164	223	10.96-09.98	■
5.2 4x4 (Z) (Y01)		Gasolina	4WD	5216	156	212	10.95-04.99	■
5.9 i 4x4 (EML)		Gasolina	4WD	5889	177	241	08.97-04.99	■
2.5 TD Laredo (ENC)		Diesel	RWD	2498	85	115	10.96-09.98	■
2.5 TD 4x4 (Z) (ENC)		Diesel	4WD	2499	85	115	10.95-04.99	■
WRANGLER (YJ, SJ_) 08.86-08.96					Open Off-Road Vehicle (Mini SUV-J Segment)			
2.5	01/90-	Gasolina	4WD	2464	76	103	01.88-12.91	■
2.5 (EPE)		Gasolina	4WD	2464	89	121	12.91-08.96	■
4.0 2WD (M400L)		Gasolina	RWD	3956	131	178	10.86-09.90	■
4.0 4x4 (M400L)		Gasolina	4WD	3956	131	178	10.86-09.90	■
4.0 (ERH)		Gasolina	4WD	3964	131	178	12.91-08.96	■
4.2 2WD		Gasolina	RWD	4229	82	111	10.86-09.90	■
4.2 (6L <C 2V>)		Gasolina	4WD	4235	84	114	08.86-08.89	■
WRANGLER II (TJ) 08.96-12.08					Open Off-Road Vehicle (Mini SUV-J Segment)			
2.4 (ED1)		Gasolina	4WD	2429	105	143	11.02-04.07	■
2.5 (P00)	-12/98	Gasolina	4WD	2464	87	118	08.96-04.07	■
3.8		Gasolina	FWD	3778	153	208	02.06-12.08	■
4.0 (ERH)		Gasolina	4WD	3964	130	177	08.96-04.07	■