

LISTA DE APLICACIONES - BUYERS GUIDE

78BD5118-2



8 424073 193483

Weight: 11.590

| O.E.M. | MAKE |
|----------|------|
| 52098666 | JEEP |

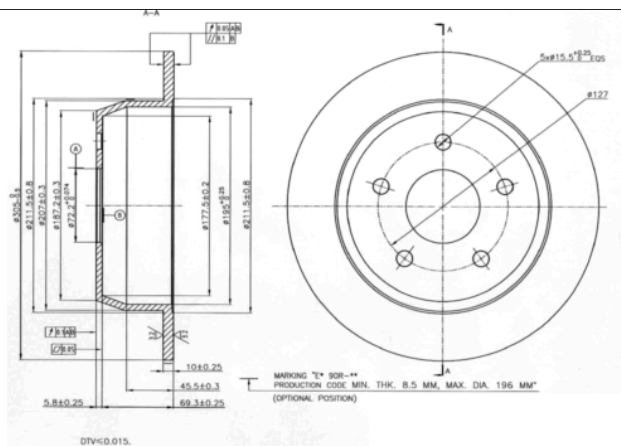

78BD5118-2



Ø305x10x75.1

| MAKE |
|---------------------|
| BEIJING BENZ (BBDC) |
| JEEP |
| JEEP (BJC) |



| Trac. | CC | Kw | CV | | |
|-------|----|----|----|--|--------------|
| | | | | | |
| | | | | | Front / Rear |

BEIJING BENZ (BBDC)

| JEEP 4700 10.03- | | | | | Hatchback (Compact SUV-J Segment) | | | |
|------------------|----------|-----|------|-----|-----------------------------------|--------|---|--|
| 4.7 | Gasolina | FWD | 4701 | 175 | 238 | 10.03- | ■ | |

JEEP

| CHEROKEE II / WAGONEER (XJ) 09.83-09.01 | | | | | Closed Off-Road Vehicle (Compact SUV-J Segment) | | | |
|---|--|----------|-----|------|---|-----|-------------|---|
| 2.5 (EPE) | | Gasolina | 4WD | 2469 | 89 | 121 | 10.95-09.01 | ■ |
| 4.0 i (ERH) | | Gasolina | 4WD | 3960 | 127 | 173 | 07.98-09.01 | ■ |
| 4.0 i (MX) | | Gasolina | 4WD | 3960 | 135 | 184 | 02.99-09.01 | ■ |
| 4.0 i (ERH) | | Gasolina | 4WD | 3964 | 125 | 170 | 10.90-09.01 | ■ |
| 4.0 i 4x4 (ERH) | | Gasolina | 4WD | 3964 | 131 | 178 | 01.95-09.01 | ■ |
| 4.0 i (MX) | | Gasolina | 4WD | 3964 | 135 | 184 | 12.91-09.01 | ■ |
| 4.0 i (ERH) | | Gasolina | 4WD | 3964 | 136 | 185 | 01.88-09.01 | ■ |
| 2.5 TDI 4x4 (ENC) | | Diesel | 4WD | 2498 | 85 | 116 | 10.96-09.01 | ■ |
| 2.5 TD 4x4 (ENC) | | Diesel | 4WD | 2499 | 85 | 116 | 01.88-09.01 | ■ |

| GRAND CHEROKEE (ZJ, ZG) 09.91-04.99 | | | | | Closed Off-Road Vehicle (Luxury Crossover SUV-J Segment) | | | |
|-------------------------------------|----------|-----|------|-----|--|-------------|---|--|
| 4.0 i 4x4 (Z) (S01) | Gasolina | 4WD | 3960 | 130 | 177 | 10.95-04.99 | ■ | |
| 4.0 i 4x4 (ZJ) (ERH) | Gasolina | 4WD | 3964 | 132 | 180 | 06.92-04.99 | ■ | |
| 4.0 i 4x4 (ZJ) (MX) | Gasolina | 4WD | 3964 | 135 | 184 | 09.91-04.99 | ■ | |

| GRAND CHEROKEE II (WJ, WG) 09.98-09.05 | | | | | Closed Off-Road Vehicle (Luxury Crossover SUV-J Segment) | | | |
|--|--|----------|-----|------|--|-----|-------------|---|
| 4.0 4x4 (ERH) | | Gasolina | 4WD | 3960 | 140 | 190 | 04.99-09.05 | ■ |
| 4.0 (ERH) | | Gasolina | RWD | 3964 | 140 | 190 | 10.98-09.04 | ■ |
| 4.7 V8 4x4 (EVA) | | Gasolina | 4WD | 4701 | 162 | 220 | 04.99-08.00 | ■ |
| 4.7 V8 4x4 (EVA) | | Gasolina | 4WD | 4701 | 164 | 223 | 04.99-09.05 | ■ |

LISTA DE APLICACIONES - BUYERS GUIDE

| | | | | | | | |
|-----------------------------------|----------|-----|------|-----|--|-------------|---|
| 4.7 V8 4x4 (EVA) | Gasolina | 4WD | 4701 | 167 | 227 | 06.03-09.05 | ■ |
| 4.7 4x4 | Gasolina | 4WD | 4701 | 172 | 233 | 09.98-08.04 | ■ |
| 4.7 V8 4x4 (EVC) | Gasolina | 4WD | 4701 | 190 | 258 | 10.01-09.05 | ■ |
| 2.7 CRD 4x4 (ENF) | Diesel | 4WD | 2685 | 120 | 163 | 10.01-09.05 | ■ |
| 2.7 CRD 4x4 | Diesel | 4WD | 2688 | 120 | 163 | 10.04-09.05 | ■ |
| 3.1 TD 4x4 (EXA) | Diesel | 4WD | 3125 | 103 | 140 | 04.99-12.01 | ■ |
| JEEP (BJC) | | | | | | | |
| GRAND CHEROKEE 02.99-07.05 | | | | | Hatchback (Compact SUV-J Segment) | | |
| 4.7 | Gasolina | FWD | 4701 | 175 | 238 | 02.99-08.01 | ■ |