

LISTA DE APLICACIONES - BUYERS GUIDE

78BD5170-2



Weight: 15.140

O.E.M.	MAKE
4721933AA	DODGE
4721933AB	DODGE
4721995AA	CHRYSLER

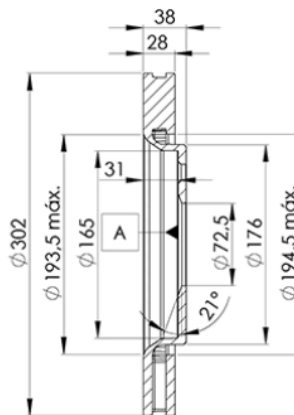
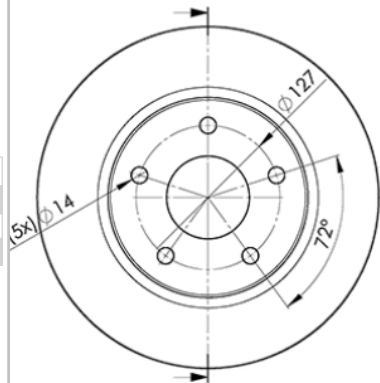

78BD5170-2

E1 90R-02C0289/1298



Ø302x28x39

MAKE
CHRYSLER
DODGE
FIAT
VW



Trac.	CC	Kw	CV
-------	----	----	----



Front / Rear

CHRYSLER

GRAND VOYAGER V / TOWN & COUNTRY V (RT) 01.08-12.11					Box Body/MPV (Large MPV-M1 Segment)			
3.8		Gasolina	FWD	3778	142	193	01.08-12.11	■
2.8 CRDI		Diesel	FWD	2777	120	163	01.08-12.11	■
GRAND VOYAGER V / TOWN & COUNTRY V (RT) 10.07-					MPV (Large MPV-M1 Segment)			
3.3 (EGV)	vehicles without ABS	Gasolina	FWD	3301	125	170	01.08-	■
3.8 (EGL)	vehicles without ABS	Gasolina	FWD	3778	142	193	10.07-	■
3.8 (EGL)		Gasolina	FWD	3778	147	200	09.08-	■
3.8 (EGL)		Gasolina	FWD	3778	148	201	10.07-	■
4.0 (EMM)		Gasolina	FWD	3952	179	243	10.07-	■
4.0 (EGQ)		Gasolina	FWD	3952	187	254	10.07-	■
3.6 Flexfuel (ERB)		Gasol./Etanol	FWD	3604	211	287	02.11-	■
2.8 CRD		Diesel	FWD	2777	120	163	10.07-	■
2.8 CRD (ENS)	vehicles without ABS	Diesel	FWD	2777	120	163	10.07-	■

DODGE

CARAVAN IV (RG_) 02.00-12.07					MPV (Large MPV-M1 Segment)			
3.3 (EGM)		Gasolina	FWD	3301	132	179	04.01-05.07	■
GRAND CARAVAN V 06.07-					MPV (Large MPV-M1 Segment)			
3.3 (EGM)		Gasolina	FWD	3301	127	173	06.07-	■
3.3 (EGV)		Gasolina	FWD	3301	131	178	06.07-12.08	■
3.6 (ERB)		Gasolina	FWD	3604	211	287	09.10-	■
3.8 (EGL)		Gasolina	FWD	3778	142	193	06.07-12.10	■
3.8 (EGH)		Gasolina	FWD	3778	148	201	06.07-12.10	■

LISTA DE APLICACIONES - BUYERS GUIDE

4.0 (EMM)		Gasolina	FWD	3952	173	235	06.07-	■
4.0 (EGQ)		Gasolina	FWD	3952	189	257	06.07-12.10	■
3.6 Flexfuel (ERB)		Gasol./Etanol	FWD	3604	211	287	09.11-	■
JOURNEY / JC 06.08-					MPV (Large MPV-M1 Segment)			
2.4 (ED3)		Gasolina	FWD	2360	125	170	01.09-	■
2.4 (EDG)		Gasolina	FWD	2360	125	170	01.09-	■
2.4 (ED3)		Gasolina	FWD	2360	127	173	06.12-	■
2.4 (ED3)		Gasolina	FWD	2360	129	175	09.08-	■
2.4 (EDG)		Gasolina	FWD	2360	129	175	09.08-	■
3.5 (EGF)		Gasolina	FWD	3518	173	235	06.08-12.10	■
3.5 AWD (EGF)		Gasolina	4WD	3518	173	235	06.08-12.10	■
3.6 AWD (ERB)		Gasolina	4WD	3604	206	280	05.13-	■
3.6 (ERB)		Gasolina	FWD	3605	206	280	06.12-12.15	■
3.6 (ERB)		Gasolina	FWD	3605	211	287	01.12-	■
2.4 ECO+ (EDG)		Gasol./Gas (LPG)	FWD	2360	125	170	06.08-	■
2.7 Flexfuel (EER)		Gasol./Etanol	FWD	2736	136	185	01.09-12.11	■
3.6 Flexfuel AWD (ERB)		Gasol./Etanol	4WD	3604	211	287	09.10-	■
2.0 CRD (ECE)		Diesel	FWD	1968	100	136	06.08-12.11	■
2.0 CRD (ECE)		Diesel	FWD	1968	103	140	06.08-	■
JOURNEY VAN (JC) 06.08-					Box Body/MPV (LCVs-N1 Segment)			
2.4 VVT		Gasolina	FWD	2360	125	170	01.09-12.12	■
2.7 Flexfuel		Gasol./Etanol	FWD	2736	136	185	01.09-12.11	■
3.6 FlexFuel A las 4 ruedas		Gasol./Etanol	4WD	3604	211	287	01.11-	■
2.0 CRD		Diesel	FWD	1968	103	140	06.08-12.11	■
FIAT								
FREEMONT (345_) 08.11-					MPV (Executive SUV-J Segment)			
3.6 (ERB)		Gasolina	FWD	3604	206	280	08.11-12.16	■
VW								
ROUTAN 09.08-12.13					MPV (Large MPV-M1 Segment)			
3.8 (CGUA)		Gasolina	FWD	3778	147	200	09.08-11.10	■
4.0 (CGVA)		Gasolina	FWD	3952	187	254	09.08-11.10	■