

LISTA DE APLICACIONES - BUYERS GUIDE

78BD5252-2



Weight: 7.924

O.E.M.	MAKE
42510-SEA-E00	HONDA
42510-SEA-E50	HONDA

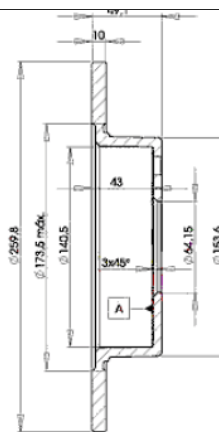
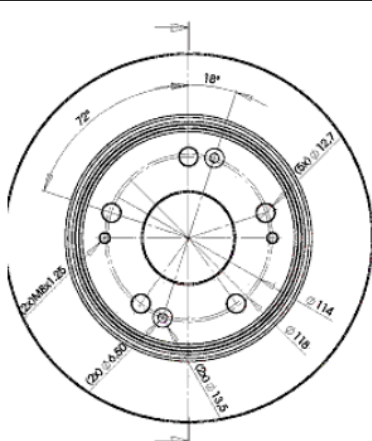

78BD5252-2

E1 90R-02C0415/0005



Ø260x10x49.2

MAKE
HONDA



Trac.	CC	Kw	CV
-------	----	----	----



Front / Rear

HONDA

ACCORD VII (CM, UC) 09.02-05.08

Saloon (Executive car-E Segment)

2.4 Vtec E (CM5) (K24A2)	Gasolina	FWD	2354	118	160	09.02-12.05	■
2.4 Vtec E (CM5) (K24A4)	Gasolina	FWD	2354	118	160	09.02-12.05	■

ACCORD VII / ACCOR EURO (CL, CN) 01.03-09.12

Saloon (Executive car-E Segment)

2.0	Gasolina	FWD	1998	110	150	01.06-03.08	■
2.0 (CL7) (K20A6)	Gasolina	FWD	1998	114	155	02.03-05.08	■
2.0 A las 4 ruedas (CL8) (K20A6)	Gasolina	4WD	1998	114	155	02.03-05.08	■
2.4 (CL9) (K24A8)	Gasolina	FWD	2354	113	154	09.06-05.08	■
2.4 i 16V	Gasolina	FWD	2354	115	156	02.03-05.08	■
2.4 Vtec	Gasolina	FWD	2354	122	166	04.06-07.08	■
2.4 (K24A)	Gasolina	FWD	2354	132	180	01.08-09.12	■
2.4 (CL9) (K24A)	Gasolina	FWD	2354	140	190	02.03-05.08	■
2.4 (CL9) (K24A3)	Gasolina	FWD	2354	140	190	02.03-05.08	■
3.0 (J30A5)	Gasolina	FWD	2997	182	247	04.06-05.08	■
2.2 i-CTDi (CN1) (N22A1)	Diesel	FWD	2204	103	140	01.04-05.08	■

ACCORD VII Tourer (CM, CN) 11.02-05.08

Estate (Compact executive car-D Segment)

2.0 (CM1) (K20A6)	Gasolina	FWD	1998	114	155	04.03-05.08	■
2.4 Vtec E	Gasolina	FWD	2354	118	160	09.03-09.05	■
2.4 (CM2) (K24A3)	Gasolina	FWD	2354	140	190	04.03-05.08	■
2.4 Vtec T (CM2) (K24A1)	Gasolina	FWD	2354	147	200	09.03-05.08	■
2.2 i-CTDi (CN2) (N22A1)	Diesel	FWD	2204	103	140	01.04-05.08	■