

LISTA DE APLICACIONES - BUYERS GUIDE

78BD5308-2



Weight: 7.328

O.E.M.	MAKE
6Q0 615 301	VW
6Q0 615 301 A	VW

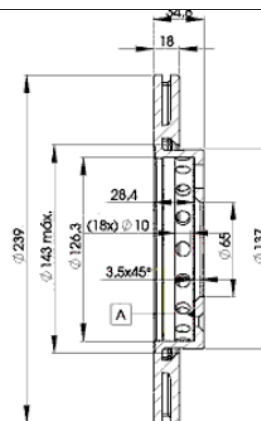
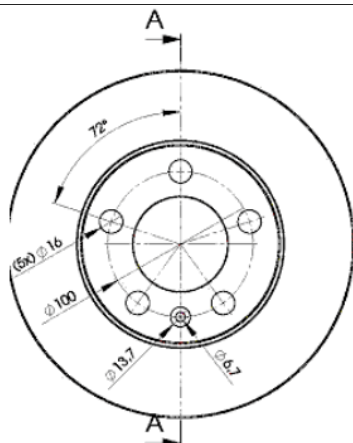

78BD5308-2



Ø239x18x35

MAKE
SKODA
SKODA (SVW)
VW



Trac.	CC	Kw	CV
-------	----	----	----



Front / Rear

SKODA

FABIA (6Y5) 01.00-12.07

						Estate Van (Compact car-C Segment)		
1.2 (AWY)		Gasolina	FWD	1198	40	54	07.01-12.07	■
1.2 (BMD)		Gasolina	FWD	1198	40	54	07.01-12.07	■
1.4 (BKY)		Gasolina	FWD	1390	55	75	05.04-12.07	■
1.4 (AZE)		Gasolina	FWD	1397	44	60	04.00-03.03	■
1.4 (AZF)		Gasolina	FWD	1397	44	60	04.00-03.03	■
1.4 TDI (AMF)		Diesel	FWD	1422	55	75	08.04-10.05	■

FABIA (6Y2) 08.99-03.08

						Hatchback (Compact car-C Segment)		
1.0 (AQV)		Gasolina	FWD	996	37	50	12.99-08.02	■
1.0 (ARV)		Gasolina	FWD	996	37	50	12.99-08.02	■
1.2 (AWY)		Gasolina	FWD	1198	40	54	07.01-04.07	■
1.2 (BMD)		Gasolina	FWD	1198	40	54	07.01-04.07	■
1.4		Gasolina	FWD	1390	59	80	02.06-10.06	■

FABIA (6Y3) 10.99-12.07

						Saloon (Compact car-C Segment)		
1.0		Gasolina	FWD	996	37	50	11.00-08.02	■
1.2 (AWY)		Gasolina	FWD	1198	40	54	07.01-12.07	■
1.2 (BMD)		Gasolina	FWD	1198	40	54	07.01-12.07	■

FABIA II (542) 12.06-12.14

						Hatchback (Compact car-C Segment)		
1.2 (BBM)		Gasolina	FWD	1198	44	60	12.06-12.14	■
1.2 (CHFA)		Gasolina	FWD	1198	44	60	12.06-12.14	■
1.4 (BXW)		Gasolina	FWD	1390	63	86	01.07-12.14	■
1.4 (CGGB)		Gasolina	FWD	1390	63	86	01.07-12.14	■

LISTA DE APLICACIONES - BUYERS GUIDE

FABIA II Combi (545) 10.07-12.14					Estate (Compact car-C Segment)			
1.2 (BBM)		Gasolina	FWD	1198	44	60	10.07-11.14	■
1.2 (CHFA)		Gasolina	FWD	1198	44	60	10.07-11.14	■
1.2 (BZG)		Gasolina	FWD	1198	51	70	10.07-12.14	■
1.2 (CEVA)		Gasolina	FWD	1198	51	70	10.07-12.14	■
1.2 (CGPA)		Gasolina	FWD	1198	51	70	10.07-12.14	■
1.2 (CHTA)		Gasolina	FWD	1198	51	70	10.07-12.14	■
1.4 (BXW)	PR 1LB, PR 1LM	Gasolina	FWD	1390	63	86	10.07-12.14	■
1.4 (CGGB)	PR 1LB, PR 1LM	Gasolina	FWD	1390	63	86	10.07-12.14	■
1.6 (BTS)		Gasolina	FWD	1598	77	105	10.07-12.14	■
1.6 (CFNA)		Gasolina	FWD	1598	77	105	10.07-12.14	■
1.4 TDI (BNM)		Diesel	FWD	1422	51	70	10.07-03.10	■
1.4 TDI (BMS)		Diesel	FWD	1422	59	80	10.07-03.10	■
1.4 TDI (BNV)		Diesel	FWD	1422	59	80	10.07-03.10	■
1.9 TDI (BLS)		Diesel	FWD	1896	77	105	10.07-03.10	■
1.9 TDI (BSW)		Diesel	FWD	1896	77	105	10.07-03.10	■
SKODA (SVW)								
FABIA (551) 12.08-12.15					Hatchback (Compact car-C Segment)			
1.4		Gasolina	FWD	1390	63	86	12.08-12.15	■
VW								
FOX II (5Z1) 09.10-12.11					Hatchback Van (City car-A Segment)			
1.2 (CHFA)		Gasolina	FWD	1198	44	60	09.10-12.11	■
FOX II (5Z1, 5Z3, 5Z4) 08.03-					Hatchback (City car-A Segment)			
1.0		Gasolina	FWD	999	53	72	08.03-12.09	■
1.0		Gasolina	FWD	999	54	73	04.08-12.09	■
1.2 (BMD)		Gasolina	FWD	1198	40	55	04.05-07.11	■
1.2 (CHFB)		Gasolina	FWD	1198	40	55	04.05-07.11	■
1.2 (CHFA)		Gasolina	FWD	1198	44	60	09.10-12.11	■
1.6 (BAH)		Gasolina	FWD	1598	74	101	10.03-08.14	■
1.6 (BJA)		Gasolina	FWD	1598	74	101	10.03-08.14	■
1.6 (BLH)		Gasolina	FWD	1598	74	101	10.03-08.14	■
1.6 (BPA)		Gasolina	FWD	1598	74	101	10.03-08.14	■
1.6 (CFZA)		Gasolina	FWD	1598	74	101	10.03-08.14	■
1.0 TotalFlex		Gasol./Etanol	FWD	999	53	72	08.03-12.09	■
1.0 City Total Flex		Gasol./Etanol	FWD	999	54	73	05.05-10.14	■
1.0 TotalFlex		Gasol./Etanol	FWD	999	56	76	05.05-08.14	■
1.0 Bluemotion Total Flex		Gasol./Etanol	FWD	999	60	82	07.13-08.14	■
1.6 TotalFlex (BPA)		Gasol./Etanol	FWD	1598	73	98	09.07-12.09	■
1.6 Plus Total Flex (BJA)		Gasol./Etanol	FWD	1598	77	105	10.03-12.09	■
1.6 Plus Total Flex (BPA)		Gasol./Etanol	FWD	1598	77	105	10.03-12.09	■
1.6 Rock in Rio Plus Total Flex		Gasol./Etanol	FWD	1598	77	105	05.08-10.14	■
POLO III PLAYA / IBIZA 01.95-11.09					Hatchback (Supermini car-B Segment)			
1.6		Gasolina	FWD	1598	74	101	01.95-11.09	■

LISTA DE APLICACIONES - BUYERS GUIDE

POLO IV (9N_, 9A_) 10.01-10.14					Hatchback (Supermini car-B Segment)			
1.6		Gasolina	FWD	1598	74	101	08.02-05.05	■
POLO IV / DERBY (9A4, 9A2, 9N2, 9A6) 09.02-					Saloon (Supermini car-B Segment)			
1.6 Flex (BPA)		Gasol./Etanol	FWD	1598	76	103	12.04-10.14	■
1.6 Flex (CCRA)		Gasol./Etanol	FWD	1598	77	104	05.08-10.14	■
2.0 Flex (CFEA)		Gasol./Etanol	FWD	1984	88	120	10.08-12.14	■