

LISTA DE APLICACIONES - BUYERS GUIDE

78BD5310-2



Weight: 8.492

O.E.M.	MAKE
1K0 615 601 AC	VW
1K0 615 601 AJ	VW
1K0 615 601 L	VW

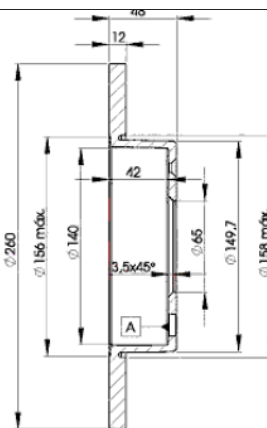
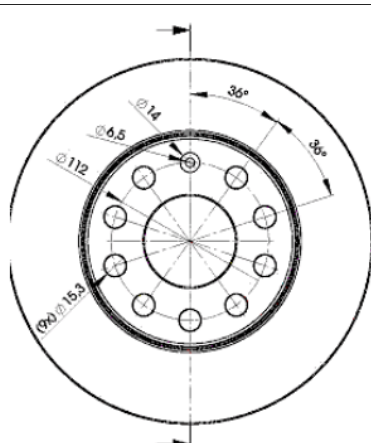

78BD5310-2

E1 90R-02C0415/0025



Ø260x12x48.5

MAKE
AUDI
SEAT
SKODA
SKODA (SVW)
VW
VW (FAW)
VW (SVW)



Trac.	CC	Kw	CV
-------	----	----	----



Front / Rear

AUDI

A3 II (8P1) 05.03-12.13

Hatchback (Compact executive car-D Segment)

1.8 T (BPU)		Gasolina	FWD	1781	110	150	08.06-08.12	■
2.0 TDI quattro (AZV)		Diesel	4WD	1968	100	136	05.03-06.08	■
2.0 TDI 16V quattro (BKD)		Diesel	4WD	1968	103	140	08.04-08.12	■
2.0 TDI 16V quattro (CBAB)		Diesel	4WD	1968	103	140	08.04-08.12	■
2.0 TDI 16V quattro (CFFB)		Diesel	4WD	1968	103	140	08.04-08.12	■
2.0 TDI quattro (BMM)		Diesel	4WD	1968	103	140	01.06-06.08	■

A3 II Sportback (8PA) 09.04-12.15

Hatchback (Compact executive car-D Segment)

2.0 TDI 16V quattro (BKD)		Diesel	4WD	1968	103	140	11.05-03.13	■
2.0 TDI 16V quattro (CBAB)		Diesel	4WD	1968	103	140	11.05-03.13	■
2.0 TDI 16V quattro (CFFB)		Diesel	4WD	1968	103	140	11.05-03.13	■
2.0 TDI quattro (BMM)		Diesel	4WD	1968	103	140	01.06-06.08	■

SEAT

ALTEA (5P1) 03.04-

MPV (Compact MPV-M1 Segment)

1.4 16V (BXW)	PR 1KF	Gasolina	FWD	1390	63	86	05.06-05.11	■
1.4 16V (CGGB)	PR 1KF	Gasolina	FWD	1390	63	86	05.06-05.11	■
1.4 TSI (CAXC)	PR 1KF	Gasolina	FWD	1390	92	125	11.07-07.15	■

ALTEA XL (5P5, 5P8) 10.06-

MPV (Compact MPV-M1 Segment)

1.4 16V (BXW)	PR 1KF	Gasolina	FWD	1390	63	86	10.06-06.13	■
1.4 16V (CGGB)	PR 1KF	Gasolina	FWD	1390	63	86	10.06-06.13	■
1.4 TSI (CAXC)	PR 1KF	Gasolina	FWD	1390	92	125	11.07-07.15	■
1.8 TFSI (BYT)	PR 1KF	Gasolina	FWD	1798	118	160	01.07-07.15	■

LISTA DE APLICACIONES - BUYERS GUIDE

1.8 TFSI (BZB)	PR 1KF	Gasolina	FWD	1798	118	160	01.07-07.15	■
1.8 TFSI (CDAA)	PR 1KF	Gasolina	FWD	1798	118	160	01.07-07.15	■
2.0 FSI (BVY)	PR 1KF	Gasolina	FWD	1984	110	150	10.06-03.09	■
2.0 FSI (BVZ)	PR 1KF	Gasolina	FWD	1984	110	150	10.06-03.09	■
2.0 TFSI 4x4 (BWA)	PR 1KF	Gasolina	4WD	1984	147	200	06.07-05.09	■
2.0 TFSI		Gasolina	FWD	1984	155	211	05.09-07.15	■
TOLEDO III (5P2) 04.04-05.09					MPV (Large MPV-M1 Segment)			
1.4 TSI (CAXC)		Gasolina	FWD	1390	92	125	11.07-05.09	■
SKODA								
OCTAVIA II / LAURA (1Z3) 02.04-06.13					Hatchback (Compact car-C Segment)			
1.4 (BUD)	PR 1KF	Gasolina	FWD	1390	59	80	06.04-04.13	■
1.4 (CGGA)	PR 1KF	Gasolina	FWD	1390	59	80	06.04-04.13	■
1.8 T	PR 1KF	Gasolina	FWD	1781	110	150	09.05-12.08	■
1.8 TSI (CDAB)	PR 1KF	Gasolina	FWD	1798	112	152	03.09-06.13	■
1.8 TSI (BZB)	PR 1KF	Gasolina	FWD	1798	118	160	06.07-04.13	■
1.8 TSI (CDAA)	PR 1KF	Gasolina	FWD	1798	118	160	06.07-04.13	■
2.0 TDI (AZV)	PR 1KF	Diesel	FWD	1968	100	136	02.04-05.10	■
OCTAVIA II Combi (1Z5) 02.04-06.13					Estate (Compact car-C Segment)			
1.4 (BCA)		Gasolina	FWD	1390	55	75	05.04-05.06	■
1.4 (BUD)	PR 1KF	Gasolina	FWD	1390	59	80	05.06-06.13	■
1.4 (CGGA)	PR 1KF	Gasolina	FWD	1390	59	80	05.06-06.13	■
1.6 (BGU)	PR 1KF	Gasolina	FWD	1595	75	102	09.04-06.13	■
1.6 (BSE)	PR 1KF	Gasolina	FWD	1595	75	102	09.04-06.13	■
1.6 (BSF)	PR 1KF	Gasolina	FWD	1595	75	102	09.04-06.13	■
1.6 (CCSA)	PR 1KF	Gasolina	FWD	1595	75	102	09.04-06.13	■
1.6 (CMXA)	PR 1KF	Gasolina	FWD	1595	75	102	09.04-06.13	■
1.8 TSI (CDAB)		Gasolina	FWD	1798	112	152	03.09-06.13	■
1.8 TSI 4x4 (CDAB)		Gasolina	4WD	1798	112	152	03.09-02.13	■
1.8 TSI (BZB)	PR 1KF	Gasolina	FWD	1798	118	160	06.07-04.13	■
1.8 TSI (CDAA)	PR 1KF	Gasolina	FWD	1798	118	160	06.07-04.13	■
2.0 FSI 4x4 (BLX)		Gasolina	4WD	1984	110	150	11.04-04.09	■
2.0 FSI 4x4 (BLY)		Gasolina	4WD	1984	110	150	11.04-04.09	■
2.0 FSI 4x4 (BVX)		Gasolina	4WD	1984	110	150	11.04-04.09	■
1.9 TDI 4x4 (BKC)		Diesel	4WD	1896	77	105	11.04-12.10	■
1.9 TDI 4x4 (BLS)		Diesel	4WD	1896	77	105	11.04-12.10	■
1.9 TDI 4x4 (BXE)		Diesel	4WD	1896	77	105	11.04-12.10	■
2.0 TDI 16V (AZV)		Diesel	FWD	1968	100	136	02.04-05.10	■
2.0 TDI (BMM)		Diesel	FWD	1968	103	140	11.05-05.10	■
2.0 TDI 4x4 (BMM)		Diesel	4WD	1968	103	140	07.06-05.10	■
SUPERB II (3T4) 03.08-05.15					Hatchback (Executive car-E Segment)			
1.4 TSI (CAXC)	PR 1KF	Gasolina	FWD	1390	92	125	07.08-05.15	■
1.8 TSI (BZB)	PR 1KF	Gasolina	FWD	1798	118	160	03.08-05.15	■
1.8 TSI (CDAA)	PR 1KF	Gasolina	FWD	1798	118	160	03.08-05.15	■
1.8 TSI 4x4 (CDAA)	PR 1KF	Gasolina	4WD	1798	118	160	11.08-05.15	■
1.9 TDI (BLS)	PR 1KF	Diesel	FWD	1896	77	105	03.08-11.10	■
1.9 TDI (BXE)	PR 1KF	Diesel	FWD	1896	77	105	03.08-11.10	■
2.0 TDI (BMP)	PR 1KF	Diesel	FWD	1968	103	140	03.08-05.10	■
2.0 TDI 16V (BKD)	PR 1KF	Diesel	FWD	1968	103	140	01.09-05.15	■
2.0 TDI 16V (CFFB)	PR 1KF	Diesel	FWD	1968	103	140	01.09-05.15	■

LISTA DE APLICACIONES - BUYERS GUIDE

2.0 TDI 16V (CLJA)	PR 1KF	Diesel	FWD	1968	103	140	01.09-05.15	■
2.0 TDI (CBBB)	PR 1KF	Diesel	FWD	1968	125	170	07.08-05.15	■
2.0 TDI (CFGB)	PR 1KF	Diesel	FWD	1968	125	170	07.08-05.15	■
2.0 TDI 4x4 (CBBB)	PR 1KF	Diesel	4WD	1968	125	170	09.08-05.15	■
2.0 TDI 4x4 (CFGB)	PR 1KF	Diesel	4WD	1968	125	170	09.08-05.15	■
SKODA (SVW)								
OCTAVIA (913) 06.07-					Hatchback (Compact car-C Segment)			
1.6		Gasolina	FWD	1598	77	105	06.07-12.17	■
1.8 TSI	PR 1KF	Gasolina	FWD	1798	118	160	06.07-03.14	■
VW								
CADDY III (2KA, 2KH, 2CA, 2CH) 03.04-03.16					Box Body/MPV (LCVs-N1 Segment)			
1.4 (BCA)		Gasolina	FWD	1390	55	75	03.04-05.06	■
1.4 (BUD)		Gasolina	FWD	1390	59	80	05.06-08.10	■
1.6 (BGU)		Gasolina	FWD	1595	75	102	04.04-05.15	■
1.6 (BSE)		Gasolina	FWD	1595	75	102	04.04-05.15	■
1.6 (BSF)		Gasolina	FWD	1595	75	102	04.04-05.15	■
1.9 TDI (BSU)		Diesel	FWD	1896	55	75	09.05-08.10	■
1.9 TDI (BJB)		Diesel	FWD	1896	77	105	04.04-08.10	■
1.9 TDI (BLS)		Diesel	FWD	1896	77	105	04.04-08.10	■
2.0 SDI (BDJ)		Diesel	FWD	1968	51	70	03.04-08.10	■
2.0 SDI (BST)		Diesel	FWD	1968	51	70	03.04-08.10	■
2.0 TDI (BMM)		Diesel	FWD	1968	103	140	09.07-08.10	■
2.0 EcoFuel (BSX)		CNG	FWD	1984	80	109	04.06-05.15	■
CADDY III (2KB, 2KJ, 2CB, 2CJ) 03.04-03.16					MPV (Mini MPV-M1 Segment)			
1.4 (BCA)		Gasolina	FWD	1390	55	75	03.04-05.06	■
1.4 (BUD)		Gasolina	FWD	1390	59	80	05.06-08.10	■
1.6		Gasolina	FWD	1595	65	88	01.05-12.09	■
1.6		Gasolina	FWD	1595	74	101	03.05-05.15	■
1.6 (BGU)		Gasolina	FWD	1595	75	102	04.04-05.15	■
1.6 (BSE)		Gasolina	FWD	1595	75	102	04.04-05.15	■
1.6 (BSF)		Gasolina	FWD	1595	75	102	04.04-05.15	■
1.9 D		Diesel	FWD	1896	48	65	10.05-06.09	■
1.9 TDI (BSU)		Diesel	FWD	1896	55	75	09.05-08.10	■
1.9 TDI (BJB)		Diesel	FWD	1896	77	105	04.04-08.10	■
1.9 TDI (BLS)		Diesel	FWD	1896	77	105	04.04-08.10	■
1.9 TDI 4motion (BLS)		Diesel	4WD	1896	77	105	05.08-08.10	■
2.0 SDI (BDJ)		Diesel	FWD	1968	51	70	03.04-08.10	■
2.0 SDI (BST)		Diesel	FWD	1968	51	70	03.04-08.10	■
2.0 TDI (BMM)		Diesel	FWD	1968	103	140	09.07-08.10	■
2.0 EcoFuel (BSX)		CNG	FWD	1984	80	109	04.06-05.15	■
GOLF V / RABBIT V (1K1) 10.03-07.10					Hatchback (Compact car-C Segment)			
2.0 GTI (BYD)	PR 1KE, PR 1KF	Gasolina	FWD	1984	169	230	09.06-12.08	■
2.5		Gasolina	FWD	2480	125	170	05.07-11.08	■
GOLF V Variant / BORA V / JETTA V / VENTO V (1K5) 01.07-07.09					Estate (Compact car-C Segment)			
1.4 (BUD)		Gasolina	FWD	1390	59	80	06.07-07.09	■
1.4 TSI (CAXA)		Gasolina	FWD	1390	90	122	06.07-07.09	■
1.4 TSI (BMY)		Gasolina	FWD	1390	103	140	06.07-07.09	■
1.6 (BSE)		Gasolina	FWD	1595	75	102	06.07-07.09	■
1.6 (BSF)		Gasolina	FWD	1595	75	102	06.07-07.09	■

LISTA DE APLICACIONES - BUYERS GUIDE

1.6 (CCSA)		Gasolina	FWD	1595	75	102	06.07-07.09	■
2.0 TFSI (BWA)	PR 1KE, PR 1KF	Gasolina	FWD	1984	147	200	06.07-07.09	■
2.0 TFSI (CAWB)	PR 1KE, PR 1KF	Gasolina	FWD	1984	147	200	06.07-07.09	■
2.0 TFSI (CBFA)	PR 1KE, PR 1KF	Gasolina	FWD	1984	147	200	06.07-07.09	■
2.0 TFSI (CCTA)	PR 1KE, PR 1KF	Gasolina	FWD	1984	147	200	06.07-07.09	■
1.6 MultiFuel (CCSA)		Gasol./Etanol	FWD	1595	75	102	11.07-07.09	■
1.9 TDI (BLS)		Diesel	FWD	1896	77	105	06.07-07.09	■
1.9 TDI (BXE)		Diesel	FWD	1896	77	105	06.07-07.09	■
1.9 TDI 4motion (BLS)		Diesel	4WD	1896	77	105	01.08-07.09	■
2.0 TDI		Diesel	FWD	1968	96	131	06.07-07.09	■
2.0 TDI (AZV)		Diesel	FWD	1968	100	136	06.07-07.09	■
2.0 TDI		Diesel	RWD	1968	100	136	06.07-07.09	■
2.0 TDI (BMM)		Diesel	FWD	1968	103	140	06.07-07.09	■
2.0 TDI 16V (BKD)		Diesel	FWD	1968	103	140	06.07-07.09	■
2.0 TDI 16V (CBDB)		Diesel	FWD	1968	103	140	06.07-07.09	■
GOLF VI / JETTA VI (5K1_) 10.08-11.12						Hatchback Van (Compact car-C Segment)		
2.0 TDI (CFGB)		Diesel	FWD	1968	125	170	05.10-11.12	■
GOLF VI / JETTA VI (5K1) 10.08-12.14						Hatchback (Compact car-C Segment)		
2.0 TFSI 4motion (CRZA)		Gasolina	4WD	1984	191	260	09.11-11.13	■
2.5 (CBTA)		Gasolina	FWD	2480	125	170	07.09-05.13	■
2.5 (CBUA)		Gasolina	FWD	2480	125	170	07.09-05.13	■
2.0 TDI (CBAA)	PR 1KE, PR 1KF	Diesel	FWD	1968	100	136	10.08-11.12	■
2.0 TDI (CFFA)	PR 1KE, PR 1KF	Diesel	FWD	1968	100	136	10.08-11.12	■
2.0 TDI 4motion (CBAB)		Diesel	4WD	1968	103	140	05.09-11.12	■
2.0 TDI 4motion (CFFB)		Diesel	4WD	1968	103	140	05.09-11.12	■
GOLF VI Variant / JETTA VI (AJ5) 07.09-07.14						Estate (Compact car-C Segment)		
2.0 TFSI (CCZA)		Gasolina	FWD	1984	147	200	07.09-07.13	■
1.6 TDI 4motion (CAYC)		Diesel	4WD	1598	77	105	07.09-07.13	■
2.0 TDI (CLCA)		Diesel	FWD	1968	81	110	01.10-07.13	■
JETTA V / BORA / VENTO (1K2) 09.04-12.13						Saloon (Compact car-C Segment)		
1.4 TSI (CAXA)		Gasolina	FWD	1390	90	122	05.07-10.10	■
1.4 TSI (BMY)		Gasolina	FWD	1390	103	140	07.06-10.10	■
1.4 TSI (CAVD)	PR 1KE, PR 1KF	Gasolina	FWD	1390	118	160	07.08-10.10	■
1.6 (BGU)		Gasolina	FWD	1595	75	102	09.04-10.10	■
1.6 (BSE)		Gasolina	FWD	1595	75	102	09.04-10.10	■
1.6 (BSF)		Gasolina	FWD	1595	75	102	09.04-10.10	■
1.6 (CCSA)		Gasolina	FWD	1595	75	102	09.04-10.10	■
1.6 FSI (BLF)		Gasolina	FWD	1598	85	115	09.05-10.10	■
2.0 FSI (BLR)		Gasolina	FWD	1984	110	150	08.05-10.10	■
2.0 FSI (BLX)		Gasolina	FWD	1984	110	150	08.05-10.10	■
2.0 FSI (BLY)		Gasolina	FWD	1984	110	150	08.05-10.10	■
2.0 FSI (BVY)		Gasolina	FWD	1984	110	150	08.05-10.10	■
2.0 FSI (BVZ)		Gasolina	FWD	1984	110	150	08.05-10.10	■
2.0 TFSI		Gasolina	FWD	1984	125	170	07.08-10.10	■
2.0 TFSI (AXX)		Gasolina	FWD	1984	147	200	10.05-10.10	■
2.0 TFSI (BPY)		Gasolina	FWD	1984	147	200	10.05-10.10	■
2.0 TFSI (BWA)		Gasolina	FWD	1984	147	200	10.05-10.10	■
2.0 TFSI (CAWB)		Gasolina	FWD	1984	147	200	10.05-10.10	■
2.0 TFSI (CBFA)		Gasolina	FWD	1984	147	200	10.05-10.10	■

LISTA DE APLICACIONES - BUYERS GUIDE

2.0 TFSI (CCTA)		Gasolina	FWD	1984	147	200	10.05-10.10	■
2.5 (BGP)		Gasolina	FWD	2480	110	150	01.06-10.10	■
2.5 (BGQ)		Gasolina	FWD	2480	110	150	01.06-10.10	■
2.5 (BTK)		Gasolina	FWD	2480	110	150	01.06-10.10	■
2.5 (CBTA)	PR 1KE, PR 1KF	Gasolina	FWD	2480	125	170	07.08-10.10	■
2.5 (CBUA)	PR 1KE, PR 1KF	Gasolina	FWD	2480	125	170	07.08-10.10	■
2.5 (CCCA)	PR 1KE, PR 1KF	Gasolina	FWD	2480	125	170	07.08-10.10	■
2.8 VR6		Gasolina	FWD	2792	128	174	10.09-10.10	■
1.6 TDI (CAYB)		Diesel	FWD	1598	66	90	12.09-10.10	■
1.6 TDI (CAYC)		Diesel	FWD	1598	77	105	06.09-10.10	■
1.9 TDI		Diesel	FWD	1896	74	101	08.05-10.10	■
1.9 TDI (BKC)		Diesel	FWD	1896	77	105	08.05-10.10	■
1.9 TDI (BLS)		Diesel	FWD	1896	77	105	08.05-10.10	■
1.9 TDI (BXE)		Diesel	FWD	1896	77	105	08.05-10.10	■
2.0 TDI (AZV)		Diesel	FWD	1968	100	136	09.05-10.10	■
2.0 TDI (CBDA)		Diesel	FWD	1968	100	136	09.05-10.10	■
2.0 TDI (BMM)		Diesel	FWD	1968	103	140	10.05-10.10	■
2.0 TDI 16V (BKD)		Diesel	FWD	1968	103	140	08.05-10.10	■
2.0 TDI 16V (CBDB)		Diesel	FWD	1968	103	140	08.05-10.10	■
2.0 TDI 16V (CBEA)		Diesel	FWD	1968	103	140	08.05-10.10	■
2.0 TDI 16V (CJAA)		Diesel	FWD	1968	103	140	08.05-10.10	■
SCIROCCO III (137, 138) 05.08-					Coupe (Sport compact car-C Segment)			
1.4 TSI (CAVD)	PR 1KE	Gasolina	FWD	1390	118	160	05.08-11.17	■
1.4 TSI (CNWA)	PR 1KE	Gasolina	FWD	1390	118	160	05.08-11.17	■
1.4 TSI (CTHD)	PR 1KE	Gasolina	FWD	1390	118	160	05.08-11.17	■
1.4 TSI (CTKA)	PR 1KE	Gasolina	FWD	1390	118	160	05.08-11.17	■
2.0 TFSI (CAWB)	PR 1KE	Gasolina	FWD	1984	147	200	05.08-11.09	■
2.0 TDI (CBDB)	PR 1KE	Diesel	FWD	1968	103	140	08.08-11.17	■
2.0 TDI (CFHC)	PR 1KE	Diesel	FWD	1968	103	140	08.08-11.17	■
SCIROCCO III (137) 06.08-05.14					Hatchback Van (Sport compact car-C Segment)			
1.4 TSI (CAVD)	PR 1KE	Gasolina	FWD	1390	118	160	06.08-05.14	■
2.0 TDI (CBDB)	PR 1KE	Diesel	FWD	1968	103	140	08.08-05.14	■
2.0 TDI (CFHC)	PR 1KE	Diesel	FWD	1968	103	140	08.08-05.14	■
TOURAN (1T1, 1T2) 02.03-05.10					MPV (Compact MPV-M1 Segment)			
1.4 TSI (BMY)	Rim 15	Gasolina	FWD	1390	103	140	02.06-05.10	■
1.4 TSI (CAVC)	Rim 15	Gasolina	FWD	1390	103	140	02.06-05.10	■
1.4 TSI (BLG)	Rim 15, PR 1KF	Gasolina	FWD	1390	125	170	11.06-05.10	■
1.4 TSI (CAVB)	Rim 15, PR 1KF	Gasolina	FWD	1390	125	170	11.06-05.10	■
1.6 (BGU)		Gasolina	FWD	1595	75	102	07.03-05.10	■
1.6 (BSE)		Gasolina	FWD	1595	75	102	07.03-05.10	■
1.6 (BSF)		Gasolina	FWD	1595	75	102	07.03-05.10	■
1.6 FSI (BAG)		Gasolina	FWD	1598	85	115	02.03-01.07	■
1.6 FSI (BLF)		Gasolina	FWD	1598	85	115	02.03-01.07	■
1.6 FSI (BLP)		Gasolina	FWD	1598	85	115	02.03-01.07	■
2.0 FSI		Gasolina	FWD	1984	85	115	10.04-05.10	■
2.0 FSI (AXW)		Gasolina	FWD	1984	110	150	10.03-01.07	■
2.0 FSI (BLR)		Gasolina	FWD	1984	110	150	10.03-01.07	■
2.0 FSI (BLX)		Gasolina	FWD	1984	110	150	10.03-01.07	■
2.0 FSI (BLY)		Gasolina	FWD	1984	110	150	10.03-01.07	■
2.0 FSI (BVY)		Gasolina	FWD	1984	110	150	10.03-01.07	■

LISTA DE APLICACIONES - BUYERS GUIDE

2.0 FSI (BVZ)		Gasolina	FWD	1984	110	150	10.03-01.07	■
1.6 BiFuel (BSF)		Gasol./Gas (LPG)	FWD	1595	75	102	11.06-05.10	■
1.9 TDI (BRU)		Diesel	FWD	1896	66	90	11.04-05.10	■
1.9 TDI (BXF)		Diesel	FWD	1896	66	90	11.04-05.10	■
1.9 TDI (BXJ)		Diesel	FWD	1896	66	90	11.04-05.10	■
1.9 TDI (AVQ)		Diesel	FWD	1896	74	100	02.03-05.04	■
1.9 TDI (BKC)		Diesel	FWD	1896	77	105	08.03-05.10	■
1.9 TDI (BLS)		Diesel	FWD	1896	77	105	08.03-05.10	■
1.9 TDI (BXE)		Diesel	FWD	1896	77	105	08.03-05.10	■
2.0 TDI (AZV)		Diesel	FWD	1968	100	136	02.03-05.10	■
2.0 TDI (BMM)		Diesel	FWD	1968	103	140	12.05-05.10	■
2.0 TDI 16V (BKD)		Diesel	FWD	1968	103	140	08.03-05.10	■
2.0 TDI (BMN)	-11/06	Diesel	FWD	1968	125	170	12.05-05.10	■
2.0 TDI (CFJA)	-11/06	Diesel	FWD	1968	125	170	12.05-05.10	■
2.0 EcoFuel (BSX)	Rim 15, PR 1KF	CNG	FWD	1984	80	109	02.06-05.09	■
TOURAN VAN (1T1, 1T2) 02.03-05.10					Box Body/MPV (Compact MPV-M1 Segment)			
FSI	Rim 15, PR 1KF	Gasolina	FWD	1598	85	116	02.03-11.06	■
2.0 FSI	Rim 15, PR 1KF	Gasolina	FWD	1984	110	150	05.04-01.07	■
2.0 EcoFuel	Rim 15, PR 1KF	Gasol./Gas (CNG)	FWD	1984	80	109	02.06-11.06	■
1.9 TDI		Diesel	FWD	1896	66	90	11.04-05.10	■
1.9 TDI	Rim 15, PR 1KF	Diesel	FWD	1896	74	101	10.03-05.05	■
1.9 TDI	Rim 15, PR 1KF	Diesel	FWD	1896	77	105	08.03-11.06	■
2.0 TDI	Rim 15, PR 1KF	Diesel	FWD	1968	100	136	02.03-05.10	■
2.0 TDI		Diesel	FWD	1968	103	140	12.05-05.10	■
2.0 TDI		Diesel	FWD	1968	103	140	08.03-05.10	■
VW (FAW)								
CADDY (9HB) 04.04-12.07					Van (LCVs-N1 Segment)			
1.6		Gasolina	FWD	1595	75	102	03.05-	■
2.0		Gasolina	FWD	1996	51	69	03.05-	■
VW (SVW)								
TOURAN II (9R1, 9R3) 11.04-					MPV (Compact MPV-M1 Segment)			
1.4 T	Rim 15, PR 1KF	Gasolina	FWD	1390	96	131	12.10-	■
1.8 Turbo	Rim 15, PR 1KF	Gasolina	FWD	1781	110	148	11.04-01.08	■
2.0	Rim 15, PR 1KF	Gasolina	FWD	1984	85	114	11.04-	■
2.0	Rim 15, PR 1KF	Gasolina	FWD	1984	88	120	04.09-	■