

LISTA DE APLICACIONES - BUYERS GUIDE

78BD5314-2



Weight: 15.816

O.E.M.	MAKE
4F0 615 601 D	AUDI
4F0 615 601 F	AUDI

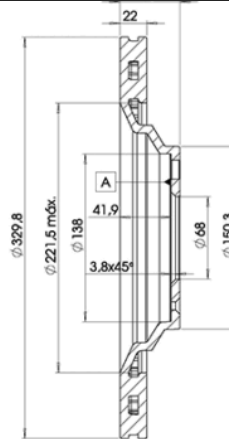
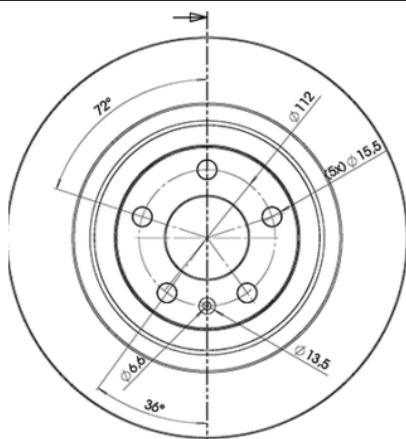

78BD5314-2



Ø329.8x22x49.1

MAKE
AUDI
AUDI (FAW)
SEAT



Trac.	CC	Kw	CV
-------	----	----	----



Front / Rear

AUDI

A6 III C6 Avant (4F5) 11.04-08.11

Estate (Executive car-E Segment)

2.0 TFSI (BPJ)	PR 1KW, PR 2EE, elec.brake detention	Gasolina	FWD	1984	125	170	06.05-08.11	■
2.4 (BDW)	PR 1KW, PR 2EE, elec.brake detention	Gasolina	FWD	2393	130	177	03.05-10.08	■
2.4 quattro (BDW)	PR 1KW, PR 2EE, elec.brake detention	Gasolina	4WD	2393	130	177	03.05-10.08	■
2.8 FSI (CCDA)	PR 1KW, elec.brake detention	Gasolina	FWD	2773	140	190	10.08-08.11	■
2.8 FSI quattro (CCDA)	PR 1KW, elec.brake detention	Gasolina	4WD	2773	140	190	10.08-08.11	■
2.8 FSI (BDX)	PR 1KW, elec.brake detention	Gasolina	FWD	2773	154	210	11.06-10.08	■
2.8 FSI quattro (BDX)	PR 1KW, PR 2EE, elec.brake detention	Gasolina	4WD	2773	154	210	06.07-10.08	■
2.8 FSI (CCEA)	PR 1KW, elec.brake detention	Gasolina	FWD	2773	162	220	10.08-08.11	■
2.8 FSI quattro (CCEA)	PR 1KW, elec.brake detention	Gasolina	4WD	2773	162	220	10.08-08.11	■
3.0 (BBJ)	PR 1KW, PR 2EE	Gasolina	FWD	2976	160	218	03.05-05.06	■
3.0 quattro (BBJ)	PR 1KW, PR 2EE, elec.brake detention	Gasolina	4WD	2976	160	218	03.05-05.06	■
3.0 TFSI quattro (CAJA)	PR 1KW, elec.brake detention	Gasolina	4WD	2995	213	290	10.08-08.11	■
3.0 TFSI quattro (CCAA)	PR 1KW, elec.brake detention	Gasolina	4WD	2995	220	299	10.08-08.11	■
3.2 FSI (AUK)	PR 1KW, PR 2EE	Gasolina	FWD	3123	188	255	03.05-10.08	■
3.2 FSI quattro (AUK)	PR 1KW, PR 2EE	Gasolina	4WD	3123	188	255	03.05-10.08	■
3.2 FSI quattro (BKH)	PR 1KW, PR 2EE	Gasolina	4WD	3123	188	255	03.05-10.08	■
4.2 quattro (BAT)	PR 1KW, PR 2EE, elec.brake detention	Gasolina	4WD	4163	246	335	03.05-05.06	■
4.2 FSI quattro (BVJ)	PR 1KW, PR 2EE, elec.brake detention	Gasolina	4WD	4163	257	350	06.06-08.11	■
2.0 TDI (BVG)	PR 1KW, PR 2EE, elec.brake detention	Diesel	FWD	1968	89	121	09.05-06.06	■

LISTA DE APLICACIONES - BUYERS GUIDE

2.0 TDI (BNA)	PR 1KW, PR 2EE, elec.brake detention	Diesel	FWD	1968	100	136	06.05-08.11	■
2.0 TDI (BRF)	PR 1KW, PR 2EE, elec.brake detention	Diesel	FWD	1968	100	136	06.05-08.11	■
2.0 TDI (CAGB)	PR 1KW, PR 2EE, elec.brake detention	Diesel	FWD	1968	100	136	06.05-08.11	■
2.0 TDI (BLB)	PR 1KW, PR 2EE, elec.brake detention	Diesel	FWD	1968	103	140	06.05-10.08	■
2.0 TDI (BRE)	PR 1KW, PR 2EE, elec.brake detention	Diesel	FWD	1968	103	140	06.05-10.08	■
2.0 TDI (CAHA)	PR 1KW, elec.brake detention	Diesel	FWD	1968	125	170	10.08-08.11	■
2.7 TDI (BSG)	PR 1KW, PR 2EE, elec.brake detention	Diesel	FWD	2698	120	163	03.05-08.11	■
2.7 TDI (CANB)	PR 1KW, PR 2EE, elec.brake detention	Diesel	FWD	2698	120	163	03.05-08.11	■
2.7 TDI quattro (BSG)	PR 1KW, PR 2EE, elec.brake detention	Diesel	4WD	2698	120	163	06.05-08.11	■
2.7 TDI quattro (CAND)	PR 1KW, PR 2EE, elec.brake detention	Diesel	4WD	2698	120	163	06.05-08.11	■
2.7 TDI (BPP)	PR 1KW, PR 2EE, elec.brake detention	Diesel	FWD	2698	132	180	03.05-10.08	■
2.7 TDI quattro (BPP)	PR 1KW, PR 2EE, elec.brake detention	Diesel	4WD	2698	132	180	11.04-10.08	■
2.7 TDI (CANA)	PR 1KW, elec.brake detention	Diesel	FWD	2698	140	190	10.08-08.11	■
2.7 TDI quattro (CANC)	PR 1KW, elec.brake detention	Diesel	4WD	2698	140	190	10.08-08.11	■
3.0 TDI quattro (BNG)	PR 1KW, PR 2EE, elec.brake detention	Diesel	4WD	2967	155	211	03.05-08.11	■
3.0 TDI quattro (CDYB)	PR 1KW, PR 2EE, elec.brake detention	Diesel	4WD	2967	155	211	03.05-08.11	■
3.0 TDI quattro (BMK)	PR 1KW, PR 2EE, elec.brake detention	Diesel	4WD	2967	165	225	03.05-05.06	■
3.0 TDI quattro (ASB)	PR 1KW, PR 2EE, elec.brake detention	Diesel	4WD	2967	171	233	06.06-10.08	■
3.0 TDI quattro (CDYA)	PR 1KW, elec.brake detention	Diesel	4WD	2967	176	240	10.08-08.11	■
3.0 TDI quattro (CDYC)	PR 1KW, elec.brake detention	Diesel	4WD	2967	176	240	10.08-08.11	■
A6 III C6 (4F2) 04.04-08.11					Saloon (Executive car-E Segment)			
2.0 TFSI (BPJ)	PR 1KW, PR 2EE, elec.brake detention	Gasolina	FWD	1984	125	170	06.05-03.11	■
2.0 TFSI (BYK)	PR 1KW, PR 2EE, elec.brake detention	Gasolina	FWD	1984	125	170	06.05-03.11	■
2.4 (BDW)	PR 1KW, PR 2EE, elec.brake detention	Gasolina	FWD	2393	130	177	05.04-10.08	■
2.4 quattro (BDW)	PR 1KW, PR 2EE, elec.brake detention	Gasolina	4WD	2393	130	177	01.05-10.08	■
2.8 V6	PR 1KW, elec.brake detention	Gasolina	FWD	2771	142	193	07.08-10.08	■
2.8 FSI (CCDA)	PR 1KW, elec.brake detention	Gasolina	FWD	2773	140	190	10.08-03.11	■
2.8 FSI quattro (CCDA)	PR 1KW, elec.brake detention	Gasolina	4WD	2773	140	190	10.08-03.11	■
2.8 FSI (BDX)	PR 1KW, PR 2EE, elec.brake detention	Gasolina	FWD	2773	154	210	11.06-10.08	■
2.8 FSI quattro (BDX)	PR 1KW, PR 2EE, elec.brake detention	Gasolina	4WD	2773	154	210	06.07-10.08	■
2.8 FSI (CCEA)	PR 1KW, elec.brake detention	Gasolina	FWD	2773	162	220	10.08-03.11	■
2.8 FSI quattro (CCEA)	PR 1KW, elec.brake detention	Gasolina	4WD	2773	162	220	10.08-03.11	■
3.0 quattro (BBJ)	PR 1KW, PR 2EE, elec.brake detention	Gasolina	4WD	2976	160	218	05.04-05.06	■
3.0 TFSI quattro (CAJA)	PR 1KW, elec.brake detention	Gasolina	4WD	2995	213	290	10.08-03.11	■
3.0 TFSI quattro (CCAA)	PR 1KW, elec.brake detention	Gasolina	4WD	2995	220	299	10.08-03.11	■
3.2 FSI (AUK)	PR 1KW, PR 2EE, elec.brake detention	Gasolina	FWD	3123	188	255	05.04-05.09	■
3.2 FSI (BKH)	PR 1KW, PR 2EE, elec.brake detention	Gasolina	FWD	3123	188	255	05.04-05.09	■
3.2 FSI (CALA)	PR 1KW, PR 2EE, elec.brake detention	Gasolina	FWD	3197	195	265	05.09-03.11	■
4.2 quattro (BAT)	PR 1KW, PR 2EE, elec.brake detention	Gasolina	4WD	4163	246	335	05.04-05.06	■

LISTA DE APLICACIONES - BUYERS GUIDE

4.2 quattro (BNK)	PR 1KW, PR 2EE, elec.brake detention	Gasolina	4WD	4163	246	335	05.04-05.06	■
4.2 FSI quattro (BVJ)	PR 1KW, PR 2EE, elec.brake detention	Gasolina	4WD	4163	257	350	06.06-03.11	■
S6 quattro (BXA)		Gasolina	4WD	5204	320	435	03.06-03.11	■
2.0 TDI (BNA)	PR 1KW, PR 2EE, elec.brake detention	Diesel	FWD	1968	100	136	07.04-03.11	■
2.0 TDI (BRF)	PR 1KW, PR 2EE, elec.brake detention	Diesel	FWD	1968	100	136	07.04-03.11	■
2.0 TDI (CAGB)	PR 1KW, PR 2EE, elec.brake detention	Diesel	FWD	1968	100	136	07.04-03.11	■
2.0 TDI (BLB)	PR 1KW, elec.brake detention	Diesel	FWD	1968	103	140	07.04-10.08	■
2.0 TDI (BRE)	PR 1KW, elec.brake detention	Diesel	FWD	1968	103	140	07.04-10.08	■
2.0 TDI (CAHA)	PR 1KW, elec.brake detention	Diesel	FWD	1968	125	170	11.08-03.11	■
2.7 TDI (BSG)	PR 1KW, PR 2EE, elec.brake detention	Diesel	FWD	2698	120	163	11.04-03.11	■
2.7 TDI (CANB)	PR 1KW, PR 2EE, elec.brake detention	Diesel	FWD	2698	120	163	11.04-03.11	■
2.7 TDI quattro (BSG)	PR 1KW, PR 2EE, elec.brake detention	Diesel	4WD	2698	120	163	06.05-03.11	■
2.7 TDI quattro (CAND)	PR 1KW, PR 2EE, elec.brake detention	Diesel	4WD	2698	120	163	06.05-03.11	■
2.7 TDI (BPP)	PR 1KW, PR 2EE, elec.brake detention	Diesel	FWD	2698	132	180	11.04-10.08	■
2.7 TDI quattro (BPP)	PR 1KW, PR 2EE, elec.brake detention	Diesel	4WD	2698	132	180	11.04-10.08	■
2.7 TDI (CANA)	PR 1KW, elec.brake detention	Diesel	FWD	2698	140	190	10.08-03.11	■
2.7 TDI quattro (CANC)	PR 1KW, elec.brake detention	Diesel	4WD	2698	140	190	10.08-03.11	■
3.0 TDI quattro (BNG)	PR 1KW, PR 2EE, elec.brake detention	Diesel	4WD	2967	155	211	05.04-03.11	■
3.0 TDI quattro (CDYB)	PR 1KW, PR 2EE, elec.brake detention	Diesel	4WD	2967	155	211	05.04-03.11	■
3.0 TDI quattro (BMK)	PR 1KW, PR 2EE, elec.brake detention	Diesel	4WD	2967	165	225	05.04-05.06	■
3.0 TDI quattro (ASB)	PR 1KW, PR 2EE, elec.brake detention	Diesel	4WD	2967	171	233	06.06-10.08	■
3.0 TDI quattro (CDYA)	PR 1KW, elec.brake detention	Diesel	4WD	2967	176	240	10.08-03.11	■
3.0 TDI quattro (CDYC)	PR 1KW, elec.brake detention	Diesel	4WD	2967	176	240	10.08-03.11	■
AUDI (FAW)								
A6L II C6 (4Z8) 03.05-12.12						Saloon (Executive car-E Segment)		
2.8		Gasolina	FWD	2773	162	220	01.08-12.12	■
SEAT								
IBIZA III (6L1) 02.02-11.09						Hatchback (Supermini car-B Segment)		
1.9 TDI Joya Racer (ASZ)	PR 1KW, PR 2EE, elec.brake detention	Diesel	FWD	1896	112	152	07.03-06.04	■