

# LISTA DE APLICACIONES - BUYERS GUIDE

## 78BD5612-2



Weight: 12.384

O.E.M.	MAKE
1C1W-1125-AA	FORD
4 041 427	FORD
4 395 257	FORD

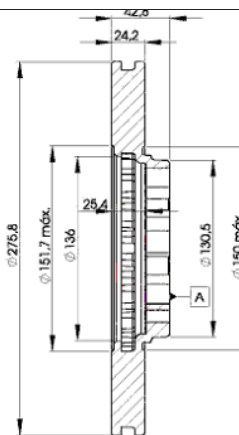
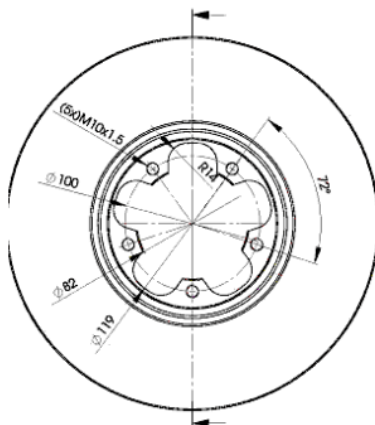

## 78BD5612-2

E1 90R-02C0452/0086



Ø276x24.5x43.2

MAKE

FORD



Trac.	CC	Kw	CV		
					Front / Rear

### FORD

#### TRANSIT IV (FD\_ , FB\_ , FS\_ , FZ\_ , FC\_ ) 01.00-05.06

#### Bus (Minibus-M2-Segment)

2.0	Gasolina	FWD	1998	84	114	09.00-03.06	■
2.3	Gasolina	RWD	2295	107	145	08.00-03.06	■
2.0 DI (F_E_ , F_F_ , F_G_ ) (D3FA)	Diesel	FWD	1998	55	75	08.00-05.06	■
2.0 DI (F_E_ , F_F_ , F_G_ ) (F3FA)	Diesel	FWD	1998	63	86	08.00-05.06	■
2.0 DI (F_E_ , F_F_ , F_G_ ) (ABFA)	Diesel	FWD	1998	74	100	08.00-05.06	■
2.0 TDCi (F_F_ , F_E_ , F_G_ ) (FIFA)	Diesel	FWD	1998	92	125	08.02-05.06	■
2.4 TD	Diesel	RWD	2402	55	75	08.00-08.03	■
2.4 TDDi	Diesel	FWD	2402	66	90	10.01-03.06	■
2.4 TDDi	Diesel	RWD	2402	88	120	08.00-08.03	■

#### TRANSIT IV (FM\_ , FN\_ ) 01.00-05.06

#### Platform/Chassis (LCVs-N1 Segment)

2.0 DI (F_E_ , F_F_ ) (D3FA)	Diesel	FWD	1998	55	75	08.00-05.06	■
2.0 DI (F_E_ , F_F_ ) (F3FA)	Diesel	FWD	1998	63	86	08.00-05.06	■
2.0 DI (F_E_ , F_F_ ) (ABFA)	Diesel	FWD	1998	74	100	08.00-05.06	■
2.0 TDCi (F_E_ , F_F_ ) (FIFA)	Diesel	FWD	1998	92	125	08.02-05.06	■
2.4 TDDi	Diesel	RWD	2402	88	120	08.00-08.03	■

#### TRANSIT IV (FA\_ ) 01.00-05.06

#### Van (LCVs-N1 Segment)

2.0	Gasolina	FWD	1998	84	114	09.00-03.06	■
2.3 (E5FC)	Gasolina	RWD	2295	105	143	03.01-03.06	■
2.3	Gasolina	RWD	2295	107	145	03.01-03.06	■
2.0 DI (FAE_ , FAF_ , FAG_ ) (D3FA)	Diesel	FWD	1998	55	75	08.00-05.06	■
2.0 DI (FAE_ , FAF_ , FAG_ ) (F3FA)	Diesel	FWD	1998	63	86	08.00-05.06	■
2.0 DI (FAE_ , FAF_ , FAG_ ) (ABFA)	Diesel	FWD	1998	74	100	08.00-05.06	■

## LISTA DE APLICACIONES - BUYERS GUIDE

2.0 TDCi (FIFA)	Diesel	FWD	1998	92	125	08.02-05.06	■
2.4 TD (F4FA)	Diesel	FWD	2402	55	75	08.00-08.03	■
2.4 TDdi	Diesel	RWD	2402	88	120	08.00-08.03	■
2.4 TDE (DOFA)	Diesel	RWD	2402	92	125	07.01-05.06	■
<b>TRANSIT TOURNEO II (FC_ _) 06.00-03.06</b>					<b>Bus (Minibus-M2-Segment)</b>		
2.0 (D3FA)	Diesel	FWD	1998	55	75	06.00-08.03	■
2.0 (ABFA)	Diesel	FWD	1998	74	101	06.00-03.05	■
2.0 (FIFA)	Diesel	FWD	1998	92	125	03.02-03.06	■