

LISTA DE APLICACIONES - BUYERS GUIDE

78BD5640-2



Weight: 7.284

O.E.M.	MAKE
1K0 615 601 AB	VW
5C0 615 601	VW

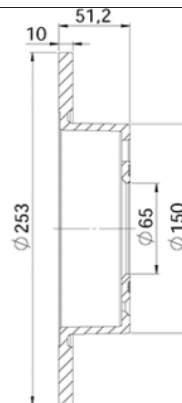
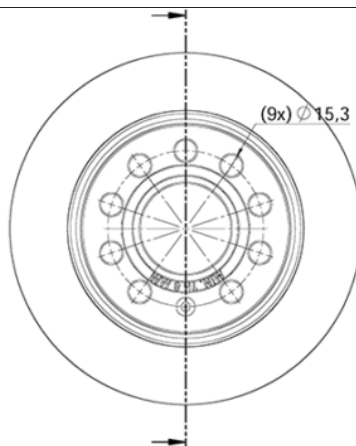

78BD5640-2

E1 90R-02C0415/0089



Ø253x10x51.2

MAKE
AUDI
CUPRA
SEAT
SKODA
SKODA (SVW)
VW
VW (SVW)



Trac.	CC	Kw	CV
-------	----	----	----



Front / Rear

AUDI

A3 II (8P7) 04.08-05.13

Convertible (Compact executive car-D Segment)

1.2 TFSI (CBZB)	PR 1KD, PR 1ZQ	Gasolina	FWD	1197	77	105	03.10-05.13	■
1.4 TFSI (CAXC)	PR 1KD, PR 1ZQ	Gasolina	FWD	1390	92	125	02.11-05.13	■
1.6 (BSE)	PR 1KD, PR 1ZQ	Gasolina	FWD	1595	75	102	09.08-05.10	■
1.8 TFSI (BZB)	PR 1KD	Gasolina	FWD	1798	118	160	04.08-05.13	■
1.8 TFSI (CDAA)	PR 1KD	Gasolina	FWD	1798	118	160	04.08-05.13	■
2.0 TFSI (CAWB)	PR 1KD	Gasolina	FWD	1984	147	200	04.08-05.13	■
2.0 TFSI (CCZA)	PR 1KD	Gasolina	FWD	1984	147	200	04.08-05.13	■
1.6 TDI (CAYC)	PR 1KD, PR 1ZQ	Diesel	FWD	1598	77	105	05.09-05.13	■
1.9 TDI (BLS)	PR 1KD	Diesel	FWD	1896	77	105	04.08-10.09	■
2.0 TDI (CBAA)	PR 1KD	Diesel	FWD	1968	100	136	04.08-05.13	■
2.0 TDI (CFFA)	PR 1KD	Diesel	FWD	1968	100	136	04.08-05.13	■
2.0 TDI (CBAB)	PR 1KD	Diesel	FWD	1968	103	140	04.08-05.13	■
2.0 TDI (CFFB)	PR 1KD	Diesel	FWD	1968	103	140	04.08-05.13	■

A3 II (8P1) 05.03-12.13

Hatchback (Compact executive car-D Segment)

1.2 TSI (CBZB)	PR 1KD, PR 1ZQ	Gasolina	FWD	1197	77	105	04.10-08.12	■
1.4 TFSI (CAXC)	PR 1KD, PR 1ZQ	Gasolina	FWD	1390	92	125	09.07-08.12	■
1.4 TFSI (CMSA)	PR 1KD, PR 1ZQ	Gasolina	FWD	1390	92	125	09.07-08.12	■
1.6 (BGU)	PR 1KD, PR 1ZQ	Gasolina	FWD	1595	75	102	05.03-08.12	■
1.6 (BSE)	PR 1KD, PR 1ZQ	Gasolina	FWD	1595	75	102	05.03-08.12	■
1.6 (BSF)	PR 1KD, PR 1ZQ	Gasolina	FWD	1595	75	102	05.03-08.12	■
1.6 FSI (BAG)	PR 1KD, PR 1ZQ	Gasolina	FWD	1598	85	115	08.03-09.07	■
1.6 FSI (BLF)	PR 1KD, PR 1ZQ	Gasolina	FWD	1598	85	115	08.03-09.07	■

LISTA DE APLICACIONES - BUYERS GUIDE

1.6 FSI (BLP)	PR 1KD, PR 1ZQ	Gasolina	FWD	1598	85	115	08.03-09.07	■
1.8 T (BPU)		Gasolina	FWD	1781	110	150	08.06-08.12	■
1.8 TFSI (BYT)	PR 1KD, PR 1ZQ	Gasolina	FWD	1798	118	160	11.06-08.12	■
1.8 TFSI (BZB)	PR 1KD, PR 1ZQ	Gasolina	FWD	1798	118	160	11.06-08.12	■
1.8 TFSI (CDAA)	PR 1KD, PR 1ZQ	Gasolina	FWD	1798	118	160	11.06-08.12	■
2.0 FSI (AXW)	PR 1KD, PR 1ZQ	Gasolina	FWD	1984	110	150	05.03-06.08	■
2.0 FSI (BLR)	PR 1KD, PR 1ZQ	Gasolina	FWD	1984	110	150	05.03-06.08	■
2.0 FSI (BLX)	PR 1KD, PR 1ZQ	Gasolina	FWD	1984	110	150	05.03-06.08	■
2.0 FSI (BLY)	PR 1KD, PR 1ZQ	Gasolina	FWD	1984	110	150	05.03-06.08	■
2.0 FSI (BMB)	PR 1KD, PR 1ZQ	Gasolina	FWD	1984	110	150	05.03-06.08	■
2.0 FSI (BVY)	PR 1KD, PR 1ZQ	Gasolina	FWD	1984	110	150	05.03-06.08	■
2.0 FSI (BVZ)	PR 1KD, PR 1ZQ	Gasolina	FWD	1984	110	150	05.03-06.08	■
2.0 TFSI (AXX)	PR 1KD, PR 1ZQ	Gasolina	FWD	1984	147	200	09.04-08.12	■
2.0 TFSI (BWA)	PR 1KD, PR 1ZQ	Gasolina	FWD	1984	147	200	09.04-08.12	■
2.0 TFSI (CAWB)	PR 1KD, PR 1ZQ	Gasolina	FWD	1984	147	200	09.04-08.12	■
2.0 TFSI (CCZA)	PR 1KD, PR 1ZQ	Gasolina	FWD	1984	147	200	09.04-08.12	■
1.6 E-Power (CCSA)	PR 1KD, PR 1ZQ	Gasol./Etanol	FWD	1595	75	102	01.11-08.12	■
1.6 E-Power (CMXA)	PR 1KD, PR 1ZQ	Gasol./Etanol	FWD	1595	75	102	01.11-08.12	■
1.6 TDI (CAYB)	PR 1KD, PR 1ZQ	Diesel	FWD	1598	66	90	05.09-08.12	■
1.6 TDI (CAYC)	PR 1KD, PR 1ZQ	Diesel	FWD	1598	77	105	05.09-08.12	■
1.9 TDI (BKC)	PR 1KD, PR 1ZQ	Diesel	FWD	1896	77	105	05.03-05.10	■
1.9 TDI (BLS)	PR 1KD, PR 1ZQ	Diesel	FWD	1896	77	105	05.03-05.10	■
1.9 TDI (BXE)	PR 1KD, PR 1ZQ	Diesel	FWD	1896	77	105	05.03-05.10	■
2.0 TDI (AZV)	PR 1KD, PR 1ZQ	Diesel	FWD	1968	100	136	05.03-08.12	■
2.0 TDI (CBAA)	PR 1KD, PR 1ZQ	Diesel	FWD	1968	100	136	05.03-08.12	■
2.0 TDI (CFFA)	PR 1KD, PR 1ZQ	Diesel	FWD	1968	100	136	05.03-08.12	■
2.0 TDI (BMM)	PR 1KD, PR 1ZQ	Diesel	FWD	1968	103	140	06.05-06.08	■
2.0 TDI 16V (BKD)	PR 1KD, PR 1ZQ	Diesel	FWD	1968	103	140	05.03-08.12	■
2.0 TDI 16V (CBAB)	PR 1KD, PR 1ZQ	Diesel	FWD	1968	103	140	05.03-08.12	■
2.0 TDI 16V (CBEA)	PR 1KD, PR 1ZQ	Diesel	FWD	1968	103	140	05.03-08.12	■
2.0 TDI 16V (CFFB)	PR 1KD, PR 1ZQ	Diesel	FWD	1968	103	140	05.03-08.12	■
2.0 TDI 16V (CLJA)	PR 1KD, PR 1ZQ	Diesel	FWD	1968	103	140	05.03-08.12	■
2.0 TDI (BUY)	PR 1KD, PR 1ZQ	Diesel	FWD	1968	120	163	06.06-06.08	■
2.0 TDI (BMN)	PR 1KD, PR 1ZQ	Diesel	FWD	1968	125	170	03.06-08.12	■
2.0 TDI (CBBB)	PR 1KD, PR 1ZQ	Diesel	FWD	1968	125	170	03.06-08.12	■
2.0 TDI (CFGB)	PR 1KD, PR 1ZQ	Diesel	FWD	1968	125	170	03.06-08.12	■
A3 II Sportback (8PA) 09.04-12.15				Hatchback (Compact executive car-D Segment)				
1.2 TSI (CBZB)	PR 1KD, PR 1ZQ	Gasolina	FWD	1197	77	105	04.10-03.13	■
1.4 TFSI (CAXC)	PR 1KD, PR 1ZQ	Gasolina	FWD	1390	92	125	09.07-03.13	■
1.4 TFSI (CMSA)	PR 1KD, PR 1ZQ	Gasolina	FWD	1390	92	125	09.07-03.13	■
1.6 (BGU)	PR 1KD, PR 1ZQ	Gasolina	FWD	1595	75	102	09.04-03.13	■
1.6 (BSE)	PR 1KD, PR 1ZQ	Gasolina	FWD	1595	75	102	09.04-03.13	■
1.6 (BSF)	PR 1KD, PR 1ZQ	Gasolina	FWD	1595	75	102	09.04-03.13	■
1.6 FSI (BLF)	PR 1KD, PR 1ZQ	Gasolina	FWD	1598	85	115	09.04-09.07	■
1.6 FSI (BLP)	PR 1KD, PR 1ZQ	Gasolina	FWD	1598	85	115	09.04-09.07	■
1.8 FSI (BPU)		Gasolina	FWD	1781	110	150	08.06-06.08	■
1.8 TFSI (BYT)	PR 1KD, PR 1ZQ, 01/07-	Gasolina	FWD	1798	118	160	11.06-03.13	■
1.8 TFSI (BZB)	PR 1KD, PR 1ZQ, 01/07-	Gasolina	FWD	1798	118	160	11.06-03.13	■
1.8 TFSI (CDAA)	PR 1KD, PR 1ZQ, 01/07-	Gasolina	FWD	1798	118	160	11.06-03.13	■
2.0 FSI (AXW)	PR 1KD, PR 1ZQ	Gasolina	FWD	1984	110	150	09.04-06.08	■

LISTA DE APLICACIONES - BUYERS GUIDE

2.0 FSI (BLR)	PR 1KD, PR 1ZQ	Gasolina	FWD	1984	110	150	09.04-06.08	■
2.0 FSI (BLX)	PR 1KD, PR 1ZQ	Gasolina	FWD	1984	110	150	09.04-06.08	■
2.0 FSI (BLY)	PR 1KD, PR 1ZQ	Gasolina	FWD	1984	110	150	09.04-06.08	■
2.0 FSI (BMB)	PR 1KD, PR 1ZQ	Gasolina	FWD	1984	110	150	09.04-06.08	■
2.0 FSI (BVY)	PR 1KD, PR 1ZQ	Gasolina	FWD	1984	110	150	09.04-06.08	■
2.0 FSI (BVZ)	PR 1KD, PR 1ZQ	Gasolina	FWD	1984	110	150	09.04-06.08	■
2.0 TFSI (AXX)	PR 1KD, PR 1ZQ	Gasolina	FWD	1984	147	200	09.04-03.13	■
2.0 TFSI (BPY)	PR 1KD, PR 1ZQ	Gasolina	FWD	1984	147	200	09.04-03.13	■
2.0 TFSI (BWA)	PR 1KD, PR 1ZQ	Gasolina	FWD	1984	147	200	09.04-03.13	■
2.0 TFSI (CAWB)	PR 1KD, PR 1ZQ	Gasolina	FWD	1984	147	200	09.04-03.13	■
2.0 TFSI (CBFA)	PR 1KD, PR 1ZQ	Gasolina	FWD	1984	147	200	09.04-03.13	■
2.0 TFSI (CCTA)	PR 1KD, PR 1ZQ	Gasolina	FWD	1984	147	200	09.04-03.13	■
2.0 TFSI (CCZA)	PR 1KD, PR 1ZQ	Gasolina	FWD	1984	147	200	09.04-03.13	■
1.6 E-Power (CCSA)	PR 1KD, PR 1ZQ	Gasol./Etanol	FWD	1595	75	102	01.11-03.13	■
1.6 E-Power (CMXA)	PR 1KD, PR 1ZQ	Gasol./Etanol	FWD	1595	75	102	01.11-03.13	■
1.6 TDI (CAYB)	PR 1KD, PR 1ZQ	Diesel	FWD	1598	66	90	05.09-03.13	■
1.6 TDI (CAYC)	PR 1KD, PR 1ZQ	Diesel	FWD	1598	77	105	05.09-03.13	■
1.9 TDI (BKC)	PR 1KD, PR 1ZQ	Diesel	FWD	1896	77	105	09.04-05.10	■
1.9 TDI (BLS)	PR 1KD, PR 1ZQ	Diesel	FWD	1896	77	105	09.04-05.10	■
1.9 TDI (BXE)	PR 1KD, PR 1ZQ	Diesel	FWD	1896	77	105	09.04-05.10	■
2.0 TDI (AZV)	PR 1KD, PR 1ZQ	Diesel	FWD	1968	100	136	09.04-03.13	■
2.0 TDI (CBAA)	PR 1KD, PR 1ZQ	Diesel	FWD	1968	100	136	09.04-03.13	■
2.0 TDI (CFFA)	PR 1KD, PR 1ZQ	Diesel	FWD	1968	100	136	09.04-03.13	■
2.0 TDI (BMM)	PR 1KD, PR 1ZQ	Diesel	FWD	1968	103	140	06.05-06.08	■
2.0 TDI 16V (BKD)	PR 1KD, PR 1ZQ	Diesel	FWD	1968	103	140	09.04-03.13	■
2.0 TDI 16V (CBAB)	PR 1KD, PR 1ZQ	Diesel	FWD	1968	103	140	09.04-03.13	■
2.0 TDI 16V (CBEA)	PR 1KD, PR 1ZQ	Diesel	FWD	1968	103	140	09.04-03.13	■
2.0 TDI 16V (CFFB)	PR 1KD, PR 1ZQ	Diesel	FWD	1968	103	140	09.04-03.13	■
2.0 TDI 16V (CLJA)	PR 1KD, PR 1ZQ	Diesel	FWD	1968	103	140	09.04-03.13	■
2.0 TDI		Diesel	FWD	1968	104	141	01.10-03.13	■
2.0 TDI (BUY)	PR 1KD, PR 1ZQ	Diesel	FWD	1968	120	163	06.06-06.08	■
2.0 TDI (BMN)	PR 1KD, PR 1ZQ	Diesel	FWD	1968	125	170	03.06-03.13	■
2.0 TDI (CBBB)	PR 1KD, PR 1ZQ	Diesel	FWD	1968	125	170	03.06-03.13	■
2.0 TDI (CFGB)	PR 1KD, PR 1ZQ	Diesel	FWD	1968	125	170	03.06-03.13	■
Q2 (GAB, GAG) 06.16-					SUV (Compact SUV-J Segment)			
1.0 TFSI (CHZJ)		Gasolina	FWD	999	85	115	10.16-10.20	■
1.4 TFSI (CZEA)		Gasolina	FWD	1395	110	150	06.16-	■
1.6 TDI (DDYA)		Diesel	FWD	1598	85	115	06.16-07.18	■
2.0 TDI (DFGA)		Diesel	FWD	1968	110	150	09.16-	■
2.0 TDI quattro (DFGA)		Diesel	4WD	1968	110	150	09.16-	■
2.0 TDI quattro (DFHA)		Diesel	4WD	1968	140	190	07.16-08.18	■
CUPRA								
Leon 08.19-					Hatchback (Compact car-C Segment)			
2.0 TSI	PR 1KD	Gasolina	FWD	1984	213	290	08.19-	■
Leon ST 08.19-					Estate (Compact car-C Segment)			
2.0 TSI	PR 1KD	Gasolina	FWD	1984	213	290	08.19-	■
2.0 TSI 4Drive	PR 1KD	Gasolina	4WD	1984	221	300	08.19-	■
SEAT								

LISTA DE APLICACIONES - BUYERS GUIDE

ALTEA (5P1) 03.04-					MPV (Compact MPV-M1 Segment)			
1.2 TSI (CBZB)	PR 1KD, PR 1ZQ	Gasolina	FWD	1197	77	105	04.10-07.15	■
1.4 16V (BXW)	PR 1KD, PR 1ZQ	Gasolina	FWD	1390	63	86	05.06-05.11	■
1.4 16V (CGGB)	PR 1KD, PR 1ZQ	Gasolina	FWD	1390	63	86	05.06-05.11	■
1.4 TSI (CAXC)	PR 1KD, PR 1ZQ	Gasolina	FWD	1390	92	125	11.07-07.15	■
1.6 (BGU)	PR 1KD, PR 1ZQ	Gasolina	FWD	1595	75	102	03.04-03.10	■
1.6 (BSE)	PR 1KD, PR 1ZQ	Gasolina	FWD	1595	75	102	03.04-03.10	■
1.6 (BSF)	PR 1KD, PR 1ZQ	Gasolina	FWD	1595	75	102	03.04-03.10	■
1.6 (CCSA)	PR 1KD, PR 1ZQ	Gasolina	FWD	1595	75	102	03.04-03.10	■
1.8 TFSI (BYT)	PR 1KD, PR 1ZQ	Gasolina	FWD	1798	118	160	01.07-07.15	■
1.8 TFSI (BZB)	PR 1KD, PR 1ZQ	Gasolina	FWD	1798	118	160	01.07-07.15	■
1.8 TFSI (CDAA)	PR 1KD, PR 1ZQ	Gasolina	FWD	1798	118	160	01.07-07.15	■
2.0 FSI (BLR)	PR 1KD, PR 1ZQ	Gasolina	FWD	1984	110	150	05.04-03.09	■
2.0 FSI (BLY)	PR 1KD, PR 1ZQ	Gasolina	FWD	1984	110	150	05.04-03.09	■
2.0 FSI (BVY)	PR 1KD, PR 1ZQ	Gasolina	FWD	1984	110	150	05.04-03.09	■
2.0 FSI (BVZ)	PR 1KD, PR 1ZQ	Gasolina	FWD	1984	110	150	05.04-03.09	■
2.0 TFSI (BWA)	PR 1KD, PR 1ZQ	Gasolina	FWD	1984	147	200	04.06-05.09	■
1.6 LPG (CHGA)	PR 1KD, PR 1ZQ	Gasol./Gas (LPG)	FWD	1595	75	102	09.09-06.13	■
1.6 MultiFuel (CMXA)		Gasol./Etanol	FWD	1595	75	102	11.10-05.11	■
1.6 TDI (CAYB)	PR 1KD, PR 1ZQ	Diesel	FWD	1598	66	90	11.10-07.15	■
1.6 TDI (CAYC)	PR 1KD, PR 1ZQ	Diesel	FWD	1598	77	105	10.09-07.15	■
1.9 TDI (BXF)	PR 1KD, PR 1ZQ	Diesel	FWD	1896	66	90	08.09-12.10	■
1.9 TDI (BJB)	PR 1KD, PR 1ZQ	Diesel	FWD	1896	77	105	04.04-12.10	■
1.9 TDI (BKC)	PR 1KD, PR 1ZQ	Diesel	FWD	1896	77	105	04.04-12.10	■
1.9 TDI (BLS)	PR 1KD, PR 1ZQ	Diesel	FWD	1896	77	105	04.04-12.10	■
1.9 TDI (BXE)	PR 1KD, PR 1ZQ	Diesel	FWD	1896	77	105	04.04-12.10	■
2.0 TDI (AZV)	PR 1KD, PR 1ZQ	Diesel	FWD	1968	100	136	03.04-05.09	■
2.0 TDI (BMM)	PR 1KD, PR 1ZQ	Diesel	FWD	1968	103	140	11.05-11.10	■
2.0 TDI 16V (BKD)	PR 1KD, PR 1ZQ	Diesel	FWD	1968	103	140	03.04-07.15	■
2.0 TDI 16V (CFHC)	PR 1KD, PR 1ZQ	Diesel	FWD	1968	103	140	03.04-07.15	■
2.0 TDI 16V 4WD (CFHC)		Diesel	4WD	1968	103	140	10.10-	■
2.0 TDI (BMN)	PR 1KD, PR 1ZQ	Diesel	FWD	1968	125	170	03.06-05.10	■
2.0 TDI (CEGA)	PR 1KD, PR 1ZQ	Diesel	FWD	1968	125	170	03.06-05.10	■
ALTEA XL (5P5, 5P8) 10.06-					MPV (Compact MPV-M1 Segment)			
1.2 TSI (CBZB)	PR 1KD, PR 1ZQ	Gasolina	FWD	1197	77	105	04.10-07.15	■
1.4 16V (BXW)	PR 1KD, PR 1ZQ, 05/08-	Gasolina	FWD	1390	63	86	10.06-06.13	■
1.4 16V (CGGB)	PR 1KD, PR 1ZQ, 05/08-	Gasolina	FWD	1390	63	86	10.06-06.13	■
1.4 TSI (CAXC)	PR 1KD, PR 1ZQ	Gasolina	FWD	1390	92	125	11.07-07.15	■
1.6 (BGU)	PR 1KD, PR 1ZQ	Gasolina	FWD	1595	75	102	10.06-11.10	■
1.6 (BSE)	PR 1KD, PR 1ZQ	Gasolina	FWD	1595	75	102	10.06-11.10	■
1.6 (BSF)	PR 1KD, PR 1ZQ	Gasolina	FWD	1595	75	102	10.06-11.10	■
1.6 (CCSA)	PR 1KD, PR 1ZQ	Gasolina	FWD	1595	75	102	10.06-11.10	■
1.8 TFSI (BYT)	PR 1KD, PR 1ZQ	Gasolina	FWD	1798	118	160	01.07-07.15	■
1.8 TFSI (BZB)	PR 1KD, PR 1ZQ	Gasolina	FWD	1798	118	160	01.07-07.15	■
1.8 TFSI (CDAA)	PR 1KD, PR 1ZQ	Gasolina	FWD	1798	118	160	01.07-07.15	■
2.0 FSI (BVY)	PR 1KD, PR 1ZQ	Gasolina	FWD	1984	110	150	10.06-03.09	■
2.0 FSI (BVZ)	PR 1KD, PR 1ZQ	Gasolina	FWD	1984	110	150	10.06-03.09	■
2.0 TFSI (BWA)	PR 1KD, PR 1ZQ	Gasolina	FWD	1984	147	200	10.06-05.09	■
2.0 TFSI 4x4 (BWA)	PR 1KD, PR 1ZQ	Gasolina	4WD	1984	147	200	06.07-05.09	■
2.0 TFSI		Gasolina	FWD	1984	155	211	05.09-07.15	■

LISTA DE APLICACIONES - BUYERS GUIDE

2.0 TFSI 4x4 (CCZB)	PR 1KD, PR 1ZQ	Gasolina	4WD	1984	155	211	05.09-07.15	■
1.6 LPG (CHGA)	PR 1KD, PR 1ZQ	Gasol./Gas (LPG)	FWD	1595	75	102	09.09-06.13	■
1.6 MultiFuel (BSE)	PR 1KD, PR 1ZQ	Gasol./Etanol	FWD	1595	75	102	10.06-11.10	■
1.6 MultiFuel (BSF)	PR 1KD, PR 1ZQ	Gasol./Etanol	FWD	1595	75	102	10.06-11.10	■
1.6 MultiFuel (CCSA)	PR 1KD, PR 1ZQ	Gasol./Etanol	FWD	1595	75	102	10.06-11.10	■
1.6 MultiFuel (CMXA)	PR 1KD, PR 1ZQ	Gasol./Etanol	FWD	1595	75	102	10.06-11.10	■
1.6 TDI (CAYB)	PR 1KD, PR 1ZQ	Diesel	FWD	1598	66	90	11.10-07.15	■
1.6 TDI (CAYC)	PR 1KD, PR 1ZQ	Diesel	FWD	1598	77	105	10.09-07.15	■
1.9 TDI (BXF)	PR 1KD, PR 1ZQ	Diesel	FWD	1896	66	90	08.09-12.10	■
1.9 TDI (BKC)	PR 1KD, PR 1ZQ	Diesel	FWD	1896	77	105	10.06-12.10	■
1.9 TDI (BLS)	PR 1KD, PR 1ZQ	Diesel	FWD	1896	77	105	10.06-12.10	■
1.9 TDI (BXE)	PR 1KD, PR 1ZQ	Diesel	FWD	1896	77	105	10.06-12.10	■
1.9 TDI 4x4 (BLS)	PR 1KD, PR 1ZQ	Diesel	4WD	1896	77	105	06.09-12.10	■
2.0 TDI (AZV)	PR 1KD, PR 1ZQ	Diesel	FWD	1968	100	136	11.06-03.09	■
2.0 TDI (BMM)	PR 1KD, PR 1ZQ	Diesel	FWD	1968	103	140	10.06-11.10	■
2.0 TDI 16V (BKD)	PR 1KD, PR 1ZQ	Diesel	FWD	1968	103	140	10.06-07.15	■
2.0 TDI 16V (CFHC)	PR 1KD, PR 1ZQ	Diesel	FWD	1968	103	140	10.06-07.15	■
2.0 TDI 16V 4x4 (CFHC)	PR 1KD, PR 1ZQ	Diesel	4WD	1968	103	140	10.10-07.15	■
2.0 TDI 4x4 (BMM)	PR 1KD, PR 1ZQ	Diesel	4WD	1968	103	140	06.07-11.10	■
2.0 TDI (BMN)	PR 1KD, PR 1ZQ	Diesel	FWD	1968	125	170	06.07-12.13	■
2.0 TDI (CEGA)	PR 1KD, PR 1ZQ	Diesel	FWD	1968	125	170	06.07-12.13	■
2.0 TDI 4x4 (BMN)	PR 1KD, PR 1ZQ	Diesel	4WD	1968	125	170	06.07-06.13	■
2.0 TDI 4x4 (CEGA)	PR 1KD, PR 1ZQ	Diesel	4WD	1968	125	170	06.07-06.13	■
2.0 TDI 4x4 (CFJA)	PR 1KD, PR 1ZQ	Diesel	4WD	1968	125	170	06.07-06.13	■
LEON II (1P1) 05.05-12.13					Hatchback (Compact car-C Segment)			
1.2 TSI (CBZB)	PR 1KD, -10/12	Gasolina	FWD	1197	77	105	02.10-12.12	■
1.4 16V (BXW)	PR 1KD, -10/12	Gasolina	FWD	1390	63	86	06.06-12.12	■
1.4 16V (CGGB)	PR 1KD, -10/12	Gasolina	FWD	1390	63	86	06.06-12.12	■
1.4 TSI (CAXC)	PR 1KD, -10/12	Gasolina	FWD	1390	92	125	11.07-12.12	■
1.6 (BSE)	PR 1KD, 08/05-, -10/12	Gasolina	FWD	1595	75	102	07.05-12.12	■
1.6 (BSF)	PR 1KD, 08/05-, -10/12	Gasolina	FWD	1595	75	102	07.05-12.12	■
1.6 (CCSA)	PR 1KD, 08/05-, -10/12	Gasolina	FWD	1595	75	102	07.05-12.12	■
1.8 TSI (BZB)	PR 1KD, -10/12	Gasolina	FWD	1798	118	160	06.07-12.12	■
1.8 TSI (CDAA)	PR 1KD, -10/12	Gasolina	FWD	1798	118	160	06.07-12.12	■
2.0 FSI (BLR)	PR 1KD, 08/05-	Gasolina	FWD	1984	110	150	07.05-05.10	■
2.0 FSI (BLY)	PR 1KD, 08/05-	Gasolina	FWD	1984	110	150	07.05-05.10	■
2.0 FSI (BVY)	PR 1KD, 08/05-	Gasolina	FWD	1984	110	150	07.05-05.10	■
2.0 FSI (BVZ)	PR 1KD, 08/05-	Gasolina	FWD	1984	110	150	07.05-05.10	■
2.0 TFSI (BWA1)	PR 1KD	Gasolina	FWD	1984	136	185	09.05-05.06	■
2.0 TFSI (BWA)	PR 1KD, 08/05-	Gasolina	FWD	1984	147	200	05.05-03.09	■
2.0 TFSI (CCZB)	PR 1KD, -10/12	Gasolina	FWD	1984	155	211	06.09-12.12	■
2.0 TFSI (BWJ)	PR 1KD	Gasolina	FWD	1984	177	240	11.06-05.11	■
2.0 TFSI (CDLD)	PR 1KD	Gasolina	FWD	1984	177	240	11.06-05.11	■
2.0 Cupra R (CDLA)	PR 1KD, -10/12	Gasolina	FWD	1984	195	265	09.09-12.12	■
1.6 LPG (CHGA)	PR 1KD, -10/12	Gasol./Gas (LPG)	FWD	1595	75	102	12.09-12.12	■
1.6 MultiFuel (BSE)	PR 1KD, -10/12	Gasol./Etanol	FWD	1595	75	102	07.05-08.13	■
1.6 MultiFuel (CCSA)	PR 1KD, -10/12	Gasol./Etanol	FWD	1595	75	102	07.05-08.13	■

LISTA DE APLICACIONES - BUYERS GUIDE

1.6 MultiFuel (CMXA)	PR 1KD, -10/12	Gasol./Etanol	FWD	1595	75	102	07.05-08.13	■
1.6 TDI (CAYB)	PR 1KD, -10/12	Diesel	FWD	1598	66	90	11.10-12.12	■
1.6 TDI (CAYC)	PR 1KD, -10/12	Diesel	FWD	1598	77	105	02.10-12.12	■
1.9 TDI (BXF)	PR 1KD	Diesel	FWD	1896	66	90	06.07-12.10	■
1.9 TDI (BKC)	PR 1KD, 08/05-	Diesel	FWD	1896	77	105	07.05-12.10	■
1.9 TDI (BLS)	PR 1KD, 08/05-	Diesel	FWD	1896	77	105	07.05-12.10	■
1.9 TDI (BXE)	PR 1KD, 08/05-	Diesel	FWD	1896	77	105	07.05-12.10	■
2.0 TDI (AZV)	PR 1KD, 08/05-	Diesel	FWD	1968	100	136	07.05-05.10	■
2.0 TDI (BMM)	PR 1KD	Diesel	FWD	1968	103	140	10.05-10.10	■
2.0 TDI 16V (BKD)	PR 1KD, 08/05-, -10/12	Diesel	FWD	1968	103	140	07.05-12.12	■
2.0 TDI 16V (CFHC)	PR 1KD, 08/05-, -10/12	Diesel	FWD	1968	103	140	07.05-12.12	■
2.0 TDI 16V (CLCB)	PR 1KD, 08/05-, -10/12	Diesel	FWD	1968	103	140	07.05-12.12	■
2.0 TDI (BMN)	PR 1KD, -10/12	Diesel	FWD	1968	125	170	05.06-12.12	■
2.0 TDI (CEGA)	PR 1KD, -10/12	Diesel	FWD	1968	125	170	05.06-12.12	■
2.0 TDI (CFJA)	PR 1KD, -10/12	Diesel	FWD	1968	125	170	05.06-12.12	■
LEON III (5F1) 09.12-					Hatchback Van (Compact car-C Segment)			
1.0 TSI (CHZD)		Gasolina	FWD	999	85	115	05.15-08.20	■
1.2 TSI (CJZB)		Gasolina	FWD	1197	63	86	01.13-08.18	■
1.2 TSI (CYVA)		Gasolina	FWD	1197	63	86	01.13-08.18	■
1.2 TSI (CYVB)		Gasolina	FWD	1197	81	110	04.14-08.18	■
1.4 TSI (CMBA)		Gasolina	FWD	1395	90	122	09.12-10.16	■
1.4 TSI (CXSA)		Gasolina	FWD	1395	90	122	09.12-10.16	■
1.4 TSI (CHPA)		Gasolina	FWD	1395	103	140	09.12-10.16	■
1.4 TSI (CPTA)		Gasolina	FWD	1395	103	140	09.12-10.16	■
1.4 TSI (CZEA)		Gasolina	FWD	1395	110	150	05.14-08.20	■
1.8 TFSI (CJSA)		Gasolina	FWD	1798	132	180	02.13-08.18	■
1.6 TDI (CLHB)		Diesel	FWD	1598	66	90	11.12-10.16	■
1.6 TDI (CLHA)		Diesel	FWD	1598	77	105	09.12-10.16	■
1.6 TDI (CRKB)		Diesel	FWD	1598	81	110	09.13-10.16	■
1.6 TDI (CXXB)		Diesel	FWD	1598	81	110	09.13-10.16	■
1.6 TDI (DBKA)		Diesel	FWD	1598	81	110	09.13-10.16	■
1.6 TDI (DDYA)		Diesel	FWD	1598	85	115	11.16-08.20	■
2.0 TDI (CKFC)		Diesel	FWD	1968	110	150	10.12-08.18	■
2.0 TDI (CRMB)		Diesel	FWD	1968	110	150	10.12-08.18	■
2.0 TDI (CUNA)		Diesel	FWD	1968	135	184	02.13-08.18	■
2.0 TDI (CUPA)		Diesel	FWD	1968	135	184	02.13-08.18	■
LEON III (5F1) 09.12-					Hatchback (Compact car-C Segment)			
1.0 TSI (DKLB)		Gasolina	FWD	999	63	86	09.18-08.20	■
1.0 TSI (CHZD)	PR 1KD	Gasolina	FWD	999	85	115	05.15-08.20	■
1.0 TSI (DKRF)	PR 1KD	Gasolina	FWD	999	85	115	05.15-08.20	■
1.2 TSI (CJZB)	PR 1KD	Gasolina	FWD	1197	63	86	12.12-08.18	■
1.2 TSI (CYVA)	PR 1KD	Gasolina	FWD	1197	63	86	12.12-08.18	■
1.2 TSI (CJZA)	PR 1KD	Gasolina	FWD	1197	77	105	01.13-08.20	■
1.2 TSI (CYVB)	PR 1KD	Gasolina	FWD	1197	81	110	04.14-08.20	■
1.4 TSI (CMBA)	PR 1KD	Gasolina	FWD	1395	90	122	11.12-10.16	■
1.4 TSI (CXSA)	PR 1KD	Gasolina	FWD	1395	90	122	11.12-10.16	■
1.4 TSI (CZCA)	PR 1KD	Gasolina	FWD	1395	92	125	05.14-08.20	■
1.4 TSI (CHPA)	PR 1KD	Gasolina	FWD	1395	103	140	09.12-08.20	■
1.4 TSI (CPTA)	PR 1KD	Gasolina	FWD	1395	103	140	09.12-08.20	■
1.4 TSI (CZDA)	PR 1KD	Gasolina	FWD	1395	110	150	05.14-08.20	■

LISTA DE APLICACIONES - BUYERS GUIDE

1.4 TSI (CZEA)	PR 1KD	Gasolina	FWD	1395	110	150	05.14-08.20	■
1.5 TSI (DACA)		Gasolina	FWD	1495	96	130	09.18-08.20	■
1.5 TSI (DPBA)		Gasolina	FWD	1495	96	130	09.18-08.20	■
1.5 TSI (DADA)		Gasolina	FWD	1498	110	150	09.18-08.20	■
1.5 TSI (DPCA)		Gasolina	FWD	1498	110	150	09.18-08.20	■
1.8 TSI (CJSA)	PR 1KD	Gasolina	FWD	1798	132	180	02.13-08.18	■
2.0 TSI (DKZA)		Gasolina	FWD	1984	140	190	09.18-08.20	■
2.0 Cupra (CJXE)	PR 1KD	Gasolina	FWD	1984	195	265	10.13-08.20	■
2.0 Cupra (CJXH)	PR 1KD	Gasolina	FWD	1984	213	290	10.15-08.20	■
2.0 Cupra (DNUC)	PR 1KD	Gasolina	FWD	1984	213	290	10.15-08.20	■
1.4 TGI (CPWA)	PR 1KD	Gasol./Gas (CNG)	FWD	1395	81	110	02.13-08.18	■
1.5 TGI (DHFA)		Gasol./Gas (CNG)	FWD	1498	96	131	10.18-08.20	■
1.6 TDI (CLHB)	PR 1KD	Diesel	FWD	1598	66	90	11.12-08.18	■
1.6 TDI (CXXA)	PR 1KD	Diesel	FWD	1598	66	90	11.12-08.18	■
1.6 TDI (DDYB)	PR 1KD	Diesel	FWD	1598	66	90	11.12-08.18	■
1.6 TDI (CLHA)	PR 1KD	Diesel	FWD	1598	77	105	09.12-08.20	■
1.6 TDI (CRKB)	PR 1KD	Diesel	FWD	1598	81	110	09.13-08.20	■
1.6 TDI (CXXB)	PR 1KD	Diesel	FWD	1598	81	110	09.13-08.20	■
1.6 TDI (DBKA)	PR 1KD	Diesel	FWD	1598	81	110	09.13-08.20	■
1.6 TDI (DDYA)		Diesel	FWD	1598	85	115	11.16-08.20	■
1.6 TDI (DGTE)		Diesel	FWD	1598	85	115	11.16-08.20	■
2.0 TDI (CRLD)	PR 1KD	Diesel	FWD	1968	81	110	05.13-08.20	■
2.0 TDI (CRVA)	PR 1KD	Diesel	FWD	1968	81	110	05.13-08.20	■
2.0 TDI (CRVC)	PR 1KD	Diesel	FWD	1968	105	143	05.13-08.20	■
2.0 TDI (CKFC)	PR 1KD	Diesel	FWD	1968	110	150	10.12-08.20	■
2.0 TDI (CRMB)	PR 1KD	Diesel	FWD	1968	110	150	10.12-08.20	■
2.0 TDI (DFFA)	PR 1KD	Diesel	FWD	1968	110	150	10.12-08.20	■
2.0 TDI (CUNA)	PR 1KD	Diesel	FWD	1968	135	184	09.12-08.20	■
2.0 TDI (CUPA)	PR 1KD	Diesel	FWD	1968	135	184	09.12-08.20	■
2.0 TDI (DJGA)	PR 1KD	Diesel	FWD	1968	135	184	09.12-08.20	■
LEON III SC (5F5) 01.13-					Coupe (Compact car-C Segment)			
1.0 TSI (CHZD)	PR 1KD	Gasolina	FWD	999	85	115	05.15-08.18	■
1.2 TSI (CJZB)	PR 1KD	Gasolina	FWD	1197	63	86	01.13-08.18	■
1.2 TSI (CYVA)	PR 1KD	Gasolina	FWD	1197	63	86	01.13-08.18	■
1.2 TSI (CJZA)	PR 1KD	Gasolina	FWD	1197	77	105	02.13-04.14	■
1.2 TSI (CYVB)	PR 1KD	Gasolina	FWD	1197	81	110	05.14-08.18	■
1.4 TSI (CMBA)	PR 1KD	Gasolina	FWD	1395	90	122	02.13-06.15	■
1.4 TSI (CXSA)	PR 1KD	Gasolina	FWD	1395	90	122	02.13-06.15	■
1.4 TSI (CZCA)	PR 1KD	Gasolina	FWD	1395	92	125	05.14-08.18	■
1.4 TSI (CHPA)	PR 1KD	Gasolina	FWD	1395	103	140	02.13-11.16	■
1.4 TSI (CPTA)	PR 1KD	Gasolina	FWD	1395	103	140	02.13-11.16	■
1.4 TSI (CZEA)	PR 1KD	Gasolina	FWD	1395	110	150	05.14-08.18	■
1.8 TSI (CJSA)	PR 1KD	Gasolina	FWD	1798	132	180	02.13-08.18	■
2.0 Cupra (CJXE)	PR 1KD	Gasolina	FWD	1984	195	265	10.13-11.16	■
2.0 Cupra (CJXA)	PR 1KD	Gasolina	FWD	1984	206	280	10.13-11.16	■
2.0 Cupra (CJXH)	PR 1KD	Gasolina	FWD	1984	213	290	10.15-11.16	■
1.6 TDI (CLHB)	PR 1KD	Diesel	FWD	1598	66	90	02.13-08.18	■
1.6 TDI (CXXA)	PR 1KD	Diesel	FWD	1598	66	90	02.13-08.18	■
1.6 TDI (DDYB)	PR 1KD	Diesel	FWD	1598	66	90	02.13-08.18	■

LISTA DE APLICACIONES - BUYERS GUIDE

1.6 TDI (CLHA)	PR 1KD	Diesel	FWD	1598	77	105	02.13-08.18	■
1.6 TDI (CRKB)	PR 1KD	Diesel	FWD	1598	81	110	09.13-11.16	■
1.6 TDI (CXXB)	PR 1KD	Diesel	FWD	1598	81	110	09.13-11.16	■
1.6 TDI (DDYA)		Diesel	FWD	1598	85	115	11.16-08.18	■
2.0 TDI	PR 1KD, 05/13-	Diesel	FWD	1968	81	110	02.13-	■
2.0 TDI (CRVA)		Diesel	FWD	1968	81	110	02.13-08.18	■
2.0 TDI (CRVC)	PR 1KD	Diesel	FWD	1968	105	143	05.13-08.18	■
2.0 TDI (CKFC)	PR 1KD	Diesel	FWD	1968	110	150	02.13-08.18	■
2.0 TDI (CRMB)	PR 1KD	Diesel	FWD	1968	110	150	02.13-08.18	■
2.0 TDI (CUNA)	PR 1KD	Diesel	FWD	1968	135	184	03.13-08.18	■
2.0 TDI (CUPA)	PR 1KD	Diesel	FWD	1968	135	184	03.13-08.18	■
LEON III ST (5F8) 01.13-					Estate Van (Compact car-C Segment)			
1.0 TSI (CHZD)		Gasolina	FWD	999	85	115	05.15-08.20	■
1.2 TSI (CJZB)		Gasolina	FWD	1197	63	86	01.13-08.18	■
1.2 TSI (CYVA)		Gasolina	FWD	1197	63	86	01.13-08.18	■
1.2 TSI (CYVB)		Gasolina	FWD	1197	81	110	05.14-08.18	■
1.4 TSI (CZDA)		Gasolina	FWD	1395	110	150	05.14-08.20	■
1.4 TSI (CZEA)		Gasolina	FWD	1395	110	150	05.14-08.20	■
1.8 TFSI (CJSA)		Gasolina	FWD	1798	132	180	10.13-08.18	■
1.6 TDI (CRKB)		Diesel	FWD	1598	81	110	09.13-08.20	■
1.6 TDI (CXXB)		Diesel	FWD	1598	81	110	09.13-08.20	■
1.6 TDI (DBKA)		Diesel	FWD	1598	81	110	09.13-08.20	■
1.6 TDI (DDYA)		Diesel	FWD	1598	85	115	11.16-08.20	■
2.0 TDI (CKFC)		Diesel	FWD	1968	110	150	04.13-08.18	■
2.0 TDI (CRBC)		Diesel	FWD	1968	110	150	04.13-08.18	■
2.0 TDI (CRLB)		Diesel	FWD	1968	110	150	04.13-08.18	■
2.0 TDI (CRMB)		Diesel	FWD	1968	110	150	04.13-08.18	■
2.0 TDI (CUNA)		Diesel	FWD	1968	135	184	08.13-08.18	■
2.0 TDI (CUPA)		Diesel	FWD	1968	135	184	08.13-08.18	■
LEON III ST (5F8) 09.12-					Estate (Compact car-C Segment)			
1.0 TSI (DKLB)		Gasolina	FWD	999	63	86	09.18-08.20	■
1.0 TSI (CHZD)	PR 1KD	Gasolina	FWD	999	85	115	05.15-08.20	■
1.0 TSI (DKRF)	PR 1KD	Gasolina	FWD	999	85	115	05.15-08.20	■
1.2 TSI (CJZB)	PR 1KD	Gasolina	FWD	1197	63	86	11.13-08.18	■
1.2 TSI (CYVA)	PR 1KD	Gasolina	FWD	1197	63	86	11.13-08.18	■
1.2 TSI (CJZA)	PR 1KD	Gasolina	FWD	1197	77	105	08.13-08.20	■
1.2 TSI (CYVB)	PR 1KD	Gasolina	FWD	1197	81	110	05.14-08.20	■
1.4 TSI (CMBA)	PR 1KD	Gasolina	FWD	1395	90	122	09.12-06.15	■
1.4 TSI (CXSA)	PR 1KD	Gasolina	FWD	1395	90	122	09.12-06.15	■
1.4 TSI (CZCA)	PR 1KD	Gasolina	FWD	1395	92	125	05.14-08.18	■
1.4 TSI (CHPA)	PR 1KD	Gasolina	FWD	1395	103	140	10.13-08.20	■
1.4 TSI (CPTA)	PR 1KD	Gasolina	FWD	1395	103	140	10.13-08.20	■
1.4 TSI (CZEA)	PR 1KD	Gasolina	FWD	1395	110	150	05.14-08.20	■
1.5 TSI (DACA)		Gasolina	FWD	1495	96	130	09.18-08.20	■
1.5 TSI (DPBA)		Gasolina	FWD	1495	96	130	09.18-08.20	■
1.5 TSI (DADA)		Gasolina	FWD	1498	110	150	09.18-08.20	■
1.5 TSI (DPCA)		Gasolina	FWD	1498	110	150	09.18-08.20	■
1.8 TSI (CJSA)	PR 1KD	Gasolina	FWD	1798	132	180	10.13-08.18	■
1.8 TSI 4Drive (CJSA)	PR 1KD	Gasolina	4WD	1798	132	180	11.14-08.18	■
1.8 TSI 4Drive (CJSB)	PR 1KD	Gasolina	4WD	1798	132	180	11.14-08.18	■

LISTA DE APLICACIONES - BUYERS GUIDE

2.0 TSI (DKZA)		Gasolina	FWD	1984	140	190	07.18-08.20	■
2.0 TSI 4Drive (DKZA)		Gasolina	4WD	1984	140	190	09.18-08.20	■
2.0 Cupra (CJXE)	PR 1KD	Gasolina	FWD	1984	195	265	10.13-08.20	■
2.0 Cupra (CJXA)	PR 1KD	Gasolina	FWD	1984	206	280	10.13-08.20	■
2.0 Cupra (CJXH)	PR 1KD	Gasolina	FWD	1984	213	290	10.15-08.20	■
2.0 Cupra (DNUC)	PR 1KD	Gasolina	FWD	1984	213	290	10.15-08.20	■
1.4 TGI (CPWA)	PR 1KD	Gasol./Gas (CNG)	FWD	1395	81	110	10.13-08.18	■
1.5 TGI (DHFA)		Gasol./Gas (CNG)	FWD	1498	96	131	10.18-08.20	■
1.6 TDI (CLHB)	PR 1KD	Diesel	FWD	1598	66	90	11.13-08.18	■
1.6 TDI (CXXA)	PR 1KD	Diesel	FWD	1598	66	90	11.13-08.18	■
1.6 TDI (DDYB)	PR 1KD	Diesel	FWD	1598	66	90	11.13-08.18	■
1.6 TDI (CLHA)	PR 1KD	Diesel	FWD	1598	77	105	10.13-08.20	■
1.6 TDI 4Drive (CLHA)	PR 1KD	Diesel	4WD	1598	77	105	04.14-08.20	■
1.6 TDI (CRKB)	PR 1KD	Diesel	FWD	1598	81	110	09.13-08.20	■
1.6 TDI (CXXB)	PR 1KD	Diesel	FWD	1598	81	110	09.13-08.20	■
1.6 TDI (DBKA)	PR 1KD	Diesel	FWD	1598	81	110	09.13-08.20	■
1.6 TDI 4Drive (CXXB)	PR 1KD	Diesel	4WD	1598	81	110	11.14-08.20	■
1.6 TDI (DDYA)		Diesel	FWD	1598	85	115	11.16-08.20	■
1.6 TDI (DGTE)		Diesel	FWD	1598	85	115	11.16-08.20	■
1.6 TDI 4Drive (DGTE)		Diesel	4WD	1598	85	115	07.18-08.20	■
2.0 TDI (CRVA)	PR 1KD	Diesel	FWD	1968	81	110	02.13-12.16	■
2.0 TDI (CRVC)	PR 1KD	Diesel	FWD	1968	105	143	10.13-08.18	■
2.0 TDI (CKFC)	PR 1KD	Diesel	FWD	1968	110	150	10.13-08.20	■
2.0 TDI (CRBC)	PR 1KD	Diesel	FWD	1968	110	150	10.13-08.20	■
2.0 TDI (CRLB)	PR 1KD	Diesel	FWD	1968	110	150	10.13-08.20	■
2.0 TDI (CRMB)	PR 1KD	Diesel	FWD	1968	110	150	10.13-08.20	■
2.0 TDI (DFFA)	PR 1KD	Diesel	FWD	1968	110	150	10.13-08.20	■
2.0 TDI (DFGA)	PR 1KD	Diesel	FWD	1968	110	150	10.13-08.20	■
2.0 TDI 4Drive (CRBC)	PR 1KD	Diesel	4WD	1968	110	150	04.14-08.20	■
2.0 TDI 4Drive (CRLB)	PR 1KD	Diesel	4WD	1968	110	150	04.14-08.20	■
2.0 TDI 4Drive (CRMB)	PR 1KD	Diesel	4WD	1968	110	150	04.14-08.20	■
2.0 TDI 4Drive (DCYA)	PR 1KD	Diesel	4WD	1968	110	150	04.14-08.20	■
2.0 TDI 4Drive (DFGA)	PR 1KD	Diesel	4WD	1968	110	150	04.14-08.20	■
2.0 TDI (CUNA)	PR 1KD	Diesel	FWD	1968	135	184	08.13-08.20	■
2.0 TDI (CUPA)	PR 1KD	Diesel	FWD	1968	135	184	08.13-08.20	■
2.0 TDI (DJGA)	PR 1KD	Diesel	FWD	1968	135	184	08.13-08.20	■
2.0 TDI 4Drive (CUNA)	PR 1KD	Diesel	4WD	1968	135	184	11.14-08.18	■
2.0 TDI 4Drive (DJGA)	PR 1KD	Diesel	4WD	1968	135	184	11.14-08.18	■
TOLEDO III (5P2) 04.04-05.09					MPV (Large MPV-M1 Segment)			
1.4 16V (BXW)	PR 1KD, -03/09	Gasolina	FWD	1390	63	86	05.06-05.09	■
1.4 TSI (CAXC)		Gasolina	FWD	1390	92	125	11.07-05.09	■
1.6 (BGU)	PR 1KD, -03/09	Gasolina	FWD	1595	75	102	10.04-05.09	■
1.6 (BSE)	PR 1KD, -03/09	Gasolina	FWD	1595	75	102	10.04-05.09	■
1.6 (BSF)	PR 1KD, -03/09	Gasolina	FWD	1595	75	102	10.04-05.09	■
1.6 (CCSA)	PR 1KD, -03/09	Gasolina	FWD	1595	75	102	10.04-05.09	■
1.8 TFSI (BYT)	PR 1KD, -03/09	Gasolina	FWD	1798	118	160	01.07-05.09	■
1.8 TFSI (BZB)	PR 1KD, -03/09	Gasolina	FWD	1798	118	160	01.07-05.09	■
1.8 TFSI (CDAA)	PR 1KD, -03/09	Gasolina	FWD	1798	118	160	01.07-05.09	■
2.0 FSI (BLR)	PR 1KD, -03/09	Gasolina	FWD	1984	110	150	10.04-05.09	■

LISTA DE APLICACIONES - BUYERS GUIDE

2.0 FSI (BLY)	PR 1KD, -03/09	Gasolina	FWD	1984	110	150	10.04-05.09	■
2.0 FSI (BVY)	PR 1KD, -03/09	Gasolina	FWD	1984	110	150	10.04-05.09	■
2.0 FSI (BVZ)	PR 1KD, -03/09	Gasolina	FWD	1984	110	150	10.04-05.09	■
2.0 TFSI (BWA)	PR 1KD, -03/09	Gasolina	FWD	1984	147	200	11.05-05.09	■
1.9 TDI (BJB)	PR 1KD, -03/09	Diesel	FWD	1896	77	105	10.04-05.09	■
1.9 TDI (BKC)	PR 1KD, -03/09	Diesel	FWD	1896	77	105	10.04-05.09	■
1.9 TDI (BLS)	PR 1KD, -03/09	Diesel	FWD	1896	77	105	10.04-05.09	■
1.9 TDI (BXE)	PR 1KD, -03/09	Diesel	FWD	1896	77	105	10.04-05.09	■
2.0 TDI (AZV)	PR 1KD, 10/04-, -03/09	Diesel	FWD	1968	100	136	09.04-05.09	■
2.0 TDI (BMM)	PR 1KD, -03/09	Diesel	FWD	1968	103	140	11.05-05.09	■
2.0 TDI 16V (BKD)	PR 1KD, 10/04-, -03/09	Diesel	FWD	1968	103	140	04.04-05.09	■
2.0 TDI (BMN)	PR 1KD, -03/09	Diesel	FWD	1968	125	170	01.06-05.09	■
2.0 TDI (CEGA)	PR 1KD, -03/09	Diesel	FWD	1968	125	170	01.06-05.09	■
SKODA								
OCTAVIA II / LAURA (1Z3) 02.04-06.13					Hatchback (Compact car-C Segment)			
1.2 TSI (CBZB)	PR 1KD	Gasolina	FWD	1197	77	105	02.10-06.13	■
1.4 (BCA)	PR 1KD, 06/04-	Gasolina	FWD	1390	55	75	05.04-05.06	■
1.4 (BUD)	PR 1KD, -01/13	Gasolina	FWD	1390	59	80	06.04-04.13	■
1.4 (CGGA)	PR 1KD, -01/13	Gasolina	FWD	1390	59	80	06.04-04.13	■
1.4 TSI (CAXA)	PR 1KD, -01/13	Gasolina	FWD	1390	90	122	11.08-06.13	■
1.6 (BGU)	PR 1KD, -01/13	Gasolina	FWD	1595	75	102	06.04-06.13	■
1.6 (BSE)	PR 1KD, -01/13	Gasolina	FWD	1595	75	102	06.04-06.13	■
1.6 (BSF)	PR 1KD, -01/13	Gasolina	FWD	1595	75	102	06.04-06.13	■
1.6 (CCSA)	PR 1KD, -01/13	Gasolina	FWD	1595	75	102	06.04-06.13	■
1.6 (CMXA)	PR 1KD, -01/13	Gasolina	FWD	1595	75	102	06.04-06.13	■
1.6 FSI (BLF)	PR 1KD, 06/04-	Gasolina	FWD	1598	85	115	02.04-10.08	■
1.8 T	PR 1KD	Gasolina	FWD	1781	110	150	09.05-12.08	■
1.8 TSI (CDAB)	PR 1KD, -01/13	Gasolina	FWD	1798	112	152	03.09-06.13	■
1.8 TSI (BZB)	PR 1KD, -01/13	Gasolina	FWD	1798	118	160	06.07-04.13	■
1.8 TSI (CDAA)	PR 1KD, -01/13	Gasolina	FWD	1798	118	160	06.07-04.13	■
2.0 FSI (BLR)	PR 1KD	Gasolina	FWD	1984	110	150	11.04-10.08	■
2.0 FSI (BLY)	PR 1KD	Gasolina	FWD	1984	110	150	11.04-10.08	■
2.0 FSI (BVY)	PR 1KD	Gasolina	FWD	1984	110	150	11.04-10.08	■
2.0 FSI (BVZ)	PR 1KD	Gasolina	FWD	1984	110	150	11.04-10.08	■
1.6 LPG (BSE)	PR 1KD	Gasol./Gas (LPG)	FWD	1595	75	102	08.09-11.12	■
1.6 LPG (CHGA)	PR 1KD	Gasol./Gas (LPG)	FWD	1595	75	102	08.09-11.12	■
1.6 MultiFuel (CCSA)	PR 1KD, 09/09-, -01/13	Gasol./Etanol	FWD	1595	75	102	01.08-06.13	■
1.6 MultiFuel (CMXA)	PR 1KD, 09/09-, -01/13	Gasol./Etanol	FWD	1595	75	102	01.08-06.13	■
1.6 TDI (CAYC)	PR 1KD, -01/13	Diesel	FWD	1598	77	105	06.09-04.13	■
1.9 TDI (BJB)	PR 1KD	Diesel	FWD	1896	77	105	06.04-12.10	■
1.9 TDI (BKC)	PR 1KD	Diesel	FWD	1896	77	105	06.04-12.10	■
1.9 TDI (BLS)	PR 1KD	Diesel	FWD	1896	77	105	06.04-12.10	■
1.9 TDI (BXE)	PR 1KD	Diesel	FWD	1896	77	105	06.04-12.10	■
2.0 TDI (CFHF)	PR 1KD	Diesel	FWD	1968	81	110	03.10-06.13	■
2.0 TDI (CLCA)	PR 1KD	Diesel	FWD	1968	81	110	03.10-06.13	■
2.0 TDI (AZV)	PR 1KD	Diesel	FWD	1968	100	136	02.04-05.10	■
2.0 TDI (BMM)	PR 1KD	Diesel	FWD	1968	103	140	11.05-05.10	■
2.0 TDI 16V (BKD)	PR 1KD, 06/04-, -01/13	Diesel	FWD	1968	103	140	02.04-04.13	■
2.0 TDI 16V (CFHC)	PR 1KD, 06/04-, -01/13	Diesel	FWD	1968	103	140	02.04-04.13	■

LISTA DE APLICACIONES - BUYERS GUIDE

2.0 TDI 16V (CLCB)	PR 1KD, 06/04-, -01/13	Diesel	FWD	1968	103	140	02.04-04.13	■
OCTAVIA II Combi (1Z5) 02.04-06.13					Estate (Compact car-C Segment)			
1.2 TSI (CBZB)	PR 1KD	Gasolina	FWD	1197	77	105	02.10-04.13	■
1.4 (BCA)	PR 1KD, 06/04-	Gasolina	FWD	1390	55	75	05.04-05.06	■
1.4 (BUD)	PR 1KD	Gasolina	FWD	1390	59	80	05.06-06.13	■
1.4 (CGGA)	PR 1KD	Gasolina	FWD	1390	59	80	05.06-06.13	■
1.4 TSI (CAXA)	PR 1KD	Gasolina	FWD	1390	90	122	11.08-06.13	■
1.6 (BGU)	PR 1KD	Gasolina	FWD	1595	75	102	09.04-06.13	■
1.6 (BSE)	PR 1KD	Gasolina	FWD	1595	75	102	09.04-06.13	■
1.6 (BSF)	PR 1KD	Gasolina	FWD	1595	75	102	09.04-06.13	■
1.6 (CCSA)	PR 1KD	Gasolina	FWD	1595	75	102	09.04-06.13	■
1.6 (CMXA)	PR 1KD	Gasolina	FWD	1595	75	102	09.04-06.13	■
1.6 FSI (BLF)	PR 1KD	Gasolina	FWD	1598	85	115	02.04-10.08	■
1.8 TSI (CDAB)	PR 1KD, -01/13	Gasolina	FWD	1798	112	152	03.09-06.13	■
1.8 TSI 4x4 (CDAB)	PR 1KD	Gasolina	4WD	1798	112	152	03.09-02.13	■
1.8 TSI (BZB)	PR 1KD, -01/13	Gasolina	FWD	1798	118	160	06.07-04.13	■
1.8 TSI (CDAA)	PR 1KD, -01/13	Gasolina	FWD	1798	118	160	06.07-04.13	■
2.0 FSI (BLR)	PR 1KD	Gasolina	FWD	1984	110	150	11.04-10.08	■
2.0 FSI (BLY)	PR 1KD	Gasolina	FWD	1984	110	150	11.04-10.08	■
2.0 FSI (BVY)	PR 1KD	Gasolina	FWD	1984	110	150	11.04-10.08	■
2.0 FSI (BVZ)	PR 1KD	Gasolina	FWD	1984	110	150	11.04-10.08	■
1.6 LPG (CHGA)	PR 1KD, 09/09-	Gasol./Gas (LPG)	FWD	1595	75	102	08.09-11.12	■
1.6 MultiFuel (CCSA)	PR 1KD, 09/09-	Gasol./Etanol	FWD	1595	75	102	01.08-06.13	■
1.6 MultiFuel (CMXA)	PR 1KD, 09/09-	Gasol./Etanol	FWD	1595	75	102	01.08-06.13	■
1.6 TDI (CAYC)	PR 1KD, -01/13	Diesel	FWD	1598	77	105	06.09-04.13	■
1.9 TDI (BJB)	PR 1KD	Diesel	FWD	1896	77	105	09.04-12.10	■
1.9 TDI (BKC)	PR 1KD	Diesel	FWD	1896	77	105	09.04-12.10	■
1.9 TDI (BLS)	PR 1KD	Diesel	FWD	1896	77	105	09.04-12.10	■
1.9 TDI (BXE)	PR 1KD	Diesel	FWD	1896	77	105	09.04-12.10	■
2.0 TDI (CFHF)	PR 1KD, -01/13	Diesel	FWD	1968	81	110	03.10-06.13	■
2.0 TDI (CLCA)	PR 1KD, -01/13	Diesel	FWD	1968	81	110	03.10-06.13	■
2.0 TDI 4x4 (CFHF)	PR 1KD, -01/13	Diesel	4WD	1968	81	110	05.11-02.13	■
2.0 TDI 16V (AZV)	PR 1KD, 06/04-	Diesel	FWD	1968	100	136	02.04-05.10	■
2.0 TDI (BMM)	PR 1KD	Diesel	FWD	1968	103	140	11.05-05.10	■
2.0 TDI 16V (BKD)	PR 1KD, 06/04-, -01/13	Diesel	FWD	1968	103	140	02.04-05.13	■
2.0 TDI 16V (CFHC)	PR 1KD, 06/04-, -01/13	Diesel	FWD	1968	103	140	02.04-05.13	■
2.0 TDI 16V (CLCB)	PR 1KD, 06/04-, -01/13	Diesel	FWD	1968	103	140	02.04-05.13	■
OCTAVIA III (5E3, NL3, NR3) 11.12-					Hatchback (Compact car-C Segment)			
1.0 TSI (CHZD)	PR 1KD	Gasolina	FWD	999	85	115	05.16-10.20	■
1.0 TSI (DKRA)	PR 1KD	Gasolina	FWD	999	85	115	05.16-10.20	■
1.0 TSI (DKRF)	PR 1KD	Gasolina	FWD	999	85	115	05.16-10.20	■
1.2 TSI (CJZB)	PR 1KD, -01/13	Gasolina	FWD	1197	63	86	11.12-02.17	■
1.2 TSI (CYVA)	PR 1KD, -01/13	Gasolina	FWD	1197	63	86	11.12-02.17	■
1.2 TSI (CJZA)	PR 1KD, -01/13	Gasolina	FWD	1197	77	105	11.12-02.17	■
1.2 TSI (CYVB)	PR 1KD	Gasolina	FWD	1197	81	110	05.15-02.17	■
1.4 TSI (CHPA)	PR 1KD	Gasolina	FWD	1395	103	140	11.12-02.17	■
1.4 TSI (CHPB)	PR 1KD, 05/15-	Gasolina	FWD	1395	110	150	08.14-10.20	■
1.4 TSI (CZDA)	PR 1KD, 05/15-	Gasolina	FWD	1395	110	150	08.14-10.20	■
1.6 (CWVA)	PR 1KD	Gasolina	FWD	1598	81	110	01.14-10.20	■

LISTA DE APLICACIONES - BUYERS GUIDE

1.8 TSI (CJSA)	PR 1KD	Gasolina	FWD	1798	132	180	11.12-10.20	■
1.8 TSI 4x4 (CJSB)	PR 1KD	Gasolina	4WD	1798	132	180	05.14-10.20	■
2.0 TSI RS (CHHB)	PR 1KD	Gasolina	FWD	1984	162	220	05.13-02.17	■
2.0 TSI RS (CHHA)	PR 1KD	Gasolina	FWD	1984	169	230	05.15-10.20	■
1.4 TSI G-TEC (CPWA)	PR 1KD	Gasol./Gas (CNG)	FWD	1395	81	110	11.13-02.17	■
1.6 TDI (CLHB)	PR 1KD, 02/13-	Diesel	FWD	1598	66	90	11.12-10.20	■
1.6 TDI (CRKA)	PR 1KD, 02/13-	Diesel	FWD	1598	66	90	11.12-10.20	■
1.6 TDI (CXXA)	PR 1KD, 02/13-	Diesel	FWD	1598	66	90	11.12-10.20	■
1.6 TDI (DDYB)	PR 1KD, 02/13-	Diesel	FWD	1598	66	90	11.12-10.20	■
1.6 TDI (CLHA)	PR 1KD, 02/13-	Diesel	FWD	1598	77	105	11.12-05.15	■
1.6 TDI 4x4 (CLHA)	PR 1KD	Diesel	4WD	1598	77	105	05.13-05.15	■
1.6 TDI (CRKB)	PR 1KD	Diesel	FWD	1598	81	110	05.13-02.17	■
1.6 TDI (CXXB)	PR 1KD	Diesel	FWD	1598	81	110	05.13-02.17	■
1.6 TDI (DBKA)	PR 1KD	Diesel	FWD	1598	81	110	05.13-02.17	■
1.6 TDI 4x4 (CRKB)	PR 1KD	Diesel	4WD	1598	81	110	05.15-02.17	■
1.6 TDI 4x4 (CXXB)	PR 1KD	Diesel	4WD	1598	81	110	05.15-02.17	■
2.0 TDI (CKFB)	PR 1KD	Diesel	FWD	1968	105	143	11.12-02.17	■
2.0 TDI (CRVC)	PR 1KD	Diesel	FWD	1968	105	143	11.12-02.17	■
2.0 TDI (CKFC)	PR 1KD	Diesel	FWD	1968	110	150	11.12-10.20	■
2.0 TDI (CRMB)	PR 1KD	Diesel	FWD	1968	110	150	11.12-10.20	■
2.0 TDI (CYKA)	PR 1KD	Diesel	FWD	1968	110	150	11.12-10.20	■
2.0 TDI (DCYA)	PR 1KD	Diesel	FWD	1968	110	150	11.12-10.20	■
2.0 TDI (DFFA)	PR 1KD	Diesel	FWD	1968	110	150	11.12-10.20	■
2.0 TDI 4x4 (CKFC)	PR 1KD	Diesel	4WD	1968	110	150	05.13-10.20	■
2.0 TDI 4x4 (CRMB)	PR 1KD	Diesel	4WD	1968	110	150	05.13-10.20	■
2.0 TDI 4x4 (DCYA)	PR 1KD	Diesel	4WD	1968	110	150	05.13-10.20	■
2.0 TDI 4x4 (DFFA)	PR 1KD	Diesel	4WD	1968	110	150	05.13-10.20	■
2.0 TDI / TDI RS 4x4 (CUNA)	PR 1KD	Diesel	4WD	1968	135	184	05.13-10.20	■
2.0 TDI / TDI RS 4x4 (CUPA)	PR 1KD	Diesel	4WD	1968	135	184	05.13-10.20	■
2.0 TDI / TDI RS 4x4 (DJGA)	PR 1KD	Diesel	4WD	1968	135	184	05.13-10.20	■
2.0 TDI RS (CUNA)	PR 1KD	Diesel	FWD	1968	135	184	05.13-10.20	■
2.0 TDI RS (CUPA)	PR 1KD	Diesel	FWD	1968	135	184	05.13-10.20	■
2.0 TDI RS (DJGA)	PR 1KD	Diesel	FWD	1968	135	184	05.13-10.20	■
OCTAVIA III Combi (5E5, 5E6) 11.12-					Estate (Compact car-C Segment)			
1.0 TSI (CHZD)	PR 1KD, PR 1ZQ	Gasolina	FWD	999	85	115	05.16-10.20	■
1.0 TSI (DKRA)	PR 1KD, PR 1ZQ	Gasolina	FWD	999	85	115	05.16-10.20	■
1.0 TSI (DKRF)	PR 1KD, PR 1ZQ	Gasolina	FWD	999	85	115	05.16-10.20	■
1.2 TSI (CJZB)	PR 1KD, 02/13-	Gasolina	FWD	1197	63	86	11.12-02.17	■
1.2 TSI (CYVA)	PR 1KD, 02/13-	Gasolina	FWD	1197	63	86	11.12-02.17	■
1.2 TSI (CJZA)	PR 1KD, 02/13-	Gasolina	FWD	1197	77	105	11.12-02.17	■
1.2 TSI (CYVB)	PR 1KD	Gasolina	FWD	1197	81	110	05.15-02.17	■
1.4 TSI (CHPA)	PR 1KD	Gasolina	FWD	1395	103	140	11.12-02.17	■
1.4 TSI (CHPB)	PR 1KD, 05/15-	Gasolina	FWD	1395	110	150	08.14-10.20	■
1.4 TSI (CZDA)	PR 1KD, 05/15-	Gasolina	FWD	1395	110	150	08.14-10.20	■
1.6 SRE (CWVA)	PR 1KD	Gasolina	FWD	1598	81	110	01.14-02.17	■
1.8 TSI (CJSA)	PR 1KD	Gasolina	FWD	1798	132	180	11.12-10.20	■
1.8 TSI (CJSB)	PR 1KD	Gasolina	FWD	1798	132	180	11.12-10.20	■
1.8 TSI 4x4 (CJSB)	PR 1KD	Gasolina	4WD	1798	132	180	11.12-02.17	■
2.0 TSI RS (CHHB)	PR 1KD, 02/13-	Gasolina	FWD	1984	162	220	11.12-02.17	■
2.0 TSI RS (CHHA)	PR 1KD	Gasolina	FWD	1984	169	230	05.15-10.20	■

LISTA DE APLICACIONES - BUYERS GUIDE

1.4 TSI G-TEC (CPWA)	PR 1KD	Gasol./Gas (CNG)	FWD	1395	81	110	11.12-02.17	■
1.6 TDI (CLHB)	PR 1KD, 02/13-	Diesel	FWD	1598	66	90	11.12-10.20	■
1.6 TDI (CRKA)	PR 1KD, 02/13-	Diesel	FWD	1598	66	90	11.12-10.20	■
1.6 TDI (CXXA)	PR 1KD, 02/13-	Diesel	FWD	1598	66	90	11.12-10.20	■
1.6 TDI (DDYB)	PR 1KD, 02/13-	Diesel	FWD	1598	66	90	11.12-10.20	■
1.6 TDI (CLHA)	PR 1KD, 02/13-	Diesel	FWD	1598	77	105	11.12-05.15	■
1.6 TDI 4x4 (CLHA)	PR 1KD	Diesel	4WD	1598	77	105	11.12-05.15	■
1.6 TDI (CRKB)	PR 1KD	Diesel	FWD	1598	81	110	05.13-02.17	■
1.6 TDI (CXXB)	PR 1KD	Diesel	FWD	1598	81	110	05.13-02.17	■
1.6 TDI (DBKA)	PR 1KD	Diesel	FWD	1598	81	110	05.13-02.17	■
1.6 TDI 4x4 (CRKB)	PR 1KD	Diesel	4WD	1598	81	110	05.15-02.17	■
1.6 TDI 4x4 (CXXB)	PR 1KD	Diesel	4WD	1598	81	110	05.15-02.17	■
1.6 TDI 4x4 (DBKA)	PR 1KD	Diesel	4WD	1598	81	110	05.15-02.17	■
2.0 TDI (CKFB)	PR 1KD	Diesel	FWD	1968	105	143	11.12-02.17	■
2.0 TDI (CRVC)	PR 1KD	Diesel	FWD	1968	105	143	11.12-02.17	■
2.0 TDI (CKFC)	PR 1KD, 02/13-	Diesel	FWD	1968	110	150	11.12-10.20	■
2.0 TDI (CRMB)	PR 1KD, 02/13-	Diesel	FWD	1968	110	150	11.12-10.20	■
2.0 TDI (CYKA)	PR 1KD, 02/13-	Diesel	FWD	1968	110	150	11.12-10.20	■
2.0 TDI (DCYA)	PR 1KD, 02/13-	Diesel	FWD	1968	110	150	11.12-10.20	■
2.0 TDI (DFFA)	PR 1KD, 02/13-	Diesel	FWD	1968	110	150	11.12-10.20	■
2.0 TDI 4x4 (CKFC)	PR 1KD	Diesel	4WD	1968	110	150	11.12-10.20	■
2.0 TDI 4x4 (CRMB)	PR 1KD	Diesel	4WD	1968	110	150	11.12-10.20	■
2.0 TDI 4x4 (DCYA)	PR 1KD	Diesel	4WD	1968	110	150	11.12-10.20	■
2.0 TDI 4x4 (DFFA)	PR 1KD	Diesel	4WD	1968	110	150	11.12-10.20	■
2.0 TDI / TDI RS 4x4 (CUNA)	PR 1KD	Diesel	4WD	1968	135	184	05.13-10.20	■
2.0 TDI / TDI RS 4x4 (CUPA)	PR 1KD	Diesel	4WD	1968	135	184	05.13-10.20	■
2.0 TDI / TDI RS 4x4 (DJGA)	PR 1KD	Diesel	4WD	1968	135	184	05.13-10.20	■
2.0 TDI RS (CUNA)	PR 1KD	Diesel	FWD	1968	135	184	05.13-10.20	■
2.0 TDI RS (CUPA)	PR 1KD	Diesel	FWD	1968	135	184	05.13-10.20	■
2.0 TDI RS (DJGA)	PR 1KD	Diesel	FWD	1968	135	184	05.13-10.20	■
YETI (5L) 05.09-					SUV (Mini SUV-J Segment)			
1.2 TSI (CBZB)	PR 1KD	Gasolina	FWD	1197	77	105	09.09-05.15	■
1.2 TSI (CYVB)	PR 1KD	Gasolina	FWD	1197	81	110	05.15-12.17	■
1.4 TSI (CAXA)	PR 1KD	Gasolina	FWD	1390	90	122	06.10-05.15	■
1.4 TSI (CZCA)	PR 1KD	Gasolina	FWD	1395	92	125	05.15-12.17	■
1.4 TSI 4x4 (CZDA)	PR 1KD	Gasolina	4WD	1395	110	150	05.15-12.17	■
1.6 (CWVA)	PR 1KD	Gasolina	FWD	1598	81	110	04.14-12.17	■
1.6 TDI (CAYC)	PR 1KD	Diesel	FWD	1598	77	105	11.10-05.15	■
2.0 TDI (CFHA)	PR 1KD	Diesel	FWD	1968	81	110	11.09-12.17	■
2.0 TDI (CLCA)	PR 1KD	Diesel	FWD	1968	81	110	11.09-12.17	■
2.0 TDI (CUUA)	PR 1KD	Diesel	FWD	1968	81	110	11.09-12.17	■
2.0 TDI (DFSA)	PR 1KD	Diesel	FWD	1968	81	110	11.09-12.17	■
2.0 TDI (CFHC)	PR 1KD	Diesel	FWD	1968	103	140	11.11-12.17	■
2.0 TDI (CLCB)	PR 1KD	Diesel	FWD	1968	103	140	11.11-12.17	■
2.0 TDI (CUUB)	PR 1KD	Diesel	FWD	1968	110	150	05.15-12.17	■
2.0 TDI (DFSB)	PR 1KD	Diesel	FWD	1968	110	150	05.15-12.17	■
2.0 TDI 4x4 (CUUB)	PR 1KD	Diesel	4WD	1968	110	150	05.15-12.17	■
2.0 TDI 4x4 (DFSB)	PR 1KD	Diesel	4WD	1968	110	150	05.15-12.17	■
SKODA (SVW)								

LISTA DE APLICACIONES - BUYERS GUIDE

OCTAVIA (913) 06.07-					Hatchback (Compact car-C Segment)			
1.6		Gasolina	FWD	1598	77	105	06.07-12.17	■
1.6		Gasolina	FWD	1598	77	105	01.10-12.15	■
1.8 TSI	PR 1KD	Gasolina	FWD	1798	118	160	06.07-03.14	■
YETI (0Y6, 0Y7) 11.13-					Closed Off-Road Vehicle (Mini SUV-J Segment)			
1.6	PR 1KD	Gasolina	FWD	1598	81	110	02.14-	■
VW								
BEETLE (5C7, 5C8) 12.11-					Convertible (Compact car-C Segment)			
1.2 TSI (CBZB)	PR 1KD, PR 1KU, 11/12-	Gasolina	FWD	1197	77	105	12.11-07.19	■
1.2 TSI 16V (CYVD)	PR 1KD, PR 1KU	Gasolina	FWD	1197	77	105	12.14-07.19	■
1.4 TSI (CAVD)	PR 1KD, PR 1KU, 11/12-	Gasolina	FWD	1390	118	160	12.11-07.16	■
1.4 TSI (CNWA)	PR 1KD, PR 1KU, 11/12-	Gasolina	FWD	1390	118	160	12.11-07.16	■
1.4 TSI (CTHD)	PR 1KD, PR 1KU, 11/12-	Gasolina	FWD	1390	118	160	12.11-07.16	■
1.4 TSI (CTKA)	PR 1KD, PR 1KU, 11/12-	Gasolina	FWD	1390	118	160	12.11-07.16	■
1.4 TSI (CZDA)	PR 1KD, PR 1KU	Gasolina	FWD	1395	110	150	12.14-09.18	■
1.8 TSI	PR 1KD, PR 1KU	Gasolina	FWD	1798	125	170	12.13-	■
2.0 TFSI (CBFA)	PR 1KD, PR 1KU, 11/12-	Gasolina	FWD	1984	147	200	12.11-07.16	■
2.0 TFSI (CCTA)	PR 1KD, PR 1KU, 11/12-	Gasolina	FWD	1984	147	200	12.11-07.16	■
2.0 TFSI (CCZA)	PR 1KD, PR 1KU, 11/12-	Gasolina	FWD	1984	147	200	12.11-07.16	■
2.0 TSI (CPLA)	PR 1KD, PR 1KU, 05/13-	Gasolina	FWD	1984	155	210	12.12-07.19	■
2.0 TSI (CPPA)	PR 1KD, PR 1KU, 05/13-	Gasolina	FWD	1984	155	210	12.12-07.19	■
2.0 TSI (CULC)	PR 1KD, PR 1KU	Gasolina	FWD	1984	162	220	12.14-09.18	■
2.5 (CBTA)	PR 1KD, PR 1KU, 12/12-	Gasolina	FWD	2480	125	170	12.11-07.16	■
2.5 (CBUA)	PR 1KD, PR 1KU, 12/12-	Gasolina	FWD	2480	125	170	12.11-07.16	■
2.5 (CCCA)	PR 1KD, PR 1KU, 12/12-	Gasolina	FWD	2480	125	170	12.11-07.16	■
1.6 TDI (CAYC)	PR 1KD, PR 1KU, 11/12-	Diesel	FWD	1598	77	105	12.11-07.16	■
2.0 TDI (CUUA)	PR 1KD, PR 1KU, 12/14-	Diesel	FWD	1968	81	110	06.14-09.18	■
2.0 TDI (CFFB)	PR 1KD, PR 1KU, 12/14-	Diesel	FWD	1968	103	140	04.12-07.16	■
2.0 TDI (CJAA)	PR 1KD, PR 1KU, 12/14-	Diesel	FWD	1968	103	140	04.12-07.16	■
2.0 TDI (CUUB)	PR 1KD, PR 1KU	Diesel	FWD	1968	110	150	09.14-09.18	■
2.0 TDI (CVCA)	PR 1KD, PR 1KU	Diesel	FWD	1968	110	150	09.14-09.18	■
2.0 TDI (DELA)	PR 1KD, PR 1KU	Diesel	FWD	1968	110	150	09.14-09.18	■
BEETLE / NOVO FUSCA (5C1, 5C2) 04.11-					Hatchback (Compact car-C Segment)			
1.2 TSI (CBZB)	PR 1KD, PR 1KU	Gasolina	FWD	1197	77	105	07.11-07.19	■
1.2 TSI 16V (CYVD)	PR 1KD, PR 1KU	Gasolina	FWD	1197	77	105	12.14-07.19	■
1.4 TSI (CAVD)	PR 1KD, PR 1KU	Gasolina	FWD	1390	118	160	10.11-07.16	■
1.4 TSI (CNWA)	PR 1KD, PR 1KU	Gasolina	FWD	1390	118	160	10.11-07.16	■
1.4 TSI (CTHD)	PR 1KD, PR 1KU	Gasolina	FWD	1390	118	160	10.11-07.16	■
1.4 TSI (CTKA)	PR 1KD, PR 1KU	Gasolina	FWD	1390	118	160	10.11-07.16	■
1.4 TSI (CZDA)	PR 1KD, PR 1KU	Gasolina	FWD	1395	110	150	12.14-07.19	■
2.0 TSI		Gasolina	FWD	1984	130	177	07.17-07.19	■
2.0 TFSI (CBFA)	PR 1KD, PR 1KU	Gasolina	FWD	1984	147	200	04.11-07.16	■
2.0 TFSI (CCTA)	PR 1KD, PR 1KU	Gasolina	FWD	1984	147	200	04.11-07.16	■
2.0 TFSI (CCZA)	PR 1KD, PR 1KU	Gasolina	FWD	1984	147	200	04.11-07.16	■
2.0 TSI (CPLA)	PR 1KD, PR 1KU, 05/13-	Gasolina	FWD	1984	155	211	12.12-07.19	■
2.0 TSI (CPPA)	PR 1KD, PR 1KU, 05/13-	Gasolina	FWD	1984	155	211	12.12-07.19	■
2.0 TSI (CULC)	PR 1KD, PR 1KU	Gasolina	FWD	1984	162	220	12.14-09.18	■
2.5 (CBTA)	PR 1KD, PR 1KU	Gasolina	FWD	2480	125	170	04.11-07.19	■
2.5 (CBUA)	PR 1KD, PR 1KU	Gasolina	FWD	2480	125	170	04.11-07.19	■

LISTA DE APLICACIONES - BUYERS GUIDE

2.5 (CCCA)	PR 1KD, PR 1KU	Gasolina	FWD	2480	125	170	04.11-07.19	■
1.6 TDI (CAYC)	PR 1KD, PR 1KU	Diesel	FWD	1598	77	105	10.11-07.16	■
2.0 TDI (CUUA)	PR 1KD, PR 1KU, 12/14-	Diesel	FWD	1968	81	110	06.14-09.18	■
2.0 TDI (CFFB)	PR 1KD, PR 1KU	Diesel	FWD	1968	103	140	04.11-07.16	■
2.0 TDI (CJAA)	PR 1KD, PR 1KU	Diesel	FWD	1968	103	140	04.11-07.16	■
2.0 TDI (CUUB)	PR 1KD, PR 1KU, 09/14-	Diesel	FWD	1968	110	150	07.14-09.18	■
2.0 TDI (CVCA)	PR 1KD, PR 1KU, 09/14-	Diesel	FWD	1968	110	150	07.14-09.18	■
2.0 TDI (DELA)	PR 1KD, PR 1KU, 09/14-	Diesel	FWD	1968	110	150	07.14-09.18	■
CADDY III (2KA, 2KH, 2CA, 2CH) 03.04-03.16					Box Body/MPV (LCVs-N1 Segment)			
1.2 TSI (CBZA)	PR 1ZF, PR 2E2	Gasolina	FWD	1197	63	86	09.10-05.15	■
1.2 TSI (CBZB)	PR 1ZF, PR 2E2	Gasolina	FWD	1197	77	105	09.10-05.15	■
1.4 (BUD)	PR 1ZF, PR 2E2, 12/07-	Gasolina	FWD	1390	59	80	05.06-08.10	■
1.6 (BGU)	PR 1ZF, PR 2E2, 12/07-	Gasolina	FWD	1595	75	102	04.04-05.15	■
1.6 (BSE)	PR 1ZF, PR 2E2, 12/07-	Gasolina	FWD	1595	75	102	04.04-05.15	■
1.6 (BSF)	PR 1ZF, PR 2E2, 12/07-	Gasolina	FWD	1595	75	102	04.04-05.15	■
1.6 BiFuel (CHGA)	PR 1ZF, PR 2E2	Gasol./Gas (LPG)	FWD	1595	75	102	05.11-05.15	■
1.6 TDI (CAYE)	PR 1ZF, PR 2E2	Diesel	FWD	1598	55	75	08.10-05.15	■
1.6 TDI (CAYD)	PR 1ZF, PR 2E2	Diesel	FWD	1598	75	102	08.10-05.15	■
1.9 TDI (BSU)	PR 1ZF, PR 2E2, 12/07-	Diesel	FWD	1896	55	75	09.05-08.10	■
1.9 TDI (BJB)	PR 1ZF, PR 2E2, 12/07-	Diesel	FWD	1896	77	105	04.04-08.10	■
1.9 TDI (BLS)	PR 1ZF, PR 2E2, 12/07-	Diesel	FWD	1896	77	105	04.04-08.10	■
1.9 TDI 4motion (BLS)	PR 1ZF, PR 2E2	Diesel	4WD	1896	77	105	11.08-08.10	■
2.0 SDI (BDJ)	PR 1ZF, PR 2E2, 12/07-	Diesel	FWD	1968	51	70	03.04-08.10	■
2.0 SDI (BST)	PR 1ZF, PR 2E2, 12/07-	Diesel	FWD	1968	51	70	03.04-08.10	■
2.0 TDI (CFHE)	PR 1ZF, PR 2E2	Diesel	FWD	1968	62	85	11.10-05.15	■
2.0 TDI 4motion (CFHE)	PR 1ZF, PR 2E2	Diesel	4WD	1968	62	85	12.10-05.15	■
2.0 TDI (CLCA)	PR 1ZF, PR 2E2, 10/10-	Diesel	FWD	1968	81	110	08.10-05.15	■
2.0 TDI 4motion (CFHF)	PR 1ZF, PR 2E2, 10/10-	Diesel	4WD	1968	81	110	08.10-05.15	■
2.0 TDI (BMM)	PR 1ZF, PR 2E2, 12/07-	Diesel	FWD	1968	103	140	09.07-08.10	■
2.0 TDI 16V (CFHC)	PR 1ZF, PR 2E2	Diesel	FWD	1968	103	140	11.10-05.15	■
2.0 TDI 16V (CLCB)	PR 1ZF, PR 2E2	Diesel	FWD	1968	103	140	11.10-05.15	■
2.0 TDI 16V 4motion (CFHC)	PR 1ZF, PR 2E2	Diesel	4WD	1968	103	140	11.10-05.15	■
2.0 TDI (CFJA)	PR 1ZF, PR 2E2	Diesel	FWD	1968	125	170	05.12-05.15	■
2.0 EcoFuel (BSX)	PR 1ZF, PR 2E2, 12/07-	CNG	FWD	1984	80	109	04.06-05.15	■
CADDY III (2KB, 2KJ, 2CB, 2CJ) 03.04-03.16					MPV (Mini MPV-M1 Segment)			
1.2 TSI (CBZA)	PR 1ZF, PR 2E2	Gasolina	FWD	1197	63	86	09.10-05.15	■
1.2 TSI (CBZB)	PR 1ZF, PR 2E2	Gasolina	FWD	1197	77	105	09.10-05.15	■
1.4 (BUD)	PR 1ZF, PR 2E2, 12/07-	Gasolina	FWD	1390	59	80	05.06-08.10	■
1.6	PR 1ZF, PR 2E2, 12/07-	Gasolina	FWD	1595	65	88	01.05-12.09	■
1.6	PR 1ZF, PR 2E2, 12/07-	Gasolina	FWD	1595	74	101	03.05-05.15	■
1.6 (BGU)	PR 1ZF, PR 2E2, 12/07-	Gasolina	FWD	1595	75	102	04.04-05.15	■
1.6 (BSE)	PR 1ZF, PR 2E2, 12/07-	Gasolina	FWD	1595	75	102	04.04-05.15	■
1.6 (BSF)	PR 1ZF, PR 2E2, 12/07-	Gasolina	FWD	1595	75	102	04.04-05.15	■
1.6 BiFuel (CHGA)	PR 1ZF, PR 2E2	Gasol./Gas (LPG)	FWD	1595	75	102	05.11-05.15	■
1.6 TDI (CAYE)	PR 1ZF, PR 2E2	Diesel	FWD	1598	55	75	08.10-05.15	■
1.6 TDI (CAYD)	PR 1ZF, PR 2E2	Diesel	FWD	1598	75	102	08.10-05.15	■
1.9 D	PR 1ZF, PR 2E2, 12/07-	Diesel	FWD	1896	48	65	10.05-06.09	■
1.9 TDI (BSU)	PR 1ZF, PR 2E2, 12/07-	Diesel	FWD	1896	55	75	09.05-08.10	■
1.9 TDI (BJB)	PR 1ZF, PR 2E2, 12/07-	Diesel	FWD	1896	77	105	04.04-08.10	■
1.9 TDI (BLS)	PR 1ZF, PR 2E2, 12/07-	Diesel	FWD	1896	77	105	04.04-08.10	■

LISTA DE APLICACIONES - BUYERS GUIDE

1.9 TDI 4motion (BLS)	PR 1ZF, PR 2E2	Diesel	4WD	1896	77	105	05.08-08.10	■
2.0 SDI (BDJ)	PR 1ZF, PR 2E2, 12/07-	Diesel	FWD	1968	51	70	03.04-08.10	■
2.0 SDI (BST)	PR 1ZF, PR 2E2, 12/07-	Diesel	FWD	1968	51	70	03.04-08.10	■
2.0 TDI (CLCA)	PR 1ZF, PR 2E2	Diesel	FWD	1968	81	110	08.10-05.15	■
2.0 TDI 4motion (CFHF)	PR 1ZF, PR 2E2, 10/10-	Diesel	4WD	1968	81	110	08.10-05.15	■
2.0 TDI (BMM)	PR 1ZF, PR 2E2, 12/07-	Diesel	FWD	1968	103	140	09.07-08.10	■
2.0 TDI 16V (CFHC)	PR 1ZF, PR 2E2	Diesel	FWD	1968	103	140	11.10-05.15	■
2.0 TDI 16V (CLCB)	PR 1ZF, PR 2E2	Diesel	FWD	1968	103	140	11.10-05.15	■
2.0 TDI 16V 4motion (CFHC)	PR 1ZF, PR 2E2	Diesel	4WD	1968	103	140	11.10-05.15	■
2.0 TDI (CFJA)	PR 1ZF, PR 2E2	Diesel	FWD	1968	125	170	05.12-05.15	■
2.0 EcoFuel (BSX)	PR 1ZF, PR 2E2, 12/07-	CNG	FWD	1984	80	109	04.06-05.15	■
EOS (1F7, 1F8) 03.06-08.15					Convertible (Compact car-C Segment)			
1.4 TSI (CAXA)	PR 1KD	Gasolina	FWD	1390	90	122	11.07-08.15	■
1.4 TSI		Gasolina	FWD	1390	92	125	11.13-	■
1.4 TSI (CAVD)	PR 1KD	Gasolina	FWD	1390	118	160	05.08-08.15	■
1.4 TSI (CTHD)	PR 1KD	Gasolina	FWD	1390	118	160	05.08-08.15	■
1.4 TSI		Gasolina	FWD	1395	110	150	11.13-	■
1.6 FSI (BLF)	PR 1KD	Gasolina	FWD	1598	85	115	06.06-05.08	■
2.0 FSI (BVY)	PR 1KD, 12/07-	Gasolina	FWD	1984	110	150	03.06-05.08	■
2.0 FSI (BVZ)	PR 1KD, 12/07-	Gasolina	FWD	1984	110	150	03.06-05.08	■
2.0 TFSI (BPY)	PR 1KD, 12/07-	Gasolina	FWD	1984	147	200	03.06-08.15	■
2.0 TFSI (BWA)	PR 1KD, 12/07-	Gasolina	FWD	1984	147	200	03.06-08.15	■
2.0 TFSI (CAWB)	PR 1KD, 12/07-	Gasolina	FWD	1984	147	200	03.06-08.15	■
2.0 TFSI (CBFA)	PR 1KD, 12/07-	Gasolina	FWD	1984	147	200	03.06-08.15	■
2.0 TFSI (CCTA)	PR 1KD, 12/07-	Gasolina	FWD	1984	147	200	03.06-08.15	■
2.0 TFSI (CCZA)	PR 1KD, 12/07-	Gasolina	FWD	1984	147	200	03.06-08.15	■
2.0 TSI (CCZB)	PR 1KD	Gasolina	FWD	1984	155	210	11.09-08.15	■
2.0 TFSI	PR 1KD	Gasolina	FWD	1984	162	220	11.13-08.15	■
3.2 V6 (BUB)	PR 1KD	Gasolina	FWD	3189	184	250	06.06-05.09	■
3.2 V6 (CBRA)	PR 1KD	Gasolina	FWD	3189	184	250	06.06-05.09	■
3.6 V6 (CDVA)	PR 1KD	Gasolina	FWD	3597	191	260	05.09-11.10	■
2.0 TDI (CFFA)	PR 1KD	Diesel	FWD	1968	100	136	11.10-08.15	■
2.0 TDI (BMM)	PR 1KD	Diesel	FWD	1968	103	140	06.06-05.08	■
2.0 TDI 16V (CBAB)	PR 1KD	Diesel	FWD	1968	103	140	05.08-08.15	■
2.0 TDI 16V (CFFB)	PR 1KD	Diesel	FWD	1968	103	140	05.08-08.15	■
GOLF V / RABBIT V (1K1) 07.03-					Hatchback Van ()			
TDI	PR 1KD	Diesel	FWD	1896	77	105	11.03-02.06	■
GOLF V / RABBIT V (1K1) 10.03-07.10					Hatchback (Compact car-C Segment)			
1.4 16V (BCA)	PR 1KD	Gasolina	FWD	1390	55	75	10.03-05.06	■
1.4 16V (BUD)	PR 1KD	Gasolina	FWD	1390	59	80	05.06-11.08	■
1.4 FSI (BKG)	PR 1KD	Gasolina	FWD	1390	66	90	10.03-07.06	■
1.4 FSI (BLN)	PR 1KD	Gasolina	FWD	1390	66	90	10.03-07.06	■
1.4 TSI (CAXA)	PR 1KD, -09/08	Gasolina	FWD	1390	90	122	05.07-11.08	■
1.4 TSI (BMY)	PR 1KD, -09/08	Gasolina	FWD	1390	103	140	05.06-11.08	■
1.4 TSI (BLG)	PR 1KD, -09/08	Gasolina	FWD	1390	125	170	11.05-11.08	■
1.6		Gasolina	FWD	1595	67	91	08.05-	■
1.6 (BGU)	PR 1KD, -09/08	Gasolina	FWD	1595	75	102	01.04-11.08	■
1.6 (BSE)	PR 1KD, -09/08	Gasolina	FWD	1595	75	102	01.04-11.08	■
1.6 (BSF)	PR 1KD, -09/08	Gasolina	FWD	1595	75	102	01.04-11.08	■
1.6 (CCSA)	PR 1KD, -09/08	Gasolina	FWD	1595	75	102	01.04-11.08	■

LISTA DE APLICACIONES - BUYERS GUIDE

1.6 FSI (BAG)	PR 1KD	Gasolina	FWD	1598	85	115	10.03-07.08	■
1.6 FSI (BLF)	PR 1KD	Gasolina	FWD	1598	85	115	10.03-07.08	■
1.6 FSI (BLP)	PR 1KD	Gasolina	FWD	1598	85	115	10.03-07.08	■
2.0 (BHY)		Gasolina	FWD	1984	85	116	01.05-11.08	■
2.0 (CBPA)		Gasolina	FWD	1984	85	116	01.05-11.08	■
2.0 FSI (AXW)	Rim 16, PR 1KD, -09/08	Gasolina	FWD	1984	110	150	01.04-11.08	■
2.0 FSI (BLR)	Rim 16, PR 1KD, -09/08	Gasolina	FWD	1984	110	150	01.04-11.08	■
2.0 FSI (BLX)	Rim 16, PR 1KD, -09/08	Gasolina	FWD	1984	110	150	01.04-11.08	■
2.0 FSI (BLY)	Rim 16, PR 1KD, -09/08	Gasolina	FWD	1984	110	150	01.04-11.08	■
2.0 FSI (BVX)	Rim 16, PR 1KD, -09/08	Gasolina	FWD	1984	110	150	01.04-11.08	■
2.0 FSI (BVY)	Rim 16, PR 1KD, -09/08	Gasolina	FWD	1984	110	150	01.04-11.08	■
2.0 FSI (BVZ)	Rim 16, PR 1KD, -09/08	Gasolina	FWD	1984	110	150	01.04-11.08	■
2.0 FSI 4motion (BLX)	Rim 16	Gasolina	4WD	1984	110	150	08.04-11.08	■
2.0 FSI 4motion (BVX)	Rim 16	Gasolina	4WD	1984	110	150	08.04-11.08	■
2.0 GTI (AXX)	PR 1KD, -09/08	Gasolina	FWD	1984	147	200	10.04-02.09	■
2.0 GTI (BPY)	PR 1KD, -09/08	Gasolina	FWD	1984	147	200	10.04-02.09	■
2.0 GTI (BWA)	PR 1KD, -09/08	Gasolina	FWD	1984	147	200	10.04-02.09	■
2.0 GTI (CAWB)	PR 1KD, -09/08	Gasolina	FWD	1984	147	200	10.04-02.09	■
2.0 GTI (CBFA)	PR 1KD, -09/08	Gasolina	FWD	1984	147	200	10.04-02.09	■
2.0 GTI (CCTA)	PR 1KD, -09/08	Gasolina	FWD	1984	147	200	10.04-02.09	■
2.0 GTI (BYD)	PR 1KD, -09/08	Gasolina	FWD	1984	169	230	09.06-12.08	■
2.5		Gasolina	FWD	2480	125	170	05.07-11.08	■
1.6 MultiFuel (CCSA)	PR 1KD, -09/08	Gasol./Etanol	FWD	1595	75	102	10.07-11.08	■
1.6 FSI		Gasol./eléc.	FWD	1598	74	101	02.06-	■
1.9 SDI		Diesel	RWD	1896	47	64	12.05-	■
1.9 TDI (BRU)	PR 1KD, -09/08	Diesel	FWD	1896	66	90	05.04-11.08	■
1.9 TDI (BXF)	PR 1KD, -09/08	Diesel	FWD	1896	66	90	05.04-11.08	■
1.9 TDI (BXJ)	PR 1KD, -09/08	Diesel	FWD	1896	66	90	05.04-11.08	■
1.9 TDI (BKC)	PR 1KD, -09/08	Diesel	FWD	1896	77	105	10.03-11.08	■
1.9 TDI (BLS)	PR 1KD, -09/08	Diesel	FWD	1896	77	105	10.03-11.08	■
1.9 TDI (BXE)	PR 1KD, -09/08	Diesel	FWD	1896	77	105	10.03-11.08	■
1.9 TDI 4motion (BKC)		Diesel	4WD	1896	77	105	08.04-11.08	■
1.9 TDI 4motion (BLS)		Diesel	4WD	1896	77	105	08.04-11.08	■
1.9 TDI 4motion (BXE)		Diesel	4WD	1896	77	105	08.04-11.08	■
2.0 SDI (BDK)	PR 1KD, -09/08	Diesel	FWD	1968	55	75	01.04-11.08	■
2.0 TDI (AZV)	PR 1KD, -09/08	Diesel	FWD	1968	100	136	10.03-11.08	■
2.0 TDI (BMM)	PR 1KD, -09/08	Diesel	FWD	1968	103	140	12.04-11.08	■
2.0 TDI 16V (BKD)	PR 1KD, -09/08	Diesel	FWD	1968	103	140	10.03-11.08	■
2.0 TDI 16V 4motion (BKD)		Diesel	4WD	1968	103	140	08.04-11.08	■
2.0 TDI 4motion (BMM)		Diesel	4WD	1968	103	140	01.07-11.08	■
2.0 TDI (BMN)	PR 1KD, -09/08	Diesel	FWD	1968	125	170	11.05-11.08	■
GOLF VI / JETTA VI (517) 03.11-					Convertible (Compact car-C Segment)			
1.2 TSI (CBZB)	PR 1KD, 06/11-	Gasolina	FWD	1197	77	105	03.11-05.16	■
1.2 TSI 16V (CJZA)	PR 1KD	Gasolina	FWD	1197	77	105	11.13-05.16	■
1.2 TSI 16V (CYVD)	PR 1KD	Gasolina	FWD	1197	77	105	11.13-05.16	■
1.4 TSI (CAXA)	PR 1KD	Gasolina	FWD	1390	90	122	11.11-05.16	■
1.4 TSI (CAVD)	PR 1KD, 06/11-	Gasolina	FWD	1390	118	160	03.11-05.16	■
1.4 TSI (CNWA)	PR 1KD, 06/11-	Gasolina	FWD	1390	118	160	03.11-05.16	■
1.4 TSI (CTHD)	PR 1KD, 06/11-	Gasolina	FWD	1390	118	160	03.11-05.16	■
1.4 TSI (CTKA)	PR 1KD, 06/11-	Gasolina	FWD	1390	118	160	03.11-05.16	■

LISTA DE APLICACIONES - BUYERS GUIDE

1.4 TSI (CXSB)	PR 1KD	Gasolina	FWD	1395	92	125	11.13-05.16	■
1.4 TSI (CZCA)	PR 1KD	Gasolina	FWD	1395	92	125	11.13-05.16	■
1.4 TSI (CHPB)	PR 1KD	Gasolina	FWD	1395	110	150	11.13-05.16	■
1.4 TSI (CZDA)	PR 1KD	Gasolina	FWD	1395	110	150	11.13-05.16	■
2.0 GTI (CCZB)	PR 1KD	Gasolina	FWD	1984	155	211	05.12-05.16	■
2.0 TSI (CULC)	PR 1KD	Gasolina	FWD	1984	162	220	11.13-05.16	■
2.0 R (CDLA)	PR 1KD	Gasolina	FWD	1984	195	265	01.13-05.16	■
1.6 TDI (CAYC)	PR 1KD, 06/11-	Diesel	FWD	1598	77	105	03.11-05.16	■
2.0 TDI (CUUA)	PR 1KD	Diesel	FWD	1968	81	110	11.13-05.16	■
2.0 TDI (CFHC)	PR 1KD	Diesel	FWD	1968	103	140	11.11-05.16	■
2.0 TDI (CUUB)	PR 1KD	Diesel	FWD	1968	110	150	11.13-05.16	■
GOLF VI / JETTA VI (5K1_) 10.08-11.12					Hatchback Van (Compact car-C Segment)			
1.2 TSI (CBZA)	PR 1KD	Gasolina	FWD	1197	63	86	05.10-11.12	■
1.2 TSI (CBZB)	PR 1KD	Gasolina	FWD	1197	77	105	11.09-08.14	■
1.2 TSi BlueMotion (CBZB)	PR 1KD	Gasolina	FWD	1197	77	105	05.09-11.12	■
1.4 TSI (CAXA)	PR 1KD	Gasolina	FWD	1390	90	122	01.09-08.14	■
TSi (CAXA)	PR 1KD	Gasolina	FWD	1390	90	122	10.08-11.12	■
1.4 TSI (CAVD)	PR 1KD	Gasolina	FWD	1390	118	160	10.08-11.12	■
1.4 TSI (CAVD)	PR 1KD	Gasolina	FWD	1390	118	160	01.09-09.12	■
2.0 GTI (CCZB)	PR 1KD	Gasolina	FWD	1984	155	211	02.09-11.12	■
1.6 TDI (CAYB)	PR 1KD	Diesel	FWD	1598	66	90	02.09-11.12	■
1.6 TDI (CAYB)	PR 1KD	Diesel	FWD	1598	66	90	02.09-08.14	■
1.6 TDI (CAYC)	PR 1KD	Diesel	FWD	1598	77	105	02.09-08.14	■
1.6 TDi BlueMotion (CAYC)	PR 1KD	Diesel	FWD	1598	77	105	05.09-11.12	■
2.0 TDI (CFFB)	PR 1KD	Diesel	FWD	1968	103	140	09.09-11.12	■
2.0 TDI (CJAA)	PR 1KD	Diesel	FWD	1968	103	140	09.09-11.12	■
2.0 TDI (CFHC)	PR 1KD	Diesel	FWD	1968	103	140	11.09-08.14	■
GOLF VI / JETTA VI (5K1) 10.08-12.14					Hatchback (Compact car-C Segment)			
1.2 TSI (CBZA)	PR 1KD	Gasolina	FWD	1197	63	86	05.10-11.12	■
1.2 TSI (CBZB)	PR 1KD, 05/09-	Gasolina	FWD	1197	77	105	11.08-11.12	■
1.4 (CGGA)	PR 1KD	Gasolina	FWD	1390	59	80	10.08-11.12	■
1.4 TSI (CAXA)	PR 1KD	Gasolina	FWD	1390	90	122	10.08-11.12	■
1.4 TSI (CAVD)	PR 1KD	Gasolina	FWD	1390	118	160	10.08-11.12	■
1.4 TSI (CNWA)	PR 1KD	Gasolina	FWD	1390	118	160	10.08-11.12	■
1.4 TSI (CTHD)	PR 1KD	Gasolina	FWD	1390	118	160	10.08-11.12	■
1.6 (BSE)	PR 1KD	Gasolina	FWD	1595	75	102	10.08-11.12	■
1.6 (BSF)	PR 1KD	Gasolina	FWD	1595	75	102	10.08-11.12	■
1.6 (CCSA)	PR 1KD	Gasolina	FWD	1595	75	102	10.08-11.12	■
1.6 (CMXA)	PR 1KD	Gasolina	FWD	1595	75	102	10.08-11.12	■
1.8 TSI (CDAA)	PR 1KD	Gasolina	FWD	1798	118	160	06.09-01.11	■
2.0 GTI (CCZB)	PR 1KD	Gasolina	FWD	1984	155	210	04.09-11.12	■
2.0 GTI (CDLG)	PR 1KD	Gasolina	FWD	1984	173	235	05.11-11.12	■
2.5 (CBTA)		Gasolina	FWD	2480	125	170	07.09-05.13	■
2.5 (CBUA)		Gasolina	FWD	2480	125	170	07.09-05.13	■
1.6 BiFuel (CHGA)	PR 1KD	Gasol./Gas (LPG)	FWD	1595	75	102	03.09-11.12	■
1.6 MultiFuel (CCSA)	PR 1KD	Gasol./Etanol	FWD	1595	75	102	10.08-11.12	■
1.6 MultiFuel (CMXA)	PR 1KD	Gasol./Etanol	FWD	1595	75	102	10.08-11.12	■
Blue E-Motion (EAA)		Eléctrico	FWD		65	88	12.10-11.13	■
1.6 TDI (CAYB)	PR 1KD	Diesel	FWD	1598	66	90	02.09-11.12	■

LISTA DE APLICACIONES - BUYERS GUIDE

1.6 TDI (CAYC)	PR 1KD	Diesel	FWD	1598	77	105	02.09-11.12	■
2.0 TDI (CBDC)	PR 1KD	Diesel	FWD	1968	81	110	10.08-11.12	■
2.0 TDI (CLCA)	PR 1KD	Diesel	FWD	1968	81	110	10.08-11.12	■
2.0 TDI (CBAA)	PR 1KD	Diesel	FWD	1968	100	136	10.08-11.12	■
2.0 TDI (CFFA)	PR 1KD	Diesel	FWD	1968	100	136	10.08-11.12	■
2.0 TDI (CBAB)	PR 1KD	Diesel	FWD	1968	103	140	10.08-05.13	■
2.0 TDI (CFFB)	PR 1KD	Diesel	FWD	1968	103	140	10.08-05.13	■
2.0 TDI (CJAA)	PR 1KD	Diesel	FWD	1968	103	140	10.08-05.13	■
2.0 TDI (CBBB)	PR 1KD	Diesel	FWD	1968	125	170	04.09-11.12	■
2.0 TDI (CFGB)	PR 1KD	Diesel	FWD	1968	125	170	04.09-11.12	■
GOLF VI VAN Variant / JETTA VI (AJ5) 07.09-05.14					Estate Van (Compact car-C Segment)			
1.2 TSI (CBZB)	PR 1KD	Gasolina	FWD	1197	77	105	09.09-05.14	■
1.4 TSI (CAXA)	PR 1KD	Gasolina	FWD	1390	90	122	07.09-05.14	■
1.4 TSI (CAVD)	PR 1KD	Gasolina	FWD	1390	118	160	07.09-10.12	■
1.6 TDi BlueMotion (CAYC)	PR 1KD	Diesel	FWD	1598	77	105	07.09-05.14	■
2.0 TDI (CBDB)	PR 1KD	Diesel	FWD	1968	103	140	07.09-05.14	■
2.0 TDI (CFHC)	PR 1KD	Diesel	FWD	1968	103	140	07.09-05.14	■
GOLF VI Variant / JETTA VI (AJ5) 07.09-07.14					Estate (Compact car-C Segment)			
1.6 BiFuel (BSF)	PR 1KD	Gasol./Gas (LPG)	FWD	1595	75	102	07.09-12.10	■
1.6 MultiFuel (CMXA)		Gasol./Etanol	FWD	1595	75	102	07.10-07.13	■
GOLF PLUS V (5M1, 521) 12.04-12.13					Hatchback (Compact car-C Segment)			
1.2 TSI (CBZA)	PR 1KD	Gasolina	FWD	1197	63	86	05.10-12.13	■
1.2 TSI (CBZB)	PR 1KD	Gasolina	FWD	1197	77	105	11.09-12.13	■
1.4 16V (BCA)	PR 1KD	Gasolina	FWD	1390	55	75	01.05-11.06	■
1.4 16V (BUD)	PR 1KD	Gasolina	FWD	1390	59	80	05.06-12.13	■
1.4 16V (CGGA)	PR 1KD	Gasolina	FWD	1390	59	80	05.06-12.13	■
1.4 FSI (BLN)	PR 1KD	Gasolina	FWD	1390	66	90	07.05-11.06	■
1.4 TSI (CAXA)	PR 1KD	Gasolina	FWD	1390	90	122	06.07-12.13	■
1.4 TSI (BMY)	PR 1KD	Gasolina	FWD	1390	103	140	05.06-06.08	■
1.4 TSI (CAVD)	PR 1KD	Gasolina	FWD	1390	118	160	06.08-12.13	■
1.4 TSI (CNWA)	PR 1KD	Gasolina	FWD	1390	118	160	06.08-12.13	■
1.4 TSI (CTHD)	PR 1KD	Gasolina	FWD	1390	118	160	06.08-12.13	■
1.4 TSI (BLG)	PR 1KD	Gasolina	FWD	1390	125	170	05.06-06.08	■
1.6		Gasolina	FWD	1595	67	91	08.05-	■
1.6 (BSE)	PR 1KD	Gasolina	FWD	1595	75	102	05.05-12.13	■
1.6 (BSF)	PR 1KD	Gasolina	FWD	1595	75	102	05.05-12.13	■
1.6 (CCSA)	PR 1KD	Gasolina	FWD	1595	75	102	05.05-12.13	■
1.6 (CMXA)	PR 1KD	Gasolina	FWD	1595	75	102	05.05-12.13	■
1.6 FSI (BLF)	PR 1KD	Gasolina	FWD	1598	85	115	12.04-05.08	■
2.0 FSI (BLR)	PR 1KD	Gasolina	FWD	1984	110	150	05.05-06.08	■
2.0 FSI (BLY)	PR 1KD	Gasolina	FWD	1984	110	150	05.05-06.08	■
2.0 FSI (BVY)	PR 1KD	Gasolina	FWD	1984	110	150	05.05-06.08	■
2.0 FSI (BVZ)	PR 1KD	Gasolina	FWD	1984	110	150	05.05-06.08	■
1.6 BiFuel (CHGA)	PR 1KD	Gasol./Gas (LPG)	FWD	1595	75	102	05.09-12.13	■
1.6 MultiFuel (CCSA)	PR 1KD	Gasol./Etanol	FWD	1595	75	102	11.07-12.13	■
1.6 MultiFuel (CMXA)	PR 1KD	Gasol./Etanol	FWD	1595	75	102	11.07-12.13	■
1.6 TDI (CAYB)	PR 1KD	Diesel	FWD	1598	66	90	02.09-12.13	■
1.6 TDI (CAYC)	PR 1KD	Diesel	FWD	1598	77	105	03.09-12.13	■

LISTA DE APLICACIONES - BUYERS GUIDE

1.9 SDI		Diesel	RWD	1896	47	64	12.05-	■
1.9 TDI (BRU)	PR 1KD, PR 1ZF	Diesel	FWD	1896	66	90	05.05-12.08	■
1.9 TDI (BXF)	PR 1KD, PR 1ZF	Diesel	FWD	1896	66	90	05.05-12.08	■
1.9 TDI (BXJ)	PR 1KD, PR 1ZF	Diesel	FWD	1896	66	90	05.05-12.08	■
1.9 TDI (BKC)	PR 1KD, PR 1ZF	Diesel	FWD	1896	77	105	01.05-01.09	■
1.9 TDI (BLS)	PR 1KD, PR 1ZF	Diesel	FWD	1896	77	105	01.05-01.09	■
1.9 TDI (BXE)	PR 1KD, PR 1ZF	Diesel	FWD	1896	77	105	01.05-01.09	■
2.0 TDI (CBDC)	PR 1KD	Diesel	FWD	1968	81	110	01.09-12.13	■
2.0 TDI (CLCA)	PR 1KD	Diesel	FWD	1968	81	110	01.09-12.13	■
2.0 TDI (BEE)	PR 1KD	Diesel	FWD	1968	96	131	05.05-05.07	■
2.0 TDI (AZV)	PR 1KD	Diesel	FWD	1968	100	136	05.05-12.13	■
2.0 TDI (CBDA)	PR 1KD	Diesel	FWD	1968	100	136	05.05-12.13	■
2.0 TDI (CFHB)	PR 1KD	Diesel	FWD	1968	100	136	05.05-12.13	■
2.0 TDI (BMM)	PR 1KD	Diesel	FWD	1968	103	140	12.05-05.11	■
2.0 TDI 16V (BKD)	PR 1KD	Diesel	FWD	1968	103	140	01.05-12.13	■
2.0 TDI 16V (CBDB)	PR 1KD	Diesel	FWD	1968	103	140	01.05-12.13	■
2.0 TDI 16V (CFHC)	PR 1KD	Diesel	FWD	1968	103	140	01.05-12.13	■
JETTA VI / VENTO (162, 163, AV3, AV2) 01.08-					Saloon (Compact car-C Segment)			
1.2 TSI (CBZB)	PR 1KD, PR 1KV, 04/11-	Gasolina	FWD	1197	77	105	10.10-12.17	■
1.2 TSI 16V (CYVD)		Gasolina	FWD	1197	77	105	08.14-12.17	■
1.4 TSI (CAXA)	PR 1KD, PR 1KV	Gasolina	FWD	1390	90	122	05.11-12.17	■
1.4 TSI (CMSB)	PR 1KD, PR 1KV	Gasolina	FWD	1390	90	122	05.11-12.17	■
1.4 TSI (CAVA)	PR 1KD, PR 1KV	Gasolina	FWD	1390	110	150	04.11-12.17	■
1.4 TSI (CTHA)	PR 1KD, PR 1KV	Gasolina	FWD	1390	110	150	04.11-12.17	■
1.4 TSI (CAVD)	PR 1KD, PR 1KV	Gasolina	FWD	1390	118	160	04.11-12.17	■
1.4 TSI (CTHD)	PR 1KD, PR 1KV	Gasolina	FWD	1390	118	160	04.11-12.17	■
1.4 TSI (CZCA)	PR 1KD, PR 1KV	Gasolina	FWD	1395	92	125	08.14-12.17	■
1.4 TSI (CZDA)	PR 1KD, PR 1KV	Gasolina	FWD	1395	110	150	08.14-12.17	■
1.4 TSI (CZTA)	PR 1KD, PR 1KV	Gasolina	FWD	1395	110	150	08.14-12.17	■
1.6 (CFNB)	PR 1KD, PR 1KV	Gasolina	FWD	1598	63	86	03.13-03.16	■
1.6 MPi (CWVB)		Gasolina	FWD	1598	66	90	09.15-04.18	■
1.6 (CFNA)	PR 1KD, PR 1KV	Gasolina	FWD	1598	77	105	12.11-04.18	■
1.6 (CLRA)	PR 1KD, PR 1KV	Gasolina	FWD	1598	77	105	12.11-04.18	■
1.6 (CWVA)		Gasolina	FWD	1598	81	110	09.15-04.18	■
1.8 TSI (CPKA)	PR 1KD, PR 1KV	Gasolina	FWD	1798	125	170	07.14-12.17	■
1.8 TSI (CPRA)	PR 1KD, PR 1KV	Gasolina	FWD	1798	125	170	07.14-12.17	■
2.0 (CBPA)	PR 1KD, PR 1KV	Gasolina	FWD	1984	85	115	06.10-12.17	■
2.0 (CKJA)	PR 1KD, PR 1KV	Gasolina	FWD	1984	85	115	06.10-12.17	■
2.0 TFSI (CBFA)	PR 1KD, PR 1KV, 04/11-	Gasolina	FWD	1984	147	200	12.10-07.14	■
2.0 TFSI (CCTA)	PR 1KD, PR 1KV, 04/11-	Gasolina	FWD	1984	147	200	12.10-07.14	■
2.0 TFSI (CCZA)	PR 1KD, PR 1KV, 04/11-	Gasolina	FWD	1984	147	200	12.10-07.14	■
2.0 TSI (CPLA)	PR 1KD, PR 1KV	Gasolina	FWD	1984	155	211	12.12-12.17	■
2.0 TSI (CPPA)	PR 1KD, PR 1KV	Gasolina	FWD	1984	155	211	12.12-12.17	■
2.5 (CBTA)		Gasolina	FWD	2480	125	170	04.10-12.17	■
2.5 (CBUA)		Gasolina	FWD	2480	125	170	04.10-12.17	■
2.5 (CCCA)		Gasolina	FWD	2480	125	170	04.10-12.17	■
2.0 Flex		Gasol./Etanol	FWD	1984	88	120	10.10-12.16	■
1.4 TSI Hybrid (CNLA)	PR 1KD, PR 1KV	Gasol./eléc.	FWD	1395	125	170	04.11-12.17	■
1.4 TSI Hybrid (CRJA)	PR 1KD, PR 1KV	Gasol./eléc.	FWD	1395	125	170	04.11-12.17	■
1.6 TDI (CAYC)	PR 1KD, PR 1KV, 04/11-	Diesel	FWD	1598	77	105	04.10-07.15	■

LISTA DE APLICACIONES - BUYERS GUIDE

2.0 TDI (CLCA)	PR 1KD, PR 1KV	Diesel	FWD	1968	81	110	10.10-12.17	■
2.0 TDI (CUUA)	PR 1KD, PR 1KV	Diesel	FWD	1968	81	110	10.10-12.17	■
2.0 TDI (CFFB)	PR 1KD, PR 1KV, 04/11-	Diesel	FWD	1968	103	140	02.11-12.17	■
2.0 TDI (CFHC)	PR 1KD, PR 1KV, 04/11-	Diesel	FWD	1968	103	140	02.11-12.17	■
2.0 TDI (CJAA)	PR 1KD, PR 1KV, 04/11-	Diesel	FWD	1968	103	140	02.11-12.17	■
2.0 TDI (CLCB)	PR 1KD, PR 1KV, 04/11-	Diesel	FWD	1968	103	140	02.11-12.17	■
2.0 TDI (CUUB)	PR 1KD, PR 1KV	Diesel	FWD	1968	110	150	07.14-12.17	■
2.0 TDI (CVCA)	PR 1KD, PR 1KV	Diesel	FWD	1968	110	150	07.14-12.17	■
2.0 TDI (DELA)	PR 1KD, PR 1KV	Diesel	FWD	1968	110	150	07.14-12.17	■
2.0 TDI (DGMA)	PR 1KD, PR 1KV	Diesel	FWD	1968	110	150	07.14-12.17	■
JETTA VII (BU3, BU4) 12.17-					Saloon (Compact car-C Segment)			
1.4 TSI (CWLA)		Gasolina	FWD	1395	110	150	12.17-	■
1.4 TSI (CZDA)		Gasolina	FWD	1395	110	150	12.17-	■
1.4 TSI (DGXA)		Gasolina	FWD	1395	110	150	12.17-	■
1.4 TSI (DJXA)		Gasolina	FWD	1395	110	150	12.17-	■
350 TSI		Gasolina	FWD	1984	169	230	12.18-	■
2.0 GLi		Gasolina	FWD	1984	170	231	12.18-	■
SCIROCCO III (137, 138) 05.08-					Coupe (Sport compact car-C Segment)			
1.4 TSI (CAXA)	PR 1KD, 09/08-	Gasolina	FWD	1390	90	122	08.08-11.17	■
1.4 TSI (CMSB)	PR 1KD, 09/08-	Gasolina	FWD	1390	90	122	08.08-11.17	■
1.4 TSI (CAVD)	PR 1KD, 08/08-	Gasolina	FWD	1390	118	160	05.08-11.17	■
1.4 TSI (CNWA)	PR 1KD, 08/08-	Gasolina	FWD	1390	118	160	05.08-11.17	■
1.4 TSI (CTHD)	PR 1KD, 08/08-	Gasolina	FWD	1390	118	160	05.08-11.17	■
1.4 TSI (CTKA)	PR 1KD, 08/08-	Gasolina	FWD	1390	118	160	05.08-11.17	■
1.4 TSI (CXSB)	PR 1KD	Gasolina	FWD	1395	92	125	11.13-11.17	■
1.4 TSI (CZCA)	PR 1KD	Gasolina	FWD	1395	92	125	11.13-11.17	■
1.4 TSI (CZDA)	PR 1KD	Gasolina	FWD	1395	110	150	07.15-11.17	■
2.0 TSI (CULA)	PR 1KD	Gasolina	FWD	1984	132	180	11.13-11.17	■
2.0 TFSI (CAWB)	PR 1KD, 08/08-	Gasolina	FWD	1984	147	200	05.08-11.09	■
2.0 TSI (CCZB)	PR 1KD	Gasolina	FWD	1984	155	210	11.09-11.17	■
2.0 TSI (CULC)	PR 1KD	Gasolina	FWD	1984	162	220	11.13-11.17	■
2.0 R (CDLC)	PR 1KD	Gasolina	FWD	1984	188	256	11.09-11.17	■
2.0 R (CDLA)	PR 1KD	Gasolina	FWD	1984	195	265	11.09-11.17	■
2.0 R (CDLK)	PR 1KD, 08/14-	Gasolina	FWD	1984	206	280	05.14-11.17	■
2.0 TDI (CFHB)	PR 1KD	Diesel	FWD	1968	100	136	11.10-11.17	■
2.0 TDI (CBDB)	PR 1KD	Diesel	FWD	1968	103	140	08.08-11.17	■
2.0 TDI (CFHC)	PR 1KD	Diesel	FWD	1968	103	140	08.08-11.17	■
2.0 TDI (CUUB)	PR 1KD	Diesel	FWD	1968	110	150	11.13-11.17	■
2.0 TDI (CBBB)	PR 1KD	Diesel	FWD	1968	125	170	05.09-11.17	■
2.0 TDI (CFGB)	PR 1KD	Diesel	FWD	1968	125	170	05.09-11.17	■
2.0 TDI (CFGC)	PR 1KD	Diesel	FWD	1968	130	177	01.13-11.17	■
2.0 TDI (CUWA)	PR 1KD	Diesel	FWD	1968	135	184	05.14-11.17	■
2.0 TDI (CUXA)	PR 1KD	Diesel	FWD	1968	135	184	05.14-11.17	■
SCIROCCO III (137) 06.08-05.14					Hatchback Van (Sport compact car-C Segment)			
1.4 TSI (CAXA)	PR 1KD, 09/08-	Gasolina	FWD	1390	90	122	08.08-05.14	■
1.4 TSI (CAVD)	PR 1KD, 08/08-	Gasolina	FWD	1390	118	160	06.08-05.14	■
2.0 TFSI (CCZB)	PR 1KD	Gasolina	FWD	1984	155	211	11.09-05.14	■
2.0 TDI (CBDB)	PR 1KD	Diesel	FWD	1968	103	140	08.08-05.14	■
2.0 TDI (CFHC)	PR 1KD	Diesel	FWD	1968	103	140	08.08-05.14	■
2.0 TDI (CBBB)	PR 1KD	Diesel	FWD	1968	125	170	05.09-05.14	■

LISTA DE APLICACIONES - BUYERS GUIDE

2.0 TDI (CFGB)	PR 1KD	Diesel	FWD	1968	125	170	05.09-05.14	■
VW (SVW)								
LAVIDA III (0C1, 0E1, 0C2) 05.18-					Saloon (Compact car-C Segment)			
200TSi		Gasolina	FWD	1197	85	116	06.22-	■
230 TSI		Gasolina	FWD	1395	95	130	05.18-	■
1.5		Gasolina	FWD	1498	81	110	04.23-	■