

# LISTA DE APLICACIONES - BUYERS GUIDE

## 78BD5923-2



Weight: 11.884

O.E.M.	MAKE
4614A190	MITSUBISHI
4615A115	MITSUBISHI
4615A190	MITSUBISHI
MN116329	MITSUBISHI
MN116330	MITSUBISHI

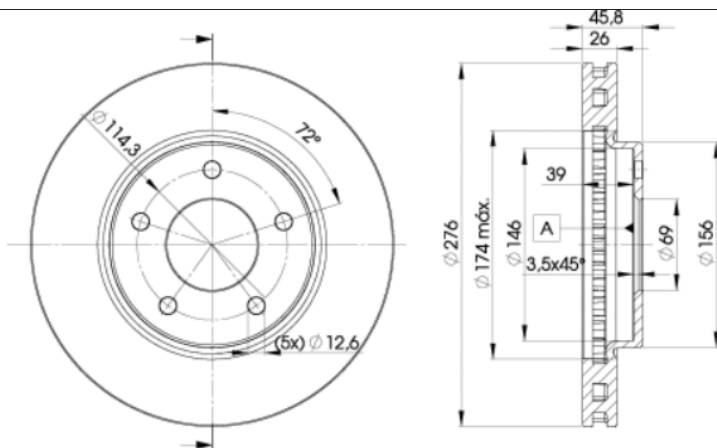

## 78BD5923-2

E1 90R-02C0538/0105



Ø276x26x45.5

MAKE
DODGE
MITSUBISHI



Trac.	CC	Kw	CV
-------	----	----	----



Front / Rear

### DODGE

#### AVENGER II 06.07-

#### Saloon (Sports car-S Segment)

2.4	Gasolina	FWD	2360	127	173	01.12-12.14	■
3.5 (EGF)	Gasolina	FWD	3518	175	238	06.07-12.09	■
3.5 AWD (EGF)	Gasolina	4WD	3518	175	238	06.07-12.11	■
3.5 AWD (EGJ)	Gasolina	4WD	3518	175	238	06.07-12.11	■
3.6 (ERB)	Gasolina	FWD	3605	211	287	01.12-12.14	■

#### CALIBER 06.06-

#### Hatchback (Compact car-C Segment)

2.4 AWD (ED3)	Gasolina	4WD	2359	125	170	10.06-	■
2.4 (ED3)	Gasolina	FWD	2359	126	172	10.06-	■
2.0 CRD (ECD)	Diesel	FWD	1968	88	120	06.06-11.11	■
2.0 CRD (ECD)	Diesel	FWD	1968	100	136	06.06-11.11	■

### MITSUBISHI

#### LANCER IV / CEDIA (CS\_A, CT\_A) 01.00-12.13

#### Saloon (Compact car-C Segment)

2.0 i (4B11)	Gasolina	FWD	1998	113	154	10.07-12.13	■
--------------	----------	-----	------	-----	-----	-------------	---

#### LANCER V EX / GALANT FORTIS / LANCER SERIE R / LANCER FORTIS (CY\_A, CZ\_A) 03.07-

#### Saloon (Compact car-C Segment)

1.5 (4A91)	Gasolina	FWD	1499	80	109	06.08-	■
1.6 MIVEC (4A92)	Gasolina	FWD	1590	86	117	05.10-	■
1.8 MIVEC (CY3A, CY6A) (4B10)	Gasolina	FWD	1798	102	139	03.09-	■
1.8 MIVEC (CY3A, CY6A) (4J10)	Gasolina	FWD	1798	102	139	03.09-	■
1.8 (CY3A, CY6A) (4B10)	Gasolina	FWD	1798	103	140	05.10-	■
1.8 (CY3A, CY6A) (4B10)	Gasolina	FWD	1798	105	143	02.08-	■
1.8 Mivec (4B10)	Gasolina	FWD	1798	110	150	11.09-	■

# LISTA DE APLICACIONES - BUYERS GUIDE

2.0 (4B11)		Gasolina	FWD	1998	108	147	01.09-	■
2.0 (CY4A) (4B11)		Gasolina	FWD	1998	110	150	01.13-	■
2.0 i (CY4A) (4B11)		Gasolina	FWD	1998	113	154	04.07-	■
2.0 i 4WD (CZ4A) (4B11)		Gasolina	4WD	1998	113	154	03.07-	■
2.0 Mivec		Gasolina	FWD	1998	115	155	09.07-	■
2.0 i (CY4A)		Gasolina	FWD	1998	118	160	10.09-	■
1.5 Bifuel (4A91)		Gasol./G as (LPG)	FWD	1499	80	109	02.10-	■
1.8 Bifuel (CY3A, CY6A) (4B10)		Gasol./G as (LPG)	FWD	1798	105	143	01.10-	■
1.8 Flexfuel (CY3A, CY6A) (4B10)		Gasol./Et anol	FWD	1798	103	140	03.09-	■
1.8 Flexfuel (CY3A) (4B10)		Gasol./Et anol	FWD	1798	105	143	01.10-	■
1.8 DI-D (4N13)		Diesel	FWD	1798	85	116	05.10-	■
1.8 DI-D (CY9A) (4N13)		Diesel	FWD	1798	110	150	06.10-	■
2.0 DI-D (CY8A) (BKD)		Diesel	FWD	1968	103	140	01.08-	■
2.0 DI-D (CY8A) (BWC)		Diesel	FWD	1968	103	140	01.08-	■
<b>LANCER V EX Sportback / GALANT FORTIS Sportback (CX_A) 10.07-</b>					<b>Hatchback (Compact car-C Segment)</b>			
1.5 (4A91)		Gasolina	FWD	1499	80	109	06.08-	■
1.6 MIVEC (4A92)		Gasolina	FWD	1590	86	117	05.10-	■
1.8 MIVEC (CX3A, CX6A) (4B10)		Gasolina	FWD	1798	103	140	03.09-	■
1.8 (CX3A) (4B10)		Gasolina	FWD	1798	105	143	06.08-	■
1.5 Bifuel (4A91)		Gasol./G as (LPG)	FWD	1499	80	109	03.10-	■
1.8 Bifuel (CX3A, CX6A) (4B10)		Gasol./G as (LPG)	FWD	1798	105	143	02.10-	■
1.8 Flex (CX3A, CX6A) (4B10)		Gasol./Et anol	FWD	1798	103	140	03.09-	■
1.8 DI-D (4N13)		Diesel	FWD	1798	85	116	05.10-	■
1.8 DI-D (CX9A) (4N13)		Diesel	FWD	1798	110	150	06.10-	■
2.0 DI-D (CX8A) (BKD)		Diesel	FWD	1968	103	140	06.08-	■
2.0 DI-D (CX8A) (BWC)		Diesel	FWD	1968	103	140	06.08-	■