

# LISTA DE APLICACIONES - BUYERS GUIDE

## 78BD5924-2



Weight: 13.560

O.E.M.	MAKE
16 063 757 80	PEUGEOT
16 114 298 80	PEUGEOT
4249.58	PEUGEOT
4249.59	PEUGEOT
4249.F3	PEUGEOT
45 15A 189	MITSUBISHI
46 15A 006	MITSUBISHI
46 15A 113	MITSUBISHI
46 15A 179	MITSUBISHI
MR 128 659	MITSUBISHI
MR 205 215	MITSUBISHI
MR 295 368	MITSUBISHI
MR 307 386	MITSUBISHI

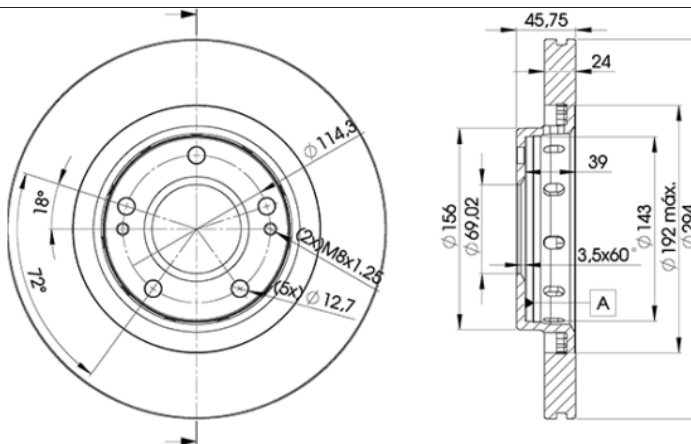

## 78BD5924-2

E1 90R-02C0433/0115



Ø294x24x45.7

MAKE
CITROËN
MITSUBISHI
PEUGEOT



Trac.	CC	Kw	CV		
					Front / Rear

### CITROËN

C-CROSSER (VU_) 02.07-12.12					SUV Van (Compact SUV-J Segment)			
2.2 HDi (VU4HNNH)	Diesel	4WD	2179	115	156	06.07-12.12	■	
C-CROSSER (VU_, VV_) 02.07-					SUV (Compact SUV-J Segment)			
2.0 (4B11)	Gasolina	FWD	1998	108	147	11.10-12.12	■	
2.0 Alas 4 ruedas (4B11)	Gasolina	4WD	1998	108	147	11.10-12.12	■	
2.4 16V (SFZ (4B12 MMC))	Gasolina	4WD	2360	125	170	08.08-12.12	■	
2.2 HDi (4HK (DW12ME5))	Diesel	4WD	2179	115	156	02.07-12.12	■	
2.2 HDi (4HN (DW12MTED4))	Diesel	4WD	2179	115	156	02.07-12.12	■	
C-CROSSER ENTERPRISE (VU_, VV_) 01.09-					SUV Van (Compact SUV-J Segment)			
2.4 16V (4B12)	Gasolina	4WD	2360	125	170	01.09-	■	
2.2 HDi (4HN (DW12MTED4))	Diesel	4WD	2179	115	156	01.09-	■	

### MITSUBISHI

LANCER III / LIBERO (CB_A, CD_A, CE_A) 07.91-12.96					Saloon (Supermini car-B Segment)			
EVO I (CD9A) (4G63 TURBO)	Gasolina	4WD	1997	184	250	10.92-12.93	■	
EVO II (CE9A) (4G63 TURBO)	Gasolina	4WD	1997	192	261	01.94-07.95	■	
EVO III (CE9A) (4G63 TURBO)	Gasolina	4WD	1997	198	269	08.95-07.96	■	
LANCER II-III (C6_A, C7_A) 04.88-12.97					Saloon (Supermini car-B Segment)			
EVO IV (CN9A) (4G63 TURBO)	Gasolina	4WD	1997	206	280	08.96-12.97	■	
LANCER V EX / GALANT FORTIS / LANCER SERIE R / LANCER FORTIS (CY_A, CZ_A) 03.07-					Saloon (Compact car-C Segment)			
2.0 EVO X	Gasolina	4WD	1998	296	402	06.09-	■	

# LISTA DE APLICACIONES - BUYERS GUIDE

LANCER V EX Sportback / GALANT FORTIS Sportback (CX_A) 10.07-					Hatchback (Compact car-C Segment)			
2.0 Ralliart 4WD (CX4A) (4B11-T/C)		Gasolina	4WD	1998	177	241	10.08-	■
OUTLANDER II (CW_W) 11.06-12.12					SUV Van (Compact SUV-J Segment)			
Di-D 4WD (CW8W)		Diesel	4WD	1968	103	140	12.06-06.10	■
Di-D 4WD (CW1W)		Diesel	4WD	2268	130	177	09.10-12.12	■
OUTLANDER II (CW_W) 09.05-12.12					SUV (Compact SUV-J Segment)			
2.0 (CW4W) (4B11)		Gasolina	FWD	1998	108	147	11.06-11.12	■
2.0 4WD (4B11)		Gasolina	4WD	1998	108	147	11.06-11.12	■
2.4 (CW5W) (4B12)		Gasolina	FWD	2360	125	170	11.06-11.12	■
2.4 4WD (CW5W) (4B12)		Gasolina	4WD	2360	125	170	09.07-11.12	■
3.0 4WD (CW6W) (6B31)		Gasolina	4WD	2998	162	220	11.06-11.12	■
3.0 AWD (6B31)		Gasolina	4WD	2998	164	223	11.06-12.10	■
3.0 4WD (CW6W) (6B31)		Gasolina	4WD	2998	169	230	09.10-12.12	■
3.0 AWD		Gasolina	4WD	2998	172	234	09.09-11.12	■
3.0		Gasolina	FWD	2998	177	241	10.09-11.12	■
2.4 Flex 4WD (4B12)		Gasol./Etanol	4WD	2360	125	170	09.07-11.12	■
2.0 DI-D (CW8W) (BSY)		Diesel	4WD	1968	103	140	02.07-11.12	■
2.2 DI-D 4WD (4HK)		Diesel	4WD	2179	115	156	08.07-11.12	■
2.2 DI-D 4WD (4HN)		Diesel	4WD	2179	115	156	08.07-11.12	■
2.2 DI-D 4WD (4N14)		Diesel	4WD	2268	103	140	09.10-11.12	■
2.2 DI-D (4N14)		Diesel	FWD	2268	130	177	11.06-11.12	■
2.2 DI-D 4WD (4N14)		Diesel	4WD	2268	130	177	11.06-11.12	■
OUTLANDER II (CW_W) 12.06-11.12					Van (Compact SUV-J Segment)			
2.0 DI-D		Diesel	RWD	1968	103	140	12.06-11.12	■
2.2 DI-D		Diesel	RWD	2268	130	177	09.10-11.12	■
OUTLANDER / AIRTREK (CU_W) 03.01-07.08					SUV (Compact SUV-J Segment)			
2.0 4WD (CU2W)		Gasolina	4WD	1997	93	126	05.03-10.06	■
2.0 (CU2W) (4G63 (DOHC 16V))		Gasolina	FWD	1997	100	136	05.03-10.06	■
2.0 4WD (CU2W) (4G63 (DOHC 16V))	vehicles with ABS	Gasolina	4WD	1997	100	136	05.03-10.06	■
2.0 Turbo 4WD (CU2W) (4G63-T (DOHC 16V))		Gasolina	4WD	1997	148	201	04.04-10.06	■
2.0 Turbo-R 4WD (CU2W) (4G63 TURBO)		Gasolina	4WD	1997	177	241	01.02-10.06	■
2.4 4WD (CU4W) (4G64 (16V))		Gasolina	4WD	2351	102	139	05.03-10.06	■
2.4 4WD (CU5W) (4G69)		Gasolina	4WD	2378	118	160	11.03-09.07	■
2.4 HDD Mivec (CU5W) (4G69)		Gasolina	FWD	2378	118	160	03.01-12.06	■
2.4 4WD (CU5W) (4G69)		Gasolina	4WD	2378	119	162	05.03-09.07	■
OUTLANDER III / PHEV III (GF_W, GG_W) 11.10-					SUV Van (Compact SUV-J Segment)			
Hybrid 4WD (GG3W)		Gasol./eléc.	4WD	2360	153	208	09.18-	■
Di-D 4WD (GF6W)		Diesel	4WD	2268	110	150	04.13-	■
OUTLANDER III / PHEV III (GG_W, GF_W, ZJ, ZL, ZK) 11.10-					SUV (Compact SUV-J Segment)			
2.0 (4B11)		Gasolina	FWD	1998	105	143	10.12-	■
2.0		Gasolina	FWD	1998	106	144	10.12-	■
2.0 (GF2W) (4B11)		Gasolina	FWD	1998	107	146	10.12-	■
2.0 4WD (GF7W, GF2W) (4B11)		Gasolina	4WD	1998	107	146	10.12-	■
2.0 (GF7W) (4J11)		Gasolina	FWD	1998	110	150	08.12-	■
2.0 4WD (GF7W) (4J11)		Gasolina	4WD	1998	110	150	08.12-	■
2.0 (GF7W) (4J11)		Gasolina	FWD	1998	112	152	04.13-	■
2.0 (GF7W)		Gasolina	FWD	1998	118	160	03.13-12.18	■

# LISTA DE APLICACIONES - BUYERS GUIDE

2.0 BiFuel		Gasol./Gas (LPG)	FWD	1998	107	146	10.12-	■
2.0 Bifuel 4WD		Gasol./Gas (LPG)	4WD	1998	107	146	10.12-	■
2.0 Hybrid 4WD (GG2W) (4B11)		Gasol./eléc.	4WD	1998	89	121	12.12-	■
2.0 Hybrid 4WD (GG2W) (S61)		Gasol./eléc.	4WD	1998	89	121	12.12-	■
2.0 Hybrid 4WD (GG2W) (Y61)		Gasol./eléc.	4WD	1998	89	121	12.12-	■
2.0 Hybrid 4WD (GG2W) (4B11)		Gasol./eléc.	4WD	1998	139	189	12.12-	■
2.0 Hybrid 4WD (GG2W) (S61)		Gasol./eléc.	4WD	1998	139	189	12.12-	■
2.0 Hybrid 4WD (GG2W) (Y61)		Gasol./eléc.	4WD	1998	139	189	12.12-	■
2.0 Hybrid 4WD (GG2W) (4B11)		Gasol./eléc.	4WD	1998	147	200	01.14-	■
2.0 Hybrid 4WD (GG2W) (S61)		Gasol./eléc.	4WD	1998	147	200	01.14-	■
2.0 Hybrid 4WD (GG2W) (Y61)		Gasol./eléc.	4WD	1998	147	200	01.14-	■
Plug-in Hybrid (GG2W)		Gasol./eléc.	4WD	1998	147	200	09.17-12.21	■
2.4 Hybrid 4WD (GG3W) (4B12)		Gasol./eléc.	4WD	2360	153	208	09.18-	■
2.2 DI-D (GF6W) (4N14)		Diesel	FWD	2268	110	150	08.12-	■
2.2 DI-D 4WD (GF6W) (4N14)		Diesel	4WD	2268	110	150	08.12-	■
2.2 DI-D 4WD (4N14)		Diesel	4WD	2268	121	165	06.15-12.18	■
2.2 DiD 4WD (4N14)		Diesel	4WD	2268	132	179	05.15-	■
PEUGEOT								
<b>4007 (VU_, VV_) 02.07-03.13</b>					<b>SUV Van (Compact SUV-J Segment)</b>			
HDi 155 (VU4HNNH, VV4HK8)		Diesel	4WD	2179	115	156	02.07-03.13	■
<b>4007 (VU_, VV_) 02.07-</b>					<b>SUV (Compact SUV-J Segment)</b>			
2.0 (4B11)		Gasolina	FWD	1998	108	147	11.10-03.13	■
2.0 4x4 (4B11)		Gasolina	4WD	1998	108	147	11.10-03.13	■
2.4 16V (SFY (4B12-MMC))		Gasolina	4WD	2360	125	170	02.07-03.13	■
2.4 16V (SFZ (4B12-MMC))		Gasolina	4WD	2360	125	170	02.07-03.13	■
2.2 HDi (4HK (DW12ME5))		Diesel	4WD	2179	115	156	02.07-03.13	■
2.2 HDi (4HN (DW12MTED4))		Diesel	4WD	2179	115	156	02.07-03.13	■