

LISTA DE APLICACIONES - BUYERS GUIDE

78BD6031-2



Weight: 16.600

O.E.M.	MAKE
40206-9X403	NISSAN

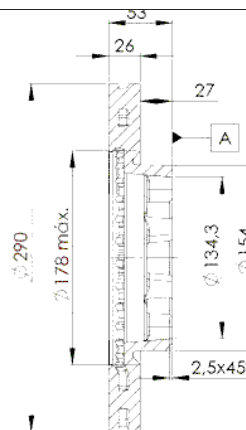
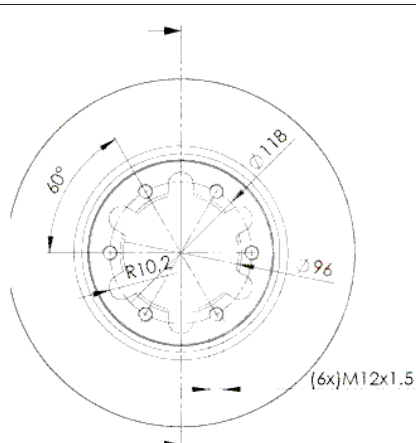

78BD6031-2

E4 90R-02C0728/2595



Ø290x26x53.5

MAKE
NISSAN



Trac.	CC	Kw	CV		
					Front / Rear

NISSAN

CABSTAR 09.06-12.12

						Platform/Chassis		
35.13 (YD25DDTI)		Diesel		2488	96	130	09.06-12.12	■
35.13 (YD25ETI)		Diesel		2488	96	130	09.06-12.12	■
45.13 (YD25DDTI)		Diesel		2488	96	130	10.06-	■
35.15 (ZD30H HD-5)		Diesel		2953	101	137	10.06-	■

CABSTAR E 10.98-10.06

						Platform/Chassis		
105.35, 110.35 (BD-30TI)		Diesel		2953	78	106	10.98-10.06	■
110.45 (BD-30TI)		Diesel		2953	78	106	10.98-10.06	■
120.45 (BD-30TI)		Diesel		2953	88	119	10.98-10.06	■

CABSTAR E (F24M, F24W) 09.06-12.13

						Platform/Chassis (LCVs-N1 Segment)		
28.11 DCI, 32.11 DCI, 35.11 DCI 2.5 (F24M) (YD25DDTI)		Diesel	RWD	2488	81	110	09.06-12.13	■
35.14 DCI 3.0 (F24M) (ZD30DDTI)		Diesel	RWD	2953	101	137	09.06-12.13	■

NT400 CABSTAR (F24M) 08.09-

						Platform/Chassis (LCVs-N1 Segment)		
35.14, 45.14 (YD25K3LD-5MI)		Diesel	RWD	2488	100	136	01.14-	■
35.15, 45.15 (YD25K3LD-5HO)		Diesel	RWD	2488	107	146	01.14-	■