

78BD6075-2

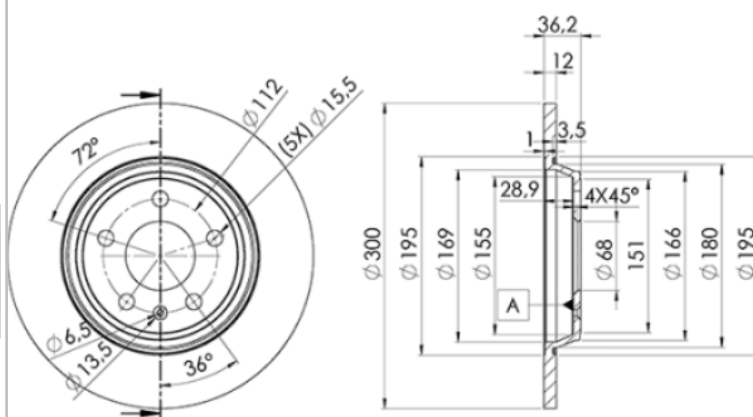

Weight: 10.940

| O.E.M. | MAKE |
|---------------|------|
| 80A 615 601 B | AUDI |
| 8K0 615 601 B | AUDI |
| 8W0 615 601 C | AUDI |
| 8W0 615 601 H | AUDI |



78BD6075-2

E1 90R-02C0415/0004



Ø300x12x36.4

| MAKE |
|-----------|
| AUDI |
| CHEVROLET |
| NISSAN |



| Trac. | CC | Kw | CV |
|-------|----|----|----|
|-------|----|----|----|



Front / Rear

AUDI

| A4 IV Allroad B8 (8KH) 04.09-06.17 | | | | | | Estate (Compact executive car-D Segment) | | | |
|------------------------------------|--------------------------------|----------|-----|------|-----|--|-------------|--|---|
| 2.0 TFSI quattro (CDNC) | PR 1KW | Gasolina | 4WD | 1984 | 155 | 211 | 04.09-05.16 | | ■ |
| 2.0 TFSI quattro (CPMA) | PR 1KW | Gasolina | 4WD | 1984 | 155 | 211 | 04.09-05.16 | | ■ |
| 2.0 TFSI quattro (CPMB) | PR 1KW, PR GP0, PR GP1, PR GP2 | Gasolina | 4WD | 1984 | 162 | 220 | 05.13-05.16 | | ■ |
| 2.0 TFSI quattro (CNCD) | PR 1KW, PR GP0, PR GP1, PR GP2 | Gasolina | 4WD | 1984 | 165 | 224 | 05.13-05.16 | | ■ |
| 2.0 TDI quattro (CAGB) | elec.brake detention, PR 1KW | Diesel | 4WD | 1968 | 100 | 136 | 09.09-05.16 | | ■ |
| 2.0 TDI quattro (CJCB) | elec.brake detention, PR 1KW | Diesel | 4WD | 1968 | 100 | 136 | 09.09-05.16 | | ■ |
| 2.0 TDI quattro (CSUB) | elec.brake detention, PR 1KW | Diesel | 4WD | 1968 | 100 | 136 | 09.09-05.16 | | ■ |
| 2.0 TDI quattro (CAGA) | elec.brake detention, PR 1KW | Diesel | 4WD | 1968 | 105 | 143 | 09.09-05.16 | | ■ |
| 2.0 TDI quattro (CJCA) | elec.brake detention, PR 1KW | Diesel | 4WD | 1968 | 105 | 143 | 09.09-05.16 | | ■ |
| 2.0 TDI quattro (CJCD) | PR 1KW, PR GP0, PR GP1, PR GP2 | Diesel | 4WD | 1968 | 110 | 150 | 05.13-05.16 | | ■ |
| 2.0 TDI quattro (CSUA) | PR 1KW, PR GP0, PR GP1, PR GP2 | Diesel | 4WD | 1968 | 110 | 150 | 05.13-05.16 | | ■ |
| 2.0 TDI quattro (CAHB) | PR 1KW | Diesel | 4WD | 1968 | 120 | 163 | 04.09-05.16 | | ■ |
| 2.0 TDI quattro (CGLD) | PR 1KW | Diesel | 4WD | 1968 | 120 | 163 | 04.09-05.16 | | ■ |
| 2.0 TDI quattro (CNHC) | PR 1KW | Diesel | 4WD | 1968 | 120 | 163 | 04.09-05.16 | | ■ |
| 2.0 TDI quattro (CAHA) | PR 1KW | Diesel | 4WD | 1968 | 125 | 170 | 04.09-05.16 | | ■ |
| 2.0 TDI quattro (CGLC) | PR 1KW, PR GP0, PR GP1, PR GP2 | Diesel | 4WD | 1968 | 130 | 177 | 11.11-05.16 | | ■ |
| 2.0 TDI quattro (CNHA) | PR 1KW, PR GP0, PR GP1, PR GP2 | Diesel | 4WD | 1968 | 140 | 190 | 09.13-05.16 | | ■ |
| 3.0 TDI quattro (CCWA) | PR 1KW | Diesel | 4WD | 2967 | 176 | 240 | 04.09-01.12 | | ■ |
| 3.0 TDI quattro (CDUC) | PR 1KW, PR GP0, PR GP1, PR GP2 | Diesel | 4WD | 2967 | 180 | 245 | 01.12-05.16 | | ■ |

LISTA DE APLICACIONES - BUYERS GUIDE

| | | | | | | | | |
|---------------------------------------|--------------------------------|---------------|-----|------|---|-----|-------------|---|
| 3.0 TDI quattro (CKVB) | PR 1KW, PR GP0, PR GP1, PR GP2 | Diesel | 4WD | 2967 | 180 | 245 | 01.12-05.16 | ■ |
| 3.0 TDI quattro (CKVC) | PR 1KW, PR GP0, PR GP1, PR GP2 | Diesel | 4WD | 2967 | 180 | 245 | 01.12-05.16 | ■ |
| A4 IV B8 (8K2) 08.07-06.17 | | | | | Saloon (Compact executive car-D Segment) | | | |
| 1.8 T | PR 1KW | Gasolina | FWD | 1781 | 110 | 150 | 07.08-05.10 | ■ |
| 1.8 TFSI (CABA) | PR 1KW | Gasolina | FWD | 1798 | 88 | 120 | 01.08-12.15 | ■ |
| 1.8 TFSI (CDHA) | PR 1KW | Gasolina | FWD | 1798 | 88 | 120 | 01.08-12.15 | ■ |
| 1.8 TFSI (CABB) | | Gasolina | FWD | 1798 | 118 | 160 | 11.07-03.12 | ■ |
| 1.8 TFSI (CDHB) | | Gasolina | FWD | 1798 | 118 | 160 | 11.07-03.12 | ■ |
| 1.8 TFSI quattro (CDHB) | PR 1KW | Gasolina | 4WD | 1798 | 118 | 160 | 09.08-03.12 | ■ |
| 1.8 TFSI (CJEB) | PR 1KW, PR 2EH | Gasolina | FWD | 1798 | 125 | 170 | 11.11-12.15 | ■ |
| 1.8 TFSI quattro (CJEB) | PR 1KW, PR 2EH, 11/12- | Gasolina | 4WD | 1798 | 125 | 170 | 11.11-12.15 | ■ |
| 2.0 TFSI (CAEA) | PR 1KW | Gasolina | FWD | 1984 | 132 | 180 | 06.08-12.15 | ■ |
| 2.0 TFSI (CDNB) | PR 1KW | Gasolina | FWD | 1984 | 132 | 180 | 06.08-12.15 | ■ |
| 2.0 TFSI (CFKA) | PR 1KW | Gasolina | FWD | 1984 | 132 | 180 | 06.08-12.15 | ■ |
| 2.0 TFSI quattro (CFKA) | | Gasolina | 4WD | 1984 | 132 | 180 | 11.09-03.12 | ■ |
| 2.0 TFSI (CAEB) | PR 1KW | Gasolina | FWD | 1984 | 155 | 211 | 06.08-05.13 | ■ |
| 2.0 TFSI (CDNC) | PR 1KW | Gasolina | FWD | 1984 | 155 | 211 | 06.08-05.13 | ■ |
| 2.0 TFSI quattro (CAEB) | PR 1KW | Gasolina | 4WD | 1984 | 155 | 211 | 06.08-12.15 | ■ |
| 2.0 TFSI quattro (CDNC) | PR 1KW | Gasolina | 4WD | 1984 | 155 | 211 | 06.08-12.15 | ■ |
| 2.0 TFSI quattro (CPMA) | PR 1KW | Gasolina | 4WD | 1984 | 155 | 211 | 06.08-12.15 | ■ |
| 2.0 TFSI (CAED) | PR 1KW, PR 2EH | Gasolina | FWD | 1984 | 162 | 220 | 05.13-12.15 | ■ |
| 2.0 TFSI quattro (CAED) | PR 1KW, PR 2EH | Gasolina | 4WD | 1984 | 162 | 220 | 05.13-12.15 | ■ |
| 2.0 TFSI quattro (CPMB) | PR 1KW, PR 2EH | Gasolina | 4WD | 1984 | 162 | 220 | 05.13-12.15 | ■ |
| 2.0 TFSI (CNCD) | PR 1KW, PR 2EH | Gasolina | FWD | 1984 | 165 | 224 | 05.13-12.15 | ■ |
| 2.0 TFSI quattro (CNCD) | PR 1KW, PR 2EH | Gasolina | 4WD | 1984 | 165 | 224 | 05.13-12.15 | ■ |
| 3.0 TFSI quattro (CMUA) | PR 1KW, PR 2EH | Gasolina | 4WD | 2995 | 200 | 272 | 02.12-12.15 | ■ |
| 3.0 TFSI quattro (CRED) | PR 1KW, PR 2EH | Gasolina | 4WD | 2995 | 200 | 272 | 02.12-12.15 | ■ |
| 3.2 FSI (CALA) | PR 1KW | Gasolina | FWD | 3197 | 195 | 265 | 09.08-03.12 | ■ |
| 3.2 FSI quattro (CALA) | PR 1KW | Gasolina | 4WD | 3197 | 195 | 265 | 11.07-03.12 | ■ |
| 2.0 TFSI flexible fuel (CFKA) | PR 1KW | Gasol./Etanol | FWD | 1984 | 132 | 180 | 11.09-12.15 | ■ |
| 2.0 TFSI flexible fuel quattro (CFKA) | elec.brake detention, PR 1KW | Gasol./Etanol | 4WD | 1984 | 132 | 180 | 11.09-12.15 | ■ |
| 2.0 TDI (CAGC) | PR 1KW | Diesel | FWD | 1968 | 88 | 120 | 06.08-12.15 | ■ |
| 2.0 TDI (CJCC) | PR 1KW | Diesel | FWD | 1968 | 88 | 120 | 06.08-12.15 | ■ |
| 2.0 TDI (CAGB) | elec.brake detention, PR 1KW | Diesel | FWD | 1968 | 100 | 136 | 11.07-12.15 | ■ |
| 2.0 TDI (CJCB) | elec.brake detention, PR 1KW | Diesel | FWD | 1968 | 100 | 136 | 11.07-12.15 | ■ |
| 2.0 TDI (CSUB) | elec.brake detention, PR 1KW | Diesel | FWD | 1968 | 100 | 136 | 11.07-12.15 | ■ |
| 2.0 TDI (CAGA) | PR 1KW | Diesel | FWD | 1968 | 105 | 143 | 11.07-12.15 | ■ |
| 2.0 TDI (CJCA) | PR 1KW | Diesel | FWD | 1968 | 105 | 143 | 11.07-12.15 | ■ |
| 2.0 TDI (CMEA) | PR 1KW | Diesel | FWD | 1968 | 105 | 143 | 11.07-12.15 | ■ |
| 2.0 TDI (CMFA) | PR 1KW | Diesel | FWD | 1968 | 105 | 143 | 11.07-12.15 | ■ |
| 2.0 TDI quattro (CAGA) | PR 1KW | Diesel | 4WD | 1968 | 105 | 143 | 11.08-12.15 | ■ |
| 2.0 TDI quattro (CJCA) | PR 1KW | Diesel | 4WD | 1968 | 105 | 143 | 11.08-12.15 | ■ |
| 2.0 TDI (CJCD) | PR 1KW, PR 2EH | Diesel | FWD | 1968 | 110 | 150 | 05.13-12.15 | ■ |
| 2.0 TDI (CMFB) | PR 1KW, PR 2EH | Diesel | FWD | 1968 | 110 | 150 | 05.13-12.15 | ■ |
| 2.0 TDI (CSUA) | PR 1KW, PR 2EH | Diesel | FWD | 1968 | 110 | 150 | 05.13-12.15 | ■ |
| 2.0 TDI quattro (CJCD) | | Diesel | 4WD | 1968 | 110 | 150 | 05.13-12.15 | ■ |
| 2.0 TDI quattro (CSUA) | | Diesel | 4WD | 1968 | 110 | 150 | 05.13-12.15 | ■ |
| 2.0 TDI (CAHB) | elec.brake detention, PR 1KW | Diesel | FWD | 1968 | 120 | 163 | 08.08-12.15 | ■ |
| 2.0 TDI (CGLD) | elec.brake detention, PR 1KW | Diesel | FWD | 1968 | 120 | 163 | 08.08-12.15 | ■ |

LISTA DE APLICACIONES - BUYERS GUIDE

| | | | | | | | | |
|---|------------------------------|----------------|-----|------|---|-----|-------------|---|
| 2.0 TDI (CNHC) | elec.brake detention, PR 1KW | Diesel | FWD | 1968 | 120 | 163 | 08.08-12.15 | ■ |
| 2.0 TDI (CAHA) | PR 1KW | Diesel | FWD | 1968 | 125 | 170 | 01.08-03.12 | ■ |
| 2.0 TDI quattro (CAHA) | PR 1KW | Diesel | 4WD | 1968 | 125 | 170 | 01.08-03.12 | ■ |
| 2.0 TDI (CGLC) | PR 1KW, PR 2EH | Diesel | FWD | 1968 | 130 | 177 | 11.11-12.15 | ■ |
| 2.0 TDI (CMGB) | PR 1KW, PR 2EH | Diesel | FWD | 1968 | 130 | 177 | 11.11-12.15 | ■ |
| 2.0 TDI quattro (CGLC) | PR 1KW, PR 2EH | Diesel | 4WD | 1968 | 130 | 177 | 11.11-12.15 | ■ |
| 2.0 TDI (CNHA) | PR 1KW, PR 2EH | Diesel | FWD | 1968 | 140 | 190 | 09.13-12.15 | ■ |
| 2.0 TDI quattro (CNHA) | PR 1KW, PR 2EH | Diesel | 4WD | 1968 | 140 | 190 | 09.13-12.15 | ■ |
| 2.7 TDI (CAMB) | elec.brake detention, PR 1KW | Diesel | FWD | 2698 | 120 | 163 | 11.07-03.12 | ■ |
| 2.7 TDI (CGKB) | elec.brake detention, PR 1KW | Diesel | FWD | 2698 | 120 | 163 | 11.07-03.12 | ■ |
| 2.7 TDI (CAMA) | PR 1KW | Diesel | FWD | 2698 | 140 | 190 | 11.07-03.12 | ■ |
| 2.7 TDI (CGKA) | PR 1KW | Diesel | FWD | 2698 | 140 | 190 | 11.07-03.12 | ■ |
| 3.0 TDI (CLAB) | PR 1KW, PR 2EH | Diesel | FWD | 2967 | 150 | 204 | 11.11-12.15 | ■ |
| 3.0 TDI quattro (CCWB) | elec.brake detention, PR 1KW | Diesel | 4WD | 2967 | 155 | 211 | 06.08-05.10 | ■ |
| 3.0 TDI | elec.brake detention, PR 1KW | Diesel | RWD | 2967 | 171 | 233 | 04.09- | ■ |
| 3.0 TDI quattro (CAPA) | PR 1KW | Diesel | 4WD | 2967 | 176 | 240 | 11.07-03.12 | ■ |
| 3.0 TDI quattro (CCLA) | PR 1KW | Diesel | 4WD | 2967 | 176 | 240 | 11.07-03.12 | ■ |
| 3.0 TDI quattro (CCWA) | PR 1KW | Diesel | 4WD | 2967 | 176 | 240 | 11.07-03.12 | ■ |
| 3.0 TDI quattro (CDUC) | PR 1KW, PR 2EH | Diesel | 4WD | 2967 | 180 | 245 | 11.11-12.15 | ■ |
| 3.0 TDI quattro (CKVB) | PR 1KW, PR 2EH | Diesel | 4WD | 2967 | 180 | 245 | 11.11-12.15 | ■ |
| 3.0 TDI quattro (CKVC) | PR 1KW, PR 2EH | Diesel | 4WD | 2967 | 180 | 245 | 11.11-12.15 | ■ |
| A4 IV B8 Avant (8K5) 11.07-06.17 | | | | | Estate (Compact executive car-D Segment) | | | |
| 1.8 TFSI (CDHA) | PR 1KW | Gasolina | FWD | 1798 | 88 | 120 | 04.08-12.15 | ■ |
| 1.8 TFSI (CABB) | PR 1KW | Gasolina | FWD | 1798 | 118 | 160 | 11.07-03.12 | ■ |
| 1.8 TFSI (CDHB) | PR 1KW | Gasolina | FWD | 1798 | 118 | 160 | 11.07-03.12 | ■ |
| 1.8 TFSI quattro (CDHB) | PR 1KW | Gasolina | 4WD | 1798 | 118 | 160 | 09.08-03.12 | ■ |
| 1.8 TFSI (CJEB) | PR 1KW, PR 2EH | Gasolina | FWD | 1798 | 125 | 170 | 11.11-12.15 | ■ |
| 1.8 TFSI quattro (CJEB) | PR 1KW, PR 2EH | Gasolina | 4WD | 1798 | 125 | 170 | 11.11-12.15 | ■ |
| 2.0 TFSI (CDNB) | PR 1KW | Gasolina | FWD | 1984 | 132 | 180 | 06.08-12.15 | ■ |
| 2.0 TFSI (CFKA) | PR 1KW | Gasolina | FWD | 1984 | 132 | 180 | 06.08-12.15 | ■ |
| 2.0 TFSI (CAEB) | PR 1KW | Gasolina | FWD | 1984 | 155 | 211 | 06.08-05.13 | ■ |
| 2.0 TFSI (CDNC) | PR 1KW | Gasolina | FWD | 1984 | 155 | 211 | 06.08-05.13 | ■ |
| 2.0 TFSI quattro (CAEB) | PR 1KW | Gasolina | 4WD | 1984 | 155 | 211 | 06.08-12.15 | ■ |
| 2.0 TFSI quattro (CDNC) | PR 1KW | Gasolina | 4WD | 1984 | 155 | 211 | 06.08-12.15 | ■ |
| 2.0 TFSI (CNCD) | PR 1KW, PR 2EH | Gasolina | FWD | 1984 | 165 | 224 | 05.13-12.15 | ■ |
| 2.0 TFSI quattro (CNCD) | PR 1KW, PR 2EH | Gasolina | 4WD | 1984 | 165 | 224 | 05.13-12.15 | ■ |
| 3.0 TFSI quattro (CMUA) | PR 1KW, PR 2EH | Gasolina | 4WD | 2995 | 200 | 272 | 02.12-12.15 | ■ |
| 3.0 TFSI quattro (CRED) | PR 1KW, PR 2EH | Gasolina | 4WD | 2995 | 200 | 272 | 02.12-12.15 | ■ |
| 3.2 FSI (CALA) | PR 1KW | Gasolina | FWD | 3197 | 195 | 265 | 09.08-03.12 | ■ |
| 3.2 FSI quattro (CALA) | PR 1KW | Gasolina | 4WD | 3197 | 195 | 265 | 04.08-03.12 | ■ |
| 2.0 TFSI flexible fuel (CFKA) | elec.brake detention, PR 1KW | Gasol./Et anol | FWD | 1984 | 132 | 180 | 11.09-12.15 | ■ |
| 2.0 TFSI flexible fuel quattro (CFKA) | elec.brake detention, PR 1KW | Gasol./Et anol | 4WD | 1984 | 132 | 180 | 11.09-12.15 | ■ |
| 2.0 TDI (CAGC) | PR 1KW | Diesel | FWD | 1968 | 88 | 120 | 06.08-12.15 | ■ |
| 2.0 TDI (CJCC) | PR 1KW | Diesel | FWD | 1968 | 88 | 120 | 06.08-12.15 | ■ |
| 2.0 TDI (CAGB) | elec.brake detention, PR 1KW | Diesel | FWD | 1968 | 100 | 136 | 04.08-12.15 | ■ |
| 2.0 TDI (CJCB) | elec.brake detention, PR 1KW | Diesel | FWD | 1968 | 100 | 136 | 04.08-12.15 | ■ |
| 2.0 TDI (CSUB) | elec.brake detention, PR 1KW | Diesel | FWD | 1968 | 100 | 136 | 04.08-12.15 | ■ |
| 2.0 TDI 16V | PR 1KW | Diesel | FWD | 1968 | 103 | 140 | 07.08- | ■ |
| 2.0 TDI (CAGA) | PR 1KW | Diesel | FWD | 1968 | 105 | 143 | 04.08-12.15 | ■ |
| 2.0 TDI (CJCA) | PR 1KW | Diesel | FWD | 1968 | 105 | 143 | 04.08-12.15 | ■ |

LISTA DE APLICACIONES - BUYERS GUIDE

| | | | | | | | | |
|--|------------------------------|---------------|-----|------|---|-----|-------------|---|
| 2.0 TDI (CMEA) | PR 1KW | Diesel | FWD | 1968 | 105 | 143 | 04.08-12.15 | ■ |
| 2.0 TDI (CMFA) | PR 1KW | Diesel | FWD | 1968 | 105 | 143 | 04.08-12.15 | ■ |
| 2.0 TDI quattro (CAGA) | PR 1KW | Diesel | 4WD | 1968 | 105 | 143 | 04.08-12.15 | ■ |
| 2.0 TDI quattro (CJCA) | PR 1KW | Diesel | 4WD | 1968 | 105 | 143 | 04.08-12.15 | ■ |
| 2.0 TDI (CJCD) | PR 1KW, PR 2EH | Diesel | FWD | 1968 | 110 | 150 | 05.13-12.15 | ■ |
| 2.0 TDI (CMFB) | PR 1KW, PR 2EH | Diesel | FWD | 1968 | 110 | 150 | 05.13-12.15 | ■ |
| 2.0 TDI (CSUA) | PR 1KW, PR 2EH | Diesel | FWD | 1968 | 110 | 150 | 05.13-12.15 | ■ |
| 2.0 TDI quattro (CJCD) | PR 1KW, PR 2EH | Diesel | 4WD | 1968 | 110 | 150 | 05.13-12.15 | ■ |
| 2.0 TDI quattro (CSUA) | PR 1KW, PR 2EH | Diesel | 4WD | 1968 | 110 | 150 | 05.13-12.15 | ■ |
| 2.0 TDI (CAHB) | elec.brake detention, PR 1KW | Diesel | FWD | 1968 | 120 | 163 | 08.08-12.15 | ■ |
| 2.0 TDI (CGLD) | elec.brake detention, PR 1KW | Diesel | FWD | 1968 | 120 | 163 | 08.08-12.15 | ■ |
| 2.0 TDI (CNHC) | elec.brake detention, PR 1KW | Diesel | FWD | 1968 | 120 | 163 | 08.08-12.15 | ■ |
| 2.0 TDI (CAHA) | PR 1KW | Diesel | FWD | 1968 | 125 | 170 | 04.08-03.12 | ■ |
| 2.0 TDI quattro (CAHA) | PR 1KW | Diesel | 4WD | 1968 | 125 | 170 | 08.08-03.12 | ■ |
| 2.0 TDI (CGLC) | PR 1KW, PR 2EH | Diesel | FWD | 1968 | 130 | 177 | 11.11-12.15 | ■ |
| 2.0 TDI quattro (CGLC) | PR 1KW, PR 2EH | Diesel | 4WD | 1968 | 130 | 177 | 11.11-12.15 | ■ |
| 2.0 TDI (CNHA) | PR 1KW, PR 2EH | Diesel | FWD | 1968 | 140 | 190 | 09.13-12.15 | ■ |
| 2.0 TDI quattro (CNHA) | PR 1KW, PR 2EH | Diesel | 4WD | 1968 | 140 | 190 | 09.13-12.15 | ■ |
| 2.7 TDI (CAMB) | elec.brake detention, PR 1KW | Diesel | FWD | 2698 | 120 | 163 | 06.08-03.12 | ■ |
| 2.7 TDI (CGKB) | elec.brake detention, PR 1KW | Diesel | FWD | 2698 | 120 | 163 | 06.08-03.12 | ■ |
| 2.7 TDI (CAMA) | PR 1KW | Diesel | FWD | 2698 | 140 | 190 | 04.08-03.12 | ■ |
| 2.7 TDI (CGKA) | PR 1KW | Diesel | FWD | 2698 | 140 | 190 | 04.08-03.12 | ■ |
| 3.0 TDI (CLAB) | PR 1KW, PR 2EH | Diesel | FWD | 2967 | 150 | 204 | 11.11-12.15 | ■ |
| 3.0 TDI quattro (CCWB) | elec.brake detention, PR 1KW | Diesel | 4WD | 2967 | 155 | 211 | 06.08-05.10 | ■ |
| 3.0 TDI | elec.brake detention, PR 1KW | Diesel | RWD | 2967 | 171 | 233 | 04.09- | ■ |
| 3.0 TDI quattro (CAPA) | PR 1KW | Diesel | 4WD | 2967 | 176 | 240 | 04.08-03.12 | ■ |
| 3.0 TDI quattro (CCLA) | PR 1KW | Diesel | 4WD | 2967 | 176 | 240 | 04.08-03.12 | ■ |
| 3.0 TDI quattro (CCWA) | PR 1KW | Diesel | 4WD | 2967 | 176 | 240 | 04.08-03.12 | ■ |
| 3.0 TDI quattro (CDUC) | PR 1KW, PR 2EH | Diesel | 4WD | 2967 | 180 | 245 | 11.11-12.15 | ■ |
| 3.0 TDI quattro (CKVB) | PR 1KW, PR 2EH | Diesel | 4WD | 2967 | 180 | 245 | 11.11-12.15 | ■ |
| 3.0 TDI quattro (CKVC) | PR 1KW, PR 2EH | Diesel | 4WD | 2967 | 180 | 245 | 11.11-12.15 | ■ |
| A4 V Allroad B9 (8WH, 8WJ) 01.16- | | | | | Estate (Compact executive car-D Segment) | | | |
| 45 TFSI Mild hybrid quattro (DKNA) | | Gasol./el éc. | 4WD | 1984 | 180 | 245 | 07.18- | ■ |
| 2.0 TFSI Mild Hybrid quattro (DDWA) | | Gasol./el éc. | 4WD | 1984 | 185 | 252 | 11.18-10.19 | ■ |
| 45 TFSI Mild hybrid quattro (DMTA) | | Gasol./el éc. | 4WD | 1984 | 195 | 265 | 08.20- | ■ |
| 40 TDI Mild Hybrid quattro (DTPA) | | Diesel/el éc. | 4WD | 1968 | 150 | 204 | 09.20- | ■ |
| 50 TDI Mild Hybrid quattro | | Diesel/el éc. | 4WD | 2967 | 210 | 286 | 08.20- | ■ |
| 2.0 TDI quattro (DEUB) | | Diesel | 4WD | 1968 | 100 | 136 | 11.16-07.18 | ■ |
| 2.0 TDI quattro (DEUA) | | Diesel | 4WD | 1968 | 110 | 150 | 11.16-10.19 | ■ |
| 40 TDI quattro (DETA) | | Diesel | 4WD | 1968 | 140 | 190 | 01.20- | ■ |
| 45 TDI quattro (DCPE) | | Diesel | 4WD | 2967 | 170 | 231 | 07.18- | ■ |
| 3.0 TDI quattro (DCPC) | | Diesel | 4WD | 2967 | 210 | 286 | 07.18-10.19 | ■ |
| 50 TDI quattro (DCPC) | | Diesel | 4WD | 2967 | 210 | 286 | 11.19- | ■ |
| A4 V B9 (8W2, 8WC) 05.15- | | | | | Saloon (Compact executive car-D Segment) | | | |
| S4 quattro (CWGD) | | Gasolina | 4WD | 2995 | 260 | 354 | 05.16- | ■ |
| 35 TFSI Mild Hybrid (DLVB) | | Gasol./el éc. | FWD | 1984 | 110 | 150 | 12.18- | ■ |
| 40 TFSI Mild Hybrid (DEMA) | | Gasol./el éc. | FWD | 1984 | 140 | 190 | 05.17- | ■ |

LISTA DE APLICACIONES - BUYERS GUIDE

| | | | | | | | | |
|--|--|-------------------------|-----|------|---|-----|-------------|---|
| 40 TFSI Mild Hybrid (DKYA) | | Gasol./el éc. | FWD | 1984 | 140 | 190 | 05.17- | ■ |
| 40 TFSI Mild Hybrid (DLVA) | | Gasol./el éc. | FWD | 1984 | 140 | 190 | 05.17- | ■ |
| 40 TFSI Mild Hybrid | | Gasol./el éc. | FWD | 1984 | 150 | 204 | 06.20- | ■ |
| 40 TFSI Mild Hybrid quattro (DMSA) | | Gasol./el éc. | 4WD | 1984 | 150 | 204 | 06.20- | ■ |
| 45 TFSI Mild Hybrid (DKNA) | | Gasol./el éc. | FWD | 1984 | 180 | 245 | 07.18-11.19 | ■ |
| 45 TFSI Mild hybrid quattro (DKNA) | | Gasol./el éc. | 4WD | 1984 | 180 | 245 | 07.18-11.19 | ■ |
| 2.0 TFSI Mild Hybrid (DDWA) | | Gasol./el éc. | FWD | 1984 | 185 | 252 | 05.17-11.19 | ■ |
| 2.0 TFSI Mild Hybrid quattro (DDWA) | | Gasol./el éc. | 4WD | 1984 | 185 | 252 | 05.17-11.19 | ■ |
| 45 TFSI Mild hybrid quattro (DMTA) | | Gasol./el éc. | 4WD | 1984 | 195 | 265 | 08.20- | ■ |
| 30 TDI Mild Hybrid (DEZB) | | Diesel/el éc. | FWD | 1968 | 100 | 136 | 07.19- | ■ |
| 35 TDI Mild Hybrid (DEZE) | | Diesel/el éc. | FWD | 1968 | 120 | 163 | 03.19- | ■ |
| 40 TDI Mild Hybrid | | Diesel/el éc. | FWD | 1968 | 150 | 204 | 09.20- | ■ |
| 40 TDI Mild Hybrid quattro (DTPA) | | Diesel/el éc. | 4WD | 1968 | 150 | 204 | 05.20- | ■ |
| 50 TDI Mild Hybrid quattro | | Diesel/el éc. | 4WD | 2967 | 210 | 286 | 08.20- | ■ |
| S4 TDI Mild Hybrid quattro | | Diesel/el éc. | 4WD | 2967 | 251 | 341 | 01.21- | ■ |
| S4 TDI Mild Hybrid quattro (DEWB) | | Diesel/el éc. | 4WD | 2967 | 255 | 347 | 05.19- | ■ |
| 45 TDI quattro (DCPE) | | Diesel | 4WD | 2967 | 170 | 231 | 07.18- | ■ |
| 50 TDI quattro (DCPC) | | Diesel | 4WD | 2967 | 210 | 286 | 07.18- | ■ |
| A4 V B9 Avant (8W5, 8WD) 08.15- | | | | | Estate (Compact executive car-D Segment) | | | |
| S4 quattro (CWGD) | | Gasolina | 4WD | 2995 | 260 | 354 | 05.16- | ■ |
| 2.0 TFSI g-tron (CVLA) | | Gasol./G as (CNG) | FWD | 1984 | 125 | 170 | 11.16-10.19 | ■ |
| 40 TFSI g-tron (CVLA) | | Gasol./G as (CNG) | FWD | 1984 | 125 | 170 | 11.16- | ■ |
| 35 TFSI Mild Hybrid (DLVB) | | Gasol./el éc. | FWD | 1984 | 110 | 150 | 12.18- | ■ |
| 35 TFSI Mild Hybrid (DMSB) | | Gasol./el éc. | FWD | 1984 | 110 | 150 | 12.18- | ■ |
| 40 TFSI Mild Hybrid (DEMA) | | Gasol./el éc. | FWD | 1984 | 140 | 190 | 05.17- | ■ |
| 40 TFSI Mild Hybrid (DKYA) | | Gasol./el éc. | FWD | 1984 | 140 | 190 | 05.17- | ■ |
| 40 TFSI Mild Hybrid (DLVA) | | Gasol./el éc. | FWD | 1984 | 140 | 190 | 05.17- | ■ |
| 40 TFSI Mild Hybrid (DMSA) | | Gasol./el éc. | FWD | 1984 | 150 | 204 | 06.20- | ■ |
| 40 TFSI Mild Hybrid quattro (DMSA) | | Gasol./el éc. | 4WD | 1984 | 150 | 204 | 06.20- | ■ |
| 45 TFSI Mild Hybrid (DKNA) | | Gasol./el éc. | FWD | 1984 | 180 | 245 | 07.18-10.19 | ■ |
| 45 TFSI Mild hybrid quattro (DKNA) | | Gasol./el éc. | 4WD | 1984 | 180 | 245 | 07.18-10.19 | ■ |
| 2.0 TFSI Mild Hybrid (DDWA) | | Gasol./el éc. | FWD | 1984 | 185 | 252 | 05.17-10.19 | ■ |
| 2.0 TFSI Mild Hybrid quattro (DDWA) | | Gasol./el éc. | 4WD | 1984 | 185 | 252 | 11.18- | ■ |
| 45 TFSI Mild hybrid quattro (DMTA) | | Gasol./el éc. | 4WD | 1984 | 195 | 265 | 08.20- | ■ |
| 30 TDI Mild Hybrid (DEZB) | | Diesel/el éc. | FWD | 1968 | 100 | 136 | 07.19- | ■ |

LISTA DE APLICACIONES - BUYERS GUIDE

| | | | | | | | | |
|------------------------------------|--------------------------------------|---------------|-----|------|--|-----|-------------|---|
| 35 TDI Mild Hybrid (DEZE) | | Diesel/el éc. | FWD | 1968 | 120 | 163 | 07.19- | ■ |
| 40 TDI Mild Hybrid | | Diesel/el éc. | FWD | 1968 | 150 | 204 | 09.20- | ■ |
| 40 TDI Mild Hybrid quattro (DTPA) | | Diesel/el éc. | 4WD | 1968 | 150 | 204 | 05.20- | ■ |
| 50 TDI Mild Hybrid quattro | | Diesel/el éc. | 4WD | 2967 | 210 | 286 | 08.20- | ■ |
| S4 TDI Mild Hybrid quattro | | Diesel/el éc. | 4WD | 2967 | 251 | 341 | 01.21- | ■ |
| S4 TDI Mild Hybrid quattro (DEWB) | | Diesel/el éc. | 4WD | 2967 | 255 | 347 | 05.19- | ■ |
| 30 TDI (DEUC) | | Diesel | FWD | 1968 | 90 | 122 | 10.18-10.19 | ■ |
| 35 TDI (DEUA) | | Diesel | FWD | 1968 | 110 | 150 | 10.18-10.19 | ■ |
| 40 TDI (DESA) | | Diesel | FWD | 1968 | 140 | 190 | 10.18- | ■ |
| 40 TDI (DETA) | | Diesel | FWD | 1968 | 140 | 190 | 10.18- | ■ |
| 40 TDI quattro (DETA) | | Diesel | 4WD | 1968 | 140 | 190 | 10.18-09.20 | ■ |
| 45 TDI quattro (DCPE) | | Diesel | 4WD | 2967 | 170 | 231 | 07.18- | ■ |
| 50 TDI quattro (DCPC) | | Diesel | 4WD | 2967 | 210 | 286 | 07.18- | ■ |
| A4 III B7 (8EC) 11.04-01.09 | | | | | Saloon (Compact executive car-D Segment) | | | |
| 2.0 TDI (BVA) | PR 1KW, elec.brake detention | Diesel | FWD | 1968 | 120 | 163 | 06.06-06.08 | ■ |
| A5 (8F7) 02.09-10.17 | | | | | Convertible (Compact executive car-D Segment) | | | |
| 1.8 TFSI (CDHB) | elec.brake detention, PR 1KW, PR 1EH | Gasolina | FWD | 1798 | 118 | 160 | 09.09-03.12 | ■ |
| 1.8 TFSI (CJEB) | PR 1KW, PR 2EH | Gasolina | FWD | 1798 | 125 | 170 | 09.11-03.16 | ■ |
| 1.8 TFSI (CJEE) | PR 1KW, PR 2EH | Gasolina | FWD | 1798 | 130 | 177 | 05.15-01.17 | ■ |
| 2.0 TFSI (CAEA) | PR 1KW | Gasolina | FWD | 1984 | 132 | 180 | 03.09-03.12 | ■ |
| 2.0 TFSI (CDNB) | PR 1KW | Gasolina | FWD | 1984 | 132 | 180 | 03.09-03.12 | ■ |
| 2.0 TFSI (CAEB) | PR 1KW | Gasolina | FWD | 1984 | 155 | 211 | 03.09-06.14 | ■ |
| 2.0 TFSI (CDNC) | PR 1KW | Gasolina | FWD | 1984 | 155 | 211 | 03.09-06.14 | ■ |
| 2.0 TFSI quattro (CAEB) | PR 1KW | Gasolina | 4WD | 1984 | 155 | 211 | 03.09-01.17 | ■ |
| 2.0 TFSI quattro (CDNC) | PR 1KW | Gasolina | 4WD | 1984 | 155 | 211 | 03.09-01.17 | ■ |
| 2.0 TFSI quattro (CPMA) | PR 1KW | Gasolina | 4WD | 1984 | 155 | 211 | 03.09-01.17 | ■ |
| 2.0 TFSI (CAED) | PR 1KW, PR 2EH | Gasolina | FWD | 1984 | 162 | 220 | 05.13-12.14 | ■ |
| 2.0 TFSI quattro (CPMB) | PR 1KW, PR 2EH | Gasolina | 4WD | 1984 | 162 | 220 | 03.12-01.17 | ■ |
| 2.0 TFSI (CNCD) | PR 1KW, PR 2EH | Gasolina | FWD | 1984 | 165 | 224 | 05.13-05.16 | ■ |
| 2.0 TFSI quattro (CNCD) | PR 1KW, PR 2EH | Gasolina | 4WD | 1984 | 165 | 224 | 05.13-05.16 | ■ |
| 3.0 TFSI quattro (CMUA) | PR 1KW, PR 2EH | Gasolina | 4WD | 2995 | 200 | 272 | 11.11-01.17 | ■ |
| 3.0 TFSI quattro (CRED) | PR 1KW, PR 2EH | Gasolina | 4WD | 2995 | 200 | 272 | 11.11-01.17 | ■ |
| 3.2 FSI (CALA) | PR 1KW | Gasolina | FWD | 3197 | 195 | 265 | 03.09-03.12 | ■ |
| 3.2 FSI quattro (CALA) | PR 1KW | Gasolina | 4WD | 3197 | 195 | 265 | 03.09-03.12 | ■ |
| 2.0 TDI (CJCA) | | Diesel | FWD | 1968 | 105 | 143 | 10.11-05.15 | ■ |
| 2.0 TDI (CJCD) | PR 1KW, PR 2EH | Diesel | FWD | 1968 | 110 | 150 | 05.13-01.17 | ■ |
| 2.0 TDI (CSUA) | PR 1KW, PR 2EH | Diesel | FWD | 1968 | 110 | 150 | 05.13-01.17 | ■ |
| 2.0 TDI (CAHB) | PR 1KW | Diesel | FWD | 1968 | 120 | 163 | 05.09-06.14 | ■ |
| 2.0 TDI (CGLD) | PR 1KW | Diesel | FWD | 1968 | 120 | 163 | 05.09-06.14 | ■ |
| 2.0 TDI (CAHA) | PR 1KW | Diesel | FWD | 1968 | 125 | 170 | 05.09-03.12 | ■ |
| 2.0 TDI (CGLC) | PR 1KW, PR 2EH | Diesel | FWD | 1968 | 130 | 177 | 10.11-01.17 | ■ |
| 2.0 TDI quattro (CGLC) | PR 1KW, PR 2EH | Diesel | 4WD | 1968 | 130 | 177 | 01.12-05.15 | ■ |
| 2.0 TDI (CNHA) | PR 1KW, PR 2EH | Diesel | FWD | 1968 | 140 | 190 | 09.13-01.17 | ■ |
| 2.0 TDI quattro (CNHA) | PR 1KW, PR 2EH | Diesel | 4WD | 1968 | 140 | 190 | 09.13-01.17 | ■ |
| 2.7 TDI (CGKB) | PR 1KW | Diesel | FWD | 2698 | 120 | 163 | 05.09-03.12 | ■ |
| 2.7 TDI (CGKA) | PR 1KW | Diesel | FWD | 2698 | 140 | 190 | 03.09-03.12 | ■ |
| 3.0 TDI (CLAB) | PR 1KW, PR 2EH | Diesel | FWD | 2967 | 150 | 204 | 10.11-01.17 | ■ |

LISTA DE APLICACIONES - BUYERS GUIDE

| | | | | | | | | |
|--------------------------------|------------------------------|----------|-----|------|--|-----|-------------|---|
| 3.0 TDI quattro (CCWA) | PR 1KW | Diesel | 4WD | 2967 | 176 | 240 | 03.09-03.12 | ■ |
| 3.0 TDI quattro (CDUC) | PR 1KW, PR 2EH | Diesel | 4WD | 2967 | 180 | 245 | 10.11-01.17 | ■ |
| 3.0 TDI quattro (CKVC) | PR 1KW, PR 2EH | Diesel | 4WD | 2967 | 180 | 245 | 10.11-01.17 | ■ |
| A5 (8T3) 06.07-10.17 | | | | | Coupe (Compact executive car-D Segment) | | | |
| 1.8 TFSI (CDHB) | elec.brake detention, PR 1KW | Gasolina | FWD | 1798 | 118 | 160 | 05.09-09.11 | ■ |
| 1.8 TFSI (CABD) | | Gasolina | FWD | 1798 | 125 | 170 | 10.07-01.17 | ■ |
| 1.8 TFSI (CJEB) | | Gasolina | FWD | 1798 | 125 | 170 | 10.07-01.17 | ■ |
| 2.0 TFSI (CDNB) | PR 1KW | Gasolina | FWD | 1984 | 132 | 180 | 11.08-03.12 | ■ |
| 2.0 TFSI (CDNC) | PR 1KW | Gasolina | FWD | 1984 | 155 | 211 | 06.08-11.13 | ■ |
| 2.0 TFSI quattro (CAEB) | PR 1KW | Gasolina | 4WD | 1984 | 155 | 211 | 06.08-01.17 | ■ |
| 2.0 TFSI quattro (CDNC) | PR 1KW | Gasolina | 4WD | 1984 | 155 | 211 | 06.08-01.17 | ■ |
| 2.0 TFSI quattro (CPMA) | PR 1KW | Gasolina | 4WD | 1984 | 155 | 211 | 06.08-01.17 | ■ |
| 2.0 TFSI quattro (CAED) | PR 1KW, PR 2EH | Gasolina | 4WD | 1984 | 162 | 220 | 03.12-01.17 | ■ |
| 2.0 TFSI quattro (CPMB) | PR 1KW, PR 2EH | Gasolina | 4WD | 1984 | 162 | 220 | 03.12-01.17 | ■ |
| 2.0 TFSI (CNCD) | PR 1KW, PR 2EH | Gasolina | FWD | 1984 | 165 | 224 | 05.13-05.16 | ■ |
| 2.0 TFSI quattro (CNCD) | PR 1KW, PR 2EH | Gasolina | 4WD | 1984 | 165 | 224 | 05.13-05.16 | ■ |
| 2.0 TFSI (CNCE) | PR 1KW, PR 2EH | Gasolina | FWD | 1984 | 169 | 230 | 08.15-01.17 | ■ |
| 2.0 TFSI quattro (CNCE) | PR 1KW, PR 2EH | Gasolina | 4WD | 1984 | 169 | 230 | 08.15-01.17 | ■ |
| 3.0 TFSI quattro (CHMB) | PR 1KW, PR 2EH | Gasolina | 4WD | 2995 | 200 | 272 | 12.11-01.17 | ■ |
| 3.0 TFSI quattro (CMUA) | PR 1KW, PR 2EH | Gasolina | 4WD | 2995 | 200 | 272 | 12.11-01.17 | ■ |
| 3.0 TFSI quattro (CRED) | PR 1KW, PR 2EH | Gasolina | 4WD | 2995 | 200 | 272 | 12.11-01.17 | ■ |
| 3.2 FSI (CALA) | | Gasolina | FWD | 3197 | 195 | 265 | 06.07-03.12 | ■ |
| 3.2 FSI quattro (CALA) | PR 1KW | Gasolina | 4WD | 3197 | 195 | 265 | 06.07-03.12 | ■ |
| 2.0 TDI (CAHB) | PR 1KW | Diesel | FWD | 1968 | 120 | 163 | 08.08-01.17 | ■ |
| 2.0 TDI (CGLD) | PR 1KW | Diesel | FWD | 1968 | 120 | 163 | 08.08-01.17 | ■ |
| 2.0 TDI (CNHC) | PR 1KW | Diesel | FWD | 1968 | 120 | 163 | 08.08-01.17 | ■ |
| 2.0 TDI (CAHA) | PR 1KW | Diesel | FWD | 1968 | 125 | 170 | 08.08-03.12 | ■ |
| 2.0 TDI quattro (CAHA) | PR 1KW | Diesel | 4WD | 1968 | 125 | 170 | 08.08-03.12 | ■ |
| 2.0 TDI (CGLC) | PR 1KW, PR 2EH | Diesel | FWD | 1968 | 130 | 177 | 10.11-01.17 | ■ |
| 2.0 TDI quattro (CGLC) | PR 1KW, PR 2EH | Diesel | 4WD | 1968 | 130 | 177 | 12.11-01.17 | ■ |
| 2.0 TDI (CNHA) | PR 1KW, PR 2EH | Diesel | FWD | 1968 | 140 | 190 | 09.13-01.17 | ■ |
| 2.0 TDI quattro (CNHA) | PR 1KW, PR 2EH | Diesel | 4WD | 1968 | 140 | 190 | 09.13-01.17 | ■ |
| 2.7 TDI (CAMB) | PR 1KW | Diesel | FWD | 2698 | 120 | 163 | 09.07-03.12 | ■ |
| 2.7 TDI (CGKB) | PR 1KW | Diesel | FWD | 2698 | 120 | 163 | 09.07-03.12 | ■ |
| 2.7 TDI (CAMA) | | Diesel | FWD | 2698 | 140 | 190 | 06.07-03.12 | ■ |
| 2.7 TDI (CGKA) | | Diesel | FWD | 2698 | 140 | 190 | 06.07-03.12 | ■ |
| 3.0 TDI (CLAB) | PR 1KW, PR 2EH | Diesel | FWD | 2967 | 150 | 204 | 10.11-01.17 | ■ |
| 3.0 TDI quattro (CCWB) | PR 1KW | Diesel | 4WD | 2967 | 155 | 211 | 03.08-05.10 | ■ |
| 3.0 TDI quattro (CAPA) | | Diesel | 4WD | 2967 | 176 | 240 | 06.07-03.12 | ■ |
| 3.0 TDI quattro (CCWA) | | Diesel | 4WD | 2967 | 176 | 240 | 06.07-03.12 | ■ |
| 3.0 TDI quattro (CDUC) | PR 1KW, PR 2EH | Diesel | 4WD | 2967 | 180 | 245 | 10.11-01.17 | ■ |
| 3.0 TDI quattro (CKVB) | PR 1KW, PR 2EH | Diesel | 4WD | 2967 | 180 | 245 | 10.11-01.17 | ■ |
| 3.0 TDI quattro (CKVC) | PR 1KW, PR 2EH | Diesel | 4WD | 2967 | 180 | 245 | 10.11-01.17 | ■ |
| A5 II (F57, F5E) 11.16- | | | | | Convertible (Compact executive car-D Segment) | | | |
| 2.0 TFSI (CVKB) | | Gasolina | FWD | 1984 | 140 | 190 | 03.17-12.19 | ■ |
| 2.0 TFSI (DKYA) | | Gasolina | FWD | 1984 | 140 | 190 | 03.17-12.19 | ■ |
| 40 TFSI (DMSA) | | Gasolina | FWD | 1984 | 150 | 204 | 11.20- | ■ |
| 2.0 TFSI (CYRB) | | Gasolina | FWD | 1984 | 185 | 252 | 03.17-12.19 | ■ |
| 2.0 TFSI quattro (CYMC) | | Gasolina | 4WD | 1984 | 185 | 252 | 11.16- | ■ |
| 2.0 TFSI quattro (CYRB) | | Gasolina | 4WD | 1984 | 185 | 252 | 11.16- | ■ |

LISTA DE APLICACIONES - BUYERS GUIDE

| | | | | | | | | |
|-------------------------------------|--|------------------|-----|------|--|-----|-------------|---|
| 35 TFSI Mild Hybrid (DMSB) | | Gasol./el éc. | FWD | 1984 | 110 | 150 | 06.20- | ■ |
| 40 TFSI Mild Hybrid (DEMA) | | Gasol./el éc. | FWD | 1984 | 140 | 190 | 05.17- | ■ |
| 40 TFSI Mild Hybrid (DKYA) | | Gasol./el éc. | FWD | 1984 | 140 | 190 | 05.17- | ■ |
| 40 TFSI Mild Hybrid (DLVA) | | Gasol./el éc. | FWD | 1984 | 140 | 190 | 05.17- | ■ |
| 40 TFSI Mild Hybrid (DMSA) | | Gasol./el éc. | FWD | 1984 | 150 | 204 | 05.20- | ■ |
| 40 TFSI Mild Hybrid quattro (DMSA) | | Gasol./el éc. | 4WD | 1984 | 150 | 204 | 06.20- | ■ |
| 45 TFSI Mild Hybrid (DKNA) | | Gasol./el éc. | FWD | 1984 | 180 | 245 | 07.18-12.19 | ■ |
| 45 TFSI Mild hybrid quattro (DKNA) | | Gasol./el éc. | 4WD | 1984 | 180 | 245 | 07.18-12.19 | ■ |
| 2.0 TFSI Mild Hybrid (DDWA) | | Gasol./el éc. | FWD | 1984 | 185 | 252 | 05.17-12.19 | ■ |
| 2.0 TFSI Mild Hybrid quattro (DDWA) | | Gasol./el éc. | 4WD | 1984 | 185 | 252 | 05.17- | ■ |
| 2.0 TFSI Mild Hybrid quattro (DLHB) | | Gasol./el éc. | 4WD | 1984 | 185 | 252 | 05.17- | ■ |
| 45 TFSI Mild hybrid quattro | | Gasol./el éc. | 4WD | 1984 | 195 | 265 | 06.20- | ■ |
| 30 TDI Mild Hybrid | | Diesel/el éc. | FWD | 1968 | 100 | 136 | 07.18- | ■ |
| 40 TDI Mild Hybrid | | Diesel/el éc. | FWD | 1968 | 150 | 204 | 09.20- | ■ |
| 40 TDI Mild Hybrid quattro | | Diesel/el éc. | 4WD | 1968 | 150 | 204 | 09.20- | ■ |
| 2.0 TDI (DEUA) | | Diesel | FWD | 1968 | 110 | 150 | 08.17-12.19 | ■ |
| 35 TDI (DEZE) | | Diesel | FWD | 1968 | 120 | 163 | 10.19- | ■ |
| 2.0 TDI (DETA) | | Diesel | FWD | 1968 | 140 | 190 | 11.16-12.19 | ■ |
| 2.0 TDI quattro (DETA) | | Diesel | 4WD | 1968 | 140 | 190 | 03.17- | ■ |
| 40 TDI (DETA) | | Diesel | FWD | 1968 | 140 | 190 | 11.16-12.19 | ■ |
| 40 TDI quattro (DETA) | | Diesel | 4WD | 1968 | 140 | 190 | 03.17- | ■ |
| 3.0 TDI (CSWB) | | Diesel | FWD | 2967 | 160 | 218 | 03.17-08.18 | ■ |
| 3.0 TDI quattro (CSWB) | | Diesel | 4WD | 2967 | 160 | 218 | 12.16-08.18 | ■ |
| 3.0 TDI quattro (DCPC) | | Diesel | 4WD | 2967 | 210 | 286 | 11.16-12.19 | ■ |
| 50 TDI quattro (DCPC) | | Diesel | 4WD | 2967 | 210 | 286 | 11.16-12.19 | ■ |
| A5 II (F53, F5P) 06.16- | | | | | Coupe (Compact executive car-D Segment) | | | |
| 1.4 TFSI (CVNA) | | Gasolina | FWD | 1395 | 110 | 150 | 11.16-02.20 | ■ |
| 35 TFSI | | Gasolina | FWD | 1984 | 110 | 150 | 03.20- | ■ |
| 40 TFSI (DMSA) | | Gasolina | FWD | 1984 | 150 | 204 | 11.20- | ■ |
| 2.0 TFSI (CYRB) | | Gasolina | FWD | 1984 | 185 | 252 | 11.16-02.20 | ■ |
| 2.0 TFSI quattro (CYMC) | | Gasolina | 4WD | 1984 | 185 | 252 | 06.16- | ■ |
| 2.0 TFSI quattro (CYRB) | | Gasolina | 4WD | 1984 | 185 | 252 | 06.16- | ■ |
| S5 quattro (CWGD) | | Gasolina | 4WD | 2995 | 260 | 354 | 07.16- | ■ |
| 35 TFSI Mild Hybrid (DLVB) | | Gasol./el éc. | FWD | 1984 | 110 | 150 | 02.19- | ■ |
| 35 TFSI Mild Hybrid (DMSB) | | Gasol./el éc. | FWD | 1984 | 110 | 150 | 02.19- | ■ |
| 40 TFSI Mild Hybrid (DEMA) | | Gasol./el éc. | FWD | 1984 | 140 | 190 | 05.17- | ■ |
| 40 TFSI Mild Hybrid (DHDA) | | Gasol./el éc. | FWD | 1984 | 140 | 190 | 05.17- | ■ |
| 40 TFSI Mild Hybrid (DKYA) | | Gasol./el éc. | FWD | 1984 | 140 | 190 | 05.17- | ■ |
| 40 TFSI Mild Hybrid (DLVA) | | Gasol./el éc. | FWD | 1984 | 140 | 190 | 05.17- | ■ |
| 40 TFSI Mild Hybrid | | Gasol./el éc. | FWD | 1984 | 150 | 204 | 07.20- | ■ |

LISTA DE APLICACIONES - BUYERS GUIDE

| | | | | | | | | |
|--|--|-------------------------|-----|------|--|-----|-------------|---|
| 40 TFSI Mild Hybrid quattro | | Gasol./el éc. | 4WD | 1984 | 150 | 204 | 07.20- | ■ |
| 45 TFSI Mild Hybrid (DKNA) | | Gasol./el éc. | FWD | 1984 | 180 | 245 | 07.18-08.20 | ■ |
| 45 TFSI Mild hybrid quattro (DKNA) | | Gasol./el éc. | 4WD | 1984 | 180 | 245 | 07.18-08.20 | ■ |
| 2.0 TFSI Mild Hybrid (DDWA) | | Gasol./el éc. | FWD | 1984 | 185 | 252 | 05.17-02.20 | ■ |
| 2.0 TFSI Mild Hybrid quattro (DDWA) | | Gasol./el éc. | 4WD | 1984 | 185 | 252 | 05.17-02.20 | ■ |
| 2.0 TFSI Mild Hybrid quattro (DLHB) | | Gasol./el éc. | 4WD | 1984 | 185 | 252 | 05.17-02.20 | ■ |
| 45 TFSI Mild hybrid quattro | | Gasol./el éc. | 4WD | 1984 | 195 | 265 | 10.19- | ■ |
| 30 TDI Mild Hybrid (DEZB) | | Diesel/el éc. | FWD | 1968 | 100 | 136 | 10.19- | ■ |
| 40 TDI Mild Hybrid | | Diesel/el éc. | FWD | 1968 | 150 | 204 | 09.20- | ■ |
| 40 TDI Mild Hybrid quattro | | Diesel/el éc. | 4WD | 1968 | 150 | 204 | 09.20- | ■ |
| 50 TDI Mild Hybrid quattro | | Diesel/el éc. | 4WD | 2967 | 210 | 286 | 08.20- | ■ |
| S5 TDI Mild Hybrid quattro | | Diesel/el éc. | 4WD | 2967 | 251 | 341 | 01.21- | ■ |
| S5 TDI Mild Hybrid quattro (DEWB) | | Diesel/el éc. | 4WD | 2967 | 255 | 347 | 12.18-02.20 | ■ |
| 2.0 TDI (CZHA) | | Diesel | FWD | 1968 | 110 | 150 | 05.17-02.20 | ■ |
| 2.0 TDI (DEUA) | | Diesel | FWD | 1968 | 110 | 150 | 05.17-02.20 | ■ |
| 35 TDI (CZHA) | | Diesel | FWD | 1968 | 110 | 150 | 05.17-02.20 | ■ |
| 35 TDI (DEUA) | | Diesel | FWD | 1968 | 110 | 150 | 05.17-02.20 | ■ |
| 35 TDI (DEZE) | | Diesel | FWD | 1968 | 120 | 163 | 10.19- | ■ |
| 3.0 TDI (CSWB) | | Diesel | FWD | 2967 | 160 | 218 | 11.16-08.18 | ■ |
| 3.0 TDI quattro (CSWB) | | Diesel | 4WD | 2967 | 160 | 218 | 07.16-08.18 | ■ |
| 45 TDI quattro (DCPE) | | Diesel | 4WD | 2967 | 170 | 231 | 07.18-02.20 | ■ |
| 3.0 TDI quattro (CRTC) | | Diesel | 4WD | 2967 | 200 | 272 | 02.17-12.17 | ■ |
| 3.0 TDI quattro (DCPC) | | Diesel | 4WD | 2967 | 210 | 286 | 01.17-02.20 | ■ |
| 50 TDI quattro (DCPC) | | Diesel | 4WD | 2967 | 210 | 286 | 01.17-02.20 | ■ |
| A5 II Sportback (F5A, F5F) 06.16- | | | | | Hatchback (Compact executive car-D Segment) | | | |
| 1.4 TFSI (CVNA) | | Gasolina | FWD | 1395 | 110 | 150 | 01.17-02.20 | ■ |
| 2.0 TFSI (CVKB) | | Gasolina | FWD | 1984 | 140 | 190 | 01.17- | ■ |
| 2.0 TFSI (DKYA) | | Gasolina | FWD | 1984 | 140 | 190 | 01.17- | ■ |
| 40 TFSI (DMSA) | | Gasolina | FWD | 1984 | 150 | 204 | 11.20- | ■ |
| 2.0 TFSI (CYRB) | | Gasolina | FWD | 1984 | 185 | 252 | 11.16-02.20 | ■ |
| 2.0 TFSI g-tron (CVLA) | | Gasol./G as (CNG) | FWD | 1984 | 125 | 170 | 02.17-02.20 | ■ |
| 40 TFSI g-tron (CVLA) | | Gasol./G as (CNG) | FWD | 1984 | 125 | 170 | 02.17- | ■ |
| 35 TFSI Mild Hybrid (DLVB) | | Gasol./el éc. | FWD | 1984 | 110 | 150 | 08.18- | ■ |
| 35 TFSI Mild Hybrid (DMSB) | | Gasol./el éc. | FWD | 1984 | 110 | 150 | 08.18- | ■ |
| 40 TFSI Mild Hybrid (DEMA) | | Gasol./el éc. | FWD | 1984 | 140 | 190 | 05.17- | ■ |
| 40 TFSI Mild Hybrid (DHDA) | | Gasol./el éc. | FWD | 1984 | 140 | 190 | 05.17- | ■ |
| 40 TFSI Mild Hybrid (DKYA) | | Gasol./el éc. | FWD | 1984 | 140 | 190 | 05.17- | ■ |
| 40 TFSI Mild Hybrid (DLVA) | | Gasol./el éc. | FWD | 1984 | 140 | 190 | 05.17- | ■ |
| 40 TFSI Mild Hybrid (DMSA) | | Gasol./el éc. | FWD | 1984 | 150 | 204 | 06.20- | ■ |

LISTA DE APLICACIONES - BUYERS GUIDE

| | | | | | | | | |
|---------------------------------------|------------------------------|---------------|-----|------|--|-----|-------------|---|
| 40 TFSI Mild Hybrid quattro (DMSA) | | Gasol./el éc. | 4WD | 1984 | 150 | 204 | 06.20- | ■ |
| 45 TFSI Mild Hybrid (DKNA) | | Gasol./el éc. | FWD | 1984 | 180 | 245 | 07.18-02.20 | ■ |
| 45 TFSI Mild hybrid quattro (DKNA) | | Gasol./el éc. | 4WD | 1984 | 180 | 245 | 02.19-02.20 | ■ |
| 2.0 TFSI Mild Hybrid (DDWA) | | Gasol./el éc. | FWD | 1984 | 185 | 252 | 05.17-02.20 | ■ |
| 2.0 TFSI Mild Hybrid quattro (DDWA) | | Gasol./el éc. | 4WD | 1984 | 185 | 252 | 05.17-02.20 | ■ |
| 2.0 TFSI Mild Hybrid quattro (DLHB) | | Gasol./el éc. | 4WD | 1984 | 185 | 252 | 05.17-02.20 | ■ |
| 45 TFSI Mild hybrid quattro | | Gasol./el éc. | 4WD | 1984 | 195 | 265 | 10.19- | ■ |
| 30 TDI Mild Hybrid (DEZB) | | Diesel/el éc. | FWD | 1968 | 100 | 136 | 10.19- | ■ |
| 40 TDI Mild Hybrid | | Diesel/el éc. | FWD | 1968 | 150 | 204 | 09.20- | ■ |
| 40 TDI Mild Hybrid quattro | | Diesel/el éc. | 4WD | 1968 | 150 | 204 | 09.20- | ■ |
| 50 TDI Mild Hybrid quattro (DMGA) | | Diesel/el éc. | 4WD | 2967 | 210 | 286 | 08.20- | ■ |
| S5 TDI Mild Hybrid quattro | | Diesel/el éc. | 4WD | 2967 | 251 | 341 | 01.21- | ■ |
| S5 TDI Mild Hybrid quattro (DEWB) | | Diesel/el éc. | 4WD | 2967 | 255 | 347 | 12.18-02.20 | ■ |
| 2.0 TDI (DEUB) | | Diesel | FWD | 1968 | 100 | 136 | 05.17-02.20 | ■ |
| 2.0 TDI (CZHA) | | Diesel | FWD | 1968 | 110 | 150 | 01.17-02.20 | ■ |
| 2.0 TDI (DEUA) | | Diesel | FWD | 1968 | 110 | 150 | 01.17-02.20 | ■ |
| 2.0 TDI quattro (CZHA) | | Diesel | 4WD | 1968 | 110 | 150 | 05.17-02.20 | ■ |
| 2.0 TDI quattro (DEUA) | | Diesel | 4WD | 1968 | 110 | 150 | 05.17-02.20 | ■ |
| 35 TDI (DEUA) | | Diesel | FWD | 1968 | 110 | 150 | 01.17-02.20 | ■ |
| 35 TDI (DEZE) | | Diesel | FWD | 1968 | 120 | 163 | 10.19- | ■ |
| 3.0 TDI (CSWB) | | Diesel | FWD | 2967 | 160 | 218 | 03.17-08.18 | ■ |
| 45 TDI quattro (DCPE) | | Diesel | 4WD | 2967 | 170 | 231 | 07.18-02.20 | ■ |
| 3.0 TDI quattro (CRTC) | | Diesel | 4WD | 2967 | 200 | 272 | 02.17-12.17 | ■ |
| 3.0 TDI quattro (DCPC) | | Diesel | 4WD | 2967 | 210 | 286 | 01.17-02.20 | ■ |
| 50 TDI quattro (DCPC) | | Diesel | 4WD | 2967 | 210 | 286 | 01.17-02.20 | ■ |
| A5 Sportback (8TA) 07.07-10.17 | | | | | Hatchback (Compact executive car-D Segment) | | | |
| 1.8 TFSI (CJED) | PR 1KW, PR 2EH | Gasolina | FWD | 1798 | 106 | 144 | 09.14-01.17 | ■ |
| 1.8 TFSI (CDHB) | elec.brake detention, PR 1KW | Gasolina | FWD | 1798 | 118 | 160 | 11.09-09.11 | ■ |
| 1.8 TFSI (CJEB) | PR 1KW, PR 2EH | Gasolina | FWD | 1798 | 125 | 170 | 08.11-01.17 | ■ |
| 2.0 TFSI (CDNB) | elec.brake detention, PR 1KW | Gasolina | FWD | 1984 | 132 | 180 | 09.09-06.14 | ■ |
| 2.0 TFSI (CDNC) | elec.brake detention, PR 1KW | Gasolina | FWD | 1984 | 155 | 211 | 09.09-11.13 | ■ |
| 2.0 TFSI quattro (CDNC) | elec.brake detention, PR 1KW | Gasolina | 4WD | 1984 | 155 | 211 | 09.09-01.17 | ■ |
| 2.0 TFSI (CNCD) | PR 1KW, PR 2EH | Gasolina | FWD | 1984 | 165 | 224 | 05.13-05.16 | ■ |
| 2.0 TFSI quattro (CNCD) | PR 1KW, PR 2EH | Gasolina | 4WD | 1984 | 165 | 224 | 05.13-05.16 | ■ |
| 3.0 TFSI quattro (CHMB) | PR 1KW, PR 2EH | Gasolina | 4WD | 2995 | 200 | 272 | 12.11-01.17 | ■ |
| 3.0 TFSI quattro (CMUA) | PR 1KW, PR 2EH | Gasolina | 4WD | 2995 | 200 | 272 | 12.11-01.17 | ■ |
| 3.0 TFSI quattro (CRED) | PR 1KW, PR 2EH | Gasolina | 4WD | 2995 | 200 | 272 | 12.11-01.17 | ■ |
| 3.2 FSI quattro (CALA) | elec.brake detention, PR 1KW | Gasolina | 4WD | 3197 | 195 | 265 | 09.09-03.12 | ■ |
| 2.0 TDI (CAGB) | elec.brake detention, PR 1KW | Diesel | FWD | 1968 | 100 | 136 | 09.09-01.17 | ■ |
| 2.0 TDI (CJCB) | elec.brake detention, PR 1KW | Diesel | FWD | 1968 | 100 | 136 | 09.09-01.17 | ■ |
| 2.0 TDI (CSUB) | elec.brake detention, PR 1KW | Diesel | FWD | 1968 | 100 | 136 | 09.09-01.17 | ■ |
| 2.0 TDI (CAGA) | elec.brake detention, PR 1KW | Diesel | FWD | 1968 | 105 | 143 | 09.09-01.17 | ■ |
| 2.0 TDI (CJCA) | elec.brake detention, PR 1KW | Diesel | FWD | 1968 | 105 | 143 | 09.09-01.17 | ■ |
| 2.0 TDI (CMEA) | elec.brake detention, PR 1KW | Diesel | FWD | 1968 | 105 | 143 | 09.09-01.17 | ■ |
| 2.0 TDI (CMFA) | elec.brake detention, PR 1KW | Diesel | FWD | 1968 | 105 | 143 | 09.09-01.17 | ■ |

LISTA DE APLICACIONES - BUYERS GUIDE

| | | | | | | | | |
|-----------------------------------|------------------------------|---------------|-----|------|---|-----|-------------|---|
| 2.0 TDI (CJCD) | PR 1KW, PR 2EH | Diesel | FWD | 1968 | 110 | 150 | 05.13-01.17 | ■ |
| 2.0 TDI (CMFB) | PR 1KW, PR 2EH | Diesel | FWD | 1968 | 110 | 150 | 05.13-01.17 | ■ |
| 2.0 TDI (CSUA) | PR 1KW, PR 2EH | Diesel | FWD | 1968 | 110 | 150 | 05.13-01.17 | ■ |
| 2.0 TDI (CAHB) | elec.brake detention, PR 1KW | Diesel | FWD | 1968 | 120 | 163 | 09.09-01.17 | ■ |
| 2.0 TDI (CGLD) | elec.brake detention, PR 1KW | Diesel | FWD | 1968 | 120 | 163 | 09.09-01.17 | ■ |
| 2.0 TDI (CNHC) | elec.brake detention, PR 1KW | Diesel | FWD | 1968 | 120 | 163 | 09.09-01.17 | ■ |
| 2.0 TDI (CAHA) | PR 1KW, elec.brake detention | Diesel | FWD | 1968 | 125 | 170 | 09.09-03.12 | ■ |
| 2.0 TDI quattro (CAHA) | elec.brake detention, PR 1KW | Diesel | 4WD | 1968 | 125 | 170 | 09.09-03.12 | ■ |
| 2.0 TDI (CGLC) | PR 1KW, PR 2EH | Diesel | FWD | 1968 | 130 | 177 | 10.11-01.17 | ■ |
| 2.0 TDI quattro (CGLC) | PR 1KW, PR 2EH | Diesel | 4WD | 1968 | 130 | 177 | 12.11-01.17 | ■ |
| 2.0 TDI (CNHA) | PR 1KW, PR 2EH | Diesel | FWD | 1968 | 140 | 190 | 09.13-01.17 | ■ |
| 2.0 TDI quattro (CNHA) | PR 1KW, PR 2EH | Diesel | 4WD | 1968 | 140 | 190 | 09.13-01.17 | ■ |
| 2.7 TDI (CGKB) | elec.brake detention, PR 1KW | Diesel | FWD | 2698 | 120 | 163 | 09.09-03.12 | ■ |
| 2.7 TDI (CAMA) | elec.brake detention, PR 1KW | Diesel | FWD | 2698 | 140 | 190 | 09.09-03.12 | ■ |
| 2.7 TDI (CGKA) | elec.brake detention, PR 1KW | Diesel | FWD | 2698 | 140 | 190 | 09.09-03.12 | ■ |
| 3.0 TDI (CLAB) | PR 1KW, PR 2EH | Diesel | FWD | 2967 | 150 | 204 | 10.11-01.17 | ■ |
| 3.0 TDI quattro (CCWA) | elec.brake detention, PR 1KW | Diesel | 4WD | 2967 | 176 | 240 | 09.09-03.12 | ■ |
| 3.0 TDI quattro (CDUC) | PR 1KW, PR 2EH | Diesel | 4WD | 2967 | 180 | 245 | 10.11-01.17 | ■ |
| 3.0 TDI quattro (CKVB) | PR 1KW, PR 2EH | Diesel | 4WD | 2967 | 180 | 245 | 10.11-01.17 | ■ |
| 3.0 TDI quattro (CKVC) | PR 1KW, PR 2EH | Diesel | 4WD | 2967 | 180 | 245 | 10.11-01.17 | ■ |
| A6 IV C7 (4G2, 4GC) 11.10- | | | | | Saloon (Executive car-E Segment) | | | |
| 1.8 TFSI (CYGA) | PR 1KW | Gasolina | FWD | 1798 | 140 | 190 | 09.14-09.18 | ■ |
| 2.0 TFSI (CDNB) | PR 1KW | Gasolina | FWD | 1984 | 132 | 180 | 05.11-09.18 | ■ |
| 2.0 TFSI (CAEB) | PR 1KW | Gasolina | FWD | 1984 | 155 | 211 | 03.11-05.13 | ■ |
| 2.0 TFSI quattro (CAEB) | PR 1KW | Gasolina | 4WD | 1984 | 155 | 211 | 05.12-04.15 | ■ |
| 2.0 TFSI (CAED) | PR 1KW | Gasolina | FWD | 1984 | 162 | 220 | 05.13-09.18 | ■ |
| 2.0 TFSI quattro (CAED) | | Gasolina | 4WD | 1984 | 162 | 220 | 05.13-09.18 | ■ |
| 2.0 TFSI (CYNB) | PR 1KW | Gasolina | FWD | 1984 | 185 | 252 | 09.14-09.18 | ■ |
| 2.0 TFSI (CYPA) | PR 1KW | Gasolina | FWD | 1984 | 185 | 252 | 09.14-09.18 | ■ |
| 2.8 FSI (CHVA) | PR 1KW | Gasolina | FWD | 2773 | 150 | 204 | 11.10-04.15 | ■ |
| 2.8 FSI quattro (CHVA) | PR 1KW | Gasolina | 4WD | 2773 | 150 | 204 | 11.10-04.15 | ■ |
| 3.0 | PR 1KW | Gasolina | FWD | 2995 | 213 | 290 | 11.11- | ■ |
| 3.0 | | Gasolina | FWD | 2995 | 213 | 290 | 11.11- | ■ |
| 3.0 TFSI quattro (CCAA) | PR 1KW | Gasolina | 4WD | 2995 | 220 | 300 | 11.10-05.12 | ■ |
| 3.0 TFSI quattro (CGWB) | PR 1KW | Gasolina | 4WD | 2995 | 220 | 300 | 11.10-05.12 | ■ |
| 3.0 TFSI quattro (CGWD) | PR 1KW | Gasolina | 4WD | 2995 | 228 | 310 | 03.11-09.18 | ■ |
| 3.0 TFSI quattro (CGXB) | PR 1KW | Gasolina | 4WD | 2995 | 228 | 310 | 03.11-09.18 | ■ |
| 3.0 TFSI quattro (CTUA) | PR 1KW | Gasolina | 4WD | 2995 | 228 | 310 | 03.11-09.18 | ■ |
| 3.0 TFSI quattro (CREC) | PR 1KW | Gasolina | 4WD | 2995 | 245 | 333 | 09.14-09.18 | ■ |
| S6 quattro (CEUC) | PR 1KW | Gasolina | 4WD | 3993 | 309 | 420 | 02.12-09.18 | ■ |
| S6 quattro (CTGE) | PR 1KW | Gasolina | 4WD | 3993 | 331 | 450 | 10.14-09.18 | ■ |
| 2.0 TFSI Hybrid (CHJA) | PR 1KW | Gasol./el éc. | FWD | 1984 | 180 | 245 | 11.11-04.15 | ■ |
| 2.0 TDI (CSUD) | PR 1KW | Diesel | FWD | 1968 | 110 | 150 | 09.14-09.18 | ■ |
| 2.0 TDI (DDCB) | PR 1KW | Diesel | FWD | 1968 | 110 | 150 | 09.14-09.18 | ■ |
| 2.0 TDI (CGLD) | PR 1KW | Diesel | FWD | 1968 | 120 | 163 | 03.11-09.18 | ■ |
| 2.0 TDI (CGLC) | PR 1KW | Diesel | FWD | 1968 | 130 | 177 | 03.11-09.18 | ■ |
| 2.0 TDI (CMGB) | PR 1KW | Diesel | FWD | 1968 | 130 | 177 | 03.11-09.18 | ■ |
| 2.0 TDI (CNHA) | PR 1KW | Diesel | FWD | 1968 | 140 | 190 | 11.13-09.18 | ■ |
| 2.0 TDI (CZJA) | PR 1KW | Diesel | FWD | 1968 | 140 | 190 | 11.13-09.18 | ■ |
| 2.0 TDI (DDDA) | PR 1KW | Diesel | FWD | 1968 | 140 | 190 | 11.13-09.18 | ■ |
| 3.0 TDI (CLAB) | PR 1KW | Diesel | FWD | 2967 | 150 | 204 | 11.10-09.18 | ■ |

LISTA DE APLICACIONES - BUYERS GUIDE

| | | | | | | | | |
|---|--------|----------|-----|------|---|-----|-------------|---|
| 3.0 TDI quattro (CLAA) | PR 1KW | Diesel | 4WD | 2967 | 150 | 204 | 03.11-09.18 | ■ |
| 3.0 TDI (CTCB) | PR 1KW | Diesel | FWD | 2967 | 155 | 211 | 09.14-09.18 | ■ |
| 3.0 TDI (CZVD) | PR 1KW | Diesel | FWD | 2967 | 155 | 211 | 09.14-09.18 | ■ |
| 3.0 TDI quattro (CRTF) | PR 1KW | Diesel | 4WD | 2967 | 155 | 211 | 09.14-09.18 | ■ |
| 3.0 TDI quattro (CZVC) | PR 1KW | Diesel | 4WD | 2967 | 155 | 211 | 09.14-09.18 | ■ |
| 3.0 TDI (CTCC) | PR 1KW | Diesel | FWD | 2967 | 160 | 218 | 09.14-09.18 | ■ |
| 3.0 TDI (CZVB) | PR 1KW | Diesel | FWD | 2967 | 160 | 218 | 09.14-09.18 | ■ |
| 3.0 TDI quattro (CRTE) | PR 1KW | Diesel | 4WD | 2967 | 160 | 218 | 09.14-09.18 | ■ |
| 3.0 TDI quattro (CZVA) | PR 1KW | Diesel | 4WD | 2967 | 160 | 218 | 09.14-09.18 | ■ |
| 3.0 TDI quattro | PR 1KW | Diesel | 4WD | 2967 | 176 | 239 | 05.13- | ■ |
| 3.0 TDI quattro (CDUC) | PR 1KW | Diesel | 4WD | 2967 | 180 | 245 | 03.11-09.18 | ■ |
| 3.0 TDI quattro (CDUD) | PR 1KW | Diesel | 4WD | 2967 | 180 | 245 | 03.11-09.18 | ■ |
| 3.0 TDI quattro (CKVB) | PR 1KW | Diesel | 4WD | 2967 | 180 | 245 | 03.11-09.18 | ■ |
| 3.0 TDI quattro (CKVC) | PR 1KW | Diesel | 4WD | 2967 | 180 | 245 | 03.11-09.18 | ■ |
| 3.0 TDI quattro (CRTD) | PR 1KW | Diesel | 4WD | 2967 | 200 | 272 | 09.14-09.18 | ■ |
| 3.0 TDI quattro (CGQB) | PR 1KW | Diesel | 4WD | 2967 | 230 | 313 | 11.11-09.18 | ■ |
| 3.0 TDI quattro (CVUA) | PR 1KW | Diesel | 4WD | 2967 | 235 | 320 | 09.14-09.18 | ■ |
| 3.0 TDI quattro (CVUB) | | Diesel | 4WD | 2967 | 240 | 326 | 09.14-09.18 | ■ |
| A6 IV C7 Avant (4G5, 4GD) 05.11- | | | | | Estate (Executive car-E Segment) | | | |
| 1.8 TFSI (CYGA) | PR 1KW | Gasolina | FWD | 1798 | 140 | 190 | 09.14-09.18 | ■ |
| 2.0 TFSI (CDNB) | PR 1KW | Gasolina | FWD | 1984 | 132 | 180 | 06.11-09.18 | ■ |
| 2.0 TFSI (CYNB) | PR 1KW | Gasolina | FWD | 1984 | 185 | 252 | 09.14-09.18 | ■ |
| 2.0 TFSI (CYPA) | PR 1KW | Gasolina | FWD | 1984 | 185 | 252 | 09.14-09.18 | ■ |
| 2.8 FSI (CHVA) | PR 1KW | Gasolina | FWD | 2773 | 150 | 204 | 05.11-04.15 | ■ |
| 2.8 FSI quattro (CHVA) | PR 1KW | Gasolina | 4WD | 2773 | 150 | 204 | 05.11-04.15 | ■ |
| 3.0 TFSI quattro (CGWB) | PR 1KW | Gasolina | 4WD | 2995 | 220 | 300 | 05.11-05.12 | ■ |
| 3.0 TFSI quattro (CGWD) | PR 1KW | Gasolina | 4WD | 2995 | 228 | 310 | 11.11-09.18 | ■ |
| 3.0 TFSI quattro (CREC) | PR 1KW | Gasolina | 4WD | 2995 | 245 | 333 | 09.14-09.18 | ■ |
| S6 quattro (CEUC) | | Gasolina | 4WD | 3993 | 309 | 420 | 02.12-09.18 | ■ |
| S6 quattro (CTGE) | PR 1KW | Gasolina | 4WD | 3993 | 331 | 450 | 10.14-09.18 | ■ |
| 2.0 TDI (CSUD) | PR 1KW | Diesel | FWD | 1968 | 110 | 150 | 09.14-09.18 | ■ |
| 2.0 TDI (DDCB) | PR 1KW | Diesel | FWD | 1968 | 110 | 150 | 09.14-09.18 | ■ |
| 2.0 TDI (CGLD) | PR 1KW | Diesel | FWD | 1968 | 120 | 163 | 05.11-09.18 | ■ |
| 2.0 TDI (CGLC) | PR 1KW | Diesel | FWD | 1968 | 130 | 177 | 05.11-09.18 | ■ |
| 2.0 TDI (CMGB) | PR 1KW | Diesel | FWD | 1968 | 130 | 177 | 05.11-09.18 | ■ |
| 2.0 TDI (CNHA) | PR 1KW | Diesel | FWD | 1968 | 140 | 190 | 11.13-09.18 | ■ |
| 2.0 TDI (CZJA) | PR 1KW | Diesel | FWD | 1968 | 140 | 190 | 11.13-09.18 | ■ |
| 2.0 TDI (DDDA) | PR 1KW | Diesel | FWD | 1968 | 140 | 190 | 11.13-09.18 | ■ |
| 3.0 TDI (CLAB) | PR 1KW | Diesel | FWD | 2967 | 150 | 204 | 05.11-09.18 | ■ |
| 3.0 TDI quattro (CLAA) | PR 1KW | Diesel | 4WD | 2967 | 150 | 204 | 05.11-09.18 | ■ |
| 3.0 TDI (CTCB) | PR 1KW | Diesel | FWD | 2967 | 155 | 211 | 09.14-09.18 | ■ |
| 3.0 TDI (CZVD) | PR 1KW | Diesel | FWD | 2967 | 155 | 211 | 09.14-09.18 | ■ |
| 3.0 TDI quattro (CRTF) | PR 1KW | Diesel | 4WD | 2967 | 155 | 211 | 09.14-09.18 | ■ |
| 3.0 TDI quattro (CZVC) | PR 1KW | Diesel | 4WD | 2967 | 155 | 211 | 09.14-09.18 | ■ |
| 3.0 TDI (CTCC) | PR 1KW | Diesel | FWD | 2967 | 160 | 218 | 09.14-09.18 | ■ |
| 3.0 TDI (CZVB) | PR 1KW | Diesel | FWD | 2967 | 160 | 218 | 09.14-09.18 | ■ |
| 3.0 TDI quattro (CRTE) | PR 1KW | Diesel | 4WD | 2967 | 160 | 218 | 09.14-09.18 | ■ |
| 3.0 TDI quattro (CZVA) | PR 1KW | Diesel | 4WD | 2967 | 160 | 218 | 09.14-09.18 | ■ |
| 3.0 TDI quattro (CDUC) | PR 1KW | Diesel | 4WD | 2967 | 180 | 245 | 05.11-09.18 | ■ |
| 3.0 TDI quattro (CDUD) | PR 1KW | Diesel | 4WD | 2967 | 180 | 245 | 05.11-09.18 | ■ |
| 3.0 TDI quattro (CKVB) | PR 1KW | Diesel | 4WD | 2967 | 180 | 245 | 05.11-09.18 | ■ |

LISTA DE APLICACIONES - BUYERS GUIDE

| | | | | | | | | |
|-------------------------------------|--------|---------------|-----|------|---|-----|-------------|---|
| 3.0 TDI quattro (CKVC) | PR 1KW | Diesel | 4WD | 2967 | 180 | 245 | 05.11-09.18 | ■ |
| 3.0 TDI quattro (CRTD) | PR 1KW | Diesel | 4WD | 2967 | 200 | 272 | 09.14-09.18 | ■ |
| 3.0 TDI quattro (CGQB) | PR 1KW | Diesel | 4WD | 2967 | 230 | 313 | 11.11-09.18 | ■ |
| 3.0 TDI quattro (CVUA) | PR 1KW | Diesel | 4WD | 2967 | 235 | 320 | 09.14-09.18 | ■ |
| 3.0 TDI quattro (CVUB) | PR 1KW | Diesel | 4WD | 2967 | 240 | 326 | 09.14-09.18 | ■ |
| A6 V C8 Avant (4A5) 05.18- | | | | | Estate (Executive car-E Segment) | | | |
| 40 TFSI 12V | | Gasolina | FWD | 1984 | 140 | 190 | 04.20- | ■ |
| 40 TFSI (DMTC) | | Gasolina | FWD | 1984 | 150 | 204 | 09.20- | ■ |
| 45 TFSI | | Gasolina | FWD | 1984 | 180 | 245 | 04.20- | ■ |
| 45 TFSI quattro | | Gasolina | 4WD | 1984 | 195 | 265 | 10.22- | ■ |
| 40 TFSI Mild Hybrid | | Gasol./el éc. | FWD | 1984 | 140 | 190 | 02.19- | ■ |
| 40 TFSI Mild Hybrid | | Gasol./el éc. | FWD | 1984 | 150 | 204 | 01.21- | ■ |
| 45 TFSI Mild Hybrid (DKNA) | | Gasol./el éc. | FWD | 1984 | 180 | 245 | 08.18- | ■ |
| 45 TFSI Mild Hybrid (DLHA) | | Gasol./el éc. | FWD | 1984 | 180 | 245 | 08.18- | ■ |
| 45 TFSI Mild hybrid quattro (DKNA) | | Gasol./el éc. | 4WD | 1984 | 180 | 245 | 08.18- | ■ |
| 45 TFSI Mild hybrid quattro (DLHA) | | Gasol./el éc. | 4WD | 1984 | 180 | 245 | 08.18- | ■ |
| 45 TFSI Mild Hybrid (DMTA) | | Gasol./el éc. | FWD | 1984 | 195 | 265 | 05.20- | ■ |
| 45 TFSI Mild hybrid quattro (DMTA) | | Gasol./el éc. | 4WD | 1984 | 195 | 265 | 05.20- | ■ |
| 50 TFSI e quattro | | Gasol./el éc. | 4WD | 1984 | 220 | 299 | 02.21- | ■ |
| 30 TDI Mild Hybrid (DEZF) | | Diesel/el éc. | FWD | 1968 | 100 | 136 | 01.19- | ■ |
| 35 TDI Mild Hybrid (DEZD) | | Diesel/el éc. | FWD | 1968 | 120 | 163 | 03.19- | ■ |
| 40 TDI Mild Hybrid (DFBA) | | Diesel/el éc. | FWD | 1968 | 150 | 204 | 05.18- | ■ |
| 40 TDI Mild Hybrid quattro (DFBA) | | Diesel/el éc. | 4WD | 1968 | 150 | 204 | 07.18- | ■ |
| 45 TDI Mild Hybrid quattro (DDVF) | | Diesel/el éc. | 4WD | 2967 | 155 | 211 | 07.18- | ■ |
| 45 TDI Mild Hybrid quattro (DDVE) | | Diesel/el éc. | 4WD | 2967 | 170 | 231 | 05.18- | ■ |
| 45 TDI Mild Hybrid quattro | | Diesel/el éc. | 4WD | 2967 | 180 | 245 | 01.21- | ■ |
| 50 TDI Mild Hybrid quattro (DDVB) | | Diesel/el éc. | 4WD | 2967 | 210 | 286 | 05.18- | ■ |
| 45 TDI quattro | | Diesel | 4WD | 2967 | 183 | 249 | 07.19- | ■ |
| A6 V Allroad C8 (4AH) 11.18- | | | | | Estate (Executive car-E Segment) | | | |
| 40 TDI Mild Hybrid quattro | | Diesel/el éc. | 4WD | 1968 | 150 | 204 | 09.20- | ■ |
| 45 TDI Mild Hybrid quattro (DDVE) | | Diesel/el éc. | 4WD | 2967 | 170 | 231 | 11.18- | ■ |
| 45 TDI Mild Hybrid quattro | | Diesel/el éc. | 4WD | 2967 | 180 | 245 | 01.21- | ■ |
| 50 TDI Mild Hybrid quattro (DDVB) | | Diesel/el éc. | 4WD | 2967 | 210 | 286 | 11.18- | ■ |
| A6 V C8 (4A2) 02.18- | | | | | Saloon (Executive car-E Segment) | | | |
| 40 TFSI (DMTC) | | Gasolina | FWD | 1984 | 150 | 204 | 09.20- | ■ |
| 45 TFSI | | Gasolina | FWD | 1984 | 185 | 252 | 11.19- | ■ |
| 45 TFSI quattro (DLHB) | | Gasolina | 4WD | 1984 | 185 | 252 | 11.19- | ■ |
| 40 TFSI Mild Hybrid | | Gasol./el éc. | FWD | 1984 | 140 | 190 | 02.19- | ■ |
| 40 TFSI Mild Hybrid | | Gasol./el éc. | FWD | 1984 | 150 | 204 | 01.21- | ■ |

LISTA DE APLICACIONES - BUYERS GUIDE

| | | | | | | | | |
|-------------------------------------|--|------------------|-----|------|--|-----|--------|---|
| 45 TFSI Mild Hybrid (DKNA) | | Gasol./el éc. | FWD | 1984 | 180 | 245 | 08.18- | ■ |
| 45 TFSI Mild Hybrid (DLHA) | | Gasol./el éc. | FWD | 1984 | 180 | 245 | 08.18- | ■ |
| 45 TFSI Mild hybrid quattro (DKNA) | | Gasol./el éc. | 4WD | 1984 | 180 | 245 | 08.18- | ■ |
| 45 TFSI Mild hybrid quattro (DLHA) | | Gasol./el éc. | 4WD | 1984 | 180 | 245 | 08.18- | ■ |
| 45 TFSI Mild Hybrid (DMTA) | | Gasol./el éc. | FWD | 1984 | 195 | 265 | 05.20- | ■ |
| 45 TFSI Mild hybrid quattro (DMTA) | | Gasol./el éc. | 4WD | 1984 | 195 | 265 | 05.20- | ■ |
| 50 TFSI e quattro (DLGA) | | Gasol./el éc. | 4WD | 1984 | 220 | 299 | 11.19- | ■ |
| 50 TFSI e quattro | | Gasol./el éc. | 4WD | 1984 | 220 | 299 | 02.21- | ■ |
| 30 TDI Mild Hybrid (DEZF) | | Diesel/el éc. | FWD | 1968 | 100 | 136 | 01.19- | ■ |
| 35 TDI Mild Hybrid (DEZD) | | Diesel/el éc. | FWD | 1968 | 120 | 163 | 03.19- | ■ |
| 40 TDI Mild Hybrid (DFBA) | | Diesel/el éc. | FWD | 1968 | 150 | 204 | 07.18- | ■ |
| 40 TDI Mild Hybrid quattro | | Diesel/el éc. | 4WD | 1968 | 150 | 204 | 07.18- | ■ |
| 45 TDI Mild Hybrid quattro (DDVF) | | Diesel/el éc. | 4WD | 2967 | 155 | 211 | 07.18- | ■ |
| 45 TDI Mild Hybrid quattro (DDVE) | | Diesel/el éc. | 4WD | 2967 | 170 | 231 | 07.18- | ■ |
| 45 TDI Mild Hybrid quattro | | Diesel/el éc. | 4WD | 2967 | 180 | 245 | 01.21- | ■ |
| 50 TDI Mild Hybrid quattro (DDVB) | | Diesel/el éc. | 4WD | 2967 | 210 | 286 | 02.18- | ■ |
| 40 TDI | | Diesel | FWD | 1968 | 140 | 190 | 02.19- | ■ |
| 45 TDI quattro | | Diesel | 4WD | 2967 | 183 | 249 | 07.19- | ■ |
| A7 II Sportback (4KA) 10.17- | | | | | Hatchback (Executive car-E Segment) | | | |
| 40 TFSI 12V (DKYA) | | Gasolina | FWD | 1984 | 140 | 190 | 11.19- | ■ |
| 40 TFSI | | Gasolina | FWD | 1984 | 150 | 204 | 11.22- | ■ |
| 45 TFSI (DLHA) | | Gasolina | FWD | 1984 | 180 | 245 | 11.19- | ■ |
| 45 TFSI | | Gasolina | FWD | 1984 | 195 | 265 | 11.22- | ■ |
| 40 TFSI Mild Hybrid | | Gasol./el éc. | FWD | 1984 | 140 | 190 | 08.20- | ■ |
| 40 TFSI Mild Hybrid | | Gasol./el éc. | FWD | 1984 | 150 | 204 | 08.20- | ■ |
| 45 TFSI Mild Hybrid (DKNA) | | Gasol./el éc. | FWD | 1984 | 180 | 245 | 07.18- | ■ |
| 45 TFSI Mild Hybrid (DLHA) | | Gasol./el éc. | FWD | 1984 | 180 | 245 | 07.18- | ■ |
| 45 TFSI Mild hybrid quattro (DKNA) | | Gasol./el éc. | 4WD | 1984 | 180 | 245 | 07.18- | ■ |
| 45 TFSI Mild hybrid quattro (DLHA) | | Gasol./el éc. | 4WD | 1984 | 180 | 245 | 07.18- | ■ |
| 45 TFSI Mild Hybrid | | Gasol./el éc. | FWD | 1984 | 195 | 265 | 05.20- | ■ |
| 45 TFSI Mild hybrid quattro | | Gasol./el éc. | 4WD | 1984 | 195 | 265 | 05.20- | ■ |
| 50 TFSI e quattro (DLGA) | | Gasol./el éc. | 4WD | 1984 | 220 | 299 | 11.19- | ■ |
| 50 TFSI e quattro | | Gasol./el éc. | 4WD | 1984 | 220 | 299 | 07.21- | ■ |
| 55 TFSI e quattro | | Gasol./el éc. | 4WD | 1984 | 270 | 367 | 07.19- | ■ |
| 55 TFSI e quattro | | Gasol./el éc. | 4WD | 1984 | 270 | 367 | 02.21- | ■ |
| S7 TFSI Mild Hybrid quattro | | Gasol./el éc. | 4WD | 2894 | 331 | 450 | 01.20- | ■ |
| 35 TDI Mild Hybrid | | Diesel/el éc. | FWD | 1968 | 120 | 163 | 10.20- | ■ |

LISTA DE APLICACIONES - BUYERS GUIDE

| | | | | | | | | |
|--|------------------------------|---------------|-----|------|---|-----|-------------|---|
| 40 TDI Mild Hybrid (DFBA) | | Diesel/el éc. | FWD | 1968 | 150 | 204 | 09.18- | ■ |
| 40 TDI Mild Hybrid quattro (DFBA) | | Diesel/el éc. | 4WD | 1968 | 150 | 204 | 09.18- | ■ |
| 45 TDI Mild Hybrid quattro (DDVF) | | Diesel/el éc. | 4WD | 2967 | 155 | 211 | 04.18- | ■ |
| 45 TDI Mild Hybrid quattro (DDVE) | | Diesel/el éc. | 4WD | 2967 | 170 | 231 | 06.18- | ■ |
| 45 TDI Mild Hybrid quattro | | Diesel/el éc. | 4WD | 2967 | 180 | 245 | 01.21- | ■ |
| 50 TDI Mild Hybrid quattro (DDVB) | | Diesel/el éc. | 4WD | 2967 | 210 | 286 | 10.17- | ■ |
| S7 TDI Mild Hybrid quattro | | Diesel/el éc. | 4WD | 2967 | 253 | 344 | 11.20- | ■ |
| S7 TDI Mild Hybrid quattro (DEWA) | | Diesel/el éc. | 4WD | 2967 | 257 | 349 | 03.19- | ■ |
| A7 Sportback (4GA, 4GF) 07.10-11.19 | | | | | Hatchback (Executive car-E Segment) | | | |
| 2.0 TFSI quattro (CYPB) | PR 1KW | Gasolina | 4WD | 1984 | 183 | 249 | 05.15-05.18 | ■ |
| 2.0 TFSI (CYPB) | PR 1KW | Gasolina | FWD | 1984 | 185 | 252 | 09.14-05.18 | ■ |
| 2.0 TFSI quattro (CYNB) | PR 1KW | Gasolina | 4WD | 1984 | 185 | 252 | 05.15-05.18 | ■ |
| 2.0 TFSI quattro (CYPB) | PR 1KW | Gasolina | 4WD | 1984 | 185 | 252 | 05.15-05.18 | ■ |
| 2.8 FSI (CHVA) | PR 1KW | Gasolina | FWD | 2773 | 150 | 204 | 02.11-03.15 | ■ |
| 2.8 FSI quattro (CHVA) | elec.brake detention, PR 1KW | Gasolina | 4WD | 2773 | 150 | 204 | 10.10-03.15 | ■ |
| 2.8 FSI quattro (CNYA) | elec.brake detention, PR 1KW | Gasolina | 4WD | 2773 | 150 | 204 | 10.10-03.15 | ■ |
| 3.0 TFSI quattro (CGWB) | elec.brake detention, PR 1KW | Gasolina | 4WD | 2995 | 220 | 300 | 10.10-05.12 | ■ |
| 3.0 TFSI quattro (CHMA) | elec.brake detention, PR 1KW | Gasolina | 4WD | 2995 | 220 | 300 | 10.10-05.12 | ■ |
| 3.0 TFSI quattro (CGWD) | | Gasolina | 4WD | 2995 | 228 | 310 | 01.11-03.15 | ■ |
| 3.0 TFSI quattro (CGXB) | | Gasolina | 4WD | 2995 | 228 | 310 | 01.11-03.15 | ■ |
| 3.0 TFSI quattro (CTTA) | | Gasolina | 4WD | 2995 | 228 | 310 | 01.11-03.15 | ■ |
| 3.0 TFSI quattro (CTUA) | | Gasolina | 4WD | 2995 | 228 | 310 | 01.11-03.15 | ■ |
| 3.0 TFSI quattro (CREC) | PR 1KW | Gasolina | 4WD | 2995 | 245 | 333 | 05.14-05.18 | ■ |
| S7 quattro (CEUC) | | Gasolina | 4WD | 3993 | 309 | 420 | 02.12-03.15 | ■ |
| S7 quattro (CTGE) | PR 1KW | Gasolina | 4WD | 3993 | 331 | 450 | 07.14-05.18 | ■ |
| RS7 quattro (CRDB) | | Gasolina | 4WD | 3993 | 412 | 560 | 10.13-04.18 | ■ |
| RS7 quattro (CWUB) | | Gasolina | 4WD | 3993 | 412 | 560 | 10.13-04.18 | ■ |
| 3.0 TDI (CLAB) | elec.brake detention, PR 1KW | Diesel | FWD | 2967 | 150 | 204 | 11.10-03.15 | ■ |
| 3.0 TDI quattro (CLAA) | PR 1KW | Diesel | 4WD | 2967 | 150 | 204 | 12.10-03.15 | ■ |
| 3.0 TDI quattro (CRTF) | PR 1KW | Diesel | 4WD | 2967 | 155 | 211 | 07.14-05.18 | ■ |
| 3.0 TDI quattro (CTCB) | PR 1KW | Diesel | 4WD | 2967 | 155 | 211 | 07.14-05.18 | ■ |
| 3.0 TDI quattro (CZVC) | PR 1KW | Diesel | 4WD | 2967 | 155 | 211 | 07.14-05.18 | ■ |
| 3.0 TDI (CTCC) | PR 1KW, PR 2EH | Diesel | FWD | 2967 | 160 | 218 | 07.14-05.18 | ■ |
| 3.0 TDI (CZVB) | PR 1KW, PR 2EH | Diesel | FWD | 2967 | 160 | 218 | 07.14-05.18 | ■ |
| 3.0 TDI quattro (CRTE) | PR 1KW | Diesel | 4WD | 2967 | 160 | 218 | 07.14-05.18 | ■ |
| 3.0 TDI quattro (CZVA) | PR 1KW | Diesel | 4WD | 2967 | 160 | 218 | 07.14-05.18 | ■ |
| 3.0 TDI quattro (CPNB) | PR 1KW | Diesel | 4WD | 2967 | 176 | 239 | 05.13-06.17 | ■ |
| 3.0 TDI quattro (CDUC) | elec.brake detention, PR 1KW | Diesel | 4WD | 2967 | 180 | 245 | 10.10-06.16 | ■ |
| 3.0 TDI quattro (CDUD) | elec.brake detention, PR 1KW | Diesel | 4WD | 2967 | 180 | 245 | 10.10-06.16 | ■ |
| 3.0 TDI quattro (CKVB) | elec.brake detention, PR 1KW | Diesel | 4WD | 2967 | 180 | 245 | 10.10-06.16 | ■ |
| 3.0 TDI quattro (CKVC) | elec.brake detention, PR 1KW | Diesel | 4WD | 2967 | 180 | 245 | 10.10-06.16 | ■ |
| 3.0 TDI quattro (CRTD) | PR 1KW | Diesel | 4WD | 2967 | 200 | 272 | 05.14-05.18 | ■ |
| 3.0 TDI quattro (CGQB) | | Diesel | 4WD | 2967 | 230 | 313 | 11.11-03.15 | ■ |
| 3.0 TDI quattro (CVUA) | PR 1KW | Diesel | 4WD | 2967 | 235 | 320 | 05.14-05.18 | ■ |
| 3.0 TDI quattro (CVUB) | PR 1KW | Diesel | 4WD | 2967 | 240 | 326 | 09.14-05.18 | ■ |
| Q5 (U.S.A. 8R) 09.08-12.10 | | | | | Closed Off-Road Vehicle (Luxury Crossover SUV-J Segment) | | | |
| 3.2 | PR 1KW, PR 1KE | Gasolina | FWD | | 201 | 274 | 09.08-12.10 | ■ |

LISTA DE APLICACIONES - BUYERS GUIDE

| Q5 (8RB) 11.08-12.17 | | | | | SUV Van (Luxury Crossover SUV-J Segment) | | | |
|--------------------------------|------------------------------|---------------|-----|------|--|-----|-------------|---|
| 2.0 TFSI quattro | PR 1KW | Gasolina | 4WD | 1984 | 155 | 211 | 11.08-09.12 | ■ |
| 3.2 FSI quattro | PR 1KW, PR 1KE | Gasolina | 4WD | 3197 | 199 | 271 | 11.08-09.12 | ■ |
| 2.0 TDI | PR 1KW | Diesel | FWD | 1968 | 100 | 136 | 05.14-05.17 | ■ |
| 2.0 TDI | PR 1KW | Diesel | FWD | 1968 | 105 | 143 | 11.11-05.13 | ■ |
| 2.0 TDI | PR 1KW, PR 2EK | Diesel | FWD | 1968 | 110 | 150 | 06.12-05.17 | ■ |
| 2.0 TDI quattro | PR 1KW | Diesel | 4WD | 1968 | 125 | 170 | 11.08-09.12 | ■ |
| 2.0 TDI quattro | PR 1KW, PR 2EK, 09/12- | Diesel | 4WD | 1968 | 130 | 177 | 07.12-06.14 | ■ |
| 3.0 TDI quattro | PR 1KW, PR 1KE | Diesel | 4WD | 2967 | 176 | 239 | 11.08-04.13 | ■ |
| 3.0 TDI quattro | PR 1KW, PR 2EK, 09/12- | Diesel | 4WD | 2967 | 180 | 245 | 06.12-05.17 | ■ |
| 3.0 TDI quattro | PR 1KW, PR 2EK | Diesel | 4WD | 2967 | 190 | 258 | 11.13-05.17 | ■ |
| Q5 (8RB) 11.08- | | | | | SUV (Luxury Crossover SUV-J Segment) | | | |
| 2.0 TFSI quattro | PR 1KW, PR 2EK, 09/12- | Gasolina | 4WD | 1984 | 130 | 177 | 09.09-10.09 | ■ |
| 2.0 TFSI quattro (CDNB) | elec.brake detention, PR 1KW | Gasolina | 4WD | 1984 | 132 | 180 | 08.09-05.17 | ■ |
| 2.0 TFSI quattro (CNCB) | elec.brake detention, PR 1KW | Gasolina | 4WD | 1984 | 132 | 180 | 08.09-05.17 | ■ |
| 2.0 TFSI quattro (CAEB) | PR 1KW | Gasolina | 4WD | 1984 | 155 | 211 | 11.08-09.12 | ■ |
| 2.0 TFSI quattro (CDNC) | PR 1KW | Gasolina | 4WD | 1984 | 155 | 211 | 11.08-09.12 | ■ |
| 2.0 TFSI quattro (CPMB) | PR 1KW, PR 2EK | Gasolina | 4WD | 1984 | 162 | 220 | 05.13-05.17 | ■ |
| 2.0 TFSI quattro (CNCD) | PR 1KW, PR 2EK, 09/12- | Gasolina | 4WD | 1984 | 165 | 224 | 06.12-05.16 | ■ |
| 3.0 TFSI quattro (CTUC) | PR 1KW, PR 2EK, 09/12- | Gasolina | 4WD | 2995 | 200 | 272 | 06.12-05.17 | ■ |
| 3.0 TFSI quattro (CTVA) | PR 1KW, PR 2EK, 09/12- | Gasolina | 4WD | 2995 | 200 | 272 | 06.12-05.17 | ■ |
| SQ5 TFSI quattro (CTUD) | | Gasolina | 4WD | 2995 | 260 | 354 | 05.13-05.17 | ■ |
| SQ5 TFSI quattro (CTXA) | | Gasolina | 4WD | 2995 | 260 | 354 | 05.13-05.17 | ■ |
| SQ5 TFSI | | Gasolina | FWD | 2995 | 264 | 359 | 03.14- | ■ |
| 3.2 FSI quattro (CALB) | PR 1KW, PR 1KE | Gasolina | 4WD | 3197 | 199 | 270 | 11.08-12.12 | ■ |
| 2.0 TFSI Hybrid quattro (CHJA) | PR 1KW | Gasol./el éc. | 4WD | 1984 | 180 | 245 | 06.11-06.16 | ■ |
| 2.0 TFSI Hybrid quattro (CHJA) | PR 1KW, PR 2EK | Gasol./el éc. | 4WD | 1984 | 180 | 245 | 09.12-05.16 | ■ |
| 2.0 TDI (CJCB) | PR 1KW | Diesel | FWD | 1968 | 100 | 136 | 11.10-05.17 | ■ |
| 2.0 TDI (CSUB) | PR 1KW | Diesel | FWD | 1968 | 100 | 136 | 11.10-05.17 | ■ |
| 2.0 TDI quattro (CAGB) | elec.brake detention, PR 1KW | Diesel | 4WD | 1968 | 100 | 136 | 08.09-05.17 | ■ |
| 2.0 TDI quattro (CJCB) | elec.brake detention, PR 1KW | Diesel | 4WD | 1968 | 100 | 136 | 08.09-05.17 | ■ |
| 2.0 TDI quattro (CSUB) | elec.brake detention, PR 1KW | Diesel | 4WD | 1968 | 100 | 136 | 08.09-05.17 | ■ |
| 2.0 TDI (CJCA) | PR 1KW | Diesel | FWD | 1968 | 105 | 143 | 11.10-05.13 | ■ |
| 2.0 TDI quattro (CAGA) | elec.brake detention, PR 1KW | Diesel | 4WD | 1968 | 105 | 143 | 08.09-05.13 | ■ |
| 2.0 TDI quattro (CJCA) | elec.brake detention, PR 1KW | Diesel | 4WD | 1968 | 105 | 143 | 08.09-05.13 | ■ |
| 2.0 TDI (CJCD) | PR 1KW, PR 2EK | Diesel | FWD | 1968 | 110 | 150 | 05.13-05.17 | ■ |
| 2.0 TDI (CSUA) | PR 1KW, PR 2EK | Diesel | FWD | 1968 | 110 | 150 | 05.13-05.17 | ■ |
| 2.0 TDI quattro (CJCD) | PR 1KW, PR 2EK | Diesel | 4WD | 1968 | 110 | 150 | 05.13-05.17 | ■ |
| 2.0 TDI quattro (CSUA) | PR 1KW, PR 2EK | Diesel | 4WD | 1968 | 110 | 150 | 05.13-05.17 | ■ |
| 2.0 TDI quattro (CAHB) | elec.brake detention, PR 1KW | Diesel | 4WD | 1968 | 120 | 163 | 11.08-05.17 | ■ |
| 2.0 TDI quattro (CGLA) | elec.brake detention, PR 1KW | Diesel | 4WD | 1968 | 120 | 163 | 11.08-05.17 | ■ |
| 2.0 TDI quattro (CGLD) | elec.brake detention, PR 1KW | Diesel | 4WD | 1968 | 120 | 163 | 11.08-05.17 | ■ |
| 2.0 TDI quattro (CNHC) | elec.brake detention, PR 1KW | Diesel | 4WD | 1968 | 120 | 163 | 11.08-05.17 | ■ |
| 2.0 TDI quattro (CAHA) | PR 1KW | Diesel | 4WD | 1968 | 125 | 170 | 11.08-09.12 | ■ |
| 2.0 TDI quattro (CGLB) | PR 1KW | Diesel | 4WD | 1968 | 125 | 170 | 11.08-09.12 | ■ |
| 2.0 TDI quattro (CMGA) | PR 1KW | Diesel | 4WD | 1968 | 125 | 170 | 11.08-09.12 | ■ |
| 2.0 TDI quattro (CGLC) | PR 1KW, PR 2EK, 09/12- | Diesel | 4WD | 1968 | 130 | 177 | 06.12-05.17 | ■ |
| 2.0 TDI quattro (CMGB) | PR 1KW, PR 2EK, 09/12- | Diesel | 4WD | 1968 | 130 | 177 | 06.12-05.17 | ■ |
| 2.0 TDI quattro (CNHA) | PR 1KW, PR 2EK | Diesel | 4WD | 1968 | 140 | 190 | 11.13-05.17 | ■ |

LISTA DE APLICACIONES - BUYERS GUIDE

| | | | | | | | | |
|------------------------------------|------------------------------|---------------|-----|------|---|-----|-------------|---|
| 3.0 TDI quattro (CCWB) | elec.brake detention, PR 1KW | Diesel | 4WD | 2967 | 155 | 211 | 11.08-09.12 | ■ |
| 3.0 TDI quattro (CCWA) | PR 1KW, PR 1KE | Diesel | 4WD | 2967 | 176 | 240 | 11.08-05.17 | ■ |
| 3.0 TDI quattro (CPNB) | PR 1KW, PR 1KE | Diesel | 4WD | 2967 | 176 | 240 | 11.08-05.17 | ■ |
| 3.0 TDI quattro (CDUD) | PR 1KW, PR 2EK, 09/12- | Diesel | 4WD | 2967 | 180 | 245 | 06.12-05.17 | ■ |
| 3.0 TDI quattro (CTBC) | PR 1KW, PR 2EK, 09/12- | Diesel | 4WD | 2967 | 184 | 250 | 06.12-05.17 | ■ |
| 3.0 TDI quattro (CTBA) | PR 1KW, PR 2EK | Diesel | 4WD | 2967 | 190 | 258 | 11.13-05.17 | ■ |
| Q5 II (FYB, FYG) 05.16- | | | | | SUV Van (Luxury Crossover SUV-J Segment) | | | |
| 3.0 SQ5 TDI Mild Hybrid quattro | | Diesel/el éc. | 4WD | 2967 | 255 | 347 | 02.19-11.20 | ■ |
| 3.0 TDI quattro | | Diesel | 4WD | 2967 | 210 | 286 | 07.17-11.20 | ■ |
| Q5 II (FYB, FYG) 05.16- | | | | | SUV (Luxury Crossover SUV-J Segment) | | | |
| 2.0 TFSI quattro (DAXC) | | Gasolina | 4WD | 1984 | 183 | 249 | 01.17-11.20 | ■ |
| 2.0 TFSI quattro (DAXB) | | Gasolina | 4WD | 1984 | 185 | 252 | 06.16-11.20 | ■ |
| 2.0 TFSI quattro (DAYB) | | Gasolina | 4WD | 1984 | 185 | 252 | 06.16-11.20 | ■ |
| SQ5 TFSI quattro (CWGD) | | Gasolina | 4WD | 2995 | 260 | 354 | 11.16- | ■ |
| 40 TFSI Mild Hybrid quattro | | Gasol./el éc. | 4WD | 1984 | 150 | 204 | 10.21- | ■ |
| 45 TFSI Mild hybrid quattro (DGKB) | | Gasol./el éc. | 4WD | 1984 | 180 | 245 | 12.18- | ■ |
| 45 TFSI Mild hybrid quattro (DNDA) | | Gasol./el éc. | 4WD | 1984 | 180 | 245 | 12.18- | ■ |
| 45 TFSI Mild hybrid quattro (DPUA) | | Gasol./el éc. | 4WD | 1984 | 195 | 265 | 08.20- | ■ |
| 45 TFSI Mild hybrid quattro (DPVA) | | Gasol./el éc. | 4WD | 1984 | 195 | 265 | 08.20- | ■ |
| 50 TFSI e quattro (DLGA) | | Gasol./el éc. | 4WD | 1984 | 220 | 299 | 04.19- | ■ |
| 50 TFSI e quattro | | Gasol./el éc. | 4WD | 1984 | 220 | 299 | 02.21- | ■ |
| 55 TFSI e quattro (DLGA) | | Gasol./el éc. | 4WD | 1984 | 270 | 367 | 08.19- | ■ |
| 55 TFSI e quattro | | Gasol./el éc. | 4WD | 1984 | 270 | 367 | 02.21- | ■ |
| 30 TDI Mild Hybrid (DEZB) | | Diesel/el éc. | FWD | 1968 | 100 | 136 | 09.19- | ■ |
| 35 TDI Mild Hybrid (DEZE) | | Diesel/el éc. | FWD | 1968 | 120 | 163 | 09.19- | ■ |
| 40 TDI Mild Hybrid quattro (DFBA) | | Diesel/el éc. | 4WD | 1968 | 150 | 204 | 09.19- | ■ |
| 50 TDI Mild Hybrid quattro (DMGA) | | Diesel/el éc. | 4WD | 2967 | 210 | 286 | 06.20- | ■ |
| SQ5 TDI Mild Hybrid quattro | | Diesel/el éc. | 4WD | 2967 | 251 | 341 | 01.21- | ■ |
| SQ5 TDI Mild Hybrid quattro (DEWB) | | Diesel/el éc. | 4WD | 2967 | 255 | 347 | 02.19-09.20 | ■ |
| 2.0 TDI (DEUB) | | Diesel | FWD | 1968 | 100 | 136 | 01.17-11.20 | ■ |
| 2.0 TDI (DEUA) | | Diesel | FWD | 1968 | 110 | 150 | 01.17-11.20 | ■ |
| 2.0 TDI quattro (DETB) | | Diesel | 4WD | 1968 | 120 | 163 | 06.16-08.18 | ■ |
| 35 TDI | | Diesel | FWD | 1968 | 120 | 163 | 10.21- | ■ |
| 35 TDI quattro (DETB) | | Diesel | 4WD | 1968 | 120 | 163 | 08.18-11.20 | ■ |
| 2.0 TDI quattro (DESA) | | Diesel | 4WD | 1968 | 140 | 190 | 06.16-08.18 | ■ |
| 2.0 TDI quattro (DETA) | | Diesel | 4WD | 1968 | 140 | 190 | 06.16-08.18 | ■ |
| 40 TDI quattro (DESA) | | Diesel | 4WD | 1968 | 140 | 190 | 10.18- | ■ |
| 40 TDI quattro (DETA) | | Diesel | 4WD | 1968 | 140 | 190 | 10.18- | ■ |
| 45 TDI quattro (DCPE) | | Diesel | 4WD | 2967 | 170 | 231 | 08.18-11.20 | ■ |
| 3.0 TDI quattro (DCPC) | | Diesel | 4WD | 2967 | 210 | 286 | 07.17-11.20 | ■ |
| 50 TDI quattro (DCPC) | | Diesel | 4WD | 2967 | 210 | 286 | 03.19-11.20 | ■ |

LISTA DE APLICACIONES - BUYERS GUIDE

| Q5 II Sportback (FYT) 11.20- | | | | | SUV (Luxury Crossover SUV-J Segment) | | | |
|----------------------------------|--------|---------------|-----|------|--------------------------------------|-----|-------------|---|
| 40 TFSI Mild Hybrid quattro | | Gasol./el éc. | 4WD | 1984 | 150 | 204 | 10.21- | ■ |
| 45 TFSI Mild hybrid quattro | | Gasol./el éc. | 4WD | 1984 | 195 | 265 | 11.20- | ■ |
| 50 TFSI e quattro | | Gasol./el éc. | 4WD | 1984 | 220 | 299 | 02.21- | ■ |
| 2.0 55 TFSI e quattro | | Gasol./el éc. | 4WD | 1984 | 270 | 367 | 07.21- | ■ |
| 55 TFSI e quattro | | Gasol./el éc. | 4WD | 1984 | 270 | 367 | 06.21- | ■ |
| SQ5 TFSI quattro | | Gasol./el éc. | 4WD | 2995 | 260 | 354 | 09.22- | ■ |
| 35 TDI Mild Hybrid | | Diesel/el éc. | FWD | 1968 | 120 | 163 | 04.21- | ■ |
| 40 TDI Mild Hybrid quattro | | Diesel/el éc. | 4WD | 1968 | 150 | 204 | 11.20- | ■ |
| 50 TDI Mild Hybrid quattro | | Diesel/el éc. | 4WD | 2967 | 210 | 286 | 11.20- | ■ |
| SQ5 TDI Mild Hybrid quattro | | Diesel/el éc. | 4WD | 2967 | 251 | 341 | 02.21- | ■ |
| CHEVROLET | | | | | | | | |
| SILVERADO / CHEYENNE 01.95-12.07 | | | | | Pickup (Pick-Up Truck) | | | |
| 5.7 | PR 1KW | Gasolina | FWD | 5733 | 184 | 250 | 01.95-12.99 | ■ |
| NISSAN | | | | | | | | |
| PRESIDENT II (JHG50) 03.90-10.02 | | | | | Saloon (Luxury car-F Segment) | | | |
| 4.5 (VH45DE) | PR 1KW | Gasolina | RWD | 4494 | 199 | 271 | 03.90-10.02 | ■ |