

LISTA DE APLICACIONES - BUYERS GUIDE

78BD6153-2



Weight: 20.596

O.E.M.	MAKE
7E0 615 301 D	VW
7H0 615 301 D	VW
JZW 615 301 E	VW

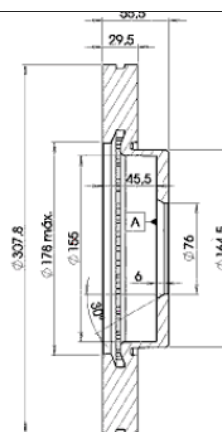

78BD6153-2



Ø308x29.6x55.7

MAKE
VW



Trac.	CC	Kw	CV
-------	----	----	----



Front / Rear

VW

CALIFORNIA T5 (7EC, 7EF, 7EG, 7HF, 7HC) 04.03-04.16

Bus (LCVs-N1 Segment)

2.0 TSI	Gasolina	FWD	1984	110	150	07.12-08.15	■
2.0 TSI	Gasolina	FWD	1984	150	204	05.11-08.15	■
2.0 TSI 4motion	Gasolina	4WD	1984	150	204	07.11-08.15	■
1.9 TDI	Diesel	FWD	1896	62	84	05.07-12.09	■
1.9 TDI	Diesel	FWD	1896	63	85	05.07-11.09	■
1.9 TDI	Diesel	FWD	1896	63	85	05.07-11.09	■
1.9 TDI	Diesel	FWD	1896	75	102	05.07-11.09	■
1.9 TDI	Diesel	FWD	1896	77	105	05.07-11.09	■
2.0 TDI	Diesel	FWD	1968	62	84	09.09-08.15	■
2.0 TDI	Diesel	FWD	1968	75	102	09.09-08.15	■
2.0 TDI	Diesel	FWD	1968	84	114	05.11-08.15	■
2.0 TDI	Diesel	FWD	1968	100	136	05.10-08.15	■
2.0 TDI 4motion	Diesel	4WD	1968	100	136	05.10-08.15	■
2.0 TDI	Diesel	FWD	1968	103	140	09.09-08.15	■
2.0 TDI 4motion	Diesel	4WD	1968	103	140	10.09-08.15	■
2.0 TDI	Diesel	FWD	1968	132	180	09.09-08.15	■
2.0 TDI 4motion	Diesel	4WD	1968	132	180	01.10-08.15	■
2.5 TDI	Diesel	FWD	2461	96	130	05.07-11.09	■
2.5 TDI 4motion	Diesel	4WD	2461	96	130	05.07-11.09	■
2.5 TDI	Diesel	FWD	2461	120	163	05.07-11.09	■
2.5 TDI	Diesel	FWD	2461	128	174	05.07-11.09	■
2.5 TDI 4motion	Diesel	4WD	2461	128	174	05.07-11.09	■

LISTA DE APLICACIONES - BUYERS GUIDE

CALIFORNIA T6 (SGC, SGG, SHC) 04.15-					Bus (LCVs-N1 Segment)			
2.0 TSI		Gasolina	FWD	1984	110	150	04.15-07.19	■
2.0 TSI		Gasolina	FWD	1984	150	204	04.15-07.19	■
2.0 TSI 4motion		Gasolina	4WD	1984	150	204	06.15-07.19	■
2.0 TDI		Diesel	FWD	1968	62	84	04.15-07.19	■
2.0 TDI		Diesel	FWD	1968	66	90	10.19-08.24	■
2.0 TDI		Diesel	FWD	1968	75	102	04.15-12.19	■
2.0 TDI		Diesel	FWD	1968	81	110	07.19-08.24	■
2.0 TDI		Diesel	FWD	1968	84	114	05.16-08.19	■
2.0 TDI		Diesel	FWD	1968	103	140	04.15-12.19	■
2.0 TDI 4motion		Diesel	4WD	1968	103	140	06.15-12.19	■
2.0 TDI		Diesel	FWD	1968	110	150	04.15-08.24	■
2.0 TDI 4motion		Diesel	4WD	1968	110	150	08.15-08.24	■
2.0 TDI		Diesel	FWD	1968	132	180	04.15-12.19	■
2.0 TDI 4motion		Diesel	4WD	1968	132	180	06.15-12.19	■
2.0 TDI		Diesel	FWD	1968	146	199	08.18-08.24	■
2.0 TDI 4motion		Diesel	4WD	1968	146	199	08.18-08.24	■
2.0 TDI		Diesel	FWD	1968	150	204	06.15-08.24	■
2.0 TDI 4motion		Diesel	4WD	1968	150	204	06.15-08.24	■
MULTIVAN V (7HM, 7HN, 7HF, 7EF, 7EM, 7EN) 04.03-03.16					Bus (Minibus-M2-Segment)			
2.0 (AXA)	Rim 16	Gasolina	FWD	1984	85	115	11.03-08.15	■
2.0 TSI (CJKB)		Gasolina	FWD	1984	110	150	07.12-08.15	■
2.0 TSI (CJKA)		Gasolina	FWD	1984	150	204	05.11-08.15	■
2.0 TSI 4motion (CJKA)	PR 2E3	Gasolina	4WD	1984	150	204	07.11-08.15	■
3.2		Gasolina	FWD	3189	170	231	11.03-06.06	■
VR6 3.2 (BDL)	Rim 16	Gasolina	FWD	3189	170	231	02.04-06.04	■
VR6 3.2 (BKK)	Rim 16	Gasolina	FWD	3189	173	235	02.04-12.09	■
VR6 3.2 (CFLA)	Rim 16	Gasolina	FWD	3189	173	235	02.04-12.09	■
VR6 3.2 4motion (BKK)	Rim 16	Gasolina	4WD	3189	173	235	07.04-12.09	■
VR6 3.2 4motion (CFLA)	Rim 16	Gasolina	4WD	3189	173	235	07.04-12.09	■
1.9 TDI (BRR)	Rim 16	Diesel	FWD	1896	62	84	01.06-11.09	■
1.9 TDI (AXC)	PR 2E3	Diesel	FWD	1896	63	85	04.03-11.09	■
1.9 TDI (BRS)	Rim 16	Diesel	FWD	1896	75	102	01.06-11.09	■
1.9 TDI (AXB)	Rim 16	Diesel	FWD	1896	77	105	04.03-11.09	■
2.0 TDI (CAAA)		Diesel	FWD	1968	62	84	09.09-08.15	■
2.0 TDI (CAAB)		Diesel	FWD	1968	75	102	09.09-08.15	■
2.0 TDI (CAAD)		Diesel	FWD	1968	84	114	05.11-08.15	■
2.0 TDI (CAAE)		Diesel	FWD	1968	100	136	05.10-08.15	■
2.0 TDI (CCHB)		Diesel	FWD	1968	100	136	05.10-08.15	■
2.0 TDI 4motion (CAAE)		Diesel	4WD	1968	100	136	05.10-08.15	■
2.0 TDI 4motion (CCHB)		Diesel	4WD	1968	100	136	05.10-08.15	■
2.0 TDI (CAAC)		Diesel	FWD	1968	103	140	09.09-08.15	■
2.0 TDI (CCHA)		Diesel	FWD	1968	103	140	09.09-08.15	■
2.0 TDI 4motion (CAAC)		Diesel	4WD	1968	103	140	09.09-08.15	■
2.0 TDI 4motion (CCHA)		Diesel	4WD	1968	103	140	09.09-08.15	■
2.0 BiTDI (CFCA)		Diesel	FWD	1968	132	180	09.09-08.15	■
2.0 BiTDI 4motion (CFCA)		Diesel	4WD	1968	132	180	09.09-08.15	■
2.5 TDI (AXD)	Rim 16	Diesel	FWD	2461	96	130	04.03-11.09	■
2.5 TDI (BNZ)	Rim 16	Diesel	FWD	2461	96	130	04.03-11.09	■
2.5 TDI 4motion (AXD)	Rim 16	Diesel	4WD	2461	96	130	07.04-11.09	■
2.5 TDI 4motion (BNZ)	Rim 16	Diesel	4WD	2461	96	130	07.04-11.09	■

LISTA DE APLICACIONES - BUYERS GUIDE

2.5 TDI (BLJ)	Rim 16	Diesel	FWD	2461	120	163	11.03-11.09	■
2.5 TDI (AXE)	Rim 16	Diesel	FWD	2461	128	174	04.03-11.09	■
2.5 TDI (BPC)	Rim 16	Diesel	FWD	2461	128	174	04.03-11.09	■
2.5 TDI 4motion (AXE)	Rim 16	Diesel	4WD	2461	128	174	07.04-11.09	■
2.5 TDI 4motion (BPC)	Rim 16	Diesel	4WD	2461	128	174	07.04-11.09	■
MULTIVAN VI (SGF, SGM, SGN, SHM, SHN) 04.15-					Bus (Minibus-M2-Segment)			
2.0 TSI (CJKB)		Gasolina	FWD	1984	110	150	04.15-07.19	■
2.0 TSI (CJKA)		Gasolina	FWD	1984	150	204	04.15-07.19	■
2.0 TSI 4motion (CJKA)		Gasolina	4WD	1984	150	204	06.15-07.19	■
2.0 TDI (CXGA)		Diesel	FWD	1968	62	84	04.15-07.19	■
2.0 TDI (CAAB)		Diesel	FWD	1968	75	102	04.15-12.19	■
2.0 TDI (CXGB)		Diesel	FWD	1968	75	102	04.15-12.19	■
2.0 TDI (CXHC)		Diesel	FWD	1968	81	110	07.19-08.24	■
2.0 TDI (CXHB)		Diesel	FWD	1968	84	114	05.16-08.19	■
2.0 TDI (CAAC)		Diesel	FWD	1968	103	140	04.15-12.19	■
2.0 TDI 4motion (CAAC)		Diesel	4WD	1968	103	140	06.15-12.19	■
2.0 TDI (CXFA)		Diesel	FWD	1968	110	150	04.15-08.24	■
2.0 TDI (CXHA)		Diesel	FWD	1968	110	150	04.15-08.24	■
2.0 TDI 4motion (CXFA)		Diesel	4WD	1968	110	150	08.15-08.24	■
2.0 TDI 4motion (CXHA)		Diesel	4WD	1968	110	150	08.15-08.24	■
2.0 TDI (CFCA)		Diesel	FWD	1968	132	180	04.15-12.19	■
2.0 TDI 4motion (CFCA)		Diesel	4WD	1968	132	180	06.15-12.19	■
2.0 TDI (CXEC)		Diesel	FWD	1968	146	199	11.18-08.24	■
2.0 TDI 4motion (CXEC)		Diesel	4WD	1968	146	199	12.18-08.24	■
2.0 TDI (CXEB)		Diesel	FWD	1968	150	204	06.15-08.24	■
2.0 TDI 4motion (CXEB)		Diesel	4WD	1968	150	204	06.15-08.24	■
TOUAREG (7LA, 7L6, 7L7) 10.02-01.13					SUV (Luxury Crossover SUV-J Segment)			
3.2 V6 (AZZ)	PR 1LB	Gasolina	4WD	3189	162	220	10.02-11.06	■
3.2 V6 (BAA)	PR 1LB	Gasolina	4WD	3189	162	220	10.02-11.06	■
3.2 V6 (BKJ)	PR 1LB	Gasolina	4WD	3189	162	220	10.02-11.06	■
3.2 V6 (BMV)	PR 1LB	Gasolina	4WD	3189	162	220	10.02-11.06	■
3.2 V6 (BMX)	PR 1LB	Gasolina	4WD	3189	162	220	10.02-11.06	■
3.2 V6 (BRJ)	PR 1LB	Gasolina	4WD	3189	162	220	10.02-11.06	■
3.2 V6 (BMV)	PR 1LB	Gasolina	4WD	3189	177	241	11.04-11.06	■
3.6 V6 FSI (BHK)	PR 1LB	Gasolina	4WD	3597	206	280	10.05-05.10	■
3.6 V6 FSI (BHL)	PR 1LB	Gasolina	4WD	3597	206	280	10.05-05.10	■
4.2 V8 FSI (BAR)	PR 1LB	Gasolina	4WD	4163	257	350	06.06-05.10	■
4.2 V8 (AXQ)	PR 1LB	Gasolina	4WD	4172	228	310	12.02-11.06	■
6.0 W12 (BJN)	PR 1LB	Gasolina	4WD	5998	331	450	08.04-05.10	■
6.0 W12 (CFRA)	PR 1LB	Gasolina	4WD	5998	331	450	08.04-05.10	■
2.5 R5 TDI (BLK)	PR 1LB	Diesel	4WD	2461	120	163	08.03-05.10	■
2.5 R5 TDI (BPD)	PR 1LB	Diesel	4WD	2461	120	163	08.03-05.10	■
2.5 R5 TDI (BAC)	PR 1LB	Diesel	4WD	2461	128	174	01.03-05.10	■
2.5 R5 TDI (BPE)	PR 1LB	Diesel	4WD	2461	128	174	01.03-05.10	■
3.0 TDI (BUN)	PR 1LB	Diesel	4WD	2967	155	211	04.06-05.10	■
3.0 TDI (CASB)	PR 1LB	Diesel	4WD	2967	155	211	04.06-05.10	■
3.0 V6 TDI (BKS)	PR 1LB	Diesel	4WD	2967	165	225	11.04-05.10	■
3.0 V6 TDI (CATA)	PR 1LB	Diesel	4WD	2967	165	225	11.04-05.10	■
3.0 V6 TDI (CASA)	PR 1LB	Diesel	4WD	2967	176	240	11.07-05.10	■
3.0 V6 TDI (CASC)	PR 1LB	Diesel	4WD	2967	176	240	11.07-05.10	■

LISTA DE APLICACIONES - BUYERS GUIDE

5.0 V10 TDI (AYH)	PR 1LB	Diesel	4WD	4921	230	313	10.02-05.10	■
5.0 V10 TDI (BKW)	PR 1LB	Diesel	4WD	4921	230	313	10.02-05.10	■
5.0 V10 TDI (BLE)	PR 1LB	Diesel	4WD	4921	230	313	10.02-05.10	■
5.0 V10 TDI (BWF)	PR 1LB	Diesel	4WD	4921	230	313	10.02-05.10	■
5.0 R50 TDI (CBWA)	PR 1LB	Diesel	4WD	4921	257	350	08.07-05.10	■
TRANSPORTER T5 (7JD, 7JE, 7JL, 7JY, 7JZ, 7FD, 7FE, 7FL, 7FY, 7FZ) 04.03-03.16					Platform/Chassis (LCVs-N1 Segment)			
2.0 (AXA)	Rim 16	Gasolina	FWD	1984	85	115	11.03-05.13	■
2.0 TSI (CJKB)		Gasolina	FWD	1984	110	150	07.12-08.15	■
VR6 3.2 (BDL)	Rim 16	Gasolina	FWD	3189	170	231	02.04-11.09	■
VR6 3.2 4motion (BDL)	Rim 16	Gasolina	4WD	3189	170	231	11.03-11.09	■
VR6 3.2 (BKK)	Rim 16	Gasolina	FWD	3189	173	235	08.03-11.09	■
2.0 CNG (AXA)		Gasol./Gas (CNG)	FWD	1984	85	115	11.03-05.11	■
1.9 TDI (BRR)	Rim 16	Diesel	FWD	1896	62	84	01.06-11.09	■
1.9 TDI (AXC)	Rim 16	Diesel	FWD	1896	63	85	04.03-11.09	■
1.9 TDI (BRS)	Rim 16	Diesel	FWD	1896	75	102	01.06-11.09	■
1.9 TDI (AXB)	Rim 16	Diesel	FWD	1896	77	105	04.03-11.09	■
2.0 TDI (CAAA)		Diesel	FWD	1968	62	84	09.09-08.15	■
2.0 TDI (CAAB)		Diesel	FWD	1968	75	102	09.09-08.15	■
2.0 TDI (CAAD)	PR 2E3	Diesel	FWD	1968	84	114	05.11-08.15	■
2.0 TDI (CAAE)	PR 2E3	Diesel	FWD	1968	100	136	05.10-08.15	■
2.0 TDI 4motion (CAAE)	PR 2E3	Diesel	4WD	1968	100	136	05.10-08.15	■
2.0 TDI 4motion (CCHB)	PR 2E3	Diesel	4WD	1968	100	136	05.10-08.15	■
2.0 TDI (CAAC)		Diesel	FWD	1968	103	140	09.09-08.15	■
2.0 TDI (CCHA)		Diesel	FWD	1968	103	140	09.09-08.15	■
2.0 TDI 4motion (CAAC)		Diesel	4WD	1968	103	140	09.09-08.15	■
2.0 TDI 4motion (CCHA)		Diesel	4WD	1968	103	140	09.09-08.15	■
2.0 BiTDI (CFCA)		Diesel	FWD	1968	132	180	09.09-08.15	■
2.0 BiTDI 4motion (CFCA)		Diesel	4WD	1968	132	180	09.09-08.15	■
2.5 TDI (AXD)	Rim 16	Diesel	FWD	2461	96	130	04.03-11.09	■
2.5 TDI (BNZ)	Rim 16	Diesel	FWD	2461	96	130	04.03-11.09	■
2.5 TDI 4motion (AXD)	Rim 16	Diesel	4WD	2461	96	130	07.04-11.09	■
2.5 TDI 4motion (BNZ)	Rim 16	Diesel	4WD	2461	96	130	07.04-11.09	■
2.5 TDI (AXE)	Rim 16	Diesel	FWD	2461	128	174	04.03-11.09	■
2.5 TDI (BPC)	Rim 16	Diesel	FWD	2461	128	174	04.03-11.09	■
2.5 TDI 4motion (AXE)	Rim 16	Diesel	4WD	2461	128	174	04.04-11.09	■
2.5 TDI 4motion (BPC)	Rim 16	Diesel	4WD	2461	128	174	04.04-11.09	■
TRANSPORTER T5 / EUROVAN / KOMBI-CARAVALLE (7HB, 7HJ, 7EB, 7EJ) 04.03-03.16					Bus (Minibus-M2-Segment)			
2.0 (AXA)	Rim 16	Gasolina	FWD	1984	85	115	11.03-08.15	■
2.0 TSI (CJKB)		Gasolina	FWD	1984	110	150	07.12-08.15	■
2.0 TSI (CJKA)	PR 2E3	Gasolina	FWD	1984	150	204	05.11-08.15	■
2.0 TSI 4motion (CJKA)	PR 2E3	Gasolina	4WD	1984	150	204	07.11-08.15	■
3.2		Gasolina	FWD	3189	170	231	11.03-06.06	■
VR6 3.2 (BDL)	Rim 16	Gasolina	FWD	3189	170	231	02.04-06.04	■
3.2 V6 4motion (BKK)	Rim 16	Gasolina	4WD	3189	173	235	11.03-12.09	■
3.2 V6 4motion (CFLA)	Rim 16	Gasolina	4WD	3189	173	235	11.03-12.09	■
VR6 3.2 (BKK)	Rim 16	Gasolina	FWD	3189	173	235	02.04-11.09	■
VR6 3.2 (CFLA)	Rim 16	Gasolina	FWD	3189	173	235	02.04-11.09	■
2.0 CNG (AXA)		Gasol./Gas (CNG)	FWD	1984	85	115	01.06-08.15	■

LISTA DE APLICACIONES - BUYERS GUIDE

1.9 TDI (BRR)	Rim 16	Diesel	FWD	1896	62	84	01.06-11.09	■
1.9 TDI (AXC)	Rim 16	Diesel	FWD	1896	63	85	04.03-11.09	■
1.9 TDI (BRS)	Rim 16	Diesel	FWD	1896	75	102	01.06-11.09	■
1.9 TDI (AXB)	Rim 16	Diesel	FWD	1896	77	105	04.03-11.09	■
2.0 TDI (CAAA)		Diesel	FWD	1968	62	84	09.09-08.15	■
2.0 TDI (CAAB)		Diesel	FWD	1968	75	102	09.09-08.15	■
2.0 TDI (CAAD)		Diesel	FWD	1968	84	114	05.11-08.15	■
2.0 TDI (CSDA)		Diesel	FWD	1968	85	116	05.11-08.15	■
2.0 TDI (CAAE)		Diesel	FWD	1968	100	136	05.10-08.15	■
2.0 TDI (CCHB)		Diesel	FWD	1968	100	136	05.10-08.15	■
2.0 TDI 4motion (CAAE)		Diesel	4WD	1968	100	136	05.10-08.15	■
2.0 TDI 4motion (CCHB)		Diesel	4WD	1968	100	136	05.10-08.15	■
2.0 TDI (CAAC)		Diesel	FWD	1968	103	140	09.09-08.15	■
2.0 TDI (CCHA)		Diesel	FWD	1968	103	140	09.09-08.15	■
2.0 TDI 4motion (CAAC)		Diesel	4WD	1968	103	140	09.09-08.15	■
2.0 TDI 4motion (CCHA)		Diesel	4WD	1968	103	140	09.09-08.15	■
2.0 BiTDI (CFCA)		Diesel	FWD	1968	132	180	09.09-08.15	■
2.0 BiTDI 4motion (CFCA)		Diesel	4WD	1968	132	180	09.09-08.15	■
2.5 TDI (AXD)	Rim 16	Diesel	FWD	2461	96	130	04.03-11.09	■
2.5 TDI (AXE)	Rim 16	Diesel	FWD	2461	96	130	04.03-11.09	■
2.5 TDI (BNZ)	Rim 16	Diesel	FWD	2461	96	130	04.03-11.09	■
2.5 TDI 4motion (AXD)	Rim 16	Diesel	4WD	2461	96	130	07.04-11.09	■
2.5 TDI 4motion (BNZ)	Rim 16	Diesel	4WD	2461	96	130	07.04-11.09	■
2.5 TDI (BLJ)	Rim 16	Diesel	FWD	2461	120	163	11.03-11.09	■
2.5 TDI (AXE)	Rim 16	Diesel	FWD	2461	128	174	04.03-11.09	■
2.5 TDI (BPC)	Rim 16	Diesel	FWD	2461	128	174	04.03-11.09	■
2.5 TDI 4motion (AXE)	Rim 16	Diesel	4WD	2461	128	174	07.04-11.09	■
2.5 TDI 4motion (BPC)	Rim 16	Diesel	4WD	2461	128	174	07.04-11.09	■
TRANSPORTER T5 / KOMBI (7HA, 7HH, 7EA, 7EH) 04.03-08.15					Van (LCVs-N1 Segment)			
2.0 (AXA)	Rim 16	Gasolina	FWD	1984	85	115	11.03-08.15	■
2.0 TSI (CJKB)		Gasolina	FWD	1984	110	150	07.12-08.15	■
2.0 TSI (CJKA)	PR 2E3	Gasolina	FWD	1984	150	204	05.11-08.15	■
2.0 TSI 4motion (CJKA)	PR 2E3	Gasolina	4WD	1984	150	204	07.11-08.15	■
3.2		Gasolina	FWD	3189	170	231	11.03-06.06	■
VR6 3.2 (BDL)	Rim 16	Gasolina	FWD	3189	170	231	04.03-06.05	■
VR6 3.2 (BKK)	Rim 16	Gasolina	FWD	3189	173	235	02.04-11.09	■
VR6 3.2 (CFLA)	Rim 16	Gasolina	FWD	3189	173	235	02.04-11.09	■
VR6 3.2 4motion (BKK)	Rim 16	Gasolina	4WD	3189	173	235	11.03-11.09	■
VR6 3.2 4motion (CFLA)	Rim 16	Gasolina	4WD	3189	173	235	11.03-11.09	■
2.0 BiFuel (AXA)		Gasol./Gas (CNG)	FWD	1984	85	115	06.07-08.15	■
1.9 TDI (BRR)	Rim 16	Diesel	FWD	1896	62	84	01.06-11.09	■
1.9 TDI (AXC)	Rim 16	Diesel	FWD	1896	63	85	04.03-11.09	■
1.9 TDI (BRS)	Rim 16	Diesel	FWD	1896	75	102	01.06-11.09	■
1.9 TDI (AXB)	Rim 16	Diesel	FWD	1896	77	105	04.03-11.09	■
2.0 TDI (CAAA)		Diesel	FWD	1968	62	84	09.09-08.15	■
2.0 TDI (CAAB)		Diesel	FWD	1968	75	102	09.09-08.15	■
2.0 TDI (CAAD)	PR 2E3	Diesel	FWD	1968	84	114	05.11-08.15	■
2.0 TDI (CAAE)	PR 2E3	Diesel	FWD	1968	100	136	05.10-08.15	■
2.0 TDI (CCHB)	PR 2E3	Diesel	FWD	1968	100	136	05.10-08.15	■
2.0 TDI 4motion (CAAE)	PR 2E3	Diesel	4WD	1968	100	136	05.10-08.15	■

LISTA DE APLICACIONES - BUYERS GUIDE

2.0 TDI 4motion (CCHB)	PR 2E3	Diesel	4WD	1968	100	136	05.10-08.15	■
2.0 TDI (CAAC)		Diesel	FWD	1968	103	140	09.09-08.15	■
2.0 TDI (CCHA)		Diesel	FWD	1968	103	140	09.09-08.15	■
2.0 TDI 4motion (CAAC)		Diesel	4WD	1968	103	140	09.09-08.15	■
2.0 TDI 4motion (CCHA)		Diesel	4WD	1968	103	140	09.09-08.15	■
2.0 BiTDI (CFCA)		Diesel	FWD	1968	132	180	09.09-08.15	■
2.0 BiTDI 4motion (CFCA)		Diesel	4WD	1968	132	180	09.09-08.15	■
2.5 TDI (AXD)	Rim 16	Diesel	FWD	2461	96	130	04.03-11.09	■
2.5 TDI (BNZ)	Rim 16	Diesel	FWD	2461	96	130	04.03-11.09	■
2.5 TDI 4motion (AXD)	Rim 16	Diesel	4WD	2461	96	130	07.04-11.09	■
2.5 TDI 4motion (BNZ)	Rim 16	Diesel	4WD	2461	96	130	07.04-11.09	■
2.5 TDI (AXE)	Rim 16	Diesel	FWD	2461	128	174	04.03-11.09	■
2.5 TDI (BPC)	Rim 16	Diesel	FWD	2461	128	174	04.03-11.09	■
2.5 TDI 4motion (AXE)	Rim 16	Diesel	4WD	2461	128	174	07.04-11.09	■
2.5 TDI 4motion (BPC)	Rim 16	Diesel	4WD	2461	128	174	07.04-11.09	■
TRANSPORTER T6 (SFD, SFE, SFL, SFZ, SJD, SJE, SJL, SJZ) 04.15-					Platform/Chassis (LCVs-N1 Segment)			
2.0 TSI (CJKB)		Gasolina	FWD	1984	110	150	04.15-06.19	■
2.0 TDI (CAAA)		Diesel	FWD	1968	62	84	04.15-11.19	■
2.0 TDI (CXGA)		Diesel	FWD	1968	62	84	04.15-11.19	■
2.0 TDI (CXGD)		Diesel	FWD	1968	66	90	10.19-08.24	■
2.0 TDI (CAAB)		Diesel	FWD	1968	75	102	04.15-11.19	■
2.0 TDI (CXGB)		Diesel	FWD	1968	75	102	04.15-11.19	■
2.0 TDI (CXHC)		Diesel	FWD	1968	81	110	07.19-08.24	■
2.0 TDI (CXHB)		Diesel	FWD	1968	84	114	05.16-11.19	■
2.0 TDI (CAAC)		Diesel	FWD	1968	103	140	04.15-11.19	■
2.0 TDI 4motion (CAAC)		Diesel	4WD	1968	103	140	06.15-11.19	■
2.0 TDI (CXHA)		Diesel	FWD	1968	110	150	08.15-08.24	■
2.0 TDI 4motion (CXHA)		Diesel	4WD	1968	110	150	05.16-08.24	■
2.0 TDI (CFCA)		Diesel	FWD	1968	132	180	04.15-11.19	■
2.0 TDI 4motion (CFCA)		Diesel	4WD	1968	132	180	06.15-11.19	■
2.0 TDI (CXEC)		Diesel	FWD	1968	146	199	08.19-08.24	■
2.0 TDI 4motion (CXEC)		Diesel	4WD	1968	146	199	08.19-08.24	■
2.0 TDI (CXEB)		Diesel	FWD	1968	150	204	05.16-08.24	■
2.0 TDI 4motion (CXEB)		Diesel	4WD	1968	150	204	05.16-08.24	■
TRANSPORTER T6 (SGA, SGH, SHA, SHH) 04.15-					Van (LCVs-N1 Segment)			
2.0 TSI (CJKB)		Gasolina	FWD	1984	110	150	04.15-07.19	■
2.0 TSI (CJKA)		Gasolina	FWD	1984	150	204	04.15-07.19	■
2.0 TSI 4motion (CJKA)		Gasolina	4WD	1984	150	204	06.15-07.19	■
ABT e-Transporter (BOSCH SMG-180.1.3)		Eléctrico	FWD		83	113	01.20-08.24	■
2.0 TDI (CAAA)		Diesel	FWD	1968	62	84	04.15-07.19	■
2.0 TDI (CXGA)		Diesel	FWD	1968	62	84	04.15-07.19	■
2.0 TDI (CXGD)		Diesel	FWD	1968	66	90	10.19-08.24	■
2.0 TDI (CAAB)		Diesel	FWD	1968	75	102	04.15-12.19	■
2.0 TDI (CXGB)		Diesel	FWD	1968	75	102	04.15-12.19	■
2.0 TDI (CXHC)		Diesel	FWD	1968	81	110	07.19-08.24	■
2.0 TDI (CXHB)		Diesel	FWD	1968	84	114	05.16-08.19	■
2.0 TDI (CAAC)		Diesel	FWD	1968	103	140	04.15-12.19	■
2.0 TDI 4motion (CAAC)		Diesel	4WD	1968	103	140	06.15-12.19	■
2.0 TDI (CXFA)		Diesel	FWD	1968	110	150	04.15-08.24	■
2.0 TDI (CXHA)		Diesel	FWD	1968	110	150	04.15-08.24	■

LISTA DE APLICACIONES - BUYERS GUIDE

2.0 TDI 4motion (CXFA)	Diesel	4WD	1968	110	150	08.15-08.24	■
2.0 TDI 4motion (CXHA)	Diesel	4WD	1968	110	150	08.15-08.24	■
2.0 TDI (CFCA)	Diesel	FWD	1968	132	180	04.15-12.19	■
2.0 TDI 4motion (CFCA)	Diesel	4WD	1968	132	180	06.15-12.19	■
2.0 TDI (CXC)	Diesel	FWD	1968	146	199	08.18-08.24	■
2.0 TDI 4motion (CXC)	Diesel	4WD	1968	146	199	08.18-08.24	■
2.0 TDI (CXEB)	Diesel	FWD	1968	150	204	06.15-08.24	■
2.0 TDI 4motion (CXEB)	Diesel	4WD	1968	150	204	06.15-08.24	■
TRANSPORTER T6 / CALIFORNIA / CARAVELLE (SGB, SGJ, SHB, SHJ) 04.15-				Bus (Minibus-M2-Segment)			
2.0 TSI (CJKB)	Gasolina	FWD	1984	110	150	04.15-07.19	■
2.0 TSI (CJKA)	Gasolina	FWD	1984	150	204	04.15-07.19	■
2.0 TSI 4motion (CJKA)	Gasolina	4WD	1984	150	204	06.15-07.19	■
ABT e-Caravella (BOSCH SMG-180.1.3)	Eléctrico	FWD		83	113	01.20-08.24	■
2.0 TDI (CAAA)	Diesel	FWD	1968	62	84	04.15-07.19	■
2.0 TDI (CXGA)	Diesel	FWD	1968	62	84	04.15-07.19	■
2.0 TDI (CXGD)	Diesel	FWD	1968	66	90	10.19-08.24	■
2.0 TDI (CAAB)	Diesel	FWD	1968	75	102	04.15-12.19	■
2.0 TDI (CXGB)	Diesel	FWD	1968	75	102	04.15-12.19	■
2.0 TDI (CXHC)	Diesel	FWD	1968	81	110	07.19-08.24	■
2.0 TDI (CXHB)	Diesel	FWD	1968	84	114	05.16-08.19	■
2.0 TDI (CAAC)	Diesel	FWD	1968	103	140	04.15-12.19	■
2.0 TDI 4motion (CAAC)	Diesel	4WD	1968	103	140	06.15-12.19	■
2.0 TDI (CXFA)	Diesel	FWD	1968	110	150	04.15-08.24	■
2.0 TDI (CXHA)	Diesel	FWD	1968	110	150	04.15-08.24	■
2.0 TDI 4motion (CXFA)	Diesel	4WD	1968	110	150	08.15-08.24	■
2.0 TDI 4motion (CXHA)	Diesel	4WD	1968	110	150	08.15-08.24	■
2.0 TDI (CFCA)	Diesel	FWD	1968	132	180	04.15-12.19	■
2.0 TDI 4motion (CFCA)	Diesel	4WD	1968	132	180	06.15-12.19	■
2.0 TDI (CXC)	Diesel	FWD	1968	146	199	11.18-08.24	■
2.0 TDI 4motion (CXC)	Diesel	4WD	1968	146	199	08.18-08.24	■
2.0 TDI (CXEB)	Diesel	FWD	1968	150	204	06.15-08.24	■
2.0 TDI 4motion (CXEB)	Diesel	4WD	1968	150	204	06.15-08.24	■