

LISTA DE APLICACIONES - BUYERS GUIDE

78BD6567-2



Weight: 12.950

O.E.M.	MAKE
3 516 567	VOLVO
3 516 567 9	VOLVO
6 848 902	VOLVO

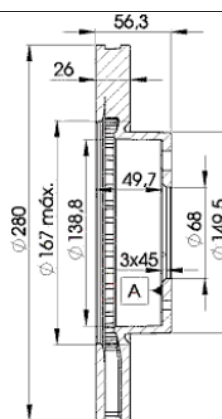
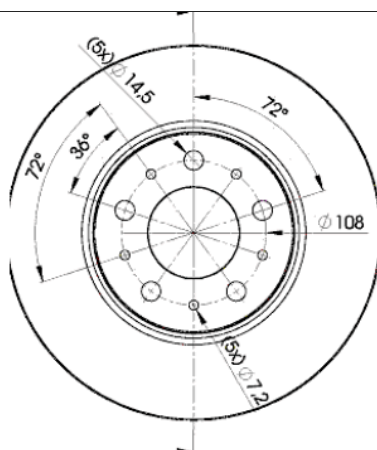

78BD6567-2

E1 90R-02C0074/0224



Ø280x26x56.3

MAKE

VOLVO



Trac.	CC	Kw	CV
-------	----	----	----



Front / Rear

VOLVO

740 (744) 04.83-12.92

Saloon (Executive car-E Segment)

2.0 (B 200 F)	vehicles with ABS	Gasolina	RWD	1986	82	111	09.90-08.92	■
2.0 (B 200 G)	10/90-, vehicles with ABS	Gasolina	RWD	1986	89	121	08.85-07.92	■
2.0 Turbo (B 200 FT)	vehicles with ABS	Gasolina	RWD	1986	114	155	09.90-08.91	■
2.0 (B 204 FTE)	vehicles with ABS	Gasolina	RWD	1986	147	200	09.90-08.92	■
2.3 (B 230 F)	10/90-, vehicles with ABS	Gasolina	RWD	2316	85	115	08.87-07.92	■
2.3 (B 234 F)	10/90-, vehicles with ABS	Gasolina	RWD	2316	111	151	08.88-08.92	■
2.3 (B 234 F)	10/90-, vehicles with ABS	Gasolina	RWD	2316	114	156	08.88-07.91	■
2.3 Turbo (B 230 FT)		Gasolina	RWD	2316	125	170	09.89-08.91	■
2.3 Turbo (B 230 GT)		Gasolina	RWD	2316	125	170	09.89-08.91	■
2.4 Diesel (D 24)	10/90-, vehicles with ABS	Diesel	RWD	2383	60	82	08.84-07.92	■

740 Kombi (745) 08.84-12.92

Estate (Executive car-E Segment)

2.0 (B 200 F)	10/90-, vehicles with ABS	Gasolina	RWD	1986	82	112	08.89-07.91	■
2.0 (B 200 E)	10/90-, vehicles with ABS	Gasolina	RWD	1986	89	121	08.85-07.92	■
2.0 (B 200 G)	10/90-, vehicles with ABS	Gasolina	RWD	1986	89	121	08.85-07.92	■
2.0 Turbo (B 200 FT)	vehicles with ABS	Gasolina	RWD	1986	114	155	09.90-08.91	■
2.0 (B 204 FTE)	vehicles with ABS	Gasolina	RWD	1986	147	200	09.90-08.92	■
2.3 (B 230 F)	10/90-, vehicles with ABS	Gasolina	RWD	2316	85	115	08.87-07.92	■
2.3 (B 230 F)		Gasolina	RWD	2316	87	118	01.88-10.90	■
2.3 (B 234 F)	10/90-, vehicles with ABS	Gasolina	RWD	2316	111	151	07.89-08.92	■
2.3 Turbo (B 230 FT)	10/90-, vehicles with ABS	Gasolina	RWD	2316	125	170	09.89-08.91	■
2.3 Turbo (B 230 GT)	10/90-, vehicles with ABS	Gasolina	RWD	2316	125	170	09.89-08.91	■
2.4 Turbo-Diesel (D 24 T)	10/90-, vehicles with ABS	Diesel	RWD	2383	80	109	09.85-07.92	■

LISTA DE APLICACIONES - BUYERS GUIDE

780 (782) 04.86-11.90					Coupe (Executive car-E Segment)			
2.4 D (D 24 TIC)		Diesel	RWD	2383	90	122	04.86-07.90	■
940 (945) 09.90-10.98					Estate (Executive car-E Segment)			
2.0 (B 200 G)		Gasolina	RWD	1986	89	121	11.94-12.95	■
2.0 (B 204 FT)		Gasolina	RWD	1986	102	139	10.94-05.97	■
2.0 Turbo (B 200 FT)		Gasolina	RWD	1986	114	155	04.96-10.98	■
2.0 GLT (B 200 GT)		Gasolina	RWD	1986	139	189	10.94-05.97	■
2.3 (B 230 FD)		Gasolina	RWD	2316	85	116	08.94-07.95	■
2.3 (B 230 FB)		Gasolina	RWD	2316	96	131	08.94-10.98	■
2.3 ti (B 230 FK)		Gasolina	RWD	2316	99	135	01.95-10.98	■
2.3		Gasolina	FWD	2316	113	154	10.94-05.97	■
2.3 Turbo (B 230 FT)		Gasolina	RWD	2316	121	165	08.94-10.98	■
2.3 Turbo (B 230 FT)		Gasolina	RWD	2316	126	171	08.95-10.98	■
940 (944) 08.90-03.95					Saloon (Executive car-E Segment)			
2.0 (B 200 F)	vehicles with ABS	Gasolina	RWD	1986	82	112	01.92-07.94	■
2.0 (B 200 E)	vehicles with ABS	Gasolina	RWD	1986	89	121	09.90-09.93	■
2.0 (B 200 G)	vehicles with ABS	Gasolina	RWD	1986	89	121	09.90-09.93	■
2.0 (B 200 G)		Gasolina	RWD	1986	89	121	11.94-12.95	■
2.0 (B 204 FT)		Gasolina	RWD	1986	102	139	09.90-09.93	■
2.0 (B 204 FT)		Gasolina	RWD	1986	102	139	10.94-05.97	■
2.0 GL (B 204 E)		Gasolina	RWD	1986	103	140	09.90-04.92	■
2.0 Turbo (B 200 FT)	-09/93	Gasolina	RWD	1986	114	155	08.90-12.94	■
2.0 Turbo (B 200 FT)		Gasolina	RWD	1986	114	155	04.96-10.98	■
2.0 GLT (B 200 GT)		Gasolina	RWD	1986	139	189	10.94-05.97	■
2.3 (B 230 FD)	-09/93	Gasolina	RWD	2316	85	116	08.92-07.94	■
2.3 (B 230 FD)		Gasolina	RWD	2316	85	116	08.94-07.95	■
2.3 (B 230 FB)	09/91-, -08/93	Gasolina	RWD	2316	96	131	08.90-12.94	■
2.3 (B 230 G)	09/91-, -08/93	Gasolina	RWD	2316	96	131	08.90-12.94	■
2.3 (B 230 FB)		Gasolina	RWD	2316	96	131	08.94-10.98	■
2.3 (B 230 FK)	09/91-, -08/93	Gasolina	RWD	2316	99	135	05.91-03.95	■
2.3 ti (B 230 FK)		Gasolina	RWD	2316	99	135	01.95-10.98	■
2.3		Gasolina	FWD	2316	113	154	10.94-05.97	■
2.3 (B 234 F)		Gasolina	RWD	2316	114	156	08.90-07.91	■
2.3 (B 234 G)		Gasolina	RWD	2316	114	156	08.90-07.91	■
2.3 (B 230 FT)		Gasolina	RWD	2316	118	160	09.90-09.93	■
2.3 Turbo (B 230 FT)	-09/93	Gasolina	RWD	2316	121	165	08.90-07.94	■
2.3 Turbo (B 230 FT)		Gasolina	RWD	2316	121	165	08.94-10.98	■
2.3 Turbo (B 230 FT)		Gasolina	RWD	2316	126	171	01.95-12.98	■
2.3 Turbo (B 230 FT+)		Gasolina	RWD	2316	140	190	08.91-07.93	■
2.4 D (D 24)	vehicles with ABS	Diesel	RWD	2383	60	82	08.90-12.94	■
2.4 Turbo Diesel (D 24 T)	-09/93, vehicles with ABS	Diesel	RWD	2383	80	109	08.90-12.94	■
2.4 TD Intercooler (D 24 TIC)	vehicles with ABS	Diesel	RWD	2383	90	122	08.90-12.94	■
940 Kombi (945) 08.90-10.95					Estate (Executive car-E Segment)			
2.0 (B 200 F)	-09/93, vehicles with ABS	Gasolina	RWD	1986	82	112	01.92-07.94	■
2.0 GL (B 204 E)		Gasolina	RWD	1986	103	140	09.90-04.92	■
2.0 Turbo (B 200 FT)	-09/93	Gasolina	RWD	1986	114	155	01.91-07.95	■
2.3 (B 230 FD)	-09/93	Gasolina	RWD	2316	85	116	08.92-07.94	■
2.3 (B 230 FB)	09/91-	Gasolina	RWD	2316	96	131	08.90-12.94	■
2.3 (B 234 F)		Gasolina	RWD	2316	114	155	08.90-07.91	■
2.3 (B 230 FB)		Gasolina	RWD	2316	118	160	09.90-09.93	■

LISTA DE APLICACIONES - BUYERS GUIDE

2.3 Turbo (B 230 FT)	-09/92	Gasolina	RWD	2316	121	165	08.90-07.94	■
2.3 Turbo (B 230 FT+)	-09/92	Gasolina	RWD	2316	140	190	08.91-07.93	■
2.4 D (D 24)	-10/92, vehicles with ABS	Diesel	RWD	2383	60	82	08.90-07.95	■
2.4 Turbo Diesel (D 24 T)	-09/93, vehicles with ABS	Diesel	RWD	2383	80	109	08.90-07.94	■
2.4 TD Intercooler (D 24 TIC)	-09/93, vehicles with ABS	Diesel	RWD	2383	90	122	08.90-08.94	■
2.4 TD	vehicles with ABS	Diesel	RWD	2383	95	130	05.91-03.95	■
960 (964) 08.90-07.94					Saloon (Executive car-E Segment)			
2.0 (B 200 F)	09/91-	Gasolina	RWD	1986	82	111	09.90-09.93	■
2.0 (B 204 E)	09/91-	Gasolina	RWD	1986	103	140	09.90-08.93	■
2.0 (B 204 FT)	09/91-	Gasolina	RWD	1986	140	190	08.90-09.93	■
2.8 GL (B 280 F)		Gasolina	RWD	2849	108	147	09.90-05.92	■
2.8 GL		Gasolina	FWD	2849	115	156	09.90-05.92	■
2.9 (B 6304 F)	-08/93	Gasolina	RWD	2922	150	204	08.90-07.94	■
2.9 (B 6304 FS)	-08/93	Gasolina	RWD	2922	150	204	08.90-07.94	■
2.9 (B 6304 GS)	-08/93	Gasolina	RWD	2922	150	204	08.90-07.94	■
2.4 TD Interc. (D 24 TIC)	-08/93	Diesel	RWD	2383	85	115	09.91-07.94	■
960 Kombi (965) 08.90-07.94					Estate (Executive car-E Segment)			
2.0 (B 204 E)	09/91-	Gasolina	RWD	1986	103	140	09.90-08.93	■
2.0 (B 204 FT)	09/91-	Gasolina	RWD	1986	140	190	08.90-09.93	■
2.3 Turbo (B 230 FT)		Gasolina	RWD	2316	121	165	09.90-08.93	■
2.8 (B 280 F)		Gasolina	RWD	2849	108	147	09.90-05.92	■
2.8		Gasolina	FWD	2849	115	156	09.90-05.92	■
2.9 (B 6304 F)	-08/93	Gasolina	RWD	2922	150	204	08.90-07.94	■
2.9 (B 6304 S)	-08/93	Gasolina	RWD	2922	150	204	08.90-07.94	■
2.4 TD Interc. (D 24 TIC)		Diesel	RWD	2383	85	115	09.91-07.94	■
2.4 TDi (D 24 TIC)		Diesel	RWD	2383	90	122	09.90-08.93	■