

# LISTA DE APLICACIONES - BUYERS GUIDE

## 78BD6668-2



Weight: 10.660

O.E.M.	MAKE
34 21 1 156 668	BMW
34 21 1 162 305	BMW

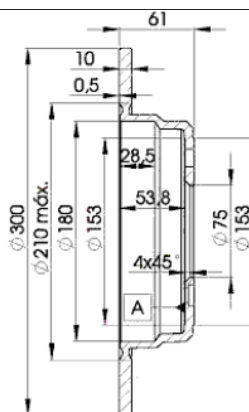

## 78BD6668-2

E1 90R-02C0241/0033



Ø300x10x61

MAKE

BMW



Trac.	CC	Kw	CV	
				Front / Rear

### BMW

#### 5 Serie III (E34) 02.87-12.95

#### Saloon (Executive car-E Segment)

518 i (M40 B18 (184E1))	Gasolina	RWD	1796	83	113	09.89-04.94	■
518 i (M43 B18 (184E2))	Gasolina	RWD	1796	85	115	05.94-08.95	■
520 i (M20 B20 (206KA))	Gasolina	RWD	1990	95	129	06.87-09.90	■
520 i 24V (M50 B20 (206S1))	Gasolina	RWD	1990	110	150	04.90-08.95	■
520 i 24V (M50 B20 (206S2))	Gasolina	RWD	1990	110	150	04.90-08.95	■
525 i (M20 B25 (256K1))	Gasolina	RWD	2494	125	170	02.88-08.90	■
525 i 24V (M50 B25 (256S1))	Gasolina	RWD	2494	141	192	03.90-08.95	■
525 i 24V (M50 B25 (256S2))	Gasolina	RWD	2494	141	192	03.90-08.95	■
525 iX 24V (M50 B25 (256S1))	Gasolina	4WD	2494	141	192	10.91-08.95	■
525 iX 24V (M50 B25 (256S2))	Gasolina	4WD	2494	141	192	10.91-08.95	■
530i (M30 B30 (306KA))	Gasolina	RWD	2986	138	188	01.88-04.90	■
530 i V8 (M60 B30 (308S1))	Gasolina	RWD	2997	160	218	09.92-12.95	■
535i (M30 B34 (346KB))	Gasolina	RWD	3430	155	211	11.87-02.93	■
M5	Gasolina	RWD	3535	210	286	12.87-12.88	■
M5 (S38 B36 (366S1))	Gasolina	RWD	3535	232	315	09.88-03.92	■
524 td (M21 D24 (246TB))	Diesel	RWD	2443	85	115	03.88-08.91	■
525 td (M51 D25 (256T1))	Diesel	RWD	2497	85	115	03.93-08.95	■
525 tds (M51 D25 (256T1))	Diesel	RWD	2497	105	143	09.91-08.95	■

#### 5 Serie III Touring (E34) 07.91-07.96

#### Estate (Executive car-E Segment)

518 i (M40 B18 (184E1))	Gasolina	RWD	1796	83	113	04.93-04.94	■
518 i (M43 B18 (184E2))	Gasolina	RWD	1796	85	115	05.94-07.96	■
520 i (M50 B20 (206S1))	Gasolina	RWD	1990	110	150	07.91-07.96	■
520 i (M50 B20 (206S2))	Gasolina	RWD	1990	110	150	07.91-07.96	■

## LISTA DE APLICACIONES - BUYERS GUIDE

525 i (M50 B25 (256S1))		Gasolina	RWD	2494	141	192	07.91-07.96
525 i (M50 B25 (256S2))		Gasolina	RWD	2494	141	192	07.91-07.96
525 ix (M50 B25 (256S1))		Gasolina	4WD	2494	141	192	01.92-03.96
525 ix (M50 B25 (256S2))		Gasolina	4WD	2494	141	192	01.92-03.96
530i (M60 B30 (308S1))		Gasolina	RWD	2997	160	218	09.92-07.96
518 g (M43 B18 (184E2))		Gasol./Gas (CNG)	RWD	1796	74	101	02.96-07.96
525 td (M51 D25 (256T1))		Diesel	RWD	2497	85	115	03.93-07.96
525 tds (M51 D25 (256T1))		Diesel	RWD	2497	105	143	12.91-07.96

