

# LISTA DE APLICACIONES - BUYERS GUIDE

## 78BD6784-2



8 424073 148100

Weight: 10.792

O.E.M.	MAKE
4 070 865	FORD
5 026 784	FORD
93BX-1124-AC	FORD
93BX-1125-AC	FORD
F5RZ-1125-A	MERCURY
F5RZ-1125-B	MERCURY
F8RZ-1125-DA	MERCURY

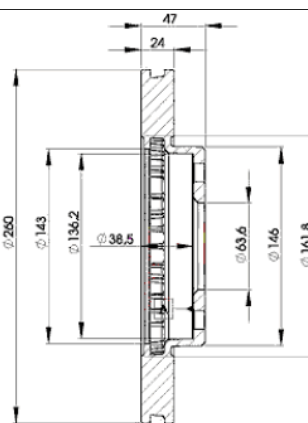
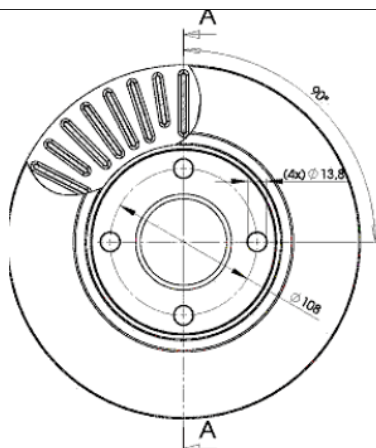

## 78BD6784-2

E1 90R-02C0452/0077



Ø260x24x47

MAKE
FORD
FORD USA
MERCURY



Trac.	CC	Kw	CV
-------	----	----	----



Front / Rear

### FORD

#### COUGAR (EC\_) 08.98-12.01

						Coupe (Sports car-S Segment)			
2.0 16V (EDBA)	-08/01	Gasolina	FWD	1988	96	131	08.98-12.01	■	
2.0 16V (EDBB)	-08/01	Gasolina	FWD	1988	96	131	08.98-12.01	■	
2.0 16V (EDBC)	-08/01	Gasolina	FWD	1988	96	131	08.98-12.01	■	
2.0 16V (EDBD)	-08/01	Gasolina	FWD	1988	96	131	08.98-12.01	■	

#### MONDEO (GBP) 02.93-08.96

						Hatchback (Large family car-D Segment)			
1.6 i 16V (L1J)		Gasolina	FWD	1597	65	88	07.94-08.96	■	
1.6 i 16V (L1F)		Gasolina	FWD	1597	66	90	02.93-08.96	■	
1.8 i 16V (RKB)		Gasolina	FWD	1796	82	112	07.94-08.96	■	
1.8 i 16V (RKA)		Gasolina	FWD	1796	85	115	02.93-08.96	■	
2.0 i 16V (NGA)		Gasolina	FWD	1988	97	132	12.94-08.96	■	
2.0 i 16V 4x4 (NGA)		Gasolina	4WD	1988	97	132	12.94-08.96	■	
2.0 i 16V (NGA)		Gasolina	FWD	1988	100	136	02.93-08.96	■	
2.5 i 24V (SEA)		Gasolina	FWD	2544	125	170	07.94-08.96	■	
1.8 TD (RFM)		Diesel	FWD	1753	65	88	06.93-08.96	■	
1.8 TD (RFN)		Diesel	FWD	1753	65	88	06.93-08.96	■	
1.8 TD (RFM)		Diesel	FWD	1753	66	90	10.95-08.96	■	
1.8 TD (RFN)		Diesel	FWD	1753	66	90	10.95-08.96	■	

#### MONDEO (GBP) 01.93-08.96

						Saloon (Large family car-D Segment)			
1.6 i 16V (L1J)		Gasolina	FWD	1597	65	88	07.94-08.96	■	
1.6 i 16V (L1F)	-07/96, vehicles without ABS	Gasolina	FWD	1597	66	90	02.93-08.96	■	
1.8 i 16V (RKB)		Gasolina	FWD	1796	82	112	01.94-08.96	■	
1.8 i 16V (RKA)		Gasolina	FWD	1796	85	115	02.93-08.96	■	

# LISTA DE APLICACIONES - BUYERS GUIDE

2.0 i 16V 4x4 (NGA)		Gasolina	4WD	1988	97	132	12.94-08.96	■
2.0 i 16V (NGA)		Gasolina	FWD	1988	100	136	02.93-08.96	■
2.5 i 24V (SEA)		Gasolina	FWD	2544	125	170	07.94-08.96	■
1.8 TD (RFM)		Diesel	FWD	1753	65	88	06.93-08.96	■
1.8 TD (RFN)		Diesel	FWD	1753	65	88	06.93-08.96	■
1.8 TD (RFM)		Diesel	FWD	1753	66	90	10.95-08.96	■
1.8 TD (RFN)		Diesel	FWD	1753	66	90	10.95-08.96	■
<b>MONDEO II (BAP) 08.96-09.00</b>					<b>Hatchback (Large family car-D Segment)</b>			
1.6 i (L1J)		Gasolina	FWD	1597	66	90	08.96-09.00	■
1.6 i 16V (L1L)		Gasolina	FWD	1597	70	95	05.98-09.00	■
1.6 i 16V (L1N)		Gasolina	FWD	1597	70	95	05.98-09.00	■
1.6 i 16V (L1Q)		Gasolina	FWD	1597	70	95	05.98-09.00	■
1.8 i (RKB)		Gasolina	FWD	1796	85	115	08.96-09.00	■
1.8 i (RKF)		Gasolina	FWD	1796	85	115	08.96-09.00	■
1.8 i (RKH)		Gasolina	FWD	1796	85	115	08.96-09.00	■
1.8 i (RKJ)		Gasolina	FWD	1796	85	115	08.96-09.00	■
1.8 i (RKK)		Gasolina	FWD	1796	85	115	08.96-09.00	■
2.0 i (NGA)		Gasolina	FWD	1988	96	131	08.96-09.00	■
2.0 i (NGB)		Gasolina	FWD	1988	96	131	08.96-09.00	■
2.0 i (NGC)		Gasolina	FWD	1988	96	131	08.96-09.00	■
2.0 i (NGD)		Gasolina	FWD	1988	96	131	08.96-09.00	■
1.8 TD (RFN)		Diesel	FWD	1753	66	90	08.96-09.00	■
<b>MONDEO II (BFP) 08.96-09.00</b>					<b>Saloon (Large family car-D Segment)</b>			
1.6 i (L1J)		Gasolina	FWD	1597	66	90	08.96-09.00	■
1.6 i 16V (L1L)		Gasolina	FWD	1597	70	95	05.98-09.00	■
1.6 i 16V (L1N)		Gasolina	FWD	1597	70	95	05.98-09.00	■
1.6 i 16V (L1Q)		Gasolina	FWD	1597	70	95	05.98-09.00	■
1.8 i (RKB)		Gasolina	FWD	1796	85	115	08.96-09.00	■
1.8 i (RKF)		Gasolina	FWD	1796	85	115	08.96-09.00	■
1.8 i (RKH)		Gasolina	FWD	1796	85	115	08.96-09.00	■
1.8 i (RKJ)		Gasolina	FWD	1796	85	115	08.96-09.00	■
1.8 i (RKK)		Gasolina	FWD	1796	85	115	08.96-09.00	■
2.0 i (NGA)		Gasolina	FWD	1988	96	131	08.96-09.00	■
2.0 i (NGB)		Gasolina	FWD	1988	96	131	08.96-09.00	■
2.0 i (NGC)		Gasolina	FWD	1988	96	131	08.96-09.00	■
2.0 i (NGD)		Gasolina	FWD	1988	96	131	08.96-09.00	■
1.8 TD (RFN)		Diesel	FWD	1753	66	90	08.96-09.00	■
<b>MONDEO II Turnier (BNP) 08.96-09.00</b>					<b>Estate (Large family car-D Segment)</b>			
1.6 i (L1J)		Gasolina	FWD	1597	66	90	08.96-09.00	■
1.6 i 16V (L1L)		Gasolina	FWD	1597	70	95	05.98-09.00	■
1.6 i 16V (L1N)		Gasolina	FWD	1597	70	95	05.98-09.00	■
1.6 i 16V (L1Q)		Gasolina	FWD	1597	70	95	05.98-09.00	■
1.8 i (RKA)	Rim 14	Gasolina	FWD	1796	85	115	08.96-09.00	■
1.8 i (RKB)	Rim 14	Gasolina	FWD	1796	85	115	08.96-09.00	■
1.8 i (RKF)	Rim 14	Gasolina	FWD	1796	85	115	08.96-09.00	■
1.8 i (RKH)	Rim 14	Gasolina	FWD	1796	85	115	08.96-09.00	■
1.8 i (RKJ)	Rim 14	Gasolina	FWD	1796	85	115	08.96-09.00	■
1.8 i (RKK)	Rim 14	Gasolina	FWD	1796	85	115	08.96-09.00	■
2.0 i (NGA)	Rim 14	Gasolina	FWD	1988	96	131	08.96-09.00	■
2.0 i (NGB)	Rim 14	Gasolina	FWD	1988	96	131	08.96-09.00	■

# LISTA DE APLICACIONES - BUYERS GUIDE

2.0 i (NGC)	Rim 14	Gasolina	FWD	1988	96	131	08.96-09.00	■
2.0 i (NGD)	Rim 14	Gasolina	FWD	1988	96	131	08.96-09.00	■
1.8 TD (RFN)		Diesel	FWD	1753	66	90	08.96-09.00	■
<b>MONDEO Turnier (BNP) 01.93-08.96</b>					<b>Estate (Large family car-D Segment)</b>			
1.6 i 16V (L1J)		Gasolina	FWD	1597	65	88	07.94-08.96	■
1.6 i 16V (L1F)		Gasolina	FWD	1597	66	90	04.93-08.96	■
1.8 i 16V (RKB)		Gasolina	FWD	1796	82	112	07.94-08.96	■
1.8 i 16V (RKA)		Gasolina	FWD	1796	85	115	04.93-08.96	■
1.8 i 16V 4x4 (RKA)		Gasolina	4WD	1796	85	115	04.93-08.96	■
2.0 i 16V (NGA)		Gasolina	FWD	1988	97	132	01.93-08.96	■
2.0 i 16V 4x4 (NGA)		Gasolina	4WD	1988	97	132	12.94-08.96	■
2.0 i 16V (NGA)		Gasolina	FWD	1988	100	136	04.93-08.96	■
2.0 i 16V 4x4 (NGA)		Gasolina	4WD	1988	100	136	04.93-08.96	■
1.8 TD (RFM)		Diesel	FWD	1753	65	88	06.93-08.96	■
1.8 TD (RFN)		Diesel	FWD	1753	65	88	06.93-08.96	■
1.8 TD (RFM)		Diesel	FWD	1753	66	90	11.95-08.96	■
1.8 TD (RFN)		Diesel	FWD	1753	66	90	11.95-08.96	■
<b>SCORPIO II (GFR, GGR) 10.94-08.98</b>					<b>Saloon (Executive car-E Segment)</b>			
2.0 i (NSD)		Gasolina	RWD	1998	85	115	10.94-08.98	■
2.0 i 16V (N3A)		Gasolina	RWD	1998	100	136	10.94-08.98	■
2.3 i 16V (Y5A)		Gasolina	RWD	2295	108	147	06.96-08.98	■
2.9 i (BRG)		Gasolina	RWD	2933	110	150	02.95-08.98	■
2.5 TD (VM)		Diesel	RWD	2499	92	125	09.96-08.98	■
2.5 TD (SCC)		Diesel	RWD	2500	85	115	10.94-08.98	■
<b>SCORPIO II Turnier (GNR, GGR) 10.94-08.98</b>					<b>Estate (Executive car-E Segment)</b>			
2.0 i (NSD)		Gasolina	RWD	1998	85	115	10.94-08.98	■
2.0 i 16V (N3A)		Gasolina	RWD	1998	100	136	10.94-08.98	■
2.3 i 16V (Y5A)		Gasolina	RWD	2295	108	147	06.96-08.98	■
2.9 i (BRG)		Gasolina	RWD	2933	110	150	02.95-08.98	■
2.5 TD (VM)		Diesel	RWD	2499	92	125	09.96-08.98	■
2.5 TD (SCC)		Diesel	RWD	2500	85	115	10.94-08.98	■
<b>FORD USA</b>								
<b>CONTOUR (U.S.A.) 08.93-12.97</b>					<b>Saloon (Compact car-C Segment)</b>			
2.0 S		Gasolina	FWD	1988	93	126	08.93-12.97	■
2.5 SE		Gasolina	FWD	2544	127	173	09.93-08.96	■
<b>MERCURY</b>								
<b>MYSTIQUE 02.94-08.01</b>					<b>Saloon (Compact car-C Segment)</b>			
2.0		Gasolina	FWD	1988	93	126	02.94-08.01	■
2.5		Gasolina	FWD	2544	127	173	09.94-08.97	■