

# LISTA DE APLICACIONES - BUYERS GUIDE

## 78BD6786-2



Weight: 8.640

O.E.M.	MAKE
1 025 911	FORD
4 115 996	FORD
5 026 786	AC
93BX-2A315-AD	FORD
F5RZ-2C02-6A	FORD USA
F5RZ-2C026-B	MERCURY
F7RZ-2C026-CA	MERCURY

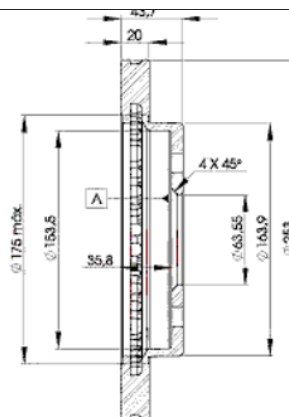
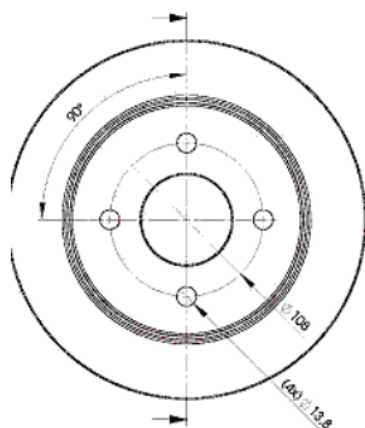

## 78BD6786-2

E1 90R-02C0452/0026



Ø253x20x43.7

MAKE
AC
FORD
FORD USA
MERCURY



Trac.	CC	Kw	CV	
				Front / Rear

### AC

#### ACE 01.95-10.98

Model	Engine	Trac.	CC	Kw	CV	Period	Segment
4.9 (1NMB CFL) (99E)	Gasolina	RWD	4942	191	260	01.95-10.98	■

#### ACE II 10.98-

Model	Engine	Trac.	CC	Kw	CV	Period	Segment
3.5 (1NMB HF6)	Gasolina	RWD	3506	260	354	11.99-12.00	■
4.6 (1NMB CFN)	Gasolina	RWD	4601	226	307	11.99-12.00	■
4.6 (1NMB CFN)	Gasolina	RWD	4601	240	326	10.98-	■
4.9 (1NMB CFL) (99E)	Gasolina	RWD	4942	179	243	10.98-	■
4.9 Super Charger (1NMB HFL) (99E)	Gasolina	RWD	4942	239	325	10.98-	■

#### ACECA 01.92-12.01

Model	Engine	Trac.	CC	Kw	CV	Period	Segment
4.6 (1NMB HFL)	Gasolina	RWD	4601	240	326	10.98-12.01	■
4.9 (1NMB HFL) (99E)	Gasolina	RWD	4942	179	243	09.93-12.97	■
4.9 Super Charger (1NMB HFL) (99E)	Gasolina	RWD	4942	239	325	10.98-12.01	■

#### COBRA Mk IV 01.90-

Model	Engine	Trac.	CC	Kw	CV	Period	Segment
4.9 Roadster (291N) (99H)	Gasolina	RWD	4942	168	228	09.97-08.99	■
4.9 (291F) (99F)	Gasolina	RWD	4942	184	250	01.90-10.97	■
4.9 Super Charger (291N) (99F)	Gasolina	RWD	4942	239	325	10.97-	■
4.9 (291F) (99UM)	Gasolina	RWD	4942	250	340	01.90-10.97	■
5.8 (291F)	Gasolina	RWD	5762	412	560	01.90-10.97	■

#### ME 01.79-12.86

Model	Engine	Trac.	CC	Kw	CV	Period	Segment
3000 (RA) (LO6)	Gasolina	RWD	2994	103	140	01.79-12.86	■

### FORD

# LISTA DE APLICACIONES - BUYERS GUIDE

COUGAR (EC_) 08.98-12.01					Coupe (Sports car-S Segment)			
2.0 16V (EDBA)		Gasolina	FWD	1988	96	131	08.98-12.01	■
2.0 16V (EDBB)		Gasolina	FWD	1988	96	131	08.98-12.01	■
2.0 16V (EDBC)		Gasolina	FWD	1988	96	131	08.98-12.01	■
2.0 16V (EDBD)		Gasolina	FWD	1988	96	131	08.98-12.01	■
2.5 V6 24V (LCBB)		Gasolina	FWD	2495	125	170	06.00-12.01	■
2.5 V6 24V (LCBC)		Gasolina	FWD	2495	125	170	06.00-12.01	■
2.5 V6 24V (LCBE)		Gasolina	FWD	2495	125	170	06.00-12.01	■
2.5 ST 200 (SGA)		Gasolina	FWD	2495	151	205	01.00-12.01	■
2.5 V6 24V (LCBA)		Gasolina	FWD	2544	125	170	08.98-12.01	■
2.5 V6 24V (LCBB)		Gasolina	FWD	2544	125	170	08.98-12.01	■
2.5 V6 24V (LCBC)		Gasolina	FWD	2544	125	170	08.98-12.01	■
2.5 V6 24V (LCBE)		Gasolina	FWD	2544	125	170	08.98-12.01	■
MONDEO (GBP) 02.93-08.96					Hatchback (Large family car-D Segment)			
1.8 i 16V (RKB)		Gasolina	FWD	1796	82	112	07.94-08.96	■
1.8 i 16V (RKA)		Gasolina	FWD	1796	85	115	02.93-08.96	■
1.8 i 16V 4x4 (RKA)		Gasolina	4WD	1796	85	115	02.93-08.96	■
2.0 i 16V 4x4 (NGA)		Gasolina	4WD	1988	97	132	12.94-08.96	■
2.0 i 16V 4x4 (NGA)		Gasolina	4WD	1988	100	136	04.93-08.96	■
2.5 i 24V (SEA)		Gasolina	FWD	2544	125	170	07.94-08.96	■
1.8 TD (RFM)		Diesel	FWD	1753	65	88	06.93-08.96	■
1.8 TD (RFN)		Diesel	FWD	1753	65	88	06.93-08.96	■
1.8 TD (RFM)		Diesel	FWD	1753	66	90	10.95-08.96	■
1.8 TD (RFN)		Diesel	FWD	1753	66	90	10.95-08.96	■
MONDEO (GBP) 01.93-08.96					Saloon (Large family car-D Segment)			
1.6 i 16V (L1F)	08/94-, vehicles with ABS	Gasolina	FWD	1597	66	90	02.93-08.96	■
1.8 i 16V (RKB)	vehicles with ABS	Gasolina	FWD	1796	82	112	01.94-08.96	■
1.8 4x4 (RKA)		Gasolina	4WD	1796	85	116	02.93-08.96	■
1.8 i 16V (RKA)	vehicles with ABS	Gasolina	FWD	1796	85	115	02.93-08.96	■
2.0 i 16V 4x4 (NGA)		Gasolina	4WD	1988	97	132	12.94-08.96	■
2.0 i 16V 4x4 (NGA)		Gasolina	4WD	1988	100	136	02.93-08.96	■
2.5 i 24V (SEA)		Gasolina	FWD	2544	125	170	07.94-08.96	■
MONDEO II (BAP) 08.96-09.00					Hatchback (Large family car-D Segment)			
1.6 i (L1J)		Gasolina	FWD	1597	66	90	08.96-09.00	■
1.6 i 16V (L1L)		Gasolina	FWD	1597	70	95	05.98-09.00	■
1.6 i 16V (L1N)		Gasolina	FWD	1597	70	95	05.98-09.00	■
1.6 i 16V (L1Q)		Gasolina	FWD	1597	70	95	05.98-09.00	■
1.8 i (RKB)		Gasolina	FWD	1796	85	115	08.96-09.00	■
1.8 i (RKF)		Gasolina	FWD	1796	85	115	08.96-09.00	■
1.8 i (RKH)		Gasolina	FWD	1796	85	115	08.96-09.00	■
1.8 i (RKJ)		Gasolina	FWD	1796	85	115	08.96-09.00	■
1.8 i (RKK)		Gasolina	FWD	1796	85	115	08.96-09.00	■
2.0 i (NGA)		Gasolina	FWD	1988	96	131	08.96-09.00	■
2.0 i (NGB)		Gasolina	FWD	1988	96	131	08.96-09.00	■
2.0 i (NGC)		Gasolina	FWD	1988	96	131	08.96-09.00	■
2.0 i (NGD)		Gasolina	FWD	1988	96	131	08.96-09.00	■
2.5 24V (SEB)		Gasolina	FWD	2495	125	170	06.00-09.00	■
2.5 24V (SEC)		Gasolina	FWD	2495	125	170	06.00-09.00	■
2.5 ST 200 (SGA)		Gasolina	FWD	2495	151	205	05.99-09.00	■

# LISTA DE APLICACIONES - BUYERS GUIDE

2.5 24V (SEA)		Gasolina	FWD	2544	125	170	08.96-09.00	■
1.8 TD (RFN)		Diesel	FWD	1753	66	90	08.96-09.00	■
<b>MONDEO II (BFP) 08.96-09.00</b>					<b>Saloon (Large family car-D Segment)</b>			
1.6 i (L1J)		Gasolina	FWD	1597	66	90	08.96-09.00	■
1.6 i 16V (L1L)		Gasolina	FWD	1597	70	95	05.98-09.00	■
1.6 i 16V (L1N)		Gasolina	FWD	1597	70	95	05.98-09.00	■
1.6 i 16V (L1Q)		Gasolina	FWD	1597	70	95	05.98-09.00	■
1.8 i (RKB)	vehicles with ABS	Gasolina	FWD	1796	85	115	08.96-09.00	■
1.8 i (RKF)	vehicles with ABS	Gasolina	FWD	1796	85	115	08.96-09.00	■
1.8 i (RKH)	vehicles with ABS	Gasolina	FWD	1796	85	115	08.96-09.00	■
1.8 i (RKJ)	vehicles with ABS	Gasolina	FWD	1796	85	115	08.96-09.00	■
1.8 i (RKK)	vehicles with ABS	Gasolina	FWD	1796	85	115	08.96-09.00	■
2.0 i (NGA)	vehicles with ABS	Gasolina	FWD	1988	96	131	08.96-09.00	■
2.0 i (NGB)	vehicles with ABS	Gasolina	FWD	1988	96	131	08.96-09.00	■
2.0 i (NGC)	vehicles with ABS	Gasolina	FWD	1988	96	131	08.96-09.00	■
2.0 i (NGD)	vehicles with ABS	Gasolina	FWD	1988	96	131	08.96-09.00	■
2.5 24V (LCBD)		Gasolina	FWD	2495	125	170	06.00-09.00	■
2.5 24V (SEB)		Gasolina	FWD	2495	125	170	06.00-09.00	■
2.5 24V (SEC)		Gasolina	FWD	2495	125	170	06.00-09.00	■
2.5 ST 200 (SGA)		Gasolina	FWD	2495	151	205	05.99-09.00	■
2.5 24V (SEA)		Gasolina	FWD	2544	125	170	08.96-09.00	■
1.8 TD (RFN)	vehicles with ABS	Diesel	FWD	1753	66	90	08.96-09.00	■
<b>MONDEO II Turnier (BNP) 08.96-09.00</b>					<b>Estate (Large family car-D Segment)</b>			
1.6 i (L1J)		Gasolina	FWD	1597	66	90	08.96-09.00	■
1.6 i 16V (L1L)		Gasolina	FWD	1597	70	95	05.98-09.00	■
1.6 i 16V (L1N)		Gasolina	FWD	1597	70	95	05.98-09.00	■
1.6 i 16V (L1Q)		Gasolina	FWD	1597	70	95	05.98-09.00	■
1.8 i (RKA)	vehicles with ABS	Gasolina	FWD	1796	85	115	08.96-09.00	■
1.8 i (RKB)	vehicles with ABS	Gasolina	FWD	1796	85	115	08.96-09.00	■
1.8 i (RKF)	vehicles with ABS	Gasolina	FWD	1796	85	115	08.96-09.00	■
1.8 i (RKH)	vehicles with ABS	Gasolina	FWD	1796	85	115	08.96-09.00	■
1.8 i (RKJ)	vehicles with ABS	Gasolina	FWD	1796	85	115	08.96-09.00	■
1.8 i (RKK)	vehicles with ABS	Gasolina	FWD	1796	85	115	08.96-09.00	■
2.0 i (NGA)	vehicles with ABS	Gasolina	FWD	1988	96	131	08.96-09.00	■
2.0 i (NGB)	vehicles with ABS	Gasolina	FWD	1988	96	131	08.96-09.00	■
2.0 i (NGC)	vehicles with ABS	Gasolina	FWD	1988	96	131	08.96-09.00	■
2.0 i (NGD)	vehicles with ABS	Gasolina	FWD	1988	96	131	08.96-09.00	■
2.5 24V (SEB)		Gasolina	FWD	2495	125	170	10.99-09.00	■
2.5 24V (SEC)		Gasolina	FWD	2495	125	170	10.99-09.00	■
2.5 ST 200 (SGA)		Gasolina	FWD	2495	151	205	05.99-09.00	■
2.5 24V (SEA)		Gasolina	FWD	2544	125	170	08.96-09.00	■
1.8 TD (RFN)		Diesel	FWD	1753	66	90	08.96-09.00	■
<b>MONDEO Turnier (BNP) 01.93-08.96</b>					<b>Estate (Large family car-D Segment)</b>			
1.8 i 16V (RKB)	vehicles with ABS	Gasolina	FWD	1796	82	112	07.94-08.96	■
1.8 i 16V 4x4 (RKA)		Gasolina	4WD	1796	85	115	04.93-08.96	■
2.0 i 16V (NGA)		Gasolina	FWD	1988	97	132	01.93-08.96	■
2.0 i 16V 4x4 (NGA)		Gasolina	4WD	1988	97	132	12.94-08.96	■
2.0 i 16V 4x4 (NGA)		Gasolina	4WD	1988	100	136	04.93-08.96	■
2.5 i 24V (SEA)		Gasolina	FWD	2544	125	170	07.94-08.96	■

# LISTA DE APLICACIONES - BUYERS GUIDE

SCORPIO II Turnier (GNR, GGR) 10.94-08.98					Estate (Executive car-E Segment)			
2.0 i (NSD)		Gasolina	RWD	1998	85	115	10.94-08.98	■
2.0 i 16V (N3A)		Gasolina	RWD	1998	100	136	10.94-08.98	■
2.3 i 16V (Y5A)		Gasolina	RWD	2295	108	147	06.96-08.98	■
2.9 i (BRG)		Gasolina	RWD	2933	110	150	02.95-08.98	■
2.9 i 24V (BOB)		Gasolina	RWD	2933	152	207	10.94-08.98	■
2.5 TD (VM)		Diesel	RWD	2499	92	125	09.96-08.98	■
2.5 TD (SCC)		Diesel	RWD	2500	85	115	10.94-08.98	■
SCORPIO / GRANADA (GAE, GGE) 04.85-09.94					Hatchback (Executive car-E Segment)			
2.4 i (ARC)		Gasolina	RWD	2394	96	130	09.86-09.88	■
SCORPIO / GRANADA (GGE) 01.86-12.94					Saloon (Executive car-E Segment)			
2.9		Gasolina	RWD	2914	107	145	09.92-09.94	■
FORD USA								
CONTOUR (U.S.A.) 08.93-12.97					Saloon (Compact car-C Segment)			
2.0 S		Gasolina	FWD	1988	93	126	08.93-12.97	■
2.0		Gasolina	FWD	1988	96	131	09.97-08.00	■
2.5		Gasolina	FWD	2544	127	173	09.97-08.00	■
2.5 SE		Gasolina	FWD	2544	127	173	09.93-08.96	■
2.5 SVT		Gasolina	FWD	2544	149	203	09.97-08.00	■
MERCURY								
MYSTIQUE 02.94-08.01					Saloon (Compact car-C Segment)			
2.0		Gasolina	FWD	1988	93	126	02.94-08.01	■
2.0		Gasolina	FWD	1988	96	131	09.97-08.01	■
2.5		Gasolina	FWD	2544	127	173	09.94-08.97	■