

LISTA DE APLICACIONES - BUYERS GUIDE

78BD7019-2



Weight: 14.300

O.E.M.	MAKE
46 15A 147	MITSUBISHI
MN 102 276	MITSUBISHI

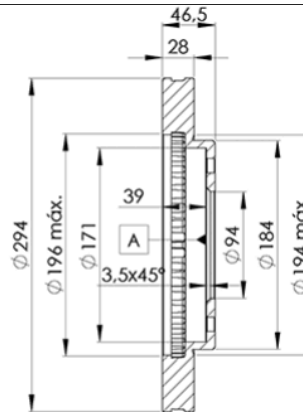
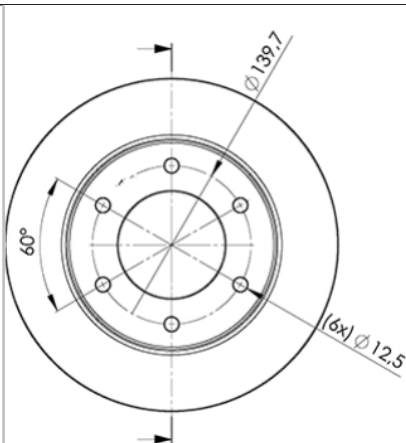

78BD7019-2

E1 90R-02C0452/0127



Ø294x28x46.5

MAKE
FIAT
MITSUBISHI
RAM



Trac.	CC	Kw	CV
-------	----	----	----



Front / Rear

FIAT

FULLBACK (502_, 503_) 01.16-

Pickup (Pick-Up Truck)

2.4 (KT0T) (4G64)	Gasolina	RWD	2351	97	132	04.16-	■
2.4 4x4 (KT0T) (4G64)	Gasolina	4WD	2351	97	132	04.16-	■
2.4 D 4x4 (KT0T) (4N15)	Diesel	4WD	2442	110	150	04.16-	■
2.4 D (KT0T) (4N15)	Diesel	RWD	2442	113	154	04.16-	■
2.4 D 4x4 (KT0T) (4N15)	Diesel	4WD	2442	113	154	04.16-	■
2.4 D 4x4 (KT0T) (4N15)	Diesel	4WD	2442	133	181	04.16-	■
2.5 D 4WD (KT0T) (4D56)	Diesel	4WD	2477	81	110	04.16-	■
2.5 D 4x4 (KT0T) (4D56)	Diesel	4WD	2477	100	136	04.16-	■

MITSUBISHI

L200 V / TRITON (KJ_, KK_, KL_) 02.14-

Pickup (Pick-Up Truck)

2.4 (KK4T)	Gasolina	RWD	2351	94	128	11.14-	■
2.4 2WD (4G64 (16V))	Gasolina	RWD	2351	94	128	11.14-08.20	■
2.4 (KK4T)	Gasolina	RWD	2351	96	131	11.14-	■
2.4 4WD (4G64 (16V))	Gasolina	4WD	2351	97	132	11.14-	■
2.2 DI-D (4N14)	Diesel	RWD	2268	110	150	07.19-	■
2.2 DI-D 4WD (4N14)	Diesel	4WD	2268	110	150	07.19-	■
2.4 DI-D	Diesel	RWD	2442	100	136	07.19-	■
2.4 DI-D 4WD	Diesel	4WD	2442	100	136	07.19-	■
2.4 DI-D	Diesel	RWD	2442	112	152	08.15-	■
2.4 DI-D 4WD	Diesel	4WD	2442	112	152	09.15-	■
2.4 DI-D (KJ0T) (4N15)	Diesel	RWD	2442	113	154	09.15-	■
2.4 DI-D 4WD (KJ0T) (4N15)	Diesel	4WD	2442	113	154	09.15-	■
2.4 DI-D (KK1T) (4N15)	Diesel	RWD	2442	133	181	01.15-	■

LISTA DE APLICACIONES - BUYERS GUIDE

2.4 DI-D 4WD (KL1T) (4N15)	Diesel	4WD	2442	133	181	11.14-	■
2.4 DI-D 4WD (KL1T, KL2T) (4N15)	Diesel	4WD	2442	140	190	09.15-	■
2.5 DI-D (4D56 (16V))	Diesel	RWD	2477	81	110	01.16-	■
2.5 DI-D 4WD (4D56 (16V))	Diesel	4WD	2477	81	110	11.14-	■
2.5 DI-D (KJ3T) (4D56 (16V))	Diesel	RWD	2477	94	128	11.14-	■
2.5 DI-D (4D56 (16V))	Diesel	RWD	2477	100	136	01.15-	■
2.5 DI-D 4WD (4D56 (16V))	Diesel	4WD	2477	100	136	11.14-	■
2.5 DI-D (KK3T) (4D56 (16V))	Diesel	RWD	2477	131	178	11.14-	■
2.5 DI-D 4WD	Diesel	4WD	2477	131	178	11.14-	■
3.2 DI-D 4WD (4M41)	Diesel	4WD	3200	132	180	05.15-	■
L200 V / TRITON / STRADA (MQ) 01.15-				Platform/Chassis (LCVs-N1 Segment)			
2.4 D (KK1T)	Diesel	RWD	2442	133	181	01.15-	■
2.4 D 4WD (KL1T)	Diesel	4WD	2442	133	181	01.15-	■
L200 III / COLT-RODEO / STRADA / TRITON (K7_T, K6_T, K5_T) 01.96-12.11				Pickup (Pick-Up Truck)			
2.5 DI-D 4x4 (K74T)	Diesel	4WD	2477	89	121	01.04-12.07	■
L200 IV / TRITON (KA_T, KB_T) 01.04-12.18				Pickup (Pick-Up Truck)			
2.4 (KA5T)	Gasolina	RWD	2351	94	128	11.05-12.15	■
2.4 4WD (KB5T) (4G64 (16V))	Gasolina	4WD	2351	94	128	09.09-12.12	■
2.4 (KA5T) (4G64 (16V))	Gasolina	RWD	2351	97	132	05.07-12.15	■
2.4 4WD (KB5T) (4G64 (16V))	Gasolina	4WD	2351	97	132	08.11-12.15	■
3.5 4WD (KB9T) (6G74 (SOHC 24V))	Gasolina	4WD	3497	132	180	11.05-12.15	■
3.5 (KA9T)	Gasolina	RWD	3497	135	184	07.06-12.11	■
3.5 4WD (KB9T)	Gasolina	4WD	3497	135	184	07.06-12.10	■
3.5 4WD (KB9T)	Gasolina	4WD	3497	137	186	08.11-12.15	■
3.5 4WD (KB9T) (6G74 (SOHC 24V))	Gasolina	4WD	3497	147	200	05.07-12.15	■
3.5 Flexfuel	Gasolina	FWD	3497	182	247	12.12-	■
2.4 CNG (KA5T)	Gasol./Gas (CNG)	RWD	2351	94	128	04.10-12.15	■
2.4 Flex (KA5T) (4G64 (16V))	Gasol./Etanol	RWD	2351	104	142	11.13-04.18	■
3.5 Flex 4WD (KB9T) (6G74 (SOHC 24V))	Gasol./Etanol	4WD	3497	147	200	09.09-12.15	■
3.5 Flexfuel 4WD (KB9T) (6G74 (SOHC 24V))	Gasol./Etanol	4WD	3497	151	205	08.09-12.17	■
2.5 D	Diesel	RWD	2477	55	75	08.11-12.15	■
2.5 D 4WD	Diesel	4WD	2477	55	75	08.11-12.15	■
2.5 D (KA4T) (4D56-TD)	Diesel	RWD	2477	66	90	08.11-12.15	■
2.5 DI-D (KA4T) (4D56 (16V))	Diesel	RWD	2477	94	128	04.10-12.15	■
2.5 DI-D (KA4T) (4D56-HP)	Diesel	RWD	2477	94	128	04.10-12.15	■
2.5 DI-D 4WD (KB4T) (4D56 (16V))	Diesel	4WD	2477	94	128	04.10-12.15	■
2.5 DI-D 16V 4WD (4D56 (16V))	Diesel	4WD	2477	98	133	04.07-12.15	■
2.5 TDiC	Diesel	RWD	2477	98	133	11.05-	■
2.5 DI-D (KA4T) (4D56-HP)	Diesel	RWD	2477	100	136	11.05-12.15	■
2.5 DI-D 4WD (KB4T) (4D56-HP)	Diesel	4WD	2477	100	136	11.05-12.15	■
2.5 DI-D (KA4T)	Diesel	RWD	2477	103	140	04.10-12.15	■
2.5 DI-D 4WD (KB4T)	Diesel	4WD	2477	103	140	04.10-12.15	■
2.5 DI-D	Diesel	RWD	2477	104	141	04.10-	■
2.5 DI-D (KA4T) (4D56-HP)	Diesel	RWD	2477	123	167	08.07-12.15	■
2.5 DI-D 4WD (KB4T) (4D56-HP)	Diesel	4WD	2477	123	167	10.07-12.15	■
2.5 DI-D (KA4T)	Diesel	RWD	2477	131	178	01.10-12.15	■
2.5 DI-D 4WD (KB4T) (4D56-HP)	Diesel	4WD	2477	131	178	04.10-12.15	■
2.8 D 4WD (KB7T)	Diesel	4WD	2835	71	97	05.05-12.15	■

LISTA DE APLICACIONES - BUYERS GUIDE

3.2 DI-D 4WD (KB8T)		Diesel	4WD	3200	118	160	07.06-12.09	■
3.2 DI-D 4WD (KB8T)		Diesel	4WD	3200	121	165	01.07-12.15	■
3.2 DI-D 4WD (KB8T) (4M41)		Diesel	4WD	3200	125	170	01.12-12.16	■
3.2 DI-D 4WD (KB8T) (4M41)		Diesel	4WD	3200	132	180	11.13-12.18	■
L200 IV / TRITON (KA_T, KB_T) 03.06-12.15					Platform/Chassis (LCVs-N1 Segment)			
2.4		Gasolina	FWD	2351	94	128	01.09-12.15	■
2.4 CNG		Gasolina	FWD	2351	94	128	12.09-12.15	■
2.5 DI-D (KA4T) (4D56 (16V))		Diesel	RWD	2477	94	128	08.07-12.15	■
2.5 DI-D (KA4T)		Diesel	RWD	2477	100	136	01.08-12.15	■
2.5 DI-D 4WD (KB4T) (4D56-HP)		Diesel	4WD	2477	131	178	09.09-12.15	■
PAJERO SPORT II / PAJERO DAKAR / CHALLENGER / MONTERO SPORT / NATIVA (KH_, KG_) 01.08-					Closed Off-Road Vehicle (Executive SUV-J Segment)			
3.0 Mivec (KG6W) (6B31)		Gasolina	RWD	2998	161	219	01.12-12.15	■
3.0 4WD (6B31)		Gasolina	4WD	2998	162	220	09.08-	■
3.5 (6G74 (SOHC 24V))		Gasolina	4WD	3497	137	186	01.10-	■
3.5 V6 24V (6G74 (SOHC 24V))		Gasolina	4WD	3497	153	208	09.08-	■
3.5 Flex 4WD		Gasol./Etanol	4WD	3497	151	205	06.11-12.18	■
2.5 DI-D (KH4W) (4D56-HP)		Diesel	RWD	2477	131	178	07.08-12.15	■
2.5 DI-D 4WD (KH4W) (4D56-HP)		Diesel	4WD	2477	131	178	07.08-	■
3.2 DI-D 4WD (4M41)		Diesel	4WD	3200	118	160	07.08-	■
3.2 DI-D 4WD (4M41)		Diesel	4WD	3200	121	165	07.08-	■
PAJERO SPORT / G-WAGON / MONTERO SPORT / CHALLENGER (K7_, K9_) 07.96-					Closed Off-Road Vehicle (Executive SUV-J Segment)			
3.2 TDi	07/08-	Diesel	RWD	3200	121	165	11.98-	■
RAM								
1200 (E_) 03.17-					Pickup (Pick-Up Truck)			
2.4 4x4 (E80)		Gasolina	4WD	2351	97	132	03.17-	■
2.5 D 4x4 (E85)		Diesel	4WD	2477	100	136	03.17-	■