

# LISTA DE APLICACIONES - BUYERS GUIDE

## 78BD7032-2



Weight: 11.420

O.E.M.	MAKE
MR 569 681	MITSUBISHI
MR 955 407	MITSUBISHI
MR 955 408	MITSUBISHI

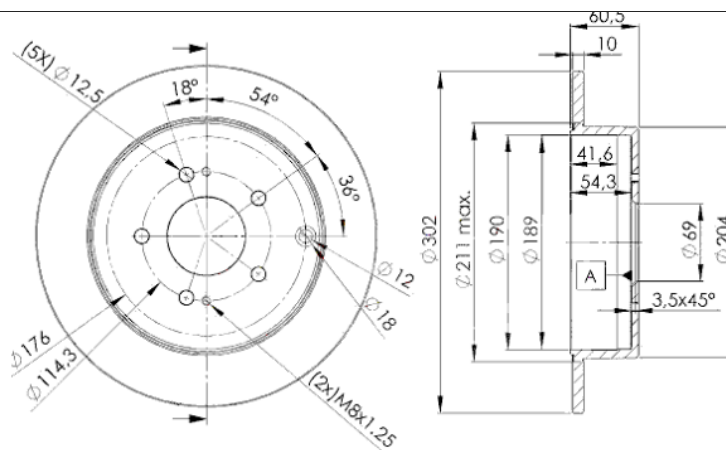

## 78BD7032-2

(E1) 90R-02C0241/1371



Ø302x10x60.5

**MAKE**  
MITSUBISHI



Trac.	CC	Kw	CV	
				Front / Rear

### MITSUBISHI

#### ENDEAVOR / EXPO-LRV (D8\_W, D7\_W) 05.02-08.11

#### SUV (Executive SUV-J Segment)

3.8 4WD (6G75)	Gasolina	4WD	3828	160	218	01.03-08.11	■
3.8 4WD (6G75)	Gasolina	4WD	3828	160	218	09.03-12.04	■
3.8 (6G75)	Gasolina	FWD	3828	168	228	09.04-08.11	■

#### GRANDIS (NA\_W) 03.03-12.11

#### MPV (Large MPV-M1 Segment)

2.4 MIVEC (NA4W) (4G69)	Gasolina	FWD	2378	121	165	04.04-12.11	■
2.4 MIVEC 4WD (NA4W) (4G69)	Gasolina	4WD	2378	121	165	04.04-12.11	■
2.4 MIVEC (NA4W) (4G69)	Gasolina	FWD	2378	130	177	04.04-12.11	■
2.0 DI-D (NA8W) (BSY)	Diesel	FWD	1968	100	136	09.05-03.10	■
2.0 DI-D (NA8W) (BWC)	Diesel	FWD	1968	103	140	02.07-03.10	■

#### GRANDIS / SPACE WAGON (N9\_, N8\_) 11.97-05.03

#### MPV (Large MPV-M1 Segment)

3.0 GLX 4WD (N96W)	Gasolina	4WD	2972	158	215	05.00-05.03	■
--------------------	----------	-----	------	-----	-----	-------------	---