

# LISTA DE APLICACIONES - BUYERS GUIDE

## 78BD7101-2

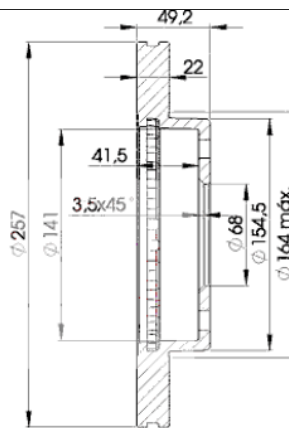

Weight: 10.924



## 78BD7101-2

E1 90R-02C0452/0077



Ø257x22x49.2

MAKE

INFINITI

NISSAN



Trac.	CC	Kw	CV
-------	----	----	----



Front / Rear

### INFINITI

#### G20 (P10) 01.90-12.97

#### Saloon (Compact executive car-D Segment)

2.0 (SR20DE)	Gasolina	FWD	1998	104	141	09.90-12.96	■
--------------	----------	-----	------	-----	-----	-------------	---

### NISSAN

#### 200SX (S13) 07.88-12.95

#### Coupe (Sports car-S Segment)

1.8 (CA18DE)	-08/91	Gasolina	RWD	1809	99	135	09.88-03.94	■
1.8 Turbo (CA18DT)		Gasolina	RWD	1809	126	171	09.88-03.94	■
2.0 i 16V		Gasolina	RWD	1998	103	140	07.88-11.93	■

#### ALMERA II / PULSAR / SENTRA (N16) 01.00-

#### Hatchback (Compact car-C Segment)

1.5 (QG15DE)	vehicles without ABS	Gasolina	FWD	1497	72	98	10.02-09.06	■
1.5 (QG15DE)	vehicles without ABS	Gasolina	FWD	1498	66	90	03.00-11.06	■
1.5 XL		Gasolina	FWD	1498	77	105	03.01-	■
1.6	vehicles without ABS	Gasolina	FWD	1597	83	113	07.00-02.03	■

#### ALMERA II / PULSAR / SENTRA (N16) 04.00-

#### Saloon (Compact car-C Segment)

1.5 (QG15DE)	vehicles without ABS	Gasolina	FWD	1497	72	98	10.02-09.06	■
1.5 (QG15DE)	vehicles without ABS	Gasolina	FWD	1498	66	90	07.00-11.06	■
1.5		Gasolina	FWD	1498	77	105	03.01-	■
1.6	vehicles without ABS	Gasolina	FWD	1597	83	113	07.00-02.03	■

#### ALMERA II Classic (B10) 03.06-

#### Saloon (Compact car-C Segment)

1.6 16V (QG16)		Gasolina	FWD	1597	79	107	03.06-	■
1.6 16V (QG16DE)		Gasolina	FWD	1597	79	107	03.06-	■

#### BLUEBIRD (U13, U14) 09.91-05.02

#### Saloon (Compact car-C Segment)

2.0		Gasolina	FWD	1998	107	145	11.91-08.01	■
-----	--	----------	-----	------	-----	-----	-------------	---

# LISTA DE APLICACIONES - BUYERS GUIDE

2.0 (SR20DE)		Gasolina	FWD	1998	107	145	04.97-05.02	■
2.0 D (CD20)		Diesel	FWD	1974	56	76	04.97-05.02	■
<b>BLUEBIRD SYLPHY (G10, N16) 01.00-08.14</b>					<b>Saloon (Compact car-C Segment)</b>			
1.8		Gasolina	FWD	1769	94	128	01.00-06.06	■
<b>PRAIRIE / LIBERTY / MULTI (M10, NM10) 12.82-10.88</b>					<b>MPV (Compact MPV-M1 Segment)</b>			
2.0 (CA20S)		Gasolina	FWD	1974	72	98	01.86-09.88	■
2.0 4x4 (CA20S)		Gasolina	4WD	1974	72	98	01.86-09.88	■
2.0 4x4 (CA20E)		Gasolina	4WD	1974	77	105	01.86-09.88	■
<b>PRAIRIE PRO / AXCESS / LIBERTY (M11) 10.88-10.98</b>					<b>MPV (Compact MPV-M1 Segment)</b>			
2.0		Gasolina	FWD	1974	66	90	10.89-03.92	■
2.0		Gasolina	FWD	1974	66	90	10.89-03.92	■
2.0 i (CA20E)		Gasolina	FWD	1974	72	98	10.88-04.92	■
2.0 i 4x4 (CA20E)		Gasolina	4WD	1974	72	98	10.88-12.92	■
2.0 (CA20E)		Gasolina	FWD	1974	77	105	09.90-03.92	■
2.0 4x4 (CA20E)		Gasolina	4WD	1974	77	105	09.90-03.92	■
2.0 (CA20E)		Gasolina	FWD	1974	85	116	03.89-08.90	■
2.0		Gasolina	FWD	1974	85	116	03.89-08.90	■
2.4 i (KA24E)		Gasolina	FWD	2389	98	133	01.90-07.94	■
2.4 i 4x4 (KA24E)		Gasolina	4WD	2389	98	133	04.92-07.94	■
<b>PRIMERA (P10) 06.90-06.96</b>					<b>Hatchback (Large family car-D Segment)</b>			
1.6 (GA16DS)	10/94-	Gasolina	FWD	1597	66	90	06.90-01.96	■
1.6 (GA16DE)	10/94-	Gasolina	FWD	1597	75	102	06.93-01.96	■
2.0 16V (SR20DI)		Gasolina	FWD	1998	85	116	06.90-01.96	■
2.0 16V 4x4 (SR20DI)		Gasolina	4WD	1998	85	116	04.91-06.96	■
2.0 i (SR20DE)		Gasolina	FWD	1998	92	125	01.95-06.96	■
2.0 (SR20DE)		Gasolina	FWD	1998	105	143	06.90-04.93	■
2.0 GT		Gasolina	FWD	1998	105	143	03.91-04.93	■
2.0 (SR20DE)		Gasolina	FWD	1998	110	150	06.90-01.96	■
2.0 (SR20DE)		Gasolina	FWD	1998	112	152	09.90-01.96	■
2.0 D (CD20)	05/93-	Diesel	FWD	1974	55	75	01.91-01.96	■
<b>PRIMERA (P10) 06.90-06.96</b>					<b>Saloon (Large family car-D Segment)</b>			
1.6 (GA16DS)	10/94-	Gasolina	FWD	1597	66	90	06.90-01.96	■
1.6 (GA16DS)	10/94-	Gasolina	FWD	1597	71	97	06.90-01.96	■
1.6 (GA16DE)	10/94-	Gasolina	FWD	1597	75	102	06.93-01.96	■
2.0 16V (SR20DI)		Gasolina	FWD	1998	85	116	06.90-01.96	■
2.0 16V 4x4 (SR20DI)		Gasolina	4WD	1998	85	116	04.91-06.96	■
2.0 i (SR20DE)		Gasolina	FWD	1998	92	125	01.95-06.96	■
2.0 (SR20DE)		Gasolina	FWD	1998	96	131	06.90-05.96	■
2.0		Gasolina	FWD	1998	105	143	06.90-04.93	■
2.0 GT 4x4 (SR20DE)		Gasolina	4WD	1998	105	143	03.91-04.93	■
2.0 4x4 (SR20DE)		Gasolina	4WD	1998	110	150	03.91-04.93	■
2.0 GT (SR20DE)		Gasolina	FWD	1998	110	150	06.90-01.96	■
2.0 D (CD20)	05/93-	Diesel	FWD	1974	55	75	01.91-01.96	■
<b>PRIMERA II (P11) 06.96-07.02</b>					<b>Hatchback (Large family car-D Segment)</b>			
1.6 16V (GA16DE)	vehicles without ABS	Gasolina	FWD	1597	66	90	09.96-07.02	■
1.6 16V (GA16DE)	vehicles without ABS	Gasolina	FWD	1597	73	99	09.96-07.02	■
1.6 16V (QG16DE)	vehicles without ABS	Gasolina	FWD	1597	78	106	09.00-07.02	■
1.8 16V (QG18DE)	vehicles without ABS	Gasolina	FWD	1769	84	114	08.99-07.02	■
2.0 16V (SR20DE)		Gasolina	FWD	1998	85	115	09.96-07.02	■

# LISTA DE APLICACIONES - BUYERS GUIDE

2.0 16V (SR20DE)		Gasolina	FWD	1998	96	131	09.96-07.02	■
1.6 16V LPG		Gasol./Gas (LPG)	FWD	1597	78	106	09.00-07.02	■
2.0 TD (CD20T)	vehicles without ABS	Diesel	FWD	1974	66	90	09.96-07.02	■
<b>PRIMERA II (P11) 06.96-12.01</b>					<b>Saloon (Large family car-D Segment)</b>			
1.6 16V (GA16DE)	vehicles without ABS	Gasolina	FWD	1597	66	90	09.96-12.01	■
1.6 16V (GA16DE)	vehicles without ABS	Gasolina	FWD	1597	73	99	09.96-10.00	■
1.6 16V (QG16DE)	vehicles without ABS	Gasolina	FWD	1597	78	106	06.96-12.01	■
1.8 16V (QG18DE)	vehicles without ABS	Gasolina	FWD	1769	84	114	08.99-12.01	■
1.8		Gasolina	FWD	1769	96	131	06.96-05.99	■
2.0 16V (SR20DE)		Gasolina	FWD	1998	85	115	09.96-12.01	■
2.0 16V (SR20DE)		Gasolina	FWD	1998	96	131	09.96-12.01	■
1.8 LPG		Gasol./Gas (LPG)	FWD	1769	84	114	08.99-12.01	■
2.0 TD (CD20T)	vehicles without ABS	Diesel	FWD	1974	66	90	09.96-12.01	■
<b>PRIMERA Traveller (W10) 07.90-03.98</b>					<b>Estate (Large family car-D Segment)</b>			
1.6 i (GA16DS)		Gasolina	FWD	1597	66	90	07.90-03.98	■
1.6 i (GA16DE)		Gasolina	FWD	1597	75	102	02.91-03.98	■
2.0 i (SR20DI)		Gasolina	FWD	1998	85	116	07.90-03.98	■
2.0 (SR20DE)		Gasolina	FWD	1998	110	150	07.94-01.98	■
2.0 D (CD20)		Diesel	FWD	1974	55	75	07.90-12.95	■
<b>SENTRA IV (B15) 07.98-12.07</b>					<b>Saloon (Compact car-C Segment)</b>			
1.8 (QG18DE)		Gasolina	FWD	1769	88	120	01.00-08.06	■
1.8 (QG18DE)		Gasolina	FWD	1769	93	126	01.00-08.06	■
<b>SKYLINE VIII (R32) 03.89-01.95</b>					<b>Coupe (Executive car-E Segment)</b>			
2.0 (HCR32) (RB20DE)		Gasolina	RWD	1998	114	155	03.89-06.93	■
2.0 (HCR32) (RB20DE)		Gasolina	RWD	1998	116	158	01.90-01.93	■
<b>SUNNY IX (B15) 04.00-09.03</b>					<b>Coupe (Supermini car-B Segment)</b>			
1.8		Gasolina	FWD	1769	85	116	04.00-09.03	■
<b>SUNNY IX (N16) 04.00-09.03</b>					<b>Hatchback (Supermini car-B Segment)</b>			
1.5		Gasolina	FWD	1498	77	105	04.00-08.03	■
1.8 (QG18DE)		Gasolina	FWD	1769	85	116	04.00-09.03	■
<b>SUNNY VIII / SENTRA / TSURU (N16) 07.95-12.03</b>					<b>Saloon (Supermini car-B Segment)</b>			
1.3		Gasolina	FWD	1295	64	87	09.97-03.00	■
1.6 (QG16DE)		Gasolina	FWD	1597	75	102	04.00-09.03	■
1.8		Gasolina	FWD	1769	85	116	04.00-09.03	■
2.0		Gasolina	FWD	1998	110	150	01.00-05.02	■