

78BD7336-2

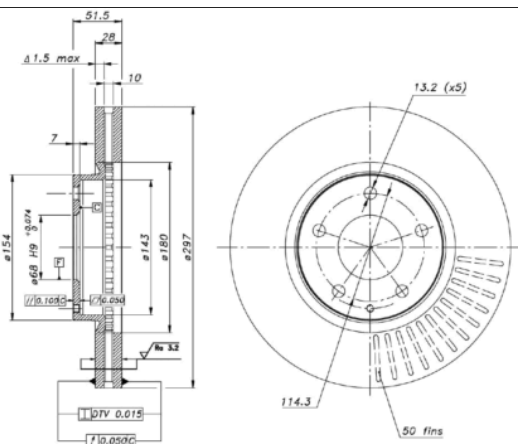

Weight: 16.200

O.E.M.	MAKE
GHP933251	MAZDA
GHP933251A	MAZDA
GHR133251	MAZDA
GHR133251A	MAZDA
GV9B33251A	MAZDA
K01133251A	MAZDA
K01133251B	MAZDA



78BD7336-2



Ø297x28x51.5

MAKE
HONGQI
MAZDA
MAZDA (CHANGAN)
MAZDA (FAW)



Trac.	CC	Kw	CV		
					Front / Rear

### HONGQI

#### E-HS3 03.19-

SUV ()

EV (TZ204XSLM2)	Eléctrico	FWD	0	114	155	03.19-	■
-----------------	-----------	-----	---	-----	-----	--------	---

#### H5 04.18-

Saloon ()

30 TD (CA4GC18TD-01)	Gasolina	FWD	1796	137	186	04.18-06.22	■
35 TD Mild Hybrid (CA4GC18TD-30)	Gasol./el éc.	FWD	1796	145	197	07.20-06.22	■

### MAZDA

#### 6 III / ATENZA (GJ) 01.13-05.16

Estate Van (Executive car-E Segment)

2.0 (PEY7)	Gasolina	FWD	1998	107	145	04.15-05.16	■
2.0 (PEY7)	Gasolina	FWD	1998	121	165	04.15-05.16	■
2.5 (PYY1)	Gasolina	FWD	2488	141	192	04.15-05.16	■
2.2 D (SHY4)	Diesel	FWD	2191	110	150	04.15-05.16	■
2.2 D AWD (SHY4)	Diesel	4WD	2191	110	150	01.13-05.16	■
2.2 D (SHY4)	Diesel	FWD	2191	129	175	04.15-05.16	■
2.2 D AWD (SHY4)	Diesel	4WD	2191	129	175	04.15-05.16	■

#### 6 III / ATENZA (GJ, GL) 08.12-

Estate (Executive car-E Segment)

2.0 (GJEFW) (PEXB)	Gasolina	FWD	1998	107	146	01.13-	■
2.0 (GJEFW) (PEXL)	Gasolina	FWD	1998	107	146	01.13-	■
2.0 (GJEFW) (PEY5)	Gasolina	FWD	1998	107	146	01.13-	■
2.0 (GJEFW) (PEY7)	Gasolina	FWD	1998	107	146	01.13-	■
2.0 (GJEFW, GJ107) (PE-VPR)	Gasolina	FWD	1998	114	155	12.12-	■
2.0 (GJEFW, GJ107) (PEY7)	Gasolina	FWD	1998	114	155	12.12-	■
2.0 (GJEFW) (PEXB)	Gasolina	FWD	1998	121	165	01.13-	■

# LISTA DE APLICACIONES - BUYERS GUIDE

2.0 (GJEFW) (PEXL)	Gasolina	FWD	1998	121	165	01.13-	■
2.0 (GJEFW) (PEY5)	Gasolina	FWD	1998	121	165	01.13-	■
2.0 (GJEFW) (PEY7)	Gasolina	FWD	1998	121	165	01.13-	■
2.5 (GJ5FW, GJ1031) (PYY1)	Gasolina	FWD	2488	136	185	12.12-	■
2.5 (GJ5FW, GJ1031) (PYY3)	Gasolina	FWD	2488	136	185	12.12-	■
2.5 (GJ5FW, GJ1031)	Gasolina	FWD	2488	138	188	12.12-	■
2.5 (PY-RPR-PYZC)	Gasolina	FWD	2488	140	190	03.18-	■
2.5 (PYY1)	Gasolina	FWD	2488	141	192	12.12-	■
2.5 (PY-Y8)	Gasolina	FWD	2488	141	192	12.12-	■
2.5 (PY-ZA)	Gasolina	FWD	2488	141	192	12.12-	■
2.5 (PYZ8)	Gasolina	FWD	2488	143	194	03.18-	■
2.5 (PYZC)	Gasolina	FWD	2488	143	194	03.18-	■
2.2 D (GJ2FW, GJ1021, GJ1022, GL1021) (SH-VPTR)	Diesel	FWD	2188	129	175	07.14-	■
2.2 D 4WD (GJ2AW) (SH-VPTR)	Diesel	4WD	2188	129	175	07.14-	■
2.2 D (SHY1)	Diesel	FWD	2191	110	150	10.12-12.20	■
2.2 D (SHY4)	Diesel	FWD	2191	110	150	10.12-12.20	■
2.2 D (SHY6)	Diesel	FWD	2191	110	150	10.12-12.20	■
2.2 D (SHY8)	Diesel	FWD	2191	110	150	10.12-12.20	■
2.2 D AWD (SHY4)	Diesel	4WD	2191	110	150	12.12-12.20	■
2.2 D AWD (SHY6)	Diesel	4WD	2191	110	150	12.12-12.20	■
2.2 D AWD (SHY8)	Diesel	4WD	2191	110	150	12.12-12.20	■
2.2 D (GJ2FW, GJ692) (SHY4)	Diesel	FWD	2191	129	175	08.12-02.18	■
2.2 D (GJ2FW, GJ692) (SHY6)	Diesel	FWD	2191	129	175	08.12-02.18	■
2.2 D AWD (SHY4)	Diesel	4WD	2191	129	175	02.15-	■
<b>6 III / ATENZA (GJ, GL) 12.12-</b>				<b>Saloon (Executive car-E Segment)</b>			
2.0 (GJ2, GL2, GL6) (PEXB)	Gasolina	FWD	1998	107	146	01.13-	■
2.0 (GJ2, GL2, GL6) (PEXL)	Gasolina	FWD	1998	107	146	01.13-	■
2.0 (GJ2, GL2, GL6) (PEY5)	Gasolina	FWD	1998	107	146	01.13-	■
2.0 (GJ2, GL2, GL6) (PEY7)	Gasolina	FWD	1998	107	146	01.13-	■
2.0 (PEXL)	Gasolina	FWD	1998	110	150	12.12-02.18	■
2.0 (PEY7)	Gasolina	FWD	1998	110	150	12.12-02.18	■
2.0 (GJEFP) (PE-VPR)	Gasolina	FWD	1998	114	155	12.12-	■
2.0 (GJEFP) (PEY5)	Gasolina	FWD	1998	114	155	12.12-	■
2.0 (GJEFP) (PEY7)	Gasolina	FWD	1998	114	155	12.12-	■
2.0 (GJEFP) (PEXB)	Gasolina	FWD	1998	121	165	01.13-	■
2.0 (GJEFP) (PEXL)	Gasolina	FWD	1998	121	165	01.13-	■
2.0 (GJEFP) (PEY5)	Gasolina	FWD	1998	121	165	01.13-	■
2.0 (GJEFP) (PEY7)	Gasolina	FWD	1998	121	165	01.13-	■
2.0	Gasolina	FWD	1998	125	170	06.16-	■
2.5 (GJ5FP, GJ1031) (PYY1)	Gasolina	FWD	2488	136	185	12.12-	■
2.5 (GJ5FP, GJ1031) (PYY3)	Gasolina	FWD	2488	136	185	12.12-	■
2.5 (GJ5FP, GJ1031) (PY-VPR)	Gasolina	FWD	2488	138	188	12.12-	■
2.5 (GJ5FP, GJ1031) (PYY1)	Gasolina	FWD	2488	138	188	12.12-	■
2.5 (GJ5FP, GL1032, GL1033) (PY-RPR)	Gasolina	FWD	2488	140	190	03.18-	■
2.5 (GJ5FP, GL1032, GL1033) (PYZC)	Gasolina	FWD	2488	140	190	03.18-	■
2.5 (GJ5FP, GL1032, GL1033) (PYY1)	Gasolina	FWD	2488	141	192	01.13-	■
2.5 (GJ5FP, GL1032, GL1033) (PY-Y8)	Gasolina	FWD	2488	141	192	01.13-	■
2.5 (GJ5FP, GL1032, GL1033) (PY-ZA)	Gasolina	FWD	2488	141	192	01.13-	■
2.5 (PYZ8)	Gasolina	FWD	2488	143	194	03.18-	■
2.5 (PYZC)	Gasolina	FWD	2488	143	194	03.18-	■
2.5 (GJ5FP, GL1032, GL1033) (PYZ4)	Gasolina	FWD	2488	170	231	03.18-	■

# LISTA DE APLICACIONES - BUYERS GUIDE

2.5 (PYZ4)		Gasolina	FWD	2488	186	253	09.17-	■
2.2 D (GJ2FP, GJ1021, GJ1022, GL1021) (SH-VPTR)		Diesel	FWD	2188	129	175	07.14-	■
2.2 D 4WD (GJ2AP) (SH-VPTR)		Diesel	4WD	2188	129	175	07.14-	■
2.2 D (GJ2FP) (SHY1)		Diesel	FWD	2191	110	150	12.12-11.20	■
2.2 D (GJ2FP) (SHY4)		Diesel	FWD	2191	110	150	12.12-11.20	■
2.2 D (GJ2FP) (SHY6)		Diesel	FWD	2191	110	150	12.12-11.20	■
2.2 D (GJ2FP) (SHY8)		Diesel	FWD	2191	110	150	12.12-11.20	■
2.2 D (GJ2FP, GJ1021, GJ1022, GL1021) (SHY1)		Diesel	FWD	2191	129	175	12.12-	■
<b>CX-5 (KE_) 11.11-02.17</b>					<b>SUV Van (Compact SUV-J Segment)</b>			
SKYACTIV-G AWD (KEK9)		Gasolina	4WD	1998	118	160	04.15-02.17	■
SKYACTIV-G (KEC9)		Gasolina	FWD	1998	121	165	04.15-02.17	■
SKYACTIV-G AWD (KEN9)		Gasolina	4WD	2488	141	192	04.15-02.17	■
SKYACTIV-D (KEF9)		Diesel	FWD	2191	110	150	04.15-02.17	■
SKYACTIV-D AWD (KEN9)		Diesel	4WD	2191	110	150	04.15-02.17	■
SKYACTIV-D AWD (KEN9, KE2AW)		Diesel	4WD	2191	129	175	04.15-02.17	■
<b>CX-5 (KE, GH) 11.11-</b>					<b>SUV (Compact SUV-J Segment)</b>			
2.0		Gasolina	FWD	1997	116	158	01.12-02.17	■
2.0 AWD		Gasolina	4WD	1997	116	158	01.12-02.17	■
2.0 (PEY5)		Gasolina	FWD	1998	110	150	02.12-02.17	■
2.0 AWD (PEY5)		Gasolina	4WD	1998	110	150	02.12-02.17	■
2.0 (PEY4)		Gasolina	FWD	1998	113	154	04.15-02.17	■
2.0 (PEY5)		Gasolina	FWD	1998	113	154	04.15-02.17	■
2.0 AWD (KE107, KEEAW) (PEY4)		Gasolina	4WD	1998	113	154	02.12-02.17	■
2.0 AWD (KE107, KEEAW) (PEY5)		Gasolina	4WD	1998	113	154	02.12-02.17	■
2.0 (KE107, KEEFW) (PEY4)		Gasolina	FWD	1998	114	155	07.12-02.17	■
2.0 (KE107, KEEFW) (PEY5)		Gasolina	FWD	1998	114	155	07.12-02.17	■
2.0 AWD (PEY4)		Gasolina	4WD	1998	114	155	07.12-02.17	■
2.0 AWD (PEY5)		Gasolina	4WD	1998	114	155	07.12-02.17	■
2.0 (KE107) (PEY5)		Gasolina	FWD	1998	115	156	01.12-02.17	■
2.0 (KE107) (PEY7)		Gasolina	FWD	1998	115	156	01.12-02.17	■
2.0 AWD (KE107) (PEY5)		Gasolina	4WD	1998	115	156	01.12-02.17	■
2.0 AWD (KE107) (PEY7)		Gasolina	4WD	1998	115	156	01.12-02.17	■
2.0 AWD (KEEAW) (PEY6)		Gasolina	4WD	1998	118	160	11.11-02.17	■
2.0 AWD (KEEAW) (PEY7)		Gasolina	4WD	1998	118	160	11.11-02.17	■
2.0 (KEEFW) (PEY6)		Gasolina	FWD	1998	121	165	11.11-02.17	■
2.0 (KEEFW) (PEY7)		Gasolina	FWD	1998	121	165	11.11-02.17	■
2.0		Gasolina	FWD	1998	125	170	01.15-	■
2.5		Gasolina	FWD	2488	135	184	07.14-	■
2.5		Gasolina	FWD	2488	136	185	04.15-	■
2.5 AWD (PY-VPS)		Gasolina	4WD	2488	136	185	04.15-02.17	■
2.5		Gasolina	FWD	2488	137	186	02.13-	■
2.5 (PY-VPS)		Gasolina	FWD	2488	137	186	02.13-02.17	■
2.5 (KE5FW) (PY-VPS)		Gasolina	FWD	2488	138	188	02.13-02.17	■
2.5 AWD (KE103) (PYY1)		Gasolina	4WD	2488	138	188	02.13-02.17	■
2.5		Gasolina	FWD	2488	141	192	03.15-	■
2.5 AWD (PYY1)		Gasolina	4WD	2488	141	192	02.15-02.17	■
2.2 D (KE2FW) (SH-VPTS)		Diesel	FWD	2188	129	175	04.12-02.17	■
2.2 D 4WD (KE2AW) (SH-VPTS)		Diesel	4WD	2188	129	175	04.12-02.17	■
2.2 D (KE2FW) (SHY1)		Diesel	FWD	2191	110	150	04.12-02.17	■
2.2 D (KE2FW) (SHY4)		Diesel	FWD	2191	110	150	04.12-02.17	■

# LISTA DE APLICACIONES - BUYERS GUIDE

2.2 D AWD (KE2AW) (SHY1)	Diesel	4WD	2191	110	150	04.12-02.17	■
2.2 D (SHY1)	Diesel	FWD	2191	129	175	04.12-02.17	■
2.2 D AWD (KE102) (SHY4)	Diesel	4WD	2191	129	175	04.12-02.17	■

## MAZDA (CHANGAN)

CX-5 (KE) 11.11-				SUV (Compact SUV-J Segment)			
2.0 (PE)	Gasolina	FWD	1998	114	155	07.12-09.17	■
2.0 AWD (PE)	Gasolina	4WD	1998	144	155	07.12-09.17	■
2.5 AWD (PY)	Gasolina	4WD	2488	144	196	02.13-09.17	■

## MAZDA (FAW)

6 ATENZA 05.14-				Saloon (Executive car-E Segment)			
2.0	Gasolina	FWD	1998	116	158	05.14-	■
2.5	Gasolina	FWD	2488	141	192	05.14-	■
CX-4 06.16-				SUV (Compact SUV-J Segment)			
2.0	Gasolina	FWD	1998	116	158	06.16-	■
2.5 (PY)	Gasolina	FWD	2488	141	192	11.19-	■
2.5 AWD (PY)	Gasolina	4WD	2488	141	192	06.16-	■