

LISTA DE APLICACIONES - BUYERS GUIDE

78BD7364-2



Weight: 24.732

O.E.M.	MAKE
SDB000621	LAND ROVER
SDB000622	LAND ROVER
SDB000623	LAND ROVER
SDB000624	LAND ROVER

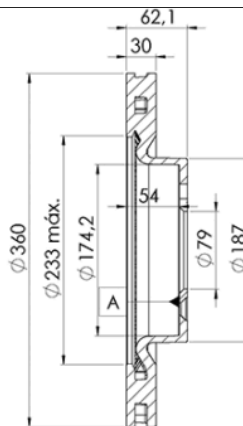
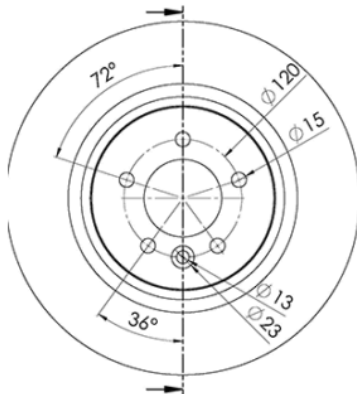

78BD7364-2



Ø360x30x62

MAKE
LAND ROVER



Trac.	CC	Kw	CV	
				Front / Rear

LAND ROVER

DISCOVERY IV / LR4 (L319) 09.09-						Closed Off-Road Vehicle (Executive SUV-J Segment)				
3.0 4x4 (306PS)	-ch AA222221	Gasolina	4WD	2995	250	340	08.13-12.18	■		
5.0 V8 4x4 (508PN)	-ch AA222221	Gasolina	4WD	4999	276	375	09.09-12.18	■		
2.7 TD 4x4 (276DT)		Diesel	4WD	2720	140	190	09.09-12.18	■		
3.0 TD 4x4 (306DT)	-ch AA222221	Diesel	4WD	2993	155	211	05.10-12.18	■		
3.0 TD 4x4 (306DT)	-ch AA222221	Diesel	4WD	2993	180	245	09.09-12.18	■		
3.0 TD 4x4 (306DT)	-ch AA222221	Diesel	4WD	2993	183	249	07.12-12.18	■		
3.0 SDV6 4x4 (306DT)	-ch AA222221	Diesel	4WD	2993	188	256	11.09-12.18	■		
DISCOVERY IV / LR4 (L319) 09.09-						Van (Executive SUV-J Segment)				
3.0 TD 4x4 (306DT)		Diesel	4WD	2993	155	211	01.11-12.17	■		
3.0 TD 4x4 (306DT)		Diesel	4WD	2993	180	245	01.11-12.17	■		
3.0 TD 4x4 (306DT)		Diesel	4WD	2993	188	256	01.11-12.17	■		
RANGE ROVER SPORT (L320) 02.05-03.13						SUV (Luxury Crossover SUV-J Segment)				
4.2 4x4 (428PS)		Gasolina	4WD	4196	298	405	09.05-02.10	■		
4.2 4x4 (428PS)	-10/09	Gasolina	4WD	4197	287	390	02.05-03.13	■		
4.2		Gasolina	FWD	4197	291	396	02.05-	■		
4.2 4x4 (428PS)		Gasolina	4WD	4197	291	396	01.06-02.10	■		
4.4 4x4 (448PN)	-10/09, Rim 18, Rim 19	Gasolina	4WD	4394	220	299	02.05-03.13	■		
5.0 4x4 (508PN)	-ch AA215622	Gasolina	4WD	4999	276	375	07.09-03.13	■		
5.0 4x4 (508PS)	-ch AA215622	Gasolina	4WD	4999	372	506	04.09-03.13	■		
5.0 4x4 (508PS)	-ch AA215622	Gasolina	4WD	4999	375	510	09.09-03.13	■		
2.7 D 4x4 (276DT)	-10/09, Rim 18, Rim 19	Diesel	4WD	2720	140	190	02.05-03.13	■		
3.0 D 4x4 (306DT)	-ch AA215622	Diesel	4WD	2993	155	211	05.10-03.13	■		

LISTA DE APLICACIONES - BUYERS GUIDE

3.0 D 4x4 (306DT)	-ch AA215622	Diesel	4WD	2993	180	245	09.09-03.13	■
3.0 D 4x4 (306DT)	-ch AA222221	Diesel	4WD	2993	183	249	08.12-03.13	■
3.0 D 4x4 (306DT)	-ch AA215622	Diesel	4WD	2993	188	256	06.11-03.13	■
3.6 D 4x4 (368DT)		Diesel	4WD	3628	200	272	04.06-03.13	■
RANGE ROVER SPORT II (L494) 04.13-					SUV (Luxury Crossover SUV-J Segment)			
5.0 SCV8 4x4 (508PS)	-ch AA215622	Gasolina	4WD	4999	375	510	04.13-12.18	■
5.0 SCV8 4x4 (508PS)		Gasolina	4WD	4999	405	550	01.14-12.18	■
3.0 SDV6 Hybrid 4x4 (306DT)		Diesel/el éc.	4WD	2993	215	292	12.14-12.17	■
3.0 SDV6 Hybrid 4x4 (306DT)		Diesel/el éc.	4WD	2993	250	340	10.13-	■
3.0 SDV6 Hybrid 4x4 (306DT)		Diesel/el éc.	4WD	2993	260	354	06.15-12.17	■
3.0 TDV6 4x4 (306DT)	-ch AA215622	Diesel	4WD	2993	155	211	04.13-12.18	■
3.0 SDV6 4x4 (306DT)	-ch AA215622	Diesel	4WD	2993	183	249	04.13-	■
3.0 TDV6 4x4 (306DT)	-ch AA215622	Diesel	4WD	2993	190	258	04.13-	■
3.0 SDV6 4x4 (306DT)	-ch AA215622	Diesel	4WD	2993	215	292	04.13-12.16	■
3.0 SDV6 4x4 (306DT)		Diesel	4WD	2993	225	306	09.14-	■
4.4 SDV8 4x4 (448DT)		Diesel	4WD	4367	250	340	10.13-	■