

LISTA DE APLICACIONES - BUYERS GUIDE

78BD7500-2



Weight: 8.164

O.E.M.	MAKE
51712-07500	KIA
51712-0X500	HYUNDAI
51712-X7500	KIA

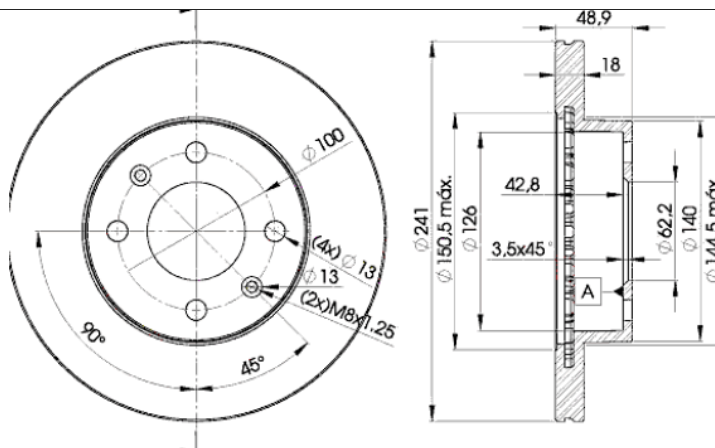

78BD7500-2

E1 90R-02C0452/0079



Ø241x18x49

MAKE
HYUNDAI
INOKOM
KIA



Trac.	CC	Kw	CV	
				Front / Rear

HYUNDAI

i10 (PA) 10.07-05.18					Hatchback (City car-A Segment)			
1.0 (G3LA)		Gasolina	FWD	998	51	69	01.11-12.13	■
1.1 (G4HG)		Gasolina	FWD	1086	48	65	12.07-12.13	■
1.1 (G4HG)		Gasolina	FWD	1086	49	67	01.08-12.13	■
1.1 (G4HG)		Gasolina	FWD	1086	50	68	11.08-12.13	■
1.1 (G4HG)		Gasolina	FWD	1086	51	69	04.11-12.13	■
1.2 LPG		Gasolina	FWD	1197	51	69	01.10-12.13	■
1.2		Gasolina	FWD	1197	55	75	10.08-04.11	■
1.2 (G4UG)		Gasolina	FWD	1197	59	80	10.07-12.13	■
1.2 (G4LA)	04/11-	Gasolina	FWD	1248	57	78	11.08-12.11	■
1.2 (G4LA)		Gasolina	FWD	1248	63	86	04.11-12.13	■
1.2 (G4LA)		Gasolina	FWD	1248	64	87	01.11-05.18	■
1.1 LPG (G4HG)		Gasol./G as (LPG)	FWD	1086	48	65	01.09-12.13	■
1.1 LPG (G4HG)		Gasol./G as (LPG)	FWD	1086	51	69	04.11-12.13	■
1.2 LPG (G4LA)		Gasol./G as (LPG)	FWD	1248	57	78	01.10-12.13	■
1.1 CRDi (D3FA)	04/11-	Diesel	FWD	1120	55	75	01.08-12.11	■
i10 II / GRAND i10 (BA, IA) 08.13-					Hatchback (City car-A Segment)			
1.2 (G4LA)		Gasolina	FWD	1248	65	88	09.14-07.19	■
i10 II / GRAND i10 12.13-					Saloon (City car-A Segment)			
1.2 (G4LA)		Gasolina	FWD	1248	65	88	12.13-	■
i10 II Cargo (BA, IA) 08.13-					Hatchback Van (LCVs-N1 Segment)			
1.0 (G3LA)		Gasolina	FWD	998	49	67	09.16-	■

LISTA DE APLICACIONES - BUYERS GUIDE

1.2 (G4LA)	Gasolina	FWD	1248	64	87	09.16-	■
INOKOM							
i10 (PA) 01.09-12.15				Hatchback (City car-A Segment)			
1.1	Gasolina	FWD	1086	51	69	04.11-	■
KIA							
PICANTO / MORNING / EURO STAR (SA) 04.04-				Hatchback (City car-A Segment)			
1.0 (G4HE)	Gasolina	FWD	999	45	61	04.04-04.11	■
1.0 (G4HE)	Gasolina	FWD	999	46	63	09.07-04.11	■
1.1 (G4HG)	Gasolina	FWD	1086	48	65	04.04-09.11	■
1.0 LPG (G4HE)	Gasol./Gas (LPG)	FWD	999	45	61	01.09-04.11	■
1.1 LPG (G4HG)	Gasol./Gas (LPG)	FWD	1086	48	65	01.09-04.11	■
1.1 CRDi (D3FA)	Diesel	FWD	1120	55	75	10.05-04.11	■
PICANTO II / MORNING / EURO STAR 05.11-				Hatchback Van (City car-A Segment)			
1.0 (G3LA)	Gasolina	FWD	998	57	77	11.14-	■
PICANTO II/MORNING/EURO STAR (TA) 05.11-				Hatchback (City car-A Segment)			
1.0 Flex (G3LA)	Gasol./Etanol	FWD	998	59	80	08.11-12.17	■