

LISTA DE APLICACIONES - BUYERS GUIDE

78BD7510-2



8 424073 148483

Weight: 9.224

O.E.M.	MAKE
51712-07700	KIA
51712-0X700	HYUNDAI
51712-B9000	HYUNDAI

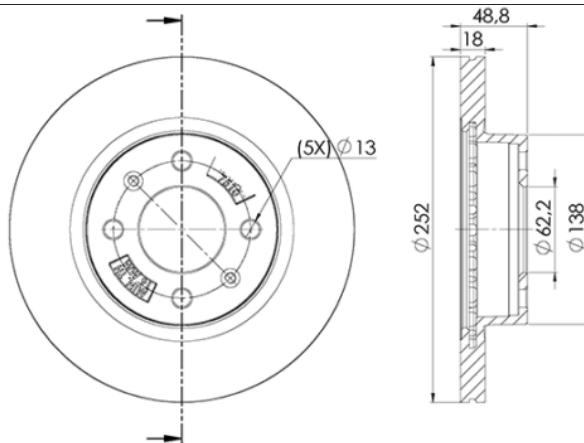

78BD7510-2



Ø252x18x48.8

MAKE
HYUNDAI
KIA



Trac.	CC	Kw	CV		
					Front / Rear

HYUNDAI

i10 (PA) 10.07-05.18

1.2 (G4LA)	Gasolina	FWD	1248	63	86	04.11-12.13	■
1.1 CRDi (D3FA)	Diesel	FWD	1120	55	75	01.08-12.11	■

i10 II / GRAND i10 (BA, IA) 08.13-

1.0 (G3LA)		Gasolina	FWD	998	49	67	08.13-12.19	■
1.2 (G4AG)		Gasolina	FWD	1197	60	82	09.13-12.17	■
1.2 (G4AG)		Gasolina	FWD	1197	61	83	01.18-12.21	■
1.2 (G4LA)		Gasolina	FWD	1248	64	87	12.13-12.19	■
1.2 (G4LA)		Gasolina	FWD	1248	65	88	09.14-07.19	■
1.0 LPG (B3LA)		Gasol./Gas (LPG)	FWD	998	49	67	02.14-12.19	■
1.0 LPG (B3LA)		Gasol./Gas (LPG)	FWD	998	51	69	07.14-08.16	■
1.1 CRDi (D3FA)		Diesel	FWD	1120	52	71	12.13-	■

i10 II / GRAND i10 12.13-

1.2 (G4AG)	Gasolina	FWD	1197	61	83	12.13-	■ ■ ■ ■ ■
1.2 (G4AG)	Gasolina	FWD	1197	61	83	03.14-05.17	
1.2 (G4LA)	Gasolina	FWD	1248	64	87	08.15-	
1.2 (G4LA)	Gasolina	FWD	1248	65	88	12.13-	
1.1 D (D3FA)	Diesel	FWD	1120	53	72	03.14-02.17	

i10 II Cargo (BA, IA) 08.13-

1.0 (G3LA)	Gasolina	FWD	998	49	67	09.16-	■
1.2 (G4LA)	Gasolina	FWD	1248	64	87	09.16-	■

LISTA DE APLICACIONES - BUYERS GUIDE

i10 III (AC3, AI3) 09.19-					Hatchback (City car-A Segment)			
1.0 MPi (G3LD)	Gasolina	FWD	998	49	67	09.19-	■	
1.0 T-GDI (G3LE)	Gasolina	FWD	998	74	100	02.20-	■	
1.2 MPI	Gasolina	FWD	1197	61	83	09.19-	■	
1.2 MPI (G4LA 11)	Gasolina	FWD	1197	62	84	09.19-	■	
1.2 MPI (G4LF)	Gasolina	FWD	1197	62	84	09.19-	■	
i10 III (AI3) 02.20-					Saloon (City car-A Segment)			
1.0 T-GDI (G3LC)	Gasolina	FWD	998	74	101	02.20-	■	
1.2 MPI (G4LA 11)	Gasolina	FWD	1197	61	83	02.20-	■	
KIA								
PICANTO / MORNING / EURO STAR (SA) 04.04-					Hatchback (City car-A Segment)			
1.0 (G4HC)	Gasolina	FWD	999	53	72	04.04-04.11	■	
1.1 CRDi (D3FA)	Diesel	FWD	1120	55	75	10.05-04.11	■	