

LISTA DE APLICACIONES - BUYERS GUIDE

78BD7520-2



Weight: 6.100

O.E.M.	MAKE
58411-07300	KIA
58411-07500	KIA
58411-0X500	HYUNDAI

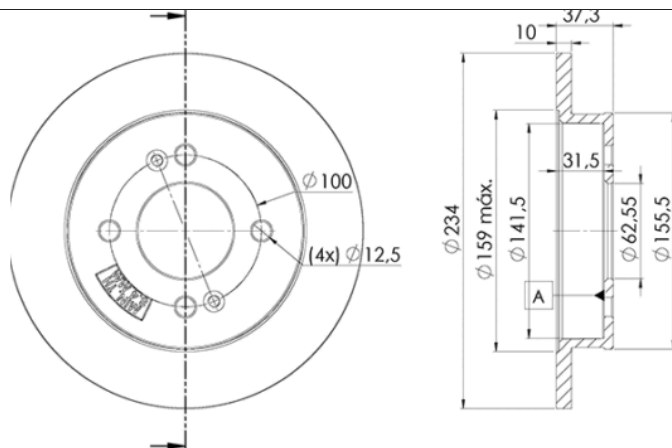

78BD7520-2



90R-02C0415/0043



Ø234x10x37.5

MAKE
HYUNDAI
INOKOM
KIA



Trac.	CC	Kw	CV
-------	----	----	----



Front / Rear

HYUNDAI

i10 (PA) 10.07-05.18

Hatchback (City car-A Segment)

1.1 (G4HG)	Gasolina	FWD	1086	49	67	01.08-12.13	■
1.1 (G4HG)	Gasolina	FWD	1086	50	68	11.08-12.13	■
1.1 (G4HG)	Gasolina	FWD	1086	51	69	04.11-12.13	■
1.2	Gasolina	FWD	1197	55	75	10.08-04.11	■
1.2 (G4UG)	Gasolina	FWD	1197	59	80	10.07-12.13	■
1.2 (G4LA)	Gasolina	FWD	1248	63	86	04.11-12.13	■
1.2 (G4LA)	Gasolina	FWD	1248	64	87	01.11-05.18	■
1.1 LPG (G4HG)	Gasol./G as (LPG)	FWD	1086	48	65	01.09-12.13	■
1.1 LPG (G4HG)	Gasol./G as (LPG)	FWD	1086	51	69	04.11-12.13	■
1.2 LPG (G4LA)	Gasol./G as (LPG)	FWD	1248	57	78	01.10-12.13	■
1.1 CRDi (D3FA)	Diesel	FWD	1120	55	75	01.08-12.11	■

INOKOM

i10 (PA) 01.09-12.15

Hatchback (City car-A Segment)

1.1	Gasolina	FWD	1086	51	69	04.11-	■
-----	----------	-----	------	----	----	--------	---

KIA

PICANTO / MORNING / EURO STAR (SA) 04.04-

Hatchback (City car-A Segment)

1.0 (G4HE)	Gasolina	FWD	999	45	61	04.04-04.11	■
1.0 (G4HE)	Gasolina	FWD	999	46	63	09.07-04.11	■
1.0 (G4HC)	Gasolina	FWD	999	53	72	04.04-04.11	■
1.1 (G4HG)	Gasolina	FWD	1086	48	65	04.04-09.11	■

LISTA DE APLICACIONES - BUYERS GUIDE

1.0 LPG (G4HE)		Gasol./Gas (LPG)	FWD	999	45	61	01.09-04.11	■
1.1 LPG (G4HG)		Gasol./Gas (LPG)	FWD	1086	48	65	01.09-04.11	■
1.1 CRDi (D3FA)		Diesel	FWD	1120	55	75	10.05-04.11	■
PICANTO II / MORNING / EURO STAR 05.11-					Hatchback Van (City car-A Segment)			
1.0 (G3LA)		Gasolina	FWD	998	57	77	11.14-	■
PICANTO III / MORNING / EURO STAR (JA) 03.17-					Hatchback (City car-A Segment)			
1.0 (G3LA)		Gasolina	FWD	998	49	67	03.17-	■
1.0 (G3LD)		Gasolina	FWD	998	49	67	03.17-	■
1.0 (G3LA)		Gasolina	FWD	998	51	69	03.17-	■
1.0 T-GDI (G3LC)		Gasolina	FWD	998	74	100	03.17-	■
1.2 MPI (G4LF)		Gasolina	FWD	1197	62	84	07.20-	■
1.2 (G4LA)		Gasolina	FWD	1248	62	84	03.17-	■
1.2		Gasolina	FWD	1248	64	87	03.17-	■
1.0 LPG (G3LA)		Gasol./Gas (LPG)	FWD	998	48	65	11.18-	■
1.0 LPG (G3LD)		Gasol./Gas (LPG)	FWD	998	48	65	11.18-	■
PICANTO III Runner / MORNING / EURO STAR (JA) 03.17-					Hatchback Van (City car-A Segment)			
1.0 MPi		Gasolina	FWD	998	49	67	11.18-	■
PICANTO II/MORNING/EURO STAR (TA) 05.11-					Hatchback (City car-A Segment)			
1.0 (G3LA)		Gasolina	FWD	998	49	67	05.11-03.17	■
1.0 (G3LA)		Gasolina	FWD	998	51	69	05.11-03.17	■
1.0		Gasolina	FWD	998	60	82	05.11-	■
1.2 (G4LA)		Gasolina	FWD	1248	63	85	09.11-03.17	■
1.2 (G4LA)		Gasolina	FWD	1248	64	87	09.11-02.17	■
1.0 LPG (B3LA)		Gasol./Gas (LPG)	FWD	998	49	67	08.13-03.17	■
1.0 Bi-Fuel (B3LA)		Gasol./Gas (LPG)	FWD	998	60	82	05.11-10.14	■
1.0 Flex (G3LA)		Gasol./Etanol	FWD	998	59	80	08.11-12.17	■
RAY (RA) 11.11-					MPV (Mini MPV-M1 Segment)			
1.0		Gasolina	FWD	998	57	78	11.11-	■
1.0 LPG		Gasolina	FWD	998	57	78	11.11-	■
1.0 TCI		Gasolina	FWD	998	78	106	11.11-	■