

LISTA DE APLICACIONES - BUYERS GUIDE

78BD7829-2



Weight: 14.064

| O.E.M. | MAKE |
|---------------|---------|
| 77 00 426 389 | RENAULT |
| 77 01 205 230 | RENAULT |
| 77 01 205 842 | RENAULT |
| 77 01 206 118 | RENAULT |
| 77 01 207 829 | RENAULT |

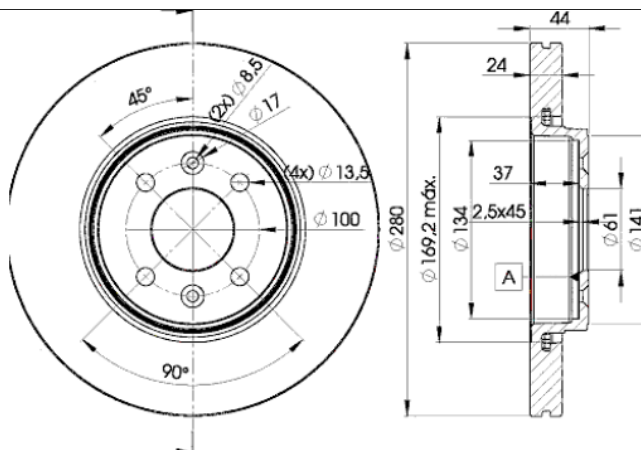

78BD7829-2

E1 90R-02C0433/0090



Ø280x24x44

| MAKE |
|---------|
| DACIA |
| RENAULT |



| Trac. | CC | Kw | CV | | |
|-------|----|----|----|--|--------------|
| | | | | | |
| | | | | | Front / Rear |

DACIA

| 09.17- | | | | | | | Pickup () | |
|-------------|--|----------|-----|------|----|-----|-------------|---|
| 1.2 TCe 115 | | Gasolina | FWD | 1197 | 85 | 115 | 08.18-12.21 | ■ |
| 1.6 SCe 100 | | Gasolina | FWD | 1598 | 75 | 102 | 09.17-12.21 | ■ |
| 1.5 dCi 75 | | Diesel | FWD | 1461 | 55 | 75 | 09.17-12.21 | ■ |
| 1.5 dCi 90 | | Diesel | FWD | 1461 | 66 | 90 | 09.17-12.21 | ■ |

| DOKKER (KE_) 11.12- | | | | | | | MPV () | |
|--------------------------|--|--------|-----|------|----|----|-------------|---|
| 1.5 dCi (KEMW) (K9K 612) | | Diesel | FWD | 1461 | 63 | 85 | 11.12-12.21 | ■ |
| 1.5 dCi (KEMW) (K9K 830) | | Diesel | FWD | 1461 | 63 | 85 | 11.12-12.21 | ■ |

| JOGGER (RK_) 09.21- | | | | | | | MPV (Compact MPV-M1 Segment) | |
|--------------------------|--|----------------------|-----|------|-----|-----|------------------------------|---|
| 1.0 TCe 110 (RKMD) | | Gasolina | FWD | 999 | 81 | 110 | 09.21- | ■ |
| 1.0 TCe 90 ECO-G (RKMT) | | Gasol./G as (LPG) | FWD | 999 | 67 | 91 | 09.21- | ■ |
| 1.0 TCe 100 ECO-G (RKMT) | | Gasol./G as (LPG) | FWD | 999 | 74 | 101 | 09.21- | ■ |
| 1.6 HYBRID 140 (RKN8) | | Gasol./el éc. | FWD | 1598 | 104 | 141 | 01.23- | ■ |

| LODGY (JS_) 03.12- | | | | | | | MPV (Compact MPV-M1 Segment) | |
|--------------------------|--|--------|-----|------|----|----|------------------------------|---|
| 1.5 dCi (JSMW) (K9K 612) | | Diesel | FWD | 1461 | 63 | 85 | 11.12- | ■ |
| 1.5 dCi (JSMW) (K9K 830) | | Diesel | FWD | 1461 | 63 | 85 | 11.12- | ■ |

RENAULT

| CAPTUR (J5_, H5_) 06.13- | | | | | | | Hatchback (Mini SUV-J Segment) | |
|--------------------------|--|----------|-----|------|----|-----|--------------------------------|---|
| 1.2 T (H5F 403) | | Gasolina | FWD | 1197 | 83 | 113 | 06.13- | ■ |
| 1.2 T (H5F 403) | | Gasolina | FWD | 1197 | 85 | 116 | 06.15- | ■ |
| 1.2 TCe 120 (H5F 408) | | Gasolina | FWD | 1197 | 87 | 118 | 01.16- | ■ |

LISTA DE APLICACIONES - BUYERS GUIDE

| | | | | | | | | |
|---|--|---------------|-----|------|--|-----|-------------|---|
| 1.2 TCe 120 (H5F 412) | | Gasolina | FWD | 1197 | 87 | 118 | 01.16- | ■ |
| 1.2 TCe 120 (H5F 403) | | Gasolina | FWD | 1197 | 88 | 120 | 06.13- | ■ |
| 1.2 TCe (J5AU) (H5F 408) | | Gasolina | FWD | 1197 | 97 | 132 | 02.18- | ■ |
| 1.3 TCe 130 (J5NJ, J5NE) (H5H 450) | | Gasolina | FWD | 1332 | 96 | 131 | 03.18- | ■ |
| 1.3 TCe 150 (J5NK, J5JS) (H5H 450) | | Gasolina | FWD | 1332 | 110 | 150 | 03.18- | ■ |
| 1.6 (J5JA, J5JY, H5JA) (H4M 750) | | Gasolina | FWD | 1598 | 84 | 114 | 02.18- | ■ |
| 1.5 dCi (J5MW) (K9K 830) | | Diesel | FWD | 1461 | 63 | 86 | 06.13- | ■ |
| 1.5 dCi 90 (J5N4, J5M5, J5MW, J5M6, J5AL, J5AJ) (K9K 608) | | Diesel | FWD | 1461 | 66 | 90 | 06.13- | ■ |
| 1.5 dCi 90 (J5N4, J5M5, J5MW, J5M6, J5AL, J5AJ) (K9K 609) | | Diesel | FWD | 1461 | 66 | 90 | 06.13- | ■ |
| 1.5 dCi 90 (J5N4, J5M5, J5MW, J5M6, J5AL, J5AJ) (K9K 628) | | Diesel | FWD | 1461 | 66 | 90 | 06.13- | ■ |
| 1.5 dCi 90 (J5N4, J5M5, J5MW, J5M6, J5AL, J5AJ) (K9K 629) | | Diesel | FWD | 1461 | 66 | 90 | 06.13- | ■ |
| 1.5 dCi 90 (J5N4, J5M5, J5MW, J5M6, J5AL, J5AJ) (K9K 838) | | Diesel | FWD | 1461 | 66 | 90 | 06.13- | ■ |
| 1.5 dCi 110 (K9K 646) | | Diesel | FWD | 1461 | 81 | 110 | 01.15- | ■ |
| 1.5 dCi 110 (K9K 856) | | Diesel | FWD | 1461 | 81 | 110 | 01.15- | ■ |
| CLIO II (BB_, CB_) 03.98- | | | | | Hatchback (Supermini car-B Segment) | | | |
| 2.0 16V Sport (CB0M) (F4R 730) | | Gasolina | FWD | 1998 | 124 | 169 | 02.00-06.09 | ■ |
| 2.0 16V Sport (CB0M) (F4R 736) | | Gasolina | FWD | 1998 | 124 | 169 | 02.00-06.09 | ■ |
| 2.0 16V (CB0M, CB1G) | | Gasolina | FWD | 1998 | 126 | 172 | 06.01-05.05 | ■ |
| 2.0 16V Sport (F4R 738) | | Gasolina | FWD | 1998 | 132 | 179 | 01.04-04.05 | ■ |
| CLIO II / EURO CLIO (BR0/1, CR0/1) 01.05- | | | | | Hatchback (Supermini car-B Segment) | | | |
| 1.2 16V (D4F 764) | | Gasolina | FWD | 1149 | 43 | 58 | 06.06-08.10 | ■ |
| 1.2 16V (D4F 786) | | Gasolina | FWD | 1149 | 76 | 103 | 09.10-12.14 | ■ |
| 1.6 | | Gasolina | FWD | 1598 | 79 | 107 | 09.05-12.10 | ■ |
| 1.6 16V GT (BR10, CR10) (K4M 862) | | Gasolina | FWD | 1598 | 94 | 128 | 06.09-12.14 | ■ |
| 2.0 16V (BR0C, BR0K, CR0C, CR0K) (M4R 700) | | Gasolina | FWD | 1997 | 102 | 139 | 09.06-12.14 | ■ |
| 2.0 16V (BR0C, BR0K, CR0C, CR0K) (M4R 701) | | Gasolina | FWD | 1997 | 102 | 139 | 09.06-12.14 | ■ |
| 1.2 Ethanol (CR1U, BR1U) (D4F 742) | | Gasol./Etanol | FWD | 1149 | 55 | 75 | 07.08-12.12 | ■ |
| 1.5 dCi (K9K 770) | | Diesel | FWD | 1461 | 55 | 75 | 08.10-12.14 | ■ |
| 1.5 dCi (K9K 766) | | Diesel | FWD | 1461 | 65 | 88 | 08.10-12.14 | ■ |
| 1.5 dCi (K9K 770) | | Diesel | FWD | 1461 | 65 | 88 | 08.10-12.14 | ■ |
| CLIO III (SB_, SR_) 06.05- | | | | | Hatchback Van (LCVs-N1 Segment) | | | |
| 1.2 (SR0J) (D4F 740) | | Gasolina | FWD | 1149 | 55 | 75 | 11.05-12.14 | ■ |
| 1.2 (SR0P) (D4F 784) | | Gasolina | FWD | 1149 | 74 | 101 | 11.07-12.11 | ■ |
| 1.2 Hi-Flex (SR1U) (D4F 742) | | Gasol./Etanol | FWD | 1149 | 58 | 79 | 11.07-12.09 | ■ |
| 1.5 dCi (K9K 768) | | Diesel | FWD | 1461 | 50 | 68 | 10.05-07.10 | ■ |
| 1.5 dCi | | Diesel | FWD | 1461 | 55 | 75 | 08.10-12.14 | ■ |
| 1.5 dCi (K9K 766) | | Diesel | FWD | 1461 | 63 | 86 | 06.05-07.10 | ■ |
| 1.5 dCi (SR1H) (K9K 770) | | Diesel | FWD | 1461 | 65 | 88 | 08.10-12.14 | ■ |
| 1.5 dCi (K9K 764) | | Diesel | FWD | 1461 | 78 | 106 | 10.05-10.07 | ■ |
| CLIO III Grandtour (KR0/1_) 11.07- | | | | | Estate (Supermini car-B Segment) | | | |
| 1.5 dCi (KR0G) (K9K 714) | | Diesel | FWD | 1461 | 50 | 68 | 11.07-12.12 | ■ |
| 1.5 dCi (KR0G) (K9K 768) | | Diesel | FWD | 1461 | 50 | 68 | 11.07-12.12 | ■ |
| 1.5 dCi (KR0F) (K9K 766) | | Diesel | FWD | 1461 | 63 | 86 | 11.07-12.12 | ■ |
| CLIO V (B7_) 06.19- | | | | | Hatchback (Supermini car-B Segment) | | | |
| 1.0 TCe 90 (B7MT) | | Gasolina | FWD | 999 | 67 | 91 | 08.20- | ■ |

LISTA DE APLICACIONES - BUYERS GUIDE

| | | | | | | | | |
|--|-----------------|------------------|-----|------|---|-----|-------------|---|
| 1.0 TCe 100 (B7MT) (H4D 450) | | Gasolina | FWD | 999 | 74 | 101 | 06.19- | ■ |
| 1.0 TCe 100 (B7MT) (H4D 452) | | Gasolina | FWD | 999 | 74 | 101 | 06.19- | ■ |
| 1.0 TCe 100 (B7MT) (H4D 460) | | Gasolina | FWD | 999 | 74 | 101 | 06.19- | ■ |
| 1.0 TCe 100 (B7MT) (H4D 472) | | Gasolina | FWD | 999 | 74 | 101 | 06.19- | ■ |
| 1.3 TCe 130 (B7MF) (H5H 450) | | Gasolina | FWD | 1332 | 96 | 131 | 06.19- | ■ |
| 1.3 TCe 130 (B7MF) (H5H 470) | | Gasolina | FWD | 1332 | 96 | 131 | 06.19- | ■ |
| 1.3 TCe 140 (B7N0) | | Gasolina | FWD | 1332 | 103 | 140 | 09.20- | ■ |
| 1.0 LPG (B7MT) | | Gasol./Gas (LPG) | FWD | 999 | 67 | 91 | 11.21- | ■ |
| 1.0 LPG (B7MT) (H4D 450) | | Gasol./Gas (LPG) | FWD | 999 | 74 | 101 | 06.19- | ■ |
| 1.0 LPG (B7MT) (H4D 452) | | Gasol./Gas (LPG) | FWD | 999 | 74 | 101 | 06.19- | ■ |
| 1.0 LPG (B7MT) (H4D 460) | | Gasol./Gas (LPG) | FWD | 999 | 74 | 101 | 06.19- | ■ |
| 1.0 LPG (B7MT) (H4D 472) | | Gasol./Gas (LPG) | FWD | 999 | 74 | 101 | 06.19- | ■ |
| 1.6 E-TECH 140 (B7MU) (H4M 630) | | Gasol./elé. | FWD | 1598 | 103 | 140 | 03.20- | ■ |
| 1.6 E-TECH 145 (B7MU) | | Gasol./elé. | FWD | 1598 | 105 | 143 | 01.22- | ■ |
| 1.5 Blue dCi 85 (B7AG) (K9K 854) | | Diesel | FWD | 1461 | 63 | 86 | 06.19- | ■ |
| 1.5 Blue dCi 85 (B7AG) (K9K 872) | | Diesel | FWD | 1461 | 63 | 86 | 06.19- | ■ |
| 1.5 Blue dCi 100 (B7AD) | | Diesel | FWD | 1461 | 74 | 101 | 11.21- | ■ |
| 1.5 Blue dCi 115 (B7AD) (K9K 854) | | Diesel | FWD | 1461 | 85 | 116 | 06.19- | ■ |
| 1.5 Blue dCi 115 (B7AD) (K9K 862) | | Diesel | FWD | 1461 | 85 | 116 | 06.19- | ■ |
| 1.5 Blue dCi 115 (B7AD) (K9K 872) | | Diesel | FWD | 1461 | 85 | 116 | 06.19- | ■ |
| GRAND SCÉNIC II (JM0/1_) 04.04- | | | | | MPV (Compact MPV-M1 Segment) | | | |
| 1.6 (K4M 788) | | Gasolina | FWD | 1598 | 77 | 105 | 06.06-11.08 | ■ |
| 1.6 (K4M 761) | | Gasolina | FWD | 1598 | 83 | 113 | 04.04-08.06 | ■ |
| 1.6 (K4M 782) | | Gasolina | FWD | 1598 | 83 | 113 | 04.04-08.06 | ■ |
| KANGOO (KC0/1_) 08.97- | | | | | MPV (Mini MPV-M1 Segment) | | | |
| 1.6 16V 4x4 (KC0P, KC0S, KC0L) (K4M 750) | | Gasolina | 4WD | 1598 | 70 | 95 | 10.01- | ■ |
| 1.6 16V 4x4 (KC0P, KC0S, KC0L) (K4M 752) | | Gasolina | 4WD | 1598 | 70 | 95 | 10.01- | ■ |
| 1.6 16V 4x4 (KC0P, KC0S, KC0L) (K4M 753) | | Gasolina | 4WD | 1598 | 70 | 95 | 10.01- | ■ |
| 1.9 dCi 4x4 (KC0V) (F9Q 782) | | Diesel | 4WD | 1870 | 59 | 80 | 10.01- | ■ |
| 1.9 dCi 4x4 (KC0V) (F9Q 790) | | Diesel | 4WD | 1870 | 59 | 80 | 10.01- | ■ |
| 1.9 dCi 4x4 (F9Q 790) | | Diesel | 4WD | 1870 | 62 | 84 | 10.03- | ■ |
| KANGOO EXPRESS (FC0/1_) 08.97- | | | | | Box Body/MPV (LCVs-N1 Segment) | | | |
| 1.6 16V 4x4 (FC0L, FC0P, FC0S) (K4M 750) | | Gasolina | 4WD | 1598 | 70 | 95 | 10.01- | ■ |
| 1.6 16V 4x4 (FC0L, FC0P, FC0S) (K4M 752) | | Gasolina | 4WD | 1598 | 70 | 95 | 10.01- | ■ |
| 1.6 16V 4x4 (FC0L, FC0P, FC0S) (K4M 753) | | Gasolina | 4WD | 1598 | 70 | 95 | 10.01- | ■ |
| 1.9 dCi 4x4 (FC0V) (F9Q 782) | | Diesel | 4WD | 1870 | 59 | 80 | 10.01- | ■ |
| 1.9 dCi 4x4 (FC0V) (F9Q 790) | | Diesel | 4WD | 1870 | 59 | 80 | 10.01- | ■ |
| 1.9 dCi 4x4 (FC0V) (F9Q 790) | | Diesel | 4WD | 1870 | 62 | 84 | 07.03- | ■ |
| LAGUNA I (B56_, 556_) 11.93-08.02 | | | | | Hatchback (Large family car-D Segment) | | | |
| 1.6 16V (B568, B561) (K4M 720) | -10/00 | Gasolina | FWD | 1598 | 79 | 107 | 11.97-03.01 | ■ |
| 1.6 16V (B568, B561) (K4M 724) | -10/00 | Gasolina | FWD | 1598 | 79 | 107 | 11.97-03.01 | ■ |
| 1.8 16V (B563, B564) (F4P 760) | -12/00, RimHo 4 | Gasolina | FWD | 1783 | 88 | 120 | 04.98-03.01 | ■ |
| 1.8 16V (B563, B564) (F4P 770) | -12/00, RimHo 4 | Gasolina | FWD | 1783 | 88 | 120 | 04.98-03.01 | ■ |
| 2.0 | | Gasolina | FWD | 1994 | 70 | 95 | 11.93-03.01 | ■ |
| 2.0 (F3R 611) | | Gasolina | FWD | 1998 | 80 | 109 | 03.99-03.01 | ■ |
| 2.0 (B56C/H/N) (F3R 722) | | Gasolina | FWD | 1998 | 83 | 113 | 11.93-03.01 | ■ |
| 2.0 (B56C/H/N) (F3R 723) | | Gasolina | FWD | 1998 | 83 | 113 | 11.93-03.01 | ■ |

LISTA DE APLICACIONES - BUYERS GUIDE

| | | | | | | | | |
|---|---------------------------|----------|-----|------|--|-----|-------------|---|
| 2.0 (F3R 722) | | Gasolina | FWD | 1998 | 84 | 114 | 06.95-02.01 | ■ |
| 2.0 (F3R 768) | | Gasolina | FWD | 1998 | 84 | 114 | 06.95-02.01 | ■ |
| 2.9 24V (B56V) | | Gasolina | FWD | 2946 | 140 | 190 | 03.97-03.01 | ■ |
| 3.0 24V (B56V) (L7X 700) | 10/99-, -12/00 | Gasolina | FWD | 2946 | 140 | 190 | 03.97-03.01 | ■ |
| 3.0 24V (B56V) (L7X 701) | 10/99-, -12/00 | Gasolina | FWD | 2946 | 140 | 190 | 03.97-03.01 | ■ |
| 1.9 dTi (B56J) (F9Q 710) | | Diesel | FWD | 1870 | 72 | 98 | 10.97-03.01 | ■ |
| 1.9 dTi (B56J) (F9Q 716) | | Diesel | FWD | 1870 | 72 | 98 | 10.97-03.01 | ■ |
| 1.9 dTi (B56J) (F9Q 717) | | Diesel | FWD | 1870 | 72 | 98 | 10.97-03.01 | ■ |
| 1.9 dCi (B56W) (F9Q 718) | RimHo 4 | Diesel | FWD | 1870 | 79 | 107 | 09.99-03.01 | ■ |
| 2.2 dT (B569) (G8T 760) | 10/99- | Diesel | FWD | 2188 | 83 | 113 | 03.96-03.01 | ■ |
| LAGUNA I Grandtour (K56_) 09.95-08.02 | | | | | Estate (Large family car-D Segment) | | | |
| 1.6 16V (K568) (K4M 720) | -12/00 | Gasolina | FWD | 1598 | 79 | 107 | 11.97-03.01 | ■ |
| 1.6 16V (K568) (K4M 724) | -12/00 | Gasolina | FWD | 1598 | 79 | 107 | 11.97-03.01 | ■ |
| 1.8 16V (K563, K564) (F4P 760) | 06/98-, -10/00 | Gasolina | FWD | 1783 | 88 | 120 | 04.98-03.01 | ■ |
| 1.8 (K56S/T/0) (F3P 670) | 06/98-, -10/00 | Gasolina | FWD | 1794 | 66 | 90 | 09.95-03.01 | ■ |
| 1.8 (K56S/T/0) (F3P 678) | 06/98-, -10/00 | Gasolina | FWD | 1794 | 66 | 90 | 09.95-03.01 | ■ |
| 1.8 (K56Z) (F3P 678) | 06/98-, -10/00 | Gasolina | FWD | 1794 | 69 | 94 | 09.95-03.01 | ■ |
| 1.8 (K56Z) (F3P 720) | 06/98-, -10/00 | Gasolina | FWD | 1794 | 69 | 94 | 09.95-03.01 | ■ |
| 1.8 (K56Z) (F3P 724) | 06/98-, -10/00 | Gasolina | FWD | 1794 | 69 | 94 | 09.95-03.01 | ■ |
| 2.0 (K56C/H) (F3R 722) | | Gasolina | FWD | 1998 | 83 | 113 | 09.95-03.01 | ■ |
| 2.0 (K56C/H) (F3R 723) | | Gasolina | FWD | 1998 | 83 | 113 | 09.95-03.01 | ■ |
| 2.0 (F3R 728) | | Gasolina | FWD | 1998 | 84 | 114 | 10.98-01.01 | ■ |
| 2.0 (F3R 768) | | Gasolina | FWD | 1998 | 84 | 114 | 10.98-01.01 | ■ |
| 3.0 24V (K56V) (L7X 700) | 05/98-, -12/00 | Gasolina | FWD | 2946 | 140 | 190 | 03.97-03.01 | ■ |
| 3.0 24V (K56V) (L7X 701) | 05/98-, -12/00 | Gasolina | FWD | 2946 | 140 | 190 | 03.97-03.01 | ■ |
| 1.9 dTi (K56J) (F9Q 710) | -12/00 | Diesel | FWD | 1870 | 72 | 98 | 10.97-03.01 | ■ |
| 1.9 dTi (K56J) (F9Q 716) | -12/00 | Diesel | FWD | 1870 | 72 | 98 | 10.97-03.01 | ■ |
| 1.9 dTi (K56J) (F9Q 717) | -12/00 | Diesel | FWD | 1870 | 72 | 98 | 10.97-03.01 | ■ |
| 1.9 dCi (K56W) (F9Q 718) | -12/00, vehicles with ABS | Diesel | FWD | 1870 | 79 | 107 | 09.99-03.01 | ■ |
| MEGANE (EA0/1_) 10.96-08.03 | | | | | Convertible (Compact car-C Segment) | | | |
| 1.4 16V (EA0D, EA1H, EA0W, EA10) (K4J 714) | vehicles with ESP | Gasolina | FWD | 1390 | 70 | 95 | 03.99-08.03 | ■ |
| 1.4 16V (EA0D, EA1H, EA0W, EA10) (K4J 750) | vehicles with ESP | Gasolina | FWD | 1390 | 70 | 95 | 03.99-08.03 | ■ |
| 1.6 16V (EA04, EA0B, EA11, EA1J) (K4M 700) | vehicles without ESP | Gasolina | FWD | 1598 | 79 | 107 | 03.99-07.03 | ■ |
| 1.6 16V (EA04, EA0B, EA11, EA1J) (K4M 701) | vehicles without ESP | Gasolina | FWD | 1598 | 79 | 107 | 03.99-07.03 | ■ |
| 1.6 16V (EA04, EA0B, EA11, EA1J) (K4M 708) | vehicles without ESP | Gasolina | FWD | 1598 | 79 | 107 | 03.99-07.03 | ■ |
| 1.6 16V (EA04, EA0B, EA11, EA1J) (K4M 709) | vehicles without ESP | Gasolina | FWD | 1598 | 79 | 107 | 03.99-07.03 | ■ |
| 2.0 i (EA0G) (F3R 791) | | Gasolina | FWD | 1998 | 80 | 109 | 03.99-08.03 | ■ |
| 2.0 i (EA0G) (F3R 796) | | Gasolina | FWD | 1998 | 80 | 109 | 03.99-08.03 | ■ |
| 2.0 16V (F4R 746) | | Gasolina | FWD | 1998 | 102 | 139 | 01.02-08.03 | ■ |
| 2.0 16V (F4R 770) | | Gasolina | FWD | 1998 | 102 | 139 | 01.02-08.03 | ■ |
| 2.0 16V IDE (EA03, EA0P, EA14) (F5R 740) | | Gasolina | FWD | 1998 | 103 | 140 | 11.99-08.03 | ■ |
| 2.0 16V (EA0H) (F7R 710) | 10/98- | Gasolina | FWD | 1998 | 108 | 147 | 10.96-11.99 | ■ |
| 2.0 16V (EA0H) (F7R 714) | 10/98- | Gasolina | FWD | 1998 | 108 | 147 | 10.96-11.99 | ■ |
| MEGANE (BA0/1_) 08.95-12.04 | | | | | Hatchback (Compact car-C Segment) | | | |
| 1.6 16V (BA04, BA0B, BA11, BA1J, BA16, BA19, BA1K, BA1V,... (K4M 700) | vehicles with ABS | Gasolina | FWD | 1598 | 79 | 107 | 03.99-08.02 | ■ |
| 1.6 16V (BA04, BA0B, BA11, BA1J, BA16, BA19, BA1K, BA1V,... (K4M 701) | vehicles with ABS | Gasolina | FWD | 1598 | 79 | 107 | 03.99-08.02 | ■ |
| 1.6 16V (BA04, BA0B, BA11, BA1J, BA16, BA19, BA1K, BA1V,... (K4M 706) | vehicles with ABS | Gasolina | FWD | 1598 | 79 | 107 | 03.99-08.02 | ■ |
| 1.6 16V (BA04, BA0B, BA11, BA1J, BA16, BA19, BA1K, BA1V,... (K4M 708) | vehicles with ABS | Gasolina | FWD | 1598 | 79 | 107 | 03.99-08.02 | ■ |

LISTA DE APLICACIONES - BUYERS GUIDE

| | | | | | | | | |
|---|---------------------------|------------------|-----|------|-----|-----|---------------------------------------|---|
| 1.6 16V (BA04, BA0B, BA11, BA1J, BA16, BA19, BA1K, BA1V,... (K4M 709) | vehicles with ABS | Gasolina | FWD | 1598 | 79 | 107 | 03.99-08.02 | ■ |
| 1.6 16V | vehicles with ABS | Gasolina | FWD | 1598 | 81 | 110 | 11.01-12.08 | ■ |
| 1.8 16V (BA06, BA12, BA1A, BA1M, BA1R) (F4P 720) | -08/02 | Gasolina | FWD | 1783 | 85 | 115 | 01.01-08.03 | ■ |
| 1.8 16V (BA06, BA12, BA1A, BA1M, BA1R) (F4P 722) | -08/02 | Gasolina | FWD | 1783 | 85 | 115 | 01.01-08.03 | ■ |
| 2.0 i (F3R 750) | | Gasolina | FWD | 1998 | 80 | 109 | 03.99-08.03 | ■ |
| 2.0 i (F3R 751) | | Gasolina | FWD | 1998 | 80 | 109 | 03.99-08.03 | ■ |
| 2.0 16V (BA0H) (F7R 710) | 10/98- | Gasolina | FWD | 1998 | 108 | 147 | 07.96-08.03 | ■ |
| 2.0 16V (BA0H) (F7R 714) | 10/98- | Gasolina | FWD | 1998 | 108 | 147 | 07.96-08.03 | ■ |
| 1.6 LPG (K4M 704) | | Gasol./Gas (LPG) | FWD | 1598 | 80 | 109 | 10.00-08.02 | ■ |
| 1.6 LPG (K4M 712) | | Gasol./Gas (LPG) | FWD | 1598 | 80 | 109 | 10.00-08.02 | ■ |
| 1.9 dTi (BA1U) (F9Q 744) | | Diesel | FWD | 1870 | 59 | 80 | 02.01-08.03 | ■ |
| 1.9 DTI (F9Q 730) | | Diesel | FWD | 1870 | 60 | 82 | 02.00-09.00 | ■ |
| 1.9 dTi (BA08, BA0N) (F9Q 730) | 05/99- | Diesel | FWD | 1870 | 72 | 98 | 03.97-02.01 | ■ |
| 1.9 dTi (BA08, BA0N) (F9Q 731) | 05/99- | Diesel | FWD | 1870 | 72 | 98 | 03.97-02.01 | ■ |
| 1.9 dTi (BA08, BA0N) (F9Q 734) | 05/99- | Diesel | FWD | 1870 | 72 | 98 | 03.97-02.01 | ■ |
| 1.9 dTi (BA08, BA0N) (F9Q 736) | 05/99- | Diesel | FWD | 1870 | 72 | 98 | 03.97-02.01 | ■ |
| 1.9 dCi (BA05, BA1F) (F9Q 732) | -08/02 | Diesel | FWD | 1870 | 75 | 102 | 02.01-08.03 | ■ |
| 1.9 dCi (BA05, BA1F) (F9Q 733) | -08/02 | Diesel | FWD | 1870 | 75 | 102 | 02.01-08.03 | ■ |
| 1.9 DT (F8Q 784) | | Diesel | FWD | 1870 | 76 | 104 | 08.98-10.99 | ■ |
| 1.9 dCi (F9Q 732) | | Diesel | FWD | 1870 | 77 | 105 | 03.99-08.03 | ■ |
| 1.9 dCi (F9Q 738) | | Diesel | FWD | 1870 | 77 | 105 | 03.99-08.03 | ■ |
| MEGANE Grandtour (KA0/1_) 03.99-08.03 | | | | | | | Estate (Compact car-C Segment) | |
| 1.6 BiFuel | vehicles with ABS | Gasolina | FWD | 1598 | 79 | 107 | 04.01-07.03 | ■ |
| 1.8 16V (KA0S, KA12, KA1A, KA1M, KA1R) (F4P 720) | | Gasolina | FWD | 1783 | 85 | 115 | 01.01-08.03 | ■ |
| 1.8 16V (KA0S, KA12, KA1A, KA1M, KA1R) (F4P 722) | | Gasolina | FWD | 1783 | 85 | 115 | 01.01-08.03 | ■ |
| 1.6 BiFuel (K4M 704) | | Gasol./Gas (LPG) | FWD | 1598 | 80 | 109 | 03.99-09.00 | ■ |
| 1.9 dTi (KA1U) (F9Q 744) | | Diesel | FWD | 1870 | 59 | 80 | 02.01-08.03 | ■ |
| 1.9 dTi (KA0N) (F9Q 731) | | Diesel | FWD | 1870 | 72 | 98 | 03.99-02.01 | ■ |
| 1.9 dTi (KA0N) (F9Q 736) | | Diesel | FWD | 1870 | 72 | 98 | 03.99-02.01 | ■ |
| 1.9 dCi (KA05, KA1F) (F9Q 732) | -07/03 | Diesel | FWD | 1870 | 75 | 102 | 02.01-08.03 | ■ |
| 1.9 dCi (KA05, KA1F) (F9Q 733) | -07/03 | Diesel | FWD | 1870 | 75 | 102 | 02.01-08.03 | ■ |
| 1.9 dCi (KA05, KA1F) (F9Q 738) | -07/03 | Diesel | FWD | 1870 | 75 | 102 | 02.01-08.03 | ■ |
| 1.9 dCi (F9Q 732) | | Diesel | FWD | 1870 | 77 | 105 | 03.99-09.00 | ■ |
| MEGANE Classic (LA0/1_) 09.96-08.08 | | | | | | | Saloon (Compact car-C Segment) | |
| 1.6 16V (LA00, LA04, LA0B, LA11, LA16, LA19, LA1J, LA1K,... (K4M 700) | 09/02-, vehicles with ABS | Gasolina | FWD | 1598 | 79 | 107 | 03.99-07.03 | ■ |
| 1.6 16V (LA00, LA04, LA0B, LA11, LA16, LA19, LA1J, LA1K,... (K4M 701) | 09/02-, vehicles with ABS | Gasolina | FWD | 1598 | 79 | 107 | 03.99-07.03 | ■ |
| 1.6 16V (LA00, LA04, LA0B, LA11, LA16, LA19, LA1J, LA1K,... (K4M 706) | 09/02-, vehicles with ABS | Gasolina | FWD | 1598 | 79 | 107 | 03.99-07.03 | ■ |
| 1.6 16V (LA00, LA04, LA0B, LA11, LA16, LA19, LA1J, LA1K,... (K4M 708) | 09/02-, vehicles with ABS | Gasolina | FWD | 1598 | 79 | 107 | 03.99-07.03 | ■ |
| 1.6 16V (LA00, LA04, LA0B, LA11, LA16, LA19, LA1J, LA1K,... (K4M 709) | 09/02-, vehicles with ABS | Gasolina | FWD | 1598 | 79 | 107 | 03.99-07.03 | ■ |
| 1.6 16V | vehicles with ABS | Gasolina | FWD | 1598 | 81 | 110 | 09.99-12.01 | ■ |
| 1.8 16V (LA06, LA12, LA1A, LA1M, LA1R) (F4P 720) | -09/02 | Gasolina | FWD | 1783 | 85 | 115 | 01.01-08.03 | ■ |
| 1.8 16V (LA06, LA12, LA1A, LA1M, LA1R) (F4P 722) | -09/02 | Gasolina | FWD | 1783 | 85 | 115 | 01.01-08.03 | ■ |
| 2.0 i (LA0G) (F3R 750) | | Gasolina | FWD | 1998 | 80 | 109 | 03.99-08.03 | ■ |
| 2.0 i (LA0G) (F3R 751) | | Gasolina | FWD | 1998 | 80 | 109 | 03.99-08.03 | ■ |

LISTA DE APLICACIONES - BUYERS GUIDE

| | | | | | | | | |
|--|----------------------|----------|-----|------|--|-----|-------------|---|
| 2.0 i (LA0G) (F3R 752) | | Gasolina | FWD | 1998 | 80 | 109 | 03.99-08.03 | ■ |
| 2.0 i (LA0G) (F3R 791) | | Gasolina | FWD | 1998 | 80 | 109 | 03.99-08.03 | ■ |
| 2.0 i (LA0G) (F3R 796) | | Gasolina | FWD | 1998 | 80 | 109 | 03.99-08.03 | ■ |
| 2.0 i (LA0G) (F3R 797) | | Gasolina | FWD | 1998 | 80 | 109 | 03.99-08.03 | ■ |
| 2.0 i (LA0G) (F3R 798) | | Gasolina | FWD | 1998 | 80 | 109 | 03.99-08.03 | ■ |
| 2.0 RT (F4R 747) | | Gasolina | FWD | 1998 | 103 | 140 | 03.01-08.03 | ■ |
| 2.0 RT (F5R 740) | | Gasolina | FWD | 1998 | 103 | 140 | 03.01-08.03 | ■ |
| 1.9 dTi (LA1U) (F9Q 744) | | Diesel | FWD | 1870 | 59 | 80 | 02.01-08.03 | ■ |
| 1.9 dCi (LA05, LA1F) (F9Q 732) | -09/02 | Diesel | FWD | 1870 | 75 | 102 | 02.01-08.03 | ■ |
| 1.9 dCi (LA05, LA1F) (F9Q 733) | -09/02 | Diesel | FWD | 1870 | 75 | 102 | 02.01-08.03 | ■ |
| 1.9 dCi (LA05, LA1F) (F9Q 738) | -09/02 | Diesel | FWD | 1870 | 75 | 102 | 02.01-08.03 | ■ |
| 1.9 DT (F8Q 784) | | Diesel | FWD | 1870 | 76 | 104 | 08.98-10.99 | ■ |
| 1.9 dCi (LA05) (F9Q 732) | | Diesel | FWD | 1870 | 77 | 105 | 03.99-07.03 | ■ |
| 1.9 dCi (LA05) (F9Q 733) | | Diesel | FWD | 1870 | 77 | 105 | 03.99-07.03 | ■ |
| MEGANE Coach (DA0/1_) 03.96-08.03 | | | | | Coupe (Compact car-C Segment) | | | |
| 1.4 16V (DA0D, DA1H, DA0W, DA10) (K4J 700) | 10/00- | Gasolina | FWD | 1390 | 70 | 95 | 03.99-07.03 | ■ |
| 1.4 16V (DA0D, DA1H, DA0W, DA10) (K4J 714) | 10/00- | Gasolina | FWD | 1390 | 70 | 95 | 03.99-07.03 | ■ |
| 1.4 16V (DA0D, DA1H, DA0W, DA10) (K4J 750) | 10/00- | Gasolina | FWD | 1390 | 70 | 95 | 03.99-07.03 | ■ |
| 1.6 16V (DA0B, DA04, DA11) (K4M 700) | vehicles without ESP | Gasolina | FWD | 1598 | 79 | 107 | 03.99-07.03 | ■ |
| 1.6 16V (DA0B, DA04, DA11) (K4M 701) | vehicles without ESP | Gasolina | FWD | 1598 | 79 | 107 | 03.99-07.03 | ■ |
| 1.6 16V (DA0B, DA04, DA11) (K4M 708) | vehicles without ESP | Gasolina | FWD | 1598 | 79 | 107 | 03.99-07.03 | ■ |
| 1.6 16V (DA0B, DA04, DA11) (K4M 709) | vehicles without ESP | Gasolina | FWD | 1598 | 79 | 107 | 03.99-07.03 | ■ |
| 2.0 i (F3R 791) | | Gasolina | FWD | 1998 | 80 | 109 | 03.99-08.03 | ■ |
| 2.0 i (F3R 796) | | Gasolina | FWD | 1998 | 80 | 109 | 03.99-08.03 | ■ |
| 2.0 16V (F4R 746) | -07/03 | Gasolina | FWD | 1998 | 102 | 139 | 01.02-08.03 | ■ |
| 2.0 16V IDE (DA03, DA0P, DA14) (F5R 740) | | Gasolina | FWD | 1998 | 103 | 140 | 11.99-08.03 | ■ |
| 2.0 16V (DA0H) (F7R 710) | 10/98- | Gasolina | FWD | 1998 | 108 | 147 | 03.96-11.99 | ■ |
| 2.0 16V (DA0H) (F7R 714) | 10/98- | Gasolina | FWD | 1998 | 108 | 147 | 03.96-11.99 | ■ |
| 1.9 dTi (DA0N) (F9Q 731) | -04/99 | Diesel | FWD | 1870 | 72 | 98 | 03.97-02.01 | ■ |
| 1.9 dTi (DA0N) (F9Q 734) | -04/99 | Diesel | FWD | 1870 | 72 | 98 | 03.97-02.01 | ■ |
| 1.9 dTi (DA0N) (F9Q 736) | -04/99 | Diesel | FWD | 1870 | 72 | 98 | 03.97-02.01 | ■ |
| 1.9 dCi (DA05, DA1F) (F9Q 732) | | Diesel | FWD | 1870 | 75 | 102 | 02.01-08.03 | ■ |
| 1.9 dCi (DA05, DA1F) (F9Q 733) | | Diesel | FWD | 1870 | 75 | 102 | 02.01-08.03 | ■ |
| 1.9 dCi (F9Q 732) | | Diesel | FWD | 1870 | 77 | 105 | 03.99-09.00 | ■ |
| 1.9 dCi (F9Q 733) | | Diesel | FWD | 1870 | 77 | 105 | 03.99-09.00 | ■ |
| MEGANE Hatchback Van (SA0/1_) 08.95-07.03 | | | | | Hatchback Van (Compact car-C Segment) | | | |
| 1.9 dCi (F9Q 738) | | Diesel | FWD | 1870 | 59 | 80 | 10.00-07.03 | ■ |
| MEGANE II (EM0/1_) 09.03-03.10 | | | | | Convertible (Compact car-C Segment) | | | |
| 1.6 (K4M 788) | | Gasolina | FWD | 1598 | 77 | 105 | 06.05-03.09 | ■ |
| 1.6 16V (K4M 760) | | Gasolina | FWD | 1598 | 82 | 112 | 01.06-06.08 | ■ |
| 1.6 16V (K4M 761) | | Gasolina | FWD | 1598 | 82 | 112 | 01.06-06.08 | ■ |
| 1.6 16V (K4M 812) | | Gasolina | FWD | 1598 | 82 | 112 | 01.06-06.08 | ■ |
| 1.6 16V (K4M 813) | | Gasolina | FWD | 1598 | 82 | 112 | 01.06-06.08 | ■ |
| 1.6 (K4M 760) | | Gasolina | FWD | 1598 | 83 | 113 | 09.03-03.09 | ■ |
| 1.6 (K4M 761) | | Gasolina | FWD | 1598 | 83 | 113 | 09.03-03.09 | ■ |
| 2.0 (F4R 770) | | Gasolina | FWD | 1998 | 99 | 135 | 09.03-12.09 | ■ |
| 2.0 (F4R 771) | | Gasolina | FWD | 1998 | 99 | 135 | 09.03-12.09 | ■ |
| 2.0 (EM0S) (F4R 770) | | Gasolina | FWD | 1998 | 102 | 139 | 09.03-02.07 | ■ |
| 2.0 (EM0S) (F4R 771) | | Gasolina | FWD | 1998 | 102 | 139 | 09.03-02.07 | ■ |

LISTA DE APLICACIONES - BUYERS GUIDE

| | | | | | | | |
|--|------------------|-----|------|-----|---|-------------|---|
| 2.0 16V Turbo (F4R 776) | Gasolina | FWD | 1998 | 120 | 163 | 05.04-03.09 | ■ |
| 1.9 dCi (F9Q 804) | Diesel | FWD | 1870 | 81 | 110 | 05.05-03.09 | ■ |
| 1.9 dCi (F9Q 816) | Diesel | FWD | 1870 | 81 | 110 | 05.05-03.09 | ■ |
| 1.9 dCi (F9Q 818) | Diesel | FWD | 1870 | 81 | 110 | 05.05-03.09 | ■ |
| 1.9 dCi (F9Q 804) | Diesel | FWD | 1870 | 85 | 115 | 09.03-03.09 | ■ |
| 1.9 dCi (F9Q 816) | Diesel | FWD | 1870 | 85 | 115 | 09.03-03.09 | ■ |
| 1.9 dCi (F9Q 818) | Diesel | FWD | 1870 | 85 | 115 | 09.03-03.09 | ■ |
| 1.9 dCi (F9Q 800) | Diesel | FWD | 1870 | 88 | 120 | 09.03-03.09 | ■ |
| 1.9 dCi (F9Q 803) | Diesel | FWD | 1870 | 96 | 131 | 05.05-02.07 | ■ |
| 1.9 dCi (F9Q 804) | Diesel | FWD | 1870 | 96 | 131 | 05.05-02.07 | ■ |
| 2.0 dCi (M9R 700) | Diesel | FWD | 1995 | 110 | 150 | 09.05-03.09 | ■ |
| 2.0 dCi (M9R 722) | Diesel | FWD | 1995 | 110 | 150 | 09.05-03.09 | ■ |
| MEGANE II (KM_) 08.03-07.09 | | | | | Estate Van (Compact car-C Segment) | | |
| 1.6 (KM0C) (K4M 780) | Gasolina | FWD | 1598 | 82 | 111 | 10.03-01.08 | ■ |
| 1.5 dCi (KM0F) (K9K 722) | Diesel | FWD | 1461 | 60 | 82 | 08.03-07.09 | ■ |
| 1.5 dCi (KM1F) (K9K 724) | Diesel | FWD | 1461 | 63 | 86 | 05.05-07.09 | ■ |
| 1.5 dCi (KM02) (K9K 728) | Diesel | FWD | 1461 | 74 | 101 | 08.03-07.09 | ■ |
| 1.5 dCi (KM1E) (K9K 732) | Diesel | FWD | 1461 | 78 | 106 | 08.03-07.09 | ■ |
| 1.9 dCi (KM14) (F9Q E 804) | Diesel | FWD | 1870 | 96 | 131 | 02.06-10.06 | ■ |
| MEGANE II (KM0/1_) 08.03-08.12 | | | | | Estate (Compact car-C Segment) | | |
| 1.6 16V (K4M 768) | Gasolina | FWD | 1598 | 75 | 102 | 05.05-07.09 | ■ |
| 1.6 16V (K4M 762) | Gasolina | FWD | 1598 | 77 | 105 | 05.05-07.09 | ■ |
| 1.6 16V (K4M 762) | Gasolina | FWD | 1598 | 81 | 110 | 05.06-10.11 | ■ |
| 1.6 16V (K4M 760) | Gasolina | FWD | 1598 | 82 | 112 | 01.06-08.09 | ■ |
| 1.6 16V (K4M 761) | Gasolina | FWD | 1598 | 82 | 112 | 01.06-08.09 | ■ |
| 1.6 16V (K4M 812) | Gasolina | FWD | 1598 | 82 | 112 | 01.06-08.09 | ■ |
| 1.6 16V (K4M 813) | Gasolina | FWD | 1598 | 82 | 112 | 01.06-08.09 | ■ |
| 1.6 (K4M 760) | Gasolina | FWD | 1598 | 83 | 113 | 08.03-07.09 | ■ |
| 1.6 (K4M 761) | Gasolina | FWD | 1598 | 83 | 113 | 08.03-07.09 | ■ |
| 2.0 (F4R 770) | Gasolina | FWD | 1998 | 99 | 135 | 08.03-07.09 | ■ |
| 2.0 (F4R 771) | Gasolina | FWD | 1998 | 99 | 135 | 08.03-07.09 | ■ |
| 2.0 (KM0S, KM2N, KM23) (F4R 770) | Gasolina | FWD | 1998 | 102 | 138 | 12.06-01.11 | ■ |
| 2.0 (KM0S, KM2N, KM23) (F4R 771) | Gasolina | FWD | 1998 | 102 | 138 | 12.06-01.11 | ■ |
| 1.6 LPG 16V (K4M 760) | Gasol./Gas (LPG) | FWD | 1598 | 82 | 112 | 01.06-08.09 | ■ |
| 1.6 16V Hi-Flex (K4M 856) | Gasol./Etanol | FWD | 1598 | 77 | 105 | 02.08-07.09 | ■ |
| 1.6 Flex | Gasol./Etanol | FWD | 1598 | 81 | 110 | 12.06-08.12 | ■ |
| 1.6 Flex (KM2E, KM2M, KM24, KM26) | Gasol./Etanol | FWD | 1598 | 85 | 115 | 11.06-08.12 | ■ |
| 1.9 dCi (F9Q 808) | Diesel | FWD | 1870 | 66 | 90 | 04.04-12.05 | ■ |
| 1.9 dCi (F9Q 808) | Diesel | FWD | 1870 | 68 | 92 | 03.04-02.07 | ■ |
| 1.9 dCi (F9Q 804) | Diesel | FWD | 1870 | 81 | 110 | 05.05-07.09 | ■ |
| 1.9 dCi (F9Q 818) | Diesel | FWD | 1870 | 81 | 110 | 05.05-07.09 | ■ |
| 1.9 dCi (F9Q 818) | Diesel | FWD | 1870 | 85 | 115 | 05.05-07.09 | ■ |
| 1.9 dCi (KMRG, KM1G, KM0G, KM2C) (F9Q 800) | Diesel | FWD | 1870 | 88 | 120 | 08.03-07.09 | ■ |
| 1.9 dCi (F9Q 803) | Diesel | FWD | 1870 | 96 | 131 | 05.05-07.09 | ■ |
| 1.9 dCi (F9Q 804) | Diesel | FWD | 1870 | 96 | 131 | 05.05-07.09 | ■ |
| 2.0 dCi (M9R 700) | Diesel | FWD | 1995 | 110 | 150 | 09.05-07.09 | ■ |
| 2.0 dCi (M9R 722) | Diesel | FWD | 1995 | 110 | 150 | 09.05-07.09 | ■ |

LISTA DE APLICACIONES - BUYERS GUIDE

| MEGANE II (BM0/1_, CM0/1_) 07.01-10.12 | | | | | Hatchback (Compact car-C Segment) | | | |
|--|--------|------------------|-----|------|-----------------------------------|-----|-------------|---|
| 1.6 (K4M 788) | | Gasolina | FWD | 1598 | 77 | 105 | 06.05-02.08 | ■ |
| 1.6 | | Gasolina | FWD | 1598 | 79 | 107 | 05.06-01.11 | ■ |
| 1.6 16V (K4M 760) | | Gasolina | FWD | 1598 | 82 | 112 | 01.06-06.08 | ■ |
| 1.6 16V (K4M 812) | | Gasolina | FWD | 1598 | 82 | 112 | 01.06-06.08 | ■ |
| 1.6 16V (K4M 813) | | Gasolina | FWD | 1598 | 82 | 112 | 01.06-06.08 | ■ |
| 1.6 16V (BM0C, CM0C) (K4M 760) | -05/05 | Gasolina | FWD | 1598 | 83 | 113 | 11.02-02.08 | ■ |
| 2.0 16V (BM0U, CM0U) (F4R 770) | | Gasolina | FWD | 1998 | 99 | 135 | 11.02-02.08 | ■ |
| 2.0 16V Turbo (F4R 776) | | Gasolina | FWD | 1998 | 120 | 163 | 05.04-02.08 | ■ |
| 1.6 BiFuel (K4M 788) | | Gasol./Gas (LPG) | FWD | 1598 | 77 | 105 | 06.05-02.08 | ■ |
| 1.6 Flex-Fuel (K4M 788) | | Gasol./Etanol | FWD | 1598 | 77 | 105 | 01.07-02.08 | ■ |
| 1.9 dCi (F9Q 808) | | Diesel | FWD | 1870 | 66 | 90 | 11.02-12.05 | ■ |
| 1.9 dCi (F9Q 808) | | Diesel | FWD | 1870 | 68 | 92 | 03.04-08.06 | ■ |
| 1.9 dCi (F9Q 804) | | Diesel | FWD | 1870 | 81 | 110 | 05.05-02.08 | ■ |
| 1.9 dCi (F9Q 818) | | Diesel | FWD | 1870 | 81 | 110 | 05.05-02.08 | ■ |
| 1.9 dCi (F9Q 804) | | Diesel | FWD | 1870 | 85 | 115 | 11.02-02.08 | ■ |
| 1.9 dCi (F9Q 816) | | Diesel | FWD | 1870 | 85 | 115 | 11.02-02.08 | ■ |
| 1.9 dCi (F9Q 818) | | Diesel | FWD | 1870 | 85 | 115 | 11.02-02.08 | ■ |
| 1.9 dCi (BM0G, CM0G) (F9Q 800) | | Diesel | FWD | 1870 | 88 | 120 | 11.02-02.08 | ■ |
| 1.9 dCi (F9Q 803) | | Diesel | FWD | 1870 | 96 | 131 | 05.05-12.09 | ■ |
| 1.9 dCi (F9Q 804) | | Diesel | FWD | 1870 | 96 | 131 | 05.05-12.09 | ■ |
| 1.9 dCi (F9Q 816) | | Diesel | FWD | 1870 | 96 | 131 | 05.05-12.09 | ■ |
| 1.9 dCi (F9Q 818) | | Diesel | FWD | 1870 | 96 | 131 | 05.05-12.09 | ■ |
| 2.0 dCi (BM1K, CM1K) (M9R 700) | | Diesel | FWD | 1995 | 110 | 150 | 09.05-02.08 | ■ |
| 2.0 dCi (BM1K, CM1K) (M9R 722) | | Diesel | FWD | 1995 | 110 | 150 | 09.05-02.08 | ■ |
| MEGANE II (LM0/1_) 08.03- | | | | | Saloon (Compact car-C Segment) | | | |
| 1.6 | | Gasolina | FWD | 1598 | 75 | 102 | 09.03- | ■ |
| 1.6 (K4M 762) | | Gasolina | FWD | 1598 | 77 | 105 | 05.05- | ■ |
| 1.6 | | Gasolina | FWD | 1598 | 80 | 109 | 09.07-12.10 | ■ |
| 1.6 (K4M 760) | | Gasolina | FWD | 1598 | 81 | 110 | 09.03-11.08 | ■ |
| 1.6 (K4M 761) | | Gasolina | FWD | 1598 | 81 | 110 | 09.03-11.08 | ■ |
| 1.6 16V (LM1R, LM0C) (K4M 760) | | Gasolina | FWD | 1598 | 82 | 112 | 01.06- | ■ |
| 1.6 16V (LM1R, LM0C) (K4M 761) | | Gasolina | FWD | 1598 | 82 | 112 | 01.06- | ■ |
| 1.6 16V (LM1R, LM0C) (K4M 812) | | Gasolina | FWD | 1598 | 82 | 112 | 01.06- | ■ |
| 1.6 16V (LM1R, LM0C) (K4M 813) | | Gasolina | FWD | 1598 | 82 | 112 | 01.06- | ■ |
| 1.6 (K4M 760) | | Gasolina | FWD | 1598 | 83 | 113 | 09.03- | ■ |
| 1.6 (K4M 761) | | Gasolina | FWD | 1598 | 83 | 113 | 09.03- | ■ |
| 2.0 (F4R 770) | | Gasolina | FWD | 1998 | 99 | 135 | 09.03- | ■ |
| 2.0 (F4R 771) | | Gasolina | FWD | 1998 | 99 | 135 | 09.03- | ■ |
| 2.0 (F4R 770) | | Gasolina | FWD | 1998 | 101 | 138 | 04.06-11.10 | ■ |
| 1.6 Hi-Flex (LM2E, LM2M, LM24) (K4M 766) | | Gasol./Etanol | FWD | 1598 | 85 | 116 | 03.06- | ■ |
| 1.9 dCi (F9Q 808) | | Diesel | FWD | 1870 | 66 | 90 | 09.03-12.05 | ■ |
| 1.9 dCi (F9Q 808) | | Diesel | FWD | 1870 | 68 | 92 | 03.04- | ■ |
| 1.9 dCi (LM14, LM1D) (F9Q 803) | | Diesel | FWD | 1870 | 81 | 110 | 05.05- | ■ |
| 1.9 dCi (LM14, LM1D) (F9Q 804) | | Diesel | FWD | 1870 | 81 | 110 | 05.05- | ■ |
| 1.9 dCi (LM14, LM1D) (F9Q 816) | | Diesel | FWD | 1870 | 81 | 110 | 05.05- | ■ |
| 1.9 dCi (LM14, LM1D) (F9Q 818) | | Diesel | FWD | 1870 | 81 | 110 | 05.05- | ■ |
| 1.9 dCi (LM0G, LM1G, LM2C) (F9Q 800) | | Diesel | FWD | 1870 | 88 | 120 | 09.03- | ■ |
| 1.9 dCi (F9Q 803) | | Diesel | FWD | 1870 | 96 | 131 | 05.05- | ■ |

LISTA DE APLICACIONES - BUYERS GUIDE

| | | | | | | | | |
|---|-----------------------------|------------------|-----|------|--|-----|-------------|---|
| 1.9 dCi (F9Q 804) | | Diesel | FWD | 1870 | 96 | 131 | 05.05- | ■ |
| 2.0 dCi (M9R 700) | | Diesel | FWD | 1995 | 110 | 150 | 09.05- | ■ |
| 2.0 dCi (M9R 722) | | Diesel | FWD | 1995 | 110 | 150 | 09.05- | ■ |
| MEGANE II Hatchback Van (KM0/2_) 08.03-07.09 | | | | | Hatchback Van (Compact car-C Segment) | | | |
| 1.5 dCi (K9K 722) | | Diesel | FWD | 1461 | 60 | 82 | 08.03-02.08 | ■ |
| 1.5 dCi (K9K 724) | | Diesel | FWD | 1461 | 63 | 86 | 04.05-02.08 | ■ |
| 1.5 dCi (K9K 728) | | Diesel | FWD | 1461 | 74 | 101 | 08.03-02.08 | ■ |
| 1.5 dCi (K9K 734) | | Diesel | FWD | 1461 | 76 | 103 | 01.07-03.09 | ■ |
| 1.5 dCi (K9K 732) | | Diesel | FWD | 1461 | 78 | 106 | 05.05-02.08 | ■ |
| MEGANE Kombi van (KA_) 02.00-07.03 | | | | | Estate Van (Compact car-C Segment) | | | |
| 1.6 (KA0B, KA04) (K4M 700) | vehicles with ABS | Gasolina | FWD | 1598 | 79 | 107 | 04.01-07.03 | ■ |
| 1.6 (KA0B, KA04) (K4M 701) | vehicles with ABS | Gasolina | FWD | 1598 | 79 | 107 | 04.01-07.03 | ■ |
| 1.6 (KA0B, KA04) (K4M 708) | vehicles with ABS | Gasolina | FWD | 1598 | 79 | 107 | 04.01-07.03 | ■ |
| 1.6 (KA0B, KA04) (K4M 709) | vehicles with ABS | Gasolina | FWD | 1598 | 79 | 107 | 04.01-07.03 | ■ |
| 1.8 (KA1M) (F4P 722) | | Gasolina | FWD | 1783 | 85 | 116 | 04.01-07.03 | ■ |
| 1.6 BiFuel (KA0B) (K4M 712) | vehicles with ABS | Gasol./Gas (LPG) | FWD | 1598 | 79 | 107 | 04.01-07.03 | ■ |
| 1.6 BiFuel (KA04) (K4M 704) | vehicles with ABS | Gasol./Gas (LPG) | FWD | 1598 | 80 | 109 | 04.01-07.03 | ■ |
| 1.9 dTi (KA1U) (F9Q 744) | | Diesel | FWD | 1870 | 59 | 80 | 04.01-07.03 | ■ |
| 1.9 dCi (KA05) (F9Q 732) | | Diesel | FWD | 1870 | 75 | 102 | 04.01-07.03 | ■ |
| 1.9 dCi (KA05) (F9Q 733) | | Diesel | FWD | 1870 | 75 | 102 | 04.01-07.03 | ■ |
| 1.9 dCi (KA05) (F9Q 732) | | Diesel | FWD | 1870 | 77 | 105 | 04.01-07.03 | ■ |
| 1.9 dCi (KA05) (F9Q 733) | | Diesel | FWD | 1870 | 77 | 105 | 04.01-07.03 | ■ |
| MEGANE Scenic (JA0/1_) 10.96-12.01 | | | | | MPV (Compact MPV-M1 Segment) | | | |
| 1.4 i (JA0E) (E7J 764) | 10/98- | Gasolina | FWD | 1390 | 55 | 75 | 01.97-09.99 | ■ |
| 1.6 i (JA0L) (K7M 720) | 10/98-, Manual Transmission | Gasolina | FWD | 1598 | 55 | 75 | 01.97-09.99 | ■ |
| 1.6 e (JA0F) (K7M 702) | 10/98-, Manual Transmission | Gasolina | FWD | 1598 | 66 | 90 | 10.96-10.99 | ■ |
| 1.6 e (JA0F) (K7M 703) | 10/98-, Manual Transmission | Gasolina | FWD | 1598 | 66 | 90 | 10.96-10.99 | ■ |
| 1.6 16V (JA0B, JA04, JA11, JA00) (K4M 700) | | Gasolina | FWD | 1598 | 79 | 107 | 04.98-10.99 | ■ |
| 1.6 16V (JA0B, JA04, JA11, JA00) (K4M 701) | | Gasolina | FWD | 1598 | 79 | 107 | 04.98-10.99 | ■ |
| 1.6 16V (JA0B, JA04, JA11, JA00) (K4M 704) | | Gasolina | FWD | 1598 | 79 | 107 | 04.98-10.99 | ■ |
| 1.6 16V (JA0B, JA04, JA11, JA00) (K4M 708) | | Gasolina | FWD | 1598 | 79 | 107 | 04.98-10.99 | ■ |
| 2.0 i (JA02, JA0G) (F3R 791) | | Gasolina | FWD | 1998 | 80 | 109 | 01.99-09.99 | ■ |
| 2.0 i (JA02, JA0G) (F3R 796) | | Gasolina | FWD | 1998 | 80 | 109 | 01.99-09.99 | ■ |
| 2.0 i (JA0G) (F3R 750) | 10/98- | Gasolina | FWD | 1998 | 84 | 114 | 01.97-09.99 | ■ |
| 2.0 i (JA0G) (F3R 751) | 10/98- | Gasolina | FWD | 1998 | 84 | 114 | 01.97-09.99 | ■ |
| 2.0 RXE 4x4 (F3R 750) | 10/98- | Gasolina | 4WD | 1998 | 84 | 114 | 05.97-10.99 | ■ |
| 1.9 D (JA0J) (F8Q 790) | 10/98- | Diesel | FWD | 1870 | 47 | 64 | 03.97-09.99 | ■ |
| 1.9 dT (JA0K, JA0Y) (F8Q 784) | 10/98- | Diesel | FWD | 1870 | 66 | 90 | 01.97-09.99 | ■ |
| 1.9 dT (JA0K, JA0Y) (F8Q 786) | 10/98- | Diesel | FWD | 1870 | 66 | 90 | 01.97-09.99 | ■ |
| 1.9 dTi (JA0N) (F9Q 730) | 10/98- | Diesel | FWD | 1870 | 72 | 98 | 04.97-09.99 | ■ |
| 1.9 dTi (JA0N) (F9Q 734) | 10/98- | Diesel | FWD | 1870 | 72 | 98 | 04.97-09.99 | ■ |
| MEGANE Scenic VAN (JA0/1_) 10.96-12.01 | | | | | Box Body/MPV (Compact MPV-M1 Segment) | | | |
| 1.9 DT (JA0K) | 10/98- | Diesel | FWD | 1870 | 66 | 90 | 01.97-09.99 | ■ |
| 1.9 dTi (JA0N) | 10/98- | Diesel | FWD | 1870 | 72 | 98 | 04.97-09.99 | ■ |
| SCÉNIC (JA0/1_, FA0_) 08.99-07.10 | | | | | MPV (Compact MPV-M1 Segment) | | | |
| 1.4 16V (JA0D, JA1H, Ja0W, JA10) (K4J 714) | 08/02-, -09/02 | Gasolina | FWD | 1390 | 70 | 95 | 09.99-08.03 | ■ |
| 1.4 16V (JA0D, JA1H, Ja0W, JA10) (K4J 750) | 08/02-, -09/02 | Gasolina | FWD | 1390 | 70 | 95 | 09.99-08.03 | ■ |
| 1.6 (K4M 708) | | Gasolina | FWD | 1598 | 75 | 102 | 03.01-08.03 | ■ |

LISTA DE APLICACIONES - BUYERS GUIDE

| | | | | | | | | |
|---|--------|-------------------|-----|------|-------------------------------------|-----|-------------|---|
| 1.6 (K4M 709) | | Gasolina | FWD | 1598 | 75 | 102 | 03.01-08.03 | ■ |
| 1.6 (JA00, JA16, JA15, JA19, JA1V, JA2B, JA2C, JA0B,... (K4M 700) | | Gasolina | FWD | 1598 | 79 | 107 | 09.99-09.03 | ■ |
| 1.6 (JA00, JA16, JA15, JA19, JA1V, JA2B, JA2C, JA0B,... (K4M 706) | | Gasolina | FWD | 1598 | 79 | 107 | 09.99-09.03 | ■ |
| 1.6 (JA00, JA16, JA15, JA19, JA1V, JA2B, JA2C, JA0B,... (K4M 707) | | Gasolina | FWD | 1598 | 79 | 107 | 09.99-09.03 | ■ |
| 1.6 (JA00, JA16, JA15, JA19, JA1V, JA2B, JA2C, JA0B,... (K4M 776) | | Gasolina | FWD | 1598 | 79 | 107 | 09.99-09.03 | ■ |
| 1.6 (JA00) | | Gasolina | FWD | 1598 | 81 | 110 | 06.01-09.03 | ■ |
| 1.6 16V | | Gasolina | FWD | 1598 | 85 | 116 | 09.99-08.03 | ■ |
| 1.8 16V (JA12, JA1R, JA1M, JA1A) (F4P 720) | -04/01 | Gasolina | FWD | 1783 | 85 | 115 | 01.01-08.03 | ■ |
| 1.8 16V (JA12, JA1R, JA1M, JA1A) (F4P 722) | -04/01 | Gasolina | FWD | 1783 | 85 | 115 | 01.01-08.03 | ■ |
| 1.8 4x4 (F4P 722) | | Gasolina | 4WD | 1783 | 85 | 116 | 07.00-04.01 | ■ |
| 2.0 16V (JA1B, JA1D, JA0C) (F4R 740) | | Gasolina | FWD | 1998 | 102 | 139 | 07.00-08.03 | ■ |
| 2.0 16V (JA1B, JA1D, JA0C) (F4R 741) | | Gasolina | FWD | 1998 | 102 | 139 | 07.00-08.03 | ■ |
| 2.0 16V (JA1B, JA1D, JA0C) (F4R 746) | | Gasolina | FWD | 1998 | 102 | 139 | 07.00-08.03 | ■ |
| 2.0 16V (JA1D, JA17) (F4R 740) | | Gasolina | FWD | 1998 | 103 | 140 | 09.99-08.03 | ■ |
| 2.0 16V (JA1D, JA17) (F4R 741) | | Gasolina | FWD | 1998 | 103 | 140 | 09.99-08.03 | ■ |
| 2.0 16V (JA1D, JA17) (F4R 744) | | Gasolina | FWD | 1998 | 103 | 140 | 09.99-08.03 | ■ |
| 2.0 16V (JA1D, JA17) (F4R 747) | | Gasolina | FWD | 1998 | 103 | 140 | 09.99-08.03 | ■ |
| 1.6 BiFuel | | Gasol./G as (LPG) | FWD | 1598 | 75 | 102 | 03.01-08.03 | ■ |
| 1.6 BiFuel (JA04) (K4M 704) | | Gasol./G as (LPG) | FWD | 1598 | 79 | 107 | 09.99-04.01 | ■ |
| 1.6 BiFuel (JA04) (K4M 712) | | Gasol./G as (LPG) | FWD | 1598 | 79 | 107 | 09.99-04.01 | ■ |
| 1.9 D (JA0J, FA0J) (F8Q 788) | | Diesel | FWD | 1870 | 47 | 64 | 09.99-03.01 | ■ |
| 1.9 D (JA0J, FA0J) (F8Q 790) | | Diesel | FWD | 1870 | 47 | 64 | 09.99-03.01 | ■ |
| 1.9 dTi (JA1U) (F9Q 744) | | Diesel | FWD | 1870 | 59 | 80 | 02.01-08.03 | ■ |
| 1.9 dTi (JA0N) (F9Q 731) | | Diesel | FWD | 1870 | 72 | 98 | 09.99-08.03 | ■ |
| 1.9 dTi (JA0N) (F9Q 734) | | Diesel | FWD | 1870 | 72 | 98 | 09.99-08.03 | ■ |
| 1.9 dTi (JA0N) (F9Q 736) | | Diesel | FWD | 1870 | 72 | 98 | 09.99-08.03 | ■ |
| 1.9 dCi RX4 (F9Q 732) | | Diesel | 4WD | 1870 | 74 | 101 | 12.02-08.03 | ■ |
| 1.9 dCi RX4 (F9Q 748) | | Diesel | 4WD | 1870 | 74 | 101 | 12.02-08.03 | ■ |
| 1.9 dCi RX4 (F9Q 796) | | Diesel | 4WD | 1870 | 74 | 101 | 12.02-08.03 | ■ |
| 1.9 dCi (JA05, JA1F) (F9Q 732) | | Diesel | FWD | 1870 | 75 | 102 | 09.99-08.03 | ■ |
| 1.9 dCi (JA05, JA1F) (F9Q 733) | | Diesel | FWD | 1870 | 75 | 102 | 09.99-08.03 | ■ |
| 1.9 dCi RX4 (F9Q 740) | | Diesel | 4WD | 1870 | 75 | 102 | 11.00-08.03 | ■ |
| SCÉNIC II (JM0/1_) 06.03- | | | | | MPV (Compact MPV-M1 Segment) | | | |
| 1.4 (JM0B, JM0H, JM1A) (K4J 730) | | Gasolina | FWD | 1390 | 72 | 98 | 06.03-11.08 | ■ |
| 1.4 (JM0B, JM0H, JM1A) (K4J 740) | | Gasolina | FWD | 1390 | 72 | 98 | 06.03-11.08 | ■ |
| 1.4 (JM0B, JM0H, JM1A) (K4J 770) | | Gasolina | FWD | 1390 | 72 | 98 | 06.03-11.08 | ■ |
| 1.6 (K4M 788) | | Gasolina | FWD | 1598 | 77 | 105 | 06.06-11.08 | ■ |
| 1.6 16V (JM1R) (K4M 706) | | Gasolina | FWD | 1598 | 82 | 112 | 10.05-11.08 | ■ |
| 1.6 16V (JM1R) (K4M 766) | | Gasolina | FWD | 1598 | 82 | 112 | 10.05-11.08 | ■ |
| 1.6 16V (JM1R) (K4M 812) | | Gasolina | FWD | 1598 | 82 | 112 | 10.05-11.08 | ■ |
| 1.6 16V (JM1R) (K4M 813) | | Gasolina | FWD | 1598 | 82 | 112 | 10.05-11.08 | ■ |
| 1.6 (JM0C, JM0J, JM1B) (K4M 761) | | Gasolina | FWD | 1598 | 83 | 113 | 06.03-10.06 | ■ |
| 1.6 (JM0C, JM0J, JM1B) (K4M 782) | | Gasolina | FWD | 1598 | 83 | 113 | 06.03-10.06 | ■ |
| 1.6 Hi-Flex (K4M 766) | | Gasol./Et anol | FWD | 1598 | 81 | 110 | 03.05-07.10 | ■ |
| 1.5 dCi (JM0F) (K9K 722) | | Diesel | FWD | 1461 | 60 | 82 | 06.03-05.06 | ■ |
| 1.5 dCi (JM1F) (K9K 724) | | Diesel | FWD | 1461 | 63 | 86 | 05.05-11.08 | ■ |
| 1.5 dCi (JM02, JM13) (K9K 728) | | Diesel | FWD | 1461 | 74 | 101 | 11.03-08.05 | ■ |

LISTA DE APLICACIONES - BUYERS GUIDE

| | | | | | | | |
|--|----------|-----|------|--|-----|-------------|---|
| 1.5 dCi (JM02, JM13) (K9K 729) | Diesel | FWD | 1461 | 74 | 101 | 11.03-08.05 | ■ |
| 1.5 dCi (JM16) (K9K 728) | Diesel | FWD | 1461 | 76 | 103 | 01.07-11.08 | ■ |
| 1.5 dCi (JM16) (K9K 734) | Diesel | FWD | 1461 | 76 | 103 | 01.07-11.08 | ■ |
| 1.5 dCi (JM1E, JM16) (K9K 732) | Diesel | FWD | 1461 | 78 | 106 | 05.05-11.08 | ■ |
| 1.5 dCi (JM1E, JM16) (K9K 734) | Diesel | FWD | 1461 | 78 | 106 | 05.05-11.08 | ■ |
| SCÉNIC VAN (FA0_, JA0/1_) 08.99-07.10 | | | | Box Body/MPV (Compact MPV-M1 Segment) | | | |
| 1.9 (FA0J) | Diesel | FWD | 1870 | 47 | 64 | 09.99-02.01 | ■ |
| 1.9 dTi (JA0N) | Diesel | FWD | 1870 | 72 | 98 | 09.99-04.01 | ■ |
| TWINGO II (CN0_) 03.07- | | | | Hatchback (City car-A Segment) | | | |
| 1.6 RS (CN0N, CN0R, CN0S) (K4M 854) | Gasolina | FWD | 1598 | 98 | 133 | 05.08-09.14 | ■ |
| WIND (E4M_) 07.10- | | | | Convertible (Compact car-C Segment) | | | |
| 1.2 (E4MF) (D4F 782) | Gasolina | FWD | 1149 | 74 | 101 | 07.10- | ■ |
| 1.2 TCe 100 (E4MF) (D4F 780) | Gasolina | FWD | 1149 | 75 | 102 | 02.11- | ■ |
| 1.6 (E4MB, E4MC) (K4M 854) | Gasolina | FWD | 1598 | 98 | 133 | 07.10- | ■ |