

LISTA DE APLICACIONES - BUYERS GUIDE

78BD8015-2



Weight: 21.200

O.E.M.	MAKE
441 615 301 AA	VW

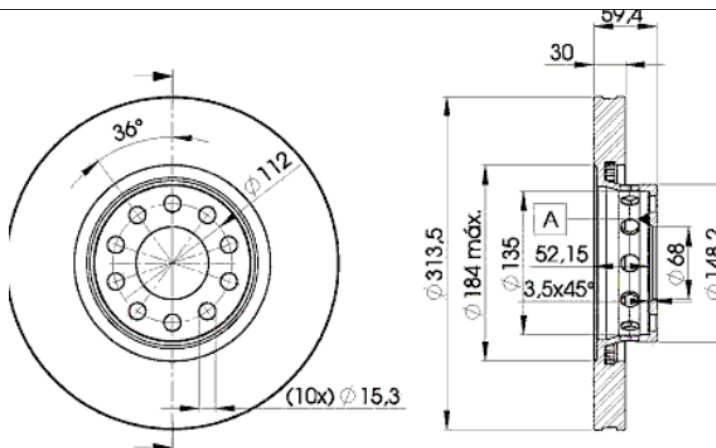

78BD8015-2



Ø314x30x59

MAKE
AUDI



Trac.	CC	Kw	CV		
					Front / Rear

AUDI

100 IV C4 (4A2) 12.90-07.94

Saloon (Executive car-E Segment)

S4 Turbo quattro (AAN)	Gasolina	4WD	2226	169	230	08.91-07.94	■
S4 V8 quattro (ABH)	Gasolina	4WD	4172	206	280	10.92-07.94	■
S4 V8	Gasolina	FWD	4172	213	290	03.94-06.94	■

100 IV C4 Avant (4A5) 12.90-11.94

Estate (Executive car-E Segment)

S4 Turbo quattro (AAN)	Gasolina	4WD	2226	169	230	09.91-07.94	■
S4 V8 quattro (ABH)	Gasolina	4WD	4172	206	280	10.92-07.94	■
S4 V8	Gasolina	FWD	4172	213	290	03.94-06.94	■

A6 C4 Avant (4A5) 06.94-01.98

Estate (Executive car-E Segment)

S6 Turbo quattro (AAN)	Gasolina	4WD	2226	169	230	06.94-12.97	■
S6 4.2 quattro (AEC)	Gasolina	4WD	4172	213	290	06.94-12.97	■
S6 Plus quattro (AHK)	Gasolina	4WD	4172	240	326	04.96-12.97	■

A6 C4 (4A2) 06.94-01.98

Saloon (Executive car-E Segment)

S6 Turbo quattro (AAN)	Gasolina	4WD	2226	169	230	06.94-10.97	■
S6 4.2 quattro (AEC)	Gasolina	4WD	4172	213	290	06.94-10.97	■
S6 Plus quattro (AHK)	Gasolina	4WD	4172	240	326	04.96-10.97	■

A8 D2 (4D2, 4D8) 03.94-12.05

Saloon (Luxury car-F Segment)

2.8 (AEJ)		Gasolina	FWD	2771	120	163	07.95-03.96	■
2.8 quattro (AEJ)		Gasolina	4WD	2771	120	163	07.95-03.96	■
2.8 (AAH)		Gasolina	FWD	2771	128	174	03.94-03.96	■
2.8 quattro (AAH)	09/94-	Gasolina	4WD	2771	128	174	03.94-03.96	■
2.8 (ACK)	-12/98	Gasolina	FWD	2771	142	193	04.96-09.02	■
2.8 (ALG)	-12/98	Gasolina	FWD	2771	142	193	04.96-09.02	■

LISTA DE APLICACIONES - BUYERS GUIDE

2.8 (AMX)	-12/98	Gasolina	FWD	2771	142	193	04.96-09.02	■
2.8 (APR)	-12/98	Gasolina	FWD	2771	142	193	04.96-09.02	■
2.8 (AQD)	-12/98	Gasolina	FWD	2771	142	193	04.96-09.02	■
2.8 quattro (ACK)	-12/98	Gasolina	4WD	2771	142	193	04.96-09.02	■
2.8 quattro (ALG)	-12/98	Gasolina	4WD	2771	142	193	04.96-09.02	■
2.8 quattro (AMX)	-12/98	Gasolina	4WD	2771	142	193	04.96-09.02	■
2.8 quattro (APR)	-12/98	Gasolina	4WD	2771	142	193	04.96-09.02	■
2.8 quattro (AQD)	-12/98	Gasolina	4WD	2771	142	193	04.96-09.02	■
3.7 (AEW)		Gasolina	FWD	3697	169	230	07.95-12.98	■
3.7 quattro (AEW)		Gasolina	4WD	3697	169	230	07.95-11.98	■
3.7 quattro (AKJ)		Gasolina	4WD	3697	169	230	07.95-11.98	■
3.7 (AKC)		Gasolina	FWD	3697	191	260	11.98-09.02	■
3.7 (AQG)		Gasolina	FWD	3697	191	260	11.98-09.02	■
4.2 quattro (AEM)		Gasolina	4WD	4172	180	245	03.94-07.96	■
4.2 quattro		Gasolina	4WD	4172	210	286	07.95-09.98	■
4.2 quattro (ABZ)		Gasolina	4WD	4172	220	299	03.94-11.98	■
4.2 quattro (AKG)		Gasolina	4WD	4172	220	299	03.94-11.98	■
S8 quattro (AHC)		Gasolina	4WD	4172	250	340	07.96-06.99	■
S8 quattro (AKH)		Gasolina	4WD	4172	250	340	07.96-06.99	■
2.5 TDI (AFB)	09/98-, -12/98	Diesel	FWD	2496	110	150	01.97-04.00	■
2.5 TDI (AKN)	09/98-, -12/98	Diesel	FWD	2496	110	150	01.97-04.00	■
2.5 TDI quattro (AFB)	09/98-, -12/98	Diesel	4WD	2496	110	150	07.97-04.00	■
2.5 TDI quattro (AKN)	09/98-, -12/98	Diesel	4WD	2496	110	150	07.97-04.00	■