

LISTA DE APLICACIONES - BUYERS GUIDE

78BD8067-1



Weight: 6.670

O.E.M.	MAKE
MR 418 067	mitsubishi

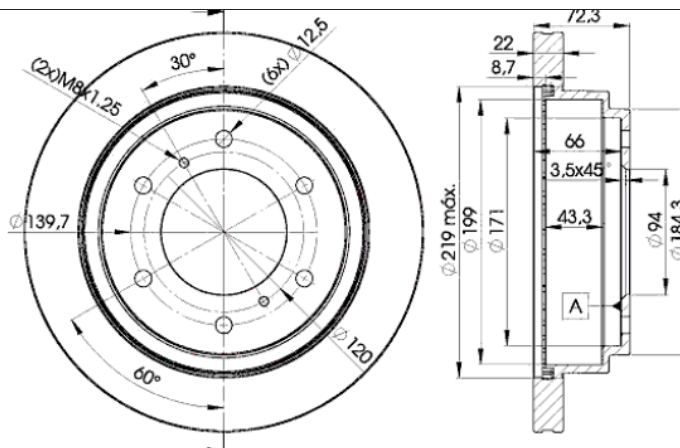

78BD8067-1

E1 90R-02C0656/0123



Ø300x22x72.5

MAKE
mitsubishi
mitsubishi (GAC)



Trac.	CC	Kw	CV	
				Front / Rear

mitsubishi

PAJERO II / MONTERO / SHOGUN (V3_W) 04.00-09.07

Closed Off-Road Vehicle (Luxury Crossover SUV-J Segment)

3.2 DiD 4WD (4M41)	Diesel	4WD	3200	118	160	05.05-09.07	■
3.2 DiD 4WD (4M41)	Diesel	4WD	3200	121	165	04.00-09.07	■

PAJERO II CLASSIC / MONTERO CLASSIC / SHOGUN CLASSIC (V2_W, V6_W, V7_W) 07.01-

Closed Off-Road Vehicle (Luxury Crossover SUV-J Segment)

3.0 (V72W, V83W, V93W)	Gasolina	4WD	2972	131	178	09.06-	■
3.0 ZR (V72W)	Gasolina	4WD	2972	132	179	08.03-	■
3.8 A las 4 ruedas (V77W) (6G75)	Gasolina	4WD	3828	160	218	06.02-	■
3.8 A las 4 ruedas (V67W)	Gasolina	4WD	3828	184	250	09.06-	■
2.5 TD (V24W) (4D56-T)	Diesel	4WD	2477	85	115	07.01-	■
3.2 DI-D	Diesel	RWD	3200	118	160	05.05-	■
3.2 DI-D (V68W, V78W) (4M41)	Diesel	4WD	3200	125	170	09.06-	■

PAJERO III / MONTERO / SHOGUN (V7_W, V6_W) 01.99-09.07

Closed Off-Road Vehicle (Luxury Crossover SUV-J Segment)

2.4	Gasolina	4WD	2351	82	112	10.01-01.07	■
3.0 V6 24V	Gasolina	4WD	2972	133	181	04.00-12.06	■
3.5 (V75W)	Gasolina	4WD	3497	140	190	04.00-04.04	■
3.5 i (V75W)	Gasolina	4WD	3497	162	220	09.03-10.06	■
3.8 (V77W)	Gasolina	4WD	3828	150	204	09.03-10.06	■
3.8 4WD (6G75)	Gasolina	4WD	3828	160	218	09.02-12.06	■
3.8 (V67W) (6G75)	Gasolina	4WD	3828	184	250	03.03-01.07	■
2.5 TDi 4WD	Diesel	4WD	2477	98	133	07.01-09.07	■
2.8 TD 4WD (V76W)	Diesel	4WD	2835	92	125	05.00-07.02	■
3.2 DI-D (V68W) (4M41)	Diesel	4WD	3200	118	160	04.00-12.06	■
3.2 DI-D	Diesel	4WD	3200	129	175	04.00-01.07	■

LISTA DE APLICACIONES - BUYERS GUIDE

PAJERO III / MONTERO / SHOGUN (V6_W, V7_W) 02.00-12.06					Open Off-Road Vehicle (Luxury Crossover SUV-J Segment)			
2.4		Gasolina	4WD	2351	82	112	10.01-12.06	■
3.0 (V73W) (6G72 (SOHC 24V))		Gasolina	4WD	2972	125	170	10.01-12.06	■
3.5 GDi 4WD (V75W)		Gasolina	4WD	3497	125	170	10.01-12.06	■
3.5 V6 GDI (V65W, V75W) (6G74 (GDI))		Gasolina	4WD	3497	149	203	04.00-12.06	■
3.8 i 4WD (V60/V70)		Gasolina	4WD	3828	149	203	09.03-10.06	■
2.5 TDi (V64W, V74W) (4D56-T)		Diesel	4WD	2477	73	99	04.00-12.06	■
2.5 TDi (V64W, V74W) (4D56-T)		Diesel	4WD	2477	85	115	09.01-12.06	■
3.2 DI-D (V68W, V78W) (4M41)		Diesel	4WD	3200	118	160	10.01-12.06	■
3.2 DI-D (V68W, V78W) (4M41)		Diesel	4WD	3200	121	165	04.00-12.06	■
PAJERO IV / MONTERO / SHOGUN (V9_, V8_, V8_V) 11.06-					Closed Off-Road Van (Luxury Crossover SUV-J Segment)			
3.2 DI-D 4WD (V88W, V98W) (4M41)		Diesel	4WD	3200	140	190	02.07-	■
3.2 TD 4WD (V88V, V98V) (4M41)		Diesel	4WD	3200	147	200	01.10-	■
PAJERO IV FULL / MONTERO / SHOGUN (V8_W, V9_W) 10.06-					SUV (Luxury Crossover SUV-J Segment)			
3.0 4WD (6G72 (SOHC 24V))		Gasolina	4WD	2972	128	174	08.14-	■
3.0 4WD (6G72 (SOHC 24V))		Gasolina	4WD	2972	130	177	09.09-	■
3.0 4WD (V83W, V93W) (6G72 (SOHC 24V))		Gasolina	4WD	2972	131	178	02.07-	■
3.0 4WD		Gasolina	4WD	2972	135	184	01.07-	■
3.5 V6 4WD		Gasolina	4WD	3497	139	189	09.09-	■
3.8 Mivec 4WD (6G75)		Gasolina	4WD	3828	172	234	06.12-	■
3.8 4WD		Gasolina	4WD	3828	174	237	01.07-12.07	■
3.8 i 4WD (V97W, V87W) (6G75)		Gasolina	4WD	3828	175	238	01.09-	■
3.8 4WD (6G75)		Gasolina	4WD	3828	179	243	01.09-12.13	■
3.8 V6 (6G75)		Gasolina	4WD	3828	180	245	02.10-	■
3.2 DI-D 4WD (4M41)		Diesel	4WD	3200	121	165	11.08-	■
3.2 DI-D (4M41)		Diesel	4WD	3200	123	167	02.07-	■
3.2 DI-D 4WD (V98W, V88W) (4M41)		Diesel	4WD	3200	140	190	02.07-	■
3.2 4WD (V98W) (4M41)		Diesel	4WD	3200	141	192	10.16-	■
3.2 DI-D 4WD (V98W, V88W) (4M41)		Diesel	4WD	3200	147	200	01.09-	■
3.2 DI-D 4WD (V98W)		Diesel	4WD	3200	149	203	01.12-	■
PAJERO SPORT II / PAJERO DAKAR / CHALLENGER / MONTERO SPORT / NATIVA (KH_, KG_) 01.08-					Closed Off-Road Vehicle (Executive SUV-J Segment)			
3.2 DI-D 4WD		Diesel	4WD	3200	132	180	11.13-12.18	■
PAJERO SPORT / G-WAGON / MONTERO SPORT / CHALLENGER (K7_, K9_) 07.96-					Closed Off-Road Vehicle (Executive SUV-J Segment)			
2.5 TD 4WD (K94W) (4D56-T)		Diesel	4WD	2477	83	112	11.97-10.98	■
MITSUBISHI (GAC)								
PAJERO 01.04-12.14					SUV (Executive SUV-J Segment)			
3.0 A las 4 ruedas (CFA2031)		Gasolina	4WD	2972	133	181	12.04-12.06	■
3.8 A las 4 ruedas (CFA5037)		Gasolina	4WD	3828	150	204	12.04-12.05	■