

LISTA DE APLICACIONES - BUYERS GUIDE

78BD8078-1



8 424073 148780

Weight: 4.170

O.E.M.	MAKE
77 00 758 195	RENAULT
77 00 758 287	RENAULT
77 00 780 077	RENAULT
77 00 780 078	RENAULT
77 00 829 553	RENAULT
77 01 204 294	RENAULT

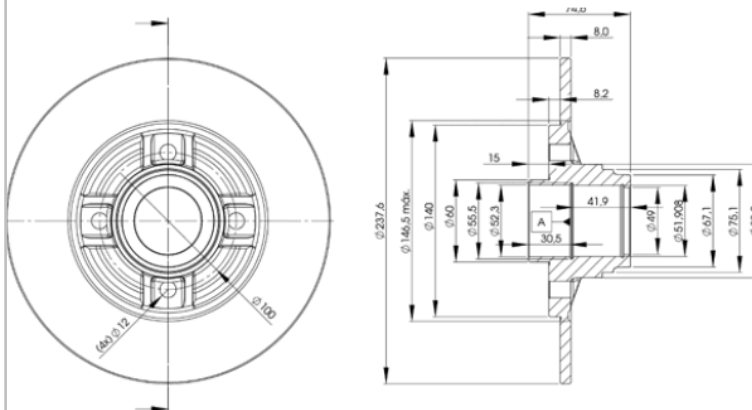

78BD8078-1



Ø237.6x8x74.6

MAKE
RENAULT



Trac.	CC	Kw	CV	
				Front / Rear

RENAULT

CLIO II (BB_, CB_) 03.98-

Hatchback (Supermini car-B Segment)

1.6 (BB01, BB1J) (K4M 740)		Gasolina	FWD	1598	81	110	06.99-02.09	■
1.6 (BB01, BB1J) (K4M 748)		Gasolina	FWD	1598	81	110	06.99-02.09	■
2.0 16V (CB0M, CB1G)		Gasolina	FWD	1998	126	172	06.01-05.05	■
1.6 Flex (K4M 740)		Gasol./Etanol	FWD	1598	81	110	05.00-12.06	■
1.6 Flex (K4M 748)		Gasol./Etanol	FWD	1598	81	110	05.00-12.06	■
1.6 Hi-Flex (CB0H) (K4M 748)		Gasol./Etanol	FWD	1598	86	117	01.05-02.10	■
1.5 dCi (BB3N, CB3N) (K9K 718)		Diesel	FWD	1461	62	84	02.07-06.09	■
1.5 dCi (K9K 712)		Diesel	FWD	1461	74	100	10.03-04.05	■

MEGANE (BA0/1_) 08.95-12.04

Hatchback (Compact car-C Segment)

2.0 16V (BA0H) (F7R 710)	-10/02	Gasolina	FWD	1998	108	147	07.96-08.03	■
2.0 16V (BA0H) (F7R 714)	-10/02	Gasolina	FWD	1998	108	147	07.96-08.03	■
1.6 LPG (K4M 704)		Gasol./Gas (LPG)	FWD	1598	80	109	10.00-08.02	■
1.6 LPG (K4M 712)		Gasol./Gas (LPG)	FWD	1598	80	109	10.00-08.02	■
1.9 DTI (F9Q 730)		Diesel	FWD	1870	60	82	02.00-09.00	■
1.9 dCi (F9Q 732)		Diesel	FWD	1870	77	105	03.99-08.03	■
1.9 dCi (F9Q 738)		Diesel	FWD	1870	77	105	03.99-08.03	■

MEGANE Classic (LA0/1_) 09.96-08.08

Saloon (Compact car-C Segment)

2.0 i (LA0G) (F3R 750)		Gasolina	FWD	1998	80	109	03.99-08.03	■
2.0 i (LA0G) (F3R 751)		Gasolina	FWD	1998	80	109	03.99-08.03	■
2.0 i (LA0G) (F3R 752)		Gasolina	FWD	1998	80	109	03.99-08.03	■

LISTA DE APLICACIONES - BUYERS GUIDE

2.0 i (LA0G) (F3R 791)		Gasolina	FWD	1998	80	109	03.99-08.03	■
2.0 i (LA0G) (F3R 796)		Gasolina	FWD	1998	80	109	03.99-08.03	■
2.0 i (LA0G) (F3R 797)		Gasolina	FWD	1998	80	109	03.99-08.03	■
2.0 i (LA0G) (F3R 798)		Gasolina	FWD	1998	80	109	03.99-08.03	■
2.0 RT (F4R 747)		Gasolina	FWD	1998	103	140	03.01-08.03	■
2.0 RT (F5R 740)		Gasolina	FWD	1998	103	140	03.01-08.03	■
1.9 dTi (LA08, LA0N, LA0K) (F9Q 730)	04/99-	Diesel	FWD	1870	72	98	03.97-02.01	■
1.9 dTi (LA08, LA0N, LA0K) (F9Q 731)	04/99-	Diesel	FWD	1870	72	98	03.97-02.01	■
1.9 dTi (LA08, LA0N, LA0K) (F9Q 734)	04/99-	Diesel	FWD	1870	72	98	03.97-02.01	■
1.9 dTi (LA08, LA0N, LA0K) (F9Q 736)	04/99-	Diesel	FWD	1870	72	98	03.97-02.01	■
1.9 dCi (LA05) (F9Q 732)		Diesel	FWD	1870	77	105	03.99-07.03	■
1.9 dCi (LA05) (F9Q 733)		Diesel	FWD	1870	77	105	03.99-07.03	■
MEGANE Hatchback Van (SA0/1_) 08.95-07.03					Hatchback Van (Compact car-C Segment)			
1.9 dCi (F9Q 738)		Diesel	FWD	1870	59	80	10.00-07.03	■
R 19 (B/C53_) 01.88-09.94					Hatchback (Compact car-C Segment)			
1.4 Cat (B/C532) (C3J 710)	vehicles without ABS	Gasolina	FWD	1390	43	58	01.89-04.92	■
1.4 (E7J 700)		Gasolina	FWD	1390	55	75	09.90-04.92	■
1.4 (B/C53P) (C2J 772)	vehicles without ABS	Gasolina	FWD	1397	43	58	01.89-05.93	■
1.7 (B/C53B) (F3N 740)	vehicles without ABS	Gasolina	FWD	1721	54	73	09.88-04.92	■
1.7 (B/C53B) (F3N 741)	vehicles without ABS	Gasolina	FWD	1721	54	73	09.88-04.92	■
1.7 (B/C53C) (F3N 742)	vehicles without ABS	Gasolina	FWD	1721	66	90	09.88-04.92	■
1.7 (B/C53C) (F3N 743)	vehicles without ABS	Gasolina	FWD	1721	66	90	09.88-04.92	■
1.7 (F2N 720)		Gasolina	FWD	1721	68	92	09.88-04.92	■
1.7 (F2N 721)		Gasolina	FWD	1721	69	94	07.88-04.92	■
1.7 (F2N 722)		Gasolina	FWD	1721	69	94	07.88-04.92	■
1.7 (F3N 746)	vehicles with ABS	Gasolina	FWD	1721	79	107	06.89-04.92	■
1.8 16V (B/C53D) (F7P 704)	vehicles without ABS	Gasolina	FWD	1764	99	135	06.89-04.92	■
1.8 16V (F7P 700)		Gasolina	FWD	1764	101	137	06.89-04.92	■
1.8 (F3P 765)		Gasolina	FWD	1794	67	91	05.92-09.94	■
1.9 D (B/C534, B/C53J) (F8Q 706)	vehicles without ABS	Diesel	FWD	1870	47	64	09.88-04.92	■
1.9 D (B/C534, B/C53J) (F8Q 742)	vehicles without ABS	Diesel	FWD	1870	47	64	09.88-04.92	■
1.9 DT (F8Q 740)	vehicles with ABS	Diesel	FWD	1870	66	90	09.90-04.92	■
1.9 DT (F8Q 610)	vehicles with ABS	Diesel	FWD	1870	68	92	09.90-04.92	■
R 19 (L53_) 01.88-12.92					Saloon (Compact car-C Segment)			
1.4 (L532, L53P) (C2J 772)	vehicles without ABS	Gasolina	FWD	1390	43	58	07.88-04.92	■
1.4 (L532, L53P) (C3J 710)	vehicles without ABS	Gasolina	FWD	1390	43	58	07.88-04.92	■
1.7 (L53B) (F3N 740)	vehicles without ABS	Gasolina	FWD	1721	54	73	10.89-04.92	■
1.7 (L53B) (F3N 741)	vehicles without ABS	Gasolina	FWD	1721	54	73	10.89-04.92	■
1.7 (L53C) (F3N 742)	vehicles without ABS	Gasolina	FWD	1721	66	90	07.88-04.92	■
1.7 (L53C) (F3N 743)	vehicles without ABS	Gasolina	FWD	1721	66	90	07.88-04.92	■
1.7 (L533) (F2N 720)	vehicles with ABS	Gasolina	FWD	1721	68	92	09.88-12.92	■
1.7 (L533) (F2N 721)	vehicles with ABS	Gasolina	FWD	1721	68	92	09.88-12.92	■
1.7 (F2N 721)		Gasolina	FWD	1721	69	94	09.90-04.92	■
1.7 (L53F) (F3N 746)	vehicles with ABS	Gasolina	FWD	1721	79	107	08.88-12.92	■
1.8 16V (L53D) (F7P 704)	vehicles without ABS	Gasolina	FWD	1764	99	135	10.89-04.92	■
1.8 16V (F7P 700)		Gasolina	FWD	1764	101	137	06.89-08.90	■
1.9 D (L534, L53J) (F8Q 706)	vehicles without ABS	Diesel	FWD	1870	47	64	10.89-04.92	■
1.9 D (L534, L53J) (F8Q 742)	vehicles without ABS	Diesel	FWD	1870	47	64	10.89-04.92	■
1.9 DT (F8Q 740)	vehicles with ABS	Diesel	FWD	1870	66	90	09.90-04.92	■
1.9 TD (L53K) (F8Q 740)	vehicles with ABS	Diesel	FWD	1870	68	92	09.90-04.92	■

LISTA DE APLICACIONES - BUYERS GUIDE

R 19 II (D53_) 07.91-04.92					Convertible (Compact car-C Segment)			
1.7 (F2N 724)	vehicles with ABS	Gasolina	FWD	1721	55	75	07.91-04.92	■
1.7 (F3N 742)		Gasolina	FWD	1721	66	90	07.91-04.92	■
1.7 (F3N 743)		Gasolina	FWD	1721	66	90	07.91-04.92	■
1.7 (D53C) (F3N 742)	vehicles without ABS	Gasolina	FWD	1721	66	90	04.92-09.93	■
1.7 (D53C) (F3N 743)	vehicles without ABS	Gasolina	FWD	1721	66	90	04.92-09.93	■
1.7 (F3N 742)	vehicles without ABS	Gasolina	FWD	1721	70	95	07.91-04.92	■
1.7 (F3N 743)	vehicles without ABS	Gasolina	FWD	1721	70	95	07.91-04.92	■
1.8 16V (D53D) (F7P 704)	vehicles without ABS	Gasolina	FWD	1764	99	135	04.92-06.96	■
1.8 16V (D53D) (F7P 700)		Gasolina	FWD	1764	101	137	07.91-04.92	■
1.8 16V (D53D) (F7P 704)		Gasolina	FWD	1764	101	137	07.91-04.92	■
1.8 16V (D53D) (F7P 704)		Gasolina	FWD	1764	101	137	05.92-04.94	■
1.8 (D53Y) (F3P 704)	vehicles without ABS	Gasolina	FWD	1794	65	88	04.92-06.96	■
1.8 (D53Y) (F3P 705)	vehicles without ABS	Gasolina	FWD	1794	65	88	04.92-06.96	■
1.8 (D53Y) (F3P 706)	vehicles without ABS	Gasolina	FWD	1794	65	88	04.92-06.96	■
1.8 (D53Y) (F3P 707)	vehicles without ABS	Gasolina	FWD	1794	65	88	04.92-06.96	■
1.8 (D53Y) (F3P 708)	vehicles without ABS	Gasolina	FWD	1794	65	88	04.92-06.96	■
1.8 (D53Y) (F3P 760)	vehicles without ABS	Gasolina	FWD	1794	65	88	04.92-06.96	■
1.8 (853A) (F3P 706)	vehicles without ABS	Gasolina	FWD	1794	66	90	09.93-06.96	■
1.8 (853A) (F3P 760)	vehicles without ABS	Gasolina	FWD	1794	66	90	09.93-06.96	■
1.8 (D53Y) (F3P 706)		Gasolina	FWD	1794	69	94	04.92-01.96	■
1.8 (D53Y) (F3P 707)		Gasolina	FWD	1794	69	94	04.92-01.96	■
1.8 (D53V, 853F, D53C) (F3P 682)	vehicles without ABS	Gasolina	FWD	1794	79	107	07.94-06.96	■
1.8 (D53V, 853F, D53C) (F3P 764)	vehicles without ABS	Gasolina	FWD	1794	79	107	07.94-06.96	■
1.8 (D53V, 853F, D53C) (F3P 765)	vehicles without ABS	Gasolina	FWD	1794	79	107	07.94-06.96	■
1.8		Gasolina	FWD	1794	86	117	01.95-06.01	■
R 19 II (S53_) 03.92-12.95					Hatchback Van (LCVs-N1 Segment)			
1.4 (E6J 700)	vehicles with ABS	Gasolina	FWD	1390	59	80	03.92-12.95	■
1.9 D (F8Q 706)	vehicles with ABS	Diesel	FWD	1870	48	65	03.92-12.95	■
1.9 D (F8Q 742)	vehicles with ABS	Diesel	FWD	1870	48	65	03.92-12.95	■
1.9 DT (F8Q 740)	vehicles without ABS	Diesel	FWD	1870	68	92	03.92-12.95	■
R 19 II (B/C53_) 01.91-06.01					Hatchback (Compact car-C Segment)			
1.2 (E7F 730)		Gasolina	FWD	1171	44	60	05.92-09.94	■
1.4 (B/C532) (C3J 710)	vehicles without ABS	Gasolina	FWD	1390	43	58	04.92-12.95	■
1.4 (B/C535) (E7J 742)	vehicles without ABS	Gasolina	FWD	1390	55	75	01.92-12.95	■
1.4 (E6J 700)		Gasolina	FWD	1390	57	78	05.93-12.98	■
1.4 (E6J 700)	vehicles with ABS	Gasolina	FWD	1390	59	80	01.92-12.95	■
1.4 (E7J 706)	vehicles with ABS	Gasolina	FWD	1390	59	80	01.92-12.95	■
1.7 (B/C53B) (F3N 740)	vehicles without ABS	Gasolina	FWD	1721	54	73	04.92-12.95	■
1.7 (B/C53B) (F3N 741)	vehicles without ABS	Gasolina	FWD	1721	54	73	04.92-12.95	■
1.7 (B/C53C) (F3N 743)	vehicles without ABS	Gasolina	FWD	1721	66	90	04.92-12.95	■
1.7 (F3N 746)	vehicles with ABS	Gasolina	FWD	1721	79	107	05.92-09.94	■
1.8 16V (B/C53D) (F7P 704)	vehicles without ABS	Gasolina	FWD	1764	99	135	04.92-12.95	■
1.8 16V (F7P 702)		Gasolina	FWD	1764	104	141	10.96-06.01	■
1.8 (B/C53Y) (F3P 706)	vehicles without ABS	Gasolina	FWD	1794	65	88	04.92-12.95	■
1.8 (B/C53Y) (F3P 707)	vehicles without ABS	Gasolina	FWD	1794	65	88	04.92-12.95	■
1.8 (B/C53Y) (F3P 708)	vehicles without ABS	Gasolina	FWD	1794	65	88	04.92-12.95	■
1.8 (B/C53Y) (F3P 760)	vehicles without ABS	Gasolina	FWD	1794	65	88	04.92-12.95	■
1.8 (5/353A) (F3P 706)	vehicles without ABS	Gasolina	FWD	1794	66	90	04.92-12.95	■
1.8 (5/353A) (F3P 760)	vehicles without ABS	Gasolina	FWD	1794	66	90	04.92-12.95	■

LISTA DE APLICACIONES - BUYERS GUIDE

1.8 (5/353F, B/C538) (F3P 682)	vehicles without ABS	Gasolina	FWD	1794	79	107	05.94-12.95	■
1.8 (5/353F, B/C538) (F3P 765)	vehicles without ABS	Gasolina	FWD	1794	79	107	05.94-12.95	■
1.8 (B/C538) (F3P 700)	vehicles with ABS	Gasolina	FWD	1794	81	110	04.92-05.94	■
1.9 D (B/C53J) (F8Q 742)	vehicles without ABS	Diesel	FWD	1870	47	64	04.92-12.95	■
1.9 dT (B/C53T) (F8Q 744)	vehicles without ABS	Diesel	FWD	1870	66	90	04.92-12.95	■
1.9 D		Diesel	FWD	1870	75	102	07.98-06.01	■
R 19 II CHAMADE (L53_) 04.92-08.03					Saloon (Compact car-C Segment)			
1.4 (532) (C3J 710)	vehicles without ABS	Gasolina	FWD	1390	43	58	04.92-12.95	■
1.4 (C1J 742)	vehicles with ABS	Gasolina	FWD	1390	44	60	05.92-09.94	■
1.4 (C2J 772)	vehicles with ABS	Gasolina	FWD	1390	44	60	05.92-09.94	■
1.4 (C3J 710)	vehicles with ABS	Gasolina	FWD	1390	44	60	05.92-09.94	■
1.4 (L535) (E7J 742)	vehicles without ABS	Gasolina	FWD	1390	55	75	11.93-12.95	■
1.4 (E6J 700)	vehicles with ABS	Gasolina	FWD	1390	57	78	10.94-11.95	■
1.4 (E7J 706)	vehicles with ABS	Gasolina	FWD	1390	59	80	10.94-11.95	■
1.6 (K7M 703)		Gasolina	FWD	1598	66	90	10.96-06.01	■
1.7 (L53B) (F3N 740)	vehicles without ABS	Gasolina	FWD	1721	54	73	04.92-12.95	■
1.7 (L53B) (F3N 741)	vehicles without ABS	Gasolina	FWD	1721	54	73	04.92-12.95	■
1.7 (F3N 740)	vehicles without ABS	Gasolina	FWD	1721	55	75	05.92-11.95	■
1.7 (F3N 741)	vehicles without ABS	Gasolina	FWD	1721	55	75	05.92-11.95	■
1.7 (L53C) (F3N 742)	vehicles without ABS	Gasolina	FWD	1721	66	90	04.92-12.95	■
1.7 (L53C) (F3N 743)	vehicles without ABS	Gasolina	FWD	1721	66	90	04.92-12.95	■
1.7 (L533) (F2N 720)	vehicles with ABS	Gasolina	FWD	1721	68	92	01.93-08.95	■
1.7 (L533) (F2N 721)	vehicles with ABS	Gasolina	FWD	1721	68	92	01.93-08.95	■
1.8 16V (L53D) (F7P 704)	vehicles without ABS	Gasolina	FWD	1764	99	135	04.92-12.95	■
1.8 (L53Y) (F3P 704)	vehicles without ABS	Gasolina	FWD	1794	65	88	04.92-12.95	■
1.8 (L53Y) (F3P 705)	vehicles without ABS	Gasolina	FWD	1794	65	88	04.92-12.95	■
1.8 (L53Y) (F3P 706)	vehicles without ABS	Gasolina	FWD	1794	65	88	04.92-12.95	■
1.8 (L53Y) (F3P 707)	vehicles without ABS	Gasolina	FWD	1794	65	88	04.92-12.95	■
1.8 (L53Y) (F3P 708)	vehicles without ABS	Gasolina	FWD	1794	65	88	04.92-12.95	■
1.8 (L53Y) (F3P 760)	vehicles without ABS	Gasolina	FWD	1794	65	88	04.92-12.95	■
1.8 (453A/F) (F3P 706)	vehicles without ABS	Gasolina	FWD	1794	66	90	04.92-12.95	■
1.8 (453A/F) (F3P 760)	vehicles without ABS	Gasolina	FWD	1794	66	90	04.92-12.95	■
1.8 (F3P 765)		Gasolina	FWD	1794	67	91	05.92-09.94	■
1.8 (F3P 700)		Gasolina	FWD	1794	79	107	05.92-11.95	■
1.8 (F3P 706)		Gasolina	FWD	1794	79	107	05.92-11.95	■
1.8 (L53V, L538) (F3P 682)	vehicles without ABS	Gasolina	FWD	1794	79	107	05.94-12.95	■
1.8 (L538) (F3P 700)	vehicles without ABS	Gasolina	FWD	1794	81	110	04.92-05.94	■
1.9 D (L53J) (F8Q 742)	vehicles without ABS	Diesel	FWD	1870	47	64	04.92-12.97	■
1.9 dT (L53T) (F8Q 744)	vehicles without ABS	Diesel	FWD	1870	66	90	04.92-12.95	■
1.9 D (F8Q 740)		Diesel	FWD	1870	68	92	05.92-11.95	■
1.9 D (F8Q 744)		Diesel	FWD	1870	68	92	05.92-11.95	■
SUPER 5 (B/C40_) 10.84-12.96					Hatchback (Supermini car-B Segment)			
1.7 (F2N 740)		Gasolina	FWD	1721	66	90	09.88-09.90	■