

LISTA DE APLICACIONES - BUYERS GUIDE

78BD8110-2



Weight: 9.210

O.E.M.	MAKE
MB 668 108	MITSUBISHI

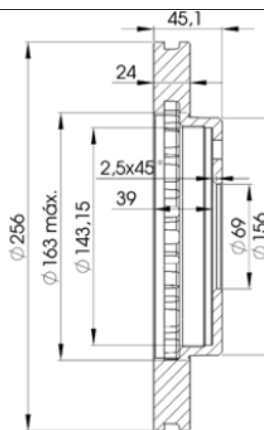
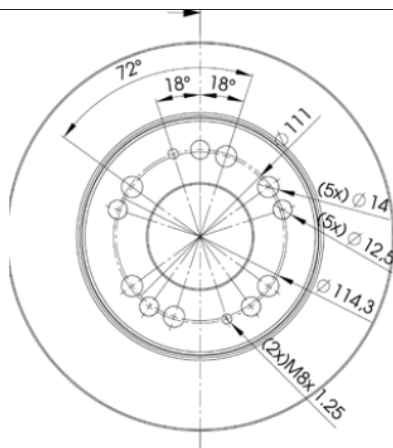

78BD8110-2

E1 90R-02C0074/0484



Ø256.5x24x45.1

MAKE
CHRYSLER
DODGE
MITSUBISHI



Trac.	CC	Kw	CV
-------	----	----	----



Front / Rear

CHRYSLER

SEBRING II (JR) 01.01-12.06

Coupe (Executive car-E Segment)

3.0	Gasolina	FWD	2972	149	203	01.01-10.05	■
-----	----------	-----	------	-----	-----	-------------	---

DODGE

STRATUS II (U.S.A.) 09.00-12.05

Coupe (Executive car-E Segment)

3.0	Gasolina	FWD	2972	149	203	09.00-12.05	■
-----	----------	-----	------	-----	-----	-------------	---

MITSUBISHI

ECLIPSE I (D2_A) 12.89-12.95

Coupe (Executive car-E Segment)

1.8 (D21A) (4G37)	Gasolina	FWD	1755	68	92	12.89-03.94	■
2.0 i 16V (D22A, D27A) (4G63 (DOHC 16V))	Gasolina	FWD	1997	110	150	04.91-11.95	■
2.0 i 16V 4WD (D22A, D27A) (4G63 (DOHC 16V))	Gasolina	4WD	1997	110	150	04.91-11.95	■
2.0 Turbo (4G63-T (DOHC 16V))	Gasolina	FWD	1997	147	200	12.89-03.94	■

ECLIPSE II 04.94-04.99

Convertible (Executive car-E Segment)

2.0 (4G63-T (DOHC 16V))	Gasolina	FWD	1997	157	214	09.95-04.99	■
-------------------------	----------	-----	------	-----	-----	-------------	---

ECLIPSE II (D3_A) 04.94-04.99

Coupe (Executive car-E Segment)

2.0 RS (4G63 (DOHC 16V))	Gasolina	FWD	1996	104	141	09.95-04.99	■
2000 GS 16V (D32A) (4G63 (DOHC 16V))	Gasolina	FWD	1997	107	146	12.95-04.99	■
2.0 Turbo (D32A)	Gasolina	FWD	1997	147	200	04.94-04.99	■
2000 GT 16V (4G63-T (DOHC 16V))	Gasolina	FWD	1997	157	214	12.95-04.99	■
2400 GS 16V (4G64 (16V))	Gasolina	FWD	2389	105	143	09.98-04.99	■

ECLIPSE III (D5_A) 05.99-12.05

Convertible (Executive car-E Segment)

2.4 RS (4G64 (16V))	Gasolina	FWD	2351	106	144	05.99-03.05	■
---------------------	----------	-----	------	-----	-----	-------------	---

LISTA DE APLICACIONES - BUYERS GUIDE

2.4 (4G64 (16V))	Gasolina	FWD	2351	110	150	05.99-03.05	■
ECLIPSE III (D5_A) 04.99-12.05				Coupe (Executive car-E Segment)			
2.4 (4G64 (16V))	Gasolina	FWD	2351	110	150	05.99-03.05	■
MAGNA II (TR) 03.91-02.94				Estate (Executive car-E Segment)			
2.6	Gasolina	FWD	2555	85	116	05.91-02.94	■
2.6 i	Gasolina	FWD	2555	96	131	10.91-02.94	■
2.6	Gasolina	FWD	2555	98	133	03.94-04.96	■
MAGNA II (TR) 03.91-02.94				Saloon (Executive car-E Segment)			
2.6	Gasolina	FWD	2555	85	116	10.91-02.94	■
2.6 i	Gasolina	FWD	2555	98	133	04.91-02.94	■