

LISTA DE APLICACIONES - BUYERS GUIDE

78BD8675-2



Weight: 13.930

O.E.M.	MAKE
48401-09100	SSANGYONG
48401-21000	SSANGYONG

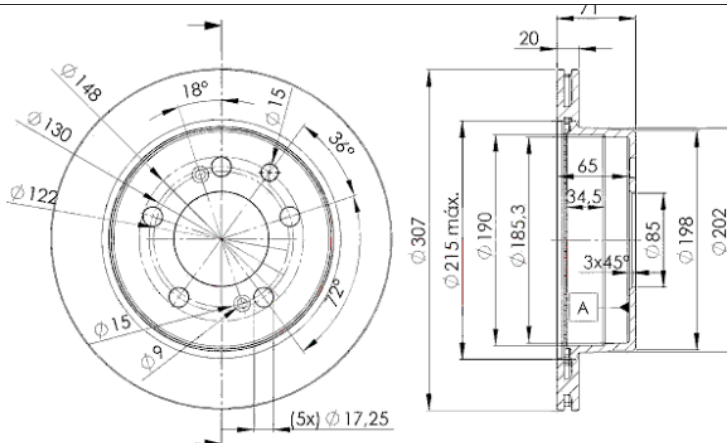

78BD8675-2

E1 90R-02C0438/1544



Ø307x20x71

MAKE
SSANGYONG



Trac.	CC	Kw	CV	
				Front / Rear

SSANGYONG

ACTYON 11.05-

					SUV (Compact SUV-J Segment)			
2.3 (G23D)		Gasolina	RWD	2295	110	150	11.06-	■
2.3 4x4 (G23D)		Gasolina	4WD	2295	110	150	11.06-	■

KYRON 05.05-

					SUV (Compact SUV-J Segment)			
2.3 4x4 (G23D)		Gasolina	4WD	2295	110	150	11.06-12.14	■
3.2 M320 4x4 (G32D)		Gasolina	4WD	3199	162	220	03.06-12.14	■
2.7 Xdi 4x4 (D27DT)		Diesel	4WD	2696	120	163	03.06-12.14	■
2.7 Xdi 4x4 (D27DT)		Diesel	4WD	2696	121	165	05.05-12.14	■

REXTON / Rexton II 04.02-

					SUV Van (Executive SUV-J Segment)			
RX270 XDi 4x4		Diesel	4WD	2696	118	160	03.11-04.13	■
RX270 XDi 4x4		Diesel	4WD	2696	132	179	03.11-04.13	■

REXTON / Rexton II (GAB_) 04.02-

					SUV (Executive SUV-J Segment)			
2.8 RX280 4x4		Gasolina	4WD	2797	142	193	03.03-	■
2.7 Xdi 4x4 (D27DT)		Diesel	4WD	2696	118	160	03.11-04.13	■
2.7 Xdi (D27DT)		Diesel	4WD	2696	120	163	08.04-	■
2.7 Xdi (D27DT)		Diesel	RWD	2696	121	165	03.05-08.06	■
2.7 Xdi 4x4 (D27DT)		Diesel	4WD	2696	121	165	05.04-05.12	■
2.7 CRDi 4x4 (D27DT)		Diesel	4WD	2696	130	176	12.03-12.09	■
2.7 Xdi Turbo 4x4 (D27DTP)		Diesel	4WD	2696	132	180	03.08-	■
2.7 D 4x4 (D27DTP)		Diesel	4WD	2696	137	186	06.06-	■

REXTON W / REXTON 07.12-

					SUV Van (Executive SUV-J Segment)			
e-XDi		Diesel	RWD	2157	131	178	07.15-	■

LISTA DE APLICACIONES - BUYERS GUIDE

e-XDi A las 4 ruedas	Diesel	4WD	2157	131	178	07.15-	■
REXTON W / REXTON 07.12-				SUV (Executive SUV-J Segment)			
2.0 Xdi (D20DTR)	Diesel	RWD	1998	110	150	07.13-11.15	■
2.0 Xdi A las 4 ruedas (D20DTR)	Diesel	4WD	1998	110	150	07.13-11.15	■
2.0 Xdi (D20DTR)	Diesel	RWD	1998	114	155	07.12-11.15	■
2.0 Xdi A las 4 ruedas (D20DTR)	Diesel	4WD	1998	114	155	07.12-11.15	■
2.2 Xdi	Diesel	RWD	2157	131	178	07.15-06.17	■
2.2 Xdi A las 4 ruedas	Diesel	4WD	2157	131	178	07.15-06.17	■
2.7 Xdi A las 4 ruedas (D27DT)	Diesel	4WD	2696	121	165	07.12-06.17	■
2.7 Xdi A las 4 ruedas (D27DTP)	Diesel	4WD	2696	137	186	10.12-06.17	■
RODIUS II / STAVIC 06.13-				MPV (Large MPV-M1 Segment)			
3.2	Gasolina	RWD	3199	162	220	07.13-	■
2.0 Xdi (D20DTR)	Diesel	RWD	1998	110	150	06.13-	■
2.0 Xdi (D20DTR)	Diesel	RWD	1998	114	155	07.13-	■
2.2 Xdi	Diesel	RWD	2157	131	178	07.15-	■
RODIUS II / STAVIC (CA1) 06.13-				SUV Van (Large MPV-M1 Segment)			
e-XDi	Diesel	RWD	2157	131	178	07.15-	■
RODIUS / STAVIC 05.05-				MPV (Large MPV-M1 Segment)			
3.2 (G32D)	Gasolina	RWD	3199	162	220	05.05-	■
3.2 4WD (G32D)	Gasolina	4WD	3199	162	220	07.07-	■
2.7 Xdi (D27DT)	Diesel	RWD	2696	120	163	05.05-	■
2.7 Xdi 4WD (D27DT)	Diesel	4WD	2696	120	163	05.05-	■
2.7 Xdi (D27DT)	Diesel	RWD	2696	121	165	05.05-	■
2.7 Xdi 4WD (D27DT)	Diesel	4WD	2696	121	165	05.05-	■
STAVIC 02.05-				MPV (Compact SUV-J Segment)			
2.0 200 XDi	Diesel	RWD	1998	100	136	06.13-	■
2.7 270 sXDi (D27DT)	Diesel	RWD	2696	121	165	02.05-	■
2.7 270 sXDi 4x4 (D27DT)	Diesel	4WD	2696	121	165	02.05-	■