

LISTA DE APLICACIONES - BUYERS GUIDE

78BD8684-2



Weight: 7.324

O.E.M.	MAKE
0060 569 164	ALFA ROMEO
16 406 261 000 1	ALFA ROMEO
6 056 916 4	ALFA ROMEO
6 060 216 1	ALFA ROMEO
6 065 347 9	ALFA ROMEO
6 065 856 6	ALFA ROMEO
6 080 178 6	ALFA ROMEO
6 080 178 7	ALFA ROMEO
6 081 178 7	ALFA ROMEO
6 081 480 4	LANCIA
7 173 891 1	LANCIA
7 173 891 2	FIAT
7 789 267	LANCIA
8 240 27 5	LANCIA
8 241 868 4	ALFA ROMEO
8 243 993 9	ALFA ROMEO
8 244 027 5	ALFA ROMEO

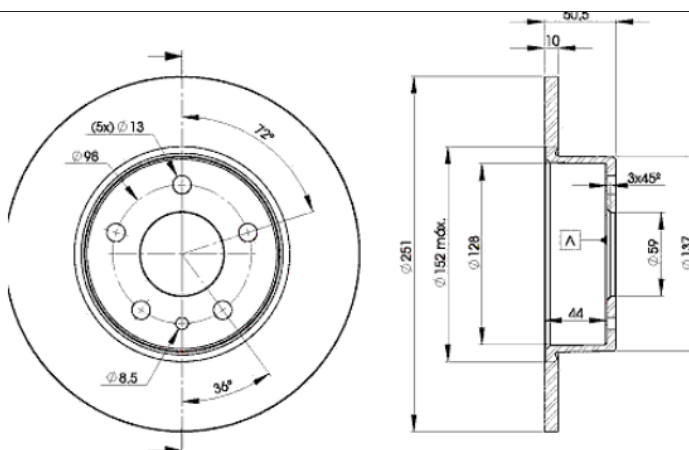

78BD8684-2

E1 90R-02C0415/0089



Ø251x10x50.5

MAKE
ALFA ROMEO
LANCIA



Trac.	CC	Kw	CV
-------	----	----	----



Front / Rear

ALFA ROMEO

147 (937_) 10.00-12.10						Hatchback (Compact car-C Segment)			
1.6 16V T.SPARK ECO (937.AXA1A, 937.BXA1A) (AR 37203)	Gasolina	FWD	1598	77	105	01.01-03.10	■		
1.6 16V T.SPARK (937.AXA1A, 937.AXB1A, 937.BXB1A) (AR 32104)	Gasolina	FWD	1598	88	120	01.01-03.10	■		
2.0 16V T.SPARK (937.AXA1, 937.AXC1, 937.BXC1) (AR 32310)	Gasolina	FWD	1970	110	150	01.01-03.10	■		
2.0 (937.AXC, 937.BXC)	Gasolina	FWD	1970	121	165	07.02-05.05	■		
1.6 LPG (937AXA1A) (AR 37203)	Gasol./Gas (LPG)	FWD	1598	77	105	01.09-03.10	■		
1.6 LPG (937BXB1A) (AR 32104)	Gasol./Gas (LPG)	FWD	1598	88	120	03.01-12.09	■		
1.9 JTD (937.AXF1A, 937.BXF1A) (182 B9.000)	Diesel	FWD	1910	74	101	06.03-03.10	■		
1.9 JTD (937AXD1A, 937BXD1A) (937 A2.000)	Diesel	FWD	1910	81	110	10.00-08.02	■		
1.9 JTD (937.AXD1A, 937.BXD1A, 937.AXV1A, 937.BXB1A,...) (937 A2.000)	Diesel	FWD	1910	85	115	04.01-03.10	■		
1.9 JTDM (937.AXD1A, 937.AXV1A, 937.BXB1A) (939 A7.000)	Diesel	FWD	1910	85	115	10.04-03.10	■		
1.9 JTDM 8V (937.AXD1A, 937.AXU1A, 937.BXU1A) (937 A3.000)	Diesel	FWD	1910	88	120	07.05-03.10	■		
1.9 JTD 16V (937.AXG1B, 937.BXG1B) (937 A4.000)	Diesel	FWD	1910	93	126	09.03-09.04	■		
1.9 JTD 16V (937.AXM1B, 937.AXS1B) (192 B1.000)	Diesel	FWD	1910	100	136	10.04-03.10	■		
1.9 JTD 16V (937.AXG1B, 937.BXG1B) (192 A5.000)	Diesel	FWD	1910	103	140	11.02-03.10	■		
1.9 JTDM 16V (937.AXN1B, 937.BXN1B) (937 A5.000)	Diesel	FWD	1910	110	150	09.04-03.10	■		
1.9 JTDM 16V (937.AXN1B, 937.BXN1B) (937 A6.000)	Diesel	FWD	1910	125	170	06.08-03.10	■		

LISTA DE APLICACIONES - BUYERS GUIDE

156 (932_) 09.97-10.05					Saloon (Compact executive car-D Segment)				
1.6 16V T.SPARK (932A4) (AR 32102)		Gasolina	FWD	1598	82	112	09.97-09.05		■
1.6 16V T.SPARK (932.A4, 932.A4100) (AR 32102)	-02/02	Gasolina	FWD	1598	88	120	09.97-09.05		■
1.6 16V T.SPARK (932.A4, 932.A4100) (AR 32103)	-02/02	Gasolina	FWD	1598	88	120	09.97-09.05		■
1.6 16V T.SPARK (932.A4, 932.A4100) (AR 32104)	-02/02	Gasolina	FWD	1598	88	120	09.97-09.05		■
1.6 16V T.SPARK (932.A4, 932.A4100) (AR 67601)	-02/02	Gasolina	FWD	1598	88	120	09.97-09.05		■
1.8 16V T.SPARK (932.A3100) (AR 32205)	-02/02	Gasolina	FWD	1747	103	140	09.97-09.05		■
1.8 16V T.SPARK (932.A3100) (AR 32201)	-ch 0383456	Gasolina	FWD	1747	106	144	09.97-10.00		■
2.0 16V T.SPARK (932A21_) (AR 32310)		Gasolina	FWD	1970	110	150	10.00-03.02		■
2.0 16V T.SPARK (932A2) (AR 32301)		Gasolina	FWD	1970	114	155	09.97-06.02		■
2.0 16V T.SPARK (932A2) (AR 32310)		Gasolina	FWD	1970	114	155	09.97-06.02		■
2.0 JTS (932AXD00, 932AXD01) (932 A2.000)		Gasolina	FWD	1970	119	162	03.01-09.05		■
2.5 V6 24V (932A1) (AR 32401)		Gasolina	FWD	2492	140	190	09.97-09.02		■
2.5 V6 24V (932A1) (AR 32402)		Gasolina	FWD	2492	140	190	09.97-09.02		■
1.9 JTD (932.A2B00) (AR 37101)		Diesel	FWD	1910	81	110	10.00-05.01		■
2.4 JTD (932B1) (AR 32501)		Diesel	FWD	2387	100	136	09.97-09.03		■
2.4 JTD (932A1B_) (839 A6.000)		Diesel	FWD	2387	103	140	10.00-09.05		■
156 Sport Wagon (932_) 02.97-05.06					Estate (Compact executive car-D Segment)				
1.6 16V T.SPARK (932A4) (AR 32102)		Gasolina	FWD	1598	82	112	01.00-09.05		■
1.6 16V T.SPARK. (932B4100) (AR 32102)	-01/02	Gasolina	FWD	1598	88	120	05.00-05.06		■
1.6 16V T.SPARK. (932B4100) (AR 32103)	-01/02	Gasolina	FWD	1598	88	120	05.00-05.06		■
1.6 16V T.SPARK. (932B4100) (AR 32104)	-01/02	Gasolina	FWD	1598	88	120	05.00-05.06		■
1.6 16V T.SPARK. (932B4100) (AR 67601)	-01/02	Gasolina	FWD	1598	88	120	05.00-05.06		■
1.8 16V T.SPARK (932B31_) (AR 32205)	-02/02	Gasolina	FWD	1747	103	140	02.97-05.06		■
1.8 16V T.SPARK (932A3) (AR 32201)	-ch 0383456	Gasolina	FWD	1747	106	144	05.00-10.00		■
2.0 16V T.SPARK (932B21_) (AR 32310)		Gasolina	FWD	1970	110	150	10.00-03.02		■
2.0 16V T.SPARK (932A2) (AR 32301)		Gasolina	FWD	1970	114	155	05.00-06.02		■
2.0 16V T.SPARK (932A2) (AR 32310)		Gasolina	FWD	1970	114	155	05.00-06.02		■
2.5 V6 24V (932A1) (AR 32401)		Gasolina	FWD	2492	140	190	02.97-08.03		■
2.5 V6 24V (932B1100) (AR 32405)	-02/02	Gasolina	FWD	2492	141	192	02.97-05.06		■
1.9 JTD (932B2) (AR 32302)		Diesel	FWD	1910	77	105	05.00-10.00		■
1.9 JTD (932.B2B00) (AR 37101)	-ch 0383456	Diesel	FWD	1910	81	110	10.00-05.01		■
1.9 JTD (932B2B, 932B2C) (937 A2.000)	-02/02	Diesel	FWD	1910	85	115	05.01-05.06		■
2.4 JTD (932B1) (AR 32501)		Diesel	FWD	2387	100	136	05.00-09.03		■
2.4 JTD (932.B1B00) (839 A6.000)	-02/02	Diesel	FWD	2387	103	140	10.00-05.06		■
164 / 168 (164_) 01.87-10.98					Saloon (Executive car-E Segment)				
2.0 Turbo (164A2B) (AR 06476)		Gasolina	FWD	1995	128	174	10.87-09.98		■
2.0 Turbo (164A2B) (AR 06476)		Gasolina	FWD	1995	129	175	02.88-10.92		■
2.0 Turbo		Gasolina	FWD	1995	148	201	07.90-10.92		■
2.0 Turbo		Gasolina	FWD	1995	152	207	07.90-10.92		■
2.0 V6 Turbo (164.K3) (AR 64102)		Gasolina	FWD	1996	148	201	09.92-09.98		■
2.0 V6 Turbo (164.A2G, 164.A2F) (AR 64101)		Gasolina	FWD	1996	150	204	03.91-09.92		■
2.5 V6 (164A1C) (AR 66201)		Gasolina	FWD	2492	120	163	09.92-09.98		■
3.0 V6 (164.H1A, 164.H1B, 164.K1P) (AR 64303)		Gasolina	FWD	2959	132	180	09.92-09.98		■
3.0 V6 (164.H1A, 164.H1B, 164.K1P) (AR 64305)		Gasolina	FWD	2959	132	180	09.92-09.98		■
3.0 V6 (164.H1A, 164.H1B, 164.K1P) (AR 64399)		Gasolina	FWD	2959	132	180	09.92-09.98		■

LISTA DE APLICACIONES - BUYERS GUIDE

3.0 V6 (164.H1A, 164.H1B, 164.K1P) (AR 66303)		Gasolina	FWD	2959	132	180	09.92-09.98	■
3.0 V6 (164.AD, 164.AH, 164.AB) (AR 06412)		Gasolina	FWD	2959	135	184	06.87-09.92	■
3.0 (164AG) (AR 06410)		Gasolina	FWD	2959	136	185	09.90-12.93	■
3.0 (164A) (AR 06410)		Gasolina	FWD	2959	138	188	11.87-09.91	■
3.0 V6 (164.A) (AR 06410)		Gasolina	FWD	2959	141	192	06.87-09.92	■
3.0		Gasolina	FWD	2959	145	197	10.94-08.97	■
3.0		Gasolina	FWD	2959	147	200	02.88-10.92	■
3.0 i.e. QV (164.AG) (AR 06430)		Gasolina	FWD	2959	147	200	09.90-09.92	■
3.0 i.e. QV (164.AG) (AR 64301)		Gasolina	FWD	2959	147	200	09.90-09.92	■
3.0 24V (164K1G, 164K1F) (AR 66302)		Gasolina	FWD	2959	154	209	03.95-10.97	■
3.0 24V (164.K1) (AR 64306)		Gasolina	FWD	2959	155	211	09.92-09.98	■
3.0 24V (164.K1) (AR 66301)		Gasolina	FWD	2959	155	211	09.92-09.98	■
3.0 24V (164.K1) (AR 66302)		Gasolina	FWD	2959	155	211	09.92-09.98	■
3.0 (164AG, 164H1) (AR 64304)		Gasolina	FWD	2959	156	212	09.93-12.95	■
3.0		Gasolina	FWD	2959	157	213	03.95-10.97	■
3.0 (164H1) (AR 64304)		Gasolina	FWD	2959	168	228	04.93-02.95	■
3.0 (164H1) (AR 64304)		Gasolina	FWD	2959	170	231	03.95-08.97	■
3.0 24V Q4 (164.K1M, 164.K1C) (AR 64307)	vehicles with ABS	Gasolina	4WD	2959	170	231	02.94-09.98	■
3.0 24V Q4 (164.K1M, 164.K1C) (AR 64308)	vehicles with ABS	Gasolina	4WD	2959	170	231	02.94-09.98	■
3.0 24V QV (164.H1) (AR 64304)	vehicles with ABS	Gasolina	FWD	2959	171	233	09.92-09.98	■
3.0 24V QV A las 4 ruedas (164K1H) (AR 64304)		Gasolina	4WD	2959	171	233	11.92-10.97	■
3.0 24V QV A las 4 ruedas (164K1H) (AR 64307)		Gasolina	4WD	2959	171	233	11.92-10.97	■
2.5 TD (164.A1A) (VM 84 A)		Diesel	FWD	2499	84	114	06.87-09.92	■
2.5 TD (164.K2A, 164.K2B) (VM 08 B)		Diesel	FWD	2499	92	125	09.92-09.98	■
2.5 TD (164.K2A, 164.K2B) (VM 32 B)		Diesel	FWD	2499	92	125	09.92-09.98	■
LANCIA								
DELTA (831_) 09.79-01.94					Hatchback (Compact car-C Segment)			
2.0 16V HF Evo Integrale (831AB.027) (831 E5.000)		Gasolina	4WD	1995	155	211	06.93-01.94	■
2.0 16V HF Evo Integrale (831AB.027) (831 E5.046)		Gasolina	4WD	1995	155	211	06.93-01.94	■
DELTA III (844_) 08.08-08.14					Hatchback (Compact car-C Segment)			
1.8 (844.AXH12) (939 B1.000)		Gasolina	FWD	1742	147	200	01.09-08.14	■
THEMA (834_) 11.84-07.94					Saloon (Executive car-E Segment)			
8.32 (834FS) (F 105 L.046)		Gasolina	FWD	2927	151	205	10.87-05.92	■
8.32 (834F) (F 105 L)		Gasolina	FWD	2927	158	215	09.87-05.89	■