

LISTA DE APLICACIONES - BUYERS GUIDE

78BD8735-2



Weight: 7.240

O.E.M.	MAKE
MB 618 735	mitsubishi

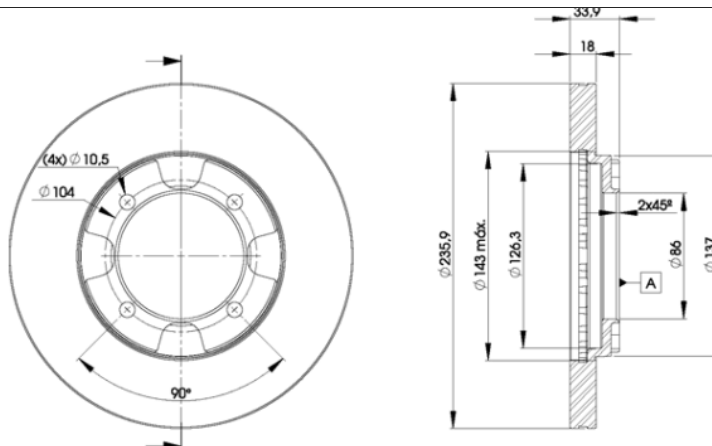

78BD8735-2



Ø236x18x34

MAKE
mitsubishi



Trac.	CC	Kw	CV		
					Front / Rear

mitsubishi

COLT II (C5_A) 10.86-05.92

						Hatchback (Supermini car-B Segment)		
1.3 GL (C61A) (4G13 (8V))		Gasolina	FWD	1299	44	60	04.88-12.90	■
1.3 (C51A) (4G13 (8V))	06/90-	Gasolina	FWD	1299	51	70	04.88-05.92	■
1.3 12V (C51A) (4G13 (12V))	06/90-	Gasolina	FWD	1299	55	75	04.88-05.92	■
1.5 GLXi (C52A) (4G15 (8V))	09/90-	Gasolina	FWD	1468	62	84	04.88-05.92	■
1.5 Cat (C52A) (4G15 (12V))		Gasolina	FWD	1468	66	90	07.90-05.92	■
1.8 GTi 16V Cat (C58A) (4G67)		Gasolina	FWD	1836	100	136	06.90-05.92	■
1.8 Diesel GLX (C54A) (4D65)	09/88-	Diesel	FWD	1795	44	60	04.88-05.92	■

GALANT VI (E3_A) 11.87-03.93

						Saloon (Compact car-C Segment)		
1.6 (E31A) (4G32)	06/90-	Gasolina	FWD	1597	55	75	01.88-10.92	■

LANCER III (C6_A, C7_A) 04.88-05.94

						Hatchback (Supermini car-B Segment)		
1.3 12V (C61A) (4G13 (12V))	-03/93	Gasolina	FWD	1299	55	75	06.92-05.94	■
1.5 (C62A) (4G15 (8V))		Gasolina	FWD	1468	62	84	06.88-05.92	■
1.5 12V (C62A) (4G15 (12V))		Gasolina	FWD	1468	66	90	05.89-05.92	■
1.8 4WD (C77A) (4G37)		Gasolina	4WD	1755	71	97	09.89-06.92	■
1.8 GTi 16V (C69A) (4G93 (DOHC 16V))		Gasolina	FWD	1834	103	140	06.92-12.93	■
1.8 GTi 16V (C68A) (4G67)		Gasolina	FWD	1836	100	136	11.89-05.92	■
1.8 D (C64A) (4D65)		Diesel	FWD	1795	44	60	04.88-05.92	■

LANCER III / LIBERO (CB_A, CD_A, CE_A) 07.91-12.96

						Saloon (Supermini car-B Segment)		
1.3 (CB1A) (4G13 (12V))	-03/93	Gasolina	FWD	1299	55	75	06.92-12.96	■
1.8 16V (CB5A) (4G93 (DOHC 16V))		Gasolina	FWD	1834	103	140	06.92-12.93	■

LISTA DE APLICACIONES - BUYERS GUIDE

LANCER II-III (C6_A, C7_A) 04.88-12.97					Saloon (Supermini car-B Segment)			
1.3 GL (C61A) (G13B)		Gasolina	FWD	1298	50	68	05.88-06.90	■
1.3 (C61A) (4G13 (8V))		Gasolina	FWD	1299	44	60	04.88-05.92	■
1.3 (C61A) (4G13 (8V))		Gasolina	FWD	1299	51	70	08.88-05.92	■
1.3 (C61A) (G13B)		Gasolina	FWD	1299	51	70	08.88-05.92	■
1.3 12V (C61A) (4G13 (12V))		Gasolina	FWD	1299	55	75	07.90-06.92	■
1.5 (C62A) (4G15 (12V))		Gasolina	FWD	1468	62	84	04.88-05.92	■
1.5 12V (C62A) (4G15 (12V))		Gasolina	FWD	1468	66	90	06.90-05.92	■
1.8 GLX Diesel (C64A) (4D65)	06/90-	Diesel	FWD	1795	44	60	04.88-05.92	■
LANCER II-III Station Wagon (C1_V, C3_V) 09.85-08.92					Estate (Supermini car-B Segment)			
1.5 (C12V) (4G15 (8V))		Gasolina	FWD	1468	61	83	09.88-12.90	■
1.5 12V (C12V) (4G15 (12V))		Gasolina	FWD	1468	66	90	09.90-12.91	■
1.8 4WD (C37V) (4G37)		Gasolina	4WD	1755	63	86	03.89-12.90	■
1.8 4WD (C37V) (4G37)		Gasolina	4WD	1755	69	94	08.90-06.92	■
1.8 D (C14V) (4D65)	09/90-	Diesel	FWD	1795	44	60	08.86-06.92	■