

LISTA DE APLICACIONES - BUYERS GUIDE

78BD8801-2



8 424073 149008

Weight: 13.930

O.E.M.	MAKE
40206-88E01	NISSAN
40206-88E03	NISSAN
40206-88E04	NISSAN
40206-88E05	NISSAN

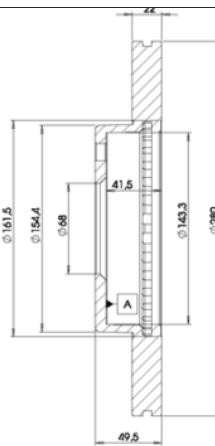
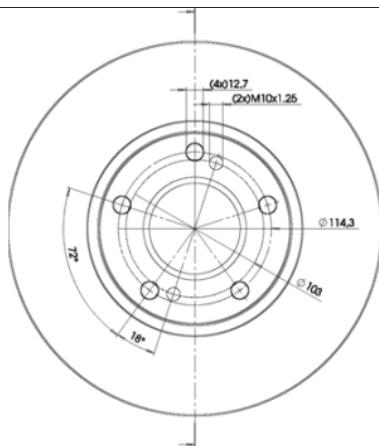

78BD8801-2

E1 90R-02C0074/0002



Ø280x22x49.3

MAKE
NISSAN



Trac.	CC	Kw	CV		
					Front / Rear

NISSAN

AVENIR II (W11) 11.97-03.06

					Estate (Compact car-C Segment)			
1.8 (QG18DE)		Gasolina	FWD	1769	92	125	11.97-12.05	■
2.0 4x4 (SR20DE)		Gasolina	4WD	1998	107	145	11.97-12.05	■

CEFIRO II (A32) 08.94-12.99

					Saloon (Sports car-S Segment)			
2.0 (VQ20DE)		Gasolina	FWD	1995	103	140	10.94-12.99	■
2.0		Gasolina	FWD	1995	114	155	08.94-11.98	■

MAXIMA IV QX (A32) 03.94-08.00

					Saloon (Sports car-S Segment)			
2.0 (VQ20DE)		Gasolina	FWD	1995	103	140	02.95-08.00	■

MAXIMA III (J30) 10.88-02.95

					Saloon (Executive car-E Segment)			
3.0 i (VG30E)		Gasolina	FWD	2960	125	170	10.88-06.94	■
3.0 (VG30E)		Gasolina	FWD	2960	128	174	10.88-06.94	■
3.0		Gasolina	FWD	2988	142	193	09.91-12.94	■

MAXIMA IV Station Wagon (A32) 10.97-12.00

					Estate (Executive car-E Segment)			
2.0 QX (VQ20DE)	-05/00	Gasolina	FWD	1995	103	140	10.97-12.00	■
2.5 V6 24V (VQ25DE)		Gasolina	FWD	2496	140	190	10.97-12.00	■

SKYLINE X (R34) 01.98-02.08

					Coupe (Executive car-E Segment)			
2.0 (HR34) (RB20DE)		Gasolina	RWD	1998	114	155	06.98-07.00	■

SKYLINE X (R34) 01.98-01.06

					Saloon (Executive car-E Segment)			
2.0 (HR34) (RB20DE)		Gasolina	RWD	1998	114	155	06.98-07.00	■

STAGEA (WC34) 09.96-10.01

					Estate (Executive car-E Segment)			
2.0 (WHC34) (RB20E)		Gasolina	RWD	1998	96	131	09.96-10.01	■