

LISTA DE APLICACIONES - BUYERS GUIDE

78BD9005-2



Weight: 18.448

O.E.M.	MAKE
1 842 193	OPEL
24 435 132	SAAB
5 69 005	OPEL
93 175 606	OPEL

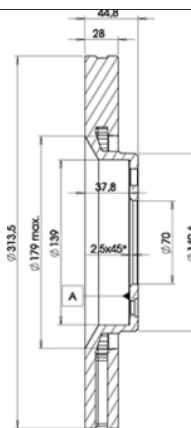

78BD9005-2

E1 90R-02C0433/0096



Ø313.5x28x44.8

MAKE
CADILLAC
CHEVROLET
OPEL
SAAB
VAUXHALL



Trac.	CC	Kw	CV
-------	----	----	----



Front / Rear

CADILLAC

BLS 04.06-					Saloon (Compact executive car-D Segment)			
2.8 T (B284R)	Gasolina	FWD	2792	206	280	12.09-12.10	■	
2.8 T (Z 28 NET)	Gasolina	FWD	2792	206	280	12.09-12.10		
2.8 T AWD (Z 28 NET)	Gasolina	4WD	2792	206	280	10.08-		
BLS Wagon 12.07-					Estate (Compact executive car-D Segment)			
2.8 T (B284R)	Gasolina	FWD	2792	206	280	08.10-	■	
2.8 T AWD (Z 28 NET)	Gasolina	4WD	2792	206	280	10.08-		

CHEVROLET

VECTRA II 01.05-					Saloon (Large family car-D Segment)			
2.8	Gasolina	FWD	2792	184	250	10.06-	■	
2.8	Gasolina	FWD	2792	188	256	11.05-09.06	■	

OPEL

SIGNUM (Z03) 05.03-					Hatchback (Large family car-D Segment)			
2.8 V6 Turbo (F48) (Z 28 NEL)	-05/08, -ch 61000001	Gasolina	FWD	2792	169	230	09.05-12.08	■
2.8 V6 Turbo (F48) (Z 28 NET)	03/06-, -05/08	Gasolina	FWD	2792	184	250	01.06-12.08	■
3.2 V6 (F48) (Z 32 SE)	ch- 31068239	Gasolina	FWD	3175	155	211	05.03-07.05	■
3.0 V6 CDTI (F48) (Y 30 DT)	ch- 31068239	Diesel	FWD	2958	130	177	05.03-07.05	■
3.0 V6 CDTI (F48) (Z 30 DT)	ch- 31068239	Diesel	FWD	2958	135	184	09.05-12.08	■
VECTRA C (Z02) 10.03-					Estate (Large family car-D Segment)			
2.8 V6 Turbo (F35) (Z 28 NEL)		Gasolina	FWD	2792	169	230	08.05-10.08	■
2.8 V6 Turbo (F35) (Z 28 NET)		Gasolina	FWD	2792	184	250	08.05-08.08	■

LISTA DE APLICACIONES - BUYERS GUIDE

2.8 V6 Turbo (F35) (Z 28 NET)		Gasolina	FWD	2792	188	255	08.05-09.08	■
2.8 V6 Turbo (F35) (Z 28 NET)		Gasolina	FWD	2792	206	280	07.06-08.08	■
3.2 V6 (F35) (Z 32 SE)	ch- 31070294,38047798	Gasolina	FWD	3175	155	211	10.03-07.05	■
3.0 V6 CDTI (F35) (Y 30 DT)	ch- 31070294,38047798	Diesel	FWD	2958	130	177	10.03-07.05	■
3.0 V6 CDTI (F35) (Z 30 DT)		Diesel	FWD	2958	135	184	08.05-08.08	■
VECTRA C (Z02) 08.02-					Hatchback (Large family car-D Segment)			
2.8 V6 Turbo (F68) (Z 28 NEL)		Gasolina	FWD	2792	169	230	08.05-08.08	■
2.8 V6 Turbo (F68) (Z 28 NET)		Gasolina	FWD	2792	184	250	08.05-08.08	■
2.8 V6 Turbo (F68) (Z 28 NET)		Gasolina	FWD	2792	188	255	08.05-09.08	■
2.8 V6 Turbo (F68) (Z 28 NET)		Gasolina	FWD	2792	206	280	08.06-08.08	■
3.2 V6 (F68) (Z 32 SE)	ch- 31070294	Gasolina	FWD	3175	155	211	08.02-07.06	■
3.0 CDTI (F68) (Y 30 DT)	ch- 31070294	Diesel	FWD	2958	130	177	06.03-07.05	■
3.0 CDTI (F68) (Z 30 DT)		Diesel	FWD	2958	135	184	08.05-08.08	■
VECTRA C (Z02) 04.02-					Saloon (Large family car-D Segment)			
2.8 V6 Turbo (F69) (Z 28 NEL)		Gasolina	FWD	2792	169	230	08.05-10.06	■
2.8 V6 Turbo (F69) (Z 28 NET)		Gasolina	FWD	2792	184	250	08.05-08.08	■
2.8 V6 Turbo (F69) (Z 28 NET)		Gasolina	FWD	2792	188	255	08.05-09.06	■
3.2 V6 (F69) (Z 32 SE)	ch- 31070294,38047798	Gasolina	FWD	3175	155	211	08.02-07.06	■
3.0 CDTI (F69) (Y 30 DT)	ch- 31070294,38047798	Diesel	FWD	2958	130	177	02.03-07.05	■
3.0 CDTI (F69) (Z 30 DT)		Diesel	FWD	2958	135	184	08.05-08.08	■
SAAB								
9-3 II (YS3F) 08.03-02.15					Convertible (Compact executive car-D Segment)			
1.8 i (Z 18 XE)		Gasolina	FWD	1796	90	122	01.04-02.15	■
1,8t (B207E)		Gasolina	FWD	1998	110	150	08.03-02.15	■
2.0 T (B207G)		Gasolina	FWD	1998	120	163	01.11-02.15	■
2.0 T (B207L)	Rim 16	Gasolina	FWD	1998	129	175	08.03-02.15	■
2.0		Gasolina	FWD	1998	130	177	09.04-12.05	■
2.0 t Biopower	Rim 17	Gasolina	FWD	1998	145	197	06.07-	■
2.0 T (B207R)		Gasolina	FWD	1998	154	210	08.03-02.15	■
2.0 T (A 20 NFT)		Gasolina	FWD	1998	162	220	01.11-02.15	■
2.0 Turbo Performance (B207R)		Gasolina	FWD	1998	185	252	04.04-02.15	■
2.8 Turbo V6 (LP9)		Gasolina	FWD	2792	169	230	02.06-02.15	■
2.8 Turbo V6 (LP9)	04/08-, -06/12, Rim 16	Gasolina	FWD	2792	184	250	02.06-02.15	■
2.8 Turbo V6 (B284L)		Gasolina	FWD	2792	188	256	12.07-02.15	■
2.8 Turbo V6 (B284R)		Gasolina	FWD	2792	203	276	02.09-02.15	■
2.8 Turbo V6 (B284R)		Gasolina	FWD	2792	206	280	02.09-02.15	■
2.0 t Biopower (B207H)		Gasol./Etanol	FWD	1998	120	163	01.11-02.15	■
2.0 t Biopower (B207L)	Rim 16	Gasol./Etanol	FWD	1998	129	175	01.07-02.15	■
2.0 t Biopower (B207L)		Gasol./Etanol	FWD	1998	129	175	01.07-02.15	■
2.0 t Biopower		Gasol./Etanol	FWD	1998	145	197	06.07-02.15	■
2.0 t Biopower (B207M)	Rim 17	Gasol./Etanol	FWD	1998	147	200	06.07-02.15	■
2.0 t Biopower (A 20 NFT)		Gasol./Etanol	FWD	1998	162	220	01.11-02.15	■
1.9 TiD (Z 19 DT)		Diesel	FWD	1910	88	120	09.04-02.15	■
1.9 TTiD (A 19 DTR)		Diesel	FWD	1910	96	130	12.07-02.15	■
1.9 TiD (Z 19 DTH)		Diesel	FWD	1910	110	150	01.06-02.15	■
1.9 TTiD (A 19 DTR)		Diesel	FWD	1910	118	160	12.07-02.15	■
1.9 TTiD (A 19 DTR)		Diesel	FWD	1910	132	180	12.07-02.15	■

LISTA DE APLICACIONES - BUYERS GUIDE

1.9 TTiD (Z 19 DTR)		Diesel	FWD	1910	132	180	12.07-02.15	■
9-3 II (E50) 03.05-02.15					Estate (Compact executive car-D Segment)			
1.8 i (Z 18 XE)		Gasolina	FWD	1796	90	122	03.05-02.15	■
1.8t 2.0 (B207E)		Gasolina	FWD	1998	110	150	03.05-02.15	■
2.0 T (B207E)	Rim 16	Gasolina	FWD	1998	110	150	03.05-02.15	■
2.0 T (B207G)		Gasolina	FWD	1998	120	163	01.07-02.15	■
2.0 t XWD (B207G)		Gasolina	4WD	1998	120	163	01.07-02.15	■
2.0 T (B207L)	Rim 16	Gasolina	FWD	1998	129	175	03.05-02.15	■
2.0	Rim 16	Gasolina	FWD	1998	143	194	04.06-09.07	■
2.0 T (B207M)		Gasolina	FWD	1998	147	200	02.09-02.15	■
2.0 T (B207R)		Gasolina	FWD	1998	154	209	03.05-02.15	■
2.0 t XWD (B207R)		Gasolina	4WD	1998	154	209	06.08-02.15	■
2.0 T (A 20 NFT)		Gasolina	FWD	1998	162	220	01.11-02.15	■
2.0 t XWD (A 20 NFT)		Gasolina	4WD	1998	162	220	01.11-02.15	■
2.0 T (B207R)	-06/12, Rim 16	Gasolina	FWD	1998	177	241	05.09-02.15	■
2.0 t XWD (B207R)	-06/12	Gasolina	4WD	1998	177	241	05.09-02.15	■
2.8 Turbo V6 (B284L)		Gasolina	FWD	2792	169	230	03.05-02.15	■
2.8 Turbo V6 (LP9)		Gasolina	FWD	2792	184	250	03.05-02.15	■
2.8 Turbo V6 (B284L)		Gasolina	FWD	2792	188	256	12.07-02.15	■
2.8 Turbo V6 (B284R)		Gasolina	FWD	2792	203	276	05.08-02.15	■
2.8 Turbo V6 (B284R)		Gasolina	FWD	2792	206	280	05.08-12.10	■
2.8 Turbo V6 XWD (B284R)		Gasolina	4WD	2792	206	280	05.08-12.11	■
2.0 t Biopower (B207E)		Gasol./Etanol	FWD	1998	110	150	01.07-02.15	■
2.0 t Biopower (B207H)		Gasol./Etanol	FWD	1998	120	163	01.11-02.15	■
2.0 t BioPower XWD (B207H)		Gasol./Etanol	4WD	1998	120	163	01.07-02.15	■
2.0 t Biopower (B207L)	Rim 16	Gasol./Etanol	FWD	1998	129	175	01.07-02.15	■
2.0 t Biopower (B207R)	Rim 16	Gasol./Etanol	FWD	1998	145	197	06.07-02.15	■
2.0 t Biopower (B207M)		Gasol./Etanol	FWD	1998	147	200	02.09-02.15	■
2.0 t BioPower XWD (B207R)		Gasol./Etanol	4WD	1998	154	209	06.08-02.15	■
2.0 t Biopower (A 20 NFT)		Gasol./Etanol	FWD	1998	162	220	01.11-02.15	■
2.0 t BioPower XWD (A 20 NFT)		Gasol./Etanol	4WD	1998	162	220	01.11-02.15	■
1.9 TiD (Z 19 DT)		Diesel	FWD	1910	88	120	03.05-02.15	■
1.9 TTiD (A 19 DTR)		Diesel	FWD	1910	96	130	12.07-02.15	■
1.9 TiD (Z 19 DTH)		Diesel	FWD	1910	110	150	03.05-02.15	■
1.9 TTiD (A 19 DTR)		Diesel	FWD	1910	118	160	12.07-02.15	■
1.9 TTiD (Z 19 DTR)		Diesel	FWD	1910	132	180	12.07-02.15	■
9-3 II (YS3F, E79, D79, D75) 09.02-02.15					Saloon (Compact executive car-D Segment)			
1.8 i (Z 18 XE)		Gasolina	FWD	1796	90	122	01.04-02.15	■
1,8t (B207E)		Gasolina	FWD	1998	110	150	09.02-02.15	■
2.0 T (B207G)		Gasolina	FWD	1998	120	163	01.07-02.15	■
2.0 t XWD (B207G)		Gasolina	4WD	1998	120	163	01.07-02.15	■
2.0 T (B207L)	Rim 16	Gasolina	FWD	1998	129	175	09.02-02.15	■
2.0 T16		Gasolina	FWD	1998	143	194	06.06-02.15	■
2.0 T (B207R)		Gasolina	FWD	1998	154	210	09.02-02.15	■
2.0 Turbo XWD (B207R)	06/08-, Rim 17	Gasolina	4WD	1998	154	210	01.08-02.15	■
2.0 T (A 20 NFT)		Gasolina	FWD	1998	162	220	01.11-02.15	■

LISTA DE APLICACIONES - BUYERS GUIDE

2.0 t XWD (A 20 NFT)		Gasolina	4WD	1998	162	220	01.08-02.15	■
2.0 T (B207R)	Rim 17	Gasolina	FWD	1998	177	241	05.09-02.15	■
2.0 t XWD (B207R)	-06/12, Rim 16	Gasolina	4WD	1998	177	241	05.09-02.15	■
2.0 Turbo Performance (B207R)		Gasolina	FWD	1998	185	252	04.04-02.15	■
2.8 Turbo V6 (LP9)		Gasolina	FWD	2792	169	230	03.05-02.15	■
2.8 Turbo V6 (LP9)	-06/12, Rim 16	Gasolina	FWD	2792	184	250	03.05-02.15	■
2.8 Turbo V6 (B284L)		Gasolina	FWD	2792	188	256	12.07-02.15	■
2.8 Turbo V6 (B284L)		Gasolina	FWD	2792	203	276	04.08-02.15	■
2.8 Turbo V6 (B284R)		Gasolina	FWD	2792	206	280	05.08-12.10	■
2.8 Turbo V6 XWD (B284R)		Gasolina	4WD	2792	206	280	05.08-12.11	■
2.0 t Biopower (B207H)		Gasol./Etanol	FWD	1998	120	163	01.07-02.15	■
2.0 t BioPower XWD (B207H)		Gasol./Etanol	4WD	1998	120	163	01.08-02.15	■
1,8t BioPower (B207L)		Gasol./Etanol	FWD	1998	129	175	05.09-02.15	■
2.0 t Biopower (B207L)	Rim 16	Gasol./Etanol	FWD	1998	129	175	01.07-02.15	■
2.0 t Biopower (B207R)		Gasol./Etanol	FWD	1998	145	197	06.07-02.15	■
2.0 t Biopower (B207M)		Gasol./Etanol	FWD	1998	147	200	05.09-02.15	■
2.0 t Biopower (B207R)	10/03-	Gasol./Etanol	FWD	1998	154	210	09.02-02.15	■
2.0 t BioPower XWD (B207R)	-06/12, Rim 16	Gasol./Etanol	4WD	1998	154	210	01.08-02.15	■
2.0 t Biopower (A 20 NFT)		Gasol./Etanol	FWD	1998	162	220	01.11-02.15	■
2.0 t BioPower XWD (A 20 NFT)		Gasol./Etanol	4WD	1998	162	220	01.08-02.15	■
1.9 TiD (Z 19 DT)		Diesel	FWD	1910	88	120	09.04-02.15	■
1.9 TTiD (A 19 DTR)		Diesel	FWD	1910	96	130	12.07-02.15	■
1.9 TiD (Z 19 DTH)		Diesel	FWD	1910	110	150	09.04-02.15	■
1.9 TTiD (A 19 DTR)	Rim 16	Diesel	FWD	1910	118	160	12.07-02.15	■
1.9 TTiD (A 19 DTR)		Diesel	FWD	1910	132	180	12.07-02.15	■
1.9 TTiD (Z 19 DTR)		Diesel	FWD	1910	132	180	12.07-02.15	■
2.2 TiD (D223L)		Diesel	FWD	2171	92	125	09.02-02.15	■
9-3X (YS3) 02.09-02.15					Estate (Compact executive car-D Segment)			
2.0 t XWD (B207R)		Gasolina	4WD	1998	154	209	02.09-02.15	■
2.0 t BioPower XWD (B207R)		Gasol./Etanol	4WD	1998	154	209	02.09-12.12	■
2.0 t BioPower XWD (A 20 NFT)	-06/12	Gasol./Etanol	4WD	1998	162	220	01.11-12.12	■
1.9 TTiD AWD (A 19 DTR)	03/09-, -06/12, Rim 16	Diesel	4WD	1910	132	180	02.09-12.12	■
1.9 TTiD AWD (Z 19 DTR)	03/09-, -06/12, Rim 16	Diesel	4WD	1910	132	180	02.09-12.12	■
VAUXHALL								
SIGNUM (Z03) 03.03-10.08					Hatchback (Large family car-D Segment)			
2.8 V6 Turbo (Z 28 NET)		Gasolina	FWD	2792	184	250	05.07-10.08	■
3.2 V6 (Z 32 SE)	ch- 31068239	Gasolina	FWD	3175	155	211	05.03-05.08	■
3.0 CDTi (Y 30 DT)	ch- 31068239	Diesel	FWD	2958	130	177	05.03-05.08	■
3.0 V6 CDTi (Z 30 DT)	ch- 31068239	Diesel	FWD	2959	135	184	07.05-06.08	■
VECTRA Mk II (C) (Z02) 10.03-05.09					Estate (Large family car-D Segment)			
2.8 V6 Turbo (Z 28 NEL)		Gasolina	FWD	2792	169	230	08.05-05.09	■
VECTRA Mk II (C) (Z02) 01.00-10.08					Saloon (Large family car-D Segment)			
2.8 V6 Turbo		Gasolina	FWD	2792	169	230	08.05-07.08	■

LISTA DE APLICACIONES - BUYERS GUIDE

VECTRA Mk II (C) GTS (Z02) 08.02-05.09				Hatchback (Large family car-D Segment)				
2.8 V6 Turbo (Z 28 NEL)	Gasolina	FWD	2792	169	230	08.05-05.09	■	