

# LISTA DE APLICACIONES - BUYERS GUIDE

## 78BD9042-2



Weight: 9.916

O.E.M.	MAKE
5 69 001	OPEL
5 69 042	OPEL
90 250 546	VAUXHALL
90 295 087	VAUXHALL
90 487 402	VAUXHALL
96 179 110	LOTUS
9617 9110	DAEWOO

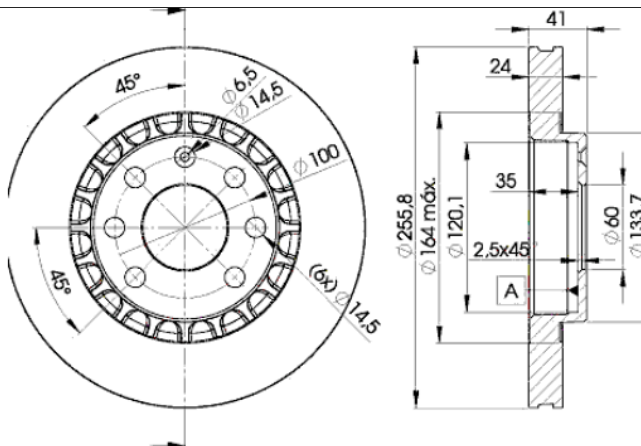

## 78BD9042-2

E1 90R-02C0433/0057



Ø256x24x41

MAKE
CHEVROLET
DAEWOO
FSO
LOTUS
OPEL
VAUXHALL
ZAZ



Trac.	CC	Kw	CV
-------	----	----	----



Front / Rear

### CHEVROLET

#### LANOS 11.05-

#### Saloon (Supermini car-B Segment)

1.6 16V (L44(96CUL4))	Gasolina	FWD	1598	78	106	11.05-12.10	■
-----------------------	----------	-----	------	----	-----	-------------	---

#### VECTRA 03.96-11.06

#### Saloon (Large family car-D Segment)

2.0 (LE4(122CUL4))	Gasolina	FWD	1998	81	110	03.96-12.05	■
--------------------	----------	-----	------	----	-----	-------------	---

### DAEWOO

#### ARANOS 01.95-11.97

#### Saloon (Executive car-E Segment)

1.5 (V15L)	Gasolina	FWD	1498	66	90	01.95-11.97	■
1.8 (Y18L)	Gasolina	FWD	1796	70	95	01.95-11.97	■
2.0 (C20LE)	Gasolina	FWD	1998	77	105	01.95-11.97	■
2.0	Gasolina	FWD	1998	81	110	01.95-11.97	■

#### CIELO 06.94-12.07

#### Saloon (Supermini car-B Segment)

1.5 (Y15L)	Gasolina	FWD	1498	55	75	04.95-07.97	■
1.5	Gasolina	FWD	1498	59	80	01.95-11.00	■
1.5 (V15L)	Gasolina	FWD	1498	66	90	06.94-07.98	■
1.5	Gasolina	FWD	1498	70	95	06.94-03.95	■

#### ESPERO (KLEJ) 10.91-09.99

#### Saloon (Executive car-E Segment)

1.5	Gasolina	FWD	1498	55	75	10.97-09.99	■
1.5 16V (A15MF)	Gasolina	FWD	1498	65	88	10.93-09.94	■
1.5 16V (A15MF)	Gasolina	FWD	1498	66	90	02.95-06.99	■
1.8 (C18LE)	Gasolina	FWD	1796	66	90	02.95-09.99	■
1.8 (C18LE)	Gasolina	FWD	1796	70	95	02.95-06.99	■
2.0 (C20LZ)	Gasolina	FWD	1998	74	101	10.91-09.93	■

# LISTA DE APLICACIONES - BUYERS GUIDE

2.0 (C20LE)		Gasolina	FWD	1998	77	105	02.95-06.99	■
2.0 (C20LE)		Gasolina	FWD	1998	81	110	10.93-12.97	■
<b>LANOS (KLAT) 02.97-</b>					<b>Saloon (Supermini car-B Segment)</b>			
1.6 16V (L44(98CUL4))		Gasolina	FWD	1598	78	106	02.97-	■
<b>LANOS / SENS (KLAT) 04.97-</b>					<b>Hatchback (Supermini car-B Segment)</b>			
1.6 16V (L44(98CUL4))		Gasolina	FWD	1598	78	106	05.97-	■
<b>LEMANS 09.90-05.97</b>					<b>Saloon (Supermini car-B Segment)</b>			
1.5 (G15MG)		Gasolina	FWD	1498	65	88	09.90-07.95	■
1.6 (A16D)		Gasolina	FWD	1598	55	75	09.90-07.95	■
<b>NEXIA / CIELO 02.95-08.97</b>					<b>Hatchback (Supermini car-B Segment)</b>			
1.5 (08, 68) (G15MF)	Rim 14	Gasolina	FWD	1498	44	60	08.96-08.97	■
1.5 (08, 68) (G15MF)	Rim 14	Gasolina	FWD	1498	52	71	02.95-08.97	■
1.5 (08, 68) (G15MF)		Gasolina	FWD	1498	55	75	02.95-08.97	■
1.5 16V (08, 68) (A15MF)	Rim 14	Gasolina	FWD	1498	66	90	02.95-08.97	■
<b>NEXIA / CIELO 02.95-06.08</b>					<b>Saloon (Supermini car-B Segment)</b>			
1.5 (19) (G15MF)	Rim 14	Gasolina	FWD	1498	44	60	08.96-08.97	■
1.5 (19) (G15MF)	Rim 14	Gasolina	FWD	1498	52	71	02.95-08.97	■
1.5 (19) (G15MF)	Rim 14	Gasolina	FWD	1498	55	75	02.95-08.97	■
1.5 16V (19) (A15MF)	Rim 14	Gasolina	FWD	1498	66	90	02.95-08.97	■
1.6 (19) (LXV)		Gasolina	FWD	1598	80	109	08.97-06.08	■
1.8 (19) (C18LE)		Gasolina	FWD	1796	74	101	02.95-06.08	■
<b>PRINCE (J19) 08.90-08.99</b>					<b>Saloon (Executive car-E Segment)</b>			
1.8 (C18LE)		Gasolina	RWD	1796	76	103	08.93-08.98	■
<b>FSO</b>								
<b>LANOS 05.04-10.08</b>					<b>Hatchback (Supermini car-B Segment)</b>			
1.6 16V (A16DMS)		Gasolina	FWD	1598	78	106	05.04-10.08	■
<b>LANOS 05.04-10.08</b>					<b>Saloon (Supermini car-B Segment)</b>			
1.6 16V (A16DMS)		Gasolina	FWD	1598	78	106	05.04-10.08	■
<b>LOTUS</b>								
<b>ELAN 09.89-11.95</b>					<b>Convertible (Sports car-S Segment)</b>			
1.6 i 16V (4XE1)		Gasolina	FWD	1588	97	132	09.89-11.95	■
1.6 i 16V Turbo (4XE1-T)		Gasolina	FWD	1588	115	156	09.91-11.95	■
1.6 i 16V Turbo (4XE1-T)		Gasolina	FWD	1588	123	167	09.89-11.95	■
<b>OPEL</b>								
<b>ASCONA C (J82) 09.81-08.88</b>					<b>Hatchback (Executive car-E Segment)</b>			
2.0 i GT (F68, M68) (20 SEH)		Gasolina	FWD	1998	95	130	03.87-08.88	■
<b>ASCONA C (J82) 09.81-10.88</b>					<b>Saloon (Executive car-E Segment)</b>			
2.0 i GT (F11, M11, F68, M68) (20 SEH)		Gasolina	FWD	1998	95	130	03.87-08.88	■
<b>ASTRA F (T92) 03.93-03.01</b>					<b>Convertible (Compact car-C Segment)</b>			
1.8 i 16V (C 18 XEL)		Gasolina	FWD	1799	85	116	11.94-03.01	■
1.8 i 16V (X 18 XE)		Gasolina	FWD	1799	85	116	11.94-03.01	■
2.0 i (C 20 NE)		Gasolina	FWD	1998	85	115	03.93-10.94	■
<b>ASTRA F (T92) 10.91-01.99</b>					<b>Estate Van (Compact car-C Segment)</b>			
1.6 i 16V (F70) (X 16 XEL)		Gasolina	FWD	1598	74	100	08.94-03.98	■
1.7 TD (F70) (17 TD)		Diesel	FWD	1686	60	82	03.95-02.98	■

# LISTA DE APLICACIONES - BUYERS GUIDE

ASTRA F (T92) 09.91-01.01					Estate (Compact car-C Segment)			
1.4 i 16V (F35, M35) (X 14 XE)	reinforced brakes	Gasolina	FWD	1389	66	90	02.96-01.98	■
1.6 i 16V (F35, M35) (X 16 XEL)		Gasolina	FWD	1598	74	100	08.94-01.98	■
1.8 (F35, M35) (18 SE)		Gasolina	FWD	1796	85	116	11.91-07.93	■
1.8 i 16V (F35, M35) (C 18 XEL)		Gasolina	FWD	1799	85	116	07.94-01.98	■
1.8 i 16V (F35, M35) (X 18 XE)		Gasolina	FWD	1799	85	116	07.94-01.98	■
1.8 i 16V (F35, M35) (C 18 XE)	-08/94	Gasolina	FWD	1799	92	125	06.93-01.98	■
2.0 i (F35, M35) (C 20 NE)		Gasolina	FWD	1998	85	115	09.91-07.94	■
2.0 i 16V (F35, M35) (X 20 XEV)		Gasolina	FWD	1998	100	136	02.95-01.98	■
2.0 i 16V (F35, M35) (C 20 XE)		Gasolina	FWD	1998	110	150	03.93-01.98	■
ASTRA F (T92) 09.91-10.00					Hatchback (Compact car-C Segment)			
1.4 i (F08, M08, F68, M68) (C 14 NZ)	reinforced brakes	Gasolina	FWD	1389	44	60	09.91-01.98	■
1.4 i (F08, M08, F68, M68) (X 14 NZ)	reinforced brakes	Gasolina	FWD	1389	44	60	09.91-01.98	■
1.4 (F08, M08, F68, M68) (14 NV)	reinforced brakes	Gasolina	FWD	1389	55	75	09.91-09.93	■
1.4 (F08, M08, F68, M68) (14 SE)	reinforced brakes	Gasolina	FWD	1389	60	82	09.92-01.98	■
1.4 Si (F08, M08, F68, M68) (C 14 SE)	reinforced brakes	Gasolina	FWD	1389	60	82	03.92-01.98	■
1.4 i 16V (F08, M08, F68, M68) (X 14 XE)	reinforced brakes	Gasolina	FWD	1389	66	90	09.96-02.98	■
1.6 i 16V (F08, M08, F68, M68) (X 16 XEL)		Gasolina	FWD	1598	74	100	08.94-01.98	■
1.8 (F08, M08, F68, M68) (18 SE)		Gasolina	FWD	1796	85	116	11.91-07.93	■
1.8 i 16V (F08, M08, F68, M68) (C 18 XEL)		Gasolina	FWD	1799	85	116	09.94-01.98	■
1.8 i 16V (F08, M08, F68, M68) (X 18 XE)		Gasolina	FWD	1799	85	116	09.94-01.98	■
1.8 i 16V (F08, M08, F68, M68) (C 18 XE)		Gasolina	FWD	1799	92	125	06.93-08.94	■
2.0 i (F08, M08, F68, M68) (C 20 NE)	-08/94	Gasolina	FWD	1998	85	115	09.91-01.98	■
2.0 i 16V (F08, M08, F68, M68) (X 20 XEV)		Gasolina	FWD	1998	100	136	02.95-01.98	■
2.0 GSi 16V (F08, M08, F68, M68) (C 20 XE)		Gasolina	FWD	1998	110	150	09.91-01.98	■
1.7 TDS (F08, M08, F68, M68) (17 TD)	reinforced brakes	Diesel	FWD	1686	60	82	12.91-01.98	■
1.7 D (F08, M08, F68, M68) (17 D)	reinforced brakes	Diesel	FWD	1699	42	57	12.91-09.92	■
1.7 D (F08, M08, F68, M68) (17 DR)	reinforced brakes	Diesel	FWD	1699	44	60	07.92-01.98	■
1.7 TD (F08, M08, F68, M68) (X 17 DTL)	reinforced brakes	Diesel	FWD	1699	50	68	11.94-01.98	■
ASTRA F (T92) 09.91-01.01					Saloon (Compact car-C Segment)			
1.4 i (F19, M19) (C 14 NZ)	reinforced brakes	Gasolina	FWD	1389	44	60	09.91-09.98	■
1.4 i (F19, M19) (X 14 NZ)	reinforced brakes	Gasolina	FWD	1389	44	60	09.91-09.98	■
1.4 (F19, M19) (14 NV)	reinforced brakes	Gasolina	FWD	1389	55	75	09.91-09.93	■
1.4 (F19, M19) (14 SE)	reinforced brakes	Gasolina	FWD	1389	60	82	09.92-09.98	■
1.4 Si (F19, M19) (C 14 SE)	reinforced brakes	Gasolina	FWD	1389	60	82	03.92-09.98	■
1.4 i 16V (F19, M19) (X 14 XE)	reinforced brakes	Gasolina	FWD	1389	66	90	02.96-09.98	■
1.6 i 16V (F19, M19) (X 16 XEL)		Gasolina	FWD	1598	74	100	08.94-09.98	■
1.6 Si (F19, M19) (C 16 SE)		Gasolina	FWD	1598	74	100	05.92-12.94	■
1.8 i 16V (F19, M19) (18 SE)		Gasolina	FWD	1796	82	112	09.95-09.96	■
1.8 i 16V (F19, M19) (C 18 SEL)	-02/98	Gasolina	FWD	1799	85	116	11.94-09.98	■
1.8 i 16V (F19, M19) (C 18 XEL)	-02/98	Gasolina	FWD	1799	85	116	11.94-09.98	■
1.8 i 16V (F19, M19) (X 18 XE)	-02/98	Gasolina	FWD	1799	85	116	11.94-09.98	■
1.8 i 16V (F19, M19) (C 18 XE)		Gasolina	FWD	1799	92	125	06.93-10.94	■
2.0 i (F19, M19) (C 20 NE)	-08/94	Gasolina	FWD	1998	85	115	03.92-09.98	■
2.0 i 16V (F19, M19) (X 20 XEV)	-02/98	Gasolina	FWD	1998	100	136	02.95-09.98	■
1.7 TDS (F19, M19) (17 TD)	reinforced brakes	Diesel	FWD	1686	60	82	03.92-09.98	■
1.7 D (F19, M19) (17 D)	reinforced brakes	Diesel	FWD	1699	42	57	03.92-09.92	■
1.7 D (F19, M19) (17 DR)	reinforced brakes	Diesel	FWD	1699	44	60	07.92-09.98	■
1.7 TD (F19, M19) (X 17 DTL)	reinforced brakes	Diesel	FWD	1699	50	68	11.94-09.98	■

# LISTA DE APLICACIONES - BUYERS GUIDE

<b>ASTRA F CLASSIC (T92) 01.98-01.05</b>						<b>Estate (Compact car-C Segment)</b>			
1.6 i 16V (F35, M35) (X 16 XEL)	-08/02	Gasolina	FWD	1598	74	101	01.98-01.05	■	
<b>ASTRA F CLASSIC (T92) 01.98-08.02</b>						<b>Hatchback (Compact car-C Segment)</b>			
1.6 i 16V (F08, M08, F68, M68) (X 16 XEL)		Gasolina	FWD	1598	74	101	01.98-08.02	■	
<b>ASTRA F CLASSIC (T92) 01.98-08.02</b>						<b>Saloon (Compact car-C Segment)</b>			
1.6 i 16V (F19, M19) (X 16 XEL)	-02/98	Gasolina	FWD	1598	74	101	01.98-08.02	■	
<b>CALIBRA (C89) 08.89-07.97</b>						<b>Coupe (Sports car-S Segment)</b>			
2.0 i (M07) (C 20 NE)		Gasolina	FWD	1998	85	115	08.89-12.96	■	
2.0 i 4x4 (M07) (C 20 NE)		Gasolina	4WD	1998	85	115	06.90-07.97	■	
2.0 i 16V (M07) (X 20 XEV)		Gasolina	FWD	1998	100	136	02.94-07.97	■	
2.0 i 16V 4x4 (M07) (X 20 XEV)		Gasolina	4WD	1998	100	136	02.94-07.97	■	
2.0 i 16V (M07) (C 20 XE)		Gasolina	FWD	1998	110	150	06.90-02.94	■	
2.0 i 16V 4x4 (M07) (C 20 XE)		Gasolina	4WD	1998	110	150	06.90-02.94	■	
<b>CORSA A (S83) 02.86-09.94</b>						<b>Hatchback Van (LCVs-N1 Segment)</b>			
1.0 (F08, W5L) (10 S)	09/87-	Gasolina	FWD	993	33	45	02.86-04.89	■	
<b>CORSA A (S83) 09.82-03.93</b>						<b>Hatchback (Supermini car-B Segment)</b>			
1.0 (F08, M08, F68, M68) (10 S)	09/87-, -08/91	Gasolina	FWD	993	33	45	09.82-03.93	■	
<b>CORSA A (S83) 09.82-03.93</b>						<b>Saloon (Supermini car-B Segment)</b>			
1.0 (F11, M11, F19, M19) (10 S)	09/87-, -08/91	Gasolina	FWD	993	33	45	09.82-09.92	■	
<b>KADETT E (T85) 10.86-02.93</b>						<b>Convertible (Compact car-C Segment)</b>			
2.0 i (20 NE)		Gasolina	FWD	1998	85	115	10.86-02.93	■	
2.0 i (20 SER)		Gasolina	FWD	1998	85	115	10.86-02.93	■	
2.0 i Cat (20 SER)		Gasolina	FWD	1998	85	116	10.86-02.93	■	
2.0 i Cat (C 20 NE)		Gasolina	FWD	1998	85	116	10.86-02.93	■	
2.0 (C 20 XE)		Gasolina	FWD	1998	110	150	09.90-05.92	■	
2.0 GSi (20 XE)		Gasolina	FWD	1998	115	156	09.90-05.92	■	
<b>KADETT E (T85) 09.84-08.91</b>						<b>Estate (Compact car-C Segment)</b>			
1.8 S (C15, C35, D15, D35) (E 18 NV)		Gasolina	FWD	1796	62	84	09.87-08.91	■	
1.8 S (C15, C35, D15, D35) (S 18 NV)		Gasolina	FWD	1796	62	84	09.87-08.91	■	
1.8 i (C15, C35, D15, D35) (C 18 NT)		Gasolina	FWD	1796	66	90	06.85-08.91	■	
1.8 i (C15, C35, D15, D35) (C 18 NZ)		Gasolina	FWD	1796	66	90	06.85-08.91	■	
1.8 E (C15, C35, D15, D35) (C 18 NE)		Gasolina	FWD	1796	74	100	10.85-08.86	■	
1.8 i (C15, C35, D15, D35) (18 E)		Gasolina	FWD	1796	85	115	09.84-08.86	■	
1.8 i (C15, C35, D15, D35) (18 SE)		Gasolina	FWD	1796	85	115	09.84-08.86	■	
2.0 i (C15, C35, D15, D35) (20 NE)		Gasolina	FWD	1998	85	115	09.87-08.91	■	
2.0 i Cat (C15, C35, D15, D35) (C 20 NE)		Gasolina	FWD	1998	85	115	09.87-08.91	■	
<b>KADETT E (T85) 09.84-12.93</b>						<b>Hatchback (Compact car-C Segment)</b>			
1.3 i Cat (C08, C48, D08, D48) (C 13 N)		Gasolina	FWD	1297	44	60	09.85-08.91	■	
1.3 N (C08, C48, D08, D48) (13 N)		Gasolina	FWD	1297	44	60	09.84-08.91	■	
1.3 N (C08, C48, D08, D48) (13 NB)		Gasolina	FWD	1297	44	60	09.84-08.91	■	
1.8 S (C08, C48, D08, D48) (E 18 NV)	Eq.V_ GT	Gasolina	FWD	1796	62	84	09.87-08.91	■	
1.8 S (C08, C48, D08, D48) (S 18 NV)	Eq.V_ GT	Gasolina	FWD	1796	62	84	09.87-08.91	■	
1.8 i (C08, C48, D08, D48) (C 18 NT)	Eq.V_ GT	Gasolina	FWD	1796	66	90	06.85-08.91	■	
1.8 i (C08, C48, D08, D48) (C 18 NZ)	Eq.V_ GT	Gasolina	FWD	1796	66	90	06.85-08.91	■	
1.8 E (C08, C48, D08, D48) (C 18 NE)	Eq.V_ GT	Gasolina	FWD	1796	74	100	10.85-08.86	■	
2.0 GSi (C08, C48, D08, D48) (20 NE)		Gasolina	FWD	1998	85	115	09.86-08.91	■	
2.0 GSi Cat (C08, C48, D08, D48) (C 20 NE)		Gasolina	FWD	1998	85	115	09.86-08.91	■	

# LISTA DE APLICACIONES - BUYERS GUIDE

2.0 GSI (C08, C48, D08, D48) (20 SEH)		Gasolina	FWD	1998	95	129	09.86-08.91	■
2.0 GSI 16V (C08, C48, D08, D48) (20 XEJ)		Gasolina	FWD	1998	110	150	03.88-08.91	■
2.0 GSI 16V Cat (C08, C48, D08, D48) (C 20 XE)		Gasolina	FWD	1998	110	150	03.88-08.91	■
2.0 GSI 16V (C08, C48, D08, D48) (20 XE)		Gasolina	FWD	1998	115	156	12.87-08.91	■
<b>KADETT E / MONZA E (T85) 09.84-12.93</b>					<b>Saloon (Compact car-C Segment)</b>			
1.3 i Cat (C19, D19) (C 13 N)		Gasolina	FWD	1297	44	60	09.85-08.91	■
1.3 N (C19, D19) (13 N)		Gasolina	FWD	1297	44	60	09.84-08.89	■
1.3 N (C19, D19) (13 NB)		Gasolina	FWD	1297	44	60	09.84-08.89	■
1.3 S (C19, D19) (13 S)		Gasolina	FWD	1297	55	75	09.84-08.87	■
1.8 S (C19, D19) (E 18 NV)		Gasolina	FWD	1796	62	84	09.87-08.91	■
1.8 S (C19, D19) (S 18 NV)		Gasolina	FWD	1796	62	84	09.87-08.91	■
1.8 i (C19, D19) (18 SV)		Gasolina	FWD	1796	66	90	08.89-05.92	■
1.8 i (C19, D19) (C 18 NT)		Gasolina	FWD	1796	66	90	08.89-05.92	■
1.8 i (C19, D19) (C 18 NZ)		Gasolina	FWD	1796	66	90	08.89-05.92	■
1.8 i (C19, D19) (C 18 NE)		Gasolina	FWD	1796	74	100	10.85-08.86	■
1.8 (C19, D19) (18 E)		Gasolina	FWD	1796	84	114	09.87-08.90	■
1.8 i (C19, D19) (18 E)		Gasolina	FWD	1796	85	115	09.84-08.86	■
1.8 i (C19, D19) (18 SE)		Gasolina	FWD	1796	85	115	09.84-08.86	■
2.0 i (C19, D19) (20 NE)		Gasolina	FWD	1998	85	115	09.87-05.92	■
2.0 i (C19, D19) (20 SE)		Gasolina	FWD	1998	85	115	09.87-05.92	■
2.0 i Cat (C19, D19) (C 20 NE)		Gasolina	FWD	1998	85	115	03.87-05.92	■
2.0 (C19, D19) (20 NE)		Gasolina	FWD	1998	95	129	01.86-12.93	■
<b>VECTRA A (J89) 04.88-12.95</b>					<b>Hatchback (Large family car-D Segment)</b>			
1.8 i Cat (F68, M68) (C 18 NZ)	08/91-	Gasolina	FWD	1796	66	90	03.90-11.95	■
2.0 (F68, M68) (C 20 NEF)		Gasolina	FWD	1998	74	100	04.88-09.89	■
2.0 i (F68, M68) (20 NE)		Gasolina	FWD	1998	85	115	09.88-10.90	■
2.0 i Cat (F68, M68) (C 20 NE)		Gasolina	FWD	1998	85	116	09.88-11.95	■
2.0 i GT (F68, M68) (20 SEH)		Gasolina	FWD	1998	95	129	09.88-11.95	■
2.0 i 16V (F68, M68) (X 20 XEV)		Gasolina	FWD	1998	100	136	08.92-08.95	■
2.0		Gasolina	FWD	1998	110	150	08.89-08.95	■
2.0 i 16V (F68, M68) (20 XEJ)		Gasolina	FWD	1998	110	150	02.89-10.90	■
2.0 i 16V Cat (F68, M68) (C 20 XE)		Gasolina	FWD	1998	110	150	02.90-11.95	■
<b>VECTRA A (J89) 08.88-12.95</b>					<b>Saloon (Large family car-D Segment)</b>			
1.8 S 4x4 (F19, M19) (E 18 NVR)		Gasolina	4WD	1796	65	88	01.89-07.89	■
2.0 (F19, M19) (C 20 NEF)		Gasolina	FWD	1998	74	100	09.88-09.89	■
2.0 i (F19, M19) (20 NE)		Gasolina	FWD	1998	85	115	09.88-10.90	■
2.0 i 4x4 (F19, M19) (20 NE)		Gasolina	4WD	1998	85	115	01.89-10.90	■
2.0 i Cat (F19, M19) (C 20 NE)		Gasolina	FWD	1998	85	116	09.88-11.95	■
2.0 i Cat 4x4 (F19, M19) (C 20 NE)		Gasolina	4WD	1998	85	116	01.89-11.95	■
2.0 i (F19, M19) (20 SEH)		Gasolina	FWD	1998	95	129	09.88-09.92	■
2.0 i 4x4 (F19, M19) (20 SEH)		Gasolina	4WD	1998	95	129	08.89-07.92	■
2.0 i 16V (F19, M19) (X 20 XEV)		Gasolina	FWD	1998	100	136	08.92-08.95	■
2.0 i 16V 4x4 (F19, M19) (X 20 XEV)		Gasolina	4WD	1998	100	136	06.94-11.95	■
2000/GT 16V (F19, M19) (20 XEJ)		Gasolina	FWD	1998	110	150	01.89-06.94	■
2000/GT 16V Cat (F19, M19) (C 20 XE)		Gasolina	FWD	1998	110	150	02.90-11.95	■
2000/GT 16V Cat 4x4 (F19, M19) (C 20 XE)		Gasolina	4WD	1998	110	150	02.90-11.95	■
2000 16V 4x4 (F19, M19) (20 XEJ)		Gasolina	4WD	1998	110	150	01.89-10.90	■
<b>VECTRA B (J96) 11.96-07.03</b>					<b>Estate (Large family car-D Segment)</b>			
1.6 i (F35) (X 16 SZR)	-04/99	Gasolina	FWD	1598	55	75	11.96-06.00	■

# LISTA DE APLICACIONES - BUYERS GUIDE

1.6 i (F35) (16 LZ2)	-04/99	Gasolina	FWD	1598	55	75	11.96-06.00	■
1.6 i 16V (F35) (X 16 XEL)	-04/99	Gasolina	FWD	1598	74	100	11.96-07.02	■
1.6 i 16V (F35) (Y 16 XE)	-04/99	Gasolina	FWD	1598	74	100	11.96-07.02	■
1.6 i 16V (F35) (Z 16 XE)	-04/99	Gasolina	FWD	1598	74	100	11.96-07.02	■
1.8 i 16V (F35) (X 18 XE1)	-04/99	Gasolina	FWD	1796	85	115	11.96-09.00	■
1.8 i 16V (F35) (Z 18 XEL)	-04/99	Gasolina	FWD	1796	85	115	11.96-09.00	■
1.8 i 16V (F35) (X 18 XE)		Gasolina	FWD	1799	85	116	11.96-09.00	■
1.7 TD (F35) (X 17 DT (TC4EE1))		Diesel	FWD	1686	60	82	11.96-12.97	■
2.0 DI 16V (F35) (X 20 DTL)	-04/99	Diesel	FWD	1995	60	82	11.96-06.00	■
2.0 DTI 16V (F35) (X 20 DTH)	-04/99	Diesel	FWD	1995	74	101	06.97-07.03	■
2.0 DTI 16V (F35) (Y 20 DTH)	-04/99	Diesel	FWD	1995	74	101	06.97-07.03	■
<b>VECTRA B (J96) 09.95-07.03</b>					<b>Hatchback (Large family car-D Segment)</b>			
1.6 i (F68) (X 16 SZR)	-04/99	Gasolina	FWD	1598	55	75	10.95-07.03	■
1.6 i (F68) (16 LZ2)	-04/99	Gasolina	FWD	1598	55	75	10.95-07.03	■
1.6 i 16V (F68) (X 16 XEL)	-04/99	Gasolina	FWD	1598	74	101	10.95-07.02	■
1.6 i 16V (F68) (Y 16 XE)	-04/99	Gasolina	FWD	1598	74	101	10.95-07.02	■
1.6 i 16V (F68) (Z 16 XE)	-04/99	Gasolina	FWD	1598	74	101	10.95-07.02	■
1.8 i 16V (F68) (X 18 XE1)	-04/99	Gasolina	FWD	1796	85	116	10.95-09.00	■
1.8 i 16V (F68) (Z 18 XEL)	-04/99	Gasolina	FWD	1796	85	116	10.95-09.00	■
1.8 i 16V (F68) (X 18 XE)		Gasolina	FWD	1799	85	116	10.95-09.00	■
1.8 FlexFuel (F68) (X 18 XE)		Gasol./G as (LPG)	FWD	1799	85	116	01.99-09.00	■
1.7 TD (F68) (X 17 DT (TC4EE1))		Diesel	FWD	1686	60	82	10.95-12.98	■
2.0 DI 16V (F68) (X 20 DTL)		Diesel	FWD	1995	60	82	11.96-06.00	■
2.0 DTI 16V (F68) (X 20 DTH)	-04/99	Diesel	FWD	1995	74	101	06.97-07.03	■
2.0 DTI 16V (F68) (Y 20 DTH)	-04/99	Diesel	FWD	1995	74	101	06.97-07.03	■
<b>VECTRA B (J96) 09.95-07.04</b>					<b>Saloon (Large family car-D Segment)</b>			
1.6 i (F19) (X 16 SZR)	-04/99	Gasolina	FWD	1598	55	75	10.95-04.02	■
1.6 i (F19) (16 LZ2)	-04/99	Gasolina	FWD	1598	55	75	10.95-04.02	■
1.6 GL (F19) (16 SV)		Gasolina	FWD	1598	60	82	09.95-08.96	■
1.6 i 16V (F19) (X 16 XEL)	-04/99	Gasolina	FWD	1598	74	100	10.95-04.02	■
1.6 i 16V (F19) (Y 16 XE)	-04/99	Gasolina	FWD	1598	74	100	10.95-04.02	■
1.6 i 16V (F19) (Z 16 XE)	-04/99	Gasolina	FWD	1598	74	100	10.95-04.02	■
1.8 i 16V (F19) (X 18 XE1)	-04/99	Gasolina	FWD	1796	85	115	10.95-09.00	■
1.8 i 16V (F19) (Z 18 XEL)	-04/99	Gasolina	FWD	1796	85	115	10.95-09.00	■
1.8 i 16V (F19) (X 18 XE)		Gasolina	FWD	1799	85	116	10.95-09.00	■
1.7 TD (F19) (X 17 DT (TC4EE1))		Diesel	FWD	1686	60	82	10.95-12.98	■
2.0 DI 16V (F19) (X 20 DTL)	-04/99	Diesel	FWD	1995	60	82	11.96-04.02	■
2.0 DTI 16V (F19) (X 20 DTH)	-04/99	Diesel	FWD	1995	74	101	06.97-04.02	■
2.0 DTI 16V (F19) (Y 20 DTH)	-04/99	Diesel	FWD	1995	74	101	06.97-04.02	■
<b>VAUXHALL</b>								
<b>ASTRA Mk II (T85) 01.87-09.93</b>					<b>Convertible (Compact car-C Segment)</b>			
2.0 i (20 NE)		Gasolina	FWD	1998	85	115	01.87-12.91	■
2.0 i (C 20 NE)		Gasolina	FWD	1998	85	115	01.87-12.91	■
2.0 i Cat (C 20 NE)		Gasolina	FWD	1998	85	115	01.91-08.93	■
<b>ASTRA Mk II (T85) 09.84-08.91</b>					<b>Estate (Compact car-C Segment)</b>			
1.3 (13 S)		Gasolina	FWD	1297	55	75	09.84-08.91	■
<b>ASTRA Mk II BELMONT (T85) 09.85-12.91</b>					<b>Saloon (Compact car-C Segment)</b>			
1.3 (13 S)		Gasolina	FWD	1297	55	75	09.85-08.91	■

# LISTA DE APLICACIONES - BUYERS GUIDE

ASTRA Mk II CC (T85) 09.84-08.91					Hatchback (Compact car-C Segment)			
1.3		Gasolina	FWD	1297	44	60	09.84-08.91	■
1.3 (13 S)		Gasolina	FWD	1297	55	75	09.84-08.91	■
2.0 (20 NE)		Gasolina	FWD	1998	85	115	09.86-08.91	■
2.0 GTE (20 SEH)		Gasolina	FWD	1998	95	129	09.86-08.91	■
1.9 (C 20 XE)		Gasolina	FWD	1998	110	149	03.88-08.91	■
2.0 GTE 16V (20 XE)		Gasolina	FWD	1998	115	156	05.88-08.91	■
ASTRA Mk III (F) (T92) 09.91-03.01					Convertible (Compact car-C Segment)			
1.4 i	reinforced brakes	Gasolina	FWD	1389	60	82	05.93-03.01	■
1.4 i 16V	reinforced brakes	Gasolina	FWD	1389	66	90	01.96-03.01	■
1.8 16V (C 18 XEL)		Gasolina	FWD	1799	85	116	11.94-03.01	■
1.8 16V (X 18 XE)		Gasolina	FWD	1799	85	116	11.94-03.01	■
2.0 i (C 20 NE)		Gasolina	FWD	1998	85	115	03.93-10.94	■
2.0 i 16V (X 20 XEV)		Gasolina	FWD	1998	100	136	01.94-02.98	■
ASTRA Mk III (F) (T92) 03.91-12.98					Estate (Compact car-C Segment)			
1.4 S	reinforced brakes	Gasolina	FWD	1389	55	75	09.91-02.98	■
1.4 i (C 14 SE)	reinforced brakes	Gasolina	FWD	1389	60	82	03.91-02.98	■
1.4 i 16V (X 14 XE)	reinforced brakes	Gasolina	FWD	1389	66	90	02.96-01.98	■
1.6 i 16V (X 16 XEL)		Gasolina	FWD	1598	74	100	01.94-02.98	■
1.8 i 16V (C 18 XEL)		Gasolina	FWD	1796	85	115	09.94-02.98	■
1.8 i 16V (C 18 XE)		Gasolina	FWD	1796	92	125	09.94-02.98	■
2.0 i (C 20 NE)		Gasolina	FWD	1998	85	115	09.91-02.98	■
2.0 i 16V (X 20 XEV)		Gasolina	FWD	1998	100	136	01.94-02.98	■
1.7 TD (17 TD)	reinforced brakes	Diesel	FWD	1686	60	82	12.91-02.98	■
1.7 D (17 D)	reinforced brakes	Diesel	FWD	1699	42	57	12.91-02.98	■
1.7 D (17 DR)	reinforced brakes	Diesel	FWD	1699	44	60	03.91-12.94	■
1.7 TD (X 17 DTL)	reinforced brakes	Diesel	FWD	1700	50	68	01.94-02.98	■
ASTRA Mk III (F) (T92) 09.91-02.98					Hatchback (Compact car-C Segment)			
1.4 i (C 14 NZ)	reinforced brakes	Gasolina	FWD	1389	44	60	09.91-02.98	■
1.4 i (X 14 NZ)	reinforced brakes	Gasolina	FWD	1389	44	60	09.91-02.98	■
1.4 S (14 NV)	reinforced brakes	Gasolina	FWD	1389	55	75	09.91-02.98	■
1.4 i (C 14 SE)	reinforced brakes	Gasolina	FWD	1389	60	82	03.92-02.98	■
1.4 i 16V (X 14 XE)	reinforced brakes	Gasolina	FWD	1389	66	90	02.96-02.98	■
1.6 i 16V (X 16 XEL)		Gasolina	FWD	1598	74	101	01.94-02.98	■
1.8 i 16V (C 18 XEL)		Gasolina	FWD	1796	85	115	09.94-02.98	■
1.8 i 16V (C 18 XE)		Gasolina	FWD	1796	92	125	09.94-02.98	■
2.0 i (C 20 NE)		Gasolina	FWD	1998	85	115	09.91-02.98	■
2.0 i 16V (X 20 XEV)		Gasolina	FWD	1998	100	136	01.94-02.98	■
2.0 i 16V (C 20 XE)		Gasolina	FWD	1998	110	150	09.91-02.98	■
1.7 TD (17 TD)	reinforced brakes	Diesel	FWD	1686	60	82	12.91-02.98	■
1.7 D (17 D)	reinforced brakes	Diesel	FWD	1699	42	57	12.91-02.98	■
1.7 D (17 DR)	reinforced brakes	Diesel	FWD	1699	44	60	09.91-12.94	■
1.7 TD (X 17 DTL)	reinforced brakes	Diesel	FWD	1700	50	68	08.94-02.98	■
ASTRA Mk III (F) (T92) 09.91-09.98					Saloon (Compact car-C Segment)			
1.4 i (C 14 SE)	reinforced brakes	Gasolina	FWD	1389	60	82	04.92-09.98	■
1.4 i 16V (X 14 XE)	reinforced brakes	Gasolina	FWD	1389	66	90	02.96-09.98	■
1.6 i 16V (X 16 XEL)		Gasolina	FWD	1598	74	100	08.94-09.98	■
1.8 i 16V (18 SE)		Gasolina	FWD	1796	82	112	09.95-02.98	■
1.8 i 16V (C 18 XEL)		Gasolina	FWD	1796	85	115	01.94-12.96	■

# LISTA DE APLICACIONES - BUYERS GUIDE

1.8 i 16V (C 18 XE)		Gasolina	FWD	1799	92	125	06.93-10.94	■
2.0 i (C 20 NE)		Gasolina	FWD	1998	85	115	03.92-09.98	■
2.0 i 16V (X 20 XEV)		Gasolina	FWD	1998	100	136	02.95-09.98	■
1.7 TD (17 TD)	reinforced brakes	Diesel	FWD	1686	60	82	12.91-09.98	■
1.7 D (17 D)	reinforced brakes	Diesel	FWD	1699	42	57	03.92-09.92	■
1.7 D (17 DR)	reinforced brakes	Diesel	FWD	1699	44	60	07.92-09.98	■
1.7 TD (X 17 DTL)	reinforced brakes	Diesel	FWD	1700	50	68	08.94-09.98	■
<b>ASTRAVAN Mk III (F) (T92) 01.91-08.98</b>					<b>Estate Van (Compact car-C Segment)</b>			
1.7 TD (F70) (17 TD)		Diesel	FWD	1686	60	82	09.95-08.96	■
1.7 D (F70) (17 D)		Diesel	FWD	1699	42	57	09.91-08.93	■
<b>CALIBRA (C89) 06.90-07.97</b>					<b>Coupe (Sports car-S Segment)</b>			
2.0 i (C 20 NE)		Gasolina	FWD	1998	85	115	06.90-07.97	■
2.0 i 4x4 (C 20 NE)		Gasolina	4WD	1998	85	115	06.90-07.97	■
2.0 i 16V (X 20 XEV)		Gasolina	FWD	1998	100	136	06.90-07.97	■
2.0 i 16V 4x4 (X 20 XEV)		Gasolina	4WD	1998	100	136	02.94-07.97	■
2.0 i 16V (C 20 XE)		Gasolina	FWD	1998	110	150	06.90-02.94	■
2.0 i 16V 4x4 (C 20 XE)		Gasolina	4WD	1998	110	150	06.90-02.94	■
<b>CAVALIER Mk III (J89) 08.88-11.95</b>					<b>Saloon (Large family car-D Segment)</b>			
2.0 i (20 NE)		Gasolina	FWD	1998	85	115	09.88-10.90	■
2.0 i (C 20 NE)		Gasolina	FWD	1998	85	115	09.88-10.90	■
2.0 i 4x4 (20 NE)		Gasolina	4WD	1998	85	115	01.91-10.92	■
2.0 i 4x4 (C 20 NE)		Gasolina	4WD	1998	85	115	01.91-10.92	■
2.0 i Cat (20 NE)		Gasolina	FWD	1998	85	115	09.88-11.95	■
2.0 i Cat (C 20 NE)		Gasolina	FWD	1998	85	115	09.88-11.95	■
2.0 i 4x4 (20 SEH)		Gasolina	4WD	1998	95	129	09.88-08.92	■
2.0 SRi (20 SEH)		Gasolina	FWD	1998	95	129	09.88-08.92	■
2.0 SRi 16V (X 20 XEV)		Gasolina	FWD	1998	100	136	09.92-08.95	■
2.0 i 16V (C 20 XE)	09/92-	Gasolina	FWD	1998	110	150	09.88-11.95	■
2.0 i 16V 4x4 (C 20 XE)		Gasolina	4WD	1998	110	150	09.88-11.95	■
2.0 GSi		Gasolina	FWD	1998	115	156	09.89-08.92	■
2.0 GSi 4x4 (20 XE)		Gasolina	4WD	1998	115	156	09.89-08.92	■
<b>CAVALIER Mk III CC (J89) 09.88-11.95</b>					<b>Hatchback (Large family car-D Segment)</b>			
2.0 i (20 NE)		Gasolina	FWD	1998	85	115	09.88-10.92	■
2.0 i 4x4 (89) (20 NE)		Gasolina	4WD	1998	85	115	09.91-10.92	■
2.0 i 4x4 (89) (C 20 NE)		Gasolina	4WD	1998	85	115	09.91-10.92	■
2.0 i Cat (20 NE)		Gasolina	FWD	1998	85	115	09.90-11.95	■
2.0 i Cat (C 20 NE)		Gasolina	FWD	1998	85	115	09.90-11.95	■
2.0 i 4x4		Gasolina	4WD	1998	95	129	09.88-09.92	■
2.0 SRi (20 SEH)		Gasolina	FWD	1998	95	129	09.88-09.92	■
2.0 i 16V (X 20 XEV)		Gasolina	FWD	1998	100	136	09.92-08.95	■
2.0 i 16V (C 20 XE)	09/92-	Gasolina	FWD	1998	110	150	09.88-11.95	■
2.0 i 16V 4x4 (C 20 XE)	09/92-	Gasolina	4WD	1998	110	150	01.92-11.93	■
<b>VECTRA (B) (J96) 08.95-03.02</b>					<b>Estate (Large family car-D Segment)</b>			
1.6 i	-04/99	Gasolina	FWD	1598	55	75	11.96-03.02	■
1.6 i 16V	-04/99	Gasolina	FWD	1598	74	100	11.96-03.02	■
1.8 i 16V (F35) (X 18 XE1)	-04/99	Gasolina	FWD	1796	85	115	11.96-09.00	■
1.8 i 16V (F35) (X 18 XE)		Gasolina	FWD	1799	85	116	09.96-09.00	■
1.8 Dualfuel (F35) (Z 18 XE)		Gasol./G as (LPG)	FWD	1796	92	125	09.00-03.02	■



# LISTA DE APLICACIONES - BUYERS GUIDE

2.0 DI 16V (F35) (X 20 DTL)	-04/99	Diesel	FWD	1995	60	82	08.95-10.01	■
2.0 DTI 16V (F35) (X 20 DTH)	-04/99	Diesel	FWD	1995	74	101	08.95-10.01	■
2.0 DTI 16V (F35) (Y 20 DTH)	-04/99	Diesel	FWD	1995	74	101	08.95-10.01	■
<b>VECTRA (B) (J96) 08.95-07.03</b>					<b>Hatchback (Large family car-D Segment)</b>			
1.6 i (F68) (X 16 SZR)	-04/99	Gasolina	FWD	1598	55	75	08.95-10.01	■
1.6 i 16V (F68) (X 16 XEL)	-04/99	Gasolina	FWD	1598	74	101	08.95-10.01	■
1.6 i 16V (F68) (Y 16 XE)	-04/99	Gasolina	FWD	1598	74	101	08.95-10.01	■
1.6 i 16V (F68) (Z 16 XE)	-04/99	Gasolina	FWD	1598	74	101	08.95-10.01	■
1.8 i 16V (F68) (X 18 XE1)	-04/99	Gasolina	FWD	1796	85	116	10.95-09.00	■
1.8 i 16V (F68) (X 18 XE)		Gasolina	FWD	1799	85	116	09.95-09.00	■
1.8 Dualfuel (F68) (Z 18 XE)		Gasol./Gas (LPG)	FWD	1796	92	125	09.00-07.03	■
1.7 TD (F68)		Diesel	FWD	1686	60	82	10.95-11.96	■
2.0 DI 16V (F68) (X 20 DTL)	-04/99	Diesel	FWD	1995	60	82	08.95-10.01	■
2.0 DTI 16V (F68) (X 20 DTH)	-04/99	Diesel	FWD	1995	74	101	06.97-10.01	■
2.0 DTI 16V (F68) (Y 20 DTH)	-04/99	Diesel	FWD	1995	74	101	06.97-10.01	■
<b>VECTRA (B) (J96) 08.95-03.02</b>					<b>Saloon (Large family car-D Segment)</b>			
1.6 i (F19) (X 16 SZR)	-04/99	Gasolina	FWD	1598	55	75	08.95-10.01	■
1.6 i 16V (F19) (X 16 XEL)	-04/99	Gasolina	FWD	1598	74	100	08.95-10.01	■
1.6 i 16V (F19) (Y 16 XE)	-04/99	Gasolina	FWD	1598	74	100	08.95-10.01	■
1.6 i 16V (F19) (Z 16 XE)	-04/99	Gasolina	FWD	1598	74	100	08.95-10.01	■
1.8 i 16V (F19) (X 18 XE1)		Gasolina	FWD	1796	85	115	10.95-09.00	■
1.8 i 16V (F19) (X 18 XE)	-04/99	Gasolina	FWD	1799	85	116	10.95-09.00	■
1.8 Dualfuel (F19) (Z 18 XE)		Gasol./Gas (LPG)	FWD	1796	92	125	09.00-03.02	■
1.7 TD (F19)		Diesel	FWD	1686	60	82	10.95-11.96	■
2.0 DI 16V (F19) (X 20 DTL)	-05/99	Diesel	FWD	1995	60	82	08.95-10.01	■
2.0 DTI 16V (F19) (X 20 DTH)	-05/99	Diesel	FWD	1995	74	101	08.95-10.01	■
2.0 DTI 16V (F19) (Y 20 DTH)	-05/99	Diesel	FWD	1995	74	101	08.95-10.01	■
<b>ZAZ</b>								
<b>LANOS / SENS-CHANCE (TA_, TF_) 10.04-</b>					<b>Hatchback (Supermini car-B Segment)</b>			
1.6 16V (A16DMS)		Gasolina	FWD	1598	78	106	04.10-02.17	■
<b>LANOS / SENS-CHANCE (TA_, TF_) 10.04-</b>					<b>Saloon (Supermini car-B Segment)</b>			
1.6 16V (TF69YO) (A16DMS)		Gasolina	FWD	1598	78	106	10.04-02.17	■