

# LISTA DE APLICACIONES - BUYERS GUIDE

## 78BD9050-2

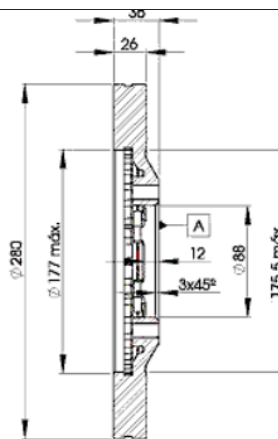

Weight: 13.372

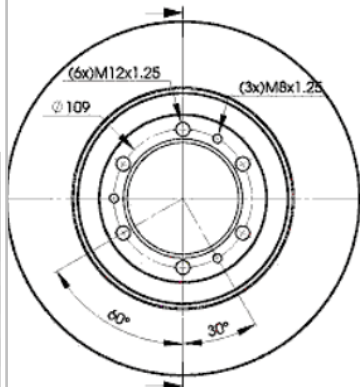

## 78BD9050-2

**E1 90R-02C0452/0078**



Ø280x26x36

### MAKE

- ACURA
- GREAT WALL
- HOLDEN
- ISUZU
- OPEL
- VAUXHALL

O.E.M.	MAKE
5 69 050	OPEL
5-69050	ISUZU
89 43 754 163	VAUXHALL
89 437 54 163	OPEL
8-94375-416-3	ISUZU
8-97034-034-3	ISUZU
97 034 034	VAUXHALL
9-70340-34	ISUZU



Trac.	CC	Kw	CV
-------	----	----	----



### ACURA

						Closed Off-Road Vehicle (Executive SUV-J Segment)		
<b>SLX 11.95-09.99</b>								
3.2 4WD (6VD1 (DOHC))	Gasolina	4WD	3165	140	190	11.95-09.99	■	

### GREAT WALL

						SUV (Compact SUV-J Segment)		
<b>HOVER H3 / HAVAL H3 09.06-</b>								
2.4 A las 4 ruedas (4G69-S4N)	Gasolina	4WD	2378	100	136	07.10-12.13	■	

						SUV (Compact SUV-J Segment)		
<b>HOVER H5 / HAVAL 5 06.10-</b>								
2.0 TD (GW4D20)	Diesel	RWD	1996	110	150	10.10-12.14	■	
2.0 TD 4WD (GW4D20)	Diesel	4WD	1996	110	150	10.10-12.14	■	
2.5 TCI	Diesel	RWD	2499	80	109	06.10-12.13	■	
2.5 TCI A las 4 ruedas	Diesel	4WD	2499	80	109	06.10-12.11	■	

### HOLDEN

						Closed Off-Road Vehicle (Compact SUV-J Segment)		
<b>FRONTERA (UES) 02.99-04.04</b>								
2.0 i 4x4	Gasolina	4WD	1998	85	115	10.95-03.99	■	
2.2 i 4x4	Gasolina	4WD	2198	96	131	02.99-07.02	■	

### ISUZU

						Closed Off-Road Vehicle (Compact SUV-J Segment)		
<b>MU / CAMEO ( _ U ) 02.89-08.02</b>								
3.0 D 4x4 (UES73EW) (4JX1-TC)	Diesel	4WD	2999	107	146	06.98-08.02	■	
3.1 TD 4x4 (UCS69)	Diesel	4WD	3059	88	120	08.93-05.98	■	
3.2	Diesel	RWD	3165	158	215	06.98-08.02	■	

						Closed Off-Road Vehicle (Pick-Up Truck)		
<b>RODEO (U.S.A.) 09.90-12.97</b>								
2.2 (X 22 SE)	Gasolina	RWD	2198	97	132	09.97-12.03	■	

# LISTA DE APLICACIONES - BUYERS GUIDE

2.2 4WD (X 22 SE)		Gasolina	4WD	2198	97	132	09.97-12.03	■	
2.6		Gasolina	RWD	2559	89	121	09.90-12.97	■	
2.6 4WD		Gasolina	4WD	2559	89	121	09.90-12.97	■	
3.1		Gasolina	RWD	3135	90	122	09.90-12.92	■	
3.1 4WD		Gasolina	4WD	3135	90	122	09.90-12.92	■	
3.2		Gasolina	RWD	3165	130	177	09.92-12.95	■	
3.2 4WD		Gasolina	4WD	3165	130	177	09.92-12.95	■	
3.2		Gasolina	RWD	3165	142	193	09.95-12.97	■	
3.2 4WD		Gasolina	4WD	3165	142	193	09.95-12.97	■	
3.2 V6		Gasolina	RWD	3165	151	205	09.97-08.04	■	
3.5		Gasolina	RWD	3494	187	254	09.03-08.04	■	
3.5 4WD		Gasolina	4WD	3494	187	254	09.03-08.04	■	
2.8 TDI		Diesel	RWD	2771	84	114	09.99-08.04	■	
2.8 TDI 4x4		Diesel	4WD	2771	84	114	09.99-08.04	■	
<b>TROOPER II (UB) 08.91-04.00</b>							<b>Closed Off-Road Vehicle (Executive SUV-J Segment)</b>		
2.6 4x4 (4ZE1)		Gasolina	4WD	2559	85	116	08.91-04.96	■	
3.2 (6VD1 (SOHC))		Gasolina	4WD	3165	130	177	08.91-07.98	■	
3.5 V6 24V AWD (6VE1)		Gasolina	4WD	3494	158	215	04.00-08.04	■	
3.5		Gasolina	RWD	3494	160	218	05.98-12.02	■	
3.0 DTI (4JX1)		Diesel	4WD	2999	117	159	05.98-08.04	■	
3.1 TD (4JG2 T)		Diesel	4WD	3059	84	114	08.91-07.98	■	
<b>TROOPER II (UB) 08.91-07.98</b>							<b>Open Off-Road Vehicle (Executive SUV-J Segment)</b>		
2.6 4x4 (4ZE1)		Gasolina	4WD	2559	85	116	08.91-04.96	■	
3.2 (6VD1 (SOHC))		Gasolina	4WD	3165	130	177	08.91-07.98	■	
3.5 V6 24V (6VE1)		Gasolina	4WD	3494	158	215	04.00-08.04	■	
3.0 DTI (4JX1T)		Diesel	4WD	2999	118	160	04.00-08.04	■	
3.1 TD (4JG2 T)		Diesel	4WD	3059	84	114	08.91-07.98	■	
<b>VEGA 08.98-08.04</b>							<b>Closed Off-Road Vehicle (Compact SUV-J Segment)</b>		
2.2		Gasolina	FWD	2198	97	132	08.98-08.04	■	
3.2		Gasolina	FWD	3165	151	205	08.98-08.04	■	
3.2		Gasolina	FWD	3165	151	205	08.98-08.04	■	
2.8 TD		Diesel	RWD	2771	88	120	08.98-12.02	■	
3.0 D		Diesel	RWD	2999	88	120	01.99-12.02	■	
<b>WIZARD ( _ U _ ) 01.93-12.04</b>							<b>Closed Off-Road Vehicle (Compact SUV-J Segment)</b>		
3.2 4x4 (UES25, UER25FW) (6VD1 (DOHC))		Gasolina	4WD	3165	158	215	06.98-08.02	■	
3.0 TD 4x4 (UES73) (4JX1-TC)		Diesel	4WD	2999	107	146	06.98-08.02	■	
3.1 TD		Diesel	RWD	3059	88	120	12.95-05.00	■	
<b>OPEL</b>									
<b>FRONTERA A (U92) 03.92-10.98</b>							<b>Closed Off-Road Vehicle (Compact SUV-J Segment)</b>		
2.2 i (54MWL4) (X 22 XE)		Gasolina	4WD	2198	100	136	03.95-10.98	■	
2.4 i (53MWL4) (C 24 NE)		Gasolina	4WD	2410	92	125	03.92-10.98	■	
2.3 TD (5JMWL4) (23 DTR)		Diesel	4WD	2260	74	100	03.92-10.98	■	
2.5 TDS (25TD)		Diesel	4WD	2499	85	115	09.96-10.98	■	
2.8 TD (5BMW4, 5BSUD2) (28TD)		Diesel	4WD	2771	83	113	03.95-08.98	■	
<b>FRONTERA A Sport (U92) 03.92-10.98</b>							<b>Open Off-Road Vehicle (Compact SUV-J Segment)</b>		
2.0 i (52SUD2, 55SUD2) (C 20 NE)	03/95-	Gasolina	4WD	1998	85	115	03.92-10.98	■	
2.0 i (52SUD2, 55SUD2) (X 20 SE)	03/95-	Gasolina	4WD	1998	85	115	03.92-10.98	■	
2.5 TDS (25TD)		Diesel	4WD	2499	85	115	09.96-10.98	■	

# LISTA DE APLICACIONES - BUYERS GUIDE

2.8 TD (5BSUD2) (28TD)		Diesel	4WD	2771	83	113	03.95-08.96	■
<b>FRONTERA B (U99) 09.98-07.04</b>				<b>Closed Off-Road Vehicle (Compact SUV-J Segment)</b>				
2.2 i (6B_ZC, 6B_VF, 6B_66, 6B_76) (X 22 SE)		Gasolina	4WD	2198	100	136	10.98-07.04	■
2.2 i (6B_ZC, 6B_VF, 6B_66, 6B_76) (Y 22 SE)		Gasolina	4WD	2198	100	136	10.98-07.04	■
3.2 i (6B1VF, 6B1_6) (6VD1 (DOHC))		Gasolina	4WD	3165	151	205	10.98-07.04	■
3.2 i (6B1VF, 6B1_6) (Y 32 NE)		Gasolina	4WD	3165	151	205	10.98-07.04	■
2.2 DTI (6B_ZC, 6B_VF, 6B_66, 6B_76) (X 22 DTH)		Diesel	4WD	2171	85	116	09.98-12.03	■
2.2 DTI (6B_ZC, 6B_VF, 6B_66, 6B_76) (Y 22 DTH)		Diesel	4WD	2171	85	116	09.98-12.03	■
2.2 DTI (6B_66, 6B_76) (Y 22 DTH)		Diesel	4WD	2171	88	120	09.02-07.04	■
<b>MONTEREY II (M92) 08.91-07.98</b>				<b>Closed Off-Road Vehicle (Executive SUV-J Segment)</b>				
3.2 (UBS25D, UBS25G) (6VD1 (SOHC))		Gasolina	4WD	3165	130	177	08.91-03.94	■
3.5 V6 24V (UBS26D, UBS26G) (6 VE1)		Gasolina	4WD	3494	158	215	07.98-08.99	■
3.0 DTI (UBS73D, UBS73G) (4 JX1)		Diesel	4WD	2999	117	159	07.98-08.99	■
3.1 TD (UBS69D, UBS69G) (4 JG2TC)		Diesel	4WD	3059	84	114	09.91-07.98	■
<b>VAUXHALL</b>								
<b>FRONTERA Mk I (A) (U92) 09.91-10.98</b>				<b>Closed Off-Road Vehicle (Compact SUV-J Segment)</b>				
2.0 (C 20 NE)		Gasolina	4WD	1998	85	115	04.95-08.98	■
2.0 (X 20 SE)		Gasolina	4WD	1998	85	115	04.95-08.98	■
2.2 i (X 22 XE)		Gasolina	4WD	2198	100	136	03.95-10.98	■
2.4 i (C 24 NE)	03/95-	Gasolina	4WD	2410	92	125	03.92-10.98	■
2.3 TD (23 DTR)	03/95-	Diesel	4WD	2260	74	100	09.91-06.98	■
2.5 TDS (25TDS (VM41B))		Diesel	4WD	2499	85	115	11.91-06.98	■
2.8 TD (28 TDI (4JB1-T))		Diesel	4WD	2771	83	113	01.95-12.96	■
<b>FRONTERA Mk I (A) Sport (U92) 03.92-10.98</b>				<b>Open Off-Road Vehicle (Compact SUV-J Segment)</b>				
2.0 i (C 20 NE)	03/95-	Gasolina	4WD	1998	85	115	03.92-10.98	■
2.0 i (X 20 SE)	03/95-	Gasolina	4WD	1998	85	115	03.92-10.98	■
2.5 TDS (25TDS (VM41B))		Diesel	4WD	2499	85	115	09.96-10.98	■
2.8 TD (28 TDI (4JB1-T))		Diesel	4WD	2771	83	113	01.95-12.96	■
<b>FRONTERA Mk II (B) (U99) 10.98-10.04</b>				<b>Closed Off-Road Vehicle (Compact SUV-J Segment)</b>				
2.2 i (X 22 SE)		Gasolina	4WD	2198	100	136	10.98-10.04	■
2.2 i (Y 22 SE)		Gasolina	4WD	2198	100	136	10.98-10.04	■
3.2 i (6VD1 (DOHC))		Gasolina	4WD	3165	151	205	10.98-10.04	■
2.2 DTI (X 22 DTH)		Diesel	4WD	2171	85	116	10.98-09.04	■
2.2 DTI (Y 22 DTH)		Diesel	4WD	2171	85	116	10.98-09.04	■
<b>MONTEREY (M92) 09.91-07.98</b>				<b>Closed Off-Road Vehicle (Executive SUV-J Segment)</b>				
3.2 (6VD1 (SOHC))		Gasolina	4WD	3165	130	177	06.92-07.98	■
3.1 TD (4 JG2TC)		Diesel	4WD	3059	84	114	09.91-07.98	■
<b>MONTEREY MK II (M98) 07.98-08.99</b>				<b>Closed Off-Road Vehicle (Executive SUV-J Segment)</b>				
3.5 V6 24V (6 VE1)		Gasolina	4WD	3494	158	215	07.98-08.99	■
3.0 DTI (4 JX1)		Diesel	4WD	2999	117	159	07.98-08.99	■