

LISTA DE APLICACIONES - BUYERS GUIDE

78BD9054-2



Weight: 14.292

O.E.M.	MAKE
5 69 053	OPEL
90 487 103	VAUXHALL

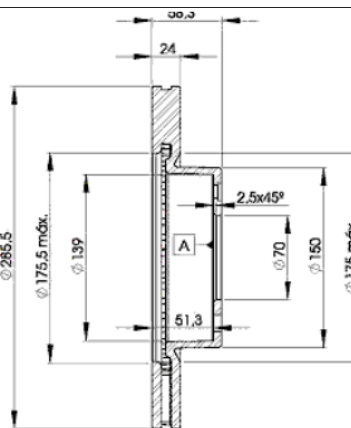
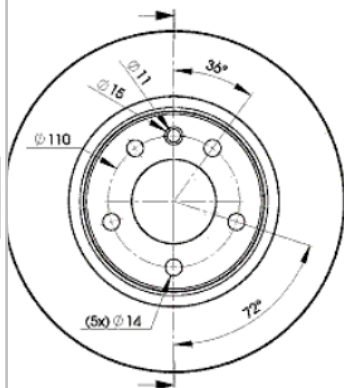

78BD9054-2

E1 90R-02C0452/0083



Ø286x24x58.4

MAKE
OPEL
VAUXHALL



Trac.	CC	Kw	CV		
					Front / Rear

OPEL

OMEGA B (V94) 03.94-07.03

Estate (Executive car-E Segment)

2.0 (F35, M35, P35)	Gasolina	RWD	1984	90	122	05.94-05.99	■
2.0 (F35, M35, P35) (X 20 SE)	Gasolina	RWD	1998	85	116	03.94-09.99	■
2.0 16V (F35, M35, P35) (X 20 XEV)	Gasolina	RWD	1998	100	136	03.94-09.99	■

OMEGA B (V94) 03.94-12.05

Saloon (Executive car-E Segment)

2.0 (F69, M69, P69)	Gasolina	RWD	1984	90	122	05.94-05.99	■
2.0 (F69, M69, P69) (X 20 SE)	Gasolina	RWD	1998	85	116	03.94-09.99	■
2.0 (F69, M69, P69) (20 SE)	Gasolina	RWD	1998	85	115	03.94-12.00	■
2.0 16V (F69, M69, P69) (X 20 XEV)	Gasolina	RWD	1998	100	136	03.94-09.99	■

VAUXHALL

OMEGA (B) (V94) 12.93-06.03

Estate (Executive car-E Segment)

2.0 (X 20 SE)	Gasolina	RWD	1998	85	116	03.94-09.99	■
2.0 16V (X 20 XEV)	Gasolina	RWD	1998	100	136	03.94-07.01	■
2.0 Dualfuel (X 20 XEV)	Gasol./G as (LPG)	RWD	1998	100	136	01.99-07.01	■

OMEGA (B) (V94) 12.93-07.03

Saloon (Executive car-E Segment)

2.0 (20 SE)	Gasolina	RWD	1998	85	116	03.94-09.99	■
2.0 (X 20 SE)	Gasolina	RWD	1998	85	116	03.94-09.99	■
2.0 (20 SE)	Gasolina	RWD	1998	85	115	09.95-09.96	■
2.0 (X 20 SE)	Gasolina	RWD	1998	85	115	09.95-09.96	■
2.0 16V (X 20 XEV)	Gasolina	RWD	1998	100	136	03.94-07.01	■
2.0 Dualfuel (X 20 XEV)	Gasol./G as (LPG)	RWD	1998	100	136	05.98-07.01	■