

# LISTA DE APLICACIONES - BUYERS GUIDE

## 78BD9057-2



Weight: 14.200

O.E.M.	MAKE
1802 1359	BUICK
18021359	CHEVROLET
5 69 057	OPEL
90 542 181	VAUXHALL

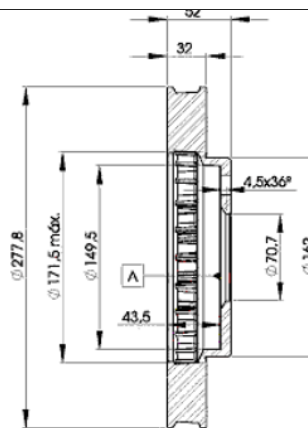
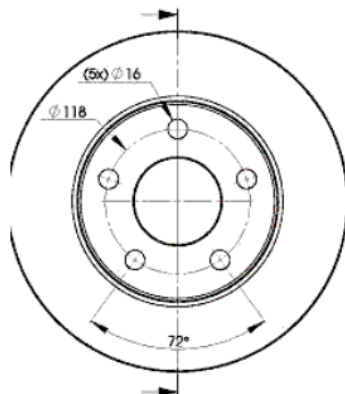

## 78BD9057-2



Ø278x32x52

MAKE
BUICK
CHEVROLET
OLDSMOBILE
OPEL
PONTIAC
VAUXHALL



Trac.	CC	Kw	CV		
					Front / Rear

### BUICK

CENTURY VI 10.96-02.05						Saloon (Large family car-D Segment)			
3.1 (L82(191CUV6))	01/97-, -12/01	Gasolina	FWD	3135	130	177	10.96-02.05	■	
LE SABRE VII 10.95-09.99						Saloon (Executive car-E Segment)			
3.8 (L36(231CUV6))	-01/97	Gasolina	FWD	3791	153	208	10.95-09.99	■	
LE SABRE VIII 01.99-						Saloon (Executive car-E Segment)			
3.8 (L36(231CUV6))	-12/01	Gasolina	FWD	3791	153	208	01.99-	■	
REGAL III 09.88-09.97						Saloon (Large family car-D Segment)			
3.1 (L82(191CUV6))	01/97-	Gasolina	FWD	3135	119	162	10.93-09.97	■	
3.8 (L36(231CUV6))	01/97-	Gasolina	FWD	3791	150	204	10.91-09.97	■	
REGAL IV (4WF_) 10.97-12.08						Saloon (Large family car-D Segment)			
2.0		Gasolina	FWD	1998	91	124	07.00-12.04	■	
2.5		Gasolina	FWD	2490	112	152	07.00-12.04	■	
3.8 (L36(231CUV6))		Gasolina	FWD	3791	149	203	10.02-09.04	■	
3.8 (L36(231CUV6))	-12/01	Gasolina	FWD	3791	153	208	10.97-10.04	■	
3.8 (L67)		Gasolina	FWD	3791	179	243	10.97-09.04	■	
3.8 (L67)		Gasolina	FWD	3791	200	272	10.97-12.04	■	
3.8 Supercharged (L67)	-12/01	Gasolina	FWD	3791	243	330	10.97-10.03	■	
RENDEZVOUS 04.00-12.07						SUV (Luxury Crossover SUV-J Segment)			
3.4		Gasolina	FWD	3350	138	188	04.00-09.06	■	

### CHEVROLET

# LISTA DE APLICACIONES - BUYERS GUIDE

TRANS SPORT (2U_) 11.96-09.03					Box Body/MPV (Large MPV-M1 Segment)			
3.4		Gasolina	FWD	3350	137	186	11.96-08.01	■
3.4		Gasolina	FWD	3350	138	188	09.01-09.03	
TRANS SPORT 08.96-09.05					MPV (Large MPV-M1 Segment)			
3.4 (LA1)	01/97-	Gasolina	FWD	3350	137	186	08.96-09.05	■
3.4 V6 (LA1)		Gasolina	FWD	3350	138	188	10.00-09.05	
3.4 V6 AWD (LA1)		Gasolina	4WD	3350	138	188	10.01-09.05	
VENTURE 09.96-12.05					MPV (Large MPV-M1 Segment)			
3.4 (LA1)		Gasolina	FWD	3350	130	177	04.98-09.04	■
3.4		Gasolina	FWD	3350	134	182	09.96-12.99	
3.4 AWD		Gasolina	4WD	3350	134	182	01.02-12.04	
3.4 (LA1)		Gasolina	FWD	3350	138	188	09.01-12.05	
OLDSMOBILE								
INTRIGUE (U.S.A.) 09.97-12.02					Saloon ()			
3.5 (LX5(212CUV6))		Gasolina	FWD	3473	160	218	09.98-12.02	■
3.8 (L36(231CUV6))		Gasolina	FWD	3791	145	197	09.97-12.99	
OPEL								
SINTRA (APV) 11.96-04.99					MPV (Large MPV-M1 Segment)			
2.2 i 16V (OUN16, Y94) (X 22 XE)		Gasolina	FWD	2198	104	141	11.96-04.99	■
3.0 i 24V (OUN16, Y94) (X 30 XE)		Gasolina	FWD	2962	148	201	11.96-04.99	
2.2 DTI (X 22 DTH)		Diesel	FWD	2171	85	116	07.97-04.99	
PONTIAC								
BONNEVILLE XI (U.S.A.) 09.99-12.05					Saloon (Luxury car-F Segment)			
3.8 (L36(231CUV6))		Gasolina	FWD	3791	153	208	09.99-12.05	■
GRAND PRIX VI 07.96-12.03					Coupe (Executive car-E Segment)			
3.1 (L82(191CUV6))		Gasolina	FWD	3135	119	162	09.96-12.97	■
3.8 GT (L36(231CUV6))		Gasolina	FWD	3791	145	197	07.96-07.99	
3.8 GT (L36(231CUV6))		Gasolina	FWD	3791	149	203	08.99-12.03	
3.8 GT Power (L67)		Gasolina	FWD	3791	179	243	07.96-12.03	
GRAND PRIX VI 07.96-12.03					Saloon (Executive car-E Segment)			
3.1 (L82(191CUV6))		Gasolina	FWD	3135	119	162	07.96-07.99	■
3.1 (L82(191CUV6))		Gasolina	FWD	3135	131	178	08.99-12.03	
3.8 (L36(231CUV6))		Gasolina	FWD	3791	145	197	07.96-07.99	
3.8 (L36(231CUV6))		Gasolina	FWD	3791	149	203	08.99-12.03	
3.8 GT Power (L67)		Gasolina	FWD	3791	179	243	07.96-12.03	
MONTANA 04.98-12.05					MPV (Large MPV-M1 Segment)			
3.4 (LA1)		Gasolina	FWD	3350	138	188	04.98-08.05	■
3.4 AWD (LA1)		Gasolina	4WD	3350	138	188	04.98-08.05	
TRANS SPORT II 11.96-08.98					Box Body/MPV (Large MPV-M1 Segment)			
3.4		Gasolina	FWD	3350	134	182	11.96-08.98	■
TRANS SPORT II 03.97-12.99					MPV (Large MPV-M1 Segment)			
3.4 (LA1)		Gasolina	FWD	3350	134	182	03.97-09.98	■
3.4 (LA1)		Gasolina	FWD	3350	137	186	09.98-12.99	
VAUXHALL								
SINTRA (APV) 09.96-04.99					MPV (Large MPV-M1 Segment)			
2.2 i 16V (X 22 XE)		Gasolina	FWD	2198	104	141	11.96-04.99	■

## LISTA DE APLICACIONES - BUYERS GUIDE

3.0 i 24V (X 30 XE)	Gasolina	FWD	2962	148	201	11.96-04.99	■
2.2 DTI (X 22 DTH)	Diesel	FWD	2171	85	116	07.97-04.99	■