

LISTA DE APLICACIONES - BUYERS GUIDE

78BD9077-2



Weight: 10.380

O.E.M.	MAKE
3 076 905 9	VOLVO

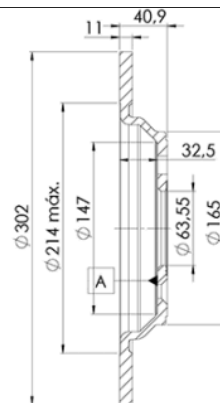
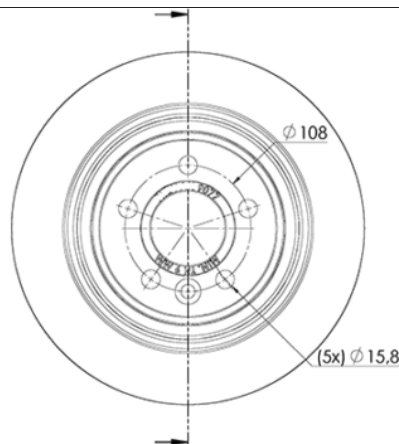

78BD9077-2



Ø302x11x40.9

MAKE
VOLVO
VOLVO ASIA



Trac.	CC	Kw	CV
-------	----	----	----



Front / Rear

VOLVO

S60 II (134) 04.10-					Saloon (Compact executive car-D Segment)				
T3 (B 4154 T4)		Gasolina	FWD	1498	112	152	03.15-05.18		■
T3 (B 4164 T3)	elec.brake detention	Gasolina	FWD	1596	110	150	04.10-12.15		■
T4 (B 4164 T)	elec.brake detention	Gasolina	FWD	1596	132	180	04.10-12.15		■
T3 (B 4204 T37)		Gasolina	FWD	1969	112	152	03.15-05.18		■
T4 (B 4204 T19)		Gasolina	FWD	1969	140	190	03.15-05.18		■
T5 (B 4204 T11)		Gasolina	FWD	1969	180	245	09.13-12.18		■
T5 AWD (B 4204 T11)		Gasolina	4WD	1969	180	245	07.14-12.18		■
T5 AWD		Gasolina	4WD	1969	180	245	06.16-12.18		■
T5 Drive-E Polestar AWD (B 4204 T11)		Gasolina	4WD	1969	186	253	06.16-05.18		■
T6 (B 4204 T9)		Gasolina	FWD	1969	225	306	09.13-12.18		■
2.0 T (B 5204 T8)		Gasolina	FWD	1984	132	180	05.12-12.15		■
T5 (B 5204 T9)		Gasolina	FWD	1984	157	214	11.13-03.15		■
2.0 T (B 4204 T6)	elec.brake detention	Gasolina	FWD	1999	149	203	04.10-12.11		■
T5 (B 4204 T7)	elec.brake detention	Gasolina	FWD	1999	177	240	04.10-12.14		■
T5 DRIVE (B 4204 T7)		Gasolina	FWD	1999	180	245	09.14-12.15		■
2.5 T		Gasolina	FWD	2497	183	249	01.13-01.16		■
T5 AWD (B 5254 T14)		Gasolina	4WD	2497	183	249	03.15-12.18		■
T5 AWD		Gasolina	4WD	2497	187	254	03.15-12.18		■
T5 AWD (B 5254 T5)		Gasolina	4WD	2521	186	253	09.12-12.15		■
T6 AWD (B 6304 T4)	elec.brake detention	Gasolina	4WD	2953	224	304	04.10-12.15		■
T6 AWD (B 6304 T3)		Gasolina	4WD	2953	242	329	04.14-12.15		■
T6 AWD (B 6304 T4)		Gasolina	4WD	2953	242	329	04.14-12.15		■
3.0 T AWD (B 6304 T5)		Gasolina	4WD	2953	258	351	04.14-12.18		■

LISTA DE APLICACIONES - BUYERS GUIDE

T4F (B 4164 T2)	elec.brake detention	Gasol./Etanol	FWD	1596	132	180	04.11-12.15	■
DRIVe / D2 (D 4162 T)	elec.brake detention	Diesel	FWD	1560	84	114	01.11-12.15	■
D2 (D 4204 T20)		Diesel	FWD	1969	88	120	03.15-05.18	■
D2 (D 4204 T8)		Diesel	FWD	1969	88	120	03.15-05.18	■
D3 (D 4204 T4)		Diesel	FWD	1969	110	150	03.15-05.18	■
D3 (D 4204 T9)		Diesel	FWD	1969	110	150	03.15-05.18	■
D3		Diesel	FWD	1969	110	150	03.15-05.18	■
D4 (D 4204 T5)		Diesel	FWD	1969	133	181	09.13-12.15	■
2.0 D4		Diesel	RWD	1969	140	190	03.15-	■
D4 (D 4204 T14)		Diesel	FWD	1969	140	190	03.15-05.18	■
D4		Diesel	FWD	1969	140	190	03.15-05.18	■
D4 Drive-E Polestar (D 4204 T14)		Diesel	FWD	1969	147	200	03.15-05.18	■
D4 Drive-E Polestar		Diesel	FWD	1969	147	200	03.15-05.18	■
D5 (D 4204 T11)		Diesel	FWD	1969	165	224	03.15-05.18	■
D5 Drive-E Polestar (D 4204 T11)		Diesel	FWD	1969	171	232	03.15-05.18	■
D3 (D 5204 T7)		Diesel	FWD	1984	100	136	05.12-12.15	■
D3 (D 5204 T2)	elec.brake detention	Diesel	FWD	1984	120	163	04.10-12.14	■
D3 (D 5204 T3)	elec.brake detention	Diesel	FWD	1984	120	163	04.10-12.14	■
D4 (D 5204 T3)		Diesel	FWD	1984	120	163	04.10-12.14	■
D4 AWD (D 5244 T21)		Diesel	4WD	2400	140	190	03.15-05.18	■
D4 AWD		Diesel	4WD	2400	140	190	03.15-05.18	■
D5 (D 5244 T10)	elec.brake detention	Diesel	FWD	2400	151	205	04.10-12.11	■
D5 AWD (D 5244 T10)	elec.brake detention	Diesel	4WD	2400	151	205	04.10-12.11	■
D5 (D 5244 T11)	elec.brake detention	Diesel	FWD	2400	158	215	04.11-12.15	■
D5 (D 5244 T15)	elec.brake detention	Diesel	FWD	2400	158	215	04.11-12.15	■
D5 AWD (D 5244 T15)	elec.brake detention	Diesel	4WD	2400	158	215	04.11-12.15	■
D4 Polestar AWD (D 5244 T21)		Diesel	4WD	2400	162	220	03.15-07.18	■
D5 (D 5244 T15)		Diesel	FWD	2400	169	230	04.14-12.15	■
D5 AWD (D 5244 T15)		Diesel	4WD	2400	169	230	04.14-12.15	■
S80 II (124) 03.06-					Saloon (Executive car-E Segment)			
T4 (B 4164 T)	elec.brake detention	Gasolina	FWD	1596	132	180	10.10-04.14	■
T5 (B 4204 T15)	elec.brake detention	Gasolina	FWD	1969	162	220	01.14-12.16	■
2.0 Drive- E (B 4204 T11)	elec.brake detention	Gasolina	FWD	1969	180	245	12.14-12.16	■
T5 (B 4204 T11)	elec.brake detention	Gasolina	FWD	1969	180	245	09.13-05.14	■
2.0 (B 4204 S3)	not leveling control	Gasolina	FWD	1999	107	146	01.08-09.12	■
2.0 T (B 4204 T6)	not leveling control	Gasolina	FWD	1999	149	203	01.10-05.11	■
T5 (B 4204 T7)	elec.brake detention	Gasolina	FWD	1999	177	241	10.10-12.16	■
2.5 T (B 5254 T14)	elec.brake detention	Gasolina	FWD	2497	183	249	09.12-12.16	■
2.5 T (B 5254 T12)	elec.brake detention	Gasolina	FWD	2497	187	254	01.12-04.16	■
2.5 T (B 5254 T6)	elec.brake detention	Gasolina	FWD	2521	147	200	03.06-12.11	■
2.5 T (B 5254 T10)	elec.brake detention	Gasolina	FWD	2521	170	231	01.10-12.12	■
T6 AWD (B 6304 T2)	elec.brake detention	Gasolina	4WD	2953	210	286	01.07-12.10	■
T6 AWD (B 6304 T4)	elec.brake detention	Gasolina	4WD	2953	224	305	10.10-12.15	■
3.2 (B 6324 S)	elec.brake detention	Gasolina	FWD	3192	175	238	03.06-12.10	■
3.2 AWD (B 6324 S)	elec.brake detention	Gasolina	4WD	3192	175	238	01.07-12.10	■
3.2 (B 6324 S5)	elec.brake detention	Gasolina	FWD	3192	179	243	01.10-12.14	■
3.2 AWD (B 6324 S5)	elec.brake detention	Gasolina	4WD	3192	179	243	01.10-12.14	■
4.4 V8 AWD (B 8444 S)	elec.brake detention	Gasolina	4WD	4414	232	316	03.06-03.12	■
T4F (B 4164 T2)	elec.brake detention	Gasol./Etanol	FWD	1596	132	180	05.11-01.14	■
2.0 FlexFuel (B 4204 S4)	elec.brake detention	Gasol./Etanol	FWD	1999	107	146	01.08-12.11	■

LISTA DE APLICACIONES - BUYERS GUIDE

2.5 T FlexFuel (B 5254 T8)	elec.brake detention	Gasol./Etanol	FWD	2521	147	200	05.08-12.11	■
2.5 T FlexFuel (B 5254 T11)	elec.brake detention	Gasol./Etanol	FWD	2521	170	231	01.10-12.11	■
3.2 Flexifuel AWD		Gasol./Etanol	4WD	3192	177	241	01.09-03.10	■
1.6 D DRIVe (D 4164 T)		Diesel	FWD	1560	80	109	01.10-12.11	■
1.6 DRIVe (D 4162 T)	elec.brake detention	Diesel	FWD	1560	84	114	06.11-01.14	■
D2		Diesel	FWD	1560	85	116	01.14-12.16	■
D4 (D 4204 T5)	elec.brake detention	Diesel	FWD	1969	133	181	09.13-12.16	■
D3 (D 5204 T7)		Diesel	FWD	1984	100	136	05.12-05.14	■
D3 / D4 (D 5204 T2)	elec.brake detention	Diesel	FWD	1984	120	163	01.10-12.16	■
D3 / D4 (D 5204 T3)	elec.brake detention	Diesel	FWD	1984	120	163	01.10-12.16	■
2.0 TDI (D 4204 T)	elec.brake detention	Diesel	FWD	1998	100	136	02.08-03.11	■
2.4 D (D 5244 T19)	elec.brake detention	Diesel	FWD	2400	120	163	03.06-03.11	■
2.4 D (D 5244 T5)	elec.brake detention	Diesel	FWD	2400	120	163	03.06-03.11	■
2.4 D (D 5244 T14)	elec.brake detention	Diesel	FWD	2400	129	175	01.10-03.11	■
D5 (D 5244 T4)	elec.brake detention	Diesel	FWD	2400	136	185	03.06-08.09	■
D5 AWD (D 5244 T4)	elec.brake detention	Diesel	4WD	2400	136	185	01.07-05.09	■
D5 (D 5244 T10)	elec.brake detention	Diesel	FWD	2400	151	205	01.10-12.11	■
D5 AWD (D 5244 T10)	elec.brake detention	Diesel	4WD	2400	151	205	01.10-12.11	■
D5 (D 5244 T11)	elec.brake detention	Diesel	FWD	2400	158	215	06.11-04.15	■
D5 (D 5244 T15)	elec.brake detention	Diesel	FWD	2400	158	215	06.11-04.15	■
D5 AWD (D 5244 T15)	elec.brake detention	Diesel	4WD	2400	158	215	06.11-04.15	■
V60 (155) 09.13-12.15					Estate Van (Compact executive car-D Segment)			
1.6 DRIVe (D 4162 T)	elec.brake detention	Diesel	FWD	1560	84	114	09.13-12.15	■
2.0 D3 (D 5204 T7)		Diesel	FWD	1984	100	136	09.13-12.15	■
2.0 D4 (D 5204 T3)		Diesel	FWD	1984	120	163	09.13-12.15	■
2.4 D4 AWD		Diesel	4WD	2400	133	181	09.13-12.15	■
2.4 D5 (D 5244 T15)		Diesel	FWD	2400	158	215	09.13-12.15	■
V60 (155) 07.10-					Estate (Compact executive car-D Segment)			
T3 (B 4154 T4)		Gasolina	FWD	1498	112	152	03.15-05.18	■
T3 (B 4164 T3)		Gasolina	FWD	1596	110	150	09.10-12.15	■
T4 (B 4164 T)		Gasolina	FWD	1596	132	180	09.10-12.15	■
T3 (B 4204 T37)		Gasolina	FWD	1969	112	152	03.15-05.18	■
T4 (B 4204 T19)		Gasolina	FWD	1969	140	190	03.15-05.18	■
T5 (B 4204 T15)		Gasolina	FWD	1969	162	220	01.14-12.17	■
T5 (B 4204 T11)		Gasolina	FWD	1969	180	245	10.13-12.18	■
T5 (B 4204 T41)		Gasolina	FWD	1969	180	245	10.13-12.18	■
T5		Gasolina	FWD	1969	180	245	03.15-05.18	■
T5 AWD (B 4204 T11)		Gasolina	4WD	1969	180	245	07.14-05.18	■
T5 AWD		Gasolina	4WD	1969	180	245	06.16-05.18	■
T5 Drive-E Polestar		Gasolina	FWD	1969	186	253	03.15-07.18	■
T5 Drive-E Polestar AWD (B 4204 T11)		Gasolina	4WD	1969	186	253	03.15-07.18	■
T6 (B 4204 T9)		Gasolina	FWD	1969	225	306	10.13-12.18	■
T6 AWD (B 4204 T9)		Gasolina	4WD	1969	225	306	10.13-12.18	■
2.0 Polestar AWD (B 4204 T43)		Gasolina	4WD	1969	270	367	06.15-05.18	■
2.0 T (B 5204 T8)		Gasolina	FWD	1984	132	180	01.14-07.18	■
T5 (B 5204 T9)		Gasolina	FWD	1984	157	214	10.13-05.18	■
2.0 T (B 4204 T6)		Gasolina	FWD	1999	149	203	07.10-12.12	■
T5 (B 4204 T7)		Gasolina	FWD	1999	177	241	09.10-12.14	■
T5 AWD (B 5254 T14)		Gasolina	4WD	2497	183	249	03.15-05.18	■

LISTA DE APLICACIONES - BUYERS GUIDE

T5 AWD (B 5254 T12)		Gasolina	4WD	2497	187	254	04.15-05.18	■
T5 AWD		Gasolina	4WD	2497	187	254	03.15-05.18	■
T6 (B 6304 T4)		Gasolina	FWD	2953	224	305	07.14-04.15	■
T6 AWD (B 6304 T4)		Gasolina	4WD	2953	224	305	07.10-12.15	■
T6 AWD (B 6304 T3)		Gasolina	4WD	2953	242	329	04.14-12.15	■
T6 AWD (B 6304 T4)		Gasolina	4WD	2953	242	329	04.14-12.15	■
3.0 T AWD (B 6304 T5)		Gasolina	4WD	2953	258	351	04.14-05.18	■
2.0 BiFuel (B 5204 T9)		Gasol./Gas (LPG)	FWD	1984	157	213	03.14-12.15	■
T4F (B 4164 T2)	elec.brake detention	Gasol./Etanol	FWD	1596	132	180	04.11-12.15	■
2.4 D6 Plug in Hybrid AWD	elec.brake detention	Diesel/eléc.	4WD	2400	158	215	06.12-12.15	■
D5 Hybrid AWD (D87PHEV)		Diesel/eléc.	4WD	2400	169	230	03.15-05.18	■
D6 Hybrid AWD (D82PHEV)		Diesel/eléc.	4WD	2400	206	280	06.12-12.15	■
D6 Hybrid AWD (D97PHEV)		Diesel/eléc.	4WD	2400	206	280	03.15-05.18	■
1.6 DRIVE (D 4162 T)	elec.brake detention	Diesel	FWD	1560	84	114	02.11-12.15	■
D2 (D 4204 T20)		Diesel	FWD	1969	88	120	03.15-05.18	■
D2 (D 4204 T8)		Diesel	FWD	1969	88	120	03.15-05.18	■
D2		Diesel	FWD	1969	88	120	03.15-05.18	■
D3 (D 4204 T4)		Diesel	FWD	1969	110	150	03.15-05.18	■
D3 (D 4204 T9)		Diesel	FWD	1969	110	150	03.15-05.18	■
D3		Diesel	FWD	1969	110	150	03.15-05.18	■
D4 (D 4204 T5)		Diesel	FWD	1969	133	181	10.13-12.15	■
D4 (D 4204 T14)		Diesel	FWD	1969	140	190	03.15-05.18	■
D4		Diesel	FWD	1969	140	190	03.15-05.18	■
D4 Drive-E Polestar (D 4204 T14)		Diesel	FWD	1969	147	200	03.15-05.18	■
D5 (D 4204 T11)		Diesel	FWD	1969	165	224	03.15-05.18	■
D5		Diesel	FWD	1969	165	224	03.15-05.18	■
D3 (D 5204 T7)		Diesel	FWD	1984	100	136	05.12-12.15	■
D3 / D4 (D 5204 T2)		Diesel	FWD	1984	120	163	07.10-12.14	■
D3 / D4 (D 5204 T3)		Diesel	FWD	1984	120	163	07.10-12.14	■
D4 AWD (D 5244 T17)		Diesel	4WD	2400	120	163	05.12-12.15	■
D4 AWD (D 5244 T12)		Diesel	4WD	2400	133	181	10.13-12.15	■
D4 AWD (D 5244 T21)		Diesel	4WD	2400	140	190	03.15-05.18	■
D4 AWD		Diesel	4WD	2400	140	190	03.15-05.18	■
D4 Polestar AWD (D 5244 T21)		Diesel	4WD	2400	147	200	03.15-05.18	■
D5 (D 5244 T10)		Diesel	FWD	2400	151	205	07.10-12.11	■
D5 AWD (D 5244 T10)		Diesel	4WD	2400	151	205	07.10-12.11	■
D5 (D 5244 T11)	elec.brake detention	Diesel	FWD	2400	158	215	04.11-12.15	■
D5 (D 5244 T15)	elec.brake detention	Diesel	FWD	2400	158	215	04.11-12.15	■
D5 AWD (D 5244 T15)	elec.brake detention	Diesel	4WD	2400	158	215	04.11-12.15	■
D4 Polestar AWD (D 5244 T21)		Diesel	4WD	2400	162	220	03.15-05.18	■
D5 (D 5244 T23)		Diesel	FWD	2400	169	230	04.14-12.15	■
D5 AWD (D 5244 T15)		Diesel	4WD	2400	169	230	04.14-12.15	■
V70 III (135) 09.13-					Estate Van (Executive car-E Segment)			
2.0 D3 DRIVE (D 5204 T7)	elec.brake detention	Diesel	FWD	1984	100	136	09.13-12.15	■
2.4 D4	elec.brake detention	Diesel	FWD	2400	120	163	09.13-	■
2.4 D4 AWD	elec.brake detention	Diesel	4WD	2400	120	163	09.13-12.15	■
2.4 D5 (D 5244 T11)	elec.brake detention	Diesel	FWD	2400	158	215	09.13-12.15	■
2.4 D5 (D 5244 T15)	elec.brake detention	Diesel	FWD	2400	158	215	09.13-12.15	■

LISTA DE APLICACIONES - BUYERS GUIDE

V70 III (135) 04.07-					Estate (Executive car-E Segment)			
T4 (B 4164 T)	elec.brake detention	Gasolina	FWD	1596	132	180	10.10-12.15	■
T4 (B 4204 T19)	elec.brake detention	Gasolina	FWD	1969	140	190	03.15-04.16	■
T5 (B 4204 T11)	elec.brake detention	Gasolina	FWD	1969	180	245	10.13-04.16	■
2.0 GDI (B 5204 T9)	elec.brake detention	Gasolina	FWD	1984	157	214	04.12-12.15	■
2.0 (B 4204 S3)	elec.brake detention	Gasolina	FWD	1999	107	145	10.07-12.11	■
2.0 T (B 4204 T6)	elec.brake detention	Gasolina	FWD	1999	149	203	09.09-12.11	■
T5 (B 4204 T7)	elec.brake detention	Gasolina	FWD	1999	177	241	01.10-12.14	■
2.5 T (B 5254 T6)	elec.brake detention	Gasolina	FWD	2521	147	200	08.07-12.09	■
2.5 T (B 5254 T10)	elec.brake detention	Gasolina	FWD	2521	170	231	04.09-12.12	■
T6 AWD (B 6304 T2)	elec.brake detention	Gasolina	4WD	2953	210	286	08.07-12.10	■
T6 AWD (B 6304 T4)	elec.brake detention	Gasolina	4WD	2953	224	305	01.10-12.15	■
T6 AWD (B 6304 T4)		Gasolina	4WD	2953	242	329	11.13-04.16	■
3.2 (B 6324 S)	elec.brake detention	Gasolina	FWD	3192	175	238	08.07-12.10	■
3.2 AWD (B 6324 S)	elec.brake detention	Gasolina	4WD	3192	175	238	04.07-12.10	■
3.2 (B 6324 S5)	elec.brake detention	Gasolina	FWD	3192	179	243	04.10-12.14	■
3.2 AWD (B 6324 S5)	elec.brake detention	Gasolina	4WD	3192	179	243	04.10-12.15	■
2.0 BiFuel (B 5204 T9)		Gasol./Gas (LPG)	FWD	1984	157	214	03.13-12.15	■
T4F (B 4164 T2)	elec.brake detention	Gasol./Etanol	FWD	1596	132	180	01.11-12.15	■
2.0 FlexiFuel (B 4204 S4)	elec.brake detention	Gasol./Etanol	FWD	1999	107	146	01.08-12.11	■
2.5 T FlexiFuel (B 5254 T8)	elec.brake detention	Gasol./Etanol	FWD	2521	147	200	05.08-12.09	■
2.5 T FlexiFuel (B 5254 T11)	elec.brake detention	Gasol./Etanol	FWD	2521	170	231	04.09-12.11	■
1.6 D (D 4164 T)	elec.brake detention	Diesel	FWD	1560	80	109	07.09-12.11	■
1.6 DRIVE / D2 (D 4162 T)	elec.brake detention	Diesel	FWD	1560	84	114	04.11-12.15	■
D2 (D 4204 T20)	elec.brake detention	Diesel	FWD	1969	88	120	03.15-04.16	■
D3 (D 4204 T9)	elec.brake detention	Diesel	FWD	1969	110	150	03.15-04.16	■
D4 (D 4204 T5)	elec.brake detention	Diesel	FWD	1969	133	181	10.13-04.16	■
D3 (D 5204 T7)	elec.brake detention	Diesel	FWD	1984	100	136	10.07-12.15	■
D3 / D4 (D 5204 T2)	elec.brake detention	Diesel	FWD	1984	120	163	03.10-12.15	■
D3 / D4 (D 5204 T3)	elec.brake detention	Diesel	FWD	1984	120	163	03.10-12.15	■
D4	elec.brake detention	Diesel	RWD	1984	120	163	01.13-	■
2.0 D (D 4204 T)	-12/10, elec.brake detention	Diesel	FWD	1998	100	136	10.07-12.15	■
2.4 D (D 5244 T19)	elec.brake detention	Diesel	FWD	2400	120	163	04.07-12.10	■
2.4 D (D 5244 T5)	elec.brake detention	Diesel	FWD	2400	120	163	04.07-12.10	■
D4 AWD (D 5244 T17)	elec.brake detention	Diesel	4WD	2400	120	163	10.07-12.15	■
2.4 D (D 5244 T14)	elec.brake detention	Diesel	FWD	2400	129	175	04.09-12.10	■
D4 AWD (D 5244 T12)	elec.brake detention	Diesel	4WD	2400	133	181	10.13-04.16	■
D5 (D 5244 T4)	elec.brake detention	Diesel	FWD	2400	136	185	04.07-12.09	■
D5 (D 5244 T10)	elec.brake detention	Diesel	FWD	2400	151	205	10.08-12.11	■
D5 AWD (D 5244 T10)	elec.brake detention	Diesel	4WD	2400	151	205	12.09-12.11	■
D5 (D 5244 T11)	elec.brake detention	Diesel	FWD	2400	158	215	04.11-12.15	■
D5 (D 5244 T15)	elec.brake detention	Diesel	FWD	2400	158	215	04.11-12.15	■
D5 AWD (D 5244 T15)	elec.brake detention	Diesel	4WD	2400	158	215	04.11-12.15	■
D5	elec.brake detention	Diesel	FWD	2400	169	230	03.11-04.16	■
D5 AWD	elec.brake detention	Diesel	4WD	2400	169	230	03.11-04.16	■
D5 AWD (D 5244 T4)	elec.brake detention	Diesel	4WD	2401	136	185	04.07-12.09	■
XC70 III (136) 04.07-					Estate (Executive car-E Segment)			
T5 (B 4204 T11)	elec.brake detention	Gasolina	FWD	1969	180	245	10.13-12.16	■

LISTA DE APLICACIONES - BUYERS GUIDE

T6 AWD (B 5254 T14)		Gasolina	4WD	2497	183	249	03.15-12.16	■
T5 AWD (B 5254 T12)		Gasolina	4WD	2497	187	254	08.15-12.16	■
T6 AWD (B 6304 T2)	elec.brake detention	Gasolina	4WD	2953	210	286	01.08-12.16	■
T6 AWD (B 6304 T4)	elec.brake detention	Gasolina	4WD	2953	224	304	01.10-04.15	■
T6 Polestar AWD		Gasolina	4WD	2953	242	329	11.13-12.16	■
3.2	elec.brake detention	Gasolina	FWD	3192	171	233	09.10-12.12	■
3.2 AWD (B 6324 S)	elec.brake detention	Gasolina	4WD	3192	175	238	08.07-12.11	■
3.2	elec.brake detention	Gasolina	FWD	3192	179	243	08.07-	■
3.2 AWD (B 6324 S5)	elec.brake detention	Gasolina	4WD	3192	179	243	05.10-12.14	■
D4 (D 4204 T5)	elec.brake detention	Diesel	FWD	1969	133	181	10.13-04.16	■
D3 (D 5204 T2)	elec.brake detention	Diesel	FWD	1984	120	163	04.10-12.15	■
D3 (D 5204 T3)	elec.brake detention	Diesel	FWD	1984	120	163	04.10-12.15	■
D3	elec.brake detention	Diesel	RWD	1984	120	163	08.11-	■
2.4 D / D4 AWD (D 5244 T16)	elec.brake detention	Diesel	4WD	2400	120	163	08.07-04.16	■
2.4 D / D4 AWD (D 5244 T17)	elec.brake detention	Diesel	4WD	2400	120	163	08.07-04.16	■
2.4 D / D4 AWD (D 5244 T5)	elec.brake detention	Diesel	4WD	2400	120	163	08.07-04.16	■
2.4 D (D 5244 T14)	elec.brake detention	Diesel	FWD	2400	129	175	06.09-12.10	■
D4 AWD (D 5244 T12)	elec.brake detention	Diesel	4WD	2400	133	181	10.13-04.16	■
D5 AWD (D 5244 T4)	elec.brake detention	Diesel	4WD	2400	136	185	04.07-12.09	■
D5 AWD (D 5244 T10)	elec.brake detention	Diesel	4WD	2400	151	205	04.09-12.11	■
D5 AWD (D 5244 T11)	elec.brake detention	Diesel	4WD	2400	158	215	04.11-12.15	■
D5 AWD (D 5244 T15)	elec.brake detention	Diesel	4WD	2400	158	215	04.11-12.15	■
D5 AWD (D 5244 T20)	elec.brake detention	Diesel	4WD	2400	162	220	03.15-04.16	■
D5 AWD (D 5244 T15)		Diesel	4WD	2400	169	230	11.13-04.16	■
XC70 III VAN (136) 04.07-12.16					Estate Van (Executive car-E Segment)			
2.0 D4		Diesel	FWD	1984	120	163	09.13-12.16	■
2.4 D4 AWD		Diesel	4WD	2400	120	163	09.13-04.16	■
2.4 D5 AWD		Diesel	4WD	2400	158	215	09.13-12.16	■
VOLVO ASIA								
S60L 06.14-					Saloon (Compact executive car-D Segment)			
1.5 T3		Gasolina	FWD	1498	112	152	06.15-12.19	■
2.0 T4		Gasolina	FWD	1969	140	190	06.15-12.19	■
2.0 T5		Gasolina	FWD	1969	180	245	06.15-12.19	■
2.0 T		Gasolina	FWD	1984	132	180	06.14-12.19	■
2.0 T5		Gasolina	FWD	1984	157	214	06.14-12.15	■